

*Release Immed.
No offsets*

Mobil Producing Texas & New Mexico Inc.

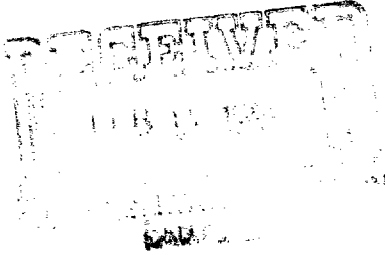

P.O. BOX 633
MIDLAND, TEXAS 79702

February 11, 1986

State of New Mexico
Energy and Minerals Department
Oil Conservation Division
State Land Office Building
Post Office Box 2088
Santa Fe, New Mexico 87501

*Case 8868
Set 509 to
hearing
only
4/2/86*

Attention: Dave Catanach

7.01
UNORTHODOX WELL LOCATIONS
MOBIL PRODUCING TX & NM, INC.
BRIDGES STATE, WELL NOS. 509 & 510
VACUUM (G-SA) FIELD
LEA COUNTY, NEW MEXICO

Gentlemen:

Mobil Producing Texas & New Mexico, Inc. (MPTM), is applying for authority to drill the subject wells at an unorthodox location under the provisions of Rule 104 (F). The wells are located closer than 330 feet from the quarter-quarter line but more than 330 feet from the lease line. These wells will be completed in the Vacuum (Grayburg-San Andres) Pool, which is a secondary recovery project.

In order to develop a 20-acre spacing program, these wells are needed at these locations to improve the recovery pattern and recover hydrocarbons that might otherwise be left in place.

In support of this request, the following items are being submitted in triplicate:

1. Form C-101 - Application for Permit to Drill, Deepen or Plug Back;
2. Form C-102 - Well location and acreage dedication plats;
3. Certified plat showing all well locations and offset operators.

State of New Mexico
Unorthodox Well Locations
Bridges State, Well Nos. 509 & 510

Page 2

MPTM is the operator of all land surrounding the 40-acre proration units.

Due to the above stated reason, we are requesting administrative approval on the unorthodox locations.

If you have any questions, please call Jean Partanen at (915) 688-2244.

Yours very truly,

G. E. Tate
JBP

G. E. Tate
Env. & Reg. Manager

JBPartanen/dwc

Attachments

cc: Oil Conservation Commission - Hobbs

Gordon Tate

Case 8868

NO. OF COPIES RECEIVED	
DISTRIBUTION	
SANTA FE	
FILE	
U.S.G.S.	
LAND OFFICE	
OPERATOR	

NEW MEXICO OIL CONSERVATION COMMISSION

Form C-101
Revised 1-1-65

5A. Indicate Type of Lease
STATE FEE

5. State Oil & Gas Lease No.
B-1520

APPLICATION FOR PERMIT TO DRILL, DEEPEN, OR PLUG BACK

1a. Type of Work
b. Type of Well DRILL DEEPEN PLUG BACK
OIL WELL GAS WELL OTHER SINGLE ZONE MULTIPLE ZONE

2. Name of Operator
Mobil Producing TX & NM, Inc.

3. Address of Operator
P. O. Box 633, Midland, Texas 79702

4. Location of Well
UNIT LETTER E LOCATED 1400 FEET FROM THE North LINE
AND 125 FEET FROM THE West LINE OF SEC. 23 TWP. T-17-S RGE 34-E NMPM

7. Unit Agreement Name

8. Farm or Lease Name
Bridges State

9. Well No.
509

10. Field and Pool, or Wildcat
Vacuum (G-SA)

12. County
Lea

19. Proposed Depth 5000' 19A. Formation Grayburg-San Andres 20. Rotary or C.T. Rotary

21. Elevations (Show whether DF, RT, etc.) 4033' 21A. Kind & Status Plug. Bond Blanket-On File 21B. Drilling Contractor Unknown 22. Approx. Date Work will start 03/15/86

PROPOSED CASING AND CEMENT PROGRAM

SIZE OF HOLE	SIZE OF CASING	WEIGHT PER FOOT	SETTING DEPTH	SACKS OF CEMENT	EST. TOP
12-1/4"	8-5/8"	24#	0 - 1700'	1 Circulate	Surface
7/8"	5-1/2"	14#	0-4800'	2 Circulate	Surface

- Class C + 2% CaCl₂ + 1/4 #/sx FC
- Lead - Class C + 4% gel + 15 #/sx salt + 1/4 #/sx FC
Tail - Class C + 2% CaCl₂ + 1/4 #/sx FC

BLOWOUT PREVENTOR PROGRAM

Casing String	Equipment Size & Series	No. & Type	Test Pressure (ps)
Surface	13-5/8" X 3000#	1 Pipe Ram & 1-MG	3000
Intermediate	9 - 11" X 5000#	1 Pipe Ram & 1-MG	5000

NOTE: MPTM is the operator of all land surrounding the 40 acre proration unit.

IN ABOVE SPACE DESCRIBE PROPOSED PROGRAM: IF PROPOSAL IS TO DEEPEN OR PLUG BACK, GIVE DATA ON PRESENT PRODUCTIVE ZONE AND PROPOSED NEW PRODUCTIVE ZONE. GIVE BLOWOUT PREVENTOR PROGRAM, IF ANY.

I hereby certify that the information above is true and complete to the best of my knowledge and belief.

Signed G. E. Tate G. E. Tate Title Env. & Reg. Manager Date 2/11/86

(This space for State Use)

APPROVED BY _____ TITLE _____ DATE _____

CONDITIONS OF APPROVAL, IF ANY:

All distances must be from the outer boundaries of the Section.

Operator Mobil Producing Tx. & N. M., Inc.		Lease Bridges State			Well No. 509
Unit Letter E	Section 23	Township T-17-S	Range R-34-E	County Lea	
Actual Footage Location of Well: 1400 feet from the North line and 125 feet from the West line					
Ground Level Elev. 4033	Producing Formation Grayburg-San Andres		Pool Vacuum	Dedicated Acreage: 40 Acres	

1. Outline the acreage dedicated to the subject well by colored pencil or hachure marks on the plat below.
2. If more than one lease is dedicated to the well, outline each and identify the ownership thereof (both as to working interest and royalty).
3. If more than one lease of different ownership is dedicated to the well, have the interests of all owners been consolidated by communitization, unitization, force-pooling, etc?

 Yes No If answer is "yes," type of consolidation _____

If answer is "no," list the owners and tract descriptions which have actually been consolidated. (Use reverse side of this form if necessary.) _____

No allowable will be assigned to the well until all interests have been consolidated (by communitization, unitization, forced-pooling, or otherwise) or until a non-standard unit, eliminating such interests, has been approved by the Division.

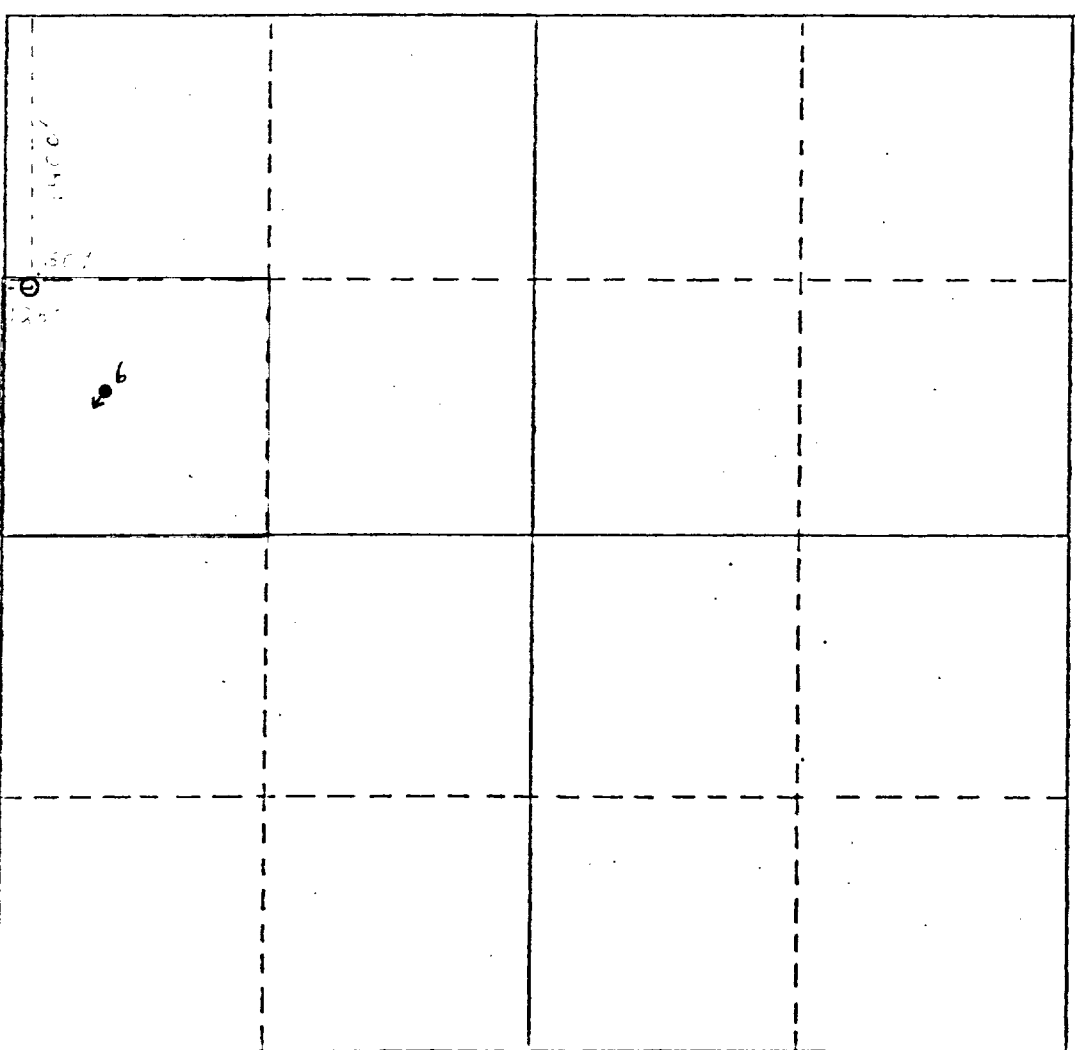

CERTIFICATION

I hereby certify that the information contained herein is true and complete to the best of my knowledge and belief.

G. E. Tate
Name
G. E. Tate

Position
Env. & Reg. Manager

Company
Mobil Producing Tx. & N.M., Inc.

Date

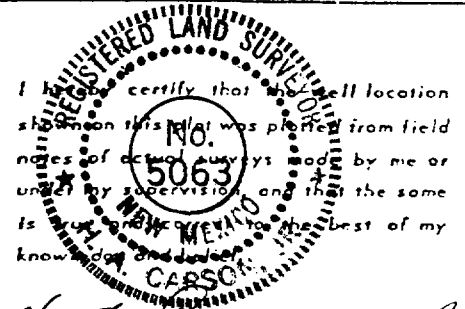

H. A. Carson Jr.
Date Surveyed
1-24-86

Registered Professional Engineer
and/or Land Surveyor

H. A. Carson Jr.
Certificate No.
5063

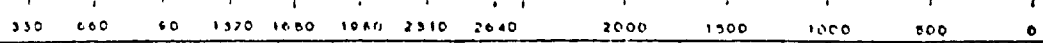

THIS DRAWING AND ALL INFORMATION THEREON IS THE PROPERTY OF MOBIL PRODUCING TEXAS & NEW MEXICO INC. AND SHALL NOT BE COPIED OR USED EXCEPT FOR THE PURPOSE FOR WHICH IT IS EXPRESSLY FURNISHED. THE DRAWING AND ANY COPIES THEREON (PARTIAL OR COMPLETE) SHALL BE RETURNED TO THE OWNER ON DEMAND.

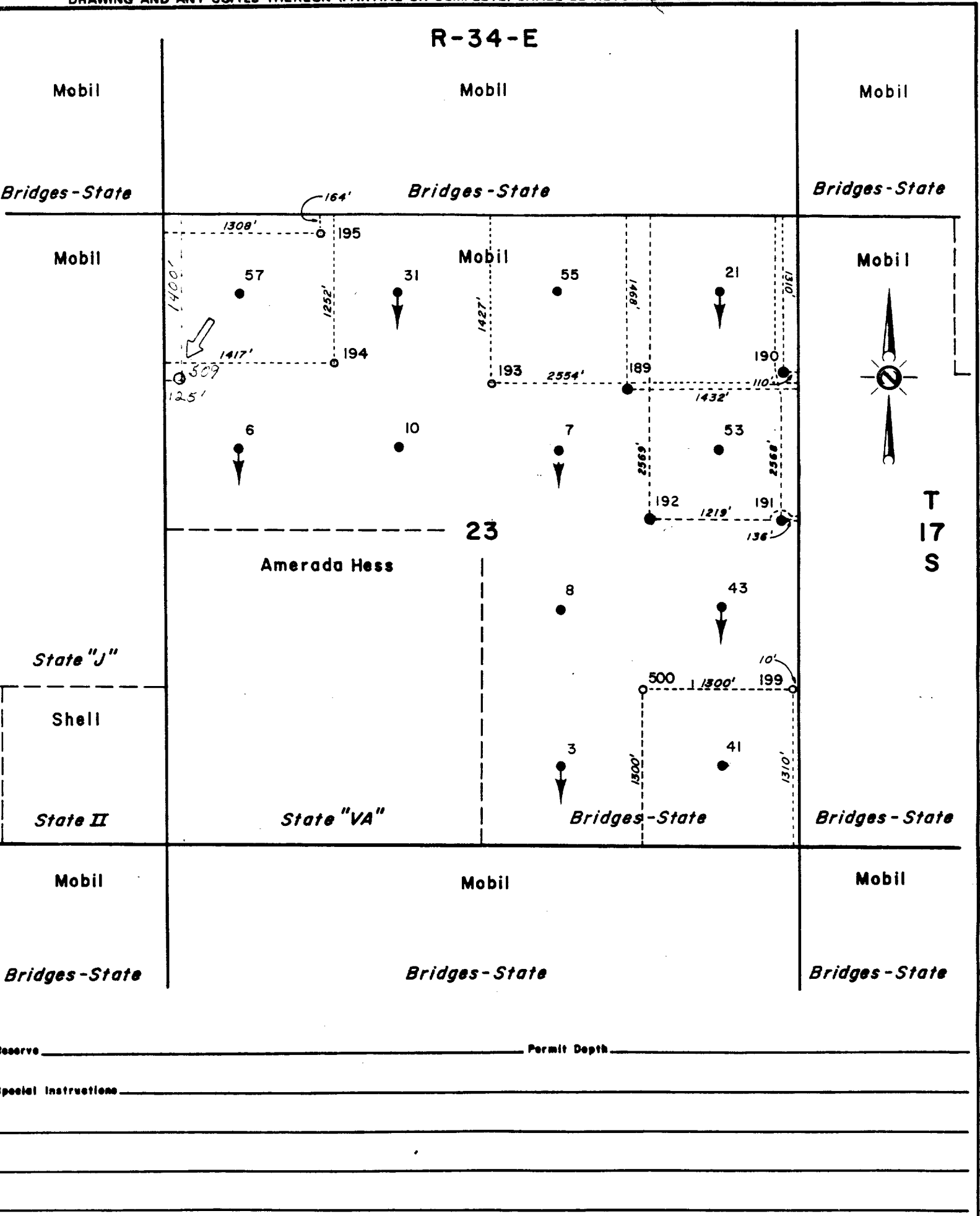

Reserve _____ Permit Depth _____
 Special Instructions _____

THE STATE OF TEXAS
 COUNTY OF MIDLAND

I hereby certify that this plat truly represents conditions as they actually exist on this lease; that said plat which is drawn to the scale indicated hereon, is to the best of my knowledge true and correct; that it accurately shows said lease with all wells on same; that number and locations of said wells are as indicated hereon; and that this plat correctly reflects all pertinent and required data.

Signature: G. E. Tate
 Title: Env. & Reg. Manager
 Date: February 11, 1986

Mobil Producing Texas & New Mexico Inc.
 Midland, Texas

LEASE Bridges State

WELL NO. 509 DATE February 11, 1986

LEASE NO. NM-569

TOTAL ACRES IN LEASE 5281.38 ACRES COVERED BY PLAT _____

DESCRIPTION Lot 2, SWNE & SE1/4 Sec. 3; NE1/4 Sec. 10; S1/2 Sec. 11; E1/2 & SW1/4 Sec. 12; W1/2 & NE1/4 Sec. 13; Sec. 14; E1/2 Sec. 15; N1/2 & SE1/4 Sec. 23; W1/2 NW, SE NW, & SW1/4 Sec. 24; NW1/4, N1/2 NE & SW1/4 NE 1/4 Sec. 25; Sec. 26; E1/2 Sec. 27; T17S, R34E; E1/2 Sec. 25; & E1/2 Sec. 34; T16S, R34E

Lea County, New Mexico

DRAWN <u>CTA</u>	DATE _____	FIELD <u>Vacuum</u>
SCALE <u>1" = 1000'</u>	FILE NO. <u>45-3</u>	(Grayburg-San Andres)

NO. OF COPIES RECEIVED	
DISTRIBUTION	
SANTA FE	
FILE	
U.S.G.S.	
LAND OFFICE	
OPERATOR	

NEW MEXICO OIL CONSERVATION COMMISSION

Form C-101
Revised 1-1-65

5A. Indicate Type of Lease
STATE FEE

5. State Oil & Gas Lease No.
B-1520

APPLICATION FOR PERMIT TO DRILL, DEEPEN, OR PLUG BACK

1a. Type of Work
b. Type of Well DRILL DEEPEN PLUG BACK
OIL WELL GAS WELL OTHER SINGLE ZONE MULTIPLE ZONE

2. Name of Operator
Mobil Producing TX & NM, Inc.

3. Address of Operator
P. O. Box 633, Midland, Texas 79702

4. Location of Well UNIT LETTER E LOCATED 1400 FEET FROM THE North LINE
AND 125 FEET FROM THE West LINE OF SEC. 23 TWP. T-17-S RGE 34-E NMPM

7. Unit Agreement Name

8. Farm or Lease Name
Bridges State

9. Well No.
509

10. Field and Pool, or Wildcat
Vacuum (G-SA)

12. County
Lea

19. Proposed Depth
5000'

19A. Formation
Grayburg-San Andres

20. Rotary or C.T.
Rotary

21. Elevations (Show whether DF, RT, etc.)
4033'

21A. Kind & Status Plug. Bond
Blanket-On File

21B. Drilling Contractor
Unknown

22. Approx. Date Work will start
03/15/86

PROPOSED CASING AND CEMENT PROGRAM

SIZE OF HOLE	SIZE OF CASING	WEIGHT PER FOOT	SETTING DEPTH	SACKS OF CEMENT	EST. TOP
12-1/4"	8-5/8"	24#	0 - 1700'	1 Circulate	Surface
7/8"	5-1/2"	14#	0-4800'	2 Circulate	Surface

- Class C + 2% CaCl₂ + 1/4 #/sx FC
- Lead - Class C + 4% gel + 15 #/sx salt + 1/4 #/sx FC
Tail - Class C + 2% CaCl₂ + 1/4 #/sx FC

BLOWOUT PREVENTOR PROGRAM

Casing String	Equipment Size & Series	No. & Type	Test Pressure (ps)
Surface	13-5/8" X 3000#	1 Pipe Ram & 1-MG	3000
Intermediate	9 - 11" X 5000#	1 Pipe Ram & 1-MG	5000

NOTE: MPTM is the operator of all land surrounding the 40 acre proration unit.

IN ABOVE SPACE DESCRIBE PROPOSED PROGRAM: IF PROPOSAL IS TO DEEPEN OR PLUG BACK, GIVE DATA ON PRESENT PRODUCTIVE ZONE AND PROPOSED NEW PRODUCTIVE ZONE. GIVE BLOWOUT PREVENTOR PROGRAM, IF ANY.

I hereby certify that the information above is true and complete to the best of my knowledge and belief.

Signed M. E. Tate G. E. Tate Title Env. & Reg. Manager Date 2/11/86

by JES (This space for State Use)

APPROVED BY _____ TITLE _____ DATE _____

CONDITIONS OF APPROVAL, IF ANY:

All distances must be from the outer boundaries of the Section.

Operator Mobil Producing Tx. & N. M., Inc.		Lease Bridges State			Well No. 509
Unit Letter E	Section 23	Township T-17-S	Range R-34-E	County Lea	
Actual Footage Location of Well: 1400 feet from the North line and 125 feet from the West line					
Ground Level Elev. 4033	Producing Formation Grayburg-San Andres		Pool Vacuum	Dedicated Acreage: 40 Acres	

1. Outline the acreage dedicated to the subject well by colored pencil or hachure marks on the plat below.
2. If more than one lease is dedicated to the well, outline each and identify the ownership thereof (both as to working interest and royalty).
3. If more than one lease of different ownership is dedicated to the well, have the interests of all owners been consolidated by communitization, unitization, force-pooling, etc?
 Yes No If answer is "yes," type of consolidation _____

If answer is "no," list the owners and tract descriptions which have actually been consolidated. (Use reverse side of this form if necessary.) _____

No allowable will be assigned to the well until all interests have been consolidated (by communitization, unitization, forced-pooling, or otherwise) or until a non-standard unit, eliminating such interests, has been approved by the Division.

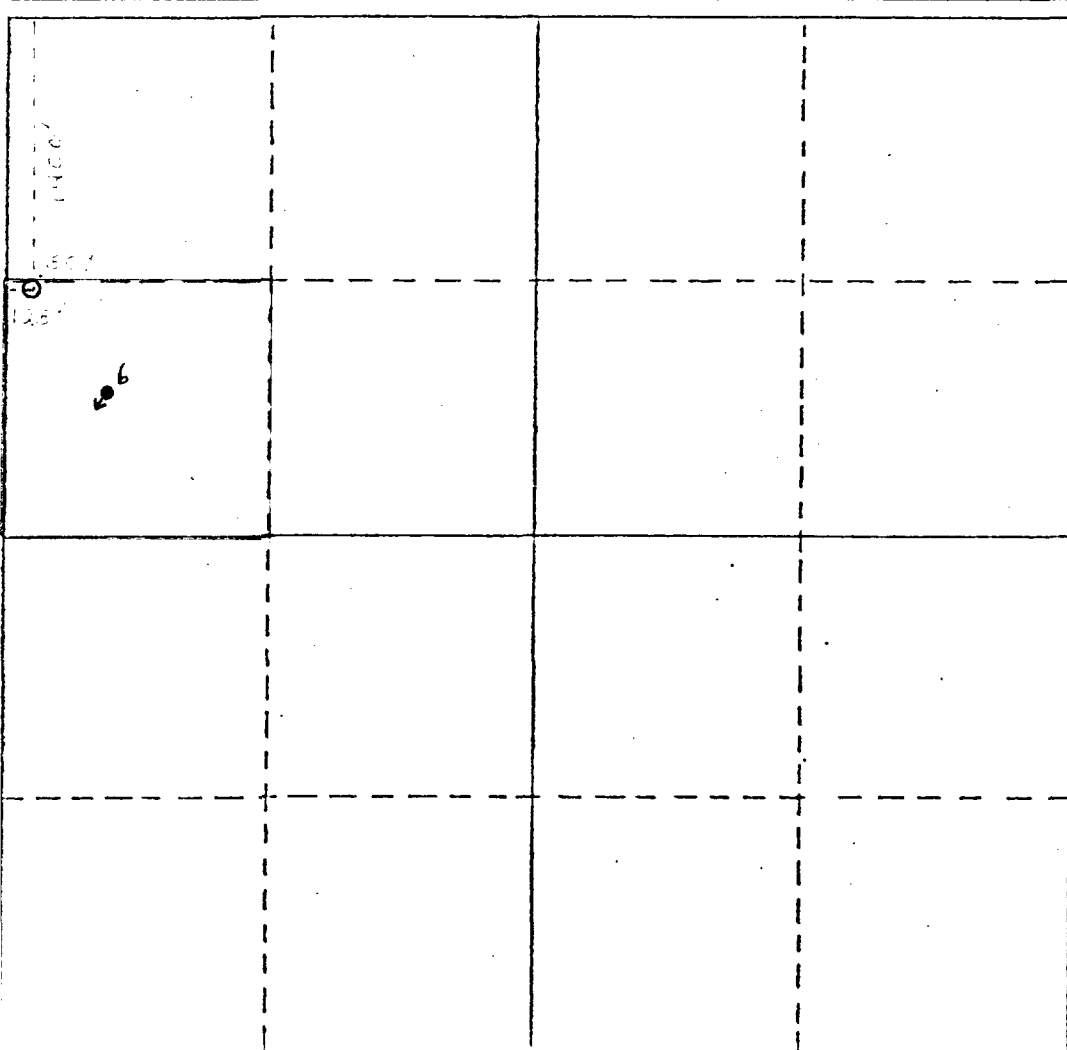

CERTIFICATION

I hereby certify that the information contained herein is true and complete to the best of my knowledge and belief.

G. E. Tate
 Name
 G. E. Tate
 Position
 Env. & Reg. Manager
 Company
 Mobil Producing Tx. & N.M., Inc
 Date

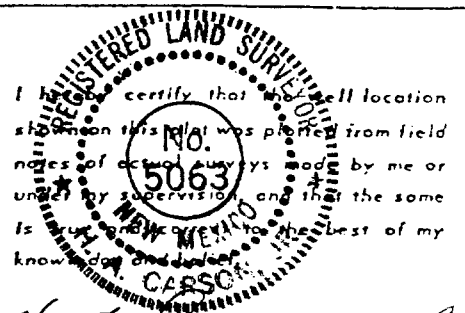

H. A. Carson Jr.
 Date Surveyed
 1-24-86
 Registered Professional Engineer
 and/or Land Surveyor

H. A. Carson Jr.
 Certificate No.
 5063

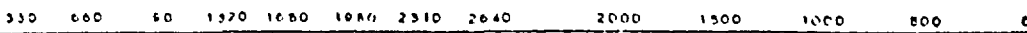

THIS DRAWING AND ALL INFORMATION THEREON IS THE PROPERTY OF MOBIL PRODUCING TEXAS & NEW MEXICO INC. AND SHALL NOT BE COPIED OR USED EXCEPT FOR THE PURPOSE FOR WHICH IT IS EXPRESSLY FURNISHED. THE DRAWING AND ANY COPIES THEREON (PARTIAL OR COMPLETE) SHALL BE RETURNED TO THE OWNER ON DEMAND.

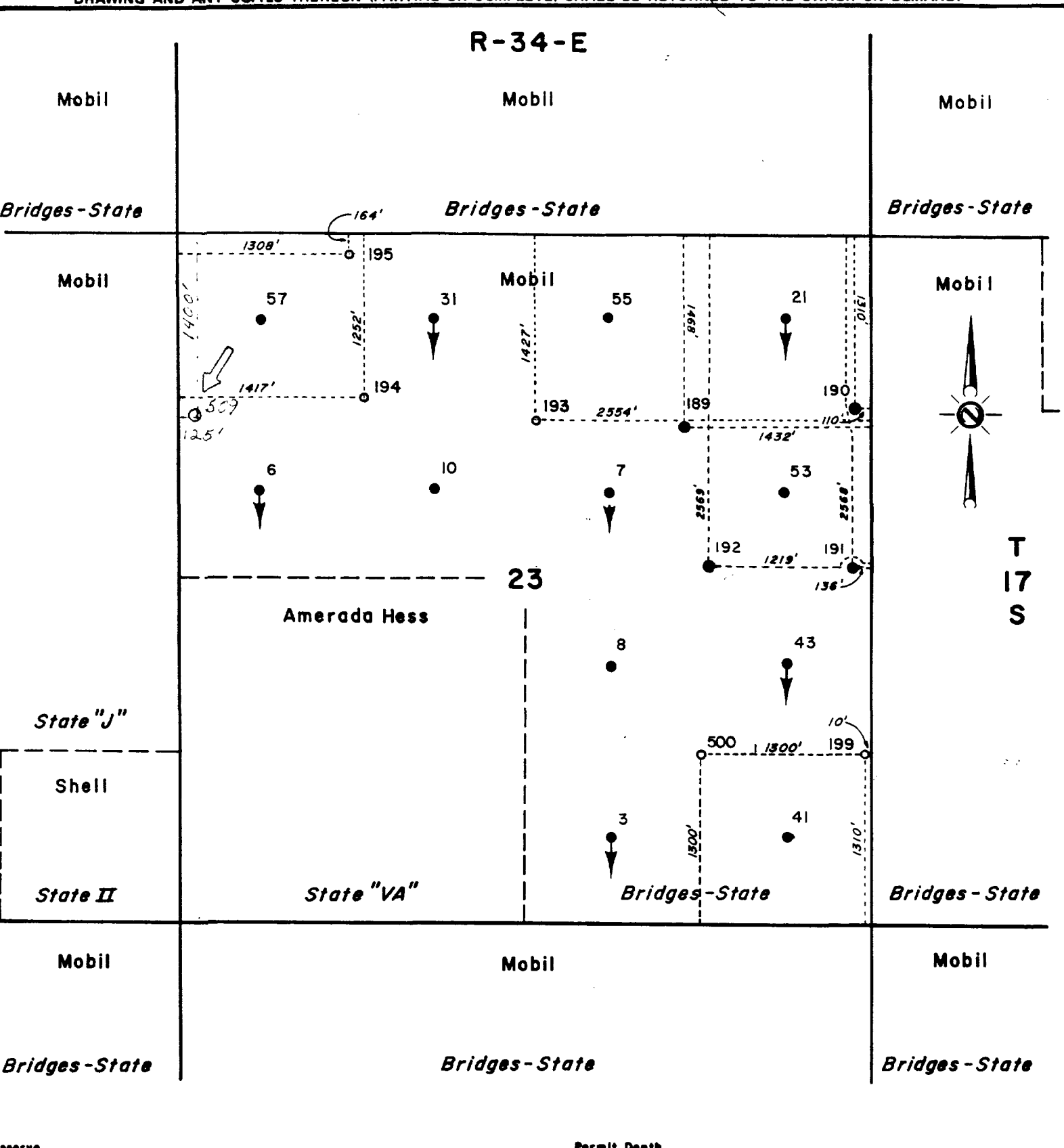

Reserve _____ Permit Depth _____
 Special Instructions _____

THE STATE OF TEXAS
 COUNTY OF MIDLAND
 I hereby certify that this plat truly represents conditions as they actually exist on this lease; that said plat which is drawn to the scale indicated hereon, is to the best of my knowledge true and correct; that it accurately shows said lease with all wells on same; that number and locations of said wells are as indicated hereon; and that this plat correctly reflects all pertinent and required data.
 Signature: G. E. Tate
 Title: Env. & Reg. Manager
 Date: February 11, 1986

Mobil Producing Texas & New Mexico Inc.
 Midland, Texas
 LEASE Bridges State
 WELL NO. 509 DATE February 11, 1986
 LEASE NO. NM-569
 TOTAL ACRES IN LEASE 5281.38 ACRES COVERED BY PLAT
 DESCRIPTION Lot 2, SWNE & SE 1/4 Sec. 3; NE 1/4 Sec. 10; S 1/2 Sec. 11; E 1/2 & SW 1/4 Sec. 12; W 1/2 & NE 1/4 Sec. 13; Sec. 14, E 1/2 Sec. 15; N 1/2 & SE 1/4 Sec. 23; W 1/2 NW, SE NW, & SW 1/4 Sec. 24; NW 1/4, N 1/2 NE & SW 1/4 NE 1/4 Sec. 25; Sec. 26; E 1/2 Sec. 27; T 17 S, R 34 E; E 1/2 Sec. 25; & E 1/2 Sec. 34; T 16 S, R 34 E
 Lea County, New Mexico
 DRAWN CTA DATE _____ FIELD Vacuum
 SCALE 1" = 1000' FILE NO. 45-3 (Grayburg-San Andres)

NO. OF COPIES RECEIVED	
DISTRIBUTION	
SANTA FE	
FILE	
U.S.G.S.	
LAND OFFICE	
OPERATOR	

NEW MEXICO OIL CONSERVATION COMMISSION

Form C-101
Revised 1-1-65

5A. Indicate Type of Lease
STATE FEE

5. State Oil & Gas Lease No.
B-1520

APPLICATION FOR PERMIT TO DRILL, DEEPEN, OR PLUG BACK

1a. Type of Work
b. Type of Well DRILL DEEPEN PLUG BACK
OIL WELL GAS WELL OTHER SINGLE ZONE MULTIPLE ZONE

2. Name of Operator
Mobil Producing TX & NM, Inc.

3. Address of Operator
P. O. Box 633, Midland, Texas 79702

4. Location of Well
UNIT LETTER E LOCATED 1400 FEET FROM THE North LINE
AND 125 FEET FROM THE West LINE OF SEC. 23 TWP. T-17-S RGE 34-E NMPM

19. Proposed Depth
5000'

19A. Formation
Grayburg-San Andres

20. Rotary or C.T.
Rotary

21. Elevations (Show whether DF, RT, etc.)
4033'

21A. Kind & Status Plug. Bond
Blanket-On File

21B. Drilling Contractor
Unknown

22. Approx. Date Work will start
03/15/86

7. Unit Agreement Name

8. Farm or Lease Name
Bridges State

9. Well No.
509

10. Field and Pool, or Wildcat
Vacuum (G-SA)

12. County
Lea

PROPOSED CASING AND CEMENT PROGRAM

SIZE OF HOLE	SIZE OF CASING	WEIGHT PER FOOT	SETTING DEPTH	SACKS OF CEMENT	EST. TOP
12-1/4"	8-5/8"	24#	0 - 1700'	1 Circulate	Surface
7/8"	5-1/2"	14#	0-4800'	2 Circulate	Surface

- Class C + 2% CaCl₂ + 1/4 #/sx FC
- Lead - Class C + 4% gel + 15 #/sx salt + 1/4 #/sx FC
Tail - Class C + 2% CaCl₂ + 1/4 #/sx FC

BLOWOUT PREVENTOR PROGRAM

Casing String	Equipment Size & Series	No. & Type	Test Pressure (ps)
Surface	13-5/8" X 3000#	1 Pipe Ram & 1-MG	3000
Intermediate	9 - 11" X 5000#	1 Pipe Ram & 1-MG	5000

NOTE: MPTM is the operator of all land surrounding the 40 acre proration unit.

IN ABOVE SPACE DESCRIBE PROPOSED PROGRAM: IF PROPOSAL IS TO DEEPEN OR PLUG BACK, GIVE DATA ON PRESENT PRODUCTIVE ZONE AND PROPOSED NEW PRODUCTIVE ZONE. GIVE BLOWOUT PREVENTOR PROGRAM, IF ANY.

I hereby certify that the information above is true and complete to the best of my knowledge and belief.

Signed G. E. Tate G. E. Tate Title Env. & Reg. Manager Date 2/11/86

(Signature)
(This space for State Use)

APPROVED BY _____ TITLE _____ DATE _____

CONDITIONS OF APPROVAL, IF ANY:

All distances must be from the outer boundaries of the Section.

Operator Mobil Producing Tx. & N. M., Inc.		Lease Bridges State			Well No. 509
Unit Letter E	Section 23	Township T-17-S	Range R-34-E	County Lea	
Actual Footage Location of Well: 1400 feet from the North line and 125 feet from the West line					
Ground Level Elev. 4033	Producing Formation Grayburg-San Andres		Pool Vacuum	Dedicated Acreage: 40 Acres	

1. Outline the acreage dedicated to the subject well by colored pencil or hachure marks on the plat below.
2. If more than one lease is dedicated to the well, outline each and identify the ownership thereof (both as to working interest and royalty).
3. If more than one lease of different ownership is dedicated to the well, have the interests of all owners been consolidated by communitization, unitization, force-pooling, etc?

Yes No If answer is "yes," type of consolidation _____

If answer is "no," list the owners and tract descriptions which have actually been consolidated. (Use reverse side of this form if necessary.) _____

No allowable will be assigned to the well until all interests have been consolidated (by communitization, unitization, forced-pooling, or otherwise) or until a non-standard unit, eliminating such interests, has been approved by the Division.

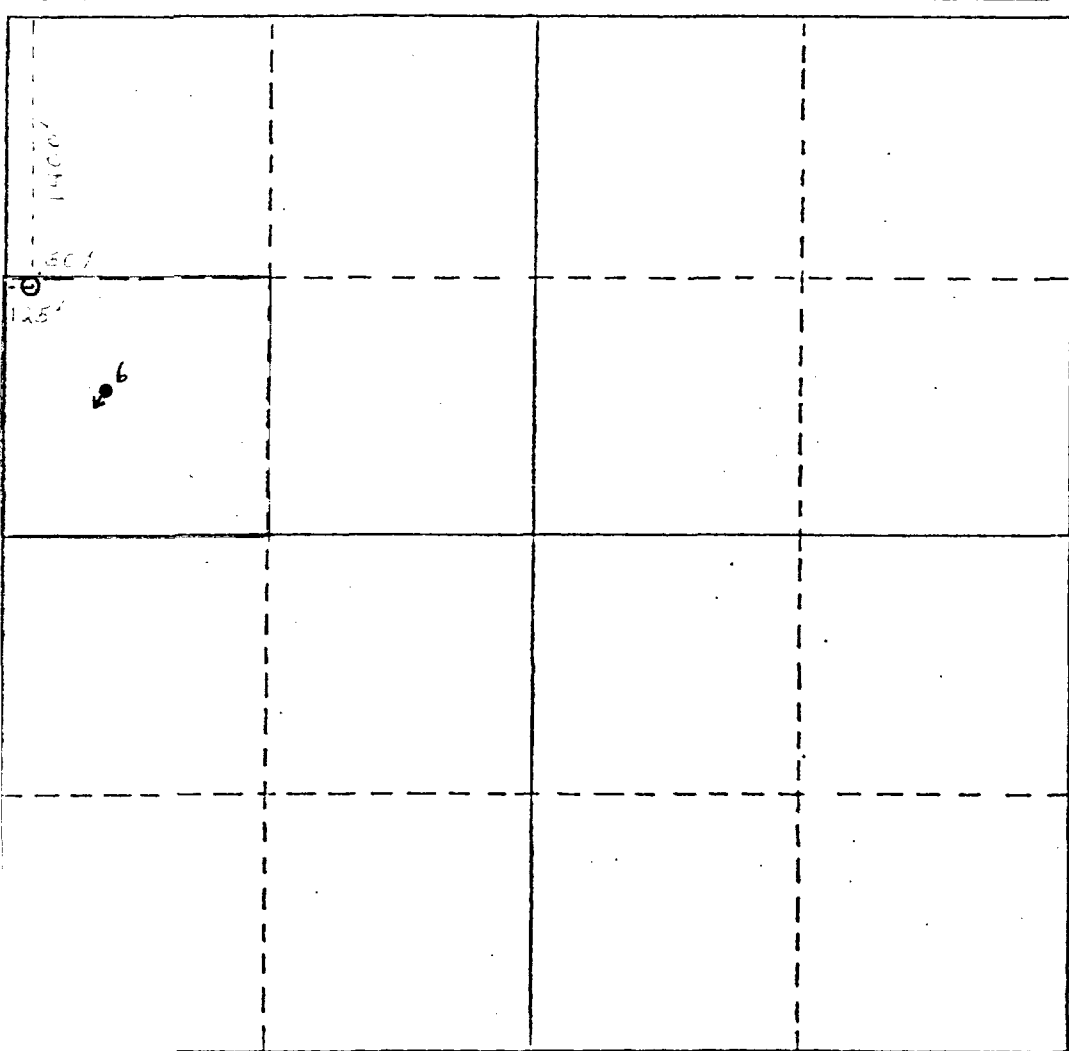

CERTIFICATION

I hereby certify that the information contained herein is true and complete to the best of my knowledge and belief.

G. E. Tate
Name *by G.E.T.*
G. E. Tate

Position
Env. & Reg. Manager

Company
Mobil Producing Tx. & N.M., Inc.

Date

I hereby certify that the well location shown on this plat was plotted from field notes of actual surveys made by me or under my supervision and that the same is true to the best of my knowledge and belief.

H. A. Carson Jr.
Date Surveyed

1-24-86

Registered Professional Engineer and/or Land Surveyor

H. A. Carson Jr.
Certificate No.

5063

THIS DRAWING AND ALL INFORMATION THEREON IS THE PROPERTY OF MOBIL PRODUCING TEXAS & NEW MEXICO INC. AND SHALL NOT BE COPIED OR USED EXCEPT FOR THE PURPOSE FOR WHICH IT IS EXPRESSLY FURNISHED. THE DRAWING AND ANY COPIES THEREON (PARTIAL OR COMPLETE) SHALL BE RETURNED TO THE OWNER ON DEMAND.

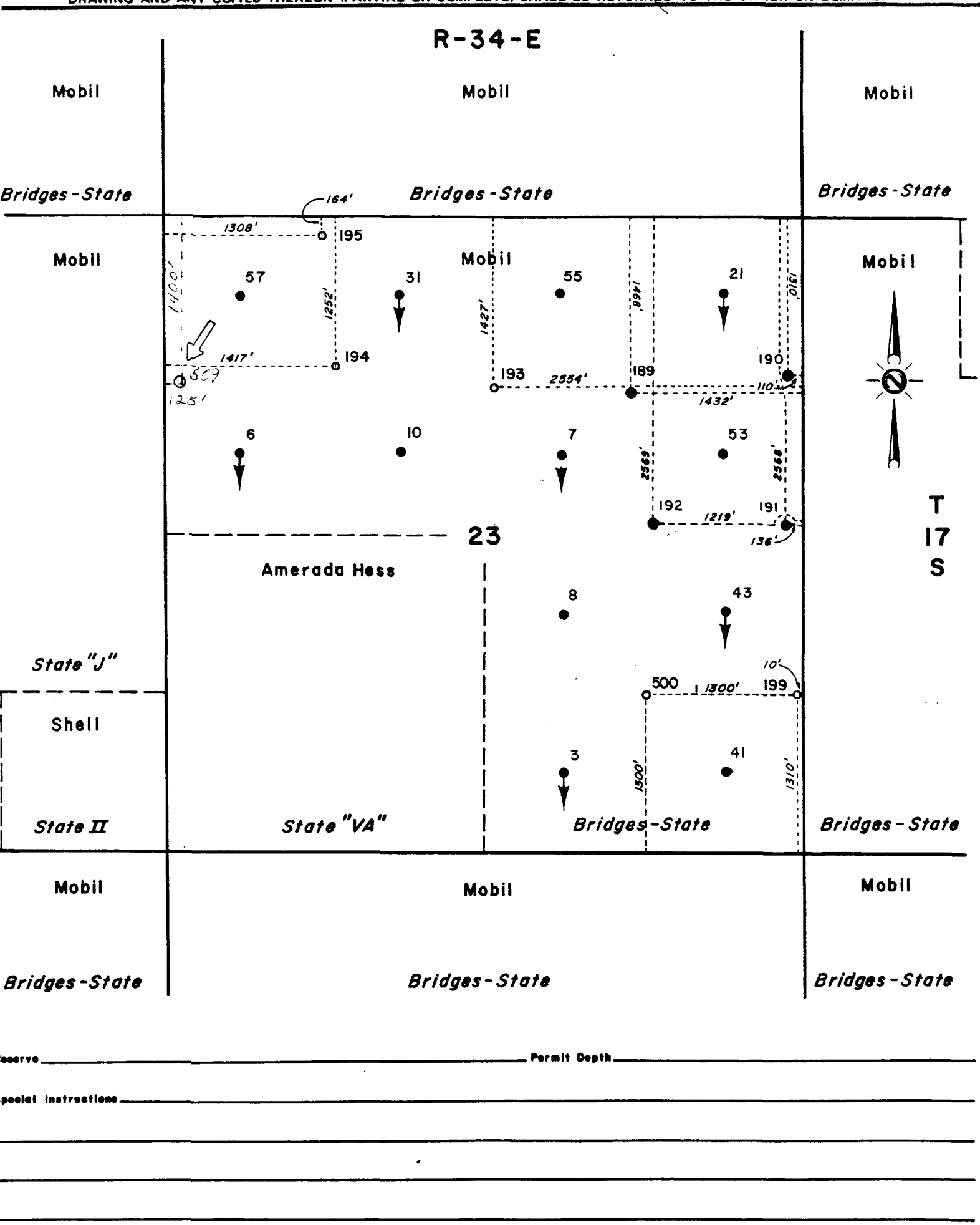

Reserve _____ Permit Depth _____
 Special Instructions _____

THE STATE OF TEXAS
 COUNTY OF MIDLAND

I hereby certify that this plat truly represents conditions as they actually exist on this lease; that said plat which is drawn to the scale indicated hereon, is to the best of my knowledge true and correct; that it accurately shows said lease with all wells on same; that number and locations of said wells are as indicated hereon; and that this plat correctly reflects all pertinent and required data.

Signature: G. E. Tate
 Title: Env. & Reg. Manager
 Date: February 11, 1986

Mobil Producing Texas & New Mexico Inc.
 Midland, Texas

LEASE Bridges State

WELL NO. 509 DATE February 11, 1986

LEASE NO. NM-569

TOTAL ACRES IN LEASE 5281.38 ACRES COVERED BY PLAT _____

DESCRIPTION Lot 2, SW NE 1/4 Sec. 3; NE 1/4 Sec. 10; S 1/2 Sec. 11; E 1/2 SW 1/4 Sec. 12; W 1/2 & NE 1/4 Sec. 13; Sec. 14; E 1/2 Sec. 15; N 1/2 & SE 1/4 Sec. 23; W 1/2 NW, SE NW, & SW 1/4 Sec. 24; NW 1/4, N 1/2 NE & SW 1/4 NE 1/4 Sec. 25; Sec. 26; E 1/2 Sec. 27; T 17 S, R 34 E; E 1/2 Sec. 25; & E 1/2 Sec. 34; T 16 S, R 34 E

Lea County, New Mexico

DRAWN <u>CTA</u>	DATE _____	FIELD <u>Vacuum</u>
SCALE <u>1" = 1000'</u>	FILE NO. <u>45-3</u>	(Grayburg-San Andres)