

Mobil Producing Texas & New Mexico Inc.

P.O. BOX 433
MIDLAND, TEXAS 79702

February 11, 1986

State of New Mexico
Energy and Minerals Department
Oil Conservation Division
State Land Office Building
Post Office Box 2088
Santa Fe, New Mexico 87501

BEFORE EXAMINER STOGNER
Oil Conservation Division
<u>MOBIL</u> Exhibit No. <u>1</u>
Case No. <u>886B</u>

Attention: Dave Catanach

7.01
UNORTHODOX WELL LOCATIONS
MOBIL PRODUCING TX & NM, INC.
BRIDGES STATE, WELL NOS. 509 & 510
VACUUM (G-SA) FIELD
LEA COUNTY, NEW MEXICO

Gentlemen:

Mobil Producing Texas & New Mexico, Inc. (MPTM), is applying for authority to drill the subject wells at an unorthodox location under the provisions of Rule 104 (F). The wells are located closer than 330 feet from the quarter-quarter line but more than 330 feet from the lease line. These wells will be completed in the Vacuum (Grayburg-San Andres) Pool, which is a secondary recovery project.

In order to develop a 20-acre spacing program, these wells are needed at these locations to improve the recovery pattern and recover hydrocarbons that might otherwise be left in place.

In support of this request, the following items are being submitted in triplicate:

1. Form C-101 - Application for Permit to Drill, Deepen or Plug Back;
2. Form C-102 - Well location and acreage dedication plats;
3. Certified plat showing all well locations and offset operators.

State of New Mexico
Unorthodox Well Locations
Bridges State, Well Nos. 509 & 510

Page 2

MPTM is the operator of all land surrounding the 40-acre proration units.

Due to the above stated reason, we are requesting administrative approval on the unorthodox locations.

If you have any questions, please call Jean Partanen at (915) 688-2244.

Yours very truly,

G. E. Tate
JBP
G. E. Tate
Env. & Reg. Manager

JBPpartanen/dwc

Attachments

cc: Oil Conservation Commission - Hobbs

A:M6042DCA.JBP

NO. OF COPIES RECEIVED
DISTRIBUTION
ANTA FE
FILE
U.S.G.S.
LAND OFFICE
OPERATOR

NEW MEXICO OIL CONSERVATION COMMISSION

Form O-101
Revised 4-65

1A. Indicate Type of Lease STATE <input checked="" type="checkbox"/> FEE <input type="checkbox"/>
2. State Oil & Gas Lease No. 3-1520

APPLICATION FOR PERMIT TO DRILL, DEEPEN, OR PLUG BACK

1. Type of Work a. Type of Well DRILL <input checked="" type="checkbox"/> DEEPEN <input type="checkbox"/> PLUG BACK <input type="checkbox"/> b. Type of Well OIL WELL <input checked="" type="checkbox"/> GAS WELL <input type="checkbox"/> OTHER <input type="checkbox"/> SINGLE ZONE <input checked="" type="checkbox"/> MULTIPLE ZONE <input type="checkbox"/>
2. Name of Operator Mobil Producing TX & NM, Inc.
3. Address of Operator P. O. Box 633, Midland, Texas 79702
4. Location of Well UNIT LETTER <u>E</u> LOCATED <u>1400</u> FEET FROM THE <u>North</u> LINE NO. <u>125</u> FEET FROM THE <u>West</u> LINE OF SEC. <u>23</u> TWP. <u>T-17-S</u> RGE <u>34-E</u> NMPM

7. Unit Agreement Name
8. Farm or Lease Name Bridges State
9. Well No. 509
10. Field and Pool, or Wildcat Vacuum (G-SA)
12. County Lea

19. Proposed Depth 5000'	19A. Formation Grayburg-San Andres	20. Rotary or C.T. Rotary	
11. Elevations (Show whether DF, RT, etc.) 4033'	21A. Kind & Status Plug. Bond Blanket-On File	21B. Drilling Contractor Unknown	22. Approx. Date Work will start 03/15/86

PROPOSED CASING AND CEMENT PROGRAM

SIZE OF HOLE	SIZE OF CASING	WEIGHT PER FOOT	SETTING DEPTH	SACKS OF CEMENT	EST. TOP
12-1/4"	8-5/8"	24#	0 - 1700'	1 Circulate	Surface
7-7/8"	5-1/2"	14#	0-4800'	2 Circulate	Surface

- Class C + 2% CaCl₂ + 1/4 #/sx FC
- Lead - Class C + 4% gel + 15 #/sx salt + 1/4 #/sx FC
Tail - Class C + 2% CaCl₂ + 1/4 #/sx FC

BLOWOUT PREVENTOR PROGRAM

Casing String	Equipment Size & Series	No. & Type	Test Pressure (ps)
Surface	13-5/8" X 3000#	1 Pipe Ram & 1-MG	3000
Intermediate	9 - 11" X 5000#	1 Pipe Ram & 1-MG	5000

NOTE: MPTM is the operator of all land surrounding the 40 acre proration unit.

IN ABOVE SPACE DESCRIBE PROPOSED PROGRAM; IF PROPOSAL IS TO DEEPEN OR PLUG BACK, GIVE DATA ON PRESENT PRODUCTIVE ZONE AND PROPOSED NEW PRODUCTIVE ZONE. GIVE BLOWOUT PREVENTOR PROGRAM, IF ANY.

I hereby certify that the information above is true and complete to the best of my knowledge and belief.

Signed M. E. Tate G. E. Tate Title Env. & Reg. Manager Date 2/11/86

(This space for State Use)

APPROVED BY _____ TITLE _____ DATE _____

CONDITIONS OF APPROVAL, IF ANY:

All distances must be from the outer boundaries of the Section.

Operator Mobil Producing Tx. & N. M., Inc.		Lease Bridges State			Well No. 509
Section Letter E	Section 23	Township T-17-S	Range R-34-E	County Lea	
Well: Postage Location of Well: 1400 feet from the North line and 125 feet from the West line					
Ground Level Elev. 4033	Producing Formation Grayburg-San Andres		Pool Vacuum	Dedicated Acreage: 40 Acres	

- Outline the acreage dedicated to the subject well by colored pencil or hachure marks on the plat below.
- If more than one lease is dedicated to the well, outline each and identify the ownership thereof (both as to working interest and royalty).
- If more than one lease of different ownership is dedicated to the well, have the interests of all owners been consolidated by communitization, unitization, force-pooling, etc?

Yes No If answer is "yes;" type of consolidation _____

If answer is "no;" list the owners and tract descriptions which have actually been consolidated. (Use reverse side of this form if necessary.) _____

No allowable will be assigned to the well until all interests have been consolidated (by communitization, unitization, forced-pooling, or otherwise) or until a non-standard unit, eliminating such interests, has been approved by the Division.

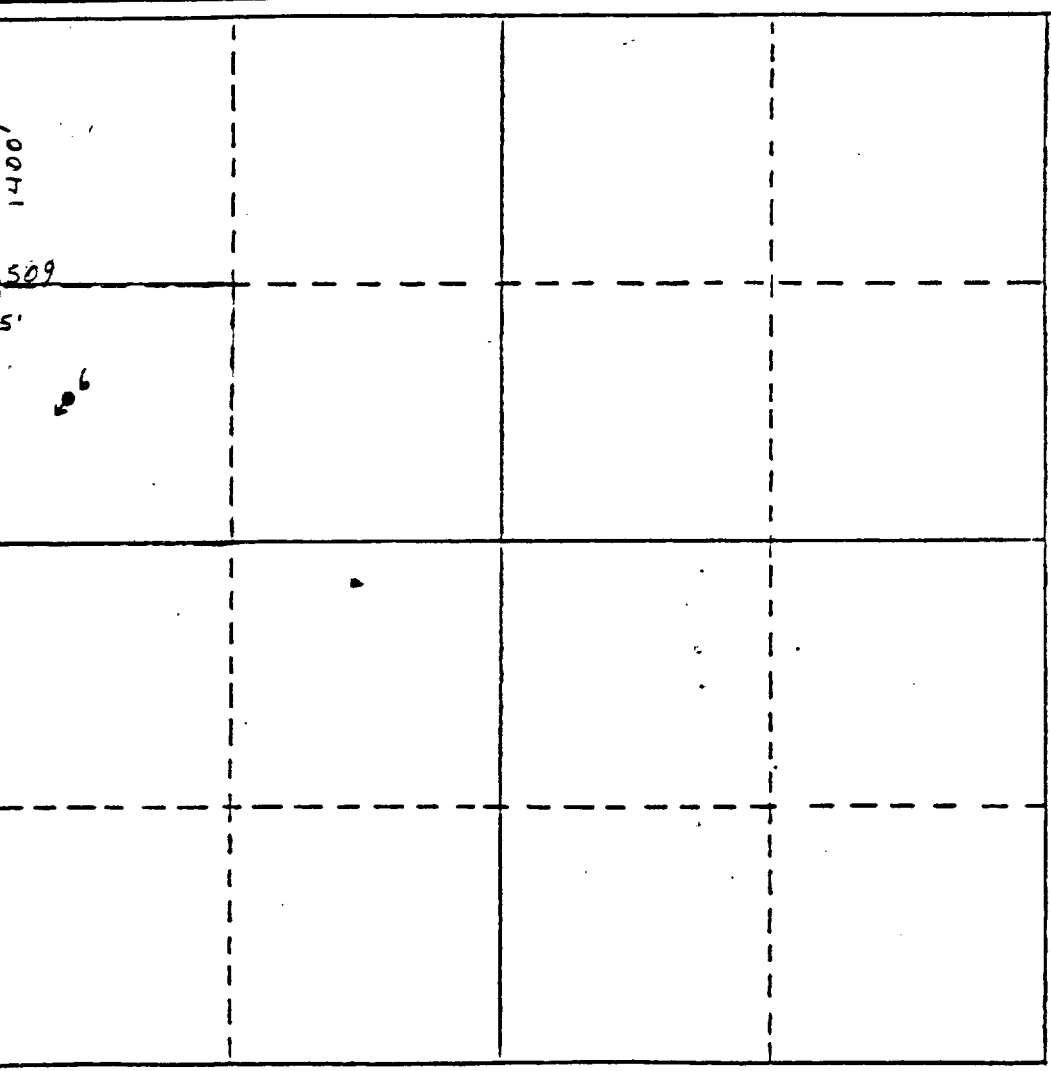

CERTIFICATION

I hereby certify that the information contained herein is true and complete to the best of my knowledge and belief.

G. E. Tate
Name
G. E. Tate
Position
Env. & Reg. Manager
Company
Mobil Producing Tx. & N.M., Inc.
Date

I hereby certify that the well location shown on this plat was plotted from field notes of at least 2 years made by me or under my supervision and that the same is true to the best of my knowledge.

H. A. Carson
Date Surveyed
1-24-86
Registered Professional Engineer
and/or Land Surveyor
H. A. Carson Jr.
Certificate No.
5063

THIS DRAWING AND ALL INFORMATION THEREON IS THE PROPERTY OF MOBIL PRODUCING TEXAS & NEW MEXICO INC. AND SHALL NOT BE COPIED OR USED EXCEPT FOR THE PURPOSE FOR WHICH IT IS EXPRESSLY FURNISHED. THE DRAWING AND ANY COPIES THEREON (PARTIAL OR COMPLETE) SHALL BE RETURNED TO THE OWNER ON DEMAND.

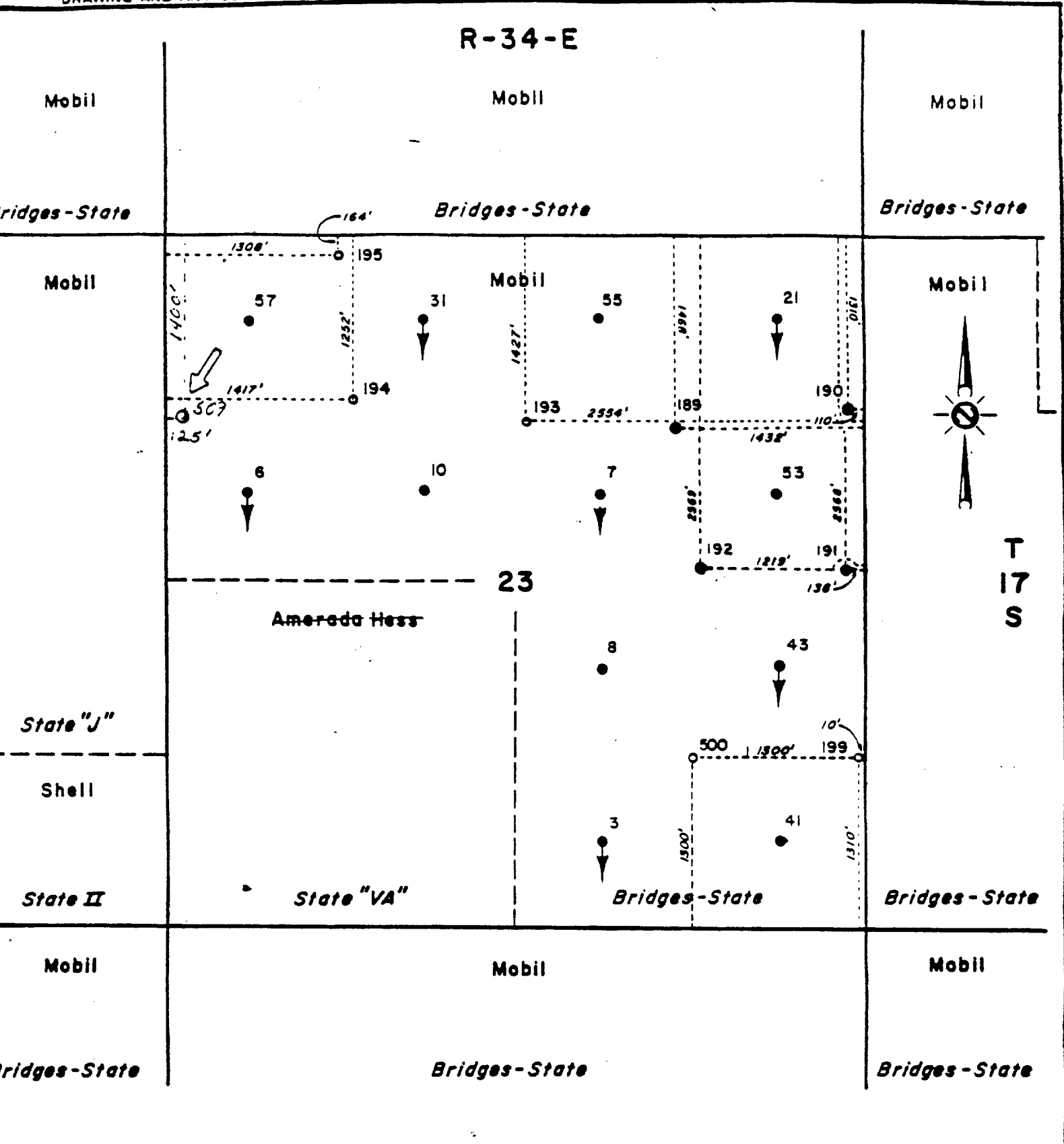

THE STATE OF TEXAS
 COUNTY OF MIDLAND

I hereby certify that this plat truly represents conditions as they actually exist on this lease; that said plat which is drawn to the scale indicated hereon, is to the best of my knowledge true and correct; that it accurately shows said lease with all wells on same; that number and locations of said wells are as indicated hereon; and that this plat correctly reflects all pertinent and required data.

Signature: *[Handwritten Signature]*
 Title: *[Handwritten Title]*
 Date: *[Handwritten Date]*

Mobil Producing Texas & New Mexico Inc.
 Midland, Texas

LEASE Bridges State

WELL NO. 509 DATE February 11, 1936

LEASE NO. NM-569

TOTAL ACRES IN LEASE 5281.38 ACRES COVERED BY PLAT _____

DESCRIPTION Lot 2, SWNE 1/4 Sec. 4, NE 1/4 Sec. 4, S1/2 Sec. 11, E1/2 SW 1/4 Sec. 12, W 1/2 NE 1/4 Sec. 3, Sec. 4, E1/2 Sec. 5, N1/2 BSE 1/4 Sec. 23, W 1/2 NW SE NW BSW 1/4 Sec. 24 NW 1/4 N1/2 NE BSW 1/4 NE 1/4 Sec. 25, Sec. 26, E 1/2 Sec. 25, B E 1/2 Sec. 34, T 6 S R 34 E

Lea County, New Mexico

DRAWN STA DATE _____ FIELD VOCUJ

Mobil Producing Texas & New Mexico Inc.

WAIVER

P O BOX 633
MIDLAND, TEXAS 79702

Mobil Producing TX & NM, Inc.
Attention: G. E. Tate
Post Office Box 633
Midland, Texas 79702

MIDLAND DIVISION

RE: UNORTHODOX WELL LOCATION
MOBIL PRODUCING TX & NM, INC.
BRIDGES STATE, WELL NO. 509
VACUUM (GRAYBURG-SAN ANDRES) FIELD
LEA COUNTY, NEW MEXICO

Gentlemen:

We, the undersigned, have been furnished a copy of Mobil Producing Texas & New Mexico, Inc.'s application to drill the subject well on an unorthodox location under the provisions of Rule 104.F.13. Please be informed that we, as an offset operator, on the State VA Lease, currently in the process of being assigned to Mobil, have no objection to the drilling of this well as set forth in MPTM's application dated February 11, 1986.

Yours truly,

Company _____

Representative _____

Signature _____

Title _____

Date _____