

KELLAHIN and KELLAHIN
Attorneys at Law
El Patio - 117 North Guadalupe
Post Office Box 2265
Santa Fe, New Mexico 87504-2265

Telephone 982-4285
Area Code 505

W. Thomas Kellahin
Karen Aubrey

Jason Kellahin
Of Counsel

February 10, 1987

HAND-DELIVERED

Mr. William J. LeMay
Oil Conservation Division
Post Office Box 2088
Santa Fe, New Mexico 87504

RECEIVED
FEB 10 1987
OIL CONSERVATION DIVISION
Case 9098

Re: Application of Union Texas Petroleum for an Exception to Order R-8170 to Permit the Application of a Full Deliverability Factor in the Formula Utilized in Determining the Allowable for Certain Units, in the Basin Dakota Pool and Mesaverde Pool, Rio Arriba and San Juan Counties, New Mexico

Dear Mr. LeMay:

Please set the enclosed application for hearing on the next available Examiner's Docket now set for March 4, 1987.

Very truly yours,

W. Thomas Kellahin

WTK:mh
Enclosure
cc: A. R. Kendrick
Box 516
Aztec, New Mexico 87410

A. R. KENDRICK

BOX 516 • AZTEC, NEW MEXICO 87410 • (505) 334-2555

March 9, 1987

Mr. Michael Stogner
Oil Conservation Division
Box 2088
Santa Fe, New Mexico 87504-2088

MAR 11 1987

Re: Case No 9098
Application of Union Texas Petroleum Corporation

Dear Mr. Stogner:

The enclosed copies of plats show the NSP order numbers near the center of the stippled proration unit for each well on each plat.

The non-standard units had been approved for the Jicarilla L #11 and Jicarilla L #12 wells, but I did not find the information until after the hearing.

Thank you for bearing with me.

If there are further questions, please contact me.

Yours very truly,

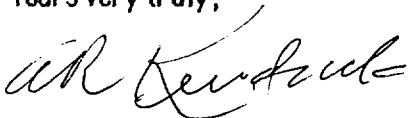

A. R. Kendrick

Enclosure

xc: Union Texas Petroleum Corporation
375 U.S. 64
Farmington, New Mexico 87401

Mr. Thomas Kellahin
Box 2265
Santa Fe, New Mexico 87504-2265

UNION TEXAS PETROLEUM CORP. JICARILLA L #5

R 5 W

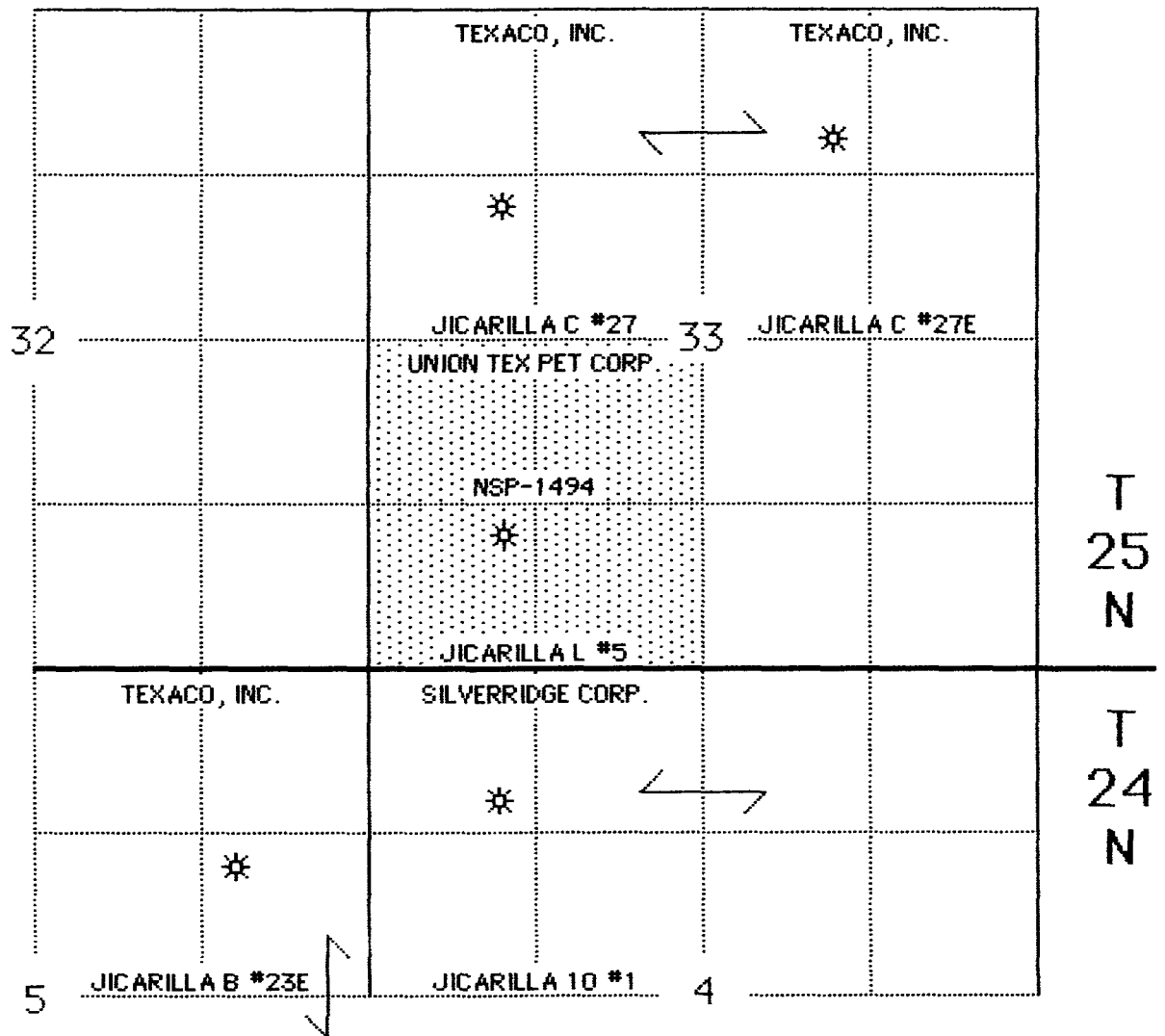

UNION TEXAS PETROLEUM CORP.
 JICARILLA L # 11
 JICARILLA L # 12

R 5 W

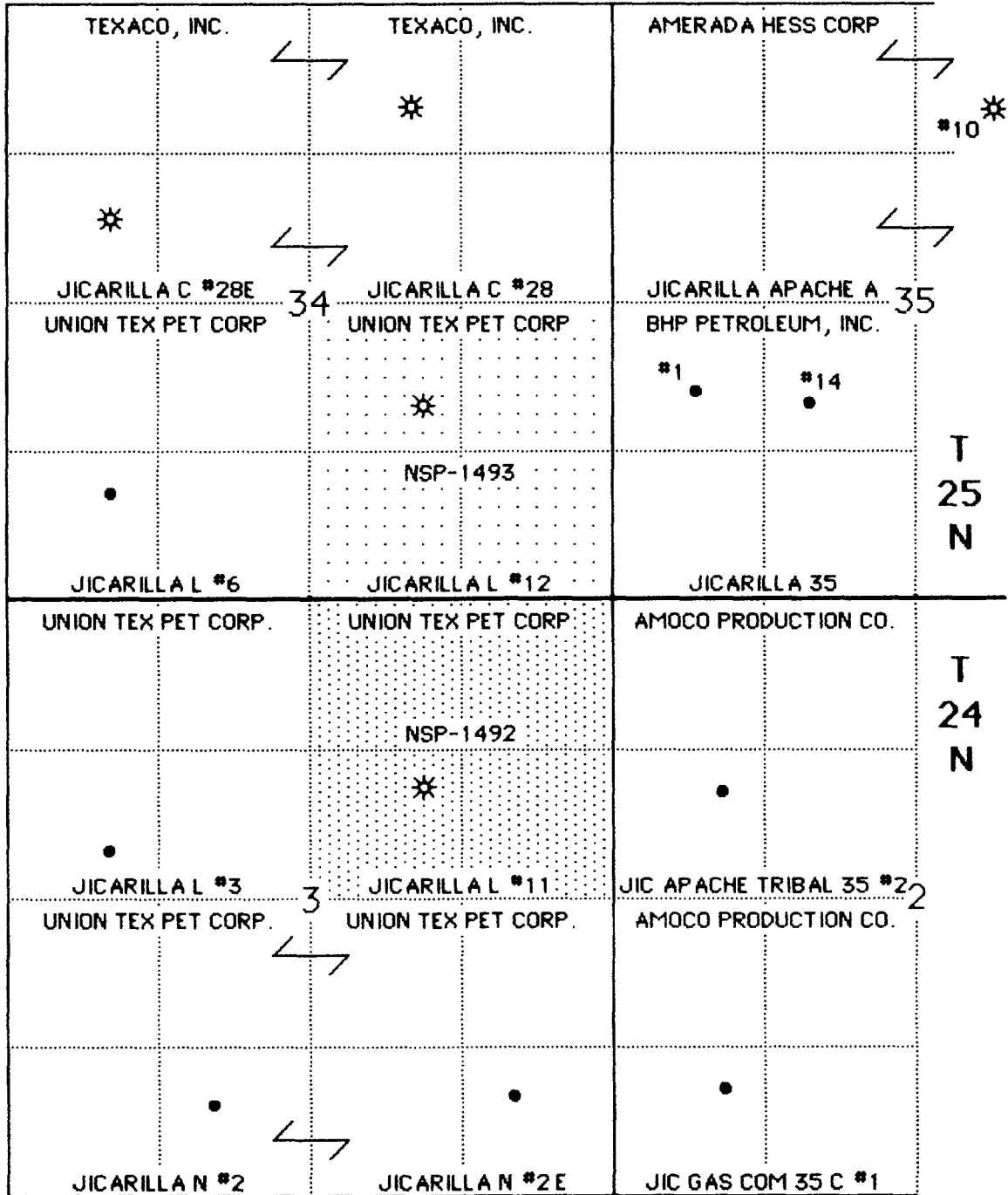

UNITED STATES
DEPARTMENT OF THE INTERIOR
BUREAU OF LAND MANAGEMENT

SUBMIT IN TRIPLICATE*
(Other instructions on reverse side)

Form approved
Budget Bureau No. 1004-0115
Expires August 31, 1985

SUNDRY NOTICES AND REPORTS ON WELLS

(Do not use this form for proposals to drill or to deepen or plug back to a different reservoir. Use "APPLICATION FOR PERMIT" for such proposals.)

1. <input type="checkbox"/> OIL WELL <input checked="" type="checkbox"/> GAS WELL <input type="checkbox"/> OTHER		5. LEASE DESIGNATION AND SERIAL NO Jicarilla Contract 10
2. NAME OF OPERATOR Union Texas Petroleum		6. IF INDIAN, ALLOTTEE OR TRIBE NAME Jicarilla Apache
3. ADDRESS OF OPERATOR 375 U.S. Highway 64, Farmington, New Mexico 87401		7. UNIT AGREEMENT NAME N/A
4. LOCATION OF WELL (Report location clearly and in accordance with any State requirements.* See also space 17 below.) At surface 1580' FSL & 1600' FEL		8. FARM OR LEASE NAME Jicarilla L
14. PERMIT NO.	15. ELEVATIONS (Show whether OP, RT, GR, etc.) 6765 GL	9. WELL NO. 12
16. Check Appropriate Box To Indicate Nature of Notice, Report, or Other Data		10. FIELD AND POOL, OR WILDCAT Otero Chacra, Basin Dakota
17. DESCRIBE PROPOSED OR COMPLETED OPERATIONS (Clearly state all pertinent details, and give pertinent dates, including estimated date of starting any proposed work. If well is directionally drilled, give subsurface locations and measured and true vertical depths for all markers and zones pertinent to this work).*		11. SEC., T., S., M., OR BLE. AND SURVEY OR AREA Section 34-T25N-R5W
		12. COUNTY OR PARISH 13. STATE Rio Arriba NM

NOTICE OF INTENTION TO:

TEST WATER SHUT-OFF <input type="checkbox"/>	PULL OR ALTER CASING <input type="checkbox"/>
FRACTURE TREAT <input type="checkbox"/>	MULTIPLE COMPLETE <input type="checkbox"/>
SHOOT OR ACIDIZE <input type="checkbox"/>	ABANDON* <input type="checkbox"/>
REPAIR WELL <input type="checkbox"/>	CHANGE PLANS <input type="checkbox"/>
(Other) <input type="checkbox"/>	

SUBSEQUENT REPORT OF:

WATER SHUT-OFF <input type="checkbox"/>	REPAIRING WELL <input type="checkbox"/>
FRACTURE TREATMENT <input type="checkbox"/>	ALTERING CASING <input type="checkbox"/>
SHOOTING OR ACIDIZING <input type="checkbox"/>	ABANDONMENT* <input type="checkbox"/>
(Other) Name change <input checked="" type="checkbox"/>	

(NOTE: Report results of multiple completion on Well Completion or Recompletion Report and Log form.)

The original proration unit for this well comprised the S/2 of Section 34, T25N-R5W. The original well (L-6) is located in SW/4, SW/4; however the entire SW/4 was removed from the Basin Dakota Pool and placed in the West Lindrith Gallup Dakota Pool (Order R-8106). The SE/4 of the original proration unit still remains in the Basin Dakota pool. Inasmuch as the infill well (L-6E) is no longer in the same pool as the initial well, we are required by N.M.O.C.D. regulations to rename the L-6E the L-12.

I hereby certify that the foregoing is true and correct

SIGNED Robert C. Frank TITLE Permit Coordinator DATE 01/08/1987

(This space for Federal or State office use)

APPROVED BY _____ TITLE _____ DATE _____

CONDITIONS OF APPROVAL, IF ANY:

*See Instructions on Reverse Side

ACCEPTED FOR RECORD
JAN 13 1987
FARMINGTON RESOURCE AREA
BY 8-913

All distances must be from the outer boundaries of the Section.

Operator UNION TEXAS PETROLEUM		Lease Jicarilla "L"		Well No. XXX 12
Unit Letter J	Section 34	Township 25N	Range 5W	County Rio Arriba
Actual Footage Location of Well: 1580 feet from the South line and 1600 feet from the East line				
Ground Level Elev. 6765	Producing Formation Dakota / Chacra	Pool Basin / Otero	Dedicated Acreage: 160 Acres	

- Outline the acreage dedicated to the subject well by colored pencil or hachure marks on the plat below.
- If more than one lease is dedicated to the well, outline each and identify the ownership thereof (both as to working interest and royalty).
- If more than one lease of different ownership is dedicated to the well, have the interests of all owners been consolidated by communitization, unitization, force-pooling, etc?

Yes No If answer is "yes," type of consolidation _____

If answer is "no," list the owners and tract descriptions which have actually been consolidated. (Use reverse side of this form if necessary.) _____

No allowable will be assigned to the well until all interests have been consolidated (by communitization, unitization, forced-pooling, or otherwise) or until a non-standard unit, eliminating such interests, has been approved by the Division

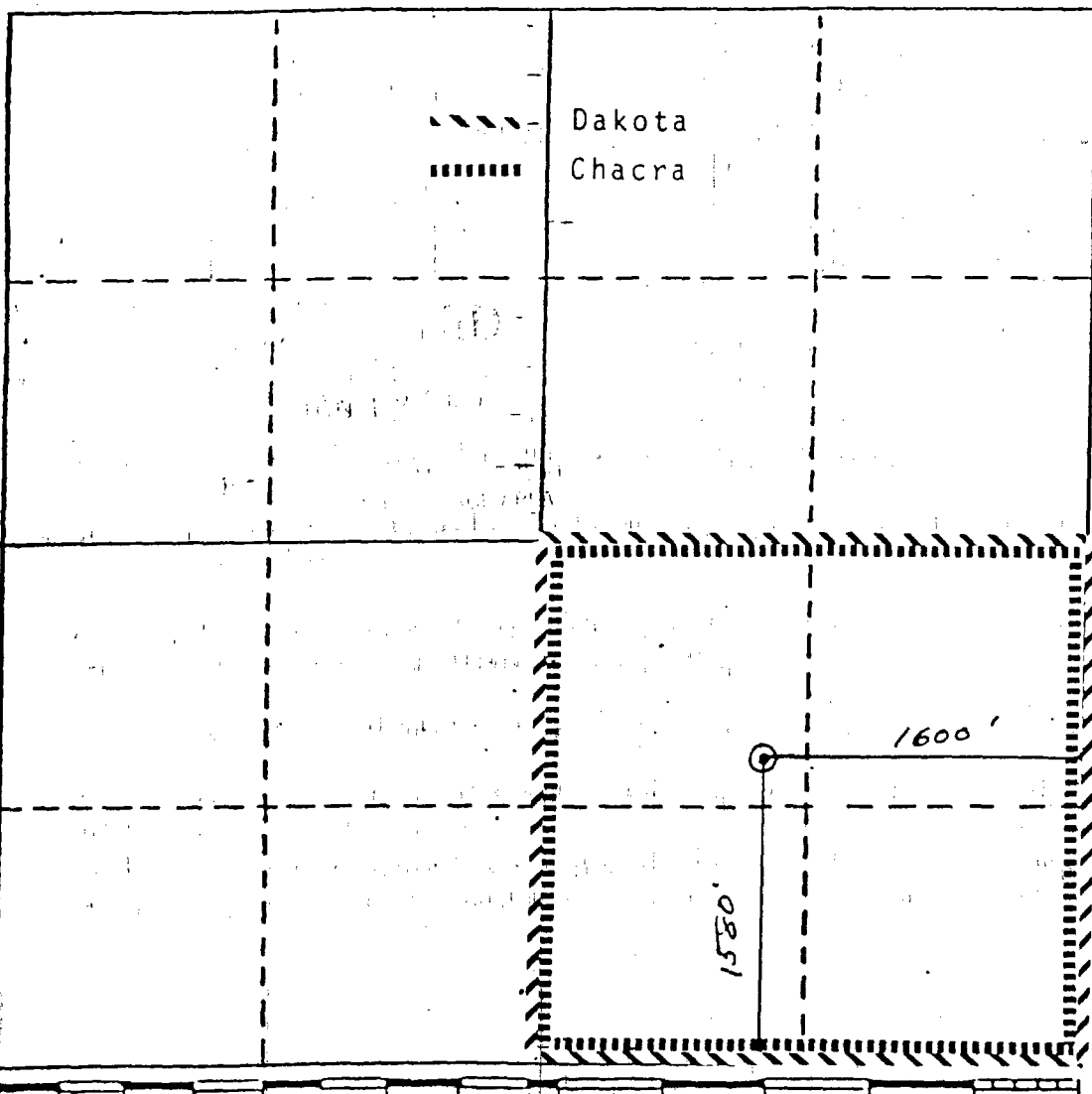

CERTIFICATION

I hereby certify that the information contained herein is true and complete to the best of my knowledge and belief.

Robert C. Frank

Name **Robert C. Frank**

Position
Permit Coordinator

Company
Union Texas Petroleum

Date
July 28, 1986

I hereby certify that the well location shown on this plat was plotted from field notes of actual surveys made by me or under my supervision, and that the same is true and correct to the best of my knowledge and belief.

Original on file

Date Surveyed _____

Registered Professional Engineer and/or Land Surveyor _____

Certificate No. _____

STATE OF NEW MEXICO

ENERGY AND MINERALS DEPARTMENT

OIL CONSERVATION DIVISION



GARREY CARRUTHERS
GOVERNOR

May 3, 1988

POST OFFICE BOX 2088
STATE LAND OFFICE BUILDING
SANTA FE, NEW MEXICO 87501
(505) 827-5800

Mr. Thomas Kellahin
Kellahin, Kellahin & Aubrey
Attorneys at Law
Post Office Box 2265
Santa Fe, New Mexico

Re: CASE NO. 9093
ORDER NO. R-8422

Applicant:

Union Texas Petroleum Corporation

Dear Sir:

Enclosed herewith are two copies of the above-referenced
Division order recently entered in the subject case.

Sincerely,

Florene Davidson

FLORENE DAVIDSON
OC Staff Specialist

Copy of order also sent to:

Hobbs OCD x
Artesia OCD x
Aztec OCD x

Other _____
