

A complex grid of handwritten notes, names, and numbers, likely representing a schedule or a detailed ledger. The grid is organized into columns and rows, with various entries including names like 'Chevron', 'Exxon', 'Yates Petroleum', and 'Phillips 66', along with dates and times. Some cells contain large numbers like '22', '23', '24', '25', '26', '27', '28', '29', '30', '31', '32', '33', '34', '35', '36', '37', '38', '39', '40'. There are also some circled numbers and handwritten annotations throughout the grid.

WELLS IN THE AREA OF REVIEW OF THE NEW MEXICO "30" STATE NO. 1

Operator	Location	Type Completion	Date	PB/TD	Casing Program and Cement	Perforation
Sage Energy Company John Etcheverry	Sec. 29, T-14, R-34-E	Oil	8-24-71	10,535'	12 3/4" at 390' with 400 sx 8 5/8" at 4400' with 375 sx 4 1/2" at 10,535' with 375 sx	10,400 to 10,418 10,440 to 10,446 10,465 to 10,475
Sage Energy Company New Mexico State No. 1	Sec. 31, T-14, R-34-E	Oil	2-15-71	10,500'	12 3/4" at 413' with 400 sx 8 5/8" at 4260' with 250 sx 5 1/2" at 10,499 with 760 sx	10,401 to 10,410
Newborn Oil Company Shell State No. 1	Sec. 30, T-14-R-34-E	Oil	2-2-72	10,510'	12 3/4" at 395' with 415 sx 8 5/8" at 4420' with 375 sx 4 1/2" at 10,510' with 375 sx	10,384 to 10403
Newborn Oil Company Shell State No. 1A	Sec. 30, T-14, R-34-E	Oil	7-19-72	10,530'	13 3/8" at 410' with 400 sx 8 5/8" at 4372' with 375 sx 4 1/2" at 10,530 with 375 sx	10,390 to 10,456
Texas Crude & Sinclair Oil Merchis-State No. 1	Sec. 30, T-14, T-34-E	D&A	5-16-72	10,704'	13 3/8" at 285' with 275 sx. 8 5/8" at 4491' with 350 sx.	
Sage Energy Company New Mexico State No. 3	Sec. 30, T-14, R-34-E	Oil	5-30-83	10,560'	12 3/4" at 395' with 415 sx 8 2/4" at 4350' with 1800 sx and 300 sx. 4 1/2" at 10,575' with 550 sx.	10,397 to 10,406
Mark Production C. Southland State No. 1	Sec. 32, T-14-R-34-E	Oil	1-2-72	10,505'	12 3/4" at 398' with 415 sx 8 5/8" 4400' with 375 sx 4 1/2" 10,505' with 375 sx	10,392 to 10,403
Newborn Oil Company Etcheverry No. 1A	Sec. 29, T-14-R-34-E	D&A	11-28-71	10,515'	13 3/8" at 390' with 400 sx 8 5/8" at 4418' with 375 sx	

BEFORE EXAMINATION BY THE COMMISSION
 OIL OPERATOR'S SIGNATURE
 DATE NOV. 9 1982

OPERATOR	Location	Type	Completion	Date	PBTD	Casing Program and Cement	Perforation
Newborn Oil Company	Sec. 29, T-14-S, R-34-E		Oil		10,500	12 3/4" at 431' with 425 sx 8 5/8" at 4400' with 375 sx 4 1/2" at 10,500' with 375 sx	10,402 to 10,470
Sage Energy Company New Mexico "30" State	Sec. 30, T-14, R-34-E		Oil		10,518'	13 3/8" at 43' with 450 sx 8 5/8" at 4482' with 2000 sx 5 1/2" at 10,561 with 380 sx	10,392 to 10,407

WELLS WITHIN THE AREA OF REVIEW OF THE

NEW MEXICO "30" STATE

✓ Mark Production Company Southland State No. 1	Sec. 32, T-14-S, R-34-E	P&A
✓ Mewborn Oil Company Etcheverry No. 1-A	Sec. 29, T-14-S, R-34-E	P&A
✓ Mewborn Oil Company Etcheverry No. 2-A	Sec. 29, T-14-S, R-34-E	P&A
✓ Mewborn Oil Company Shell State No. 1	Sec. 30, T-14-S, R-34-E	P&A
✓ Mewborn Oil Company Shell State No. 1A	Sec. 30, T-14-S, R-34-E	P&A
✓ Texas Crude and Sinclair Merchris-State No. 1	Sec. 30, T-14-S, R-34-E	P&A
Sage Energy Company John Etcheverry No. 1	Sec. 29, T-14-W, R-34-E	Oil
Sage Energy Company New Mexico State No. 1	Sec. 31, T-14-W, R-34-E	T&A
Sage Energy Company New Mexico State No. 3	Sec. 31, T-14-W, R-34-E	Oil
Sage Energy Company New Mexico "30" State No. 1	Sec. 30, T-14-W, R-34-E	Oil

PLUGGED WELLS WITHIN THE AREA OF REVIEW

NEW MEXIC "30" STATE

Mark Production Company
Southland State No. 1 Sec. 32, T-14-S, R-34-E

P&A June 18, 1976
Plug No. 1 20 sx in 4½" casing 10,330
to 10,505'
Plug No. 2 40 sx in and out 4½" stub
from 7480 to 7580.
Plug No. 3 50 sx at 5300 to 5400'
Plug No. 4 50 sx 8 5/8" shoe 4350'
to 4450'
Plug No. 5 65 sx in 8 5/8" stub
1535' to 1635'
80 sx in 12 3/4" shoe 350' to 450'
10 sx at surface 0' to 10'

Establish dry hole marker 9.5# mud
between plugs.
Recovered 7527' of 4½" csg. and
1585' of 8 5/8" csg.

Mark Production Company and
Newborn Oil Company
John Etcheverry, Jr. "A" No. 1
Sec. 29, T-14-S, R-34-E

Plug and abandon January 1, 1972.
Plug No. 1 25 sx at 1150' 8 5/8" stub.
Plug No. 2 25 sx at 390' 13 3/8" shoe.
Plug No. 3 10 sx at surface

Mewborn Oil Company
John Etcheverry, Jr. "A" No. 2
Sec. 29, T-14-S, R-34-E

P&A August 27, 1985
Set CIBP at 10,355' with 4 sx cement on
top.
20 sx at 7990'
20 sx at 5922'
Cut off 4½" csg at 5580'
Spot 35 sx on 4½" plug at 5580'
35 sx at 4450'
Spot 35 sx at 1945'
Welding on 8 5/8" csg. Cut off at 487'.
Spot 90 sx cement plug. Tagged plug at
374' with wireline and set 10 sx at
surface and erected dry hole market.

Mewborne Oil Company Sec. 30, T-14-S, R-34-E
Shell State No. 1

P&A 12-21-84
Set CIBP at 10,340' with 4 sx cement.
at 5922' set 20 sx plug.
Cut off csg at 4475' 20 sx plug on top
50 sx plug at 4525', Spot 30 sx
at 1945'. Spot 50 sx on top of 8 5/8"
plug.
Tagged 8 5/8" stub plug at 690'
75 sx cement plug at 445'
Tag cement at 340', cut off wellhead an
set 10 sx surface plug and marker.

BEFORE EXAMINER: CATANIACH
OIL CONSERVATION DIVISION
EXHIBIT NO. <u>3</u>
<u>9182</u>

PLUGGED WELLS WITHIN THE AREA OF
REVIEW NEW MEXICO "30" STATE

Mewborne Oil Company
Shell "A" State No. 1
(DRY HOLE)

Sec. 30, T-14-S, R-34-E Plugged and Abandon Nov. 3, 1978
CIBP at 10,390' with 35 sx on top.
25 sx at 5846'
35 sx at 5846'
35 sx at 4443'
35 sx at 4420'
30 sx at 1950'
60 sx at 1050'
75 sx at 460'
10 sx at top with marker.

4½" csg shot off at 5700' and 5700'
pulled out of hole.
8 5/8" casing shot off at 995' and 995'
were pulled.

Texas Crude Oil - Sinclair Oil and Gas Co.
Machris-State No. 1
(DRY HOLE)

Sec. 30, T-14-S, R-30-S 25 sx at 10,705'
25 sx at 10,400'
25 sx at 9,600'
25 sx at 7,200'
25 sx at 5,900'
25 sx at 4,425'
3356' of 8 5/8" casing was pulled and
plug set as follows:
25 sx at 3,350'
25 sx at 1,100'
25 sx at 298'
10 sx at top of surface.
Steel marker placed in top.

PLUGGED WELL DATA

Operator Name Mewborne Oil Company Lease Name John Etchevery, Jr. "A" Well No. 2
 Footage Location 2080 FNL and 560 FSL Section 29 Township 14-S Range R-34-E
 County Lea Date P&A August, 1985

Schematic

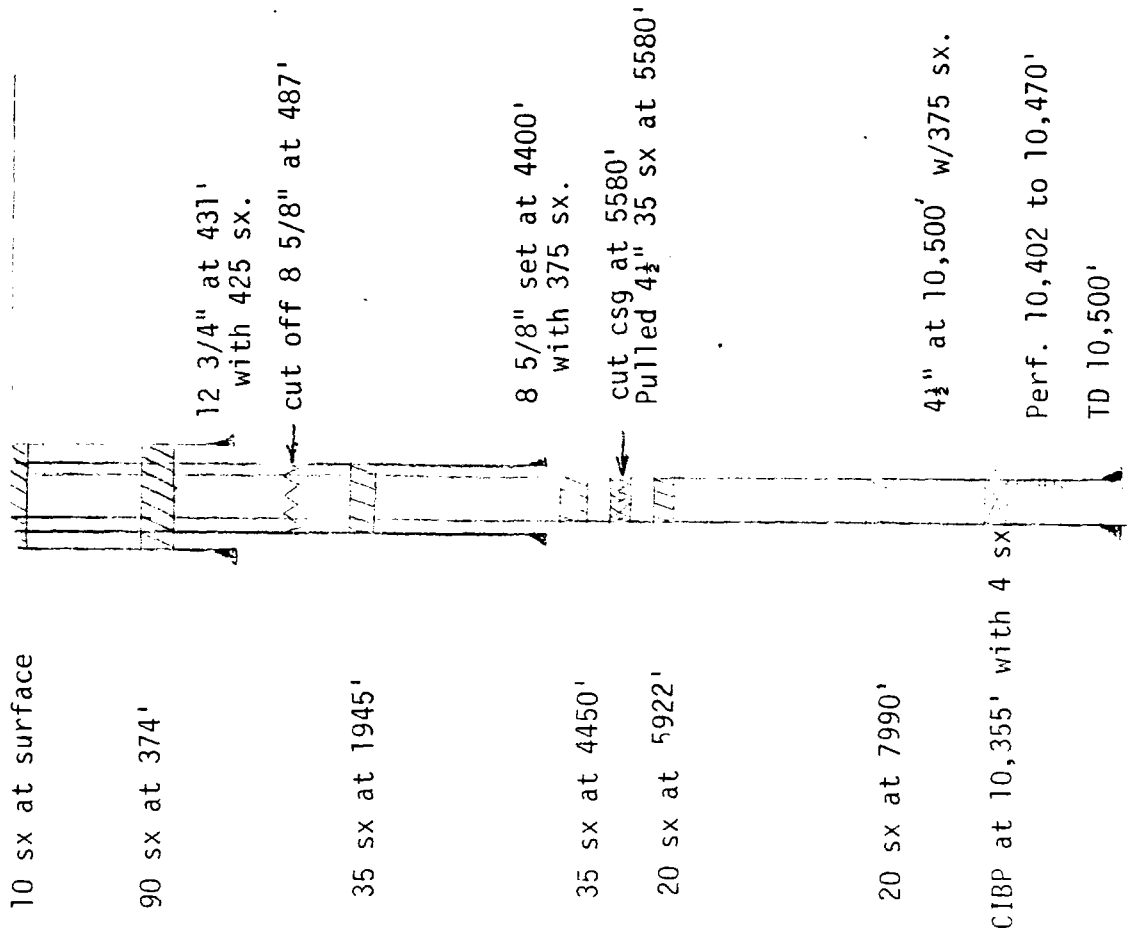

Tabular Data

Surface Casing: Size 12 3/4" set at 431'
 Cemented with 425' sx. TOC surface
 Feet determined by visual. Hole Size 17 1/2"
 Intermediate Casing:
 Size 8 5/8" set at 4400'
 Cemented with 375' sx. TOC 3000'
 Feet determined by calculations. Hole size 11"
 Long String:
 Size 4 1/2" set at 10,500'
 Cemented with 375' sx. TOC 8288'
 Feet determined by calculations. Hole size 7 7/8"
 Total Depth 10,500'
 Producing Intervals; perforated or open hole
10,402' feet to 10,470' feet.

NEW MEXICO OIL CONSERVATION COMMISSION

DISTRIBUTION		
DATE		
FILE		
S.G.S.		
LAND OFFICE		
OPERATOR		

5a. Indicate Type of Lease
State Fee

5. State Oil & Gas Lease No.

SUNDRY NOTICES AND REPORTS ON WELLS
(DO NOT USE THIS FORM FOR PROPOSALS TO DRILL OR TO DEEPEN OR PLUG BACK TO A DIFFERENT RESERVOIR. USE "APPLICATION FOR PERMIT" (FORM C-101) FOR SUCH PROPOSALS.)

OIL WELL <input checked="" type="checkbox"/> GAS WELL <input type="checkbox"/> OTHER-		7. Unit Agreement Name
Name of Operator Mewbourne Oil Company		8. Farm or Lease Name Etcheverry "A"
Address of Operator P. O. Box 7698, Tyler, Texas 75711		9. Well No. 2
Location of Well UNIT LETTER <u>E</u> <u>2080</u> FEET FROM THE <u>North</u> LINE AND <u>560</u> FEET FROM THE <u>West</u> LINE, SECTION <u>29</u> TOWNSHIP <u>14S</u> RANGE <u>34E</u> N.M.P.M.		10. Field and Pool, or Wildcat Tres Papalotes Penn, Wet
15. Elevation (Show whether DF, RT, GR, etc.) 4139' GL		12. County Lea

Check Appropriate Box To Indicate Nature of Notice, Report or Other Data

NOTICE OF INTENTION TO:

PERFORM REMEDIAL WORK

TEMPORARILY ABANDON

PULL OR ALTER CASING

OTHER _____

PLUG AND ABANDON

CHANGE PLANS

SUBSEQUENT REPORT OF:

REMEDIAL WORK

COMMENCE DRILLING OPNS.

CASING TEST AND CEMENT JOB

OTHER _____

ALTERING CASING

PLUG AND ABANDONMENT

17. Describe Proposed or Completed Operations (Clearly state all pertinent details, and give pertinent dates, including estimated date of starting any proposed work) SEE RULE 1103.

- 5/24/85 - Set CI3P at 10,355'. Dumped 4 sacks of cement with bailer.
- 8/20/85 - Circulated hole with 9.5#, 35 viscosity plug mud. Spotted 20 sack plug at 7990', 20 sack plug at 5922'.
- 8/21/85 - Took stretch on 4-1/2" casing. Free pointed at 5600'. Cut off casing at 5580'.
- 8/22/85 - Finished pulling 4-1/2" casing. Spotted 35 sack plug at 5580'.
- 8/23/85 - Tagged plug at 5535'. Spotted 35 sacks at 4450'. Tagged plug at 4280' with wireline. Spotted 35 sacks at 1945'.
- 8/24/85 - Welded on 8-5/8" casing. RU casing jacks. Free pointed and cut off at 487'.
- 8/27/85 - Spotted 90 sack cement plug. Pulled out of hole. WOC 4 hours. Rigged up wireline. Tagged plug at 374'. Rigged down wireline and set 10 sacks surface plug and erected dry hole marker.

I hereby certify that the information above is true and complete to the best of my knowledge and belief.

SIGNED Raymond Thompson TITLE Exploration Secretary DATE August 28, 1985

APPROVED BY Jack Griffin TITLE OIL & GAS INSPECTOR DATE OCT 22 1986

CONDITIONS OF APPROVAL, IF ANY:

PLUGGED WELL DATA

Operator Name Mewbourne Oil Company Lease Name Shell State Well No. 1
 Footage Location 560' FSL and 560' FEL Section 30 Township T-14-S Range R-34-E
 County Lea County, New Mexico Date P&A 12-21-84

SCHEMATIC

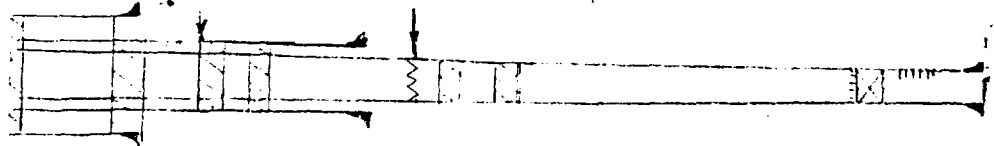

10 sx at surface
 75 sx at 340' - 445'
 75 sx at 690' - 805'
 30 sx at 1945'
 50 sx in top of 4 1/2" stub.
 50 sx at 4525'
 20 sx at 5922'

CIBP at 10,340' w/4 sx on top.

12 3/4" at 395' w/415 sx

Recovered 690' of 8 5/8" csg.

8 5/8" at 4420' w/375 sx

Rec. 4475' 4 1/2" csg.

TABULAR DATA

Surface Casing: Size 12 3/4" set at 395'
 Cemented with 415 sx. TOC Surface
 Feet determined by Visual. Hole Size 17 1/2"
Intermediate Casing:
 Size 8 5/8" set at 4420'
 Cemented with 375 sx. TOC 2430'
 Feet determined by calculations. Hole size 11"
Long String:
 Size 4 1/2" set at 10,510
 Cemented with 375 sx. TOC 8288
 Feet determined by calculations. Hole size 7 7/8"
 Total Depth 10,510'
 Producing Intervals; perforated or open hole
10,384 feet to 10,403 feet.

Perf. 10,384' to 10,403'
 4 1/2" set at 10,510 w/375 sx
 TD 10,510'

NO. OF COPIES RECEIVED	
DISTRIBUTION	
SANTA FE	
FILE	
U.S.G.S.	
LAND OFFICE	
OPERATOR	

NEW MEXICO OIL CONSERVATION COMMISSION

Form C-103
Supersedes Old
C-102 and C-103
Effective 1-1-65

5a. Indicate Type of Lease
State Fee
5. State Oil & Gas Lease No.

SUNDRY NOTICES AND REPORTS ON WELLS
(DO NOT USE THIS FORM FOR PROPOSALS TO DRILL OR TO DEEPEN OR PLUG BACK TO A DIFFERENT RESERVOIR. USE "APPLICATION FOR PERMIT -" (FORM C-101) FOR SUCH PROPOSALS.)

OIL WELL GAS WELL OTHER-

Name of Operator
Mewbourne Oil Company

7. Unit Agreement Name

8. Farm or Lease Name
Shell-State

Address of Operator
P. O. Box 7698, Tyler, Texas 75711

9. Well No.
1

Location of Well
UNIT LETTER P 560 FEET FROM THE South LINE AND 560 FEET FROM
THE East LINE, SECTION 30 TOWNSHIP 14-S RANGE 34-E NMPM.

10. Field and Pool, or Wildcat
Tres Papalotes
Permo-Penn

15. Elevation (Show whether DF, RT, GR, etc.)
4143' GL

12. County
Lea

Check Appropriate Box To Indicate Nature of Notice, Report or Other Data

NOTICE OF INTENTION TO:		SUBSEQUENT REPORT OF:	
PERFORM REMEDIAL WORK <input type="checkbox"/>	PLUG AND ABANDON <input type="checkbox"/>	REMEDIAL WORK <input type="checkbox"/>	ALTERING CASING <input type="checkbox"/>
TEMPORARILY ABANDON <input type="checkbox"/>	CHANGE PLANS <input type="checkbox"/>	COMMENCE DRILLING OPNS. <input type="checkbox"/>	PLUG AND ABANDONMENT <input checked="" type="checkbox"/>
PULL OR ALTER CASING <input type="checkbox"/>	OTHER <input type="checkbox"/>	CASING TEST AND CEMENT JOBS <input type="checkbox"/>	OTHER <input type="checkbox"/>

17. Describe Proposed or Completed Operations (Clearly state all pertinent details, and give pertinent dates, including estimated date of starting any proposed work) SEE RULE 1103.

- 12-13-84 Set CIBP at 10,340' and capped with 4 sxs cement.
- 12-14-84 Circulated hole with mud. Pulled out of hole and set 20 sx cement plug. Pulled out to 5922' and set 20 sx cement plug. Cut off csg at 4475'.
- 12-15-84 Set 50 sx cement at 4525'.
- 12-19-84 Spotted 30 sx cement plug at 1945'. Went in hole with tubing to 805'. Spotted 50 sx plug in top of 8-5/8" stub.
- 12-20-84 Tagged 8-5/8" stub plug at 690'. Spotted 75 sx cement plug at 445'.
- 12-21-84 Tagged cement plug at 340'. Cut off wellhead and set 10' sx surface plug and erected dry hole marker.

I hereby certify that the information above is true and complete to the best of my knowledge and belief.

SIGNED [Signature] TITLE Gas Control Supervisor DATE January 14, 1985

APPROVED BY [Signature] TITLE OIL & GAS INSPECTOR DATE 4-1-85

CONDITIONS OF APPROVAL, IF ANY:

PLUGGED WELL DATA

Operator Name Mewborne Oil Company Lease Name Shell "A" State Well No. 1
 Footage Location 2080' FNL and 560' FEL Section 30 Township 14S Range 34E
 County Lea Date P&A 11-30-78

SCHEMATIC

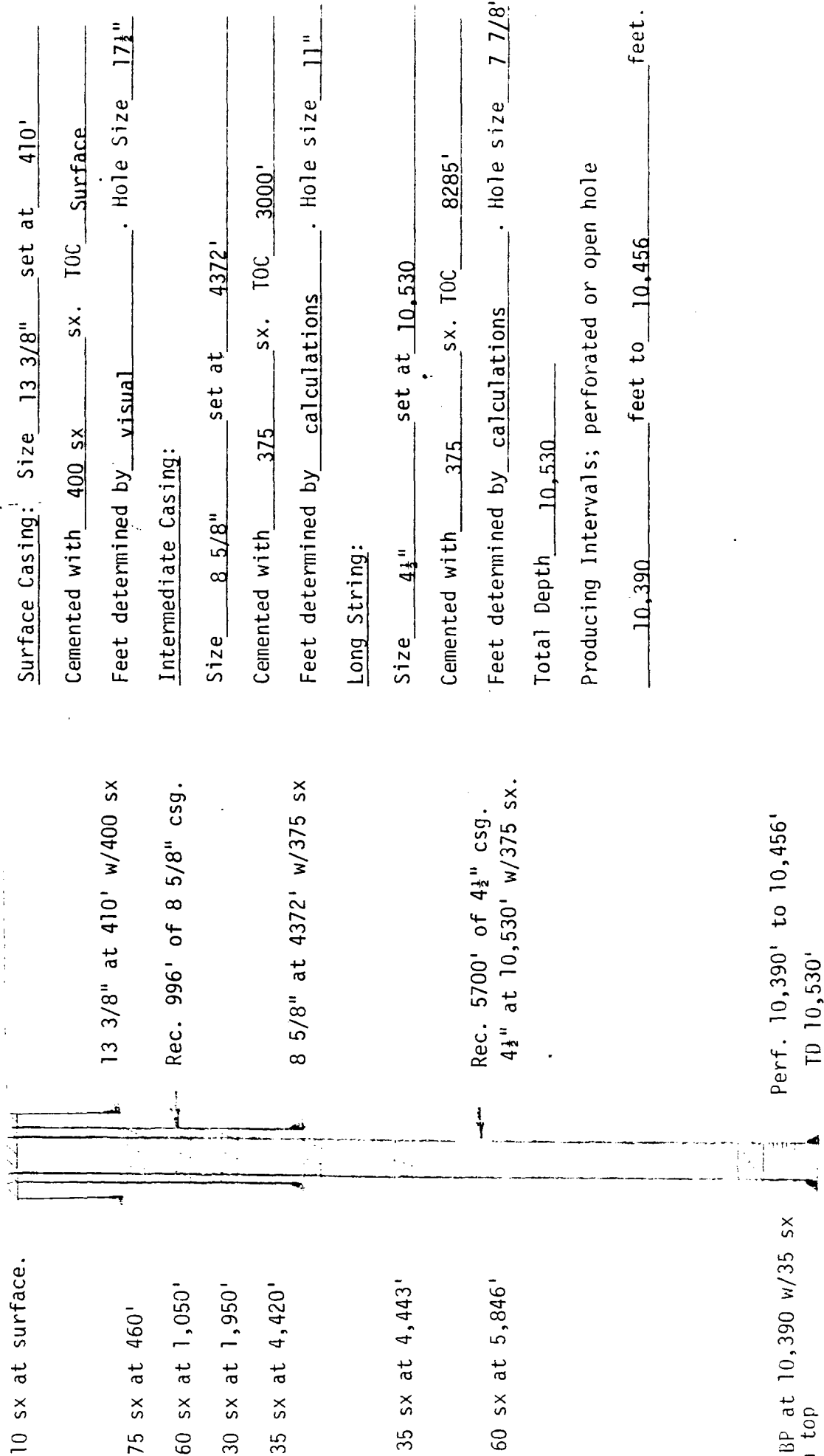

TABULAR DATA

Surface Casing: Size 13 3/8" set at 410'
 Cemented with 400 sx sx. TOC Surface
 Feet determined by visual. Hole Size 17 1/2"
 Intermediate Casing:
 Size 8 5/8" set at 4372'
 Cemented with 375 sx. TOC 3000'
 Feet determined by calculations. Hole size 11"
 Long String:
 Size 4 1/2" set at 10,530'
 Cemented with 375 sx. TOC 8285'
 Feet determined by calculations. Hole size 7 7/8"
 Total Depth 10,530'
 Producing Intervals; perforated or open hole
10,390 feet to 10,456 feet.

CIBP at 10,390 w/35 sx on top
 Perf. 10,390' to 10,456'
 TD 10,530'

NO. OF COPIES RECEIVED		
DISTRIBUTION		
QUANTITY		
FILE		
U.S.G.S.		
LAND OFFICE		
OPERATOR		

NEW MEXICO OIL CONSERVATION COMMISSION

Form C-101
 Supersedes Old
 C-102 and C-103
 Effective 1-1-65

5a. Indicate Type of Lease
 State Fee

5. State Oil & Gas Lease No.
 NM 3352

7. Unit Agreement Name

8. Farm or Lease Name
 Shell "A" State

9. Well No.
 1

10. Field and Pool, or Wildcat
 Tres Papalotes-West

12. County
 Lea

SUNDRY NOTICES AND REPORTS ON WELLS
(DO NOT USE THIS FORM FOR PROPOSALS TO DRILL OR TO DEEPEN OR PLUG BACK TO A DIFFERENT RESERVOIR. USE "APPLICATION FOR PERMIT TO DRILL" (FORM C-101) FOR SUCH PROPOSALS.)

OIL WELL GAS WELL OTHER

1. Name of Operator
 MEWBOURNE OIL COMPANY

2. Address of Operator
 P. O. Box 7698, Tyler, TX 75711

3. Location of Well
 UNIT LETTER H 2080 FEET FROM THE North LINE AND 560 FEET FROM
 THE East LINE, SECTION 30 TOWNSHIP 14S RANGE 34E NMPM.

15. Elevation (Show whether DF, RT, GR, etc.)
 4143 GL

Check Appropriate Box To Indicate Nature of Notice, Report or Other Data

NOTICE OF INTENTION TO:

SUBSEQUENT REPORT OF:

PERFORM REMEDIAL WORK <input type="checkbox"/>	PLUG AND ABANDON <input type="checkbox"/>	REMEDIAL WORK <input type="checkbox"/>	ALTERING CASING <input type="checkbox"/>
TEMPORARILY ABANDON <input type="checkbox"/>	CHANGE PLANS <input type="checkbox"/>	COMMENCE DRILLING OPNS. <input type="checkbox"/>	PLUG AND ABANDONMENT <input checked="" type="checkbox"/>
PULL OR ALTER CASING <input type="checkbox"/>	OTHER <input type="checkbox"/>	CASING TEST AND CEMENT JOB <input type="checkbox"/>	
		OTHER _____ <input type="checkbox"/>	

Describe Proposed or Completed Operations (Clearly state all pertinent details, and give pertinent dates, including estimated date of starting any proposed work) SEE RULE 1103.

On November 3, 1978 plugged well as follows:

- Set Cast Iron Plug at top perforations - 10,390', with 35 sax cement on top.
- 25 sx plug at 5846'
- 35 sx plug at 5846'
- 35 sx plug at 4443'
- 35 sx plug at 4420'
- 30 sx plug at 1950'
- 60 sx plug at 1050'
- 75 sx plug at 460'
- 10 sx at top with marker.

4-1/2" casing was shot off at 5700' and the 5700' were pulled.
 8-5/8" casing was shot off at 995' and 995' were pulled.

I hereby certify that the information above is true and complete to the best of my knowledge and belief.

SIGNED Maryann Ltz TITLE Production Clerk DATE 11/30/78

APPROVED BY Eddie Seay TITLE OIL & GAS INSPECTOR DATE MAR 11 1980

CONDITIONS OF APPROVAL, IF ANY:

PLUGGED WELL DATA

Operator Name Mark Production Company Lease Name Southland State Well No. 1
 Footage Location 560 FNL and 560 EML Section 32 Township 14S Range 34E
 County Lea Date P&A Nov. 1976

SCHEMATIC

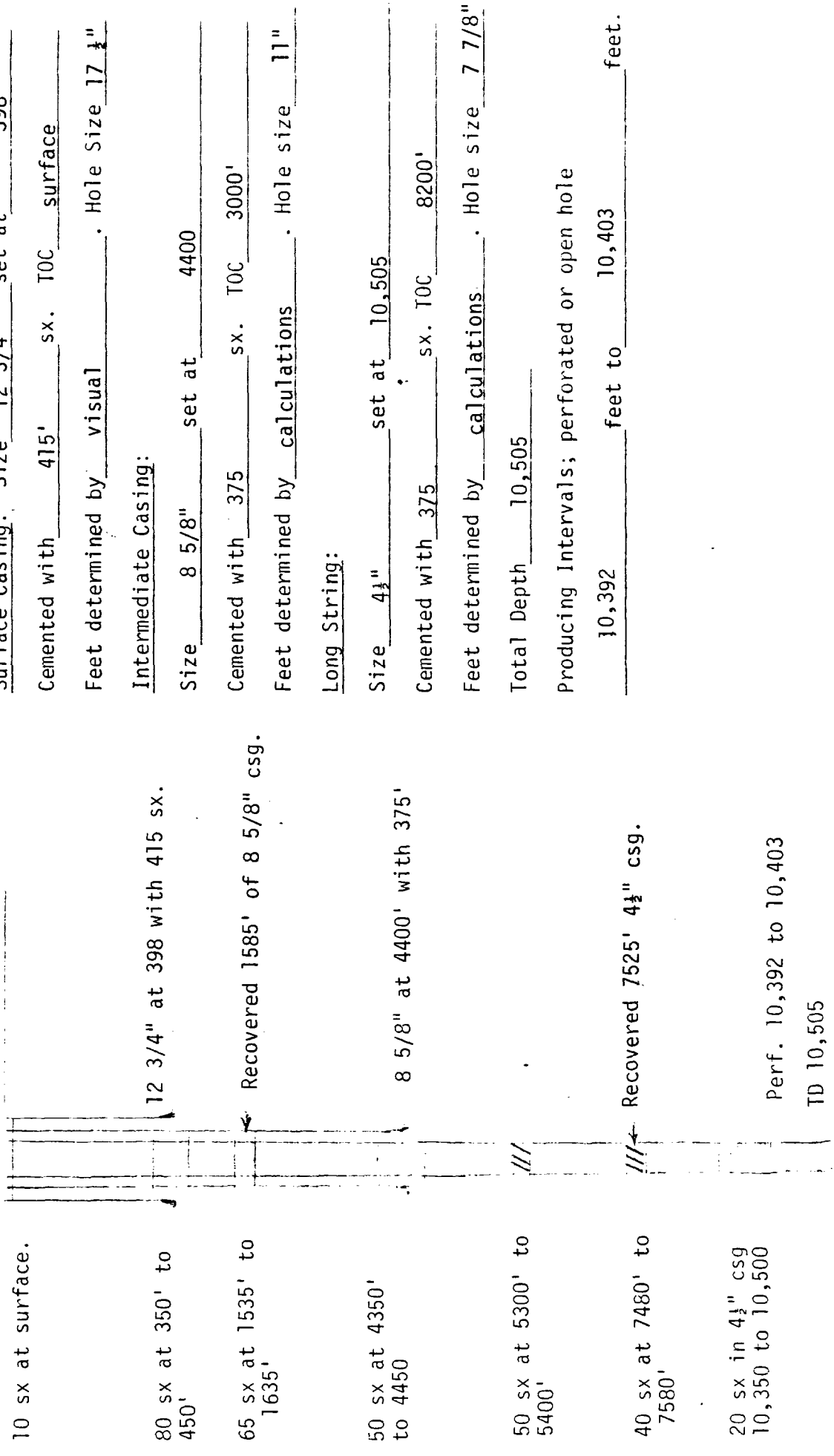

TABULAR DATA

Surface Casing: Size 12 3/4" set at 398
 Cemented with 415' sx. TOC surface
 Feet determined by visual. Hole Size 17 1/2"
Intermediate Casing:
 Size 8 5/8" set at 4400
 Cemented with 375 sx. TOC 3000'
 Feet determined by calculations. Hole size 11"
Long String:
 Size 4 1/2" set at 10,505
 Cemented with 375 sx. TOC 8200'
 Feet determined by calculations. Hole size 7 7/8"
 Total Depth 10,505
 Producing Intervals; perforated or open hole
10,392 feet to 10,403 feet.

NO. OF COPIES RECEIVED	
DISTRIBUTION	
SANTA FE	
FILE	
U.S.G.S.	
LAND OFFICE	
OPERATOR	

NEW MEXICO OIL CONSERVATION COMMISSION

Form C-103
Supersedes Old
C-102 and C-103
Effective 1-1-65

5a. Indicate Type of Lease
State Fee
5. State Oil & Gas Lease No.

SUNDRY NOTICES AND REPORTS ON WELLS

(DO NOT USE THIS FORM FOR PROPOSALS TO DRILL OR TO DEEPEN OR PLUG BACK TO A DIFFERENT RESERVOIR. USE "APPLICATION FOR PERMIT -" (FORM C-101) FOR SUCH PROPOSALS.)

1. OIL WELL GAS WELL OTHER-
2. Name of Operator **Mark Production Company**
3. Address of Operator **1112 Tower West, Midland, Texas 79701**
4. Location of Well **300 North 63**
UNIT LET **West** **32** FEET FROM THE **14S** LINE AND **34E** FEET FROM THE _____ LINE, SECTION _____ TOWNSHIP _____ RANGE _____ NMPM.
15. Elevation (Show whether DF, RT, GR, etc.) **4180**
7. Unit Agreement Name
8. Farm or Lease Name
9. Well No.
10. Field and Pool, or Wildcat
12. County

Check Appropriate Box To Indicate Nature of Notice, Report or Other Data

NOTICE OF INTENTION TO:

PERFORM REMEDIAL WORK
TEMPORARILY ABANDON
PULL OR ALTER CASING
OTHER _____
PLUG AND ABANDON
CHANGE PLANS

SUBSEQUENT REPORT OF:

REMEDIAL WORK
COMMENCE DRILLING OPNS.
CASING TEST AND CEMENT JOB
OTHER _____
ALTERING CASING
PLUG AND ABANDONMENT

17. Describe Proposed or Completed Operations (Clearly state all pertinent details, and give pertinent dates, including estimated date of starting any proposed work)

6/14/76	Plug #1	20 sx. cement in 4 1/2" casing	1050'
6/14/76	Plug #2	40 sx. cement in & out of 4 1/2" stub	7480 - 7580'
6/14/76	Plug #3	30 sx. cement (Glorietta)	3300' - 3400'
6/14/76	Plug #4	50 sx. cement 8 5/8" shoe	4350' - 4450'
6/13/76	Plug #5	65 sx. cement 8 5/8" stub	1535' - 1635'
6/13/76	Plug #6	50 sx. cement 12 3/4" shoe	350 - 400'
6/13/76	Plug #7	10 sx. cement surface	0 - 10'

Established dry hole marker
9.5# mud between plugs

Recovered 7325' of 4 1/2" casing
Recovered 1580' of 8 5/8" casing

18. I hereby certify that the information above is true and complete to the best of my knowledge and belief.

SIGNED *E. T. Cathey* TITLE *J. E. Northcutt* DATE June 18, 1976

Orig. Signed by
John Rangan

APPROVED BY _____ TITLE _____ DATE NOV 5 1976

CONDITIONS OF APPROVAL, IF ANY:

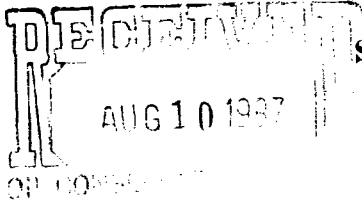

SAGE ENERGY COMPANY

P. O. DRAWER 3068

MIDLAND, TEXAS 79702

915/683-5271

August 7, 1987

Energy and Mineral Department
State of New Mexico
P. O. Box 2088
Santa Fe, New Mexico 87501

Attn: David R. Catanach

Subj: Plugging Data
John Etcheverry, Jr. "A" No. 1
Lease No. 9182
Lea County, New Mexico

Dear Sir:

After contacting Mewborne Oil Company and the Hobbs Division Office, I found that the subject well was more completely plugged as shown on the enclosed Form C-103. In my opinion, the well was adequately plugged to prevent migration of fluid outside the intended injection zone at 10,412' - 10,424' as identified on the cross section, Exhibit No. 11.

Very truly yours,

SAGE ENERGY COMPANY

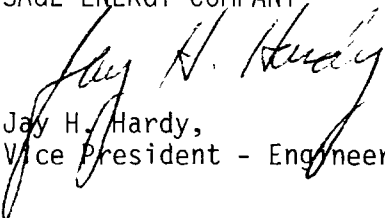
Jay H. Hardy,
Vice President - Engineering

JHH:h

cc: Karen Aubrey
Kellahain, Kellahain and Aubrey
P. O. Box 2265
Santa Fe, New Mexico 87504

PLUGGED WELL DATA

Corrected 8/6/81
By W. H. Hensley

Operator Name Mark Production Co-Mewborne Oil Lease Name John Etchevery, Jr. "A"

Well No. 1

Footage Location 1980 FNL and 1830 FWL

Section 29

Township 14S

Range 34E

County Lea

Date P&A 1-20-72

SCHEMATIC

TABULAR DATA

10 sx at surface.

Surface Casing: Size 13 3/8" set at 390

Cemented with 400 sx. TOC Surface

Feet determined by Visual. Hole Size 17 1/2"

Intermediate Casing:

Size 8 5/8" set at 4418'

Cemented with 375 sx. TOC 3500'

Feet determined by Calculations. Hole size 11"

Long String:

Size None set at _____

Cemented with _____ sx. TOC _____

Feet determined by _____ . Hole size _____

Total Depth 10,515

Producing Intervals; perforated or open hole

_____ feet to _____ feet

13 3/8" at 390' with 400 sx

Shot 8 5/8" casing off at 1190', worked casing free

8 5/8" set at 4418' with 375'

25 sx at 4400'

25 sx at 5902'

25 sx at 8005'

25 sx at 9485'

35 sx at bottom

TD 10,515'

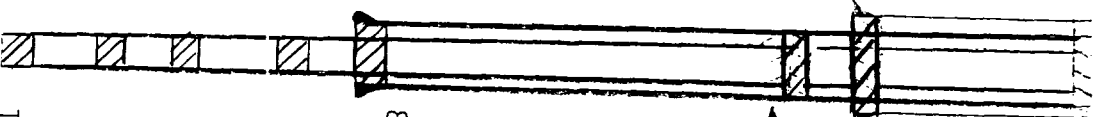

NO. OF COPIES RECEIVED		
DISTRIBUTION		
SANTA FE		
FILE		
U.S.G.S.		
LAND OFFICE		
OPERATOR		

NEW MEXICO OIL CONSERVATION COMMISSION

Form C-103
Supersedes Old
C-102 and C-103
Effective 1-1-85

5a. Indicate Type of Lease
State Fee **XX**
5. State Oil & Gas Lease No.

SUNDRY NOTICES AND REPORTS ON WELLS
(DO NOT USE THIS FORM FOR PROPOSALS TO DRILL OR TO DEEPEN OR PLUG BACK TO A DIFFERENT RESERVOIR. USE "APPLICATION FOR PERMIT -" (FORM C-101) FOR SUCH PROPOSALS.)

1. OIL WELL <input checked="" type="checkbox"/> GAS WELL <input type="checkbox"/> OTHER- <input type="checkbox"/>	7. Unit Agreement Name
2. Name of Operator Mark Production Company	8. Farm or Lease Name John Etcheverry, Jr. "A"
3. Address of Operator 1108 Simons Building, Dallas, Texas 75201	9. Well No. 1
4. Location of Well UNIT LETTER F 1980 FEET FROM THE North LINE AND 1830 FEET FROM THE West LINE, SECTION 29 TOWNSHIP 14-S RANGE 34-E NMPM.	10. Field and Pool, or Wildcat Undesignated
15. Elevation (Show whether DF, RT, GR, etc.) 4141' GL	12. County Les

16. Check Appropriate Box To Indicate Nature of Notice, Report or Other Data

<p>NOTICE OF INTENTION TO:</p> <p>PERFORM REMEDIAL WORK <input type="checkbox"/></p> <p>TEMPORARILY ABANDON <input type="checkbox"/></p> <p>PULL OR ALTER CASING <input type="checkbox"/></p> <p>OTHER <input type="checkbox"/></p>	<p>SUBSEQUENT REPORT OF:</p> <p>PLUG AND ABANDON <input type="checkbox"/></p> <p>CHANGE PLANS <input type="checkbox"/></p> <p>OTHER <input type="checkbox"/></p>	<p>REMEDIAL WORK <input type="checkbox"/></p> <p>COMMENCE DRILLING OPNS. <input type="checkbox"/></p> <p>CASING TEST AND CEMENT JOB <input type="checkbox"/></p> <p>OTHER <input type="checkbox"/> TA</p>	<p>ALTERING CASING <input type="checkbox"/></p> <p>PLUG AND ABANDONMENT <input checked="" type="checkbox"/></p>
---	--	--	---

17. Describe Proposed or Completed Operations (Clearly state all pertinent details, and give pertinent dates, including estimated date of starting any proposed work) SEE RULE 1103.

11-28-71 Drilled to 10,515' - plugged and abandoning

10 jts of 12-3/4" casing set at 390' left in hole.
114 jts of 8-5/8" casing set at 4418' left in hole.

Set 35 sack plug at bottom
Set 25 sack plug at 9485' - Wolfcamp
Set 25 sack plug at 8005' - Abo
Set 25 sack plug at 5902' - Glorieta
Set 25 sack plug at bottom of intermediate - 4400'

Planning to pull 8-5/8" casing when weather permits rig to move off location. Will place 25 sack plug on top of stub, 25 sacks at bottom of 12-3/4" casing and 10 sacks at top with a cap.

18. I hereby certify that the information above is true and complete to the best of my knowledge and belief.

SIGNED *Reginald Thompson* TITLE Assistant Secretary DATE 12-2-71

APPROVED BY *John Etcheverry* TITLE MANAGER DISTRICT I DATE DEC 13 1971

CONDITIONS OF APPROVAL, IF ANY:

PLUGGED WELL DATA

Operator Name Mark Production Co-Mewborne Oil Lease Name John Etchevery, Jr. "A" Well No. 1

Footage Location 1980 FNL and 1830 FWL Section 29 Township 14S Range 34E

County Lea Date P&A 1-20-72

SCHEMATIC

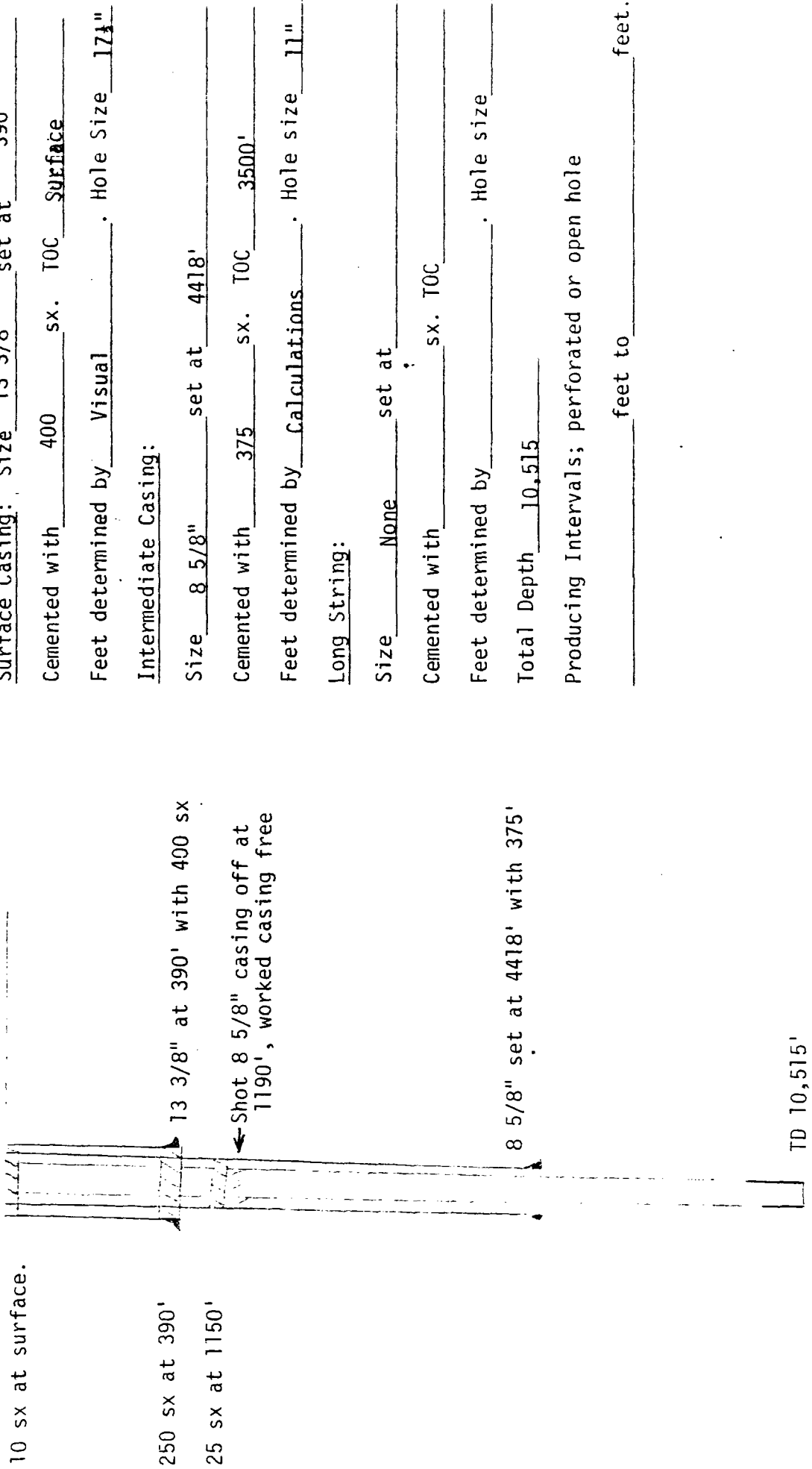

TABULAR DATA

Surface Casing: Size 13 3/8" set at 390
 Cemented with 400 sx. TOC SURFACE
 Feet determined by Visual. Hole Size 17 1/4"
 Intermediate Casing:
 Size 8 5/8" set at 4418'
 Cemented with 375 sx. TOC 3500'
 Feet determined by Calculations. Hole size 11"
 Long String:
 Size None set at _____
 Cemented with _____ sx. TOC _____
 Feet determined by _____ Hole size _____
 Total Depth 10,515
 Producing Intervals; perforated or open hole _____ feet to _____ feet.

TD 10,515'

NO. OF COPIES RECEIVED		
DISTRIBUTION		
SANTA FE		
FILE		
U.S.G.S.		
LAND OFFICE		
OPERATOR		

NEW MEXICO OIL CONSERVATION COMMISSION

Form C-103
Supersedes Old
C-102 and C-103
Effective 1-1-65

5a. Indicate Type of Lease
State Fee

5. State Oil & Gas Lease No.

SUNDRY NOTICES AND REPORTS ON WELLS
(DO NOT USE THIS FORM FOR PROPOSALS TO DRILL OR TO DEEPEN OR PLUG BACK TO A DIFFERENT RESERVOIR. USE "APPLICATION FOR PERMIT -" (FORM C-101) FOR SUCH PROPOSALS.)

1. OIL WELL <input checked="" type="checkbox"/> GAS WELL <input type="checkbox"/> OTHER Dry	7. Unit Agreement Name
2. Name of Operator Mark Production Company	8. Farm or Lease Name John Etcheverry, Jr. "A"
3. Address of Operator 1108 Simons Building, Dallas, Texas 75201	9. Well No. 1
4. Location of Well UNIT LETTER F , 1980 FEET FROM THE North LINE AND 1830 FEET FROM THE West LINE, SECTION 29 TOWNSHIP 14-S RANGE 34-E NMPM.	10. Field and Pool, or Wildcat Undesignated
15. Elevation (Show whether DF, RT, GR, etc.) 4141' GL	12. County Lea

16. Check Appropriate Box To Indicate Nature of Notice, Report or Other Data

NOTICE OF INTENTION TO:	SUBSEQUENT REPORT OF:
PERFORM REMEDIAL WORK <input type="checkbox"/>	REMEDIAL WORK <input type="checkbox"/>
TEMPORARILY ABANDON <input type="checkbox"/>	COMMENCE DRILLING OPNS. <input type="checkbox"/>
PULL OR ALTER CASING <input type="checkbox"/>	CASING TEST AND CEMENT JOB <input type="checkbox"/>
OTHER _____ <input type="checkbox"/>	OTHER _____ <input type="checkbox"/>
PLUG AND ABANDON <input type="checkbox"/>	ALTERING CASING <input type="checkbox"/>
CHANGE PLANS <input type="checkbox"/>	PLUG AND ABANDONMENT <input checked="" type="checkbox"/>

17. Describe Proposed or Completed Operations (Clearly state all pertinent details, and give pertinent dates, including estimated date of starting any proposed work) SEE RULE 1103.

1-1-72 Sho: 8-5/8" casing off at approximately 1190' - worked casing free -

Set plug No. 1	25 sacks	@ 1150'	8-5/8" Stub
Set Plug No. 2	25 sacks	@ 390'	13-3/8" shoe
Set Plug No. 3	10 sacks	@ Surface	

18. I hereby certify that the information above is true and complete to the best of my knowledge and belief.

SIGNED *Gaylord Thompson* TITLE Assistant Secretary DATE 1-20-72

APPROVED BY *Nathan E. Olegg* TITLE OIL & GAS INSPECTOR DATE MAR 6 1972

CONDITIONS OF APPROVAL, IF ANY:

DATA ON PROPOSED OPERATION

PILOT WATERFLOOD

VII.

1. Estimated average injection rate is 300 BWPD and the maximum is 500 BWPD.
2. The system is closed.
3. Estimated average injection pressure is 2000 psi and the maximum is 3000 psi.
4. Injection fluid is fresh and produced water. Analysis of fresh water is attached.
5. Not applicable.

VIII.

The injection zone is:

Perforations from 10,392' to 10,407'. Top of Permo. - Penn. (Bough "C") is 10,392'. The thickness of the Permo. Penn. formation is 700'.

Source of drinking water is Cretaceous at 250' to 350'.

- IX. No stimulation program needed.
- X. Logs and test data on file with the division.
- XI. Analysis attached.

XIII.

I have no knowledge of open faults or any other hydrologic connection between the injection zone and any underground source of drinking water.

GEOLOGY

The Tres Papalotes field located in T-14, R-34, Lea County, New Mexico, produces from several members of the Bough "C" formation. The Bough "C" is widely productive along the western platform margin of the Tatum Basin. Dated as Permo-Penn is age, the productive members consist of clean porous white limestone, very fossiliferous, with chert nodules interspersed within the limestone. The dispositional model of this reservoir is the most likely algal mats grew and thrived within the photic zone, basinward from the basin edge in a relatively high energy environment, achieving in the process the porous high permeability productive limestone.

PERMISSION EXAMINER CATALOG
OIL COMPANY DIVISION
SECTION NO. 4
CASE NO. 9182

WATER ANALYSIS - Halliburton Services

Located NW/4 of SW/4 of Sec. 29, T-14-S,
R-34-E, Lea County, New Mexico

Res. at 70° = 5.41 ohms

S. G. = 1.000

PL = 7.8

Ca ++ = 100 ppm
Mg ++ = 100 ppm
Cl - = 75 ppm
SO₄-- = 70 ppm
Bicarb = 168 ppm
Fe = None

DATE	ANALYST
	W. J. HANCOCK
WELL NO.	5
9182	

PILOT WATERFLOOD WELL DATA SHEET

OPERATOR SAGE ENERGY COMPANY NEW MEXICO "30" State No. 1

WELL NO. 800 FEL and 1980 FSL of Sec. 30, T-14-W, R-34-E LEA COUNTY, New Mexico

FOOTAGE LOCATION SECTION TOWNSHIP RANGE

Schematic

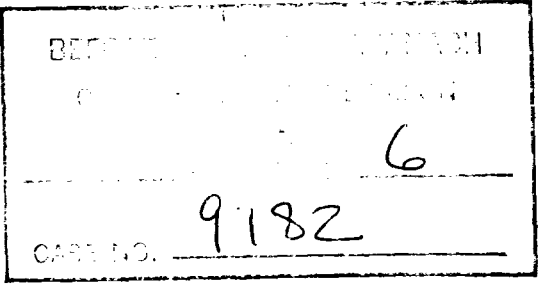
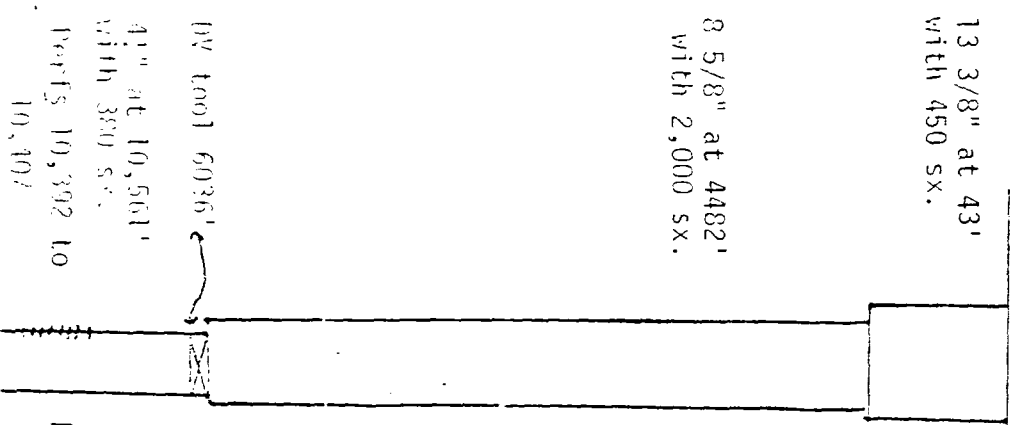

Tabular Data

<u>Surface Casing</u>	Size <u>13 3/8"</u>	"	Cemented with <u>450 SX</u>	"	SX.
	TOC <u>Circulated</u>		feet determined by <u>Visual survey</u>		
	Hole size <u>17 1/2"</u>				
<u>Intermediate Casing</u>	Size <u>8 5/8"</u>	"	Cemented with <u>2000 Halliburton Light</u>		
	TOC <u>Circulated</u>		feet determined by <u>Circulated to Surface</u>		
	Hole size <u>11"</u>				
<u>Long string</u>	Size <u>4 1/2"</u>	"	Cemented with <u>550 SX</u>		SX.
	TOC <u>9273</u>		feet determined by <u>Calculations</u>		
	Hole size <u>7 7/8"</u>				
	Total depth <u>10,519'</u>		<u>PBID</u>		
<u>Injection Interval</u>	<u>10,392'</u>		feet to <u>10,407'</u>		feet
			(perforated or open-hole, indicate which)		

WELL LOG 60361
 4" at 10,561' with 380 SX.
 Perf's 10,392 to 10,407
 PBID 10,518 to 10,530

Affidavit of Publication

STATE OF NEW MEXICO)
) ss.
COUNTY OF LEA)

Joyce Clemens being first duly sworn on oath deposes and says that he is Adv. Director of THE LOVINGTON DAILY LEADER, a daily newspaper of general paid circulation published in the English language at Lovington, Lea County, New Mexico; that said newspaper has been so published in such county continuously and uninteruptedly for a period in excess of Twenty-six (26) consecutive weeks next prior to the first publication of the notice hereto attached as hereinafter shown; and that said newspaper is in all things duly qualified to publish legal notices within the meaning of Chapter 167 of the 1937 Session Laws of the State of New Mexico.

That the notice which is hereto attached, entitled
Legal Notice

and numbered in the
..... Court of Lea
County, New Mexico, was published in a regular and
entire issue of THE LOVINGTON DAILY LEADER and
not in any supplement thereof, once each week on the
same day of the week, for two (2)
consecutive weeks, beginning with the issue of
July 2, 1987

and ending with the issue of
July 9, 1987

And that the cost of publishing said notice is the
sum of \$ 11.88

which sum has been (Paid) ~~XXXXXXXX~~ as Court Costs

Joyce Clemens
Subscribed and sworn to before me this 16th
day of July, 1987

Mr. Jean Armer
Notary Public, Lea County, New Mexico
My Commission Expires Sept. 28, 1990

LEGAL NOTICE

Sage Energy Company, P.O. Drawer 3068, Midland, Texas 79702 has applied to convert its New Mexico "30" State No. 1 well located 880' FEL and 1980' FSL of Sec. 30, T-14-S, R-34-E, Lea County, New Mexico to a water injection well in a pilot waterflood. The operator intends to inject formation and fresh water into the Tres Papalotes (West) Penn. at a depth from 10,392' to 10,407' at the approximate rate of 500 BWPD on 3000 psi. Interested parties must file objections on or request a hearing with the Oil Conservation Commission, P.O. Box 1488, Santa Fe, New Mexico 87504, within 15 days of todays date.

SAGE ENERGY COMPANY

Frances Holzgraf

Production Clerk

Published in the Lovington Daily Leader July 2 and 9, 1987.

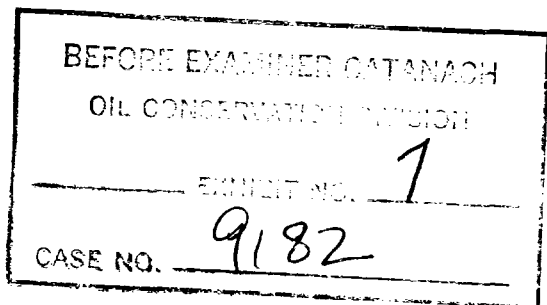

W A I V E R

New Mexico Oil Conservation Commission
P. O. Box 2088
Santa Fe, New Mexico 87501

Re: Sage Energy Company, New Mexico "30" State, 800' FEL and 1980' FSL of
Sec. 30, T-14-S, R-34-E, Lea County, New Mexico.

Dear Sir:

I have been duly notified of the intent of Sage Energy Company to convert the
captioned well to a pilot waterflood well. I have no objection to this con-
version.

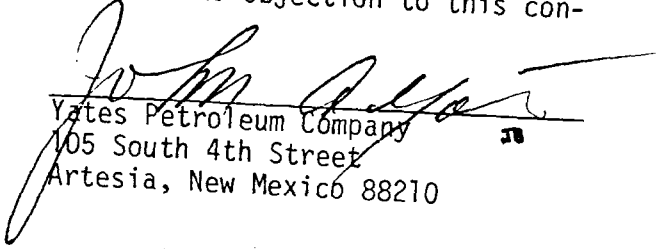

Yates Petroleum Company
105 South 4th Street
Artesia, New Mexico 88210

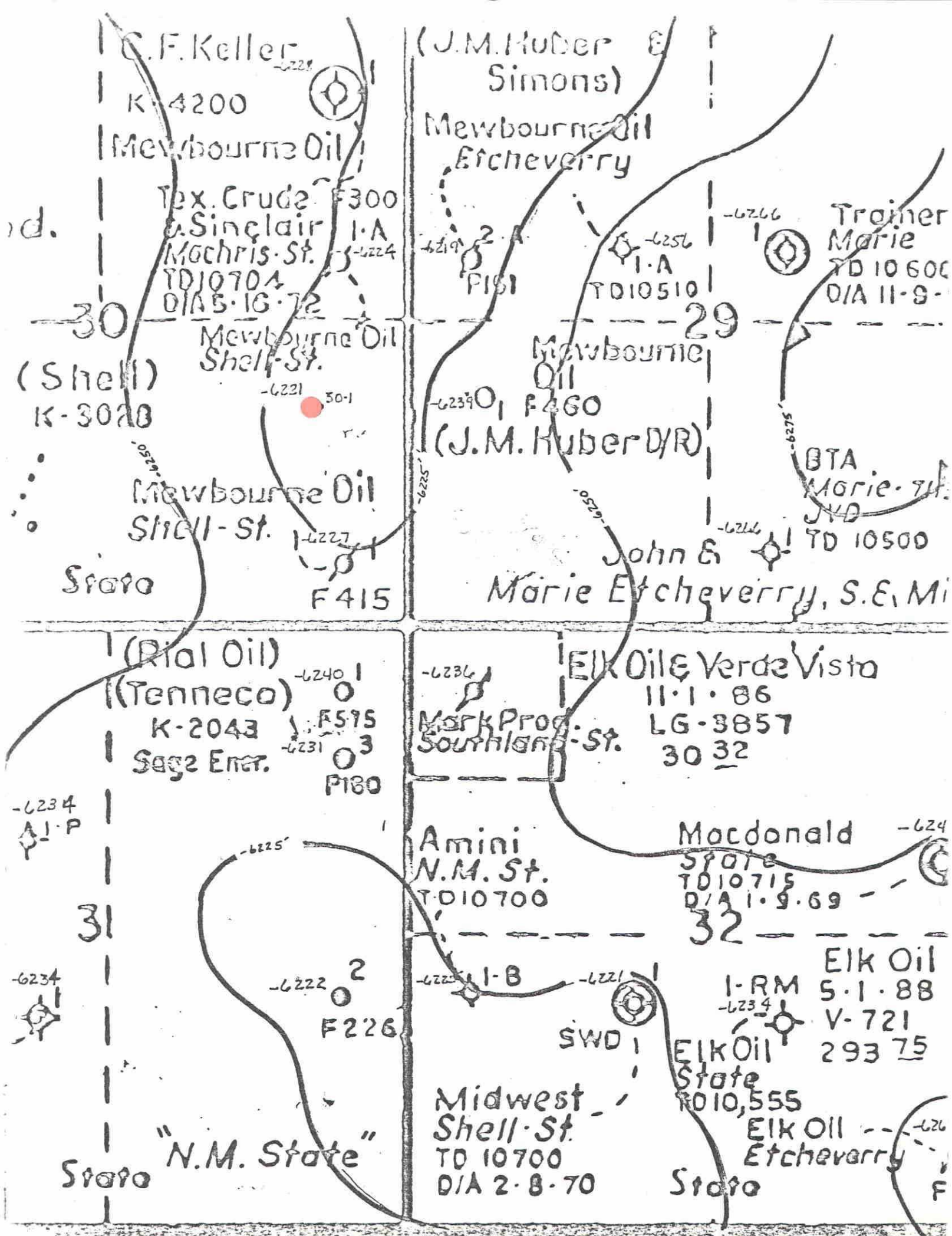
DEPOSE EXAMINER CANTAMACH
Oil Conservation Division
8
9182

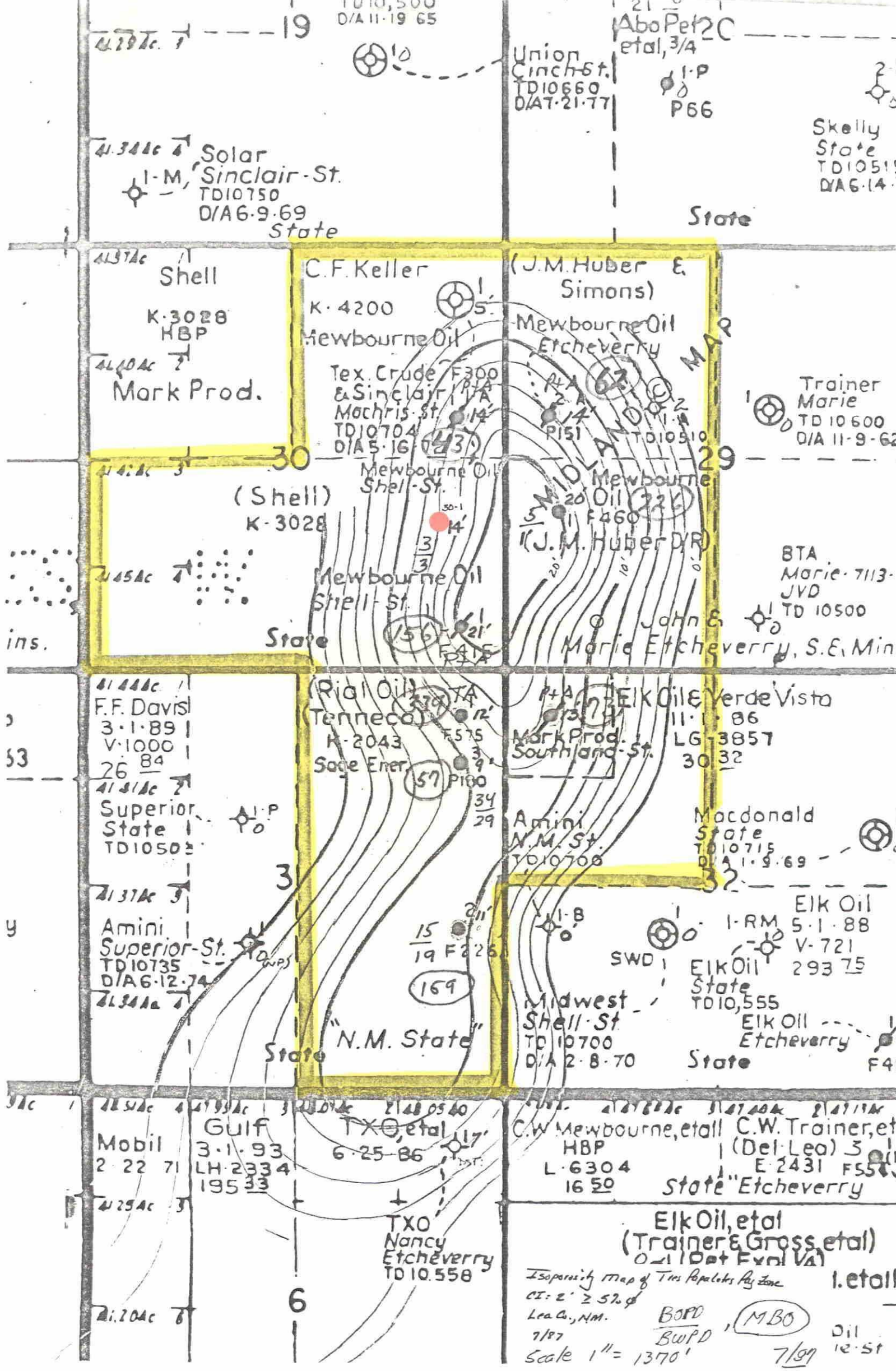

BEFORE EXAMINER CATANACH
 OIL CONSERVATION DIVISION
 EXHIBIT NO. 9
 CASE NO. 9182

TRES PAPALOTES FIELD
 Structure Map of Tres
 Papalotes pay zone.
 C.I. = 25'
 Lea County, New Mexico
 SCALE: 0 1000



Isoperimetry Map of Tins Popalok's Az. Zone
 CI: 2' ± 5%
 Lea Co., NM. BOPD (MBO)
 7/87 BWPD
 Scale 1" = 1370'
 7/99 Oil 12.5t

BEFORE EXAMINER CATANACH
OIL CONSERVATION DIVISION

EXHIBIT NO. 10

CASE NO. 9182
