

Unit Name SUNNY SIDE STATE UNIT - EXPLORATORY
 Operator YATES PETROLEUM CORPORATION
 County CHAVES

DATE	OCC CASE NO.	9317	EFFECTIVE DATE	TOTAL ACREAGE	STATE	FEDERAL	INDIAN-FEE	SEGREGATION CLAUSE	TERM
APPROVED	OCC ORDER NO.	P-8612	March 30, 1988	8,836.81	8,836.81	-0-	-0-	Strict	5 Years & so Long as

OCD: MARCH 11, 1988
 COMMISSIONER: March 30, 1988

UNIT AREA

- TOWNSHIP 10 SOUTH, RANGE 26 EAST, NMPM
- Section 1: All
 - Section 2: S/2
 - Section 3: S/2
 - Section 4: S/2
 - Section 5: S/2, NE/4NE/4, S/2NE/4
 - Section 8: All
 - Section 9: All
 - Section 10: All
 - Section 11: All
 - Section 12: All
 - Section 13: All
 - Section 14: All
 - Section 15: All
 - Section 16: All
 - Section 24: W/2, W/2SE/4

- TOWNSHIP 10 SOUTH, RANGE 27 EAST, NMPM
- Section 6: All

3 CD

Unit Name SUNNY SIDE STATE UNIT - EXPLORATORY
 Operator YATES PETROLEUM CORPORATION
 County CHAVES COUNTY, NEW MEXICO

STATE TRACT NO.	LEASE NO.	INSTI-TUTION	SEC.	TWP.	RGE.	SUBSECTION	DATE	ACRES	ACREAGE		LESSEE
									NOT	RATIFIED	
1	LG-5229-1	C. S.	1	10S	26E	Lots 3, 4, S $\frac{1}{2}$ NW $\frac{1}{4}$, S $\frac{1}{2}$	3/15/88	480.27			Apache Corporation
2	LG-5231	C. S.	4	10S	26E	N $\frac{1}{2}$ SW $\frac{1}{4}$, SW $\frac{1}{4}$ SW $\frac{1}{4}$, NE $\frac{1}{2}$ SE $\frac{1}{4}$, SW $\frac{1}{4}$ SE $\frac{1}{4}$	2/26/88	200.00			Yates Petroleum Corp.
3	LG-5232	C. S.	5	10S	26E	Lot 1, S $\frac{1}{2}$ NE $\frac{1}{4}$, NW $\frac{1}{4}$ SW $\frac{1}{4}$, SE $\frac{1}{4}$ SW $\frac{1}{4}$, SE $\frac{1}{4}$	2/26/88	600.06			Yates Petroleum Corp.
4	LG-5233	C. S.	10	10S	26E	N $\frac{1}{2}$, NW $\frac{1}{4}$ SW $\frac{1}{4}$, S $\frac{1}{2}$ SW $\frac{1}{4}$, SE $\frac{1}{4}$	2/26/88	600.00			Yates Petroleum Corp.
5	LG-5234	C. S.	11	10S	26E	NW $\frac{1}{4}$, W $\frac{1}{2}$ SW $\frac{1}{4}$, SE $\frac{1}{4}$ SW $\frac{1}{4}$, NE $\frac{1}{2}$ SE $\frac{1}{4}$	2/26/88	320.00			Yates Petroleum Corp.
6	LG-5235-1	C. S.	13	10S	26E	SE $\frac{1}{4}$, SW $\frac{1}{4}$ NE $\frac{1}{4}$, N $\frac{1}{2}$ NE $\frac{1}{4}$, W $\frac{1}{2}$ W $\frac{1}{4}$, NE $\frac{1}{4}$ NW $\frac{1}{4}$, SE $\frac{1}{4}$ SW $\frac{1}{4}$	3/15/88	520.00			Apache Corporation
7	LG-5236	C. S.	14	10S	26E	SWNE $\frac{1}{4}$, N $\frac{1}{2}$ NW $\frac{1}{4}$, SW $\frac{1}{4}$ NW $\frac{1}{4}$, N $\frac{1}{2}$ SW $\frac{1}{4}$, SW $\frac{1}{4}$ SW $\frac{1}{4}$, S $\frac{1}{2}$ SE $\frac{1}{4}$ 2/26/88	2/26/88	360.00			Yates Petroleum Corp.
8	LG-5237	C. S.	15	10S	26E	All	2/26/88	640.00			Yates Petroleum Corp.
9	LG-5238	C. S.	16	10S	26E	N $\frac{1}{2}$, W $\frac{1}{2}$ SW $\frac{1}{4}$, SE $\frac{1}{4}$	2/26/88	560.00			Yates Petroleum Corp.
10	LG-5239	C. S.	24	10S	26E	N $\frac{1}{2}$ NW $\frac{1}{4}$, SW $\frac{1}{4}$ NW $\frac{1}{4}$, SW $\frac{1}{4}$, W $\frac{1}{2}$ SE $\frac{1}{4}$	2/26/88	360.00			Yates Petroleum Corp.
11	LG-5241	C. S.	6	10S	27E	Lots 1, 2, 3, 4, 5, 6, 7, S $\frac{1}{2}$ NE $\frac{1}{4}$, SE $\frac{1}{4}$ NW $\frac{1}{4}$, E $\frac{1}{2}$ SW $\frac{1}{4}$, SE $\frac{1}{4}$ 2/26/88	3/15/88	120.00			Apache Corporation
12	LG-5412-1	C. S.	12	10S	26E	N $\frac{1}{2}$ NW $\frac{1}{4}$, SE $\frac{1}{4}$ NW $\frac{1}{4}$	3/15/88	80.07			Apache Corporation
13	LG-7421-2	C. S.	1	10S	26E	Lot 2, SW $\frac{1}{4}$ NE $\frac{1}{4}$	3/15/88	320.00			Apache Corporation
14	LG-7422-1	C. S.	2	10S	26E	S $\frac{1}{2}$	3/15/88	320.00			Apache Corporation
15	LG-7423-1	C. S.	3	10S	26E	S $\frac{1}{2}$	3/15/88	320.00			Apache Corporation
16	LG-7424-1	C. S.	9	10S	26E	N $\frac{1}{2}$ SE $\frac{1}{4}$, SE $\frac{1}{4}$ SE $\frac{1}{4}$, NW $\frac{1}{4}$ NE $\frac{1}{4}$, NE $\frac{1}{4}$ SW $\frac{1}{4}$	3/15/88	240.00			Apache Corporation
17	LG-7999	C. S.	4	10S	26E	SE $\frac{1}{4}$ SE $\frac{1}{4}$, SE $\frac{1}{4}$ SW $\frac{1}{4}$, NW $\frac{1}{4}$ SE $\frac{1}{4}$			120.00		Chevron USA Inc.
18	LG-8000	C. S.	16	10S	26E	E $\frac{1}{2}$ SW $\frac{1}{4}$			80.00		Samedan Oil Corp.
19	LH-1858-1	C. S.	9	10S	26E	S $\frac{1}{2}$ NE $\frac{1}{4}$, NE $\frac{1}{4}$ NE $\frac{1}{4}$			120.00		Texaco Producing Inc.
20	LH-1859-1	C. S.	11	10S	26E	NE $\frac{1}{4}$, W $\frac{1}{2}$ SE $\frac{1}{4}$, SE $\frac{1}{4}$ SE $\frac{1}{4}$			280.00		Texaco Producing Inc.
21	LG-1860-1	C. S.	14	10S	26E	N $\frac{1}{2}$ NE $\frac{1}{4}$, SE $\frac{1}{4}$ NE $\frac{1}{4}$, N $\frac{1}{2}$ SE $\frac{1}{4}$			200.00		Yates Petroleum Corp.
22	LH-2612	C. S.	8	10S	26E	All	2/26/88	640.00			Yates Petroleum Corp.
23	LH-2613-1	C. S.	9	10S	26E	E $\frac{1}{2}$ NW $\frac{1}{4}$, SW $\frac{1}{4}$ NW $\frac{1}{4}$	3/15/88	120.00			Apache Corporation
24	V-2331	C. S.	1	10S	26E	Lot 1, SE $\frac{1}{4}$ NE $\frac{1}{4}$	3/15/88	80.02			Elk Oil Company
25	V-2332	C. S.	12	10S	26E	E $\frac{1}{2}$, SW $\frac{1}{4}$, SW $\frac{1}{4}$ NW $\frac{1}{4}$	3/15/88	520.00			Apache Corporation
26	V-2333	C. S.	13	10S	26E	SE $\frac{1}{4}$ NW $\frac{1}{4}$, SE $\frac{1}{4}$ NE $\frac{1}{4}$, NE $\frac{1}{4}$ SW $\frac{1}{4}$			120.00		W. W. Cline
27	V-2334	C. S.	14	10S	26E	SE $\frac{1}{4}$ NW $\frac{1}{4}$, SE $\frac{1}{4}$ SW $\frac{1}{4}$			80.00		W. W. Cline
28	V-2336	C. S.	28	10S	26E	SE $\frac{1}{4}$ NW $\frac{1}{4}$			40.00		W. W. Cline
29	VB-113	C. S.	5	10S	26E	NE $\frac{1}{4}$ SW $\frac{1}{4}$, SW $\frac{1}{4}$ SW $\frac{1}{4}$			80.00		W. W. Cline

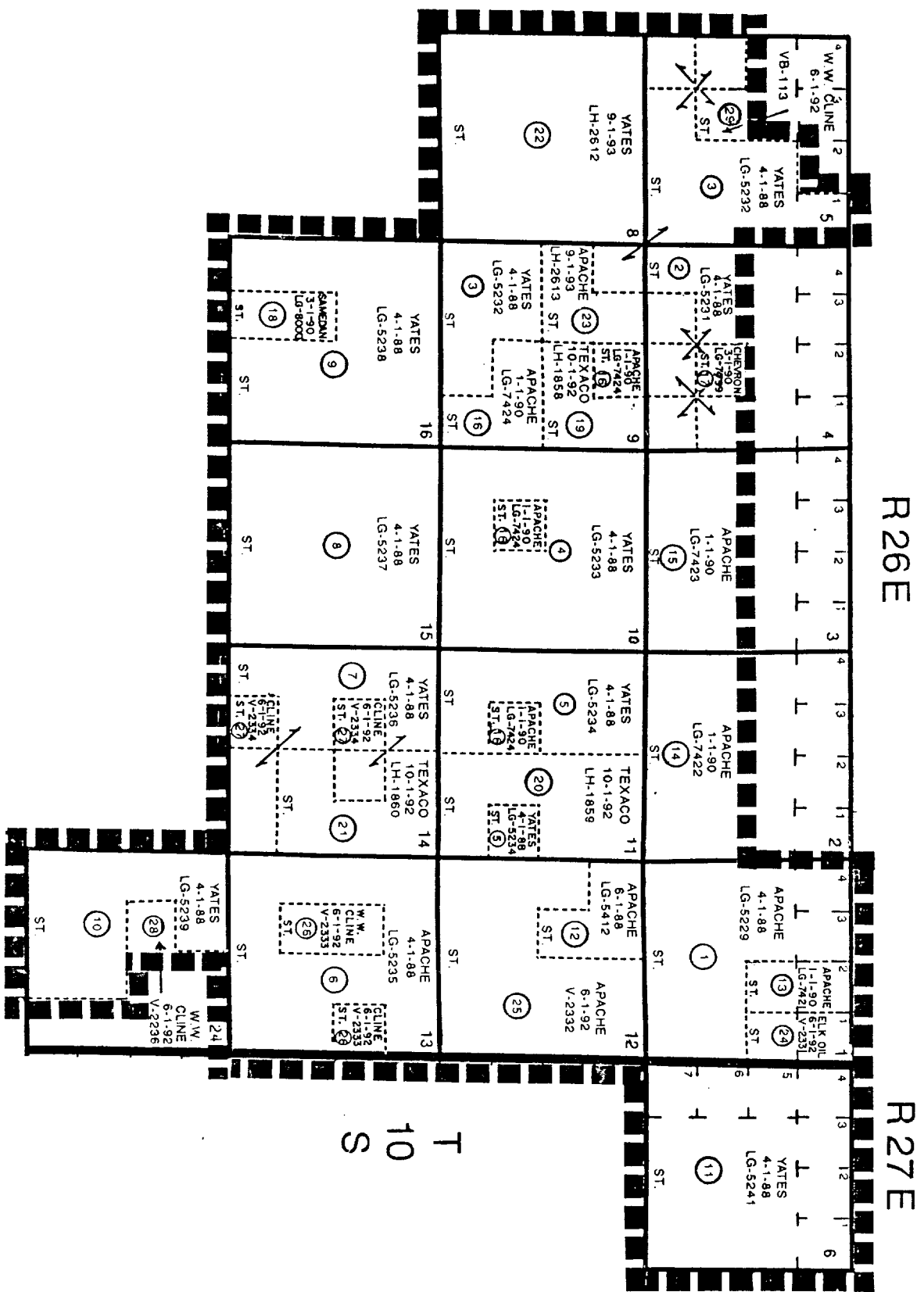

R26E

R27E

T 10 S

- STATE LANDS 8836.81 ACRES 100%
- TRACT NUMBER
- UNIT OUTLINE

SUNNY SIDE STATE UNIT
 CHAVES COUNTY, NEW MEXICO
 EXHIBIT "A"
 YATES PETROLEUM CORPORATION
 105 S. 4TH
 ARTESIA, NEW MEXICO