

HINKLE, COX, EATON, COFFIELD & HENSLEY

ATTORNEYS AT LAW

218 MONTEZUMA

POST OFFICE BOX 2068

SANTA FE, NEW MEXICO 87504-2068

(505) 982-4554

2800 CLAYDESTA NATIONAL BANK BUILDING

POST OFFICE BOX 3580

MIDLAND, TEXAS 79702

(915) 683-4691

1700 TEXAS AMERICAN BANK BUILDING

POST OFFICE BOX 9238

AMARILLO, TEXAS 79105

(806) 372-5569

700 UNITED BANK PLAZA

POST OFFICE BOX 10

ROSWELL, NEW MEXICO 88202

(505) 622-6510

March 28, 1988

LEWIS C. COX
PAUL W. EATON
CONRAD E. COFFIELD
HAROLD L. HENSLEY, JR.
STUART D. SHANOR
C. D. MARTIN
PAUL J. KELLY, JR.
OWEN M. LOPEZ
DOUGLAS L. LUNSFORD
T. CALDER EZZELL, JR.
WILLIAM B. BURFORD*
RICHARD E. OLSON
RICHARD A. SIMMS
RICHARD R. WILFONG*
STEVEN D. ARNOLD
JAMES J. WECHSLER
NANCY S. CUSACK
JEFFREY L. FORNACIARI
JEFFREY D. HEWETT*
JAMES BRUCE
JERRY F. SHACKELFORD*
JEFFREY W. HELLBERG*

ALBERT L. PITTS
THOMAS M. HIASKO
JOHN C. CHAMBERS*
THOMAS D. HAINES, JR.
FRANKLIN H. MCCALLUM*
GREGORY J. NIBERT
DAVID T. MARKETTE*
FRED W. SCHWENDIMANN
JAMES R. MCADAMS*
JAMES M. HUDSON
MACDONNELL GORDON
REBECCA NICHOLS JOHNSON
PAUL R. NEWTON
WILLIAM P. JOHNSON
KAREN M. RICHARDSON*
ELLEN S. CASEY
JAMES C. BROCKMANN
SUSAN L. NIESER*
MARK A. WILSON*
GREGORY S. WHEELER
ANDREW J. CLOUTIER*

OF COUNSEL
O. M. CALHOUN
MACK EASLEY
JOE W. WOOD
STEPHEN L. ELLIOTT

CLARENCE E. HINKLE (1904-1985)
W. E. BONDURANT, JR. (1913-1973)
ROY C. SNOODGRASS, JR. (1915-1987)

*NOT LICENSED IN NEW MEXICO

Mr. William LeMay
New Mexico Oil Conservation Division
State Land Office Building
Santa Fe, New Mexico 87501

HAND DELIVERED

Re: Case No. 9343, Application of Mesa Grande Resources for
Compulsory Pooling and a Non-Standard Proration Unit;
Case No. 9344, Application of NANCO, Inc. for
Compulsory Pooling; and
Case No. 9345, Application of NANCO, Inc. for
Compulsory Pooling.

Dear Mr. LeMay:

Applicants in the above cases hereby request that the cases
be dismissed from the March 30, 1988 Examiner docket. Thank you.

Very truly yours,

HINKLE, COX, EATON,
COFFIELD & HENSLEY

James Bruce

JGB:jr

RECEIVED

MAR 28 1988

NEW MEXICO OIL CONSERVATION DIVISION

STATE OF NEW MEXICO

ENERGY AND MINERALS DEPARTMENT

OIL CONSERVATION DIVISION



GARREY CARRUTHERS
GOVERNOR

April 7, 1988

POST OFFICE BOX 2088
STATE LAND OFFICE BUILDING
SANTA FE, NEW MEXICO 87501
(505) 827-5800

Mr. James Bruce
Hinkle, Cox, Eaton,
Coffield & Hensley
Attorneys at Law
Post Office Box 2263
Santa Fe, New Mexico

Re: CASE NO. 9344
ORDER NO. R-8636

Applicant:

Nanco, Inc.

Dear Sir:

Enclosed herewith are two copies of the above-referenced
Division order recently entered in the subject case.

Sincerely,

Florence Davidson

FLORENE DAVIDSON
OC Staff Specialist

Copy of order also sent to:

Hobbs OCD x
Artesia OCD x
Aztec OCD x

Other _____

**BARKER CREEK, PARADOX (PENNSYLVANIAN)
GAS POOL**

**BLANCO (PICTURED CLIFFS) GAS POOL
GAVILAN (PICTURED CLIFFS) GAS POOL
UTE DOME (PARADOX) GAS POOL**

San Juan and Rio Arriba Counties, New Mexico

Order No. R-46, Adopting Spacing Rules for the Aztec-Pictured Cliffs Gas Pool, the Barker Creek, Paradox-Pennsylvanian Gas Pool, the Blanco-Pictured Cliffs Gas Pool, the Gavilan-Pictured Cliffs Gas Pool, the South Kutz Canyon-Pictured Cliffs Gas Pool, the West Kutz Canyon-Pictured Cliffs Gas Pool, the La Plata-Mesaverde Gas Pool, the Northwest La Plata-Mesaverde Gas Pool, the South La Plata-Mesaverde Gas Pool, and the Ute Dome-Paradox Gas Pool, San Juan and Rio Arriba Counties, New Mexico, December 29, 1950.

NOTE: Order No. R-1670 Supersedes this order as it relates to Aztec (Pictured Cliffs) Gas Pool, South Kutz Canyon and West Kutz Canyon (Pictured Cliffs) consolidated into West Kutz (Pictured Cliffs) Gas Pool, La Plata (Mesaverde) Northwest La Plata (Mesaverde), and South La Plata (Mesaverde) Gas Pools were consolidated into Blanco-Mesaverde Gas Pool.

The application of the Oil Conservation Commission upon its own motion for establishing a well spacing pattern for each of the designated gas pools in the counties of San Juan and Rio Arriba, state of New Mexico producing or capable of producing gas from Pictured Cliffs formation, except Kutz Canyon-Fulcher Basin, Mesaverde formation (except Blanco Pool) and any of the Pennsylvanian formations.

CASE NO. 237
Order No. R-46

ORDER OF THE COMMISSION

BY THE COMMISSION: This cause came on regularly for hearing at 10:00 o'clock A.M., November 21, 1950, at Santa Fe, New Mexico, before the Oil Conservation Commission of New Mexico, hereinafter referred to as the "Commission".

NOW, on this 29th day of December 1950, the Commission having considered the whole matter including the testimony adduced at said hearing,

FINDS:

1. That due public notice having been given as required by law, the Commission has jurisdiction of this cause and the subject matter thereof.

2. That for purposes of orderly development, protection of correlative rights and the prevention of waste, the following pools in San Juan and Rio Arriba Counties, New Mexico heretofore by the Commission named, defined and classified as gas pools, as the respective boundaries thereof may be changed by extension or otherwise, should be provided with proper spacing pattern and production units;

Aztec (Pictured Cliffs) pool, 160-acre spacing;
Barker Creek, Paradox (Pennsylvanian) pool, 640-acre spacing;

Blanco (Pictured Cliffs) pool, 160-acre spacing;
Gavilan (Pictured Cliffs) pool, 160-acre spacing;
South Kutz Canyon (Pictured Cliffs) pool, 160-acre spacing;
West Kutz Canyon (Pictured Cliffs) pool, 160-acre spacing;
La Plata (Mesaverde) pool, 320-acre spacing;
NW La Plata (Mesaverde) pool, 320-acre spacing;

South La Plata (Mesaverde) pool, 320-acre spacing;
Ute Dome (Paradox) pool, 640-acre spacing.

3. That for La Plata, NW La Plata and South La Plata pools, wells should be orthodox locations on NW/4 and SE/4 of each section in said pools.

4. Under 160-acre spacing for Aztec, Blanco (Pictured Cliffs), Gavilan, South Kutz Canyon and West Kutz Canyon pools, orthodox locations should be required as stated in Rule 104 (or 330' from inner and 660' from outer boundaries of the respective quarter section);

5. For those pools appearing to require 640-acre spacing in Pennsylvanian formation, orthodox locations should be required to be not closer than 330' to center and 1650' from boundary of each section in the Barker Creek (Paradox-Pennsylvanian) and Ute Dome (Paradox-Pennsylvanian) pools.

6. That existing Commission Orders 748 and 815, relating to the Kutz Canyon-Fulcher Basin pool, and Order No. 799 relating to the Blanco pool should be and remain in full effect and undisturbed hereby.

IT IS THEREFORE ORDERED:

1. That for purposes of orderly development, protection of correlative rights, and the prevention of waste, a spacing and production unit pattern is hereby provided for each of the following heretofore named, defined and classified pools, as the respective boundaries thereof may from time to time be changed:

POOL	FORMATION	SPACING
Aztec	Pictured Cliffs	160-acre
Barker Creek	Paradox-Pennsylvanian	640-acre
Blanco	Pictured Cliffs	160-acre
Gavilan	Pictured Cliffs	160-acre
La Plata	Mesaverde	320-acre
NW La Plata	Mesaverde	320-acre
South La Plata	Mesaverde	320-acre
South Kutz Canyon	Pictured Cliffs	160-acre
West Kutz Canyon	Pictured Cliffs	160-acre
Ute Dome	Paradox	640-acre

2. That orthodox locations shall be in the approximate center of the NW/4 and SE/4 of each section within the confines of La Plata, Northwest La Plata, and South La Plata pools, under 320 acre spacing for Mesaverde production.

3. That orthodox locations shall be as in Rule 104 (or 330' from inner and 660' from outer boundaries of the respective quarter section) within the boundaries of the Aztec, Blanco, Gavilan, South Kutz Canyon and West Kutz Canyon pools for 160-acre spacing for Pictured Cliffs production.

4. That orthodox locations shall be not closer than 330' to center of the respective sections and 1650' from boundaries within the boundaries of Barker Creek and Ute Dome pools for 640-acre spacing for Paradox-Pennsylvanian production.

5. That Orders Nos. 748, 815, relative to Kutz Canyon-Fulcher Basin Pool, and 799, relating to Blanco Mesaverde, shall remain in full force and effect.

6. That wells now drilled or drilling are excepted.

IT IS FURTHER ORDERED:

1. That for the purpose of preventing inequities and impairment of correlative rights the Commission upon its own motion or upon application of any interested person, after notice and hearing grant exceptions in proper cases.

DONE at Santa Fe, New Mexico, on the day and year hereinabove specified.

STATE OF NEW MEXICO
ENERGY AND MINERALS DEPARTMENT

OIL CONSERVATION DIVISION

P. O. BOX 2088

SANTA FE, NEW MEXICO 87501

30-039-22334

Form O-101
Revised 10-1-78

NO. OF COPIES RECEIVED	5
DISTRIBUTION	
SANTA FE	7
FILE	1
U.S.G.S.	2
LAND OFFICE	
OPERATOR	1

APPLICATION FOR PERMIT TO DRILL, DEEPEN, OR PLUG BACK

1a. Type of Work DRILL <input checked="" type="checkbox"/> DEEPEN <input type="checkbox"/> PLUG BACK <input type="checkbox"/>		2a. Indicate Type of Lease STATE <input type="checkbox"/> FEDERAL <input checked="" type="checkbox"/>	
b. Type of Well OIL WELL <input type="checkbox"/> GAS WELL <input checked="" type="checkbox"/> OTHER <input type="checkbox"/>		3. State Oil & Gas Lease No.	
2. Name of Operator NANCO, INC.		7. Unit Agreement Name	
3. Address of Operator 611 Philtower Building, Tulsa, Oklahoma 74103		8. Form of Lease Name LOCER	
4. Location of Well UNIT LETTER <u>#2 Locer X</u> LOCATED <u>1799.26</u> FEET FROM THE <u>West</u> LINE <u>1735</u> <u>South</u> <u>3555.16</u> FEET FROM THE <u>North</u> LINE OF SEC. 15 TWP. 25N RGE. 2W		9. Well No. Number 2	
11. Formation (Show whether DE, KL, etc.) G.L. 7311.5E		10. Field and Pool, or Wildcat <u>Davidson Lindrich</u> <u>9C</u>	
21a. Kind & Status Plug. bond \$5,000 Single Well		12. County Rio Arriba	
21b. Drilling Contractor L. E. Wilson Bloomfield, New Mexico		13. Proposed Depth 3700'	
21c. Drilling Contractor L. E. Wilson Bloomfield, New Mexico		14. Formation Pictured Cliffs	
21d. Drilling Contractor L. E. Wilson Bloomfield, New Mexico		15. Rotary or C.T. Rotary	
21e. Drilling Contractor L. E. Wilson Bloomfield, New Mexico		16. Approx. Date Work will start 4-23-80	

PROPOSED CASING AND CEMENT PROGRAM

SIZE OF HOLE	SIZE OF CASING	WEIGHT PER FOOT	SETTING DEPTH	SACKS OF CEMENT	EST. TOP
11-3/4"	8-5/8"	24 lbs.	100'	To Surface	
6-3/4"	4-1/2"	11.5 J-55	3700'	100 Sacks	
				150	

APPROVAL VALID
FOR 90 DAYS UNLESS
DRILLING COMMENCED,

EXPIRES 7-20-80



IN ABOVE SPACE DESCRIBE PROPOSED PROGRAM: IF PROPOSAL IS TO DEEPEN OR PLUG BACK, GIVE DATA ON PRESENT PRODUCTIVE ZONE AND PROPOSED NEW PRODUCTIVE ZONE, GIVE BLOWOUT PREVENTER PROGRAM, IF ANY.

I hereby certify that the information above is true and complete to the best of my knowledge and belief.

Signed E. Allen Phillips Title President Date April 15, 1980

(This space for State Use)

APPROVED BY San L. Davey TITLE SUPERVISOR DISTRICT #3 DATE APR 21 1980

CONDITIONS OF APPROVAL, IF ANY:

100' Casing required

All distances must be from the outer boundaries of the Section.

Operator NANCO, INC. 611 Philtower Bldg., Tulsa, Okla. 74103			Lease LOCER LEASE		Well No. 2
Unit Letter K	Section 15	Township 25 N	Range 2 W	County Rio Arriba	
Actual Footage Location of Well: 1799.25 feet from the West line and 3555.16 feet from the South line					
Ground Level Elev. 7311.5	Producing Formation Picture Cliffs	Pool Guadalupe	Dedicated Acreage: 16.0		Acre

1. Outline the acreage dedicated to the subject well by colored pencil or hatchure marks on the plat below.
2. If more than one lease is dedicated to the well, outline each and identify the ownership thereof (both as to working interest and royalty).
3. If more than one lease of different ownership is dedicated to the well, have the interests of all owners been consolidated by communitization, unitization, force-pooling, etc?

☐ Yes ☐ No If answer is "yes," type of consolidation _____

If answer is "no," list the owners and tract descriptions which have actually been consolidated. (Use reverse side of this form if necessary.) _____

No allowable will be assigned to the well until all interests have been consolidated (by communitization, unitization, forced-pooling, or otherwise) or until a non-standard unit, eliminating such interests, has been approved by the Division.

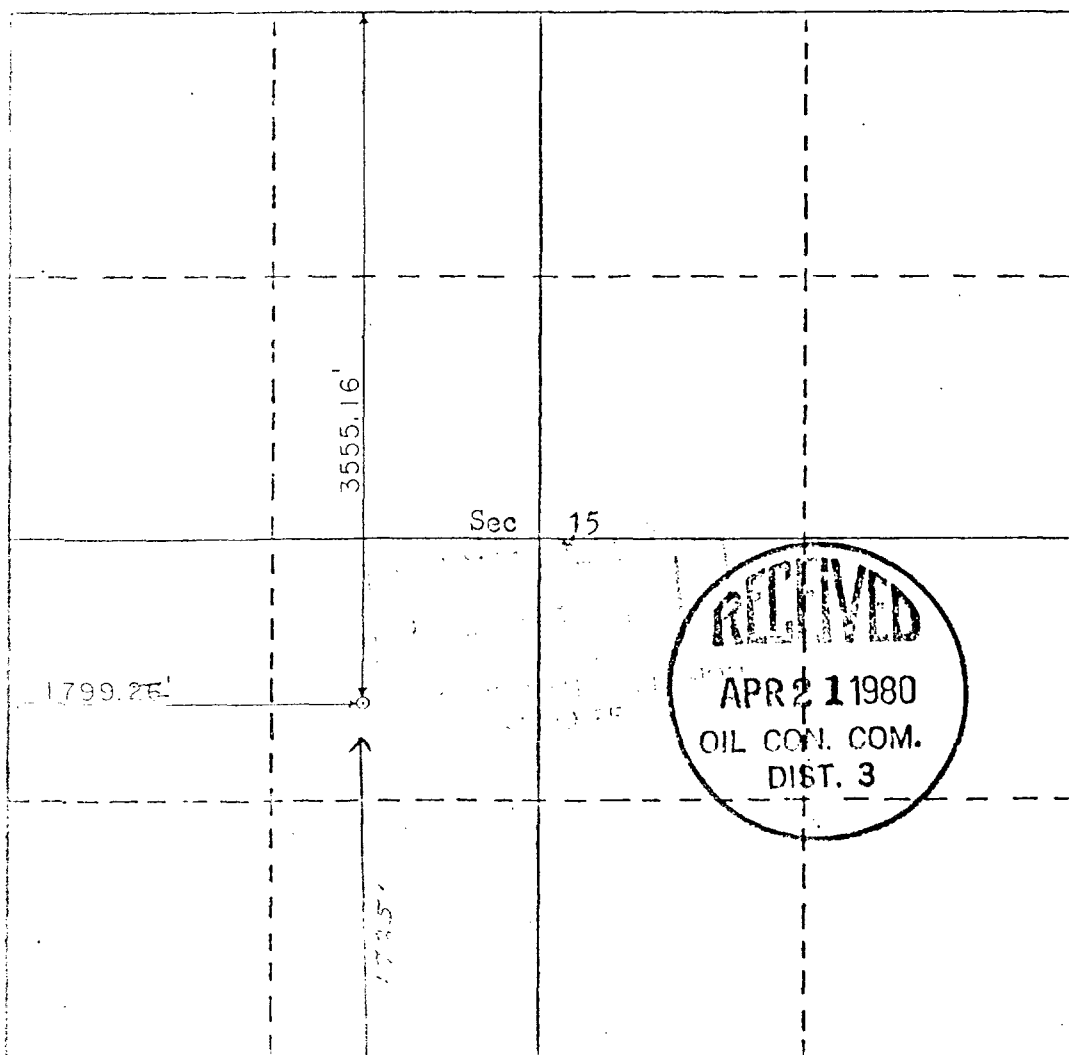

CERTIFICATION

I hereby certify that the information contained herein is true and complete to the best of my knowledge and belief.

E. Alex Phillips

Name **E. Alex Phillips**

Position **President**

Company **NANCO, INC.**

Date **11-15-80**

I hereby certify that the well location shown on this plat was plotted from field notes of actual surveys made by me or under my supervision, and that the same is true and correct to the best of my knowledge and belief.

March 30, 1980

Date Surveyed

Wayne E. Johnston

Registered Professional Engineer
and U.S. Land Surveyor

Wayne E. Johnston

6540

Certificate No.

DISTRIBUTION		
SANTA FE		
FILE		
U.S.G.S.		
LAND OFFICE		
OPERATOR		

NEW MEXICO OIL CONSERVATION COMMISSION
WELL COMPLETION OR RECOMPLETION REPORT AND LOG

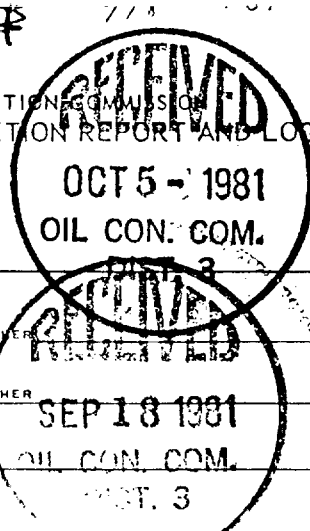

Revised 1-1-65

14. TYPE OF WELL a. TYPE OF COMPLETION NEW WELL <input checked="" type="checkbox"/> WORK OVER <input type="checkbox"/> DEEPEN <input type="checkbox"/> b. TYPE OF COMPLETION OIL WELL <input type="checkbox"/> GAS WELL <input checked="" type="checkbox"/> DRY <input type="checkbox"/> OTHER <input type="checkbox"/> c. Plug Back <input type="checkbox"/> DIFF. RESVR. <input type="checkbox"/>				5a. Indicate Type of Lease. State <input type="checkbox"/> Fee <input checked="" type="checkbox"/> 5. State Oil & Gas Lease No. 7. Unit Agreement Name 8. Farm or Lease Name Locer 9. Well No. #2 10. Field and Pool, or Wildcat Gavilan 12. County Rio Arriba			
2. Name of Operator Nanco, Inc. 3. Address of Operator 611 Philtower Building, Tulsa, OK. 74103 4. Location of Well UNIT LETTER <u>K</u> LOCATED <u>1799.56</u> FEET FROM THE <u>West</u> LINE AND <u>3555.56</u> FEET FROM THE <u>North</u> LINE OF SEC. 15 TWP. 25N RGE. 2W NMPM				11. Date Spudded 4-23-80 15. Date T.D. Reached 5-4-80 17. Date Compl. (Ready to Prod.) 8-20-80 12. Elevations (DF, RKB, RT, GR, etc.) 7311.51 GL 19. Elev. Casinghead 7316.51 20. Total Depth 3648' 21. Plug Back T.D. 3648' 22. If Multiple Completions, How Many 23. Intervals Drilled By Rotary Tools Cable Tools X 24. Producing Interval(s), of this completion - Top, Bottom, Name 25. Was Directional Survey Made Yes Attached hereto 26. Type Electric and Other Log Run Dual Induction-Compensated Neutron-Cement Bond 27. Was Well Cored NO			
28. CASING RECORD (Report all strings set in well)							
CASING SIZE		WEIGHT LB./FT.		DEPTH SET		HOLE SIZE	
8-5/8"		34		100'		10-3/4"	
J-55 4-1/2"		11		3650'		6-3/4"	
29. LINER RECORD							
SIZE		TOP		BOTTOM		SACKS CEMENT	
30. TUBING RECORD							
SIZE		DEPTH SET		PACKER SET			
2-3/8"		3470'		3460'			
31. Perforation Record (Interval, size and number)							
2 shots per foot -3500-3516' -16'-32 holes							
2 shots per foot -3524-3542' -18'-36 holes							
2-3/8" Shot Holes							
32. ACID, SHOT, FRACTURE, CEMENT SQUEEZE, ETC.							
DEPTH INTERVAL				AMOUNT AND KIND MATERIAL USED			
33. PRODUCTION							
Date First Production 8-20-80		Production Method (Flowing, gas lift, pumping - Size and type pump) Flowing Gas EN. Well Completion				Well Status (Prod. or Shut-in) Shut In.	
Date of Test 9-18-80		Hours Tested 3 hours		Coke Size 3/4"		Prod'n. Per Test Period Oil - Bbl. Gas - MCF Water - Bbl. Gas - Oil Ratio 1,550 MCF None	
Flowing Pressure		Casing Pressure		Calculated 24-Hour Rate Oil - Bbl. Gas - MCF Water - Bbl. Oil Gravity - API (Corr.) 1,550 MCF			
34. Disposition of Gas (Sold, used for fuel, vented, etc.) Vented for testing						Test Witnessed By Lynn Alexander Ron Sorrow	
35. List of Attachments E. Logs-Cement Bond Log-Tefteller, Inc. Gas Test - Deviation Test I hereby certify that the information shown on both sides of this form is true and complete to the best of my knowledge and belief.							
SIGNED E. Alex Phillips		TITLE President				DATE 9-10-81	

This form is to be filed with the appropriate District Office of the Commission not later than 30 days after the completion of any newly-drilled or deepened well. It shall be accompanied by one copy of all electrical and resistivity logs run on the well and a summary of all special tests conducted, including drill stem tests. All data reported shall be measured by the true vertical depth of the well. In the case of horizontally drilled wells, true vertical depths shall also be reported. For multiple completions, items 30 through 34 shall be reported for each zone. The form is to be filed in quadruplicate except on state land, where six copies are required. See rule 1145.

INDICATE FORMATION TOPS IN CONFORMANCE WITH GEOGRAPHICAL SECTION OF STATE

Southeastern New Mexico

Northwestern New Mexico

T. Anhy _____	T. Canyon _____	T. Ojo Alamo <u>3180</u>	T. Penn. "B" _____
T. Salt _____	T. Strawn _____	T. Kirtland Fruitland <u>3370</u>	T. Penn. "C" _____
B. Salt _____	T. Atoka _____	T. Pictured Cliffs <u>3460</u>	T. Penn. "D" _____
T. Yates _____	T. Miss _____	T. Cliff House _____	T. Leadville _____
T. 7 Rivers _____	T. Devonian _____	T. Menefee _____	T. Madison _____
T. Queen _____	T. Silurian _____	T. Point Lookout _____	T. Elbert _____
T. Grayburg _____	T. Montoya _____	T. Mancos _____	T. McCracken _____
T. San Andres _____	T. Simpson _____	T. Gallup _____	T. Ignacio Qtzite _____
T. Glorieta _____	T. McKee _____	Base Greenhorn _____	T. Granite _____
T. Paddock _____	T. Ellenburger _____	T. Dakota _____	T. _____
T. Blinobry _____	T. Gr. Wash _____	T. Morrison _____	T. _____
T. Tubb _____	T. Granite _____	T. Todilto _____	T. _____
T. Drinkard _____	T. Delaware Sand _____	T. Entrada _____	T. _____
T. Abo _____	T. Bone Springs _____	T. Wingate _____	T. _____
T. Wolfcamp _____	T. _____	T. Chinde _____	T. _____
T. Penn. _____	T. _____	T. Permian _____	T. _____
T. Cisco (Bough C) _____	T. _____	T. Penn. "A" _____	T. _____

OIL OR GAS SANDS OR ZONES

No. 1, from.....to..... No. 4, from.....to.....
No. 2, from.....to..... No. 5, from.....to.....
No. 3, from.....to..... No. 6, from.....to.....

IMPORTANT WATER SANDS

Include data on rate of water inflow and elevation to which water rose in hole.

No. 1, from.....to.....feet.

No. 2, from.....to.....feet.

No. 3, from.....to.....feet.

No. 4, from.....to.....feet.

FORMATION RECORD (Attach additional sheets if necessary)

From	To	Thickness in Feet	Formation	From	To	Thickness in Feet	Formation
3464	3552	88	Gross Pictured Cliffs Sandstone				

NO. OF COPIES RECEIVED	
DISTRIBUTION	
SANTA FE	
FILE	
U.S.G.S.	
LAND OFFICE	
TRANSPORTER	OIL
	GAS
OPERATOR	
PRODUCTION OFFICE	

NEW MEXICO OIL CONSERVATION COMMISSION

REQUEST FOR ALLOWABLE
AND
AUTHORIZATION TO TRANSPORT OIL AND NATURAL GAS

Form C-104
Supersedes Old C-104 and C-110
Effective 1-1-85

OCT 28 1981

I. Operator

NANCO, INC.

Address

611 PHILTOWER BUILDING, TULSA, OKLAHOMA 74103

Reason(s) for filing (Check proper box) Other (Please explain)

New Well ☒ Change in Transporter of:

Recompletion ☐ Oil ☐ Dry Gas ☐

Change in Ownership ☐ Casinghead Gas ☐ Condensate ☐

If change of ownership give name and address of previous owner

II. DESCRIPTION OF WELL AND LEASE

Lease Name	Well No.	Pool Name, Including Formation	Kind of Lease	Lease No.
LOCER	#2	GAVILAN	State, Federal or Fee Fee	1
Location				
Unit Letter	K	1799.56 Feet From The West	Line and 3555.56 Feet From The North	
Line of Section	15	Township	25 North	Range 2 West, NMPM, Rio Arriba County

III. DESIGNATION OF TRANSPORTER OF OIL AND NATURAL GAS

Name of Authorized Transporter of Oil <input type="checkbox"/> or Condensate <input type="checkbox"/>	Address (Give address to which approved copy of this form is to be sent)
Name of Authorized Transporter of Casinghead Gas <input type="checkbox"/> or Dry Gas <input checked="" type="checkbox"/>	Address (Give address to which approved copy of this form is to be sent)
El Paso Natural Gas Company	PO Box 990, Farmington, New Mexico 87401
If well produces oil or liquids, give location of tanks.	Is gas actually connected? When
	Yes August 18, 1981

If this production is commingled with that from any other lease or pool, give commingling order number:

IV. COMPLETION DATA

Designate Type of Completion - (X)	Oil Well	Gas Well	New Well	Workover	Deepen	Plug Back	Same Res'v.	Diff. Res'v.
Date Spudded	Date Compl. Ready to Prod.	Total Depth	P.B.T.D.					
4-23-80	8-20-80	3668'	3669'					
Elevations (DE, RKB, RI, GR, etc.)	Name of Producing Formation	Top Oil/Gas Pay	Tubing Depth					
7311.51 GR	Pictured Cliffs	3500	3520'					
Perforations	2 shots per foot (32 shots) 3500-3516'	Depth Casing Shoe						
	2 shots per foot (36 shots) 3524-3542'	3648'						
TUBING, CASING, AND CEMENTING RECORD								
HOLE SIZE	CASING & TUBING SIZE	DEPTH SET	SACKS CEMENT					
10-3/4"	8-5/8"	100'	To Surface					
6-3/4"	4-1/2"	3648'	200 sacks					
	2-3/8"	3520'						

V. TEST DATA AND REQUEST FOR ALLOWABLE OIL WELL

(Test must be after recovery of total volume of load oil and must be equal to or exceed top allowable for this depth or be for full 24 hours)

Date First New Oil Run To Tanks	Date of Test	Producing Method (Flow, pump, gas lift, etc.)	
Length of Test	Tubing Pressure	Casing Pressure	Choke Size
Actual Prod. During Test	Oil-Bble.	Water-Bble.	Gas-MCF

GAS WELL

Actual Prod. Test-MCF/D	Length of Test	Bble. Condensate/MMCF	Gravity of Condensate
1,550 MCF	3 Hours	None	No record
Testing Method (pitot, back pr.)	Tubing Pressure (Shut-in)	Casing Pressure (Shut-in)	Choke Size
One Point Back Pressure	580 PSI	964 PSI	3/4" Pos Choke

VI. CERTIFICATE OF COMPLIANCE

I hereby certify that the rules and regulations of the Oil Conservation Commission have been complied with and that the information given above is true and complete to the best of my knowledge and belief.

E. Allen Phillips Jr.
(Signature)
President
(Title)
September 30, 1981
(Date)

OIL CONSERVATION COMMISSION

APPROVED 10-19-81
OCT 19 1981
BY [Signature]
TITLE DEPUTY OIL & GAS INSPECTOR, DIST. #3

This form is to be filed in compliance with RULE 1104.
If this is a request for allowable for a newly drilled or deepened well, this form must be accompanied by a tabulation of the deviation tests taken on the well in accordance with RULE 111.
All sections of this form must be filled out completely for allowable on new and recompleted wells.
Fill out only Sections I, II, III, and VI for changes of owner, well name or number, or transporter, or other such change of condition.
Separate Forms C-104 must be filed for each pool in multiply completed wells.