

UNFILED

**EXXON** COMPANY, U.S.A.

POST OFFICE BOX 1600 • MIDLAND, TEXAS 79702-1600

PRODUCTION DEPARTMENT  
SOUTHWESTERN DIVISION

*Case File -  
Case 9366*

March 24, 1988

New Mexico FF State  
Well No. 1  
Lea County, New Mexico

New Mexico Oil Conservation Commission  
P. O. Box 2088  
Santa Fe, New Mexico 87501

Exxon requests permission to drill the captioned well as an unorthodox location in the Undesignated Shipp-Strawn Pool.

Field Rules for the Shipp Strawn Pool specify that no well be drilled more than 150 feet from the center of a quarter quarter section. This well is staked 990 feet from the South line and 330 feet from the East line of Section 9, T17S, R37E in Lea County.

Exxon's seismic data indicates a Strawn carbonate mound development that can best be accessed from a well at the proposed unorthodox location.

By copy of this letter, offsetting operators and unleased mineral interest owners are notified of our intent to drill this well at an unorthodox location. If you have no objection to this proposal, please sign the attached waivers and mail them in the postage paid envelopes provided.

The list of offset operators notified is attached.

Sincerely

*Charlotte Harper*

Charlotte Harper  
Permits Supervisor

CHH:jjf  
Attachments

New Mexico FF State #1  
Offset Operator's List

I. W. Lovelady  
P. O. Box 2666  
4520 W. Hwy. 80  
Midland, TX 79703

Florida Exploration Company  
c/o Enron Oil and Gas  
P. O. Box 2267  
508 W. Wall, Ste. 1100  
Midland, TX 79701

Securities Fund  
Investors Incorporated  
No. 30 Rockefeller Plaza  
New York, NY 10020

Delta U. S. Corporation  
Attn: Joan Mullenax  
110 N. College  
Tyler, TX 75710-2012

Huron Drilling Corporation  
1700 Broadway, Suite 1122  
Tower Building  
Denver, CO 80202

Petroleum Properties Inc.  
Petroleum Invest. Services Inc  
Freda Jackson & Leon DuCharme  
No. 30 Rockefeller Plaza  
New York, NY 10020

Pennzoil Company  
200 N. Loraine, Ste. 1230  
Briarcroft Building  
Midland, TX 79702

TOG Limited Partnership  
P. O. Box 352  
West Point, CT 06881

Ladd Petroleum Corporation  
370 17th Street, Ste. 1700  
Denver, CO 80202-5617

Kerr-McGee Corporation  
One Marienfeld Place, Ste. 330  
Midland, TX 79701

Segal Oil and Gas Incorporated  
No. 6 Peter Cooper Road  
New York, NY 10010

Barbara Fasken  
303 W. Wall Avenue  
Suite 1901  
Midland, TX 79701-5116

C. Wayne Greenlee  
41 East Illinois  
Suite 401  
Midland, TX 79701

Harry A. Trueblood, Jr.  
Lincoln Twr. Bldg., Ste. 1300  
1860 Lincoln Street  
Denver, CO 80295

Richard S. Brooks  
303 W. Wall Ave.  
Suite 608  
Midland, TX 79701-0608

Charles B. Gillespie  
Charles B. Gillespie, Jr.  
550 W. Texas, Tower 2, Ste. 670  
Midland, TX 79702

John J. O'Shea, Trustee  
Longwood Daniel M. O'Shea, and  
John E. McDermott  
1860 Lincoln Street, Ste. 1100  
Denver, CO 80295

Robert H. Angevine  
3601 Imperial Avenue  
Midland, TX 79703

Sohio Petroleum Company  
9401 Southwest Freeway  
Suite 600  
Houston, TX 77074

John M. Templeton, Jr. and  
John M. Templeton, Jr. as  
Trustee  
P. O. Box 408  
Englewood, NJ 07631

James B. Henry  
3104 Shell Avenue  
Midland, TX 79705

Mesa Operating Ltd. Partnership  
and Mesa Ltd. Partnership  
One Mesa Square  
Amarillo, TX 79189

John M. Templeton, Jr. and  
John M. Templeton, Jr. as  
Trustee  
3309 Lindlewood Crescent  
Chesapeake, VA 23321

Unicon Producing Company  
1 Riverway  
P. O. Box 2120  
Houston, TX 77001

Consolidated Oil and Gas Inc.  
1860 Lincoln Street  
Suite 1100  
Denver, CO 80295

Thomas M. Yett  
901 Sherman Street  
Denver, CO 80206

Union Texas Explor. Corp.  
1330 Post Oak Blvd.  
Houston, TX 77252-2120

Apollo Oil Company  
P. O. Box 278  
Hobbs, NM 88240

Gross Oil Delaware Corporation  
110 East 57th Street  
New York, NY 10019

Exploration Finance Company  
13910 Champion Forrest Dr.,  
Suite 200  
Houston, TX 77060

New Mexico FF State #1  
Offset Operator's List  
(Con't)

Hanley Petroleum, Inc.  
1500 Wilco Building  
Midland, TX 79701

RECEIVED  
MAR 21 1988

WAIVER

Case File

New Mexico Oil Conservation Commission  
P. O. Box 2088  
Santa Fe, New Mexico 87501

This is to advise that the undersigned has been given due notice that Exxon Corporation has made an application for an unorthodox location for the New Mexico FF State Well No. 1 in the Undesignated Shipp-Strawn.

We hereby waive any objection to the granting of this application for the above well which will be located 990 feet FSL and 330 feet FEL of Section 9, T17S, R37E, Lea County, New Mexico.

Executed this 29<sup>th</sup> day of March, 1988.

Company HARRY A. TRUEBLOOD JR

By Harry A Trueblood

SUITE 1100

1860 LINCOLN STREET

DENVER, COLORADO 80245

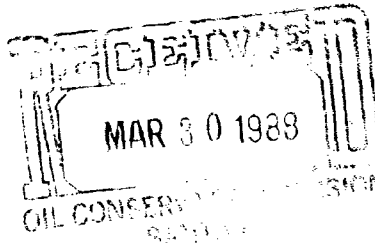

*Case file*

WAIVER

New Mexico Oil Conservation Commission  
P. O. Box 2088  
Santa Fe, New Mexico 87501

This is to advise that the undersigned has been given due notice that Exxon Corporation has made an application for an unorthodox location for the New Mexico FF State Well No. 1 in the Undesignated Shipp-Strawn.

We hereby waive any objection to the granting of this application for the above well which will be located 990 feet FSL and 330 feet FEL of Section 9, T17S, R37E, Lea County, New Mexico.

Executed this 28 day of March, 1988.

Company Consolidated Oil & Gas, Inc

By Floyd E. Ellison

WAIVER

New Mexico Oil Conservation Commission  
P. O. Box 2088  
Santa Fe, New Mexico 87501

This is to advise that the undersigned has been given due notice that Exxon Corporation has made an application for an unorthodox location for the New Mexico FF State Well No. 1 in the Undesignated Shipp-Strawn.

We hereby waive any objection to the granting of this application for the above well which will be located 990 feet FSL and 330 feet FEL of Section 9, T17S, R37E, Lea County, New Mexico.

Executed this 17<sup>th</sup> day of May, 1988.

Company Unicon Producing Co.

By B. J. Hepley

WAIVER

Exxon Corporation  
P. O. Box 1600  
Midland, Texas 79702

Attention Stephen Johnson

This is to advise that the undersigned has been given due notice that Exxon Corporation has made an application for an unorthodox location for the New Mexico FF State Well No. 1 in the Undesignated Shipp-Strawn.

We hereby waive any objection to the granting of this application for the above well which will be located 990 feet FSL and 330 feet FEL of Section 9, T17S, R37E, Lea County, New Mexico.

Executed this 17<sup>th</sup> day of May, 1988.

Company Unicon Producing Co.

By J. J. Lepley

NO. OF COPIES RECEIVED	
DISTRIBUTION	
SANTA FE	
FILE	
U.S.G.S.	
LAND OFFICE	
OPERATOR	

5A. Indicate Type of Lease  
STATE  FEDERAL

5. State Oil & Gas Lease No.  
V-1356

APPLICATION FOR PERMIT TO DRILL, DEEPEN, OR PLUG BACK

1a. Type of Work DRILL <input checked="" type="checkbox"/> DEEPEN <input type="checkbox"/> PLUG BACK <input type="checkbox"/>		7. Unit Agreement Name
b. Type of Well OIL WELL <input checked="" type="checkbox"/> GAS WELL <input type="checkbox"/> OTHER <input type="checkbox"/> SINGLE ZONE <input type="checkbox"/> MULTIPLE ZONE <input type="checkbox"/>		8. Farm or Lease Name New Mexico FF State
2. Name of Operator Exxon Corporation Attn: Permits Supervisor		9. Well No. 1
3. Address of Operator P. O. Box 1600, Midland, TX 79702		10. Field and Pool, or Wildcat Undes. Shipp-Strawn
4. Location of Well UNIT LETTER <u>P</u> LOCATED <u>990</u> FEET FROM THE <u>S</u> LINE AND <u>330</u> FEET FROM THE <u>E</u> LINE OF SEC. <u>9</u> TWP. <u>17S</u> RGE. <u>37E</u> NMPM		17. County Lea
19. Proposed Depth 11,700		19A. Formation Strawn
20. Rotary or C.T. Rotary		
21. Elevations (show whether DL, KI, etc.) 3762 GR	21A. Kind & Status Plug. Bond Blanket	21B. Drilling Contractor Unknown
		22. Approx. Date Work will start June 1, 1988

23. PROPOSED CASING AND CEMENT PROGRAM

SIZE OF HOLE	SIZE OF CASING	WEIGHT PER FOOT	SETTING DEPTH	SACKS OF CEMENT	EST. TOP
17 1/2	13 3/8	54.5	450	500 sx CLC	Surface
12 1/4	9 5/8	40	4400	950 sx CLC	Surface
7 7/8	5 1/2	17, 15.5	TD	1275 sx CLH	3800'

IN ABOVE SPACE DESCRIBE PROPOSED PROGRAM; IF PROPOSAL IS TO DEEPEN OR PLUG BACK, GIVE DATA ON PRESENT PRODUCTIVE ZONE AND PROPOSED NEW PRODUCTIVE ZONE. GIVE BLOWOUT PREVENTER PROGRAM, IF ANY.

I hereby certify that the information above is true and complete to the best of my knowledge and belief.  
Signed Charlotte Harper Title Permits Supervisor Date 3-24-88

(This space for State Use)

APPROVED BY \_\_\_\_\_ TITLE \_\_\_\_\_ DATE \_\_\_\_\_  
CONDITIONS OF APPROVAL, IF ANY:



Operator <b>Exxon Corporation</b>		Lease <b>NEW MEXICO "FF" STATE</b>			Well No. <b>1</b>
Unit Letter <b>P</b>	Section <b>9</b>	Township <b>17S</b>	Range <b>37E</b>	County <b>LEA</b>	
Actual Footage Location of Well: <b>330'</b> feet from the <b>EAST</b> line and <b>990'</b> feet from the <b>SOUTH</b> line					
Ground Level Elev. <b>3762'</b>	Producing Formation <b>STRAWN</b>	Pool <b>UNDESIGNATED SHIPP</b>	Dedicated Acreage: <b>80</b> Acres		

1. Outline the acreage dedicated to the subject well by colored pencil or hachure marks on the plat below.
2. If more than one lease is dedicated to the well, outline each and identify the ownership thereof (both as to working interest and royalty).
3. If more than one lease of different ownership is dedicated to the well, have the interests of all owners been consolidated by communitization, unitization, force-pooling, etc?

Yes  No If answer is "yes," type of consolidation \_\_\_\_\_

If answer is "no," list the owners and tract descriptions which have actually been consolidated. (Use reverse side of this form if necessary.) \_\_\_\_\_

No allowable will be assigned to the well until all interests have been consolidated (by communitization, unitization, forced-pooling, or otherwise) or until a non-standard unit, eliminating such interests, has been approved by the Commission.

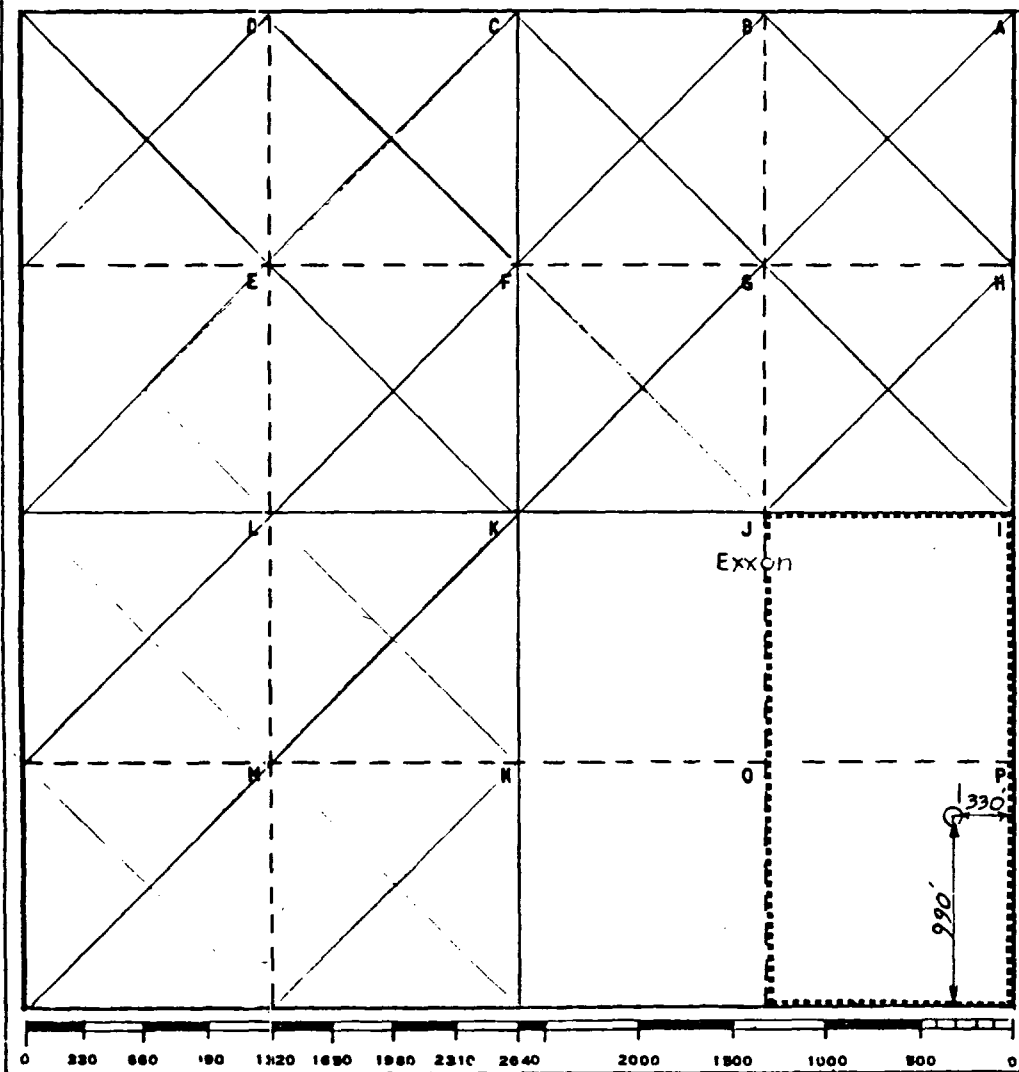

**CERTIFICATION**

I hereby certify that the information contained herein is true and complete to the best of my knowledge and belief.

*Charlotte Harper*

Name **Charlotte Harper**

Position **Permits Supervisor**

Company **Exxon Corporation**  
**Box 1600 Midland, Texas**

Date **3-24-88**

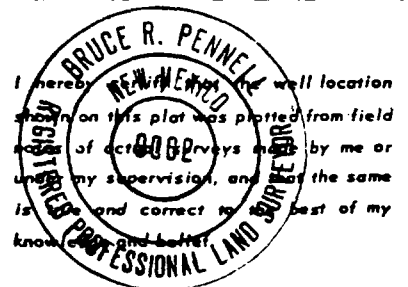

Date Surveyed **3-17-88**

Registered Professional Engineer and/or Land Surveyor

*Bruce R. Pennell*

Certificate No. **#9062**



NAME AND ADDRESS OF SENDER

*Eaton*

Indicate type of mail:  
 Registered  
 Insured  
 C.O.D.  
 Certified  
 Express Mail

Check appropriate block for Registered Mail:  
 With Postal Insurance  
 Without Postal Insurance

Affix stamps here if issued as certificate of mailing or for additional copies of this bill.  
 POSTMARK AND DATE OF RECEIPT

Line	Number of Articles	Name of Addressee, Street, and Post-Office Address	Postage	Fee	Handling Charge (if Reg. Mail)	Insured Value	Due Sender if C.O.D.	R. F. Fee	S. O. Fee	S. M. Fee	Post. Del. Fee	Remarks
1	369145	Barbara Tasker 303 W. Wall Ave	25	.85				.90				
2		Ste 1701 Midland, TX 79701-50										
3	369146	John M Templeton, Jr Trustee	25	.85				.90				
4		P.O. box 408 Englewood, NJ 07031										
5	369147	Richard S Brooks 303 W Wall Ave	25	.85				.90				
6		Ste 608 Midland, TX 79701-6008										
7	369148	Robert H Anguine 3601 Imperial	25	.85				.90				
8		Midland, TX 79703										
9	369149	The Gray Rock Corp. Ste 3000	25	.85				.90				
10		2101 San Jacinto St. Suite 85										
11		Dallas TX 75201										
12	369150	Vaughn Petroleum, Inc.	25	.85				.90				
13		2340 Renaissance Trc Dallas TX 75207										
14	369151	B. L. Estes et al P.O. Box 352	25	.85				.90				
15		Westport, CT 06881										



POSTMASTER PER (Name of receiving employer)  
*[Signature]*

Total Number of Pieces Received at Post Office  
*7*

Total Number of Pieces Listed by Sender  
*7*

Affix stamps here if issued as certificate of mailing or for additional copies of this bill.  
 POSTMARK AND DATE OF RECEIPT

**NAME AND ADDRESS OF SENDER**

**EXXON**

Line	Number of Articles	Name of Addressee, Street, and Post-Office Address	Indicate type of mail			Check appropriate block for Registered Mail:			Affix stamp here if issued as certificate of mailing or for additional copies of this bill.									
			<input type="checkbox"/> Registered	<input type="checkbox"/> Insured	<input type="checkbox"/> COD	<input type="checkbox"/> Certified	<input type="checkbox"/> Express Mail	Postage	Fee	Handling Charge	Act. Value (if regis.)	Insured Value	Due Sender If C.O.D.	R. R. Fee	S. O. Fee	S. H. Fee	Post. Del. Fee	Remarks
1	369152	Bureau of Land Management					<input checked="" type="checkbox"/>											
2		Box 1228 Carlsbad, NM 88520																
3	369153	NM Oil Conservation Division					<input checked="" type="checkbox"/>											
4		811 South First St Artesia, NM																
5	369154	Cherrow USA, Inc 15 Smith Rd																
6		Midland, TX 79705																
7	369155	Hanley Petroleum, Inc																
8		1500 Wilco Building Midland, TX 79701																
9	369156	NM Oil Conservation Division					<input checked="" type="checkbox"/>											
10		P.O. Box 2088 Santa Fe, NM 87501																
11	369157	Arco Oil & Gas Co. P.O. Box 6610																
12		Midland, TX 79702																
13	369158	TX Production Corporation																
14		900 Wilco Bldg. 455 W. Wall St																
15		Midland, TX 79701																
Total Number of Pieces Used by Sender			Total Number of Pieces Received at Post Office			POSTMASTER, PER (Name of receiving employee)												

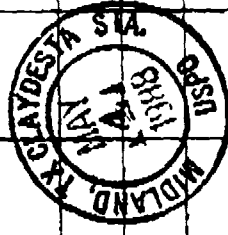

The full declaration of value is required on all domestic and international registered mail. The maximum indemnity payable for nonnegotiable documents under Express Mail document reconstruction insurance is \$50,000 per piece subject to a limit of \$500,000 per occurrence. The maximum indemnity payable on Express Mail merchandise insurance is \$500. The maximum indemnity payable is \$25,000 for Registered Mail, \$500 for COD and \$500 for Insured Mail. Special handling charges apply only to Third- and Fourth-Class parcels. Special delivery service also includes special handling service.



**NAME AND ADDRESS OF SENDER**

**Indicate type of mail**  
 Registered  
 Insured  
 COD  
 Certified  
 Express Mail

**Check appropriate block for Registered Mail:**  
 With Postal Insurance  
 Without Postal Insurance

**AMIA stamp here if issued as certificate of mailing or for additional copies of this bill.**

**POSTMARK AND DATE OF RECEIPT**

Line	Number of Articles	Name of Addressee, Street, and Post-Office Address	Postage	Express Mail Fee	Handling Charge (if Reg.)	Insured Value	Due Sender if C.O.D.	A. R. Fee	S. D. Fee	S. H. Fee	Post. Del. Fee	Remarks
1	369159	Cities Service Oil & Gas Corp. P.O. Box 300 Tulsa, OK 74102		85				90				
2	369160	Exxon Oil & Gas Co. (Hwy) 508 Wall St. Ste 500 Midland TX 79701		85				90				
3	369161	Araco Production Co. Box 3092 Houston, TX 77253 (Paragon sec)		85				90				
4	369162	Reedy Stevens, Inc. Box 1518 314 Security Mall Roswell, NM 87201		85				90				
5	369163	NM Oil Conservation P.O. Box 2088 310 Santa Fe Trail Santa Fe, NM 87504		85				90				
6	369164	Jim Bruce 218 Monterzuma Box 2008 Santa Fe, NM 87504		85				90				
7	369165	Jim Bruce 218 Monterzuma P.O. Box 2008 Santa Fe, NM 87504		85				90				
8												
9												
10												
11												
12												
13												
14												
15												



**Total Number of Pieces Received at Post Office** 7

**POSTMASTER, PER (Name of receiving employee)** [Signature]

The full declaration of value is required on all domestic and international registered mail. The maximum indemnity payable for nonnegotiable documents under Express Mail document reconstruction insurance is \$50,000 per piece subject to a limit of \$500,000 per occurrence. The maximum indemnity payable on Express Mail merchandise insurance is \$500. The maximum indemnity payable is \$25,000 for Registered Mail, \$500 for COD and \$500 for Insured Mail. Special handling charges apply only to Third- and Fourth-Class parcels. Special delivery service also includes special handling service.

NAME AND ADDRESS OF SENDER  
**EXXON**

Indicate type of mail:  
 Registered  
 Insured  
 COD  
 Certified  
 Express Mail

Check appropriate block for Registered Mail:  
 With Postal Insurance  
 Without Postal Insurance

Affix stamp here if issued as certificate of mailing or for additional copies of this bill.  
**POSTMARK AND DATE OF RECEIPT**

Line	Number of Articles	Name of Addressee, Street, and Post-Office Address	Postage	Express Mail Fee	Handling Charge (if Reg.)	Insured Value	R. R. Fee	S. D. Fee	S. H. Fee	Post. Del. Fee	Remarks
1	369166	T. W. Lovelady, Post Office		.85			.90				
2		4520 W. Hwy 80, Midland, TX 79703		.85			.90				
3	369167	Delta U.S. Corp. Attn: Jean Mullendax		.85			.90				
4		110 N. College, Lyles, TX 75710-2012		.85			.90				
5	369168	Pennzoil Co., 200 N. Lorraine		.85			.90				
6		Ste 1230, Midland, TX 79703		.85			.90				
7	369169	Kerr-McGee Corp., P. Marionfeldt		.85			.90				
8		Ste 330, Midland, TX 79701		.75			.90				
9	369170	Chwayne Greenlee, 41 E. Illinois		.85			.90				
10		Ste 401, Midland, TX 79701		.85			.90				
11	369171	Charles B. Gillespie, Ste 670		.85			.90				
12		550 W. Texas, Two #3, Midland, TX 79701		.85			.90				
13	369172	Sohio Petroleum Co., Ste 660		.85			.90				
14		Eller Southwest, Eury, Hastings, TX 70774									
15											



Total Number of Pieces Listed by Sender: 7

Total Number of Pieces Received at Post Office: 7

POSTMASTER, PER (Name of receiving employee): [Signature]

The full declaration of value is required on all domestic and international registered mail. The maximum indemnity payable for nonnegotiable documents under Express Mail domestic reconstruction insurance is \$50,000 per piece subject to a limit of \$500,000 per occurrence. The maximum indemnity payable on Express Mail merchandise insurance is \$500. The maximum indemnity payable is \$25,000 for Registered Mail, \$500 for COD and \$500 for Insured Mail. Special handling charges apply only to Third- and Fourth-Class parcels. Special delivery service also includes special handling service.

U. S. G. P. O. 1936-166-494

FORM MUST BE COMPLETED BY TYPEWRITER, INK OR BALL POINT PEN

**NAME AND ADDRESS OF SENDER**

**EXXON**

List	Number of Articles	Name of Addressee, Street, and Post-Office Address	Indicate type of mail		Check appropriate block for Registered Mail:		Affix stamps here if issued as surcharges or for additional copies of this bill.									
			<input type="checkbox"/> Registered	<input type="checkbox"/> Insured	<input type="checkbox"/> COD	<input checked="" type="checkbox"/> Certified	<input type="checkbox"/> Express Mail	Handling Charge	Act. Value (If Regs.)	Insured Value	Due Sender If C.O.D.	R. R. Fee	S. D. Fee	S. H. Fee	Post. Del. Fee	Remarks
1	369173	Mesa Ltd. Partnership														
2		One Mesa Sq. Amarillo TX 79109														
3	369174	Consolidated Oil & Gas Inc.														
4		1800 Lincoln St. Littleton, CO 80120														
5	369175	Apollo Oil Co. Box 27														
6		Hobbs, NM 88240														
7	369176	Florida Exploration Co. Box 2262														
8		508 W. Wall, Ste. 1100														
9		Midland, TX 79701														
10	<del>369177</del>	Huron Drilling Corp. 100 Broadway														
11		Lower Bldg. Denver, CO 80202														
12	369178	106 Limited Partnership														
13		Box 352 Westpoint, CT 06881														
14	369179	Segal Oil & Gas Inc. 166 Park														
15		Corner Park NY 10010														
Total Number of Pieces Listed by Sender		Total Number of Pieces Received at Post Office		POSTMASTER, PER (Name of receiving employee)		The full declaration of value is required on all domestic and international registered mail. The maximum indemnity payable for non-registered documents under Express Mail document reconstruction insurance is \$50,000 per piece subject to a limit of \$500,000 per occurrence. The maximum indemnity payable on Express Mail merchandise insurance is \$500. The maximum indemnity payable is \$25,000 for Registered Mail, \$500 for COD and \$500 for Insured Mail. Special handling charges apply only to Third- and Fourth-Class parcels. Special delivery service also includes special handling service.										



**NAME AND ADDRESS OF SENDER**

**Indicate type of mail**  
 Registered  
 Insured  
 COD  
 Certified  
 Express Mail

**Check appropriate block for Registered Mail:**  
 With Postal Insurance  
 Without Postal Insurance

**AFR stamp here if issued as certificate of mailing of tax additional copies of this bill.**  
**POSTMARK AND DATE OF RECEIPT**

Line	Number of Articles	Name of Addressee, Street, and Post-Office Address	Postage	Fee	Handling Charge	Insured Value (if Registered)	Due Sender (if C.O.D.)	R. R. Fee	S. D. Fee	S. H. Fee	Remarks
1	369180	Harry A Innebbold Sr Ste 1300		85				90			
2		1860 Lincoln St Denver Co 80205		85				90			
3	369181	Securities Trust Investors Inc		85				90			
4		No 30 Rockefeller Plz N.Y. N.Y. 10020		85				90			
5	369182	John E. Mejerovich 1810 Lincoln St		85				90			
6		Ste 100 Denver, Co 80205		85				90			
7	369183	Gross Oil Delaware Corp.		85				90			
8		110 East 57th St N.Y. N.Y. 10019		85				90			
9	369184	Thomas M. Yell 901 Sherman St		85				90			
10		Denver, Co 80206		85				90			
11	369185	Exploration Finance Company		85				90			
12		1390 Champion Forest Dr Ste 200		85				90			
13		Houston, TX 77028		85				90			
14	369186	Union Texas Exp Inc Corp.		85				90			
15		1330 1st Oak Blvd Houston, TX 77020		85				90			

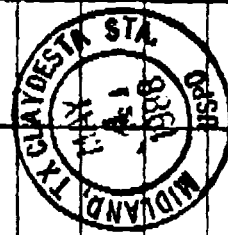

**Total Number of Pieces Listed by Sender** POSTMASTER, PER (Number of receiving employee)

**Total Number of Pieces Received at Post Office** 7

The full declaration of value is required on all domestic and international registered mail. The maximum indemnity payable for nonnegotiable documents under Express Mail does not exceed \$50,000 per piece subject to a limit of \$500,000 per occurrence. The maximum indemnity payable on Express Mail merchandise insurance is \$500. The maximum indemnity payable is \$25,000 for Registered Mail \$500 for COD and \$500 for Insured Mail. Special handling charges apply only to Third- and Fourth-Class parcels. Special delivery service also includes special handling service.

**NAME AND ADDRESS OF SENDER**

**Exxon**

Indicate type of mail:  
 Registered  
 Insured  
 C.O.D.  
 Certified

Name of Addressee, Street, and Post-Office Address

1 **369187** Freda Jackson & Leon DuCharme  
 #30 Rocker Sella Plz Ny Ny 10000  
 2 **369188** Union Producing Co. Riverway  
 Box 2120 Houston, TX 77001  
 3 **369189** Cadco Petroleum Corp 564700  
 370 17th St Denver, Co 80202  
 4 **369190** James B. Henry 3104 Skull Ave  
 Midland, TX 79705  
 5 **369191** John M. Kempelowski  
 3309 Lindwood Crescent  
 Chesapeake, VA 23321  
 6 **369192** Landover Corp Box 3728  
 Midland, TX 79702  
 7 **369193** Attn: William L. Holmes

Number of Article

1 55  
 2 85  
 3 85  
 4 85  
 5 85  
 6 85  
 7 85  
 8 85  
 9 85  
 10 85  
 11 85  
 12 85  
 13 85  
 14 85  
 15 85

Check appropriate block for Registered Mail:  
 With Postal Insurance  
 Without Postal Insurance

Handling Charge

Act. Value (if Reg.)

Insured Value

Postage

Fee

Express Mail

Postage

Affix stamp here if issued as certificate of mailing or for additional copies of this bill.

POSTMARK AND DATE OF RECEIPT

Due Sender if C.O.D.

R. R. S. D. Fee

S. H. Fee

Post. Del. Fee

90  
 90  
 90  
 90  
 90  
 90  
 90  
 90  
 90  
 90  
 90  
 90  
 90  
 90



Total Number of Pieces Listed by Sender: 6

Total Number of Pieces Received at Post Office: 6

POSTMASTER, PER (Name of receiving employee): *[Signature]*

The full declaration of value is required on all domestic and international registered mail. The maximum indemnity payable for negotiable documents under Express Mail does not exceed \$50,000 per piece subject to a limit of \$500,000 per occurrence. The maximum indemnity payable on Express Mail merchandise insurance is \$500. The maximum indemnity payable is \$25,000 for Registered Mail, \$500 for COD and \$500 for Insured Mail. Special handling charges apply only to Third- and Fourth-Class parcels. Special delivery service also includes special handling service.

FORM MUST BE COMPLETED BY TYPEWRITER, INK OR BALL POINT PEN

U. S. G. P. O. 1986-166-4



7/19/88

WAIVER

Case 9366

New Mexico Oil Conservation Commission  
P. O. Box 2088  
Santa Fe, New Mexico 87501

This is to advise that the undersigned has been given due notice that Exxon Corporation has made an application for an unorthodox location for the New Mexico FF State Well No. 1 in the Undesignated Shipp-Strawn.

We hereby waive any objection to the granting of this application for the above well which will be located 990 feet FSL and 330 feet FEL of Section 9, T17S, R37E, Lea County, New Mexico.

Executed this 19th day of April, 1988.

Company STANDARD OIL PRODUCTION COMPANY

By

Art Ensley 4/19/88

Art Ensley  
District Landman

APR - 1 1988

WAIVER

New Mexico Oil Conservation Commission  
P. O. Box 2088  
Santa Fe, New Mexico 87501

This is to advise that the undersigned has been given due notice that Exxon Corporation has made an application for an unorthodox location for the New Mexico FF State Well No. 1 in the Undesignated Shipp-Strawn.

We hereby waive any objection to the granting of this application for the above well which will be located 990 feet FSL and 330 feet FEL of Section 9, T17S, R37E, Lea County, New Mexico.

Executed this 28<sup>th</sup> day of March, 1988.

Company James B. Henry  
By James B. Henry

APR - 1 1988

WAIVER

New Mexico Oil Conservation Commission  
P. O. Box 2088  
Santa Fe, New Mexico 87501

This is to advise that the undersigned has been given due notice that Exxon Corporation has made an application for an unorthodox location for the New Mexico FF State Well No. 1 in the Undesignated Shipp-Strawn.

We hereby waive any objection to the granting of this application for the above well which will be located 990 feet FSL and 330 feet FEL of Section 9, T17S, R37E, Lea County, New Mexico.

Executed this 28<sup>th</sup> day of March, 1988.

Company

Robert H. Angwine

By \_\_\_\_\_

APR - 1 1988

WAIVER

Exxon Corporation  
P. O. Box 1600  
Midland, Texas 79702

Attention Stephen Johnson

This is to advise that the undersigned has been given due notice that Exxon Corporation has made an application for an unorthodox location for the New Mexico FF State Well No. 1 in the Undesignated Shipp-Strawn.

We hereby waive any objection to the granting of this application for the above well which will be located 990 feet FSL and 330 feet FEL of Section 9, T17S, R37E, Lea County, New Mexico.

Executed this 29th day of March, 1988.

Company Richard S. Brooks

By Richard S. Brooks

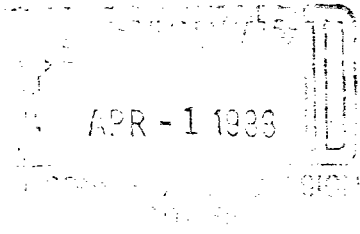

WAIVER

New Mexico Oil Conservation Commission  
P. O. Box 2088  
Santa Fe, New Mexico 87501

This is to advise that the undersigned has been given due notice that Exxon Corporation has made an application for an unorthodox location for the New Mexico FF State Well No. 1 in the Undesignated Shipp-Strawn.

We hereby waive any objection to the granting of this application for the above well which will be located 990 feet FSL and 330 feet FEL of Section 9, T17S, R37E, Lea County, New Mexico.

Executed this 29<sup>th</sup> day of March, 1988.

Company Barbara Fackler

By Robert H. Angewine

APR - 1 1988

WAIVER

New Mexico Oil Conservation Commission  
P. O. Box 2088  
Santa Fe, New Mexico 87501

This is to advise that the undersigned has been given due notice that Exxon Corporation has made an application for an unorthodox location for the New Mexico FF State Well No. 1 in the Undesignated Shipp-Strawn.

We hereby waive any objection to the granting of this application for the above well which will be located 990 feet FSL and 330 feet FEL of Section 9, T17S, R37E, Lea County, New Mexico.

Executed this 29th day of March, 1988.

Company C. Wayne Greenie

By v

Case 9366

WAIVER

New Mexico Oil Conservation Commission  
P. O. Box 2088  
Santa Fe, New Mexico 87501

This is to advise that the undersigned has been given due notice that Exxon Corporation has made an application for an unorthodox location for the New Mexico FF State Well No. 1 in the Undesignated Shipp-Strawn.

We hereby waive any objection to the granting of this application for the above well which will be located 990 feet FSL and 330 feet FEL of Section 9, T17S, R37E, Lea County, New Mexico.

Executed this 11 day of April, 1988.

Company CHARLES B. GILLESPIE, JR.

By William R. Crow

Case 9366

WAIVER

New Mexico Oil Conservation Commission  
P. O. Box 2088  
Santa Fe, New Mexico 87501

This is to advise that the undersigned has been given due notice that Exxon Corporation has made an application for an unorthodox location for the New Mexico FF State Well No. 1 in the Undesignated Shipp-Strawn.

We hereby waive any objection to the granting of this application for the above well which will be located 990 feet FSL and 330 feet FEL of Section 9, T17S, R37E, Lea County, New Mexico.

Executed this 8th day of April, 1988.

Company Apollo Oil Company

By *Alan W. Ricketts*



Case 9366

WAIVER

New Mexico Oil Conservation Commission  
P. O. Box 2088  
Santa Fe, New Mexico 87501

This is to advise that the undersigned has been given due notice that Exxon Corporation has made an application for an unorthodox location for the New Mexico FF State Well No. 1 in the Undesignated Shipp-Strawn.

We hereby waive any objection to the granting of this application for the above well which will be located 990 feet FSL and 330 feet FEL of Section 9, T17S, R37E, Lea County, New Mexico.

Executed this 10<sup>th</sup> day of April, 1988.

Company GROSS OIL (DELAWARE) CORP

By Pete D. Sean

Case 9366

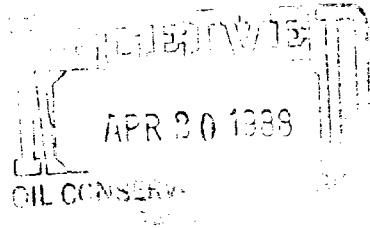

WAIVER

New Mexico Oil Conservation Commission  
P. O. Box 2088  
Santa Fe, New Mexico 87501

This is to advise that the undersigned has been given due notice that Exxon Corporation has made an application for an unorthodox location for the New Mexico FF State Well No. 1 in the Undesignated Shipp-Strawn.

We hereby waive any objection to the granting of this application for the above well which will be located 990 feet FSL and 330 feet FEL of Section 9, T17S, R37E, Lea County, New Mexico.

Executed this 11<sup>th</sup> day of April, 1988.

Company ENRON O&G

By B. H. Morrison *and*

B. H. MORRISON, Agent and Attorney-in-Fact