

NO. OF COPIES RECEIVED	
DISTRIBUTION	
SANTA FE	
FILE	
U.S.G.S.	
LAND OFFICE	
OPERATOR	

5A. Indicate Type of Lease  
STATE  FEE

5. State Oil & Gas Lease No.  
VB - 0155

APPLICATION FOR PERMIT TO DRILL, DEEPEN, OR PLUG BACK

1a. Type of Work  
DRILL  DEEPEN  PLUG BACK

b. Type of Well  
OIL WELL  GAS WELL  OTHER  SINGLE ZONE  MULTIPLE ZONE

2. Name of Operator  
Sohio Petroleum Company

3. Address of Operator  
P. O. Box 4587, Houston, TX 77210

4. Location of Well  
UNIT LETTER \_\_\_\_\_ LOCATED 1060 FEET FROM THE East LINE  
AND 1300 FEET FROM THE North LINE OF SEC. 36 TWP. 16S R. 37E NMPM

7. Unit Agreement Name  
8. Farm or Lease Name  
State 36

9. Well No.  
2

10. Field and Pool, or Wildcat  
Shipp-Strawn

12. County  
Lea

19. Proposed Depth  
12300'

19A. Formation  
Strawn

20. Rotary or C.T.  
Rotary

21. Elevations (Show whether D.F., K.T., etc.)  
3748.4 GL

21A. Kind & Status Plug. bond  
Blanket

21B. Drilling Contractor  
To Be Announced

22. Approx. Date Work will start  
July 1, 1988

23.

PROPOSED CASING AND CEMENT PROGRAM

SIZE OF HOLE	SIZE OF CASING	WEIGHT PER FOOT	SETTING DEPTH	SACKS OF CEMENT	EST. TOP
17½"	13-3/8"	48	400'	350'	Surface
11"	8-5/8"	24#	4500'	1450'	Surface
7-7/8"	5½"	17#	12300'	300'	10500'

The proposal is to drill to 400' and set and cement 13-3/8" surface casing as outlined above. A 2-Ram, Annular BOP stack will be nipped up and tested initially and every 30 days thereafter is required. 11" hole will be drilled to 4500' and 8-5/8" casing set across the salt. 7-7/8" hole will be drilled to total depth. The objective is to test the Strawn reservoir (est. top @ 11,627') and stimulate as necessary. One DST is proposed in the Lower Strawn.

BEFORE EXAMINER CATANACH  
OIL CONSERVATION DIVISION  
STANDARD EXHIBIT NO. 7  
CASE NO. 9386

IN ABOVE SPACE DESCRIBE PROPOSED PROGRAM; IF PROPOSAL IS TO DEEPEN OR PLUG BACK, GIVE DATA ON PRESENT PRODUCTIVE ZONE AND PROPOSED NEW PRODUCTIVE ZONE. GIVE BLOWOUT PREVENTER PROGRAM, IF ANY.

I hereby certify that the information above is true and complete to the best of my knowledge and belief.

Signed T.C. Corney Title Sr. Permit Agent Date 5-25-88  
(This space for State Use)

APPROVED BY \_\_\_\_\_ TITLE \_\_\_\_\_ DATE \_\_\_\_\_  
CONDITIONS OF APPROVAL, IF ANY:

**NEW MEXICO OIL CONSERVATION COMMISSION  
WELL LOCATION AND ACREAGE DEDICATION PLAT**

Form C-102  
Supersedes C-128  
Effective 1-1-65

All distances must be from the outer boundaries of the Section.

Operator <b>SOHIO PETROLEUM CO.</b>		Lease <b>STATE 36</b>		Well No. <b>2</b>
Unit Letter <b>A</b>	Section <b>36</b>	Township <b>16 South</b>	Range <b>37 East</b>	County <b>Lea</b>
Actual Footage Location of Well: <b>1300</b> feet from the <b>north</b> line and <b>1060</b> feet from the <b>east</b> line				
Ground Level Elev. <b>3748.4</b>	Producing Formation <b>Strawn</b>	Pool <b>Shipp - Strawn</b>	Dedicated Acreage:  Acres	

1. Outline the acreage dedicated to the subject well by colored pencil or hachure marks on the plat below.
2. If more than one lease is dedicated to the well, outline each and identify the ownership thereof (both as to working interest and royalty).
3. If more than one lease of different ownership is dedicated to the well, have the interests of all owners been consolidated by communitization, unitization, force-pooling, etc?

Yes    No   If answer is "yes," type of consolidation \_\_\_\_\_

If answer is "no," list the owners and tract descriptions which have actually been consolidated. (Use reverse side of this form if necessary.) \_\_\_\_\_

No allowable will be assigned to the well until all interests have been consolidated (by communitization, unitization, forced-pooling, or otherwise) or until a non-standard unit, eliminating such interests, has been approved by the Commission.

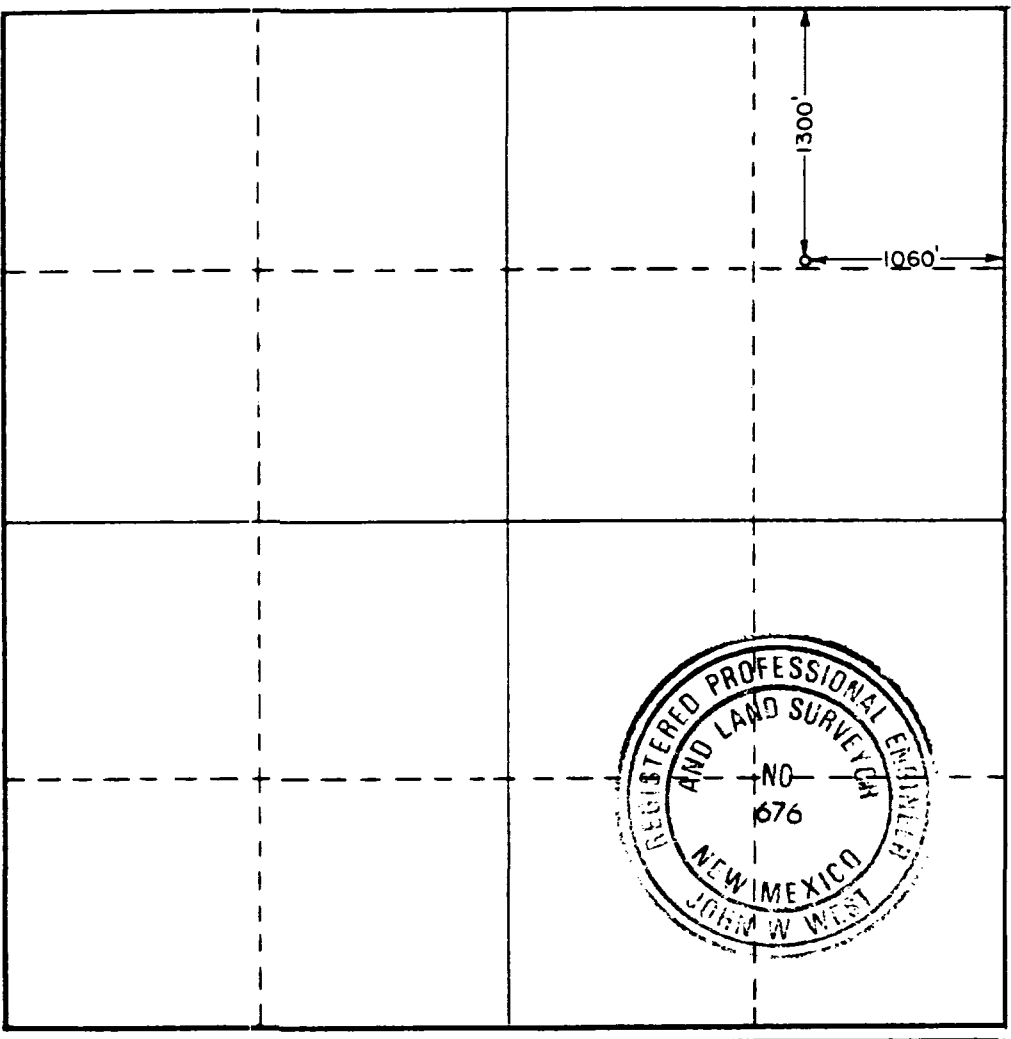

**CERTIFICATION**

*I hereby certify that the information contained herein is true and complete to the best of my knowledge and belief.*

Name  
**T. C. Romney**

Position  
**Sr. Permit Agent**

Company  
**Sohio Petroleum Company**

Date  
**5-25-88**

*I hereby certify that the well location shown on this plat was plotted from field notes of actual surveys made by me or under my supervision, and that the same is true and correct to the best of my knowledge and belief.*

Date Surveyed  
**April 23, 1988**

Registered Professional Engineer and/or Land Surveyor

*John W. West*

Certificate No. **JOHN W. WEST, 676**  
**RONALD J. EIDSON, 3239**

