

NEW MEXICO OIL CONSERVATION COMMISSION
WELL LOCATION AND ACREAGE DEDICATION PLAT

Supersedes C-12
Effective 11-65

All distances must be from the outer boundaries of the Section.

Operator HORIZON OIL & GAS CO.			Lease Anderson		Well No. 1
Unit Letter 0	Section 8	Township 20-S	Range 37-E	County Lea	
Actual Footage Location of Well: 330 feet from the South line and 1980 feet from the East line					
Ground Level Elev. 3538	Producing Formation Blindry Paddock Tubbs		Pool Monument	Dedicated Acreage: 40 Acres	

1. Outline the acreage dedicated to the subject well by colored pencil or hatchure marks on the plat below.
2. If more than one lease is dedicated to the well, outline each and identify the ownership thereof (both as to working interest and royalty).
Only one lease involved
3. If more than one lease of different ownership is dedicated to the well, have the interests of all owners been consolidated by communitization, unitization, force-pooling, etc?
Not applicable

☐ Yes ☐ No If answer is "yes," type of consolidation _____

If answer is "no," list the owners and tract descriptions which have actually been consolidated. (Use reverse side of this form if necessary.) _____

No allowable will be assigned to the well until all interests have been consolidated (by communitization, unitization, forced-pooling, or otherwise) or until a non-standard eliminating such interests, has been approved by the Commission.

BEFORE EXAMINER STOOBER
Oil Conservation Division
Horizon District No. 2
Case No. 9424

TOPOGRAPHY: Natural Pasture, Flat; Pwr. Ln. 140' West of Loc.

DISTANCE & DIRECTION: From Jct. of Hwy 8 & Hwy 322, in Monument, Go South 3.0 mi. on Hwy 8 to the SE Sec. 8, Thence West on Lease Rd. 0.4 mi. to Location.

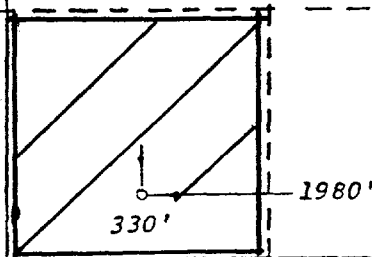

CERTIFICATION

I hereby certify that the information contained herein is true and complete to the best of my knowledge and belief.

Name
Curtis F. Covington

Position
Engineer

Company
Horizon Oil & Gas Co.

Date
6-23-87

I hereby certify that the well location shown on this plat is based on field notes of actual surveys made by me or under my supervision, and that same is true and correct to the best of my knowledge and belief.

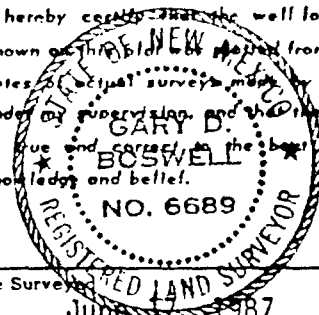

Date Surveyed
June 1987

Registered Professional Engineer and/or Land Surveyor

Gary D. Boswell
Certificate No. **6689**

0 330 660 990 1320 1650 1980 2310 2640 2970 3300 3630 3960 4290 4620 4950 5280 5610 5940 6270 6600 6930 7260 7590 7920 8250 8580 8910 9240 9570 9900 0