

NEW MEXICO OIL CONSERVATION COMMISSION  
WELL LOCATION AND ACREAGE DEDICATION PLAT

Form C-102  
Supersedes C-128  
Effective 1-1-65

All distances must be from the outer boundaries of the Section.

Operator Union Pacific Resources Co.		Lease State 26		Well No. 2
Unit Letter J	Section 26	Township 10 South	Range 33 East	County Lea
Actual Footage Location of Well: 1910 feet from the South line and 1980 feet from the East line				
Ground Level Elev. 4199.0	Producing Formation	Pool	Dedicated Acreage: Acres	

1. Outline the acreage dedicated to the subject well by colored pencil or hachure marks on the plat below.
2. If more than one lease is dedicated to the well, outline each and identify the ownership thereof (both as to working interest and royalty).
3. If more than one lease of different ownership is dedicated to the well, have the interests of all owners been consolidated by communitization, unitization, force-pooling, etc?

Yes  No If answer is "yes," type of consolidation \_\_\_\_\_

If answer is "no," list the owners and tract descriptions which have actually been consolidated. (Use reverse side of this form if necessary.) \_\_\_\_\_

No allowable will be assigned to the well until all interests have been consolidated (by communitization, unitization, forced-pooling, or otherwise) or until a non-standard unit, eliminating such interests, has been approved by the Commission.

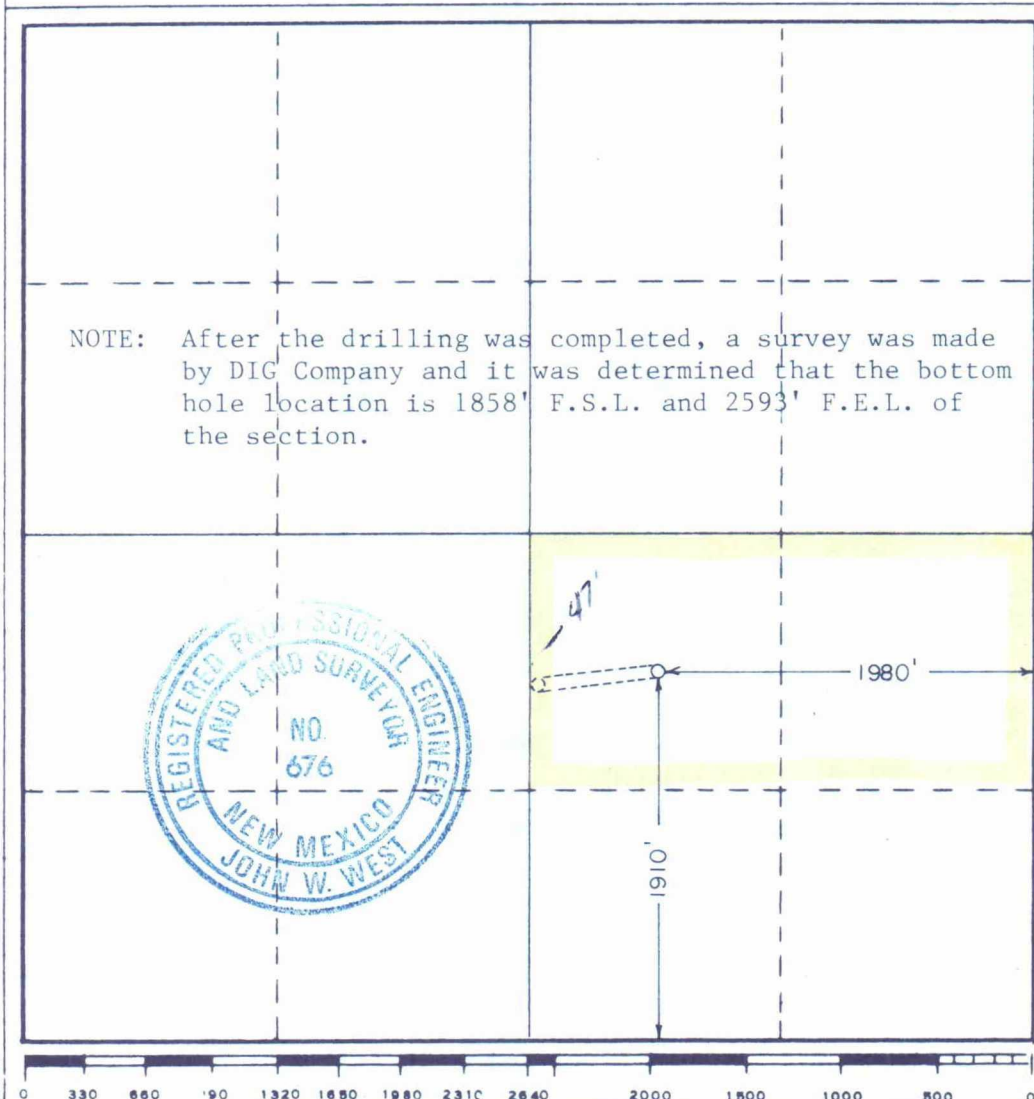

CERTIFICATION

I hereby certify that the information contained herein is true and complete to the best of my knowledge and belief.

Name \_\_\_\_\_  
Position \_\_\_\_\_  
Company  
**UNION PACIFIC RESOURCES**  
Date  
**EXHIBIT NO. 4**  
**DOCKET NO. 9439-9440**  
**DATE 8-17-88**

I hereby certify that the well location shown on this plat was plotted from field notes of actual surveys made by me or under my supervision, and that the same is true and correct to the best of my knowledge and belief.

Date Surveyed  
August 15, 1988  
Registered Professional Engineer  
and/or Land Surveyor  
*John W. West*  
Certificate No. JOHN W. WEST, 676  
RONALD J. EIDSON, 3239

Deviation Angles  
Vada (Devonian) Pool  
Lea County, New Mexico

Approximate Depth	26 - 1	26 - 2 Straight	26 - 2 Side-Track
500	0.75	0.00	0.00
1,000	1.00	0.90	0.90
1,500	0.75	1.00	1.00
2,000		0.20	0.20
2,500	0.25	0.30	0.30
3,000		0.90	0.90
3,500	1.25	0.40	0.40
4,000	0.75	0.20	0.20
4,500		0.25	0.25
5,000	0.25	0.75	0.75
5,500		1.00	1.00
6,000	0.75	1.00	1.00
6,500	0.75	1.25	1.25
7,000		1.25	1.25
7,500	1.00	1.25	1.25
8,000	1.00	1.00	1.00
8,500	1.00	1.50	1.50
9,000		1.00	1.00
9,500	1.00	1.25	1.25
10,000		1.50	5.75
10,500	1.25	2.25	10.00
11,000	1.75	3.25	9.50
11,500	3.25	3.75	9.75
12,000	5.00	3.00	12.75
12,500	6.00	4.50	15.00
TD	7.25	3.50	14.75

*Antibank  
deviation*

UNION PACIFIC RESOURCES  
EXHIBIT NO. 5  
DOCKET NO. 9439 & 9440  
DATE 8-17-88

RECEIVED  
FEB 02 1968

PRODUCTION DEPARTMENT

Deviation surveys taken on Wolverine Exploration's UPRC State 24-26  
#1 well in Lea County, New Mexico:

<u>Depth</u>	<u>Degree</u>
468	.75
1333	1.00
163-	.75
2582	.25
3568	1.25
4153	.75
5109	.25
6102	.75
6497	.75
7453	1.00
8070	1.00
8716	1.00
9699	1.00
10,638	1.25
10,864	1.75
11,485	2.25
11,591	3.25
11,645	3.25
11,688	4.25
11,721	4.00
11,820	4.25
11,895	4.25
11,976	4.75
12,067	5.00
12,159	5.50
12,254	6.00
12,302	5.50
12,385	5.50
12,483	6.00
12,656	6.75
12,698	7.00
12,800	7.25

I hereby certify that I have personal knowledge of the facts placed  
on this sheet and that such information given above is true and complete.

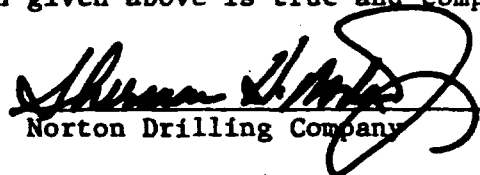
  
Norton Drilling Company

Before me, the undersigned authority, on this day personally appeared  
Sherman H. Norton, Jr., known to me to be the person whose name is  
subscribed hereto, who, after being duly sworn, on oath states that he

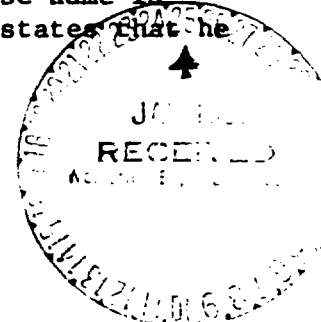

# UNION PACIFIC RESOURCES

WELL # :  
STATE NO. 20-2 *Straight Hole*

LOCATION :  
LEA COUNTY, NEW MEXICO

DATE :  
8/26/88

JOB TYPE :  
GYRO, MULTISHOT

JOB # :  
09-2087

SURVEYOR :  
MASSEY, HENRIK

DEPTHS :  
0 - 4200. 4200 - 12887

DECL. :  
10 DEGREES EAST

ELEV. :  
0'

FILE # :  
VT-MK7

\*\*\*\*\*

FINAL STATION DATA

MD. 12887.00  
TVD. 12881.31  
N/S -197.23  
E/W -191.18

CLOSURE DISTANCE  
235.33 FEET  
CLOSURE DIRECTION  
S 54.33 W

1 IN. = 50 FT.

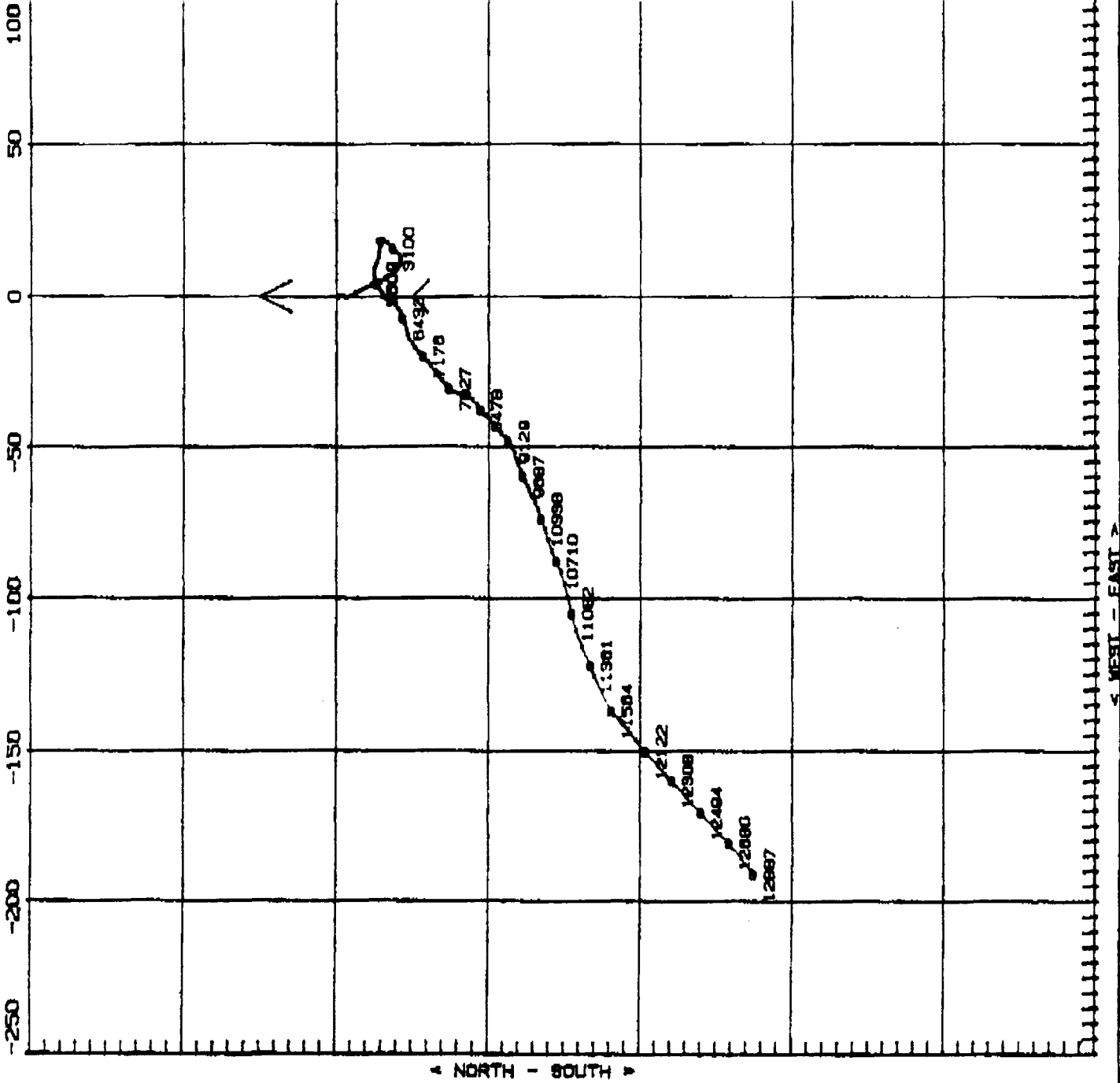

CUSTOMER : UNION PACIFIC RESOURCES

WELL # : STATE NO.26-2

LOCATION : LEA COUNTY, NEW MEXICO

DATE : 6/26/88

JOB TYPE : GYRO, MULTISHOT

JOB # : GS-2087

SURVEYOR : MASSEY, HENDRIX

DEPTHS : 0 - 4200, 4200 - 12887

DECL. : 10 DEGREES EAST

ELEV. : 0'

FILE # : WT-KK7

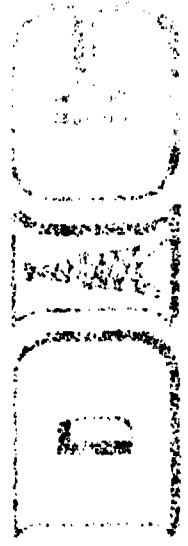

METHOD : RADIUS OF CURVATURE

SECTION : 0

FINAL STATION DATA!

THIS SURVEY IS CORRECT TO THE  
BEST OF MY KNOWLEDGE AND IS  
SUPPORTED BY ACTUAL FIELD DATA.

DIG REPRESENTATIVE

MEASURED	INCL.	HOLE	COURSE	VERTICAL	TRUE	RECTANGULAR	CL	OS	UR	E	DOG-LEG
DEPTH	ANGLE	DIRECTION	LENGTH	DEPTH		COORDINATES	DISTANCE	DIRECTION	SEVERITY		
FEET	DEGS.	DEGS.	FEET	FEET	N/S	feet E/W	FEET	DEGS.			9G/100FT
12887.00	3.50	S 52.00 W	21.00	12881.31		137.23 S	191.18 W	235.33'	S 54.33 W		1.46

UNION PACIFIC RESOURCES  
STATE NO. 26-2  
WT-KK7

PAGE 1  
03:47:24  
00/08/00

MEASURED	INCL.	HOLE	COURSE	VERTICAL	RED TANGULAR	C L O S U R E	DOG-LEG
DEPTH	ANGLE	DIRECTION	LENGTH	DEPTH	COG DI N A T E S	DISTANCE	SEVERITY
FEET	DEGS.	DEGS.	FEET	FEET	N/S FEET E/W	FEET	DEGS.
				TRUE			
0.00	0.00	S 01.00 E	0.00	0.00	0.00 N	0.00	N 00.00 E
100.00	.20	S 01.00 E	100.00	100.00	.17 S	.17	S 01.00 E
200.00	.30	S 22.00 E	100.00	200.00	.60 S	.61	S 08.49 E
300.00	.20	S 15.00 E	100.00	300.00	1.01 S	1.04	S 12.68 E
400.00	.30	S 01.00 E	100.00	400.00	1.44 S	1.47	S 11.30 E
500.00	0.00	S * * * * *	100.00	500.00	1.71 S	1.73	S 09.75 E
600.00	.10	S 26.00 E	100.00	600.00	1.78 S	1.81	S 10.52 E
700.00	.20	S 33.00 W	100.00	700.00	2.03 S	2.06	S 08.83 E
800.00	.30	S 35.00 W	100.00	800.00	2.40 S	2.40	S 01.72 E
900.00	.80	S 17.00 E	100.00	899.99	5.31 S	3.31	S 01.26 W
1000.00	.90	S 39.00 E	100.00	999.98	4.61 S	4.66	S 07.64 E
1100.00	.80	S 17.00 E	100.00	1099.97	5.92 S	6.06	S 12.50 E
1200.00	.90	S 27.00 E	100.00	1199.96	7.29 S	7.52	S 14.36 E
1300.00	.70	S 35.00 E	100.00	1299.95	8.49 S	8.87	S 16.94 E
1400.00	.70	S 09.00 E	100.00	1399.94	9.81 S	10.38	S 17.55 E
1500.00	1.00	S 27.00 E	100.00	1499.93	11.01 S	11.55	S 17.61 E
1600.00	1.00	S 08.00 E	100.00	1599.91	12.67 S	13.29	S 17.59 E
1700.00	1.00	S 37.00 E	100.00	1699.90	14.27 S	15.01	S 18.16 E
1800.00	.80	S 29.00 E	100.00	1799.89	15.58 S	16.53	S 19.55 E
1900.00	.80	S 37.00 E	100.00	1899.88	16.75 S	17.89	S 20.59 E
2000.00	.20	S 21.00 E	100.00	1999.87	17.51 S	18.76	S 20.98 E
2100.00	.70	S 38.00 E	100.00	2099.87	18.19 S	19.53	S 21.32 E
2200.00	.50	S 59.00 E	100.00	2199.86	18.89 S	20.46	S 22.65 E
2300.00	.80	S 40.00 E	100.00	2299.86	19.62 S	21.48	S 24.01 E
2400.00	.80	S 69.00 E	100.00	2399.85	20.42 S	22.68	S 25.78 E

UNION PACIFIC RESOURCES  
 STATE NO. 26-2  
 WT-KK7

PAGE 2  
 03:48:20  
 00/00/00

MEASURED	INCL.	HOLE	DIRECTION	COURSE	VERTICAL	TRUE	REGULAR	C L J S U R E	DUG-LEG	
DEPTH	ANGLE	DIRECTION	DEGS.	LENGTH	DEPTH	FEET	COORDINATES	DISTANCE	SEVERITY	
FEET	DEGS.	DEGS.	DEGS.	FEET	FEET	FEET	E/W	FEET	DEGS.	
2500.00	.30	S 62.00 E		100.00	2499.84		20.82 S	10.74 E	23.42' S 27.28 E	.50
2600.00	.40	S 81.00 E		100.00	2599.84		21.01 S	11.31 E	23.86' S 28.30 E	.15
2700.00	.30	N 65.00 E		100.00	2699.84		20.93 S	11.91 E	24.08' S 29.64 E	.23
2800.00	.30	S 82.00 E		100.00	2799.84		20.85 S	12.42 E	24.27' S 30.78 E	.17
2900.00	.90	N 46.00 E		100.00	2899.83		20.54 S	13.38 E	24.51' S 33.09 E	.75
3000.00	.90	N 34.00 E		100.00	2999.82		19.34 S	14.39 E	24.10' S 36.66 E	.19
3100.00	.70	N 45.00 E		100.00	3099.81		18.26 S	15.28 E	23.81' S 39.92 E	.25
3200.00	.90	N 53.00 E		100.00	3199.80		17.34 S	16.33 E	23.82' S 43.27 E	.23
3300.00	.80	N 45.00 E		100.00	3299.79		16.37 S	17.45 E	23.93' S 46.82 E	.15
3400.00	.50	N 07.00 W		100.00	3399.78		15.34 S	17.80 E	23.50' S 49.26 E	.63
3500.00	.40	N 25.00 W		100.00	3499.78		14.58 S	17.59 E	22.85' S 50.34 E	.17
3600.00	.10	N 64.90 W		100.00	3599.76		14.28 S	17.29 E	22.42' S 50.45 E	.33
3700.00	.20	N 71.00 E		100.00	3699.78		14.07 S	17.30 E	22.30' S 50.87 E	.28
3800.00	.20	N 35.00 E		100.00	3799.78		13.87 S	17.58 E	22.39' S 51.73 E	.12
3900.00	.30	N 11.00 E		100.00	3899.78		13.47 S	17.74 E	22.28' S 52.88 E	.14
4000.00	.28	S 67.00 W		100.00	3999.77		13.24 S	17.47 E	21.92' S 52.83 E	.44
4100.00	.20	S 07.00 E		100.00	4099.77		13.53 S	17.31 E	21.96' S 51.99 E	.24
4200.00	0.00	*** ** *		100.00	4199.77		13.78 S	17.33 E	22.09' S 51.67 E	.28
4293.00	.25	S 78.00 W		93.00	4292.77		13.74 S	17.13 E	21.96' S 51.26 E	.27
4386.00	0.00	*** ** *		93.00	4385.77		13.78 S	16.93 E	21.83' S 50.85 E	.27
4479.00	.25	S 29.00 E		93.00	4478.77		13.96 S	17.83 E	22.02' S 50.65 E	.27
4572.00	.25	S 08.00 W		93.00	4571.77		14.35 S	17.10 E	22.33' S 49.99 E	.17
4665.00	.50	N 38.00 W		93.00	4664.77		14.48 S	16.64 E	22.06' S 48.97 E	.75
4758.00	.75	N 82.00 W		93.80	4757.76		13.98 S	15.78 E	21.08' S 48.46 E	.56
4851.00	1.00	N 88.00 W		93.00	4850.75		13.86 S	14.37 E	19.95' S 46.03 E	.29

SURVEY DATA FROM 4293' - 12887' OBTAINED FROM SMITH INTERNATIONAL

P04 P \* PM 01:58 08 27.08 08

UNION PACIFIC RESOURCES  
 STATE NO. 26-2  
 MT-KK7

PAGE 3  
 03:49:12  
 09/08/60

MEASURED	INCL.	HOLE	DIRECTION	COURSE	VERTICAL	TRUE	N/S	feet	E/W	DISTANCE	DIRECTION	DEGS.	DOG-LEG
DEPTH	ANGLE			LENGTH	DEPTH			feet		FEET			DOG/100FT
FEET	DEGS.	DEGS.		FEET	FEET								
4944.00	1.25	N	76.00 W	93.00	4943.73		13.61 S	12.56 E		18.52'	S 42.72 E		.37
5037.00	.75	N	72.00 W	93.00	5036.72		13.16 S	11.00 E		17.15'	S 39.90 E		.54
5130.00	.75	N	61.00 W	93.00	5129.71		12.67 S	9.89 E		16.07'	S 37.96 E		.15
5223.00	1.00	N	86.00 W	93.00	5222.70		12.27 S	8.54 E		14.95'	S 34.82 E		.48
5316.00	1.00	N	83.00 W	93.00	5315.69		12.12 S	6.92 E		13.96'	S 29.73 E		.06
5409.00	1.00	S	73.00 W	93.00	5408.67		12.26 S	5.32 E		13.36'	S 23.44 E		.45
5502.00	1.00	S	59.00 W	93.00	5501.66		12.92 S	3.84 E		13.47'	S 16.54 E		.26
5595.00	1.00	S	52.00 W	93.00	5594.64		13.84 S	2.50 E		14.06'	S 10.24 E		.13
5688.00	.75	S	59.00 W	93.00	5687.63		14.64 S	1.33 E		14.70'	S 05.19 E		.29
5781.00	.50	S	71.00 W	93.00	5780.63		15.07 S	.41 E		15.07'	S 01.57 E		.36
5874.00	.75	S	41.00 W	93.00	5873.62		15.53 S	.42 W		15.63'	S 01.53 W		.43
5967.00	1.00	S	14.00 W	93.00	5966.61		16.88 S	1.07 W		16.91'	S 03.62 W		.51
6060.00	.75	S	32.00 W	93.00	6059.60		18.18 S	1.62 W		18.25'	S 05.10 W		.40
6153.00	1.00	S	58.00 W	93.00	6152.59		19.17 S	2.62 W		19.35'	S 07.77 W		.50
6246.00	1.00	S	56.00 W	93.00	6245.58		20.06 S	3.98 W		20.45'	S 11.22 W		.04
6339.00	1.25	S	63.00 W	93.00	6338.56		20.98 S	5.55 W		21.71'	S 14.82 W		.31
6432.00	1.00	S	76.00 W	93.00	6431.54		21.62 S	7.26 W		22.31'	S 18.55 W		.38
6525.00	1.25	S	59.00 W	93.00	6524.52		22.32 S	8.94 W		24.04'	S 21.82 W		.45
6618.00	1.25	S	83.00 W	93.00	6617.50		22.97 S	10.84 W		25.40'	S 25.26 W		.56
6711.00	1.00	S	80.00 W	93.00	6710.48		23.24 S	12.65 W		26.46'	S 28.55 W		.28
6804.00	1.00	S	61.00 W	93.00	6803.47		23.78 S	14.17 W		27.68'	S 30.79 W		.35
6897.00	1.00	S	52.00 W	93.00	6896.45		24.68 S	15.52 W		29.15'	S 32.17 W		.17
6990.00	1.25	S	64.00 W	93.00	6989.44		25.64 S	17.07 W		30.80'	S 33.65 W		.37
7083.00	1.00	S	43.00 W	93.00	7082.42		26.72 S	18.53 W		32.52'	S 34.73 W		.51
7176.00	1.50	S	44.00 W	93.00	7175.39		28.20 S	19.92 W		34.52'	S 35.25 W		.54

05

P

\* M

PM

01:58

08

06, 27, 88



UNION PACIFIC RESOURCES  
 STATE NO. 26-2  
 HT-KK7

PAGE 4  
 03:50:05  
 06/08/00

MEASURED DEPTH FEET	INCL. ANGLE DEGS.	HOLE DIRECTION DEGS.	COURSE LENGTH FEET	VERTICAL DEPTH FEET	TRUE	N/S	Feet	E/W	DISTANCE FEET	C L J S U R E	DIRECTION DEGS.	DOG-LEG SEVERITY
7269.00	1.00	S 55.00 W	93.00	7268.37		S	21.46	W	36.49	S	36.03	.59
7362.00	1.25	S 49.00 W	93.00	7361.35		S	22.90	W	38.25	S	36.78	.30
7455.00	1.50	S 53.00 W	93.00	7454.33		S	24.64	W	40.42	S	37.56	.29
7548.00	1.25	S 55.00 W	93.00	7547.30		S	26.44	W	42.56	S	38.41	.27
7641.00	1.00	S 46.00 W	93.00	7640.28		S	27.85	W	44.35	S	38.90	.33
7734.00	1.25	S 59.00 W	93.00	7733.26		S	29.30	W	46.12	S	39.44	.38
7827.00	1.25	S 44.00 W	93.00	7826.24		S	30.88	W	48.10	S	39.94	.35
7920.00	1.00	S 26.00 W	93.00	7919.22		S	31.22	W	49.91	S	39.76	.46
8013.00	1.00	S 03.00 W	93.00	8012.21		S	32.32	W	51.37	S	38.99	.43
8106.00	1.00	S 14.00 W	93.00	8105.20		S	32.56	W	52.78	S	38.10	.21
8199.00	1.00	S 31.00 W	93.00	8198.18		S	33.18	W	54.34	S	37.64	.32
8292.00	1.50	S 45.00 W	93.00	8291.16		S	34.43	W	56.36	S	37.65	.63
8385.00	1.25	S 60.00 W	93.00	8384.13		S	36.19	W	58.51	S	38.21	.47
8478.00	1.50	S 49.00 W	93.00	8477.11		S	38.01	W	60.66	S	38.80	.39
8571.00	1.25	S 44.00 W	93.00	8570.08		S	39.53	W	62.87	S	39.07	.30
8664.00	1.25	S 45.00 W	93.00	8663.06		S	41.05	W	64.89	S	39.24	.02
8757.00	1.25	S 60.00 W	93.00	8756.03		S	42.65	W	65.86	S	39.64	.35
8850.00	1.25	S 53.00 W	93.00	8849.01		S	44.34	W	68.90	S	40.13	.16
8943.00	1.25	S 37.00 W	93.00	8941.99		S	45.77	W	70.82	S	40.27	.37
9036.00	1.00	S 45.00 W	93.00	9034.97		S	46.97	W	72.64	S	40.29	.32
9129.00	1.00	S 66.00 W	93.00	9127.96		S	48.30	W	74.20	S	40.62	.29
9222.00	1.50	S 54.00 W	93.00	9220.94		S	50.06	W	76.11	S	41.12	.68
9315.00	1.25	S 71.00 W	93.00	9313.91		S	52.03	W	78.19	S	41.72	.51
9408.00	1.25	S 83.00 W	93.00	9406.89		S	54.00	W	79.85	S	42.55	.28
9501.00	1.25	S 63.00 W	93.00	9499.86		S	55.93	W	81.59	S	43.27	.47

UNION PACIFIC RESOURCES  
STATE NO. 26-2  
MT-KK7

PAGE 5  
03:50:57  
00/00/00

07 P

MEASURED INCL. HOLE DIRECTION DEGS. DEPTH FEET COURSE LENGTH FEET TRUE VERTICAL DEPTH FEET S ECT AN G U L A R D I S T A N C E FEET C L O S U R E D I R E C T I O N D E G S . 9 0 0 - L E G S E V E R I T Y

9594.00	1.50	S 74.00 W	93.00	9592.84	66.23 S	58.00 W	83.62'	S 43.92 W	.39
9687.00	1.25	S 63.00 W	93.00	9685.81	61.04 S	60.08 W	85.65'	S 44.54 W	.39
9780.00	1.00	S 66.00 W	93.00	9778.79	61.83 S	61.73 W	87.37'	S 44.95 W	.28
9873.00	1.00	S 67.00 W	93.00	9871.78	62.48 S	63.21 W	88.98'	S 45.34 W	.02
9966.00	1.00	S 70.00 W	93.00	9964.76	63.07 S	64.72 W	90.37'	S 45.74 W	.05
10059.00	1.50	S 61.50 W	93.50	10057.74	63.91 S	66.57 W	92.28'	S 46.17 W	.58
10152.00	1.50	S 62.00 W	93.00	10150.71	65.07 S	68.71 W	94.63'	S 46.56 W	.03
10245.00	2.00	S 76.00 W	93.00	10243.67	66.79 S	71.35 W	97.26'	S 47.19 W	.70
10338.00	2.00	S 64.00 W	93.00	10336.61	67.20 S	74.40 W	100.25'	S 47.91 W	.45
10431.00	2.25	S 74.00 W	93.00	10429.55	68.43 S	77.61 W	103.47'	S 48.60 W	.48
10524.00	2.25	S 73.00 W	93.00	10522.47	69.47 S	81.11 W	106.79'	S 49.42 W	.04
10617.00	2.50	S 69.00 W	93.00	10615.39	70.72 S	84.76 W	110.39'	S 50.16 W	.32
10710.00	2.25	S 61.00 W	93.00	10708.31	72.35 S	88.25 W	114.11'	S 50.65 W	.45
10803.00	2.25	S 73.00 W	93.00	10801.24	73.77 S	91.60 W	117.61'	S 51.15 W	.51
10896.00	2.50	S 77.00 W	93.00	10894.16	74.77 S	95.32 W	121.15'	S 51.89 W	.32
10989.00	3.25	S 74.00 W	93.00	10987.05	75.94 S	99.84 W	125.44'	S 52.74 W	.82
11082.00	3.50	S 77.00 W	93.00	11079.88	77.31 S	105.14 W	130.50'	S 53.67 W	.33
11175.00	3.50	S 74.00 W	93.00	11172.71	78.73 S	110.63 W	135.79'	S 54.56 W	.20
11268.00	3.50	S 64.00 W	93.00	11265.54	80.76 S	115.93 W	141.29'	S 55.14 W	.66
11361.00	5.00	S 68.00 W	93.00	11358.28	83.56 S	122.22 W	148.06'	S 55.64 W	1.64
11401.00	5.25	S 72.00 W	40.00	11398.12	84.79 S	125.58 W	151.52'	S 55.97 W	1.09
11564.00	3.75	S 56.00 W	163.00	11560.61	90.37 S	137.04 W	164.15'	S 56.60 W	1.19
11657.00	.75	S 37.00 W	93.00	11653.53	92.88 S	139.67 W	167.73'	S 56.38 W	3.28
11750.00	.75	S 62.00 W	93.00	11746.52	93.56 S	140.59 W	168.93'	S 56.33 W	.35
11843.00	.50	S 37.00 W	93.00	11839.52	94.31 S	141.36 W	169.93'	S 56.29 W	.39

07 P

\* PM

01:00 PM

06.27.88

UNION PACIFIC RESOURCES  
 STATE NO. 26-2  
 WT-KK7

PAGE 6  
 03:31:50  
 00/00/00

MEASURED DEPTH FEET	INCL. ANGLE DEGS.	HOLE DIRECTION DEGS.	COURSE LENGTH FEET	VERTICAL DEPTH FEET	TRUE	N/S	feet E/W	DISTANCE FEET	DIRECTION DEGS.	DOG-LEG SEVERITY DG/100FT
11939.00	2.25	S 59.00 W	96.00	11935.48		95.85 S	143.06 W	172.20'	S 56.18 W	1.87
12029.00	3.00	S 50.00 W	90.00	12025.39		98.24 S	146.41 W	176.31'	S 56.14 W	.95
12122.00	3.50	S 47.00 W	93.00	12118.24		101.73 S	150.36 W	181.54'	S 55.92 W	.57
12215.00	4.00	S 47.00 W	93.00	12211.04		105.88 S	154.81 W	187.55'	S 55.63 W	.54
12308.00	4.25	S 47.00 W	93.00	12303.80		110.35 S	159.78 W	194.18'	S 55.37 W	.31
12401.00	4.50	S 48.00 W	93.00	12396.53		115.06 S	165.09 W	201.23'	S 55.13 W	.28
12494.00	4.50	S 48.00 W	93.00	12489.24		119.94 S	170.51 W	208.47'	S 54.88 W	0.00
12587.00	4.25	S 48.00 W	93.00	12581.97		124.68 S	175.79 W	215.51'	S 54.65 W	.27
12680.00	4.00	S 47.00 W	93.00	12674.67		129.20 S	180.72 W	222.15'	S 54.44 W	.28
12773.00	3.75	S 54.00 W	93.00	12767.52		133.20 S	185.56 W	228.42'	S 54.33 W	.57
12866.00	3.25	S 55.00 W	93.00	12860.34		136.50 S	190.19 W	234.19'	S 54.33 W	.54
12887.00	3.50	S 52.00 W	21.00	12881.31		137.23 S	191.18 W	235.33'	S 54.33 W	1.46

CLOSURE DISTANCE = 235.33 FEET.  
 CLOSURE DIRECTION = S 54.33 W

RECEIVED

AUG 03 1988

PRODUCTION DEPARTMENT

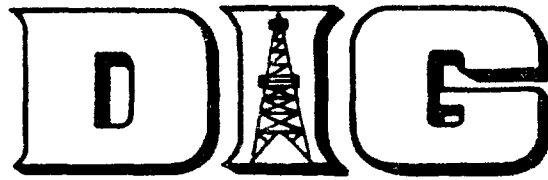

SUB-SURFACE  
DIRECTIONAL  
SURVEY  
REPORT

UNION PACIFIC RESOURCES

COMPANY

STATE WELL 26 NO. 2 *Side Track*

WELL NAME

LEA COUNTY, NEW MEXICO

STATE AND COUNTY

CERTIFIED REPORT

SECTION PALETTE FOR PLANS

WELL #  
STATE WELL 35 NO. 1

LOCATION  
LEA COUNTY, NEW MEXICO

DATE  
8-28-83 TO 7-27-84

JOB TYPE  
SYNO. MNG. MMS

JOB #  
02-2057, SMITH, 1-1-1986

SURVEYOR  
MAPSEY, SMITH, MARSH

DEPTHS  
6-4200, 4200, 6473, 9873, 11953

DECL.  
10 DEGREES EAST

ELEV.  
437

FILE #  
W-4478

\*\*\*\*\*

FINAL STATION DATA

NO. 12958, 01  
TVD. 12895.89  
MMS 51.95  
EVA 019.49

SURVEY 1161 YMS  
GMS, 85 51.95  
CUMUL. DEPRESSION  
0.85, 10.3

1 IN. = 200 FT.

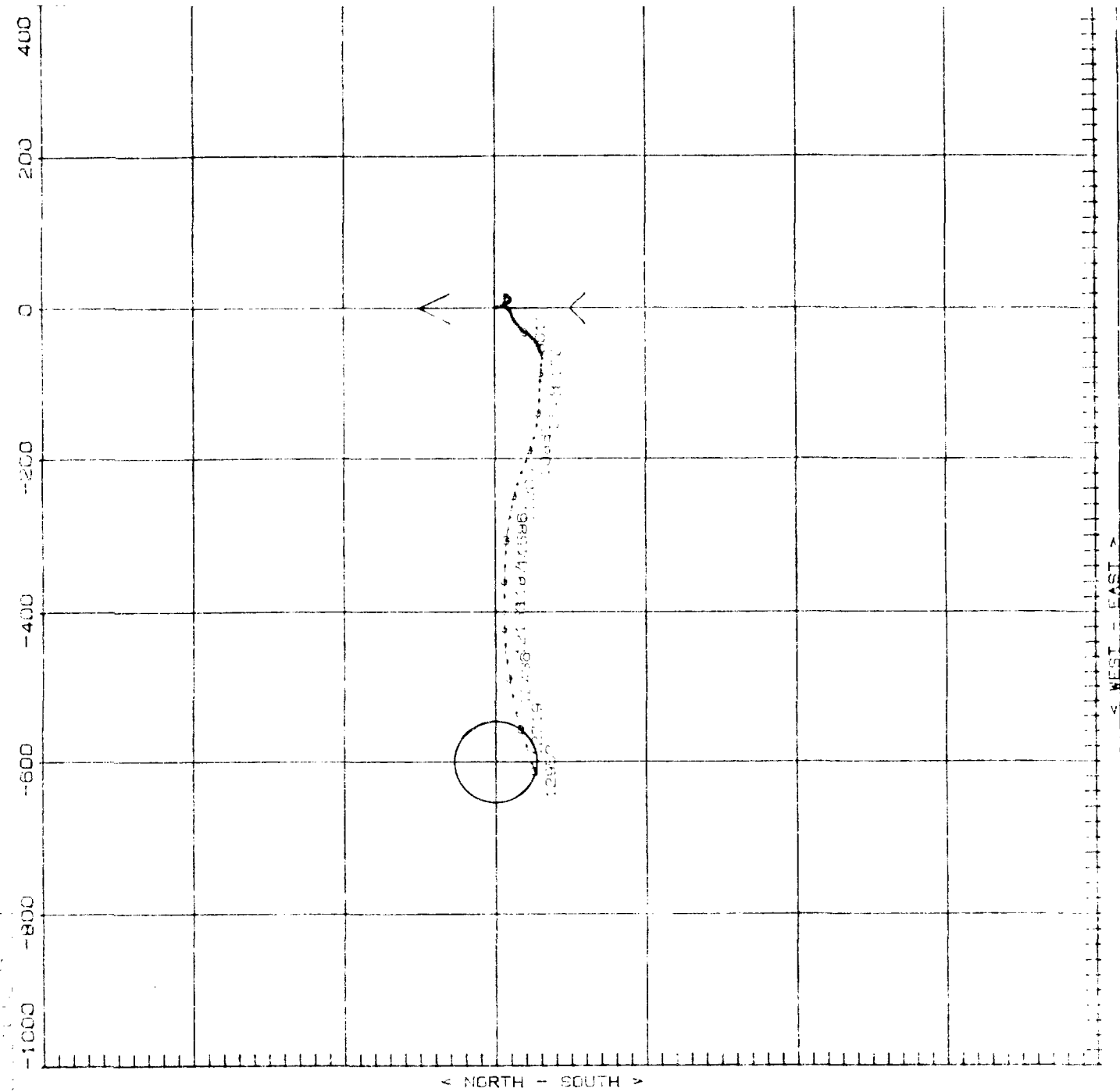

CUSTOMER : UNION PACIFIC RESOURCES

WELL # : STATE WELL 26 NO.2

LOCATION : LEA COUNTY, NEW MEXICO

DATE : 6-26-88 TO 7-30-88

JOB TYPE : GYRO, MMS, MMS

JOB # : GS-2087, SMITH, MS-2098

SURVEYOR : MASSEY, SMITH, MASSEY

DEPTHS : 0-4200, 4200-9873, 9873-12953

DECL. : 10 DEGREES EAST

ELEV. : 4217'

FILE # : WT-KK75

METHOD : RADIUS OF CURVATURE

SECTION : N90W

FINAL STATION DATA!

MEASURED	INCL.	HOLE	COURSE	VERTICAL	SURCEA	VERTICAL	R E C T A N G L A R	D I S T A N C E	D I R E C T I O N	D I S T A N C E	D I R E C T I O N
DEPTH	ANGLE	DIRECTION	LENGTH	DEPTH	DEPTH	DEPTH	SECTION	FEET	FEET	FEET	FEET
FEET	DEGS.	DEGS.	FEET	FEET	FEET	FEET	N/S	FEET	E/W	FEET	DEGS.
12953.00	10.75	8 3 72.0	45.10	1.0845.88	0.78153	615.40	51.93	515.40	5	515.10	5 85.15 W

THIS SURVEY IS CORRECT TO THE  
 BEST OF MY KNOWLEDGE AND IS  
 SUPPORTED BY ACTUAL FIELD DATA.

*Larry Massey*  
 DIG REPRESENTATIVE

UNION PACIFIC RESOURCES  
 STATE WELL 26 NO.2  
 AT-KK75

PAGE 1  
 00:41:42  
 00/00/00

MEASURED DEPTH FEET	INCL. ANGLE DEGS.	HOLE DIRECTION DEGS.	COURSE LENGTH FEET	TRUE VERTICAL DEPTH FEET	SURSEA DEPTH FEET	VERTICAL SECTION FEET	N/S	feet E/W	RECORDING DISTANCE FEET	C L O S U R E DIRECTION DEGS.	DOG-LI SEVER
0.00	0.00	S 01.00 E	100.00	0.00	-4217.00	0.00	0.00 N	0.00 E	0.00'	N 00.00 E	0.0
100.00	.20	S 01.00 E	100.00	100.00	-4117.00	-0.00	.17 S	.00 E	.17'	S 01.00 E	.2
200.00	.30	S 22.00 E	100.00	200.00	-4017.00	-0.09	.60 S	.09 E	.61'	S 08.49 E	1
300.00	.20	S 15.00 E	100.00	300.00	-3917.00	-0.23	1.01 S	.23 E	1.04'	S 12.68 E	1
400.00	.30	S 01.00 E	100.00	400.00	-3817.00	-0.29	1.44 S	.29 E	1.47'	S 11.30 E	1
500.00	0.00	S 01.00 E	100.00	500.00	-3717.00	-0.29	1.71 S	.29 E	1.73'	S 09.75 E	.3
600.00	.10	S 26.00 E	100.00	600.00	-3617.00	-0.33	1.78 S	.33 E	1.81'	S 10.52 E	.1
700.00	.20	S 33.00 W	100.00	700.00	-3517.00	-0.32	2.03 S	.32 E	2.06'	S 08.83 E	.1
800.00	.30	S 35.00 W	100.00	800.00	-3417.00	-0.07	2.40 S	.07 E	2.40'	S 01.72 E	.1
900.00	.80	S 17.00 E	100.00	899.99	-3317.01	.07	3.31 S	.97 W	3.31'	S 01.26 W	.6
1000.00	.90	S 39.00 E	100.00	999.98	-3217.02	-.62	4.61 S	.62 E	4.56'	S 07.64 E	.3
1100.00	.80	S 17.00 E	100.00	1099.97	-3117.03	-1.31	5.92 S	1.31 E	6.06'	S 12.50 E	.3
1200.00	.90	S 27.00 E	100.00	1199.96	-3017.04	-1.97	7.29 S	1.87 E	7.52'	S 14.36 E	.1
1300.00	.70	S 35.00 E	100.00	1299.95	-2917.05	-2.58	8.49 S	2.58 E	8.87'	S 16.94 E	.2
1400.00	.70	S 39.00 E	100.00	1399.94	-2817.06	-3.04	9.61 S	3.04 E	10.00'	S 17.55 E	.3
1500.00	1.00	S 27.00 E	100.00	1499.93	-2717.07	-3.50	11.01 S	3.50 E	11.55'	S 17.61 E	.4
1600.00	1.00	S 08.00 E	100.00	1599.91	-2617.09	-4.02	12.67 S	4.02 E	13.29'	S 17.59 E	.3
1700.00	1.50	S 37.00 E	100.00	1699.90	-2517.10	-4.68	14.27 S	4.68 E	15.91'	S 18.16 E	.5
1800.00	.80	S 39.00 E	100.00	1799.89	-2417.11	-5.53	15.59 S	5.53 E	16.53'	S 19.55 E	.2
1900.00	.80	S 37.00 E	100.00	1899.88	-2317.12	-6.29	16.75 S	6.29 E	17.89'	S 20.59 E	.1
2000.00	.20	S 21.00 E	100.00	1999.87	-2217.13	-6.71	17.51 S	6.71 E	18.76'	S 20.98 E	.6
2100.00	.70	S 38.00 E	100.00	2099.87	-2117.13	-7.10	18.19 S	7.10 E	19.53'	S 21.32 E	.5
2200.00	.50	S 59.00 E	100.00	2199.86	-2017.14	-7.98	18.88 S	7.98 E	20.16'	S 22.65 E	.2
2300.00	.46	S 40.00 E	100.00	2299.86	-1917.14	-8.74	17.62 S	8.74 E	21.40'	S 24.01 E	.3
2400.00	.30	S 59.00 E	100.00	2399.85	-1817.15	-9.65	20.42 S	9.65 E	22.68'	S 25.98 E	.4

MEASURED	INCL.	HOLE	COURSE	TRUE	SURSEA	VERTICAL	DEPTH	FEET	FEET	N/S	feet	E/W	FEET	DIRECTION	DEGS.	DISTANCE	C L O S U R E	DOG-LI
DEPTH	ANGLE	DIRECTION	LENGTH	DEPTH	DEPTH	FEET	FEET	FEET	FEET									SEVER
FEET	DEGS.	DEGS.	FEET	FEET	FEET	FEET	FEET	FEET	FEET									DEGS.
2500.00	.30	S 62.00 E	100.00	2499.84	-1717.16	-10.74	20.32	S	10.74	E	23.42	S	27.28	E	.50			
2600.00	.40	S 81.00 E	100.00	2599.84	-1617.16	-11.31	21.01	S	11.31	E	23.86	S	28.30	E	.11			
2700.00	.30	N 65.00 E	100.00	2699.84	-1517.16	-11.91	20.93	S	11.91	E	24.08	S	29.64	E	.23			
2800.00	.30	S 82.00 E	100.00	2799.84	-1417.16	-12.42	20.85	S	12.42	E	24.27	S	30.78	E	.11			
2900.00	.90	N 46.00 E	100.00	2899.83	-1317.17	-13.58	20.54	S	13.58	E	24.51	S	33.09	E	.72			
3000.00	.90	N 34.00 E	100.00	2999.82	-1217.18	-14.39	19.34	S	14.39	E	24.10	S	36.66	E	.19			
3100.00	.70	N 45.00 E	100.00	3099.81	-1117.19	-15.28	18.26	S	15.28	E	23.81	S	39.92	E	.21			
3200.00	.90	N 53.00 E	100.00	3199.80	-1017.20	-16.33	17.34	S	16.33	E	23.82	S	43.27	E	.21			
3300.00	.80	N 45.00 E	100.00	3299.79	-917.21	-17.45	16.37	S	17.45	E	23.93	S	46.82	E	.11			
3400.00	.50	N 07.00 W	100.00	3399.78	-817.22	-17.90	15.34	S	17.90	E	23.50	S	49.25	E	.61			
3500.00	.40	N 25.00 W	100.00	3499.78	-717.22	-17.59	14.58	S	17.59	E	22.85	S	50.34	E	.17			
3600.00	.10	N 64.00 W	100.00	3599.78	-617.22	-17.29	14.28	S	17.29	E	22.42	S	50.45	E	.13			
3700.00	.20	N 71.00 E	100.00	3699.78	-517.22	-17.30	14.07	S	17.30	E	22.30	S	50.87	E	.24			
3800.00	.20	N 35.00 E	100.00	3799.78	-417.22	-17.58	13.87	S	17.58	E	22.39	S	51.73	E	.11			
3900.00	.30	N 11.00 E	100.00	3899.78	-317.22	-17.74	13.47	S	17.74	E	22.29	S	52.80	E	.17			
4000.00	.20	S 67.00 W	100.00	3999.77	-217.23	-17.47	13.24	S	17.47	E	21.92	S	52.83	E	.14			
4100.00	.20	S 07.00 E	100.00	4099.77	-117.23	-17.31	13.53	S	17.31	E	21.96	S	51.99	E	.21			
4200.00	0.00	* * * * *	100.00	4199.77	-17.23	-17.33	13.70	S	17.33	E	22.09	S	51.67	E	.12			
4293.00	.25	S 78.00 W	93.00	4292.77	75.77	-17.13	13.74	S	17.13	E	21.96	S	51.26	E	.12			
4386.00	.90	* * * * *	93.00	4385.77	168.77	-16.93	13.78	S	16.93	E	21.83	S	50.85	E	.21			
4479.00	.25	S 29.00 E	93.00	4478.77	261.77	-17.03	13.96	S	17.03	E	22.02	S	50.65	E	.12			
4572.00	.25	S 08.00 W	93.00	4571.77	354.77	-17.10	14.35	S	17.10	E	22.33	S	49.99	E	.17			
4665.00	.50	N 38.00 W	93.00	4664.77	447.77	-16.54	14.40	S	16.54	E	22.06	S	48.97	E	.21			
4758.00	.75	N 32.00 W	93.00	4757.76	540.76	-15.78	13.90	S	15.78	E	21.88	S	48.46	E	.51			
4851.00	1.00	N 08.00 W	93.00	4850.75	633.75	-14.37	13.80	S	14.37	E	19.96	S	46.03	E	.21			

SURVEY DATA FROM 4293' - 9873' OBTAINED FROM SMITH INTERNATIONAL



MEASURED DEPTH FEET	INCL. ANGLE DEGS.	HOLE DIRECTION DEGS.	COURSE LENGTH FEET	TRUE VERTICAL DEPTH FEET	SURSEA DEPTH FEET	VERTICAL SECTION FEET	N/S	E/W	FEET	C L O S U R E D I S T A N C E	D I R E C T I O N	D O G - L E S E V E R I D E G S .
4944.00	1.25	N 76.00 W	93.00	4943.73	726.73	-12.56	13.61	S	12.56	18.52	S 42.72 E	.37
5037.00	.75	N 72.00 W	93.00	5036.72	819.72	-11.00	13.16	S	11.00	17.15	S 39.90 E	.54
5130.00	.75	N 61.00 W	93.00	5129.71	912.71	-9.89	12.67	S	9.89	16.07	S 37.96 E	.15
5223.00	1.00	N 86.00 W	93.00	5222.70	1005.70	-8.54	12.27	S	8.54	14.95	S 34.82 E	.42
5316.00	1.00	N 93.00 W	93.00	5315.69	1098.69	-6.92	12.12	S	6.92	13.96	S 29.73 E	.06
5409.00	1.00	S 73.00 W	93.00	5408.67	1191.67	-5.32	12.26	S	5.32	13.36	S 23.44 E	.45
5502.00	1.00	S 59.00 W	93.00	5501.66	1284.66	-3.84	12.92	S	3.84	13.47	S 16.54 E	.26
5595.00	1.00	S 52.00 W	93.00	5594.64	1377.64	-2.50	13.84	S	2.50	14.06	S 10.24 E	.12
5688.00	.75	S 59.00 W	93.00	5687.63	1470.63	-1.33	14.64	S	1.33	14.70	S 15.19 E	.25
5781.00	.50	S 71.00 W	93.00	5780.63	1563.63	-1.41	15.07	S	1.41	15.07	S 01.57 E	.30
5874.00	.75	S 41.00 W	93.00	5873.62	1656.62	.42	15.63	S	1.42	15.63	S 01.53 W	.42
5967.00	1.00	S 14.00 W	93.00	5966.61	1749.61	1.07	16.88	S	1.07	16.91	S 03.62 W	.51
6060.00	.75	S 32.00 W	93.00	6059.60	1842.60	1.62	18.18	S	1.62	18.25	S 05.10 W	.41
6153.00	1.00	S 58.00 W	93.00	6152.59	1935.59	2.62	19.17	S	2.62	19.35	S 07.77 W	.51
6246.00	1.00	S 56.00 W	93.00	6245.58	2028.58	3.98	20.06	S	3.98	20.45	S 11.22 W	.04
6339.00	1.25	S 63.00 W	93.00	6338.56	2121.56	5.55	20.93	S	5.55	21.71	S 14.82 W	.31
6432.00	1.00	S 76.00 W	93.00	6431.54	2214.54	7.26	21.62	S	7.26	22.81	S 18.55 W	.31
6525.00	1.25	S 59.00 W	93.00	6524.52	2307.52	8.94	22.32	S	8.94	24.04	S 21.82 W	.46
6618.00	1.25	S 83.00 W	93.00	6617.50	2400.50	10.84	22.97	S	10.84	25.40	S 25.26 W	.56
6711.00	1.00	S 90.00 W	93.00	6710.48	2493.48	12.65	23.24	S	12.65	26.46	S 28.55 W	.26
6804.00	1.00	S 61.00 W	93.00	6803.47	2586.47	14.17	23.78	S	14.17	27.68	S 30.79 W	.31
6897.00	1.00	S 52.00 W	93.00	6896.45	2679.45	15.52	24.68	S	15.52	29.15	S 32.17 W	.17
6990.00	1.25	S 64.00 W	93.00	6989.44	2772.44	17.07	25.64	S	17.07	30.80	S 33.65 W	.62
7083.00	1.00	S 43.00 W	93.00	7082.42	2865.42	18.53	26.72	S	18.53	32.52	S 34.73 W	.51
7176.00	1.50	S 44.00 W	93.00	7175.39	2958.39	19.92	28.20	S	19.92	34.52	S 35.25 W	.54

UNION PACIFIC RESOURCES  
 STATE WELL 26 NO.2  
 WT-KR75

PAGE 4  
 00:44:33  
 60/00/00

MEASURED DEPTH FEET	INCL ANGLE DEGS.	HOLE DIRECTION DEGS.	COURSE LENGTH FEET	TRUE VERTICAL DEPTH FEET	SUBSEA DEPTH FEET	VERTICAL SECTION FEET	RECORD INCHES	W/S	FEET E/W	CULAR DISTANCE FEET	CL O S U R E DIRECTION DEGS.	000-LI SEVER
7269.00	1.00	S 55.00 W	93.00	7269.37	3051.37	21.45	29.51 S		21.46 W	36.49'	S 36.03 W	.51
7362.00	1.25	S 49.00 W	93.00	7361.35	3144.35	22.90	30.63 S		22.90 W	38.25'	S 36.78 W	.31
7455.00	1.50	S 53.00 W	93.00	7454.33	3237.33	24.64	32.04 S		24.64 W	40.42'	S 37.56 W	.21
7548.00	1.25	S 55.00 W	93.00	7547.30	3330.30	26.14	33.35 S		26.14 W	42.56'	S 38.41 W	.21
7641.00	1.00	S 46.00 W	93.00	7640.28	3423.28	27.85	34.51 S		27.85 W	44.35'	S 38.90 W	.31
7734.00	1.25	S 59.00 W	93.00	7733.26	3516.26	29.30	35.62 S		29.30 W	46.12'	S 39.44 W	.31
7827.00	1.25	S 44.00 W	93.00	7826.24	3609.24	30.88	36.88 S		30.88 W	48.10'	S 39.94 W	.31
7920.00	1.00	S 26.00 W	93.00	7919.22	3702.22	31.92	38.37 S		31.92 W	49.91'	S 39.76 W	.41
8013.00	1.00	S 03.00 W	93.00	8012.21	3795.21	32.32	39.93 S		32.32 W	51.37'	S 38.99 W	.41
8106.00	1.00	S 14.00 W	93.00	8105.20	3888.20	32.56	41.53 S		32.56 W	52.79'	S 38.10 W	.31
8199.00	1.00	S 31.00 W	93.00	8198.18	3981.18	33.18	43.03 S		33.18 W	54.34'	S 37.64 W	.31
8292.00	1.50	S 45.00 W	93.00	8291.16	4074.16	34.43	44.62 S		34.43 W	56.36'	S 37.55 W	.61
8385.00	1.25	S 60.00 W	93.00	8384.13	4167.13	36.19	45.98 S		36.19 W	58.51'	S 36.21 W	.41
8478.00	1.50	S 49.00 W	93.00	8477.11	4260.11	38.01	47.27 S		38.01 W	61.66'	S 38.90 W	.31
8571.00	1.25	S 44.00 W	93.00	8570.09	4353.09	39.53	48.81 S		39.53 W	62.97'	S 39.47 W	.31
8664.00	1.25	S 45.00 W	93.00	8663.06	4446.06	41.95	50.25 S		41.05 W	64.89'	S 39.24 W	.81
8757.00	1.25	S 60.00 W	93.00	8756.03	4539.03	42.65	51.48 S		42.65 W	66.96'	S 39.64 W	.31
8850.00	1.25	S 53.00 W	93.00	8849.01	4632.01	44.34	52.60 S		44.34 W	68.80'	S 40.13 W	.41
8943.00	1.25	S 37.00 W	93.00	8941.99	4724.99	45.77	54.03 S		45.77 W	70.92'	S 40.27 W	.31
9036.00	1.00	S 45.00 W	93.00	9034.97	4817.97	46.97	55.41 S		46.97 W	72.64'	S 40.29 W	.31
9129.00	1.00	S 66.00 W	93.00	9127.96	4910.96	48.30	56.32 S		48.30 W	74.20'	S 40.62 W	.31
9222.00	1.50	S 54.00 W	93.00	9220.94	5003.94	50.06	57.34 S		50.06 W	76.11'	S 41.12 W	.61
9315.00	1.25	S 71.00 W	93.00	9313.91	5096.91	52.03	58.36 S		52.03 W	78.19'	S 41.72 W	.31
9408.00	1.25	S 93.00 W	93.00	9406.89	5189.89	54.00	58.92 S		54.00 W	80.85'	S 42.55 W	.21
9501.00	1.25	S 37.00 W	93.00	9499.86	5282.86	55.93	59.41 S		55.93 W	81.59'	S 43.27 W	.41

MEASURED DEPTH FEET	INCL. ANGLE DEGS.	HOLE DIRECTION DEGS.	COURSE LENGTH FEET	TRUE VERTICAL DEPTH FEET	SURSEA DEPTH FEET	VERTICAL SECTION FEET	N/S FEET	RECTANGULAR CORNER DISTANCE FEET	C L O S U R E DIRECTION DEGS.
9594.00	1.50	S 74.00 W	93.00	9592.94	5375.84	58.00	60.23 S	58.00	S 43.92 W
9687.00	1.25	S 63.00 W	93.00	9685.91	5468.91	60.08	61.04 S	60.08	S 44.54 W
9790.00	1.00	S 66.00 W	93.00	9778.79	5561.79	61.73	61.93 S	61.73	S 44.95 W
9873.00	1.00	S 67.00 W	93.00	9871.78	5654.78	63.21	62.48 S	63.21	S 45.34 W
9982.00	4.75	N 32.00 W	109.00	9980.62	5763.62	68.57	63.18 S	68.57	S 47.34 W
10076.00	5.75	N 93.00 W	94.00	10074.23	5857.23	77.09	62.06 S	77.09	S 51.17 W
10170.00	6.25	N 85.00 W	94.00	10167.71	5950.71	86.37	61.02 S	86.37	S 54.91 W
10265.00	7.25	N 35.00 W	95.00	10262.05	6045.05	97.99	60.06 S	97.99	S 58.50 W
10359.00	8.00	N 38.00 W	94.00	10355.22	6138.22	110.44	59.30 S	110.44	S 61.77 W
10454.00	9.00	N 36.00 W	95.00	10449.18	6232.18	124.46	58.56 S	124.46	S 64.80 W
10548.00	10.00	N 37.00 W	94.00	10541.39	6324.39	139.94	57.61 S	139.94	S 67.62 W
10642.00	10.50	N 79.00 W	94.00	10634.38	6417.38	156.53	55.58 S	156.53	S 70.45 W
10737.00	10.50	N 72.00 W	95.00	10727.79	6510.79	173.28	51.25 S	173.28	S 73.53 W
10831.00	10.00	N 71.00 W	94.00	10820.29	6603.29	189.15	45.94 S	189.15	S 76.35 W
10926.00	9.75	N 70.00 W	95.00	10913.39	6696.39	204.50	40.50 S	204.50	S 78.80 W
11020.00	9.50	N 69.00 W	94.00	11006.56	6789.56	219.22	35.00 S	219.22	S 80.93 W
11114.00	9.75	N 71.00 W	94.00	11099.24	6882.24	233.99	29.62 S	233.99	S 82.79 W
11209.00	9.00	N 75.00 W	95.00	11192.97	6975.97	248.79	25.10 S	248.79	S 84.24 W
11303.00	9.90	N 79.00 W	94.00	11285.81	7068.81	263.11	21.79 S	263.11	S 85.27 W
11398.00	9.75	N 80.00 W	95.00	11379.37	7162.37	277.52	19.12 S	277.52	S 86.06 W
11492.00	8.75	N 32.00 W	94.00	11472.58	7255.58	291.65	16.88 S	291.65	S 86.69 W
11586.00	7.75	N 34.00 W	94.00	11565.36	7348.36	305.64	15.04 S	305.64	S 87.19 W
11681.00	10.25	N 32.00 W	95.00	11658.91	7441.91	323.99	13.75 S	323.99	S 87.56 W
11775.00	11.25	N 37.00 W	94.00	11751.26	7534.26	348.50	12.83 S	348.50	S 87.84 W
11870.00	11.75	N 39.00 W	93.00	11844.36	7627.36	359.52	12.17 S	359.52	S 88.05 W

UNION PACIFIC RESOURCES  
STATE WELL 26 NO. 2  
JT-KK75

MEASURED	INCL.	HOLE	COURSE	TRUE	SUBSEA	VERTICAL	DEPTH	FEET	FEET	N/S	feet	E/W	FEET	DIRECTION	DEGS.	DOG-LE
DEPTH	ANGLE	DIRECTION	LENGTH	VERTICAL	DEPTH	SECTION	FEET	FEET	FEET	FEET	FEET	FEET	FEET	DIRECTION	DEGS.	SEVER:
FEET	DEGS.	DEGS.	FEET	FEET	FEET	FEET	FEET	FEET	FEET	FEET	FEET	FEET	FEET	DIRECTION	DEGS.	DG/100
11964.00	13.00	N 89.00 W	94.00	11936.17	7719.17	379.66	379.66	11.82	S	379.66	W	379.85	S 88.22 W			1.30
12058.00	12.75	N 90.00 W	94.00	12027.81	7810.51	400.51	400.51	11.63	S	400.51	W	400.78	S 88.34 W			.30
12153.00	13.00	S 88.00 W	95.00	12120.42	7903.42	421.77	421.77	12.00	S	421.77	W	421.94	S 88.37 W			.50
12247.00	13.75	S 86.00 W	94.00	12211.87	7994.87	443.49	443.49	13.14	S	443.49	W	443.68	S 88.30 W			.90
12342.00	13.75	S 83.00 W	95.00	12304.15	8087.15	465.96	465.96	15.30	S	465.96	W	466.21	S 88.12 W			.70
12436.00	14.25	S 82.00 W	94.00	12395.35	8178.35	488.51	488.51	18.27	S	488.51	W	488.85	S 87.86 W			.50
12530.00	15.00	S 79.00 W	94.00	12486.31	8269.31	511.91	511.91	22.19	S	511.91	W	512.39	S 87.52 W			1.10
12625.00	14.25	S 75.00 W	95.00	12578.23	8361.23	535.23	535.23	27.58	S	535.23	W	535.99	S 87.05 W			1.30
12719.00	14.25	S 73.00 W	94.00	12669.34	8452.34	557.52	557.52	33.96	S	557.52	W	558.55	S 86.51 W			.50
12814.00	14.50	S 72.00 W	95.00	12761.36	8544.36	580.01	580.01	41.05	S	580.01	W	581.46	S 85.95 W			.30
12908.00	14.75	S 72.00 W	94.00	12852.32	8635.32	602.59	602.59	49.39	S	602.59	W	604.53	S 85.41 W			.20
12953.00	14.75	S 72.00 W	45.00	12895.83	8678.83	613.48	613.48	51.93	S	613.48	W	615.69	S 85.16 W			0.00

CLOSURE DISTANCE = 615.68 FEET.  
CLOSURE DIRECTION = S 85.16 W

Reservoir Volumetric Analysis Summary  
Vada (Devonian) Pool

<u>Field</u>	Avg. Rec. Factor - % ( 40 Acres )	Avg. Rec. Factor - % ( 80 Acres )
<u>Bagley (Devonian)</u>	58.4%	29.2%
Wells - 25 ; 11 Wells Active		
Avg. Rec./Well- 1079 MBO		
Spacing Rules - 80 acres		
Avg. Net Pay - 288 ft.		
Avg. Water Sat.-51.6%		
Form. Volume Factor -1.03		
Avg. Porosity - 4.4%		
<u>Caprock, East (Devonian)</u>	85.7%	42.9%
Wells - 27 ; 6 Wells Active		
Avg. Rec./Well- 846 MBO		
Spacing Rules - 40 acres		
Avg. Net Pay - 65 ft.		
Avg. Water Sat.-28%		
Form. Volume Factor -1.03		
Avg. Porosity - 7.0%		
<u>Mescalero (Devonian)</u>	89.2%	44.6%
Wells - 8 ; 2 Wells Active		
Avg. Rec./Well- 722 MBO		
Spacing Rules - 40 acres		
Avg. Net Pay - 70 ft.		
Avg. Water Sat.-52%		
Form. Volume Factor -1.03		
Avg. Porosity - 8.0%		
<u>Moore (Devonian)</u>	67.0%	33.5%
Wells - 19 ; 7 Wells Active		
Avg. Rec./Well- 1086 MBO		
Spacing Rules - 40 acres		
Avg. Net Pay - 140 ft.		
Avg. Water Sat.-24%		
Form. Volume Factor -1.03		
Avg. Porosity - 8.0%		
<u>Vada (Devonian)</u>	75.7%	37.8%
Wells - 2; 1 Well Active		
Avg. Rec./Well- 400 MBO		
Spacing Rules - Proposed 80 acres		
Avg. Net Pay - 75 ft.		
Avg. Water Sat.-28%		
Form. Volume Factor -1.03		
Avg. Porosity - 3.25%		

UNION PACIFIC RESOURCES

EXHIBIT NO. 6

DOCKET NO. 94-3489100

DATE 8-17-88

Vada (Devonian) Pool  
State 26 No. 1  
August, 1988

Day	Rate		Pressure (PSIG)	Choke Size (Inch)	Comments
	BOPD	BWPD			
01	217	0.0	7.9	652	7/64p
02	217	0.0	7.2	650	7/64p
03	217	0.0	6.1	650	7/64p
04	215	1.1	5.98	650	7/64p
05	219	0.0	6.4	650	7/64p
06	205	0.0	5.4	652	7/64p
07	214	0.0	6.6	650	7/64p
08	199	0.0	5.9	650	7/64p
09	219	0.0	6.7	650	7/64p
10					
11	250	0.0	6.7	650	7/64p
12	217	0.0	5.8	650	7/64p
13	225	0.0	6.2	650	7/64p
14					
15					
16					
17					
18					
19					
20					
21					
22					
23					
24					
25					
26					
27					
28					
29					
30					
31					

Total:

Avg:

Cums:

RABSTA

a - adjustable choke  
p -

positive

choke

UNION PACIFIC RESOURCES

EXHIBIT NO. 7  
DOCKET NO. 9439 & 9440  
DATE 8-17-88

Vada (Devonian) Pool  
 State 26 No. 1  
 July, 1988

Day	Rate			Pressure (PSIG)	Choke Size (INCH)	Comments
	ROPD	BWPD	MCFD			
01	510	0.0	13.3	640	10/64a	
02	432	0.0	14.7	610	10/64a	
03	456	4.6	12.3	550	10/64a	
04	440	2.3	12.6	535	10/64a	
05	315	1.0		620	8/64p	Decr.choke size to limit wtr
06	231	3.0	9.0	635	8/64p	Treat tanks. Circ. 26 BSW From oil tank. Down 5 hours
07	312	0.75	9.0	640	8/64p	
08	317	0.5	7.5	645	8/64p	
09	317	0.0	9.3	650	8/64p	
10	322	0.0	9.2	650	8/64p	
11	289	0.0	8.8	650	8/64p	
12	329	0.0	9.7	650	8/64p	
13	331	0.58	9.0	650	8/64p	
14	313	0.5	8.9	650	8/64p	
15	317	0.0	9.1	650	8/64p	
16	296	0.0	9.0	650	8/64p	
17	307	0.0	8.9	650	8/64p	
18	343	0.0	10.7	650	8/64p	
19	294	0.0	8.9	645	8/64p	
20	317	1.0	9.1	650	8/64p	
21	343	1.0	8.7	610	8/64p	
22	293	0.0	9.0	595	8/64p	
23	278	0.0	4.5	580	8/64p	
24	304	1.7	8.5	570	8/64p	
25	286	3.0	7.6	560	8/64p	
26	283	2.3	7.2	545	8/64p	
27	206	0.0	6.1	610	7/64p	Change Choke @ 9:45 am
28	206	2.9	6.1	635	7/64p	
29	200	0.0	6.0	650	7/64p	
30	204	0.0	7.1	652	7/64p	
31	218	0.5	6.9	650	7/64p	

Total: 9,609 BO 25.6 BW 266.7 MCF

Avg: 310 RO 0.8 BW 8.6 MCF

Cons: 66,397 BO 51.6 BW 552.5 MCF

a - adjustable choke

p - positive choke

Vada (Devonian) Pool  
State 26 No. 1  
June, 1988

Day	Rate			Pressure (PSIG)	Choke Size (INCH)	Comments
	ROPD	BWPD	MCFD			
01	284	0.0	-			
02	367	0.0	-		6/64a	
03	618	0.0	24.6	625	12/64p	Tied in Gas
04	571	0.0	-	630	11/64p	
05	572	0.0	-	630	11/64p	
06	444	0.0	-	640	10/64p	
07	482	0.0	-	640	11/64p	
08	485	0.0	-	640	7.5/64a	Adj. choke
09	501	0.0	-	640	7.5/64a	
10	505	0.0	-		7.5/64a	
11	506	0.0	13.8	635	* P-38	
12	508	0.0	13.7	635	P-38	
13	504	0.0	13.4		P-38	
14	503	0.0	13.0	635	P-38	
15	507	0.0	12.3		P-38	
16	503	0.0	13.7	635	P-38	
17	502	0.0	11.8	640	P-38	
18	515	0.0	13.4	640	P-38	
19	491	0.0	13.8	640	P-38	
20	513	0.0	14.5		P-38	
21	504	0.0	12.0		P-38	
22	500	0.0	12.2	640	P-38	
23	510	0.0	12.3	640	P-38	
24	507	0.0	12.2	640	P-38	
25	498	0.0	13.8	640	P-38	
26	504	0.0	13.7		P-38	
27	505	0.0	13.9		P-38	
28	508	0.0	13.3	635	P-38	
29	499	0.0	11.2	640	P-38	
30	534	0.0	13.2	580	10.5/64a	

Total: 14,950 BO 285.8 MCF

Avg: 498 BO 13.6 MCF

Cums: 56,788 BO 285.8 MCF

\* P-38 10.25/64

a - adjustable choke

p - positive choke



Vada (Devonian) Pool  
 State 26 No. 1  
 May, 1988

Day	Rate			Pressure (PSIG)	Choke Size (INCH)	Comments
	ROPD	BWPD	MCFD			
01	756	0.0	-		10/64a	
02	451	0.0	-		7/64a	
03	403	0.0	-			
04	490	0.0	-	640	7.5/64a	
05	530	0.0	-	640	7.5/64a	
06	403	0.0	-	640	7/64a	
07	418	0.0	-	640	7/64a	
08	425	0.0	-	640	7/64a	
09	433	0.0	-			
10	441	0.0	-	640	7/64a	
11	435	0.0	-	640	7/64a	
12	428	0.0	-	640	7/64a	
13	433	0.0	-	640	7/64a	
14	442	0.0	-	640	7/64a	
15	425	0.0	-	640	7/64a	
16	425	0.0	-			
17	422	0.0	-			
18	393	0.0	-			
19	402	0.0	-			
20	467	0.0	-	640	6.5/64a	
21	390	0.0	-	640	7/64a	
22	395	0.0	-	640	6.5/64a	
23	322	0.0	-			
24	342	0.0	-	640	6.5/64a	
25	347	0.0	-	640	6/64a	
26	355	0.0	-	640	6/64a	
27	388	0.0	-	640		
28	390	0.0	-	640	6.75/64a	
29	399	0.0	-	640	6.75/64a	
30	360	0.0	-	640	6.75/64a	Allowable Made
31	0	0.0	-	640	6.75/64a	

Total: 12,710 BO

Avg: 410 BO

Cums: 41,838 BO

a - adjustable choke

p - positive choke

Vada (Devonian) Pool  
State 26 No. 1  
April, 1988

Day	Rate BOPD	Rate BWPD	MCFD	Pressure (PSIG)	Choke Size (INCH)	Comments
01						Installing LACT
02						
03						
04	402	0.0	-			Proving LACT
05	759	0.0	-	610	11/64	35.75BO/hr calc. 858 BOPD
06	791	0.0	-	610	11/64	
07	804	0.0	-			
08	462	0.0	-			
09	570	0.0	-			
10	480	0.0	-			
11	445	0.0	-			
12	592	0.0	-			Working on LACT
13	388	0.0	-			
14	497	0.0	-	640	7/64	
15	276	0.0	-	640	7/64	
16	373	0.0	-			
17	458	0.0	-	640	8/64	
18	446	0.0	-	640	8/64	
19	308	0.0	-	640	6/64	
20	441	0.0	-			
21	418	0.0	-			
22	463	0.0	-			
23	441	0.0	-			
24	425	0.0	-			
25	440	0.0	-			
26	407	0.0	-			Worked on LACT & proved meter
27	433	0.0	-			
28	464	0.0	-			
29	338	0.0	-			Made allowable
30	0	0.0	-			

Total: 12,321 BO

Avg: 474 BO

Cums: 29,128 BO

a - adjustable choke  
p - positive choke

Vada (Devonian) Pool  
 State 26 No. 1  
 March, 1988

Day	Rate BOPD	Rate BWPD	MCFD	Pressure (PSIG)	Choke Size (INCH)	Comments
01						Full BHP, BU 45" 4797# 78 1/2 hr tst
02						Leave SI pending Lease Sale
03						
04						
05						
06						
07						
08	55					Prod. to use oil in acid job
09						
10						
11						
12						
13						
14						
15						Lease Sale
16	1353	in 8 hrs		160	3/4	Acid w/500g, used 137 BO
17	35					Tanks full
18						
19						Shrinkage & tank bottoms 55 BO
20	1233	0.0	-			
21	945	0.0	-			
22	1474	0.0	-			
23	967	0.0	-			
24	979	0.0	-			
25	971	0.0	-			
26	983	0.0	-			
27	500	0.0	-			
28	1462	0.0	-			
29	1449	0.0	-			
30	0	0.0	-			
31	498	0.0	-			

Total: 12,712 BO

Avg: 978 BO

Cums: 16,807 BO

a - adjustable choke  
 p - positive choke

Vada (Devonian) Pool  
State 26 No. 1  
February, 1988

Day	Rate			Pressure (PSIG)	Choke Size (INCH)	Comments
	BOPD	BWPD	MCFD			
01						
02						
03						
04						
05						
06						
07						
08						
09						
10						
11						
12						
13						878 BO from DST & Comp.
14	326	0.0	-	10	3/4a	
15	290	0.0	-	10	3/4a	
16	303	0.0	-	10		
17	257	0.0	-	10	1/2a	SI 15" TP 650 psig
18	194	0.0	-	10	1/2a	Valve leaked. Lk to pit
19	292	0.0	-	12	1/2a	
20	241	0.0	-	11	1/2a	SI 15" TP 550 psig
21	225	0.0	-	10	1/2a	
22	234	0.0	-	10	3/4a	
23	220	0.0	-	7	3/4a	
24	214	0.0	-	7	3/4a	
25	206	0.0	-	7	3/4a	
26	215	0.0	-	7	3/4a	SI for BHP test. 20" 660 psig
27						
28						
29						

Total: 4,095 BO

Avg: 247 BO

Cums: 4,095 BO

a - adjustable choke  
p - positive choke

STATE OF NEW MEXICO  
DEPARTMENT OF ENERGY AND MINERALS  
OIL CONSERVATION DIVISION

IN THE MATTER OF THE APPLICATION  
OF UNION PACIFIC RESOURCES COMPANY  
FOR APPROVAL OF GAS DIRECTIONAL  
DRILLING, UNORTHODOX LOCATION AND  
SPECIAL POOL RULES LEA COUNTY,  
NEW MEXICO.

CASE: 9439  
9440

CERTIFICATE OF MAILING  
AND  
COMPLIANCE WITH ORDER R-8054

In accordance with Division Rule 1207 (Order R-8054) I hereby certify that on June 28, 1988, notice of the hearing, and a copy of applications for the above referenced case, was mailed at least twenty days prior to the hearing originally set for August 17, 1988 to the interested parties listed on Exhibit "A" attached hereto.

  
W. Thomas Kellahin

SUBSCRIBED AND SWORN to before me this 16th day of August, 1988.

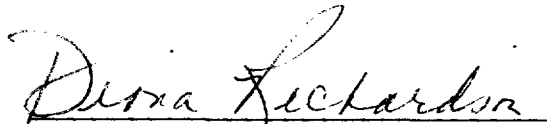
  
Notary Public

My Commission Expires:

Oct 28, 1989

BEFORE EXAMINER CATANACH OIL CONSERVATION DIVISION <u>Union Pacific</u> EXHIBIT NO. <u>8</u> CASE NO. <u>9439/9440</u>
---

EXHIBIT "A"

R. O. Major &  
A. F. Giebel  
505 N. Big Springs, Suite 300  
Midland, Texas 79701

Donald B. Anderson  
Box 1000  
Roswell, New Mexico 88210

Texaco, Inc.  
Box 3109  
Midland, Texas 79701

Kaiser-Francis Special Acct.  
D. & Samson Resource Co.  
- Jt. Venture  
Box 21468  
Tulsa, Oklahoma 74121

KELLAHIN, KELLAHIN and AUBREY

*Attorneys at Law*

El Patio - 117 North Guadalupe  
Post Office Box 2265

Santa Fé, New Mexico 87504-2265

Telephone 982-4285  
Area Code 505

W. Thomas Kellahin  
Karen Aubrey

Jason Kellahin  
Of Counsel

June 28, 1988

Mr. William J. LeMay  
Oil Conservation Division  
P. O. Box 2088  
Santa Fe, New Mexico 87504

"Hand Delivered"

Re: First Amended  
Application of Union Pacific Resources Company  
for the Adoption of Special Rules and Regulations  
for the Vada Devonian Oil Pool, Lea County,  
New Mexico

Dear Mr. LeMay:

On behalf of Union Pacific Resources Company please  
find enclosed our First Amended Application for the  
referenced hearing which is set for July 20, 1988.

Very truly yours,



W. Thomas Kellahin

WTK:ca  
Enc.

cc: Mr. Jerry R. Carter, Jr.  
Union Pacific Resources Company  
1000 Louisiana, Suite 3000  
Houston, Texas 77002

All parties listed in application

KELLAHIN, KELLAHIN and AUBREY

*Attorneys at Law*

W. Thomas Kellahin  
Karen Aubrey

El Patio - 117 North Guadalupe  
Post Office Box 2265

Telephone 982-4285  
Area Code 505

Jason Kellahin  
Of Counsel

Santa Fé, New Mexico 87504-2265

June 28, 1988

Mr. William J. LeMay  
Oil Conservation Commission  
P. O. Box 2088  
Santa Fe, New Mexico 87504

"Hand Delivered"

Re: Union Pacific Resources Company  
for an Unorthodox Subsurface  
Location and Approval to  
Intentionally Deviate Wellbore  
Lea County, New Mexico

Dear Mr. LeMay:

On behalf of Union Pacific Resources Company, please set the enclosed application for hearing at the next available examiner's docket now set for July 20, 1988.

We suggest the following to be used for the advertisement for this case:

Application of Union Pacific Resources Company for an unorthodox subsurface location and directional drilling, Lea County, New Mexico. Applicant in the above styled cause seeks approval to plug back its State 26 No. 2 Well to 9,900 feet and then commence drilling directionally to penetrate the top of the Devonian Formation at a true vertical depth of approximately 12,900 feet and within a 150 foot radius of an unorthodox subsurface location 1910 feet from the South line and 2580 feet from the East line of Section 26, T10S, R33E, with the N/2SE/4 of said section being dedicated to its State 26 #2 Well, forming a standard 80-acre oil spacing and proration unit for said pool. Said location is approximately \_\_\_\_\_ miles \_\_\_\_\_ of \_\_\_\_\_, New Mexico.

By copy of this letter and application sent certified mail return-receipt to all offset operators, we are notifying each of them of the right to appear at the hearing either in support or in opposition to this



KELLAHIN, KELLAHIN & AUBREY

Mr. William J. LeMay  
June 28, 1988  
Page 2

application. Should any such party desire more information about this matter or about the procedures to hearing this application, they may call the Division or the undersigned.

Very truly yours,

A handwritten signature in black ink, appearing to read "W. Thomas Kellahin". The signature is written in a cursive style with a large initial "W".

W. Thomas Kellahin

WTK:ca

cc: Mr. Jerry R. Carter, Jr.  
Union Pacific Resources Company  
1000 Louisiana, Suite 3000  
Houston, Texas 77002

Sec. \_\_\_\_\_ Township No. \_\_\_\_\_ of Range No. \_\_\_\_\_

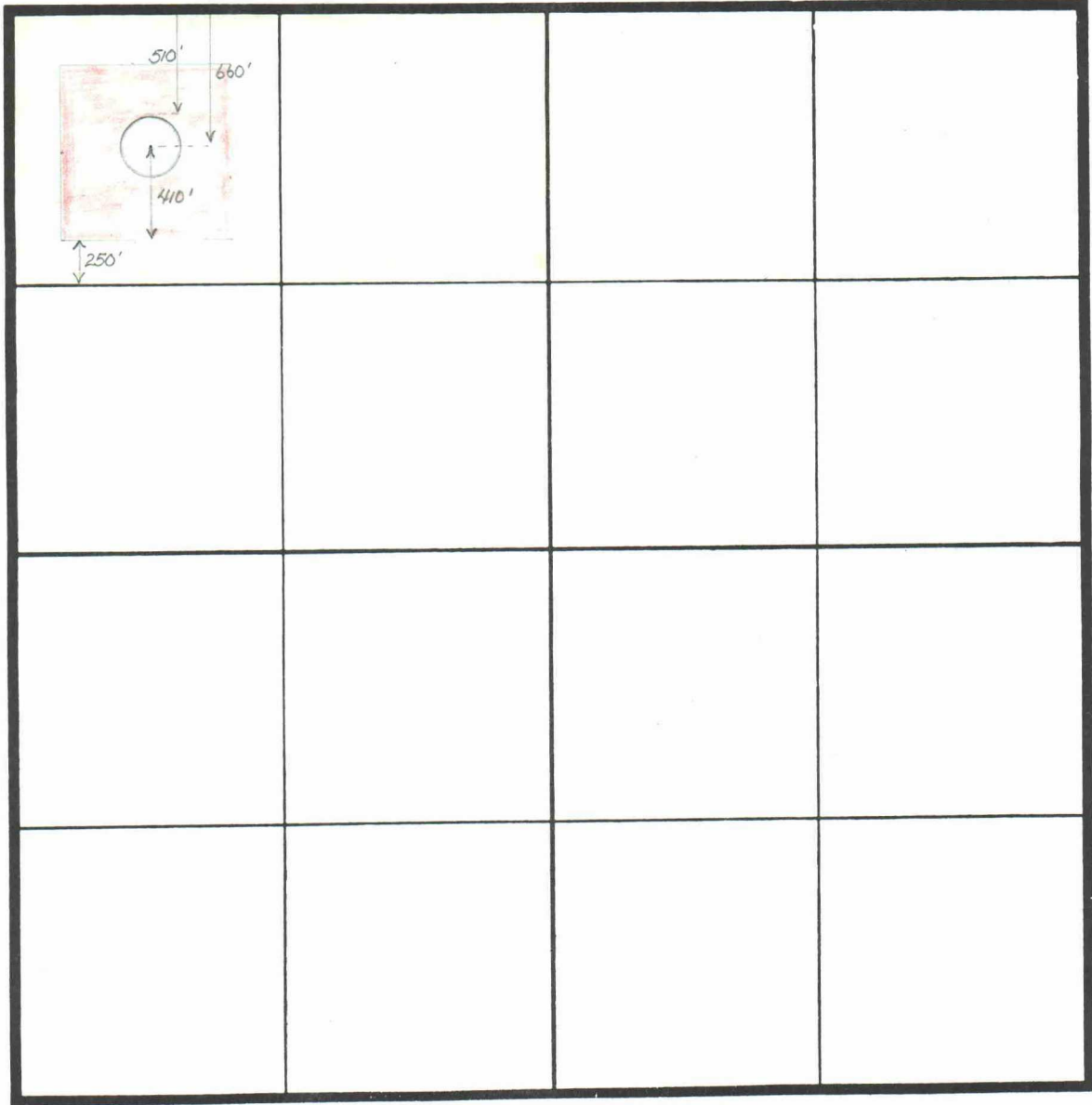

Case 9439

ROYALTY AND MINERAL RECORD

File No. \_\_\_\_\_

Twp. 10 South Rge. 33 East County Lea State New Mex.

Fee

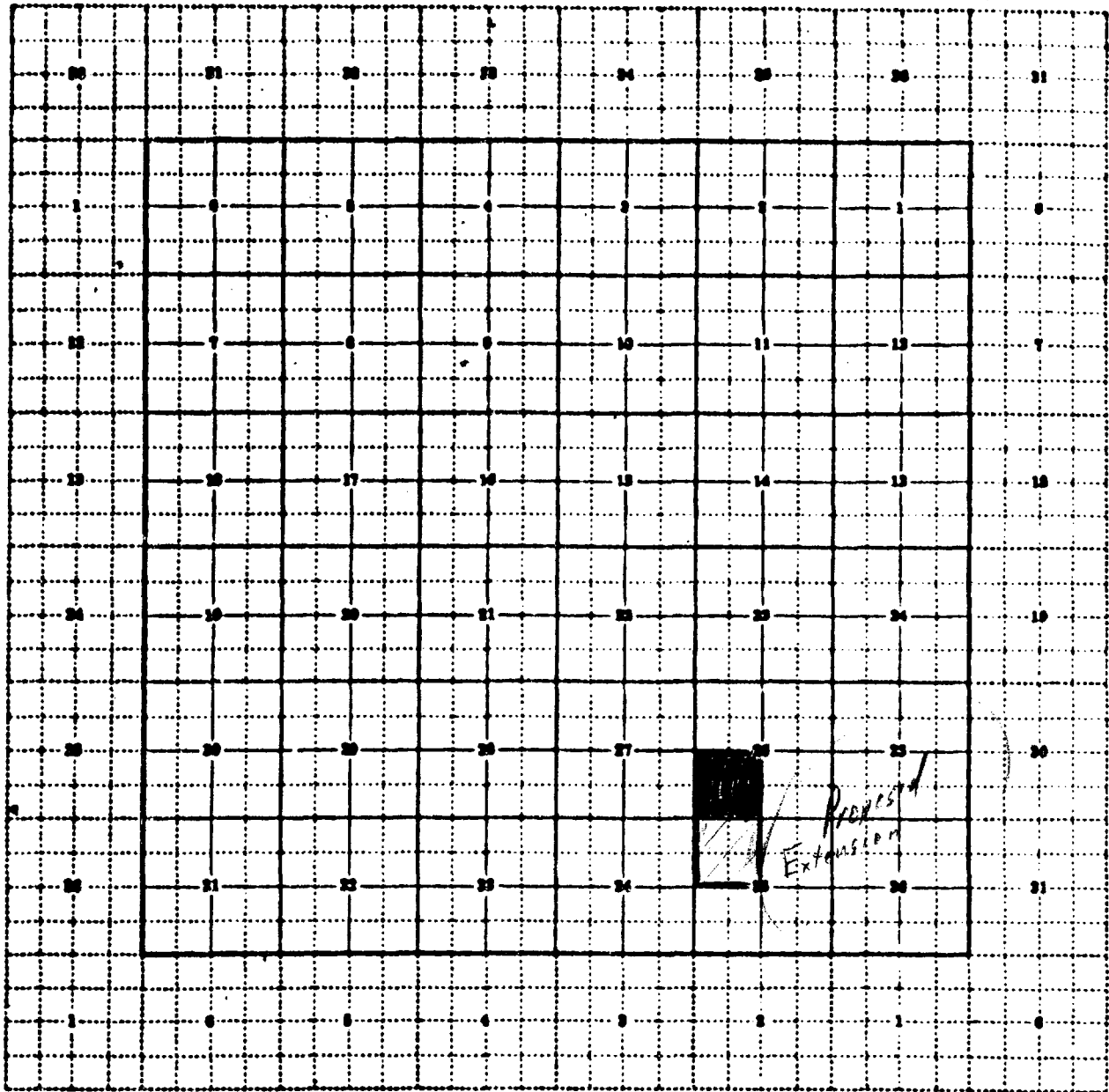

Description of Lands

Vada ~~From~~ Donovan SW/4 Sec. 26 (R-8667, 6/10/85)

Total Acres \_\_\_\_\_