

NEW MEXICO OIL CONSERVATION COMMISSION
WELL LOCATION AND ACREAGE DEDICATION PLAT

Form C-102
Supersedes C-128
Effective 1-1-65

All distances must be from the outer boundaries of the Section.

Operator Union Pacific Resources Co.		Lease State 26		Well No. 2
Unit Letter J	Section 26	Township 10 South	Range 33 East	County Lea
Actual Footage Location of Well: 1910 feet from the South line and 1980 feet from the East line				
Ground Level Elev. 4199.0	Producing Formation	Pool	Dedicated Acreage: Acres	

1. Outline the acreage dedicated to the subject well by colored pencil or hachure marks on the plat below.
2. If more than one lease is dedicated to the well, outline each and identify the ownership thereof (both as to working interest and royalty).
3. If more than one lease of different ownership is dedicated to the well, have the interests of all owners been consolidated by communitization, unitization, force-pooling, etc?

Yes No If answer is "yes," type of consolidation _____

If answer is "no," list the owners and tract descriptions which have actually been consolidated. (Use reverse side of this form if necessary.) _____

No allowable will be assigned to the well until all interests have been consolidated (by communitization, unitization, forced-pooling, or otherwise) or until a non-standard unit, eliminating such interests, has been approved by the Commission.

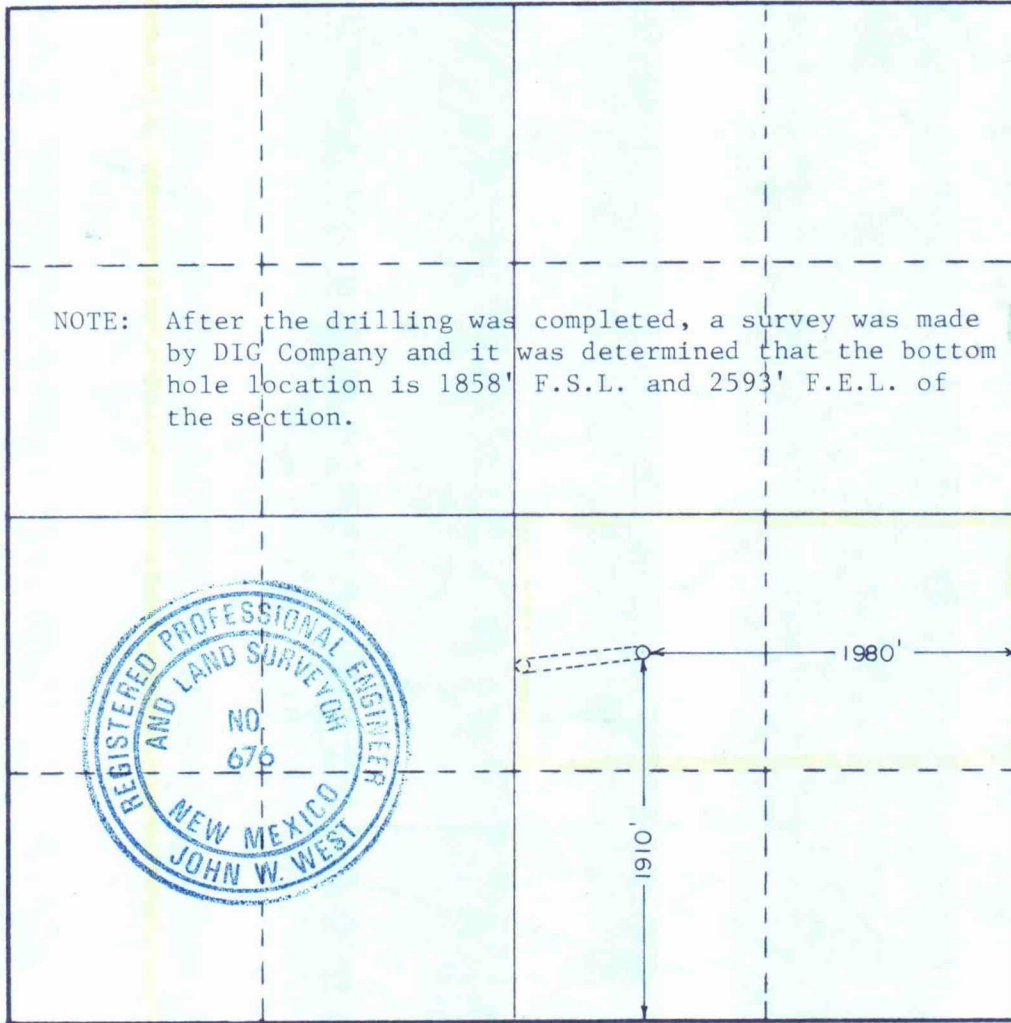

NOTE: After the drilling was completed, a survey was made by DIG Company and it was determined that the bottom hole location is 1858' F.S.L. and 2593' F.E.L. of the section.

CERTIFICATION

I hereby certify that the information contained herein is true and complete to the best of my knowledge and belief.

Name

Position

UNION PACIFIC RESOURCES

EXHIBIT NO. 4

DOCKET NO. 9439 & 9440

DATE 8-17-88

I hereby certify that the well location shown on this plat was plotted from field notes of actual surveys made by me or under my supervision, and that the same is true and correct to the best of my knowledge and belief.

Date Surveyed

August 15, 1988

Registered Professional Engineer and/or Land Surveyor

John W. West

Certificate No. JOHN W. WEST, 676
RONALD J. EIDSON, 3239

Deviation Angles
Vada (Devonian) Pool
Lea County, New Mexico

Approximate Depth	26 - 1	26 - 2 Straight	26 - 2 Side-Track
500	0.75 - 6.5	0.00 - 0	0.00
1,000	1.00 8.7	0.90 7.85	0.90
1,500	0.75 6.5	1.00 8.7	1.00
2,000	6.5	0.20 1.7	0.20
2,500	0.25 2.2	0.30 2.6	0.30
3,000	2.2	0.90 7.8	0.90
3,500	1.25 10.9	0.40 3.5	0.40
4,000	0.75 6.5	0.20 1.7	0.20
4,500	6.5	0.25 2.2	0.25
5,000	0.25 2.2	0.75 6.5	0.75
5,500	2.2	1.00 8.7	1.00
6,000	0.75 6.5	1.00 8.7	1.00
6,500	0.75 2.2	1.25 10.9	1.25
7,000	2.2	1.25 10.9	1.25
7,500	1.00 8.7	1.25 10.9	1.25
8,000	1.00 8.7	1.00 8.7	1.00
8,500	1.00 8.7	1.50 13.0	1.50
9,000	3.7	1.00 8.7	1.00
9,500	1.00 8.7	1.25 10.9	1.25
10,000	2.2	1.50 13.0	5.75
10,500	1.25 10.9	2.25 19.6	10.00
11,000	1.75 15.3	3.25 28.4	9.50
11,500	3.25 28.4	3.75 32.7	9.75
12,000	5.00 44.0	3.00 26.2	12.75
12,500	6.00 52.5	4.50 39.3	15.00
TD	7.25 32	3.50 18.3	14.75

-10142
322'

310'

UNION PACIFIC RESOURCES

EXHIBIT NO. 5

DOCKET NO. 9439 & 9440

DATE 8-17-88

FEB 02 1968

PRODUCTION DEPARTMENT

Deviation surveys taken on Wolverine Exploration's UPRC State 24-26
#1 well in Lea County, New Mexico:

<u>Depth</u>	<u>Degree</u>
468	.75
1333	1.00
163-	.75
2582	.25
3563	1.25
4153	.75
5109	.25
6102	.75
6497	.75
7453	1.00
8070	1.00
8716	1.00
9699	1.00
10,638	1.25
10,864	1.75
11,485	2.25
11,591	3.25
11,645	3.25
11,688	4.25
11,721	4.00
11,820	4.25
11,895	4.25
11,976	4.75
12,067	5.00
12,159	5.50
12,254	6.00
12,302	5.50
12,385	5.50
12,483	6.00
12,656	6.75
12,698	7.00
12,800	7.25

I hereby certify that I have personal knowledge of the facts placed
on this sheet and that such information given above is true and complete.

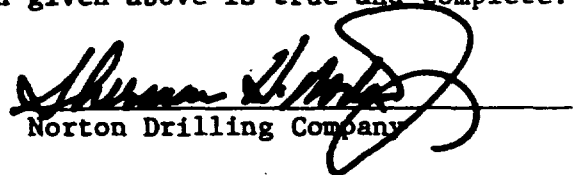
Norton Drilling Company

Before me, the undersigned authority, on this day personally appeared
Sherman H. Norton, Jr., known to me to be the person whose name is
subscribed hereto, who, after being duly sworn, on oath states that he

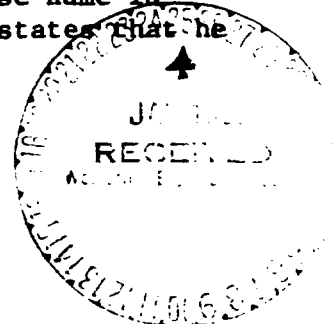

UNION PACIFIC RESOURCES

WELL # :
STATE NO. 28-2 *Straight stake*

LOCATION :
LEA COUNTY, NEW MEXICO

DATE :
8/28/88

JOB TYPE :
GYRO, MULTISHOT

JOB # :
08-2087

SURVEYOR :
MASSEY, HENRIK

DEPTHS :
0 - 4200. 4200 - 12887

DECL. :
10 DEGREES EAST

ELEV. :
0'

FILE # :
VT-KK7

FINAL STATION DATA

MD. 12887.00
TVD. 12881.31
N/S -137.23
E/W -191.18

CLOSURE DISTANCE
235.33 FEET
CLOSURE DIRECTION
S 54.33 W

1 IN. = 50 FT.

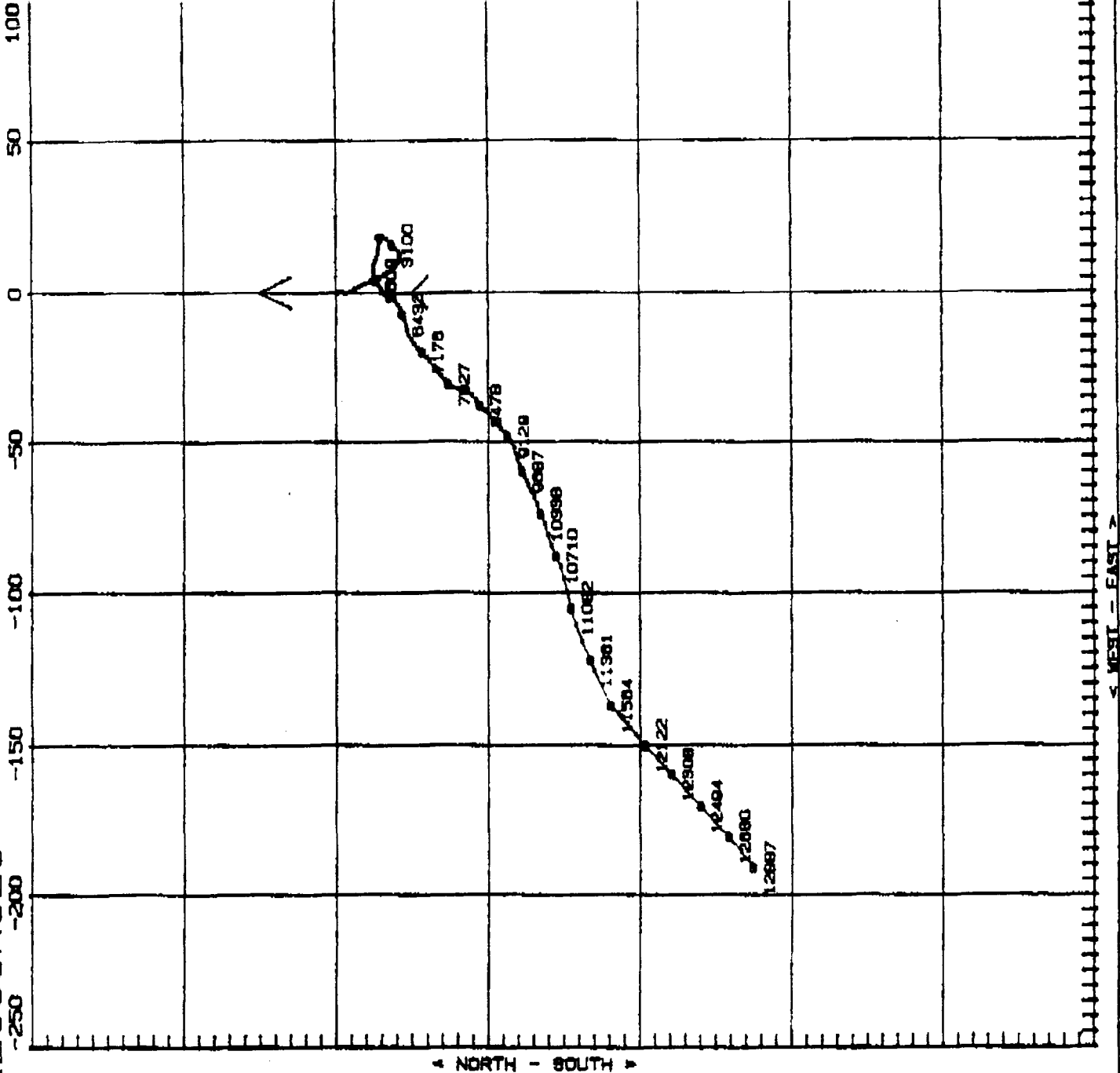

UNION PACIFIC RESOURCES
 STATE NO. 26-2
 WT-KK7

PAGE 1
 03:47:24
 00708700

MEASURED DEPTH FEET	INCL. ANGLE DEGS.	HOLE DIRECTION DEGS.	COURSE LENGTH FEET	VERTICAL DEPTH FEET	N/S	E/W	DISTANCE FEET	DIRECTION DEGS.	DOG-LEG SEVERITY
0.00	0.00	*** ** *	0.00	0.00	0.00	N	0.00'	00.00 E	0.00
100.00	.20	S 01.00 E	100.00	100.00	.17	S	.17'	S 01.00 E	.20
200.00	.30	S 22.00 E	100.00	200.00	.60	S	.61'	S 08.49 E	.13
300.00	.20	S 15.00 E	100.00	300.00	1.01	S	1.04'	S 12.68 E	.10
400.00	.30	S 01.00 E	100.00	400.00	1.44	S	1.47'	S 11.30 E	.12
500.00	0.00	*** ** *	100.00	500.00	1.71	S	1.73'	S 09.75 E	.30
600.00	.10	S 26.00 E	100.00	600.00	1.78	S	1.81'	S 10.52 E	.10
700.00	.20	S 33.00 W	100.00	700.00	2.03	S	2.06'	S 08.83 E	.17
800.00	.30	S 35.00 W	100.00	800.00	2.40	S	2.40'	S 01.72 E	.10
900.00	.80	S 17.00 E	100.00	899.99	3.31	S	3.31'	S 01.26 W	.60
1000.00	.90	S 39.00 E	100.00	999.98	4.61	S	4.66'	S 07.64 E	.34
1100.00	.80	S 17.00 E	100.00	1099.97	5.92	S	6.06'	S 12.50 E	.34
1200.00	.90	S 27.00 E	100.00	1199.96	7.29	S	7.52'	S 14.36 E	.18
1300.00	.70	S 35.00 E	100.00	1299.95	8.49	S	8.87'	S 16.94 E	.23
1400.00	.70	S 09.00 E	100.00	1399.94	9.61	S	10.38'	S 17.55 E	.31
1500.00	1.00	S 27.00 E	100.00	1499.93	11.01	S	11.55'	S 17.61 E	.40
1600.00	1.00	S 08.00 E	100.00	1599.91	12.62	S	13.29'	S 17.59 E	.33
1700.00	1.00	S 37.00 E	100.00	1699.90	14.27	S	15.01'	S 18.16 E	.50
1800.00	.80	S 29.00 E	100.00	1799.89	15.50	S	16.53'	S 19.55 E	.24
1900.00	.80	S 37.00 E	100.00	1899.88	16.75	S	17.89'	S 20.59 E	.11
2000.00	.20	S 21.00 E	100.00	1999.87	17.51	S	18.76'	S 20.98 E	.61
2100.00	.70	S 38.00 E	100.00	2099.87	18.19	S	19.53'	S 21.32 E	.51
2200.00	.50	S 59.00 E	100.00	2199.86	18.88	S	20.46'	S 22.65 E	.29
2300.00	.80	S 40.00 E	100.00	2299.86	19.62	S	21.48'	S 24.01 E	.37
2400.00	.80	S 69.00 E	100.00	2399.85	20.42	S	22.68'	S 25.78 E	.40

UNION PACIFIC RESOURCES
 STATE NO. 26-2
 WT-KK7

PAGE 2
 03:48:20
 00/00/00

P04

MEASURED	INCL.	HOLE	COURSE	VERTICAL	TRUE	REGULAR	C L O S U R E	DUG-LEG
DEPTH	ANGLE	DIRECTION	LENGTH	DEPTH		DISTANCE	DIRECTION	SEVERITY
FEET	DEGS.	DEGS.	FEET	FEET		FEET	DEGS.	DG/100FT
2500.00	.30	S 62.00 E	100.00	2499.84		23.42'	S 27.28 E	.50
2600.00	.40	S 81.00 E	100.00	2599.84		23.86'	S 28.30 E	.15
2700.00	.30	N 65.00 E	100.00	2699.84		24.08'	S 29.64 E	.23
2800.00	.30	S 82.00 E	100.00	2799.84		24.27'	S 30.78 E	.17
2900.00	.90	N 46.00 E	100.00	2899.83		24.51'	S 33.09 E	.75
3000.00	.90	N 34.00 E	100.00	2999.82		24.10'	S 36.66 E	.19
3100.00	.70	N 45.00 E	100.00	3099.81		23.81'	S 39.92 E	.25
3200.00	.90	N 53.00 E	100.00	3199.80		23.82'	S 43.27 E	.23
3300.00	.80	N 45.00 E	100.00	3299.79		23.93'	S 46.82 E	.15
3400.00	.50	N 07.00 W	100.00	3399.78		23.50'	S 49.26 E	.63
3500.00	.40	N 25.00 W	100.00	3499.78		22.85'	S 50.34 E	.17
3600.00	.10	N 64.90 W	100.00	3599.78		22.42'	S 50.45 E	.33
3700.00	.20	N 71.00 E	100.00	3699.78		22.30'	S 50.87 E	.28
3800.00	.20	N 35.00 E	100.00	3799.78		22.39'	S 51.73 E	.12
3900.00	.30	N 11.00 E	100.00	3899.78		22.28'	S 52.80 E	.14
4000.00	.28	S 67.00 W	100.00	3999.77		21.92'	S 52.83 E	.44
4100.00	.20	S 07.00 E	100.00	4099.77		21.96'	S 51.99 E	.24
4200.00	0.00	* * * * *	100.00	4199.77		22.09'	S 51.67 E	.20
4293.00	.25	S 78.00 W	93.00	4292.77		21.96'	S 51.26 E	.27
4386.00	0.00	* * * * *	93.00	4385.77		21.83'	S 50.85 E	.27
4479.00	.25	S 29.00 E	93.00	4478.77		22.02'	S 50.65 E	.27
4572.00	.25	S 08.00 W	93.00	4571.77		22.33'	S 49.99 E	.17
4665.00	.50	N 38.00 W	93.00	4664.77		22.06'	S 48.97 E	.75
4758.00	.75	N 82.00 W	93.00	4757.76		21.08'	S 48.46 E	.56
4851.00	1.00	N 88.00 W	93.00	4850.75		19.96'	S 46.03 E	.29

SURVEY DATA FROM 4293' - 12887' OBTAINED FROM SMITH INTERNATIONAL

06

27

88

01 : 50

PM

* E

P

UNION PACIFIC RESOURCES
STATE NO. 26-2
WT-KK7

PAGE 3
03:49:12
09/08/80

07
0
A

MEASURED INCL. HOLE COURSE VERTICAL X E C T A N G U L A R E L D S U R E D D G - L E G
DEPTH ANGLE DIRECTION HOLE LENGTH COURSE VERTICAL X E C T A N G U L A R E L D S U R E D D G - L E G
FEET DEGS. DEGS. FEET FEET FEET N/S DEGS. FEET DEGS. FEET DEGS. FEET DEGS. FEET DEGS.

4944.00	1.25	N 76.00 W	93.00	4943.73	13.61 S	12.56 E	18.52'	S 42.72 E	.37
5037.00	.75	N 72.00 W	93.00	5036.72	13.16 S	11.00 E	17.15'	S 39.90 E	.54
5130.00	.75	N 61.00 W	93.00	5129.71	12.67 S	9.89 E	16.07'	S 37.96 E	.15
5223.00	1.00	N 86.00 W	93.00	5222.70	12.27 S	8.54 E	14.95'	S 34.82 E	.48
5316.00	1.00	N 83.00 W	93.00	5315.69	12.12 S	6.92 E	13.96'	S 29.73 E	.06
5409.00	1.00	S 73.00 W	93.00	5408.67	12.26 S	5.32 E	13.36'	S 23.44 E	.45
5502.00	1.00	S 59.00 W	93.00	5501.66	12.92 S	3.84 E	13.47'	S 16.54 E	.26
5595.00	1.00	S 52.00 W	93.00	5594.64	13.84 S	2.50 E	14.06'	S 10.24 E	.13
5688.00	.75	S 59.00 W	93.00	5687.63	14.64 S	1.33 E	14.70'	S 05.19 E	.29
5781.00	.50	S 71.00 W	93.00	5780.63	15.07 S	.41 E	15.07'	S 01.57 E	.36
5874.00	.75	S 41.00 W	93.00	5873.62	15.83 S	.42 W	15.63'	S 01.53 W	.43
5967.00	1.00	S 14.00 W	93.00	5966.61	16.88 S	1.07 W	16.91'	S 03.62 W	.51
6060.00	.75	S 32.00 W	93.00	6059.60	18.18 S	1.62 W	18.25'	S 05.10 W	.40
6153.00	1.00	S 58.00 W	93.00	6152.59	19.17 S	2.62 W	19.35'	S 07.77 W	.50
6246.00	1.00	S 56.00 W	93.00	6245.58	20.06 S	3.98 W	20.45'	S 11.22 W	.04
6339.00	1.25	S 63.00 W	93.00	6338.56	20.98 S	5.55 W	21.71'	S 14.82 W	.31
6432.00	1.00	S 76.00 W	93.00	6431.54	21.62 S	7.26 W	22.81'	S 18.55 W	.38
6525.00	1.25	S 59.00 W	93.00	6524.52	22.32 S	8.94 W	24.04'	S 21.82 W	.45
6618.00	1.25	S 83.00 W	93.00	6617.50	22.97 S	10.84 W	25.40'	S 25.26 W	.56
6711.00	1.00	S 80.00 W	93.00	6710.48	23.24 S	12.65 W	26.46'	S 28.55 W	.28
6804.00	1.00	S 61.00 W	93.00	6803.47	23.78 S	14.17 W	27.68'	S 30.79 W	.35
6897.00	1.00	S 52.00 W	93.00	6896.45	24.68 S	15.52 W	29.15'	S 32.17 W	.17
6990.00	1.25	S 64.00 W	93.00	6989.44	25.64 S	17.07 W	30.80'	S 33.65 W	.37
7083.00	1.00	S 43.00 W	93.00	7082.42	26.72 S	18.53 W	32.52'	S 34.73 W	.51
7176.00	1.50	S 44.00 W	93.00	7175.39	28.20 S	19.92 W	34.52'	S 35.25 W	.54

06.27.88

01:56 PM

* P

UNION PACIFIC RESOURCES
STATE NO. 26-2
WT-KK7

PAGE 4
03:50:05
00/00/00

MEASURED INCL. HOLE COURSE VERTICAL R E C T A M B U L A R C L O S U R E DUG-LEG
DEPTH ANGLE DIRECTION LENGTH DEPTH DEPTH COORDINATES DISTANCE DIRECTION SEVERITY
FEET DEGS. FEET FEET FEET N/S Feet E/W FEET DEGS. FEET DEGS. FEET/100FT

7269.00	1.00	S 55.00 W	93.00	7268.37	29.51 S	21.46 W	36.49'	S 36.93 W	.59
7362.00	1.25	S 49.00 W	93.00	7361.35	30.53 S	22.90 W	38.25'	S 36.78 W	.30
7455.00	1.50	S 53.00 W	93.00	7454.33	32.04 S	24.64 W	40.42'	S 37.56 W	.29
7548.00	1.25	S 55.00 W	93.00	7547.30	33.35 S	26.44 W	42.56'	S 38.41 W	.27
7641.00	1.00	S 46.00 W	93.00	7640.28	34.51 S	27.85 W	44.35'	S 38.90 W	.33
7734.00	1.25	S 59.00 W	93.00	7733.26	35.62 S	29.30 W	46.12'	S 39.44 W	.38
7827.00	1.25	S 44.00 W	93.00	7826.24	36.88 S	30.88 W	48.10'	S 39.94 W	.35
7920.00	1.00	S 26.00 W	93.00	7919.22	38.37 S	31.92 W	49.91'	S 39.76 W	.46
8013.00	1.00	S 03.00 W	93.00	8012.21	39.93 S	32.32 W	51.37'	S 38.99 W	.43
8106.00	1.00	S 14.00 W	93.00	8105.20	41.53 S	32.56 W	52.78'	S 38.10 W	.21
8199.00	1.00	S 31.00 W	93.00	8198.18	43.03 S	33.18 W	54.34'	S 37.64 W	.32
8292.00	1.50	S 45.00 W	93.00	8291.16	44.62 S	34.43 W	56.36'	S 37.55 W	.63
8385.00	1.25	S 60.00 W	93.00	8384.13	45.98 S	36.19 W	58.51'	S 38.21 W	.47
8478.00	1.50	S 49.00 W	93.00	8477.11	47.27 S	38.01 W	60.66'	S 38.88 W	.39
8571.00	1.25	S 44.00 W	93.00	8570.08	48.81 S	39.63 W	62.87'	S 39.07 W	.30
8664.00	1.25	S 45.00 W	93.00	8663.06	50.25 S	41.05 W	64.89'	S 39.24 W	.92
8757.00	1.25	S 60.00 W	93.00	8756.03	51.48 S	42.65 W	66.86'	S 39.64 W	.35
8850.00	1.25	S 53.00 W	93.00	8849.01	52.60 S	44.34 W	68.90'	S 40.13 W	.16
8943.00	1.25	S 37.00 W	93.00	8941.99	54.03 S	45.77 W	70.82'	S 40.27 W	.37
9036.00	1.00	S 45.00 W	93.00	9034.97	55.41 S	46.97 W	72.64'	S 40.29 W	.32
9129.00	1.00	S 66.00 W	93.00	9127.96	56.32 S	48.30 W	74.20'	S 40.62 W	.39
9222.00	1.50	S 54.00 W	93.00	9220.94	57.34 S	50.06 W	76.11'	S 41.12 W	.68
9315.00	1.25	S 71.00 W	93.00	9313.91	58.36 S	52.03 W	78.19'	S 41.72 W	.51
9408.00	1.25	S 83.00 W	93.00	9406.89	58.82 S	54.00 W	79.85'	S 42.55 W	.28
9501.00	1.25	S 63.00 W	93.00	9499.86	59.41 S	55.93 W	81.59'	S 43.27 W	.47

06

P

* P

PM

01:58

06:27:88

UNION PACIFIC RESOURCES
 STATE NO. 26-2
 NY-KK?

PAGE 5
 03:50:57
 00/00/00

MEASURED INCL.	HOLE	COURSE	VERTICAL	TRUE	N/S	feet	E/W	FEET	DIRECTION	DEGS.	90-LEG
DEPTH	ANGLE	LENGTH	DEPTH								SEVERITY
FEET	DEGS.	FEET	FEET								90/100FT
9594.00	1.50	S 74.00 W	93.00	9592.84	66.23 S	58.00 W		83.62'	S 43.92 W		.39
9687.00	1.25	S 63.00 W	93.00	9685.81	61.04 S	60.08 W		85.65'	S 44.54 W		.39
9780.00	1.00	S 66.00 W	93.00	9778.79	61.83 S	61.73 W		87.37'	S 44.95 W		.28
9873.00	1.00	S 67.00 W	93.00	9871.78	62.48 S	63.21 W		88.98'	S 45.34 W		.02
9966.00	1.00	S 70.00 W	93.00	9964.76	63.07 S	64.72 W		90.37'	S 45.74 W		.05
10059.00	1.50	S 61.00 W	93.00	10057.74	63.91 S	66.57 W		92.28'	S 46.17 W		.58
10152.00	1.50	S 62.00 W	93.00	10150.71	65.07 S	68.71 W		94.63'	S 46.56 W		.03
10245.00	2.00	S 76.00 W	93.00	10243.57	66.09 S	71.35 W		97.26'	S 47.19 W		.70
10338.00	2.00	S 64.00 W	93.00	10336.61	67.20 S	74.40 W		100.25'	S 47.91 W		.45
10431.00	2.25	S 74.00 W	93.00	10429.55	68.43 S	77.61 W		103.47'	S 48.60 W		.48
10524.00	2.25	S 73.00 W	93.00	10522.47	69.47 S	81.11 W		106.79'	S 49.42 W		.04
10617.00	2.50	S 69.00 W	93.00	10615.39	70.72 S	84.76 W		110.39'	S 50.16 W		.32
10710.00	2.25	S 61.00 W	93.00	10708.31	72.35 S	88.25 W		114.11'	S 50.65 W		.45
10803.00	2.25	S 73.00 W	93.00	10801.24	73.77 S	91.60 W		117.61'	S 51.15 W		.51
10896.00	2.50	S 77.00 W	93.00	10894.16	74.77 S	95.32 W		121.15'	S 51.89 W		.32
10989.00	3.25	S 74.00 W	93.00	10987.05	75.94 S	99.84 W		125.44'	S 52.74 W		.82
11082.00	3.50	S 77.00 W	93.00	11079.88	77.31 S	105.14 W		130.50'	S 53.67 W		.33
11175.00	3.50	S 74.00 W	93.00	11172.71	78.73 S	110.63 W		135.79'	S 54.56 W		.20
11268.00	3.50	S 64.00 W	93.00	11265.54	80.76 S	115.93 W		141.29'	S 55.14 W		.66
11361.00	5.00	S 68.00 W	93.00	11358.28	83.56 S	122.22 W		148.06'	S 55.64 W		1.54
11401.00	5.25	S 72.00 W	40.00	11398.12	84.79 S	125.58 W		151.52'	S 55.97 W		1.09
11564.00	3.75	S 56.00 W	163.00	11560.61	90.37 S	137.04 W		164.15'	S 56.60 W		1.19
11657.00	.75	S 37.00 W	93.00	11653.53	92.88 S	139.67 W		167.73'	S 56.38 W		3.28
11750.00	.75	S 62.00 W	93.00	11746.52	93.56 S	140.59 W		168.93'	S 56.33 W		.35
11843.00	.50	S 37.00 W	93.00	11839.52	94.31 S	141.36 W		169.93'	S 56.29 W		.39

P 07

P * PM 01:56

06.27.88

UNION PACIFIC RESOURCES
STATE NO. 26-2
WT-KK7

PAGE 6
03:31:50
00/00/00

MEASURED	INCL.	HOLE	COURSE	VERTICAL	TRUE	N/S	feet	E/W	FEET	DIRECTION	DEGS.	DG/100FT
DEPTH	ANGLE	DIRECTION	LENGTH	DEPTH								
FEET	DEGS.	DEGS.	FEET	FEET								
11939.00	2.25	S 59.00 W	96.00	11935.48		95.85	S	143.06	W	172.20'	S 56.18 W	1.87
12029.00	3.00	S 50.00 W	90.00	12025.39		98.24	S	146.41	W	176.31'	S 56.14 W	.95
12122.00	3.50	S 47.00 W	93.00	12118.24		101.73	S	150.36	W	181.54'	S 55.92 W	.57
12215.00	4.00	S 47.00 W	93.00	12211.04		105.88	S	154.81	W	187.55'	S 55.63 W	.54
12308.00	4.25	S 47.00 W	93.00	12303.80		110.35	S	159.78	W	194.18'	S 55.37 W	.31
12401.00	4.50	S 48.00 W	93.00	12396.53		115.06	S	165.09	W	201.23'	S 55.13 W	.28
12494.00	4.50	S 48.00 W	93.00	12489.24		119.94	S	170.51	W	208.47'	S 54.88 W	0.00
12587.00	4.25	S 48.00 W	93.00	12581.97		124.68	S	175.79	W	215.51'	S 54.65 W	.27
12680.00	4.00	S 47.00 W	93.00	12674.23		129.20	S	180.72	W	222.15'	S 54.44 W	.28
12773.00	3.75	S 54.00 W	93.00	12767.52		133.20	S	185.56	W	228.42'	S 54.33 W	.57
12866.00	3.25	S 55.00 W	93.00	12860.34		136.50	S	190.19	W	234.10'	S 54.33 W	.54
12887.00	3.50	S 52.00 W	21.00	12881.31		137.23	S	191.18	W	235.33'	S 54.33 W	1.46

CLOSURE DISTANCE = 235.33 FEET.
CLOSURE DIRECTION = S 54.33 W

RECEIVED

AUG 03 1988

PRODUCTION DEPARTMENT

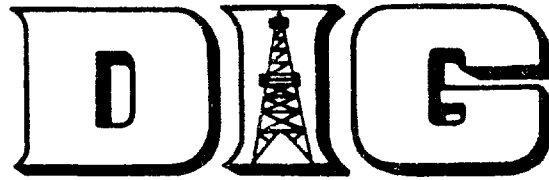

SUB-SURFACE
DIRECTIONAL
SURVEY
REPORT

UNION PACIFIC RESOURCES

COMPANY

STATE WELL 26 NO. 2 *Soda Stack*

WELL NAME

LEA COUNTY, NEW MEXICO

STATE AND COUNTY

CERTIFIED REPORT

UNION PACIFIC RECORDERS

WELL #
STATE WELL 26 NC.C

LOCATION
LEA COUNTY, NEW MEXICO

DATE
6-26-88 TO 7-30-88

JOB TYPE
SYRS. MMS. RMS

JOB #
CS-2087, SMITH, 45-2098

SURVEYOR
MASSEY, SMITH, MASSEY

DEPTHS
0-4200, 4200-9873, 9873-12953

DECL.
10 DEGREES EAST

ELEV.
4217

FILE #
WT-4K7S

FINAL STATION DATA

NO. 12953.00
TVD. 12895.89
N/S -51.93
E/W -613.48

CLOSURE DISTANCE
615.68 FEET
CLOSURE DIRECTION
S 85.18 W

1 IN. = 200 FT.

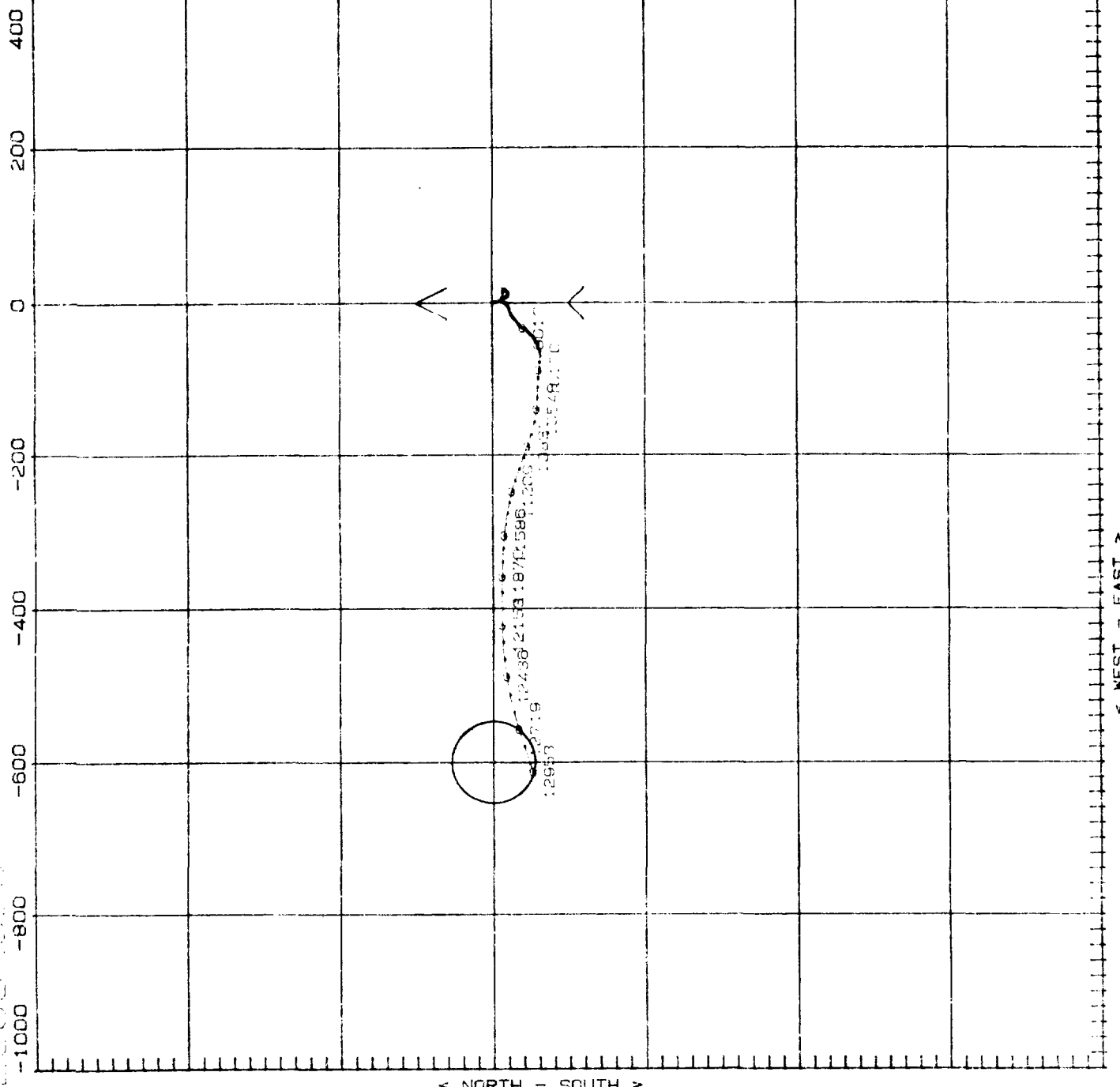

CUSTOMER : UNION PACIFIC RESOURCES
 WELL # : STATE WELL 26 NO.2
 LOCATION : LEA COUNTY, NEW MEXICO
 DATE : 6-26-88 TO 7-30-88
 JOB TYPE : GYRO, MMS, MMS
 JOB # : GS-2087, SMITH, MS-2098
 SURVEYOR : MASSEY, SMITH, MASSEY
 DEPTHS : 0-4200, 4200-9873, 9873-12953
 DECL. : 10 DEGREES EAST
 ELEV. : 4217'
 FILE # : WT-KK75

METHOD : RADIUS OF CURVATURE
 SECTION : N90W

FINAL STATION DATA!

MEASURED	INCL.	HOLE	COURSE	VERTICAL	SUBSEA	DEPTH	FEET	FEET	N/S	FEET	E/W	FEET	DEGS.
12953.00	10.75	5 72.10 W	45.00	12895.33	0.72.53	0	613.40	0	51.73	0	513.40	0	516.03
													0.0

THIS SURVEY IS CORRECT TO THE
 BEST OF MY KNOWLEDGE AND IS
 SUPPORTED BY ACTUAL FIELD DATA.
Larry Massey
 DIG REPRESENTATIVE

MEASURED DEPTH FEET	INCL. ANGLE DEGS.	HOLE DIRECTION DEGS.	COURSE LENGTH FEET	TRUE VERTICAL DEPTH FEET	SURSEA DEPTH FEET	VERTICAL SECTION FEET	N/S	E/W	RECTANGULAR DISTANCE FEET	C L O S U R E DIRECTION DEGS.	00C-LIE SEVERE 0C/100
0.00	0.00	S 01.00 E	0.00	0.00	-4217.00	0.00	0.00	0.00	0.00	N 00.00 E	0.00
100.00	.20	S 01.00 E	100.00	100.00	-4117.00	-0.00	.17	S	.17	S 01.00 E	.20
200.00	.30	S 22.00 E	100.00	200.00	-4017.00	-0.09	.60	S	.61	S 08.49 E	.13
300.00	.20	S 15.00 E	100.00	300.00	-3917.00	-0.23	1.01	S	1.04	S 12.68 E	.11
400.00	.30	S 01.00 E	100.00	400.00	-3817.00	-0.29	1.14	S	1.47	S 11.30 E	.11
500.00	0.00	S 26.00 E	100.00	500.00	-3717.00	-0.29	1.71	S	1.73	S 09.75 E	.31
600.00	.10	S 26.00 E	100.00	600.00	-3617.00	-0.33	1.78	S	1.81	S 10.52 E	.11
700.00	.20	S 33.00 W	100.00	700.00	-3517.00	-0.32	2.03	S	2.06	S 08.83 E	.11
800.00	.30	S 35.00 W	100.00	800.00	-3417.00	-0.07	2.46	S	2.40	S 01.72 E	.11
900.00	.80	S 17.00 E	100.00	899.99	-3317.01	.07	3.31	S	3.31	S 01.26 W	.61
1000.00	.90	S 39.00 E	100.00	999.98	-3217.02	-0.62	4.61	S	4.56	S 07.64 E	.31
1100.00	.80	S 17.00 E	100.00	1099.97	-3117.03	-1.31	5.92	S	5.06	S 12.50 E	.31
1200.00	.90	S 27.00 E	100.00	1199.96	-3017.04	-1.87	7.29	S	7.52	S 14.36 E	.11
1300.00	.70	S 35.00 E	100.00	1299.95	-2917.05	-2.58	8.49	S	8.87	S 15.94 E	.21
1400.00	.70	S 39.00 E	100.00	1399.94	-2817.06	-3.04	9.61	S	10.08	S 17.55 E	.31
1500.00	1.00	S 27.00 E	100.00	1499.93	-2717.07	-3.50	11.01	S	11.55	S 17.61 E	.41
1600.00	1.00	S 08.00 E	100.00	1599.91	-2617.09	-4.02	12.67	S	13.29	S 17.59 E	.31
1700.00	1.50	S 37.00 E	100.00	1699.90	-2517.10	-5.68	14.27	S	15.91	S 13.16 E	.51
1800.00	.80	S 29.00 E	100.00	1799.89	-2417.11	-6.53	15.88	S	16.53	S 19.55 E	.21
1900.00	.80	S 37.00 E	100.00	1899.88	-2317.12	-6.29	16.75	S	17.89	S 20.59 E	.31
2000.00	.20	S 21.00 E	100.00	1999.87	-2217.13	-6.71	17.51	S	18.76	S 20.98 E	.61
2100.00	.70	S 38.00 E	100.00	2099.87	-2117.13	-7.10	18.19	S	19.53	S 21.32 E	.51
2200.00	.50	S 29.00 E	100.00	2199.86	-2017.14	-7.98	18.88	S	20.46	S 22.65 E	.61
2300.00	.30	S 40.00 E	100.00	2299.86	-1917.14	-8.74	19.62	S	21.43	S 24.01 E	.61
2400.00	.60	S 29.00 E	100.00	2399.85	-1817.15	-9.65	20.42	S	22.68	S 25.48 E	.41

UNION PACIFIC RESOURCES
 STATE WELL 26 NO.2
 WT-KK75

PAGE 2
 00:42:39
 00/00/00

MEASURED INCL. HOLE DIRECTION COURSE LENGTH VERTICAL DEPTH SURSEA DEPTH VERTICAL SECTION RECORDING PARAMETERS CLOSURE DISTANCE DIRECTION DEGS. DEGS.
 FEET ANGLE DECS. DECS. FEET FEET FEET FEET N/S FEET E/W FEET FEET DEGS.

2500.00	.30	S 52.00 E	100.00	2499.84	-1717.16	-10.74	20.32 S	10.74 E	23.42	S 27.28 E	.50
2600.00	.40	S 81.00 E	100.00	2599.84	-1617.16	-11.31	21.01 S	11.31 E	23.86	S 28.30 E	.15
2700.00	.30	N 55.00 E	100.00	2699.84	-1517.16	-11.91	20.93 S	11.91 E	24.08	S 29.64 E	.22
2800.00	.30	S 82.00 E	100.00	2799.84	-1417.16	-12.42	20.85 S	12.42 E	24.27	S 30.78 E	.17
2900.00	.90	N 46.00 E	100.00	2899.83	-1317.17	-13.38	20.54 S	13.38 E	24.51	S 33.09 E	.72
3000.00	.90	N 34.00 E	100.00	2999.82	-1217.18	-14.39	19.34 S	14.39 E	24.10	S 36.66 E	.19
3100.00	.70	N 45.00 E	100.00	3099.81	-1117.19	-15.28	18.26 S	15.28 E	23.81	S 39.92 E	.25
3200.00	.90	N 53.00 E	100.00	3199.80	-1017.20	-16.33	17.34 S	16.33 E	23.82	S 43.27 E	.23
3300.00	.80	N 45.00 E	100.00	3299.79	-917.21	-17.45	16.37 S	17.45 E	23.93	S 46.82 E	.15
3400.00	.50	N 07.00 W	100.00	3399.78	-817.22	-17.90	15.34 S	17.80 E	23.50	S 49.26 E	.63
3500.00	.40	N 25.00 W	100.00	3499.78	-717.22	-17.59	14.58 S	17.59 E	22.85	S 50.34 E	.17
3500.00	.10	N 54.00 W	100.00	3599.78	-617.22	-17.29	14.28 S	17.29 E	22.42	S 50.45 E	.33
3700.00	.20	N 71.00 E	100.00	3699.78	-517.22	-17.30	14.07 S	17.30 E	22.30	S 50.87 E	.28
3800.00	.20	N 35.00 E	100.00	3799.78	-417.22	-17.58	13.87 S	17.58 E	22.39	S 51.73 E	.12
3900.00	.30	N 11.00 E	100.00	3899.78	-317.22	-17.74	13.47 S	17.74 E	22.28	S 52.80 E	.14
4000.00	.20	S 57.00 W	100.00	3999.77	-217.23	-17.47	13.24 S	17.47 E	21.92	S 52.83 E	.44
4100.00	.20	S 07.00 E	100.00	4099.77	-117.23	-17.31	13.53 S	17.31 E	21.96	S 51.99 E	.24
4200.00	0.00	* * * * *	100.00	4199.77	-17.23	-17.33	13.70 S	17.33 E	22.09	S 51.67 E	.20

SURVEY DATA FROM 4293' - 9873' OBTAINED FROM SMITH INTERNATIONAL

4293.00	.25	S 78.00 W	93.00	4292.77	75.77	-17.13	13.74 S	17.13 E	21.96	S 51.26 E	.27
4386.00	0.00	* * * * *	93.00	4395.77	168.77	-16.93	13.78 S	16.93 E	21.83	S 50.85 E	.27
4479.00	.25	S 29.00 E	93.00	4476.77	261.77	-17.03	13.96 S	17.03 E	22.02	S 50.65 E	.27
4572.00	.25	S 08.00 W	93.00	4571.77	354.77	-17.10	14.35 S	17.10 E	22.30	S 49.99 E	.17
4665.00	.50	N 38.00 W	93.00	4664.77	447.77	-16.94	14.48 S	16.94 E	22.96	S 48.97 E	.75
4758.00	.75	N 32.00 W	93.00	4757.76	540.76	-16.76	13.98 S	16.78 E	21.88	S 48.46 E	.66
4851.00	1.00	N 39.00 W	93.00	4850.75	633.75	-14.37	13.86 S	14.37 E	19.96	S 45.83 E	.25

UNION PACIFIC RESOURCES
 STATE WELL 26 NO.2
 WT-KK75

PAGE 3
 00:43:36
 00/00/00

MEASURED DEPTH FEET	INCL. ANGLE DEGS.	HOLE DIRECTION DEGS.	COURSE LENGTH FEET	TRUE VERTICAL DEPTH FEET	SURSEA DEPTH FEET	VERTICAL SECTION FEET	N/S	CORDINATION	W/E	FEET	DISTANCE FEET	COURSE DIRECTION	W/E	DEGS.	DOG-LE SEVERI
4944.00	1.25	N 76.00 W	93.00	4943.73	726.73	-12.56	13.61	S	12.56	E	18.52	S	42.72	E	.35
5037.00	.75	N 72.00 W	93.00	5036.72	819.72	-11.00	13.16	S	11.00	E	17.15	S	39.90	E	.57
5130.00	.75	N 51.00 W	93.00	5129.71	912.71	-9.89	12.67	S	9.89	E	16.07	S	37.96	E	.11
5223.00	1.00	N 86.00 W	93.00	5222.70	1005.70	-8.54	12.27	S	8.54	E	14.95	S	34.82	E	.48
5316.00	1.00	N 93.00 W	93.00	5315.69	1098.69	-6.92	12.12	S	6.92	E	13.96	S	29.73	E	.03
5409.00	1.00	S 73.00 W	93.00	5408.67	1191.67	-5.32	12.26	S	5.32	E	13.36	S	23.44	E	.41
5502.00	1.00	S 59.00 W	93.00	5501.66	1284.66	-3.84	12.92	S	3.84	E	13.47	S	16.54	E	.21
5595.00	1.00	S 52.00 W	93.00	5594.64	1377.64	-2.50	13.84	S	2.50	E	14.06	S	10.24	E	.11
5688.00	.75	S 59.00 W	93.00	5687.63	1470.63	-1.33	14.64	S	1.33	E	14.70	S	05.19	E	.29
5781.00	.50	S 71.00 W	93.00	5780.63	1563.63	-.41	15.07	S	.41	E	13.07	S	01.57	E	.31
5874.00	.75	S 41.00 W	93.00	5873.62	1656.62	.42	15.63	S	.42	W	15.63	S	01.53	W	.48
5967.00	1.00	S 14.00 W	93.00	5966.61	1749.61	1.07	16.88	S	1.07	W	16.91	S	03.62	W	.51
6060.00	.75	S 32.00 W	93.00	6059.60	1842.60	1.62	18.18	S	1.62	W	18.25	S	05.10	W	.41
6153.00	1.00	S 58.00 W	93.00	6152.59	1935.59	2.62	19.17	S	2.62	W	17.35	S	07.77	W	.51
6246.00	1.00	S 56.00 W	93.00	6245.58	2028.58	3.98	20.06	S	3.98	W	20.45	S	11.22	W	.07
6339.00	1.25	S 53.00 W	93.00	6338.56	2121.56	5.55	20.93	S	5.55	W	21.71	S	14.82	W	.31
6432.00	1.00	S 76.00 W	93.00	6431.54	2214.54	7.26	21.62	S	7.26	W	22.81	S	18.55	W	.51
6525.00	1.25	S 59.00 W	93.00	6524.52	2307.52	8.74	22.32	S	8.74	W	24.04	S	21.82	W	.48
6618.00	1.25	S 83.00 W	93.00	6617.50	2400.50	10.84	22.97	S	10.84	W	25.40	S	25.26	W	.51
6711.00	1.00	S 90.00 W	93.00	6710.48	2493.48	12.65	23.24	S	12.65	W	26.46	S	28.85	W	.28
6804.00	1.00	S 61.00 W	93.00	6803.47	2586.47	14.17	23.78	S	14.17	W	27.58	S	30.79	W	.35
6897.00	1.00	S 52.00 W	93.00	6896.45	2679.45	15.52	24.68	S	15.52	W	29.15	S	32.17	W	.17
6990.00	1.25	S 54.00 W	93.00	6989.44	2772.44	17.07	25.64	S	17.07	W	30.80	S	33.65	W	.37
7083.00	1.00	S 43.00 W	93.00	7082.42	2865.42	18.53	26.72	S	18.53	W	32.52	S	34.73	W	.51
7176.00	1.50	S 44.00 W	93.00	7175.39	2958.39	19.92	28.20	S	19.92	W	34.52	S	35.25	W	.54

UNION PACIFIC RESOURCES
 STATE WELL 26 NO.2
 WT-KK79

PAGE 4
 00:44:32
 00/00/00

MEASURED INCL ANGLE DEGS. HOLE DIRECTION DEGS. COURSE LENGTH FEET TRUE VERTICAL DEPTH FEET SUBSEA DEPTH FEET VERTICAL SECTION FEET RECORDING N/S FEET E/W DEGS. C L O S U R E DISTANCE FEET SEVER DEGS.

7269.00	1.00	S	55.00	W	93.00	7268.37	3051.37	21.46	29.51	S	21.46	W	36.49	S	36.03	W	000-L
7362.00	1.25	S	49.00	W	93.00	7361.35	3144.35	22.90	30.63	S	22.90	W	38.25	S	36.78	W	SEVER
7455.00	1.50	S	53.00	W	93.00	7454.33	3237.33	24.04	32.04	S	24.04	W	40.42	S	37.56	W	06/10
7548.00	1.25	S	55.00	W	93.00	7547.30	3330.30	26.44	33.35	S	26.44	W	42.56	S	38.41	W	DEGS.
7641.00	1.00	S	46.00	W	93.00	7640.28	3423.28	27.85	34.51	S	27.85	W	44.35	S	38.90	W	
7734.00	1.25	S	59.00	W	93.00	7733.26	3516.26	29.30	35.62	S	29.30	W	46.12	S	39.44	W	
7827.00	1.25	S	44.00	W	93.00	7826.24	3609.24	30.88	36.88	S	30.88	W	48.10	S	39.94	W	
7920.00	1.00	S	26.00	W	93.00	7919.22	3702.22	31.92	38.37	S	31.92	W	49.91	S	39.76	W	
8013.00	1.00	S	03.00	W	93.00	8012.21	3795.21	32.32	39.93	S	32.32	W	51.37	S	38.99	W	
8106.00	1.00	S	14.00	W	93.00	8105.20	3888.20	32.56	41.53	S	32.56	W	52.79	S	38.10	W	
8199.00	1.00	S	31.00	W	93.00	8198.18	3981.18	33.18	43.03	S	33.18	W	54.34	S	37.64	W	
8292.00	1.50	S	45.00	W	93.00	8291.16	4074.16	34.43	44.62	S	34.43	W	56.36	S	37.55	W	
8385.00	1.25	S	60.00	W	93.00	8384.13	4167.13	36.19	45.98	S	36.19	W	58.51	S	38.21	W	
8478.00	1.50	S	49.00	W	93.00	8477.11	4260.11	38.01	47.27	S	38.01	W	60.66	S	38.00	W	
8571.00	1.25	S	44.00	W	93.00	8570.08	4353.08	39.53	48.81	S	39.53	W	62.87	S	39.07	W	
8664.00	1.25	S	45.00	W	93.00	8663.06	4446.06	41.05	50.25	S	41.05	W	64.89	S	39.24	W	
8757.00	1.25	S	50.00	W	93.00	8756.03	4539.03	42.55	51.48	S	42.55	W	66.96	S	39.64	W	
8850.00	1.25	S	53.00	W	93.00	8849.01	4632.01	44.34	52.60	S	44.34	W	69.00	S	40.13	W	
8943.00	1.25	S	37.00	W	93.00	8941.99	4724.99	45.77	54.03	S	45.77	W	70.82	S	40.27	W	
9036.00	1.00	S	45.00	W	93.00	9034.97	4817.97	46.97	55.41	S	46.97	W	72.64	S	40.29	W	
9129.00	1.00	S	66.00	W	93.00	9127.96	4910.96	48.30	56.32	S	48.30	W	74.20	S	40.62	W	
9222.00	1.50	S	54.00	W	93.00	9220.94	5003.94	50.06	57.34	S	50.06	W	76.11	S	41.12	W	
9315.00	1.25	S	71.00	W	93.00	9313.91	5096.91	52.93	58.36	S	52.93	W	78.19	S	41.72	W	
9408.00	1.25	S	33.00	W	93.00	9406.89	5189.89	54.80	58.92	S	54.80	W	79.85	S	42.55	W	
9501.00	1.25	S	33.00	W	93.00	9499.86	5282.86	55.93	59.41	S	55.93	W	81.59	S	43.27	W	

MEASURED DEPTH FEET	INCL. ANGLE DEGS.	HOLE DIRECTION DEGS.	COURSE LENGTH FEET	TRUE VERTICAL DEPTH FEET	SUBSEA DEPTH FEET	VERTICAL SECTION FEET	N/S	E/W	FEET	C L U S U R E DISTANCE FEET	DIRECTION DEGS.	DUG/10
9594.00	1.50	S 74.00 W	93.00	9592.84	5375.24	58.00	60.23	S	58.00	83.62	S 43.92 W	.3
9687.00	1.25	S 63.00 W	93.00	9685.81	5468.31	60.98	61.04	S	60.98	85.65	S 44.54 W	.3
9780.00	1.00	S 66.00 W	93.00	9778.79	5561.79	61.73	61.83	S	61.73	87.37	S 44.95 W	.2
9873.00	1.00	S 67.00 W	93.00	9871.78	5654.78	63.21	62.48	S	63.21	88.88	S 45.34 W	.0
9982.00	4.75	N 32.00 W	109.00	9980.62	5763.62	68.57	63.18	S	68.57	93.24	S 47.34 W	3.6
10076.00	5.75	N 83.00 W	94.00	10074.23	5857.23	77.09	62.06	S	77.09	98.97	S 51.17 W	1.0
10170.00	6.25	N 85.00 W	94.00	10167.71	5950.71	86.87	61.03	S	86.87	106.16	S 54.91 W	.5
10265.00	7.25	N 85.00 W	95.00	10262.05	6045.05	97.99	60.06	S	97.99	114.93	S 58.50 W	1.0
10359.00	8.00	N 88.00 W	94.00	10355.22	6138.22	110.44	59.30	S	110.44	125.35	S 61.77 W	.9
10454.00	9.00	N 86.00 W	95.00	10449.18	6232.18	124.46	58.56	S	124.46	137.55	S 64.80 W	1.1
10548.00	10.00	N 87.00 W	94.00	10541.39	6326.39	139.94	57.61	S	139.94	151.34	S 67.62 W	1.0
10642.00	10.50	N 79.00 W	94.00	10634.38	6417.38	156.53	55.88	S	156.53	166.11	S 70.45 W	1.6
10737.00	10.50	N 72.00 W	95.00	10727.79	6510.79	173.28	51.25	S	173.28	180.70	S 73.53 W	1.3
10831.00	10.00	N 71.00 W	94.00	10820.29	6603.29	189.15	45.94	S	189.15	194.64	S 76.35 W	.5
10926.00	9.75	N 70.00 W	95.00	10913.39	6696.39	204.50	40.50	S	204.50	208.47	S 78.80 W	.3
11020.00	9.50	N 69.00 W	94.00	11006.56	6789.56	219.22	35.00	S	219.22	222.00	S 80.93 W	.3
11114.00	9.75	N 71.00 W	94.00	11099.24	6882.24	233.59	29.52	S	233.59	235.86	S 82.79 W	.4
11209.00	9.00	N 75.00 W	95.00	11192.97	6975.97	248.79	25.10	S	248.79	250.95	S 84.24 W	1.0
11303.00	9.00	N 79.00 W	94.00	11285.81	7068.81	263.11	21.79	S	263.11	264.01	S 85.27 W	.5
11398.00	8.75	N 80.00 W	95.00	11378.57	7162.57	277.52	19.12	S	277.52	278.18	S 86.06 W	.3
11492.00	8.75	N 82.00 W	94.00	11472.58	7255.58	291.65	16.88	S	291.65	292.13	S 86.89 W	.3
11586.00	9.75	N 84.00 W	94.00	11565.36	7348.36	306.64	15.04	S	306.64	307.01	S 87.19 W	1.1
11681.00	10.25	N 87.00 W	95.00	11658.91	7441.91	323.09	13.75	S	323.09	323.58	S 87.56 W	.7
11775.00	11.25	N 87.00 W	94.00	11751.26	7534.26	340.60	12.83	S	340.60	340.84	S 87.84 W	1.0
11870.00	11.75	N 89.00 W	95.00	11844.36	7627.36	359.52	12.17	S	359.52	359.73	S 88.06 W	.6

UNION PACIFIC RESOURCES
 STATE WELL 26 NO.2
 WT-KK7S

MEASURED INCL. HOLE DIRECTION DEGS. ANGLE DEGS. DEPTH FEET COURSE LENGTH FEET TRUE VERTICAL DEPTH FEET SUBSEA DEPTH FEET VERTICAL SECTION FEET R E C T A N G L A R S E C T I O N N / S D E G S. E / W D I S T A N C E F E E T C L O S U R E D I S T A N C E F E E T D I R E C T I O N D E G S. D I R E C T I O N D E G S. U. R. E. D O S. L. I. S E V E R D G / 1 0

MEASURED	INCL.	HOLE	DIRECTION	DEGS.	ANGLE	DEPTH	COURSE	LENGTH	TRUE	VERTICAL	SUBSEA	DEPTH	VERTICAL	SECTION	N/S	D E G S.	E/W	D I S T A N C E	C L O S U R E	D I R E C T I O N	D E G S.	D I R E C T I O N	D E G S.	U. R. E.	D O S. L. I.	S E V E R	D G / 1 0	
11964.00	13.00	N	89.00	W	94.00	11936.17	94.00	7719.17	379.66	11.82	S	379.66	W	379.66	11.82	S	379.66	W	379.66	S	88.22	W	379.66	S	88.22	W	379.66	1.31
12058.00	12.75	N	90.00	W	94.00	12027.91	94.00	7810.51	400.51	11.63	S	400.51	W	400.51	11.63	S	400.51	W	400.51	S	88.34	W	400.51	S	88.34	W	400.51	1.31
12153.00	13.00	S	88.00	W	95.00	12120.42	95.00	7903.42	421.77	12.00	S	421.77	W	421.77	12.00	S	421.77	W	421.77	S	88.37	W	421.77	S	88.37	W	421.77	1.51
12247.00	13.75	S	86.00	W	94.00	12211.87	94.00	7994.87	443.49	13.14	S	443.49	W	443.49	13.14	S	443.49	W	443.49	S	88.30	W	443.49	S	88.30	W	443.49	1.91
12342.00	13.75	S	83.00	W	95.00	12304.15	95.00	8087.15	465.96	15.30	S	465.96	W	465.96	15.30	S	465.96	W	465.96	S	86.12	W	465.96	S	86.12	W	465.96	1.71
12436.00	14.25	S	82.00	W	94.00	12395.35	94.00	8178.35	488.51	18.27	S	488.51	W	488.51	18.27	S	488.51	W	488.51	S	87.86	W	488.51	S	87.86	W	488.51	1.51
12530.00	15.00	S	79.00	W	94.00	12486.31	94.00	8269.31	511.91	22.19	S	511.91	W	511.91	22.19	S	511.91	W	511.91	S	87.52	W	511.91	S	87.52	W	511.91	1.11
12625.00	14.25	S	75.00	W	95.00	12578.23	95.00	8361.23	535.23	27.58	S	535.23	W	535.23	27.58	S	535.23	W	535.23	S	87.05	W	535.23	S	87.05	W	535.23	1.31
12719.00	14.25	S	73.00	W	94.00	12669.34	94.00	8452.34	557.52	33.96	S	557.52	W	557.52	33.96	S	557.52	W	557.52	S	86.51	W	557.52	S	86.51	W	557.52	1.51
12814.00	14.50	S	72.00	W	95.00	12761.36	95.00	8544.36	580.91	41.05	S	580.91	W	580.91	41.05	S	580.91	W	580.91	S	85.95	W	580.91	S	85.95	W	580.91	1.31
12908.00	14.75	S	72.00	W	94.00	12852.32	94.00	8635.32	602.59	48.39	S	602.59	W	602.59	48.39	S	602.59	W	602.59	S	85.41	W	602.59	S	85.41	W	602.59	1.21
12953.00	14.75	S	72.00	W	45.00	12895.83	45.00	8678.83	613.48	51.93	S	613.48	W	613.48	51.93	S	613.48	W	613.48	S	85.16	W	613.48	S	85.16	W	613.48	0.01

CLOSURE DISTANCE = 615.68 FEET.
 CLOSURE DIRECTION = S 35.16 W

Reservoir Volumetric Analysis Summary
Vada (Devonian) Pool

<u>Field</u>	Avg. Rec. Factor - % (40 Acres)	Avg. Rec. Factor - % (80 Acres)
<u>Bagley (Devonian)</u>	58.4%	29.2%
Wells - 25 ; 11 Wells Active		
Avg. Rec./Well- 1079 MBO		
Spacing Rules - 80 acres		
Avg. Net Pay - 288 ft.		
Avg. Water Sat.-51.6%		
Form. Volume Factor -1.03		
Avg. Porosity - 4.4%		
<u>Caprock, East (Devonian)</u>	85.7%	42.9%
Wells - 27 ; 6 Wells Active		
Avg. Rec./Well- 846 MBO		
Spacing Rules - 40 acres		
Avg. Net Pay - 65 ft.		
Avg. Water Sat.-28%		
Form. Volume Factor -1.03		
Avg. Porosity - 7.0%		
<u>Mescalero (Devonian)</u>	89.2%	44.6%
Wells - 8 ; 2 Wells Active		
Avg. Rec./Well- 722 MBO		
Spacing Rules - 40 acres		
Avg. Net Pay - 70 ft.		
Avg. Water Sat.-52%		
Form. Volume Factor -1.03		
Avg. Porosity - 8.0%		
<u>Moore (Devonian)</u>	67.0%	33.5%
Wells - 19 ; 7 Wells Active		
Avg. Rec./Well- 1086 MBO		
Spacing Rules - 40 acres		
Avg. Net Pay - 140 ft.		
Avg. Water Sat.-24%		
Form. Volume Factor -1.03		
Avg. Porosity - 8.0%		
<u>Vada (Devonian)</u>	75.7%	37.8%
Wells - 2; 1 Well Active		
Avg. Rec./Well- 400 MBO		
Spacing Rules - Proposed 80 acres		
Avg. Net Pay - 75 ft.		
Avg. Water Sat.-28%		
Form. Volume Factor -1.03		
Avg. Porosity - 3.25%		

UNION PACIFIC RESOURCES
EXHIBIT NO. 6
DOCKET NO. 9439 & 9440
DATE 8-17-88

Vada (Devonian) Pool
State 26 No. 1
August, 1988

Day	Rate		Pressure (PSIG)	Choke Size (Inch)	Comments
	BOPD	RWPD			
01	217	0.0	7.9	652	7/64p
02	217	0.0	7.2	650	7/64p
03	217	0.0	6.1	650	7/64p
04	215	1.1	5.98	650	7/64p
05	219	0.0	6.4	650	7/64p
06	205	0.0	5.4	652	7/64p
07	214	0.0	6.6	650	7/64p
08	199	0.0	5.9	650	7/64p
09	219	0.0	6.7	650	7/64p
10					
11	250	0.0	6.7	650	7/64p
12	217	0.0	5.8	650	7/64p
13	225	0.0	6.2	650	7/64p
14					
15					
16					
17					
18					
19					
20					
21					
22					
23					
24					
25					
26					
27					
28					
29					
30					
31					

Total:

Avg:

Cums:

RABSTA

a - adjustable choke
p -

positive

choke

UNION PACIFIC RESOURCES

EXHIBIT NO. 7DECKET NO. 9439 & 9440DATE 8-17-88

Vada (Devonian) Pool
State 26 No. 1
July, 1988

Day	Rate		Pressure (PSIG)	Choke Size (INCH)	Comments
	ROPD	BWPD			
01	510	0.0	13.3	640	10/64a
02	432	0.0	14.7	610	10/64a
03	456	4.6	12.3	550	10/64a
04	440	2.3	12.6	535	10/64a
05	315	1.0		620	8/64p
06	231	3.0	9.0	635	8/64p
					Decr.choke size to limit wtr
					Treat tanks. Circ. 26 BSW
					From oil tank. Down 5 hours
07	312	0.75	9.0	640	8/64p
08	317	0.5	7.5	645	8/64p
09	317	0.0	9.3	650	8/64p
10	322	0.0	9.2	650	8/64p
11	289	0.0	8.8	650	8/64p
12	329	0.0	9.7	650	8/64p
13	331	0.58	9.0	650	8/64p
14	313	0.5	8.9	650	8/64p
15	317	0.0	9.1	650	8/64p
16	296	0.0	9.0	650	8/64p
17	307	0.0	8.9	650	8/64p
18	343	0.0	10.7	650	8/64p
19	294	0.0	8.9	645	8/64p
20	317	1.0	9.1	650	8/64p
21	343	1.0	8.7	610	8/64p
22	293	0.0	9.0	595	8/64p
23	278	0.0	4.5	580	8/64p
24	304	1.7	8.5	570	8/64p
25	286	3.0	7.6	560	8/64p
26	283	2.3	7.2	545	8/64p
27	206	0.0	6.1	610	7/64p
28	206	2.9	6.1	635	7/64p
29	200	0.0	6.0	650	7/64p
30	204	0.0	7.1	652	7/64p
31	218	0.5	6.9	650	7/64p

Total: 9,609 BO 25.6 BW 266.7 MCF

Avg: 310 RO 0.8 BW 8.6 MCF

Cons: 66,397 BO 51.6 BW 552.5 MCF

a - adjustable choke
p - positive choke

Vada (Devonian) Pool
 State 26 No. 1
 June, 1988

Day	Rate ROPD	BWPD	MCFD	Pressure (PSIG)	Choke Size (INCH)	Comments
01	284	0.0	-			
02	367	0.0	-		6/64a	
03	618	0.0	24.6	625	12/64p	Tied in Gas
04	571	0.0	-	630	11/64p	
05	572	0.0	-	630	11/64p	
06	444	0.0	-	640	10/64p	
07	482	0.0	-	640	11/64p	
08	485	0.0	-	640	7.5/64a	Adj. choke
09	501	0.0	-	640	7.5/64a	
10	505	0.0	-		7.5/64a	
11	506	0.0	13.8	635	* P-38	
12	508	0.0	13.7	635	P-38	
13	504	0.0	13.4		P-38	
14	503	0.0	13.0	635	P-38	
15	507	0.0	12.3		P-38	
16	503	0.0	13.7	635	P-38	
17	502	0.0	11.8	640	P-38	
18	515	0.0	13.4	640	P-38	
19	491	0.0	13.8	640	P-38	
20	513	0.0	14.5		P-38	
21	504	0.0	12.0		P-38	
22	500	0.0	12.2	640	P-38	
23	510	0.0	12.3	640	P-38	
24	507	0.0	12.2	640	P-38	
25	498	0.0	13.8	640	P-38	
26	504	0.0	13.7		P-38	
27	505	0.0	13.9		P-38	
28	508	0.0	13.3	635	P-38	
29	499	0.0	11.2	640	P-38	
30	534	0.0	13.2	580	10.5/64a	

Total: 14,950 BO 285.8 MCF

Avg: 498 BO 13.6 MCF

Cums: 56,788 BO 285.8 MCF

* P-38 10.25/64

a - adjustable choke

p - positive choke

Vada (Devonian) Pool
 State 26 No. 1
 May, 1988

Day	Rate			Pressure (PSIG)	Choke Size (INCH)	Comments
	ROFD	BWPD	MCFD			
01	756	0.0	-		10/64a	
02	451	0.0	-		7/64a	
03	403	0.0	-			
04	490	0.0	-	640	7.5/64a	
05	530	0.0	-	640	7.5/64a	
06	403	0.0	-	640	7/64a	
07	418	0.0	-	640	7/64a	
08	425	0.0	-	640	7/64a	
09	433	0.0	-			
10	441	0.0	-	640	7/64a	
11	435	0.0	-	640	7/64a	
12	428	0.0	-	640	7/64a	
13	433	0.0	-	640	7/64a	
14	442	0.0	-	640	7/64a	
15	425	0.0	-	640	7/64a	
16	425	0.0	-			
17	422	0.0	-			
18	393	0.0	-			
19	402	0.0	-			
20	467	0.0	-	640	6.5/64a	
21	390	0.0	-	640	7/64a	
22	395	0.0	-	640	6.5/64a	
23	322	0.0	-			
24	342	0.0	-	640	6.5/64a	
25	347	0.0	-	640	6/64a	
26	355	0.0	-	640	6/64a	
27	388	0.0	-	640		
28	390	0.0	-	640	6.75/64a	
29	399	0.0	-	640	6.75/64a	
30	360	0.0	-	640	6.75/64a	Allowable Made
31	0	0.0	-	640	6.75/64a	

Total: 12,710 BO

Avg: 410 BO

Cums: 41,838 BO

a - adjustable choke
 p - positive choke

Vada (Devonian) Pool
State 26 No. 1
April, 1988

Day	Rate BOPD	Rate BWPD	MCFD	Pressure (PSIG)	Choke Size (INCH)	Comments
01						Installing LACT
02						
03						
04	402	0.0	-			Proving LACT
05	759	0.0	-	610	11/64	35.75BO/hr calc. 858 BOPD
06	791	0.0	-	610	11/64	
07	804	0.0	-			
08	462	0.0	-			
09	570	0.0	-			
10	480	0.0	-			
11	445	0.0	-			
12	592	0.0	-			Working on LACT
13	388	0.0	-			
14	497	0.0	-	640	7/64	
15	276	0.0	-	640	7/64	
16	373	0.0	-			
17	458	0.0	-	640	8/64	
18	446	0.0	-	640	8/64	
19	308	0.0	-	640	6/64	
20	441	0.0	-			
21	418	0.0	-			
22	463	0.0	-			
23	441	0.0	-			
24	425	0.0	-			
25	440	0.0	-			
26	407	0.0	-			Worked on LACT & proved meter
27	433	0.0	-			
28	464	0.0	-			
29	338	0.0	-			Made allowable
30	0	0.0	-			

Total: 12,321 BO

Avg: 474 BO

Cums: 29,128 BO

a - adjustable choke

p - positive choke

Vada (Devonian) Pool
 State 26 No. 1
 March, 1988

Day	Rate			Pressure (PSIG)	Choke Size (INCH)	Comments
	BOPD	BWPD	MCFD			
01						Full BHP, BU 45" 4797# 78 1/2 hr tst Leave SI pending Lease Sale
02						
03						
04						
05						
06						
07						
08	55					Prod. to use oil in acid job
09						
10						
11						
12						
13						
14						
15						Lease Sale
16	1353			160	3/4	Acid w/500g, used 137 BO
17	35					Tanks full
18						
19						Shrinkage & tank bottoms 55 BO
20	1233	0.0	-			
21	945	0.0	-			
22	1474	0.0	-			
23	967	0.0	-			
24	979	0.0	-			
25	971	0.0	-			
26	983	0.0	-			
27	500	0.0	-			
28	1462	0.0	-			
29	1449	0.0	-			
30	0	0.0	-			
31	498	0.0	-			

Total: 12,712 BO

Avg: 978 BO

Cums: 16,807 BO

a - adjustable choke

p - positive choke

Vada (Devonian) Pool
 State 26 No. 1
 February, 1988

Day	Rate			Pressure	Choke Size	Comments
	BOPD	BWPD	MCFD	(PSIG)	(INCH)	
01						
02						
03						
04						
05						
06						
07						
08						
09						
10						
11						
12						
13						878 BO from DST & Comp.
14	326	0.0	-	10	3/4a	
15	290	0.0	-	10	3/4a	
16	303	0.0	-	10		
17	257	0.0	-	10	1/2a	SI 15" TP 650 psig
18	194	0.0	-	10	1/2a	Valve leaked. Lk to pit
19	292	0.0	-	12	1/2a	
20	241	0.0	-	11	1/2a	SI 15" TP 550 psig
21	225	0.0	-	10	1/2a	
22	234	0.0	-	10	3/4a	
23	220	0.0	-	7	3/4a	
24	214	0.0	-	7	3/4a	
25	206	0.0	-	7	3/4a	
26	215	0.0	-	7	3/4a	SI for BHP tst. 20" 660 psig
27						
28						
29						

Total: 4,095 BO

Avg: 247 BO

Cums: 4,095 BO

a - adjustable choke
 p - positive choke

Sec. _____ Township No. _____ of Range No. _____

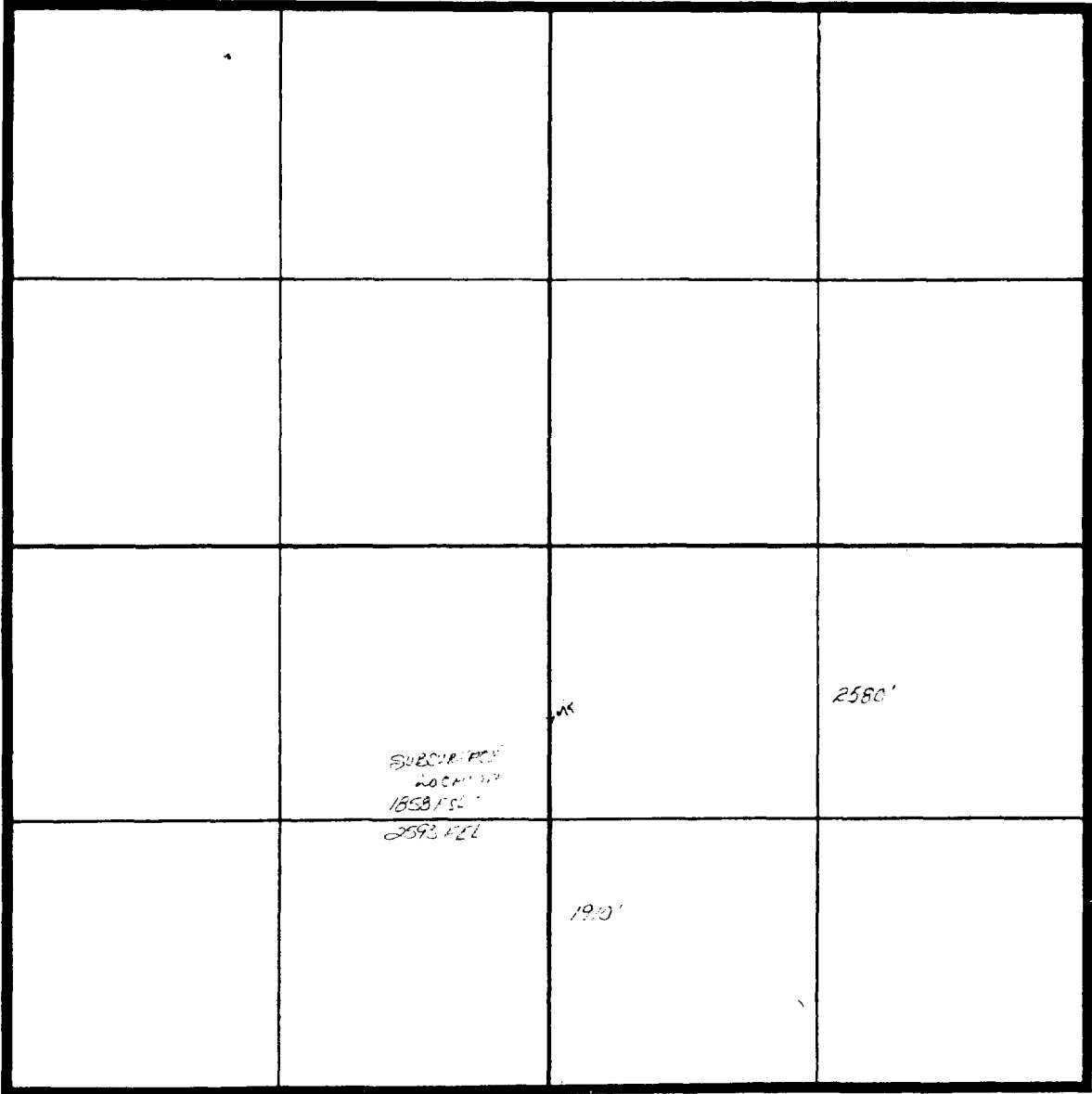

REGISTRATION DIVISION
RECEIVED
'90 MAR 15 AM 9 06

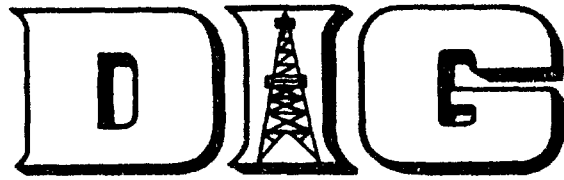

*Case file for
R-8771*

**SUB-SURFACE
DIRECTIONAL
SURVEY
REPORT**

Case 9440

Western Reserves Oil Co. Inc
UNION PACIFIC RESOURCES

COMPANY
STATE WELL 26 NO. 2

WELL NAME
LEA COUNTY, NEW MEXICO

STATE AND COUNTY

SL: 1980/E + 1910/S

26-10-33

BHL: 1858/S + 2593/E

OK

W. Stover

CERTIFIED REPORT

UNION PACIFIC RESOURCES

WELL # 1
STATE WELL 28 NO. 2

LOCATION 1
LEA COUNTY, NEW MEXICO

DATE 1
6-26-88 TO 7-30-88

JOB TYPE 1
CYRC, MMS, MMS

JOB # 1
SS-2087, SMITH, NS-2099

SURVEYOR 1
MASSEY, SMITH, MASSEY

DEPTHS 1
C-4200, 4200-9873, 9873-12953

DECL. 1
10 DEGREES EAST

ELEV. 1
4217'

FILE # 1
WT-KX7S

FINAL STATION DATA

MD. 12953.00
TVD. 12895.83
N/S -51.93
E/W -813.48

CLOSURE DISTANCE
615.68 FEET
CLOSURE DIRECTION
S 85.16 W

1 IN. = 200 FT.

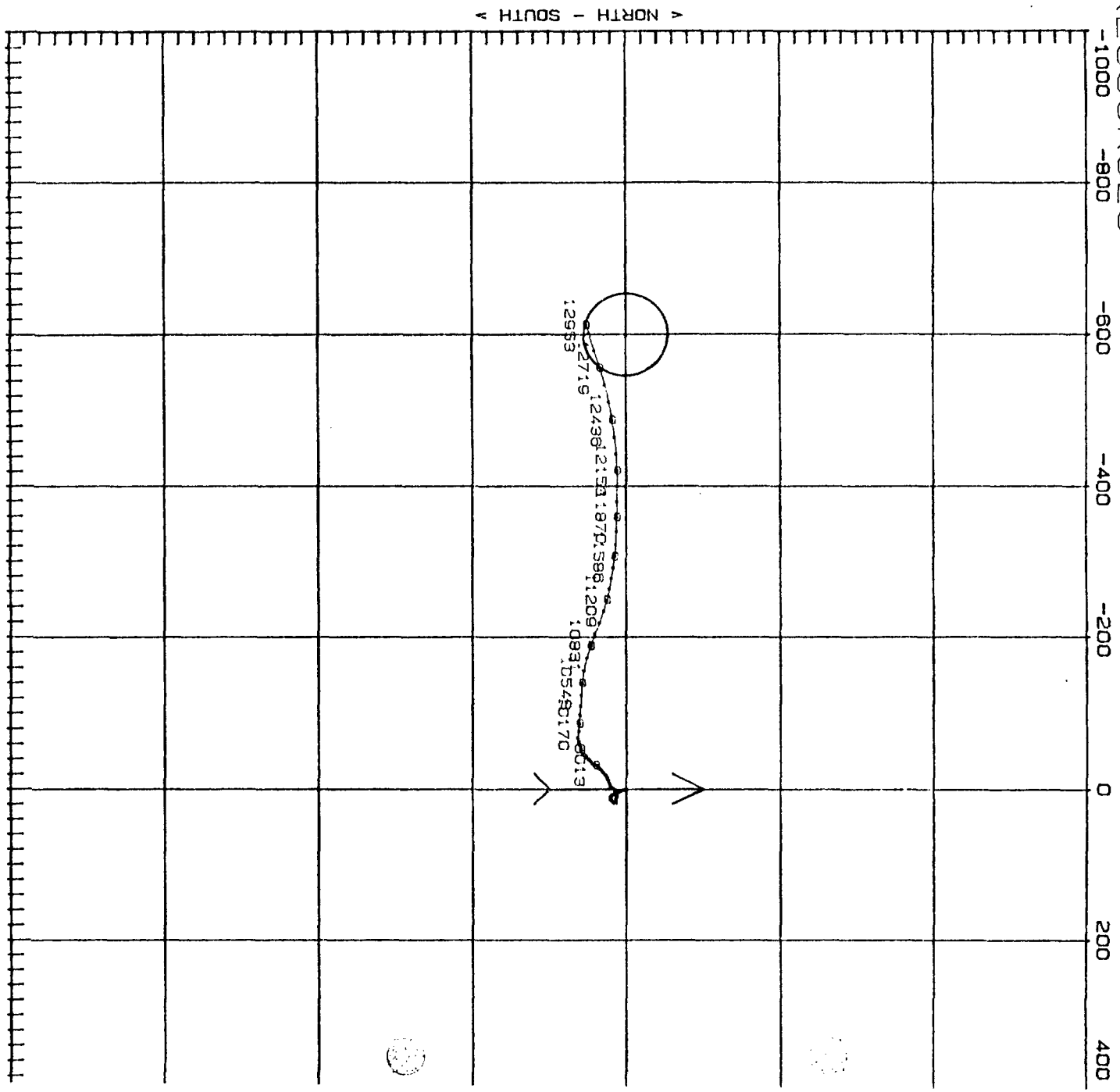

< WEST - EAST >

CUSTOMER : UNION PACIFIC RESOURCES

WELL # : STATE WELL 26 NO. 2

LOCATION : LEA COUNTY, NEW MEXICO

DATE : 6-26-88 TO 7-30-88

JOB TYPE : OYRD, MMS, MMS

JOB # : GS-2087, SMITH, MS-2098

SURVEYOR : MASSEY, SMITH, MASSEY

DEPTH : 0--4200, 4200--9873, 9873--12953

DECL. : 10 DEGREES EAST

ELEV. : 4217'

FILE # : WT-KK75

METHOD : RADIUS OF CURVATURE

SECTION : N90W

FINAL STATION DATA:

MEASURED	INCL.	HOLE	COURSE	VERTICAL	SUBSEA	VERTICAL	ANGULAR	CL	CUR	DEGS.
DEPTH	ANGLE	DIR	LENGTH	DEPTH	DEPTH	SECTION	FEET	FEET	FEET	DEGS.
FEET	DEGS.	DEGS.	FEET	FEET	FEET	FEET	N/S	FEET	FEET	DEGS.

12853.00	14.75	5	72.20	4	45.00	12895.33	9678.93	413.48	51.93	5	413.48	5	515.68	5	35.16	4	0
----------	-------	---	-------	---	-------	----------	---------	--------	-------	---	--------	---	--------	---	-------	---	---

THIS SURVEY IS CORRECT TO THE
 BEST OF MY KNOWLEDGE AND IS
 SUPPORTED BY ACTUAL FIELD DATA.

Jerry Massey
 DIG REPRESENTATIVE

NION PACIFIC RESOURCES

STATE WELL 26 NO.2

T-KK75

MEASURED DEPTH FEET	INCL. ANGLE DEGS.	HOLE DIRECTION DEGS.	COURSE LENGTH FEET	VERTICAL DEPTH FEET	SURGEA DEPTH FEET	VERTICAL SECTION FEET	COORDINATES N/S	ULTRAR E/W	CLOSURE DISTANCE FEET	DR. DIR. DEGS.	LOG SEV
0:00	0.00	*	0.00	0.00	-4217.00	0.00	0.00 N	0.00 E	0.00'	00.00	
100:00	.20	S 01.00 E	100.00	100.00	-4117.00	-0.00	.17 S	.00 E	1.73'	01.00	
200:00	.30	S 22.00 E	100.00	200.00	-4017.00	-0.09	.60 S	.09 E	1.81'	08.49	
300:00	.20	S 15.00 E	100.00	300.00	-3917.00	-0.23	1.01 S	.23 E	2.06'	08.83	
400:00	.30	S 01.00 E	100.00	400.00	-3817.00	-0.29	1.44 S	.29 E	2.40'	01.72	
500:00	0.00	*	100.00	500.00	-3717.00	-0.29	1.71 S	.29 E	2.58'	01.26	
600:00	.10	S 26.00 E	100.00	600.00	-3617.00	-0.33	1.78 S	.33 E	2.87'	01.52	
700:00	.20	S 33.00 W	100.00	700.00	-3517.00	-0.32	2.03 S	.32 E	3.17'	01.72	
800:00	.30	S 35.00 W	100.00	800.00	-3417.00	-0.07	2.40 S	.07 E	3.31'	01.26	
900:00	.80	S 17.00 E	100.00	899.99	-3317.01	.07	3.31 S	.07 W	4.66'	07.64	
1000:00	.90	S 39.00 E	100.00	999.98	-3217.02	-0.62	4.61 S	.62 E	6.06'	12.50	
1100:00	.80	S 17.00 E	100.00	1099.97	-3117.03	-1.31	5.92 S	1.31 E	7.52'	14.36	
1200:00	.90	S 27.00 E	100.00	1199.96	-3017.04	-1.87	7.29 S	1.87 E	8.87'	16.94	
1300:00	.70	S 35.00 E	100.00	1299.95	-2917.05	-2.58	8.49 S	2.58 E	10.08'	17.55	
1400:00	.70	S 09.00 E	100.00	1399.94	-2817.06	-3.04	9.61 S	3.04 E	11.55'	17.61	
1500:00	1.00	S 27.00 E	100.00	1499.93	-2717.07	-3.50	11.01 S	3.50 E	13.29'	17.59	
1600:00	1.00	S 08.00 E	100.00	1599.91	-2617.09	-4.02	12.67 S	4.02 E	15.01'	18.16	
1700:00	1.00	S 37.00 E	100.00	1699.90	-2517.10	-4.68	14.27 S	4.68 E	16.53'	19.55	
1800:00	.30	S 29.00 E	100.00	1799.89	-2417.11	-5.53	15.58 S	5.53 E	17.89'	20.59	
1900:00	.90	S 37.00 E	100.00	1899.88	-2317.12	-6.29	16.75 S	6.29 E	18.75'	20.98	
2000:00	.20	S 21.00 E	100.00	1999.87	-2217.13	-6.71	17.51 S	6.71 E	19.53'	21.32	
2100:00	.70	S 38.00 E	100.00	2099.87	-2117.13	-7.10	18.19 S	7.10 E	20.46'	22.65	
2200:00	.50	S 59.00 E	100.00	2199.86	-2017.14	-7.88	18.88 S	7.88 E	21.48'	24.01	
2300:00	.20	S 40.00 E	100.00	2299.85	-1917.14	-8.74	19.62 S	8.74 E	22.68'	25.78	
2400:00	.80	S 69.00 E	100.00	2399.85	-1817.15	-9.86	20.42 S	9.86 E			

UNION PACIFIC RESOURCES
STATE WELL 26 ND.2
T-KK7S

MEASURED DEPTH FEET	INCL. ANGLE DEGS.	HOLE DIRECTION DEGS.	COURSE LENGTH FEET	VERTICAL DEPTH FEET	SURSEA DEPTH FEET	VERTICAL SECTION FEET	CORR. V/S	CORR. FEET	S U L A R	D I S T A N C E	D I R E C T I O N
2300.00	.30	S 62.00 E	100.00	2499.84	-1717.16	-10.74	20.82	10.74	23.42	S 27.29 E	
2400.00	.40	S 81.00 E	100.00	2599.84	-1517.16	-11.31	21.01	11.31	23.98	S 33.30 E	
2700.00	.30	N 55.00 E	100.00	2699.34	-1517.16	-11.61	20.92	11.91	24.09	S 29.54 E	
2800.00	.30	S 62.00 E	100.00	2799.24	-1417.16	-12.02	20.95	12.02	24.27	S 30.78 E	
2900.00	.90	N 46.00 E	100.00	2899.33	-1317.17	-13.39	20.54	13.38	24.51	S 33.09 E	
3000.00	.90	N 34.00 E	100.00	2999.82	-1217.18	-14.39	19.34	14.39	24.10	S 36.66 E	
3100.00	.70	N 45.00 E	100.00	3099.81	-1117.19	-15.28	18.26	15.28	23.91	S 39.92 E	
3200.00	.90	N 53.00 E	100.00	3199.80	-1017.20	-16.33	17.34	16.33	23.82	S 43.27 E	
3300.00	.80	N 45.00 E	100.00	3299.79	-917.21	-17.45	16.37	17.45	23.93	S 46.82 E	
3400.00	.50	N 07.00 W	100.00	3399.79	-817.22	-17.30	15.34	17.80	23.50	S 49.26 E	
3500.00	.40	N 25.00 W	100.00	3499.78	-717.22	-17.59	14.58	17.59	22.85	S 50.74 E	
3600.00	.10	N 54.00 W	100.00	3599.79	-617.22	-17.29	14.28	17.29	22.42	S 50.45 E	
3700.00	.20	N 71.00 E	100.00	3699.79	-517.22	-17.30	14.07	17.30	22.50	S 50.87 E	
3800.00	.20	N 35.00 E	100.00	3799.73	-417.22	-17.58	13.87	17.58	22.39	S 51.73 E	
3900.00	.30	N 11.00 E	100.00	3899.72	-317.22	-17.74	13.47	17.74	22.28	S 52.80 E	
4000.00	.20	S 57.00 W	100.00	3999.77	-217.23	-17.47	13.24	17.47	21.92	S 52.83 E	
4100.00	.20	S 07.00 E	100.00	4099.77	-117.23	-17.31	13.53	17.31	21.96	S 51.99 E	
4200.00	0.00	*** ** *	100.00	4199.77	-17.23	-17.33	13.70	17.33	22.09	S 51.67 E	
4293.00	.25	S 78.00 W	93.00	4292.77	75.77	-17.13	13.74	17.13	21.96	S 51.26 E	
4386.00	0.00	*** ** *	93.00	4385.77	168.77	-16.93	13.78	16.93	21.83	S 50.85 E	
4479.00	.25	S 29.00 E	93.00	4478.77	261.77	-17.03	13.96	17.03	22.02	S 50.65 E	
4572.00	.25	S 08.00 W	93.00	4571.77	354.77	-17.10	14.35	17.10	22.33	S 49.99 E	
4565.00	.50	N 38.00 W	93.00	4664.77	447.77	-16.34	14.48	16.34	22.05	S 49.97 E	
4758.00	.75	N 32.00 W	93.00	4757.76	540.76	-15.78	13.98	15.78	21.08	S 48.46 E	
4851.00	1.00	N 38.50 W	93.00	4856.75	633.75	-14.37	13.86	14.37	19.96	S 46.03 E	

SURVEY DATA FROM 4293' - 9875' OBTAINED FROM SMITH INTERNATIONAL

UNION PACIFIC RESOURCES
STATE WELL 26 NO.2

T-4475

MEASURED DEPTH	INCL. ANGLE DEGS.	HOLE DIRECTION DEGS.	COURSE LENGTH FEET	VERTICAL DEPTH FEET	SUBSEA DEPTH FEET	VERTICAL SECTION FEET	SECTION O.D.	ORDINATE N/S	E/W	DISTANCE FEET	DIRECTION DEGS.	JOB NO.
1944.00	1.25	N	76.00	4943.73	726.73	-12.56	13.61	12.56	1	19.52	342.72	
7137.00	.75	N	72.00	5036.72	619.72	-11.00	13.19	11.00	1	17.15	331.98	
79.00	.75	N	61.00	5129.71	912.71	-9.89	12.57	9.89	1	16.07	37.91	
5.00	1.00	N	85.00	5222.70	1005.70	-8.34	12.27	8.34	1	14.95	34.82	
5.00	1.00	N	83.00	5315.69	1099.69	-6.92	12.12	6.92	1	13.96	29.73	
2409.00	1.00	S	73.00	5408.67	1191.67	-5.32	12.86	5.32	1	13.36	23.44	
3502.00	1.00	S	59.00	5501.66	1284.66	-3.84	12.92	3.84	1	13.47	15.54	
3595.00	1.00	S	52.00	5594.64	1377.64	-2.50	13.84	2.50	1	14.06	10.24	
5688.00	.75	S	59.00	5687.63	1470.63	-1.33	14.64	1.33	1	14.70	5.19	
5781.00	.50	S	71.00	5780.63	1563.63	-1.41	15.07	1.41	1	15.07	3.01	
5874.00	.75	S	41.00	5873.62	1656.62	.42	15.65	1.42	1	15.65	3.01	
5967.00	1.00	S	14.00	5966.61	1749.61	1.07	16.88	1.07	1	16.91	3.03	
5060.00	.75	S	32.00	6059.60	1842.60	1.62	18.18	1.62	1	18.25	3.05	
6153.00	1.00	S	58.00	6152.59	1935.59	2.62	19.17	2.62	1	19.35	3.17	
6246.00	1.00	S	55.00	6245.58	2028.58	3.95	20.05	3.98	1	20.45	3.11	
6339.00	1.25	S	63.00	6338.56	2121.56	5.55	20.98	5.55	1	21.71	3.14	
6432.00	1.00	S	76.00	6431.54	2214.54	7.26	21.62	7.26	1	22.81	3.18	
6525.00	1.25	S	59.00	6524.52	2307.52	8.94	22.32	8.94	1	24.04	3.21	
6618.00	1.25	S	83.00	6617.50	2400.50	10.34	22.97	10.84	1	25.40	3.25	
6711.00	1.00	S	80.00	6710.48	2493.48	12.65	23.24	12.65	1	26.46	3.28	
6804.00	1.00	S	61.00	6803.47	2586.47	14.17	23.79	14.17	1	27.68	3.30	
6897.00	1.00	S	52.00	6896.45	2679.45	15.52	24.68	15.52	1	29.15	3.32	
6990.00	1.25	S	64.00	6989.44	2772.44	17.07	25.64	17.07	1	30.80	3.35	
7083.00	1.00	S	43.00	7082.42	2865.42	18.53	26.72	18.53	1	32.52	3.34	
7176.00	1.50	S	44.00	7175.39	2958.39	19.92	28.20	19.92	1	34.52	3.35	

UNION PACIFIC RESOURCES
STATE WELL 26 NO.2

WT-KK78

MEASURED DEPTH FEET	INCL. ANGLE DEGS.	HOLE DIRECTION DEGS.	COURSE LENGTH FEET	VERTICAL DEPTH FEET	SUBSEA DEPTH FEET	VERTICAL SECTION FEET	COR D O R D I N A T E S N/E	E W	D I S T A N C E FEET	D I R E C T I O N DEGS.	LOG
7269.00	1.00	S 55.00 W	93.00	7268.37	3051.37	21.46	29.51	3	21.46	36.49	S 36.03 W
562.00	1.25	S 49.00 W	93.00	7361.35	3144.35	22.20	30.63	3	22.00	39.25	S 36.78 W
7455.00	1.50	S 53.00 W	93.00	7454.33	3237.33	24.64	32.04	3	24.64	40.42	S 37.56 W
7548.00	1.25	S 55.00 W	93.00	7547.30	3330.30	26.44	33.35	3	26.44	42.55	S 38.41 W
7641.00	1.00	S 46.00 W	93.00	7640.28	3423.28	27.55	34.51	3	27.55	44.35	S 38.90 W
7734.00	1.25	S 57.00 W	93.00	7733.26	3516.26	29.30	35.82	3	29.30	46.12	S 39.44 W
7827.00	1.25	S 44.00 W	93.00	7826.24	3609.24	30.88	36.88	3	30.88	48.10	S 39.94 W
7920.00	1.00	S 26.00 W	93.00	7919.22	3702.22	31.92	38.37	3	31.92	49.91	S 39.76 W
8013.00	1.00	S 03.00 W	93.00	8012.21	3795.21	32.32	39.93	3	32.32	51.37	S 38.99 W
8106.00	1.00	S 14.00 W	93.00	8105.20	3888.20	32.56	41.53	3	32.56	52.79	S 38.10 W
8199.00	1.00	S 31.00 W	93.00	8198.18	3981.18	33.18	43.03	3	33.18	54.34	S 37.64 W
8292.00	1.50	S 45.00 W	93.00	8291.16	4074.16	34.43	44.62	3	34.43	56.35	S 37.65 W
8385.00	1.25	S 50.00 W	93.00	8384.13	4167.13	36.19	46.99	3	36.19	58.51	S 38.21 W
8478.00	1.50	S 49.00 W	93.00	8477.11	4260.11	38.01	47.27	3	38.01	60.66	S 38.86 W
8571.00	1.25	S 44.00 W	93.00	8570.09	4353.09	39.33	48.81	3	39.33	62.87	S 39.07 W
8664.00	1.25	S 45.00 W	93.00	8663.06	4446.06	41.05	50.25	3	41.05	64.89	S 39.24 W
8757.00	1.25	S 60.00 W	93.00	8756.03	4539.03	42.55	51.48	3	42.55	66.85	S 39.64 W
8850.00	1.25	S 53.00 W	93.00	8849.01	4632.01	44.34	52.60	3	44.34	68.80	S 40.13 W
8943.00	1.25	S 37.00 W	93.00	8941.99	4724.99	45.77	54.03	3	45.77	70.82	S 40.27 W
9036.00	1.00	S 45.00 W	93.00	9034.97	4817.97	46.97	55.41	3	46.97	72.64	S 40.29 W
9129.00	1.00	S 56.00 W	93.00	9127.96	4910.96	48.30	56.82	3	48.30	74.23	S 40.62 W
9222.00	1.50	S 54.00 W	93.00	9220.94	5003.94	50.06	57.34	3	50.06	75.11	S 41.12 W
9315.00	1.25	S 71.00 W	93.00	9313.91	5096.91	52.03	58.36	3	52.03	78.15	S 41.72 W
9408.00	1.25	S 83.00 W	93.00	9406.89	5189.89	54.00	58.82	3	54.00	79.85	S 42.55 W
9501.00	1.25	S 53.00 W	93.00	9499.86	5282.86	55.93	59.41	3	55.93	81.59	S 43.27 W

UNION PACIFIC RESOURCES
STATE WELL 26 NO.2
WT-KK75

MEASURED DEPTH FEET	INCL. ANGLE DEGS.	HOLE DIRECTION	COURSE LENGTH FEET	VERTICAL DEPTH FEET	SUBSEA DEPTH FEET	VERTICAL SECTION FEET	CORNER DIMENSIONS	DISTANCE FEET	DIRECTION DEGS.	DOF
594.00	1.50	N 74.00 W	93.00	9592.94	5375.34	59.00	60.23 S	58.00 W	83.52 S	43.92 W
587.00	1.25	S 53.10 W	93.00	7693.81	5468.91	60.08	61.04 S	50.88 W	85.55 S	44.54 W
7793.00	1.00	S 56.00 W	93.00	7779.79	5561.79	61.73	61.83 S	61.73 W	87.37 S	44.95 W
9273.00	1.00	S 57.00 W	93.00	9671.78	5654.78	63.21	62.48 S	63.21 W	88.88 S	45.34 W
9992.00	4.75	N 22.00 W	109.00	9990.62	5753.62	68.57	63.18 S	68.57 W	93.24 S	47.34 W
10076.00	5.75	N 33.00 W	94.00	10074.23	5857.23	77.09	62.06 S	77.09 W	98.97 S	51.17 W
10170.00	3.25	N 35.00 W	94.00	10167.71	5950.71	86.87	61.03 S	86.87 W	106.16 S	54.91 W
10265.00	7.25	N 35.00 W	95.00	10262.05	6045.05	97.99	60.06 S	97.99 W	114.93 S	58.50 W
10359.00	8.00	N 28.00 W	94.00	10355.22	6138.22	110.44	59.30 S	110.44 W	125.35 S	51.77 W
10454.00	9.00	N 26.00 W	95.00	10449.18	6232.18	124.46	58.55 S	124.46 W	137.58 S	54.80 W
10548.00	10.00	N 27.00 W	94.00	10541.39	6324.39	139.94	57.61 S	139.94 W	151.34 S	57.82 W
10642.00	10.50	N 79.00 W	94.00	10634.38	6417.38	156.53	55.59 S	156.53 W	166.11 S	70.45 W
10737.00	10.50	N 72.00 W	95.00	10727.79	6510.79	173.28	51.25 S	173.28 W	180.70 S	73.53 W
10831.00	10.00	N 71.00 W	94.00	10820.29	6603.29	189.15	45.94 S	189.15 W	194.54 S	76.35 W
10926.00	9.75	N 70.00 W	95.00	10913.89	6696.89	204.50	40.50 S	204.50 W	208.47 S	78.80 W
11020.00	9.50	N 69.00 W	94.00	11006.56	6789.56	219.22	35.00 S	219.22 W	222.00 S	80.93 W
11114.00	9.75	N 71.00 W	94.00	11099.24	6882.24	233.99	29.62 S	233.99 W	235.86 S	82.79 W
11209.00	9.00	N 75.00 W	95.00	11192.97	6975.97	248.79	25.10 S	248.79 W	250.05 S	84.24 W
11303.00	9.00	N 79.00 W	94.00	11285.81	7068.81	263.11	21.79 S	263.11 W	264.01 S	85.27 W
11398.00	8.75	N 50.00 W	95.00	11379.67	7162.67	277.52	19.12 S	277.52 W	278.18 S	86.06 W
11492.00	8.75	N 32.00 W	94.00	11472.58	7255.58	291.85	16.98 S	291.85 W	292.13 S	86.59 W
11586.00	9.75	N 24.00 W	94.00	11565.36	7348.36	306.64	15.04 S	306.64 W	307.01 S	87.19 W
11681.00	10.25	N 27.00 W	95.00	11658.91	7441.91	323.09	13.75 S	323.09 W	323.38 S	87.56 W
11775.00	11.25	N 37.00 W	94.00	11751.26	7534.26	340.50	12.93 S	340.50 W	340.84 S	87.94 W
11870.00	11.75	N 39.00 W	95.00	11844.36	7627.36	359.52	12.17 S	359.52 W	359.73 S	88.06 W

UNION PACIFIC RESOURCES
STATE WELL 26 NO. 2
WT-KK79

MEASURED DEPTH FEET	INCL. ANGLE DEGS.	HOLE DIRECTION DEGS.	COURSE LENGTH FEET	VERTICAL DEPTH FEET	SUBSEA DEPTH FEET	VERTICAL SECTION FEET	RECTANGULAR COORDINATES N/S	ULARS E/W	CLOSURE DISTANCE FEET	DIRECTION DEGS.
12342.00	13.75	S 33.00 W	95.90	12364.15	2097.15	465.96	15.30 S	465.96 W	466.21	S 89.12 W
12247.00	13.75	S 36.00 W	94.00	12211.87	7994.37	443.49	13.14 S	443.49 W	443.28	S 88.30 W
2153.00	13.00	S 88.00 W	95.90	12120.42	7993.42	421.77	12.00 S	421.77 W	421.94	S 88.37 W
2058.00	12.75	S N 90.00 W	94.00	12027.91	7810.81	400.61	11.33 S	400.61 W	400.76	S 88.34 W
12436.00	14.25	S 82.00 W	94.00	12395.35	3170.35	488.51	18.27 S	488.51 W	488.85	S 97.26 W
12530.00	15.00	S 79.00 W	94.00	12486.31	8269.31	511.91	22.19 S	511.91 W	512.39	S 97.52 W
12625.00	14.25	S 75.00 W	95.00	12578.23	8361.23	535.28	27.58 S	535.28 W	535.99	S 97.05 W
12719.00	14.25	S 73.00 W	94.00	12669.34	8452.34	557.52	33.95 S	557.52 W	558.55	S 96.51 W
12814.00	14.50	S 72.00 W	95.00	12761.36	8544.36	580.01	41.05 S	580.01 W	581.45	S 95.95 W
12908.00	14.75	S 72.00 W	94.00	12852.32	8635.32	602.59	48.39 S	602.59 W	604.53	S 95.41 W
12953.00	14.75	S 72.00 W	45.00	12895.93	8679.93	612.48	51.93 S	612.48 W	615.68	S 95.15 W

CLOSURE DISTANCE = 615.68 FEET.
CLOSURE DIRECTION = S 95.16 W