

COUNTY

BASE AND MERIDIAN

RANGE *25E*

RANGE

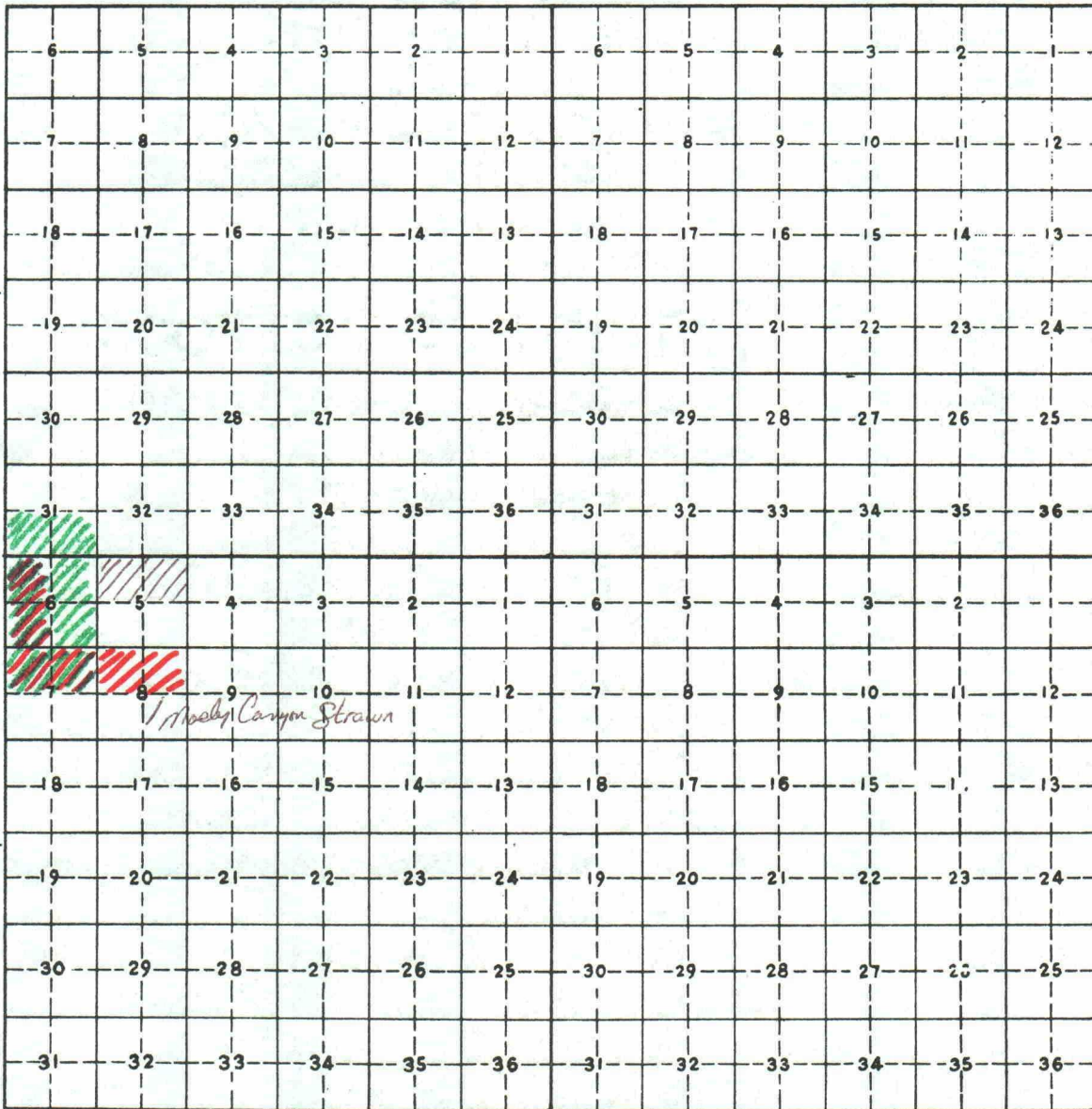

Baldete
Canyon
Moxos
Gas

TWP. 245

KELLAHIN, KELLAHIN and AUBREY
Attorneys at Law

W. Thomas Kellahin
Karen Aubrey

El Patio - 117 North Guadalupe
Post Office Box 2265

Telephone 982-4285
Area Code 505

Jason Kellahin
Of Counsel

Santa Fé, New Mexico 87504-2265

October 18, 1988

RECEIVED

OCT 18 1988

Mr. William J. LeMay
Oil Conservation Division
P.O. Box 2088
Santa Fe, NM 87504

OIL CONSERVATION DIVISION

HAND DELIVERED

Re: OGS Operating Company, Inc.
for Compulsory Pooling
Eddy County, New Mexico

Case 9523

Dear Mr. LeMay:

On behalf of OGS Operating Company, Inc., we would appreciate you setting the enclosed application for a public hearing on the Division's Examiner docket now scheduled for November 9, 1988.

By copy of this letter to all parties to be pooled, we are notifying them by certified mail-return receipt, that they have the right to appear at the hearing, to make a statement to the Division, to present evidence and cross-examine witnesses either in support of or in opposition to the application. Those parties are directed to contact the Division or the applicant's attorney to determine what additional rights they may have. In addition, they are advised that the entry of a compulsory pooling order will affect their rights to share in the production from the subject well.

Very truly yours,

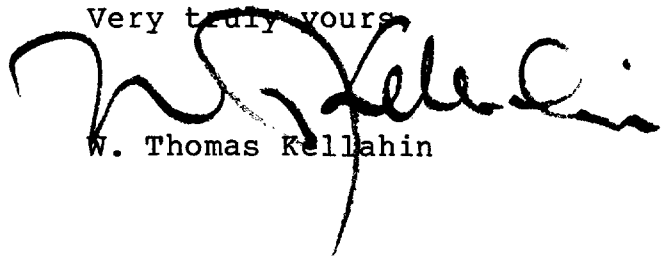

W. Thomas Kellahin

WTK/dm
Encl.

cc: Thom O'Brien
OGS Operating Co.

"Certified Return-Receipt Requested"
all parties to be pooled

RECEIVED

OCT 18 1989

STATE OF NEW MEXICO
DEPARTMENT OF ENERGY AND MINERALS
OIL CONSERVATION DIVISION

OIL CONSERVATION DIVISION

IN THE MATTER OF THE APPLICATION
OF OGS OPERATING COMPANY, INC.
FOR COMPULSORY POOLING, EDDY
COUNTY, NEW MEXICO.

CASE: 9523

A P P L I C A T I O N

COMES NOW, OGS OPERATING COMPANY, INC., by and through its attorneys, Kellahin, Kellahin & Aubrey and in accordance with Section 70-2-17(c) NMSA (1978) applies to the New Mexico Oil Conservation Division for an order pooling all mineral interests underlying the following described acreage in Section 5, T24S, R25E, Eddy County, New Mexico, in the following described manner:

N/2 to form a 319.62 acre, more or less, gas spacing and proration unit for any and all formations and/or pools within said vertical limits developed on 320-acre gas well spacing.

The above described unit is to be dedicated to a well to be drilled to the base of the Morrow Formation at a standard well location 990 feet from the North line and 1980 feet from the West line of said Section 5.

1. Applicant, OGS Operating Company, Inc. is a working interest owner of the SE/4NE/4 and S/2NW/4 of said Section 5.

2. Applicant has sought a voluntary agreement for the formation of a N/2 section spacing unit for the drilling, completion and production of the subject well but has been unable to obtain a voluntary agreement from the following parties:

- | | | |
|-----|---|--|
| (a) | Amoco Production Company
501 Westlake Park Blvd.
Houston, TX 77077
Attn: Mr. Tim Custer | Lot 3 (NE/4NW/4)
40.01 acres
12.5179% of unit |
| (b) | Yates Petroleum Corporation
105 S. Fourth Street
Artesia, NM 88210
Attn: Mr. Randy Patterson | Lots 1 & 2
SW/4NE/4
120.54 acres
37.7135% of unit |
| (c) | Santa Fe Energy Company
500 W. Illinois Suite 500
Midland, TX 79701
Attn: Mr. Pat Tower | Lot 4 (NW/4NW/4)
39.07 acres
12.2239% of unit |

3. Pursuant to the Division notice requirements, applicant has notified all parties to be pooled of this application for compulsory pooling and the applicant's request for a hearing before the Division to be set on November 9, 1988.

4. In order to obtain its just and equitable share of the potential production underlying the above tract, applicant needs an order pooling the mineral interest involved in order to protect applicant's correlative rights and prevent waste.

WHEREFORE, applicant prays that this application be set for hearing before the Division's duly appointed examiner, and that after notice and hearing as required by law, the Division enter its order pooling the mineral interest described herein. Applicant further prays that it be named operator of the well, and that the order make provisions for applicant to recover out of

production its costs of drilling, completing and equipping the subject well, costs of operation, including costs of supervision, and a risk factor in the amount of 200% for the drilling and completing of the well, for such other and further relief as may be proper.

Respectfully submitted,

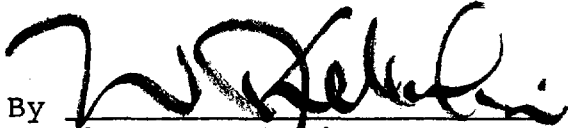

By
W. Thomas Kellahin
Kellahin, Kellahin, & Aubrey
P.O. Box 2265
Santa Fe, NM 87504

(505) 982-4285

County Eddy Pool Dark Canyon-Pennsylvanian Gas

TOWNSHIP 23 South Range 24 East NMPM

6	5	4	3	2	1
7	8	9	10	11	12
18	17	16	15	14	13
19	20	21	22	23	24
30	29	28	27	26	25
31	32	33	34	35	36



Ext: 1/2 Sec. 36 (R-7334, 8-19-83)

9523

Case No. ~~9253~~

COUNTY Eddy POOL Dark Canyon - Pennsylvanian Gas

TOWNSHIP 23 South RANGE 25 East NMPM

6	5	4	3	2	1
7	8	9	10	11	12
18	17	16	15	14	13
19	20	21	22	23	24
30	29	28	27	26	25
31	32	33	34	35	36

Description: All Sec. 30 (R. 2760, 9-1-64) EXT: 1/2 sec 31 (R. 023, 3-9-82)

County Eddy Pool Mosley Canyon-Strawn Gas

TOWNSHIP 24 South Range 25 East NMPM

5	5	4	3	2	1	
7	8	9	10	11	12	
18	17	16	15	14	13	
19	20	21	22	23	24	
30	29	28	27	26	25	
31	32	33	34	35	36	

Description: Sec. 8, $\frac{N}{2}$, (R-7076-9-2M-82)

Ext: $\frac{N}{2}$ Sec. 7 (R-7158, 12-8-82) EXT: $\frac{W}{2}$ SEC 6 (R-8627, 4/188)

County Eddy Pool Baldrige Canyon - Morrow Gas

TOWNSHIP 23 South Range 25 East NMPM

6	5	4	3	2	1
7	8	9	10	11	12
18	17	16	15	14	13
19	20	21	22	23	24
30	29	28	27	26	25
31	32	33	34	35	36

EXT: $\frac{5}{2}$ Sec 31 (A-6698, 6-2-81)

County Eddy Pool Baldridge Canyon - Morrow Gas

TOWNSHIP 24 South

Range 24 East

NMPM

6	5	4	3	2	
7	8	9	10	11	12
18	17	16	15	14	13
19	20	21	22	23	24
30	29	28	27	26	25
31	32	33	34	35	36

Description: $\frac{E}{2}$ Sec 13 (R-5987, 4-1-79) Ext: All Sec. 11,

$\frac{W}{2}$ Sec. 12, $\frac{W}{2}$ Sec. 13 (R-6420, 8-1-80)

Ext: $\frac{E}{2}$ Sec 1, $\frac{E}{2}$ Sec 12 (R-6698, 6-2-81)

Ext: Sec: 1 $\frac{W}{2}$, Sec: 2 All Sec: 14 $\frac{S}{2}$ (R-7030, 7-21-80)

Ext: $\frac{N}{2}$ Sec. 14 (R-6838, 11-8-81) Ext: $\frac{N}{2}$ Sec. 22, $\frac{N}{2}$ Sec. 23 (R-7785, 1-12-85)

COUNTY *Eddy*

POOL *Horseshoe Bend - Morrow Gas*

TOWNSHIP *23 South*

RANGE *25 East*

NMPM

6	5	4	3	2	1
7	8	9	10	11	12
18	17	16	15	14	13
19	20	21	22	23	24
30	29	28	27	26	25
31	32	33	34	35	36

Description: 1/2 Sec 34 (R-5252, 9-1-76)

<p>20</p> <p>Cherwin 51818</p> <p>U.S.</p> <p>H. Yates et al 7-1-88 7-27569</p> <p>Shell Chimney DA 2182 DA 2183</p> <p>U.S.</p> <p>H.M. Kincaid, M.I. P.M. Hallcomb</p>	<p>21</p> <p>Referra Des Shelli-Fed. DA 5784 DA 5785</p> <p>ARCO 3-1-78 4600</p> <p>U.S.</p> <p>Terra Res. 10-1-82 68717 10187</p> <p>M.E. Yates 10-1-82 10187</p> <p>U.S.</p> <p>H.E. Yates et al 11-1-81</p>	<p>22</p> <p>Yates Pet et al 10-1-82 10187</p> <p>U.S.</p> <p>Yates Pet 10-1-82 10187</p> <p>U.S.</p> <p>BTA 10-1-82 65945</p> <p>U.S.</p> <p>BTA 10-1-82 65945</p>	<p>23</p> <p>W.G. Smith 10-1-82 10187</p> <p>U.S.</p> <p>W.A. Moncrief 10-1-82 10187</p> <p>U.S.</p> <p>Amoco 10-1-82 10187</p> <p>U.S.</p> <p>Amoco 10-1-82 10187</p>	<p>24</p> <p>W.G. Smith 10-1-82 10187</p> <p>U.S.</p> <p>W.A. Moncrief 10-1-82 10187</p> <p>U.S.</p> <p>Amoco 10-1-82 10187</p> <p>U.S.</p> <p>Amoco 10-1-82 10187</p>	<p>25</p> <p>W.A. Moncrief 10-1-82 10187</p> <p>U.S.</p> <p>W.A. Moncrief 10-1-82 10187</p> <p>U.S.</p> <p>Amoco 10-1-82 10187</p> <p>U.S.</p> <p>Amoco 10-1-82 10187</p>	<p>26</p> <p>W.A. Moncrief 10-1-82 10187</p> <p>U.S.</p> <p>W.A. Moncrief 10-1-82 10187</p> <p>U.S.</p> <p>Amoco 10-1-82 10187</p> <p>U.S.</p> <p>Amoco 10-1-82 10187</p>	<p>27</p> <p>W.A. Moncrief 10-1-82 10187</p> <p>U.S.</p> <p>W.A. Moncrief 10-1-82 10187</p> <p>U.S.</p> <p>Amoco 10-1-82 10187</p> <p>U.S.</p> <p>Amoco 10-1-82 10187</p>	<p>28</p> <p>W.A. Moncrief 10-1-82 10187</p> <p>U.S.</p> <p>W.A. Moncrief 10-1-82 10187</p> <p>U.S.</p> <p>Amoco 10-1-82 10187</p> <p>U.S.</p> <p>Amoco 10-1-82 10187</p>	<p>29</p> <p>W.A. Moncrief 10-1-82 10187</p> <p>U.S.</p> <p>W.A. Moncrief 10-1-82 10187</p> <p>U.S.</p> <p>Amoco 10-1-82 10187</p> <p>U.S.</p> <p>Amoco 10-1-82 10187</p>	<p>30</p> <p>W.A. Moncrief 10-1-82 10187</p> <p>U.S.</p> <p>W.A. Moncrief 10-1-82 10187</p> <p>U.S.</p> <p>Amoco 10-1-82 10187</p> <p>U.S.</p> <p>Amoco 10-1-82 10187</p>	<p>31</p> <p>W.A. Moncrief 10-1-82 10187</p> <p>U.S.</p> <p>W.A. Moncrief 10-1-82 10187</p> <p>U.S.</p> <p>Amoco 10-1-82 10187</p> <p>U.S.</p> <p>Amoco 10-1-82 10187</p>	<p>32</p> <p>W.A. Moncrief 10-1-82 10187</p> <p>U.S.</p> <p>W.A. Moncrief 10-1-82 10187</p> <p>U.S.</p> <p>Amoco 10-1-82 10187</p> <p>U.S.</p> <p>Amoco 10-1-82 10187</p>	<p>33</p> <p>W.A. Moncrief 10-1-82 10187</p> <p>U.S.</p> <p>W.A. Moncrief 10-1-82 10187</p> <p>U.S.</p> <p>Amoco 10-1-82 10187</p> <p>U.S.</p> <p>Amoco 10-1-82 10187</p>	<p>34</p> <p>W.A. Moncrief 10-1-82 10187</p> <p>U.S.</p> <p>W.A. Moncrief 10-1-82 10187</p> <p>U.S.</p> <p>Amoco 10-1-82 10187</p> <p>U.S.</p> <p>Amoco 10-1-82 10187</p>	<p>35</p> <p>W.A. Moncrief 10-1-82 10187</p> <p>U.S.</p> <p>W.A. Moncrief 10-1-82 10187</p> <p>U.S.</p> <p>Amoco 10-1-82 10187</p> <p>U.S.</p> <p>Amoco 10-1-82 10187</p>	<p>36</p> <p>W.A. Moncrief 10-1-82 10187</p> <p>U.S.</p> <p>W.A. Moncrief 10-1-82 10187</p> <p>U.S.</p> <p>Amoco 10-1-82 10187</p> <p>U.S.</p> <p>Amoco 10-1-82 10187</p>	<p>37</p> <p>W.A. Moncrief 10-1-82 10187</p> <p>U.S.</p> <p>W.A. Moncrief 10-1-82 10187</p> <p>U.S.</p> <p>Amoco 10-1-82 10187</p> <p>U.S.</p> <p>Amoco 10-1-82 10187</p>	<p>38</p> <p>W.A. Moncrief 10-1-82 10187</p> <p>U.S.</p> <p>W.A. Moncrief 10-1-82 10187</p> <p>U.S.</p> <p>Amoco 10-1-82 10187</p> <p>U.S.</p> <p>Amoco 10-1-82 10187</p>	<p>39</p> <p>W.A. Moncrief 10-1-82 10187</p> <p>U.S.</p> <p>W.A. Moncrief 10-1-82 10187</p> <p>U.S.</p> <p>Amoco 10-1-82 10187</p> <p>U.S.</p> <p>Amoco 10-1-82 10187</p>	<p>40</p> <p>W.A. Moncrief 10-1-82 10187</p> <p>U.S.</p> <p>W.A. Moncrief 10-1-82 10187</p> <p>U.S.</p> <p>Amoco 10-1-82 10187</p> <p>U.S.</p> <p>Amoco 10-1-82 10187</p>
--	--	---	--	--	---	---	---	---	---	---	---	---	---	---	---	---	---	---	---	---

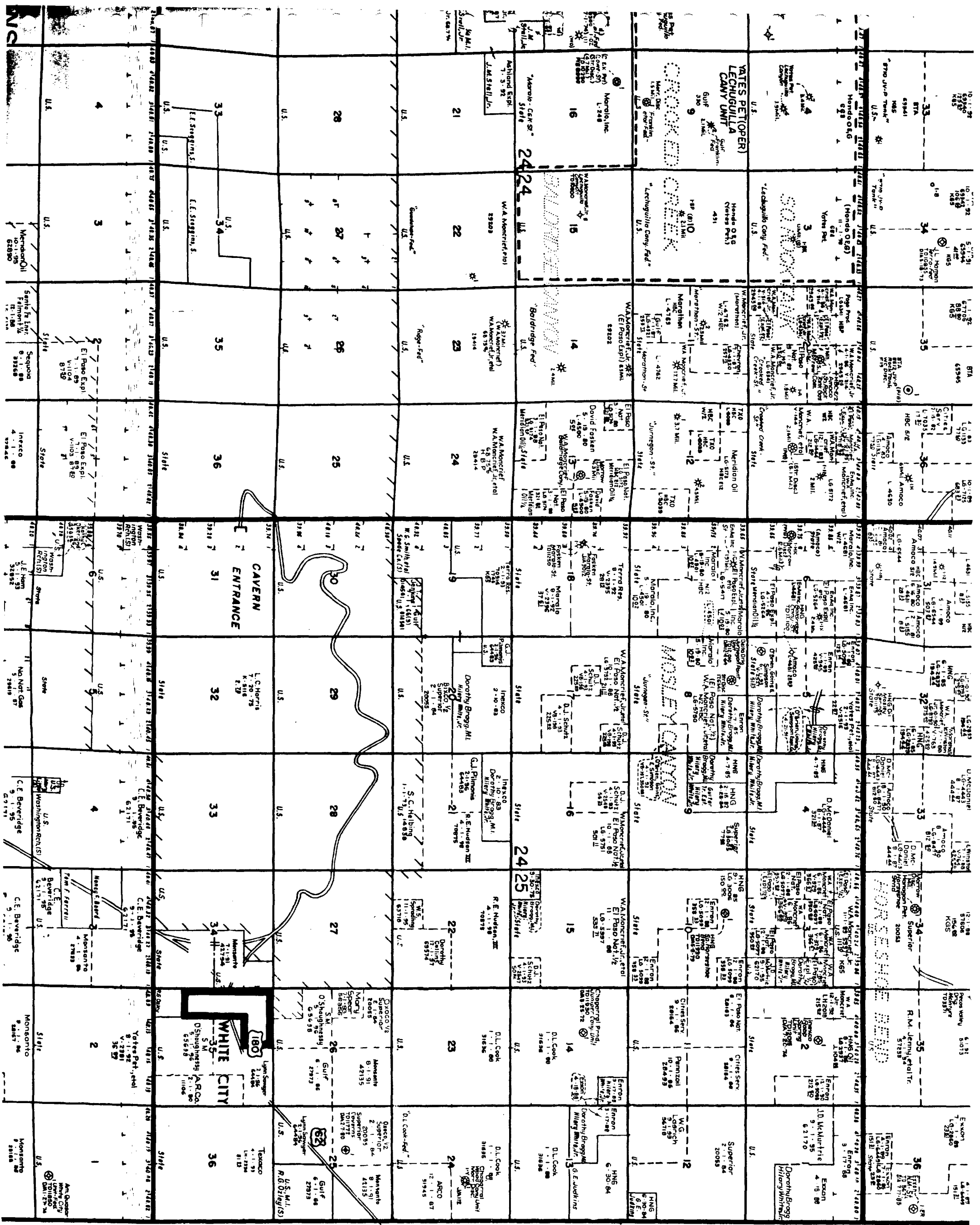

T 24 S

KELLAHIN, KELLAHIN and AUBREY

Attorneys at Law

El Patio - 117 North Guadalupe
Post Office Box 2265

Santa Fé, New Mexico 87504-2265

October 18, 1988

W. Thomas Kellahin
Karen Aubrey

Jason Kellahin
Of Counsel

Telephone 982-4285
Area Code 505

RECEIVED

OCT 18 1988

Mr. William J. LeMay
Oil Conservation Division
P.O. Box 2088
Santa Fe, NM 87504

OIL CONSERVATION DIVISION

HAND DELIVERED

Re: OGS Operating Company, Inc.
for Compulsory Pooling
Eddy County, New Mexico

Case 9523

Dear Mr. LeMay:

On behalf of OGS Operating Company, Inc., we would appreciate you setting the enclosed application for a public hearing on the Division's Examiner docket now scheduled for November 9, 1988.

By copy of this letter to all parties to be pooled, we are notifying them by certified mail-return receipt, that they have the right to appear at the hearing, to make a statement to the Division, to present evidence and cross-examine witnesses either in support of or in opposition to the application. Those parties are directed to contact the Division or the applicant's attorney to determine what additional rights they may have. In addition, they are advised that the entry of a compulsory pooling order will affect their rights to share in the production from the subject well.

Very truly yours,

W. Thomas Kellahin

WTK/dm
Encl.

cc: Thom O'Brien
OGS Operating Co.

"Certified Return-Receipt Requested"
all parties to be pooled

OCT 18 1988

STATE OF NEW MEXICO
DEPARTMENT OF ENERGY AND MINERALS
OIL CONSERVATION DIVISION

OIL CONSERVATION DIVISION

IN THE MATTER OF THE APPLICATION
OF OGS OPERATING COMPANY, INC.
FOR COMPULSORY POOLING, EDDY
COUNTY, NEW MEXICO.

CASE: 9523

A P P L I C A T I O N

COMES NOW, OGS OPERATING COMPANY, INC., by and through its attorneys, Kellahin, Kellahin & Aubrey and in accordance with Section 70-2-17(c) NMSA (1978) applies to the New Mexico Oil Conservation Division for an order pooling all mineral interests underlying the following described acreage in Section 5, T24S, R25E, Eddy County, New Mexico, in the following described manner:

N/2 to form a 319.62 acre, more or less, gas spacing and proration unit for any and all formations and/or pools within said vertical limits developed on 320-acre gas well spacing.

The above described unit is to be dedicated to a well to be drilled to the base of the Morrow Formation at a standard well location 990 feet from the North line and 1980 feet from the West line of said Section 5.

1. Applicant, OGS Operating Company, Inc. is a working interest owner of the SE/4NE/4 and S/2NW/4 of said Section 5.

2. Applicant has sought a voluntary agreement for the formation of a N/2 section spacing unit for the drilling, completion and production of the subject well but has been unable to obtain a voluntary agreement from the following parties:

- | | | |
|-----|---|--|
| (a) | Amoco Production Company
501 Westlake Park Blvd.
Houston, TX 77077
Attn: Mr. Tim Custer | Lot 3 (NE/4NW/4)
40.01 acres
12.5179% of unit |
| (b) | Yates Petroleum Corporation
105 S. Fourth Street
Artesia, NM 88210
Attn: Mr. Randy Patterson | Lots 1 & 2
SW/4NE/4
120.54 acres
37.7135% of unit |
| (c) | Santa Fe Energy Company
500 W. Illinois Suite 500
Midland, TX 79701
Attn: Mr. Pat Tower | Lot 4 (NW/4NW/4)
39.07 acres
12.2239% of unit |

3. Pursuant to the Division notice requirements, applicant has notified all parties to be pooled of this application for compulsory pooling and the applicant's request for a hearing before the Division to be set on November 9, 1988.

4. In order to obtain its just and equitable share of the potential production underlying the above tract, applicant needs an order pooling the mineral interest involved in order to protect applicant's correlative rights and prevent waste.

WHEREFORE, applicant prays that this application be set for hearing before the Division's duly appointed examiner, and that after notice and hearing as required by law, the Division enter its order pooling the mineral interest described herein. Applicant further prays that it be named operator of the well, and that the order make provisions for applicant to recover out of

production its costs of drilling, completing and equipping the subject well, costs of operation, including costs of supervision, and a risk factor in the amount of 200% for the drilling and completing of the well, for such other and further relief as may be proper.

Respectfully submitted,



By
W. Thomas Kellahin
Kellahin, Kellahin, & Aubrey
P.O. Box 2265
Santa Fe, NM 87504

(505) 982-4285

COUNTY

BASE AND MERIDIAN

RANGE 25E

RANGE

TWP

TWP 24S

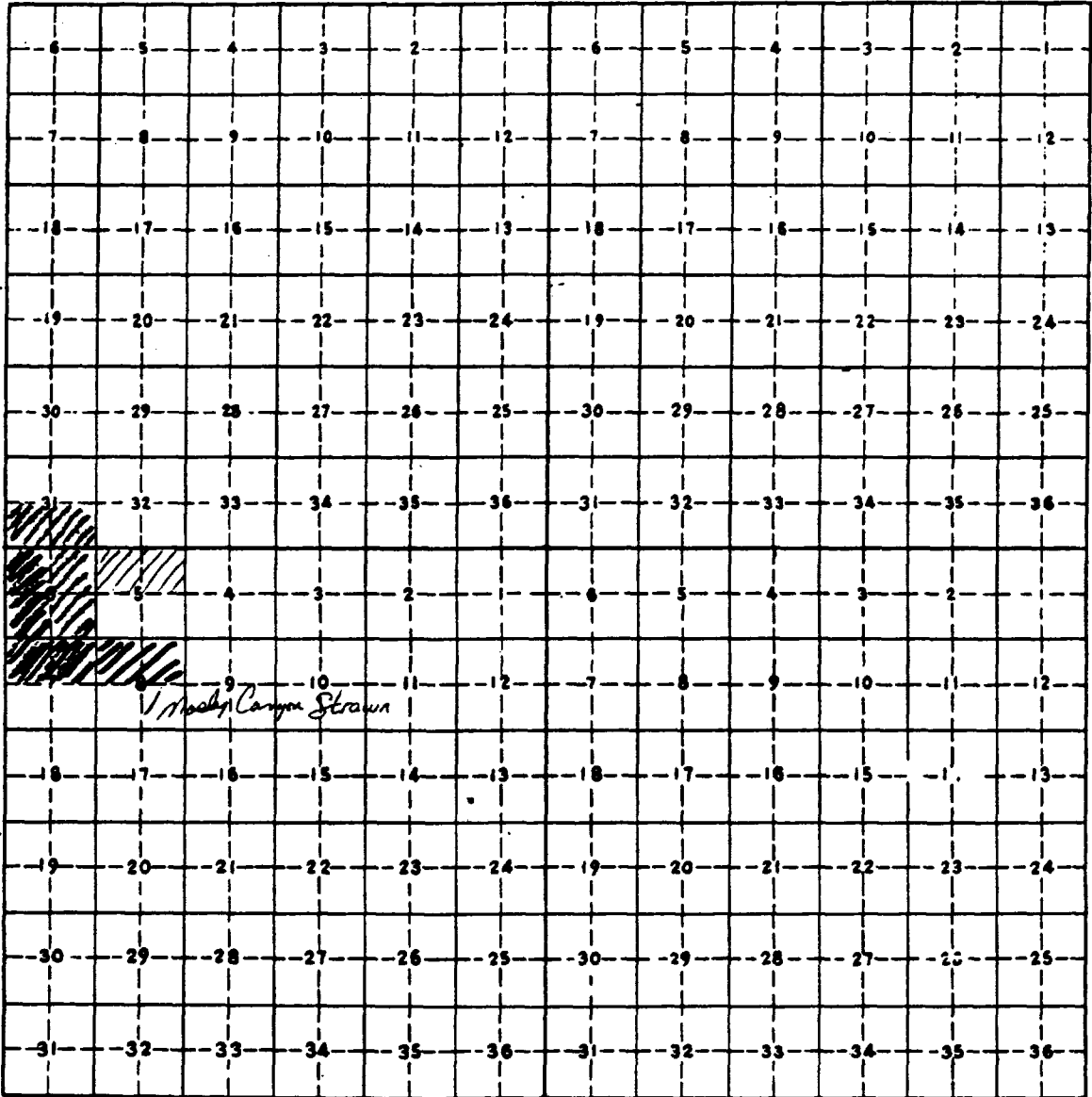

Baldwin
Canyon
Narrow
Gas

V. Mosby Canyon Strawn

COMPULSORY POOLING

Case No. 9523

COM NAME: OGS Operating Company, Inc.
 OPERATOR: OGS Operating Company, Inc.
 APPROVED: _____
 EFFECTIVE: _____
 TERM: _____
 WELL LOCATION: _____

Eddy
 COUNTY
Morrow
 FORMATION
Univ.
 INSTITUTION
640.32
 ACREAGE

SECTION 5 TOWNSHIP 24S RANGE 25E

Lot 4 39.87 Santa Fe Energy Op. V-2630	Lot 3 40.01 Amoco Prod. Co. L-4681-1	Lot 2 40.15 Yates Pet Corp. V-2516	Lot 1 40.29 Yates Pet Corp. V-2516
HNG Oil Co. V-945	HNG Oil Co. V-945	Yates Pet. Corp. V-2516	Not State

1
 40.29
 40.15

 80.44
 40.01

 120.45
 39.87

 160.32
 16

 320.32

L-4681-1	Lot 3	Amoco Producing Company	40.01
V-945	S $\frac{1}{2}$ NW $\frac{1}{4}$	HNG Oil Company	80.00
V-2516	Lots 1,2, SW $\frac{1}{4}$ NE $\frac{1}{4}$	Yates Petroleum Corp.	120.44
V-2630	Lot 4	Santa Fe Energy Operating...	39.87
Not State	SE $\frac{1}{4}$ NE $\frac{1}{4}$		40.00

* 320.32

CASE 9521:

Application of Keith McKamey for compulsory pooling, Lea County, New Mexico, above-styled cause, seeks an order pooling all mineral interests from the surface to the base of the Wolfcamp formation or to a depth of 11,200 feet, whichever is shallower, (which includes but is not necessarily limited to the Undesignated Gem-Wolfcamp Pool, Undesignated East Lusk-Bone Spring Pool, East Lusk-Delaware Pool, and Undesignated South Tonto-Yates-Seven Rivers Pool) underlying the NW/4 SW/4 of Section 25, Township 19 South, Range 32 East, forming a standard 40-acre oil spacing and proration unit, to be dedicated to the existing Grace Petroleum Corporation West Tonto "A" Federal Com well No. 1-Y, to be re-entered by the applicant and located at a previously approved northdow oil well location (Administrative Order No. NSL-1442) 2450 feet from the South line and 660 feet from the West line (Unit L) of said Section 25. Also to be considered will be the cost of drilling and completing said well and the allocation of the cost thereof as well as actual operating costs and charges for supervision, designation of applicant as operator of the well and a charge for risk involved in drilling said well. Said unit is located approximately 4 miles Northwest of Laguna Gatuna Salt Lake.

CASE 9522:

Application of Pennzoll Exploration and Production Company for the amendment of Division Order No. R-8716, Lea County, New Mexico. Applicant, in the above-styled cause, seeks the amendment of Division Order No. R-8716, which order authorized an northdow oil well location 2310 feet from the South line and 810 feet from the West line (Unit L) of Section 1, Township 17 South, Range 37 East. Applicant now seeks to substitute therefor an northdow oil well location 900 feet from the South line and 1750 feet from the West line of said Section 1, Undesignated Shipp-Strawn Pool, with the S/2 SW/4 of said Section 1 being dedicated to its Price Family Trust Well No. 2, forming a standard 80-acre oil spacing and proration unit for said pool. Said location is approximately 4.5 miles North by East of Humble City, New Mexico.

CASE 9523:

Application of OGS Operating Company, Inc. for compulsory pooling, Eddy County, New Mexico. Applicant, in the above-styled cause, seeks an order pooling all mineral interests from the surface to the base of the Morrow formation underlying the ~~rest~~ of Section 5, Township 24 South, Range 25 East, forming a standard ~~320~~-acre, more or less, gas spacing and proration unit for any and all formations and/or pools within said vertical limits developed on 320-acre gas well spacing, said unit to be dedicated to a well to be drilled at a standard gas well location 990 feet from the North line and 1980 feet from the West line (Unit C) of said Section 5. Also to be considered will be the cost of drilling and completing said well and the allocation of the cost thereof as well as actual operating costs and charges for supervision, designation of applicant as operator of the well and a charge for risk involved in drilling said well. Said unit is located approximately 6 miles Northwest of Whites City, New Mexico.

320.52

lots 1, 2, 3 and 4 and the S/2 W/2

ILLEGIBLE

R. W. Byram & Co., - April, 1988

STATE OF NEW MEXICO
ENERGY AND MINERALS DEPARTMENT

Garrey Carruthers
Governor

Anita Lockwood
Acting Secretary

OIL CONSERVATION COMMISSION

LAND COMMISSIONER
BILL HUMPHRIES, MEMBER

STATE PETROLEUM ENGINEER
WILLIAM J. LEMAY, MEMBER AND
DIRECTOR, OIL CONSERVATION
DIVISION

STATE GEOLOGIST AND
DIRECTOR, MINING AND
MINERAL DIVISION
ERLING A. BROSTUEN

OIL CONSERVATION DIVISION
Main Office and Geothermal Section Office
State Land Office Bldg., 310 Old Santa Fe Trail, Santa Fe
Mailing Address: P. O. Box 2088, Santa Fe, New Mexico 87504

TELEPHONES:
(505) 827-5800

Director: (505) 827-5802 Engineering: (505) 827-5811
Administration: (505) 827-5804 Legal: (505) 827-5805
Geothermal: (505) 827-5811

WILLIAM J. LEMAY, DIRECTOR

Chief Engineer
Victor T. Lyon

Engineering & Geological
Services Bureau
Michael E. Stogner
David R. Catanach
Roy E. Johnson

General Counsel
Charles Roybal

Environmental Bureau
David Boyer
Jami Bailey
Roger Anderson

Records, Public Information &
Administration Bureau
Prentiss Childs

DISTRICT OFFICES (OIL & GAS)

DISTRICT I - Hobbs 88240

P. O. Box 1980
Telephone: (505) 393-6161

J. T. Sexton, Supervisor and
Oil & Gas Inspector
P. F. Kautz, Geologist and Deputy
Oil & Gas Inspector
Deputy Oil & Gas Inspectors:
R. M. Castleberry
E. W. Seay
D. R. Smith
J. R. Griffin

DISTRICT III - Aztec 87410

1000 Rio Brazos Road
Telephone: (505) 334-6178

F. T. Chavez, Supervisor and
Oil & Gas Inspector
Ernest L. Busch, Geologist and
Deputy Oil & Gas Inspector
C. C. Gholson, Deputy Oil &
Gas Inspector

DISTRICT II - Artesia 88210

P. O. Drawer DD
Telephone: (505) 748-1283

Mike Williams, Acting Supervisor and
Oil & Gas Inspector
Darrell G. Moore, Geologist and Deputy
Oil & Gas Inspector
Deputy Oil & Gas Inspectors:
M. B. Williams
J. D. Robinson
M. C. Stubblefield

DISTRICT IV - Santa Fe 87504

P. O. Box 2088
Telephone: (505) 827-5810

Roy E. Johnson, Geologist and
Oil & Gas Inspector

STATE OF NEW MEXICO
ENERGY, MINERALS AND NATURAL RESOURCES DEPARTMENT
OIL CONSERVATION DIVISION

IN THE MATTER OF THE
APPLICATION OF OGS OPERATING
COMPANY, INC. FOR COMPULSORY
POOLING, EDDY COUNTY, NM

CASE **9523**

CERTIFICATE OF MAILING

AND

COMPLIANCE WITH ORDER R-8054

In Accordance with Division Rule 1207 (Order R-8054) I hereby certify that on October 18, 1988 I caused to be mailed by certified mail return receipt requested notice of this hearing and a copy of the application for the above referenced case along with the cover letter, at least twenty days prior to the hearing set for November 9, 1988, to the parties shown in the Application as evidence by the attached copy of return receipt cards.

W. Thomas Kellahin

SUBSCRIBED AND SWORN to before me this 8th day of October, 1988.

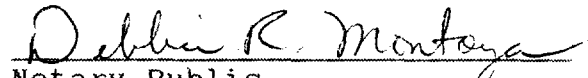
Notary Public

My Commission Expires:

July 25, 1989

BEFORE EXAMINER CATANACH	
OIL CONSERVATION DIVISION	
<u>OGS</u>	EXHIBIT NO. <u>3</u>
CASE NO. <u>9523</u>	

70M - OGS Operating Co - Appl

SENDER: Complete items 1 and 2 when additional services are desired, and complete items 3 and 4.
Put your address in the "RETURN TO" Space on the reverse side. Failure to do this will prevent this card from being returned to you. The return receipt fee will provide you the name of the person delivered to and the date of delivery. For additional fees the following services are available. Consult postmaster for fees and check box(es) for additional service(s) requested.

1. Show to whom delivered, date, and addressee's address. (Extra charge) 2. Restricted Delivery (Extra charge)

3. Article Addressed to: Yates Petroleum Corp. 105 S. Fourth Street Artesia, NM 88210 Attn: Mr. Randy Patterson	4. Article Number P 955 861 831 Type of Service: <input type="checkbox"/> Registered <input type="checkbox"/> Insured <input checked="" type="checkbox"/> Certified <input type="checkbox"/> COD <input type="checkbox"/> Express Mail <input type="checkbox"/> Return Receipt for Merchandise
Always obtain signature of addressee or agent and DATE DELIVERED.	
5. Signature - Address X <i>[Signature]</i>	8. Addressee's Address (ONLY if requested and fee paid)
6. Signature - Agent X	
7. Date of Delivery 10/20/88	

PS Form 3811, Mar. 1988 * U.S.G.P.O. 1988-212-865 DOMESTIC RETURN RECEIPT

Tom - OGS Operating Co - Appl.

SENDER: Complete items 1 and 2 when additional services are desired, and complete items 3 and 4.
Put your address in the "RETURN TO" Space on the reverse side. Failure to do this will prevent this card from being returned to you. The return receipt fee will provide you the name of the person delivered to and the date of delivery. For additional fees the following services are available. Consult postmaster for fees and check box(es) for additional service(s) requested.

1. Show to whom delivered, date, and addressee's address. (Extra charge) 2. Restricted Delivery (Extra charge)

3. Article Addressed to: Santa Fe Energy Company 500 W. Illinois Suite 500 Midland, TX 79701 Attn: Mr. Pat Tower	4. Article Number P 955 861 830 Type of Service: <input type="checkbox"/> Registered <input type="checkbox"/> Insured <input checked="" type="checkbox"/> Certified <input type="checkbox"/> COD <input type="checkbox"/> Express Mail <input type="checkbox"/> Return Receipt for Merchandise
Always obtain signature of addressee or agent and DATE DELIVERED.	
5. Signature - Address X	8. Addressee's Address (ONLY if requested and fee paid)
6. Signature - Agent X <i>[Signature]</i>	
7. Date of Delivery 10-21-88	

PS Form 3811, Mar. 1988 * U.S.G.P.O. 1988-212-865 DOMESTIC RETURN RECEIPT

Tom - OGS Operating Co - Appl.

SENDER: Complete items 1 and 2 when additional services are desired, and complete items 3 and 4.
Put your address in the "RETURN TO" Space on the reverse side. Failure to do this will prevent this card from being returned to you. The return receipt fee will provide you the name of the person delivered to and the date of delivery. For additional fees the following services are available. Consult postmaster for fees and check box(es) for additional service(s) requested.

1. Show to whom delivered, date, and addressee's address. (Extra charge) 2. Restricted Delivery (Extra charge)

3. Article Addressed to: Amoco Production Co. 501 Westlake Park Blvd. Houston, TX 77077 Attn: Mr. Tim Custer	4. Article Number P 955 861 832 Type of Service: <input type="checkbox"/> Registered <input type="checkbox"/> Insured <input checked="" type="checkbox"/> Certified <input type="checkbox"/> COD <input type="checkbox"/> Express Mail <input type="checkbox"/> Return Receipt for Merchandise
Always obtain signature of addressee or agent and DATE DELIVERED.	
5. Signature - Address X	8. Addressee's Address (ONLY if requested and fee paid)
6. Signature - Agent X <i>[Signature]</i>	
7. Date of Delivery 10/24	

PS Form 3811, Mar. 1988 * U.S.G.P.O. 1988-212-865 DOMESTIC RETURN RECEIPT

KELLAHIN, KELLAHIN and AUBREY

Attorneys at Law

El Patio - 117 North Guadalupe

Post Office Box 2265

Santa Fé, New Mexico 87504-2265

Telephone 982-4285

Area Code 505

W. Thomas Kellahin
Karen Aubrey

Jason Kellahin
Of Counsel

October 18, 1988

RECEIVED

OCT 18 1988

Mr. William J. LeMay
Oil Conservation Division
P.O. Box 2088
Santa Fe, NM 87504

OIL CONSERVATION DIVISION

HAND DELIVERED

Re: OGS Operating Company, Inc.
for Compulsory Pooling
Eddy County, New Mexico

Dear Mr. LeMay:

On behalf of OGS Operating Company, Inc., we would appreciate you setting the enclosed application for a public hearing on the Division's Examiner docket now scheduled for November 9, 1988.

By copy of this letter to all parties to be pooled, we are notifying them by certified mail-return receipt, that they have the right to appear at the hearing, to make a statement to the Division, to present evidence and cross-examine witnesses either in support of or in opposition to the application. Those parties are directed to contact the Division or the applicant's attorney to determine what additional rights they may have. In addition, they are advised that the entry of a compulsory pooling order will affect their rights to share in the production from the subject well.

Very truly yours,

Signature of W. Thomas Kellahin

W. Thomas Kellahin

WTK/dm
Encl.

cc: Thom O'Brien
OGS Operating Co.

"Certified Return-Receipt Requested"
all parties to be pooled

STATE OF NEW MEXICO
ENERGY AND MINERALS DEPARTMENT
OIL CONSERVATION DIVISION

GARREY CARRUTHERS
GOVERNOR

November 21, 1988

POST OFFICE BOX 2088
STATE LAND OFFICE BUILDING
SANTA FE, NEW MEXICO 87501
(505) 827-5800

Mr. Thomas Kellahin
Kellahin, Kellahin & Aubrey
Attorneys at Law
Post Office Box 2265
Santa Fe, New Mexico

Re: CASE NO. 9523
ORDER NO. R-3789

Applicant:
OGS Operating Company, Inc.

Dear Sir:

Enclosed herewith are two copies of the above-referenced
Division order recently entered in the subject case.

Sincerely,

Florene Davidson

FLORENE DAVIDSON
OC Staff Specialist

Copy of order also sent to:

Hobbs OCD x
Artesia OCD x
Aztec OCD

Other _____
