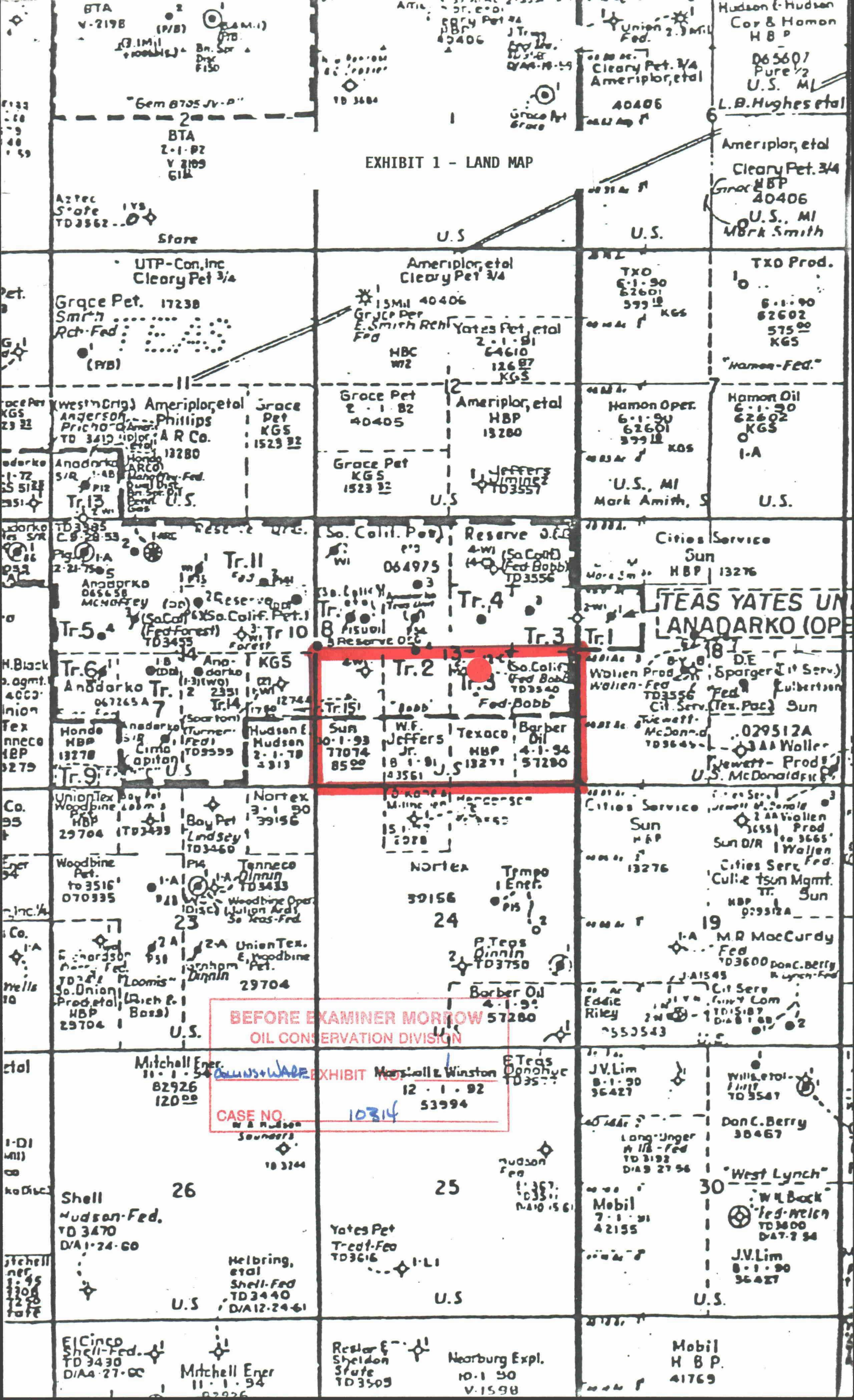

EXHIBIT 1 - LAND MAP



BEFORE EXAMINER MORROW  
OIL CONSERVATION DIVISION  
EXHIBIT NO. 10314  
CASE NO. 10314

BTA  
V-2198  
"Gem 8705 JV-A"  
BTA  
2-1-82  
V 2109  
G1K

Store  
AZtec  
S. of  
TD3562

UTP-Con, Inc  
Cleary Pet 3/4  
Grace Pet. 17238  
Smt. 7  
Rct. Fed.  
(P/B)

Weston (Grig) Ameriplor, etal  
Phillips  
TD 3413  
A R Co.  
13280  
Anadarko  
S/R  
Tr. 13

Tr. 5  
Tr. 6  
Tr. 7  
Tr. 8  
Tr. 9  
Tr. 10  
Tr. 11  
Tr. 12  
Tr. 13  
Tr. 14  
Tr. 15

Hudson E  
Hudson  
2-1-78  
2313

UnionTex  
Woodbine  
HBP  
29704  
Woodbine  
Pet.  
to 3516  
070335

Shell  
Hudson-Fed.  
TD 3470  
D/A 1-24-60

Shell  
Hudson-Fed.  
TD 3470  
D/A 1-24-60

El Cinco  
Shell-Fed.  
TD 3430  
D/A 4-27-60

Ameriplor, etal  
Cleary Pet 3/4  
15 Mil 40406  
Gr JCP Per  
E. Smith Rch  
Fed  
HBC  
W72

Ameriplor, etal  
Cleary Pet 3/4  
Grace Pet  
2-1-82  
40405

Grace Pet  
KGS  
1523 32

So. Calif. Pub  
064975

Tr. 2  
Tr. 3  
Tr. 4  
Tr. 5  
Tr. 6  
Tr. 7  
Tr. 8  
Tr. 9  
Tr. 10  
Tr. 11  
Tr. 12  
Tr. 13  
Tr. 14  
Tr. 15

Nortex  
3-1-90  
39156

Yates Pet  
Treat-Fed  
TD 3616

Yates Pet  
Treat-Fed  
TD 3616

Restar E  
Sheldon  
State  
TD 3509

Union 2.3 Mil  
Cleary Pet. 3/4  
Ameriplor, etal  
40406

TXO Prod.  
6-1-90  
62601  
575 00  
KGS

Hamon Oper.  
6-1-90  
62601  
575 00  
KGS

Cities Service  
Sun  
HBP  
13276

Barber  
Oil  
4-1-94  
57280

Cities Service  
Sun  
HBP  
13276

Barber Oil  
4-1-94  
57280

J.V. Lim  
8-1-90  
36427

Mobil  
H B P.  
41769

Hudson E-Hudson  
Cor & Hamon  
H B P  
D65607  
Pure 1/2  
U.S. MI  
L.B. Hughes etal

Ameriplor, etal  
Cleary Pet. 3/4  
HBP  
40406  
U.S., MI  
MBrk Smith

Hamon Oil  
6-1-90  
62602  
KGS  
I-A  
U.S.

Wolien Prod  
Wolien-Fed  
TD 3556  
Cit. Serv. (Tex. Pac) Sun

Wolien Prod  
Wolien-Fed  
TD 3556  
Cit. Serv. (Tex. Pac) Sun

Cities Service  
Sun  
HBP  
13276

Eddie  
Riley

Don C. Berry  
38467

J.V. Lim  
8-1-90  
36427