

Acreege Plat

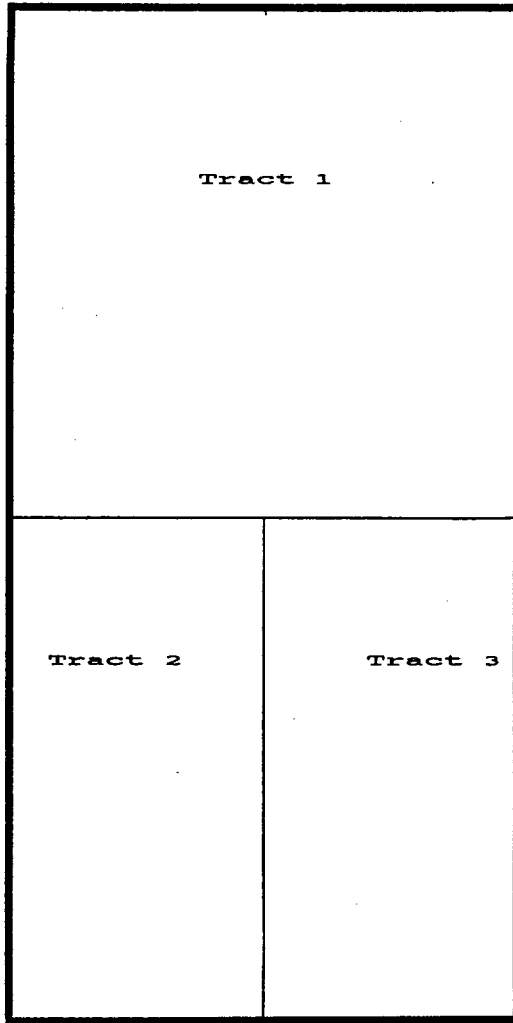

BEFORE EXAMINER CATANACH
OIL CONSERVATION DIVISION

CH EXHIBIT NO. 2

CASE NO. 10389

Scale: 1" = 1000'

T-8-S, R-37-E:
Section 5: W/2
Roosevelt Co., New Mexico

Leasehold & Mineral Ownership:

Tract 1: Lots 3, 4 and S/2 NW/4 (all NW/4) of Section 5 - 159.09 ac

Mineral Owner	Lessee	Net Acres
1. Jerry Mahoney	Chi Energy	79.545
2. Faye Saunders	Chi Energy	26.156
3. Mary Lee Reese	Chi Energy	13.257
4. Woodlan P. Saunders	Open of record Chi	13.257
5. Sally Saunders Toles	Chi Energy	8.838
6. SSG Limited Partnership	Chi Energy	8.838
7. Elyse Saunders Patterson	Chi Energy	8.838

cont.

Leasehold & Mineral Ownership cont.

Tract 2: W/2 SW/4 of Section 5 - 80.00 ac

Mineral Owner	Lessee	Net Acres
1. Faye Ainsworth	Chi Energy	20.000
2. Exalee Howard	Chi Energy	20.000
3. J. C. Ainsworth Estate Trust Joe C. Ainsworth III, David B. Ainsworth and Nancy Johnson, Trustees	Open of record Chi	20.000
4. Ross N. Ainsworth	Open of record Chi	10.000
5. Mary Nell Hayes	Chi Energy	10.000

Tract 3: E/2 SW/4 of Section 5 - 80.00 ac

Mineral Owner	Lessee	Net Acres
1. Colene Scheller and Laura Jean Moomey as Attnys in Fact for Gladys Perucca	Chi Energy	40.000
2. S. L. Parham, Jr.	Chi Energy	20.000
3. McDuff Partners	Chi Energy	15.000
4. Hrs. of Mary Ann Gelder	Open of record	5.000

Total Net Acres leased to Chi:

314.09
~~270.033~~

Total Net Acres Open of record:

5.00
~~48.257~~

Total Acres:

319.09