

BEFORE THE OIL CONSERVATION DIVISION  
OF THE STATE OF NEW MEXICO

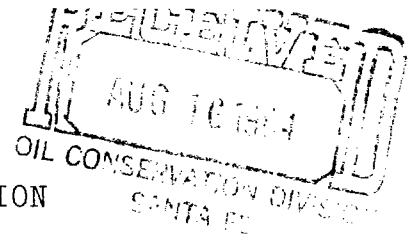

IN THE MATTER OF THE APPLICATION OF :  
MARBOB ENERGY CORPORATION FOR AN : CASE NO. 8325  
UNORTHODOX OIL WELL LOCATION, EDDY :  
COUNTY, NEW MEXICO :

---

APPLICATION

COMES NOW MARBOB ENERGY CORPORATION, by its attorneys, and in support hereof, respectfully states:

1. Applicant is the operator of the Grayburg-San Andres formation, (Grayburg Jackson Seven Rivers Queen Grayburg San Andres Pool), and underlying:

TOWNSHIP 17 SOUTH, RANGE 29 EAST, N.M.P.M.

Section 22: NE/14NE/14

containing 40 acres, more or less,  
and proposes to drill its M. Dodd A No. 34 Well at a point located 100 feet from the north line and 330 feet from the east line of Section 22.

2. The applicant seeks an exception to the well location requirements of Rule 104-C.1(a) of the Oil conservation Division to permit the drilling of the well at the above mentioned unorthodox location to a depth sufficient to adequately test the Grayburg-San Andres formation.

3. The approval of this application will afford applicant the opportunity to produce its just and equitable share of oil and will otherwise prevent waste and protect correlative rights.

WHEREFORE, applicant prays:

A. That this application be set for hearing on September 5, 1984 before an examiner and that notice of said hearing be given as required by law.

B. That upon hearing the Division enter its order granting applicant permission to drill its M. Dodd No. 34 Well at a point 100 feet from the north line and 330 feet from the east line of said Section 22.

C. And for such other and further relief as may be just in the premises.

MARBOB ENERGY CORPORATION

BY:

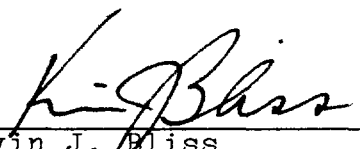
  
\_\_\_\_\_  
Kevin J. Bliss  
Attorney for Applicant

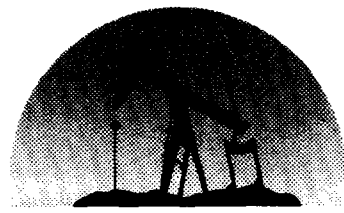

**marbob**  
energy corporation  
July 11, 1984

By JPP

Case 8325

Joe D. Ramey  
Director  
Oil Conservation Division  
P. C. Box 2088  
Santa Fe, New Mexico 87501

NSL -

RULE 104 FI

Release August 2, 1984

40 ACRES. Dedicated SE/4 NE/4 of  
Sec. 20

Federal, State,  
Dear Mr. Ramey: and Fee

The purpose of this letter is to request administrative approval without notice and hearing of unorthodox well locations within a secondary recovery project. The well locations for which administrative approval are sought are the M. Dodd A No. 31 located 1350 feet FNL and 330 feet FEL in Section 22, Township 17 South, Range 29 East and the M. Dodd A No. 34 located 100 feet FNL and 330 feet FEL in Section 22, Township 17 South, Range 29 East, Eddy County, New Mexico. The wells will be completed in the Grayburg San Andres formation in the Grayburg Jackson Seven Rivers Queen Grayburg San Andres Pool. The wells will permit and continue to effect an efficient production and injection pattern within the secondary recovery project and are necessary for adequate drainage. Note that these locations are not closer than 330 feet to an outer boundary of the lease nor closer than 10 feet to any quarter quarter section line.

Attached to this application as Exhibits A, B, C, and D are the following:

- A. Well location and Acreage  
Dedication Plats (Forms C-102)  
filed with the Artesia office  
of the Oil Conservation Division.  
(Exhibits A and B).
- B. A list of wells located within the  
secondary recovery project indicating  
specifically which wells are production  
and which are injection wells. (Exhibit C).
- C. A plat showing the ownership of the  
offsetting leases. (Exhibit D).

Tenneco Oil Exploration and Production, Phillips Oil Company (formerly General American), and Marbob are the operators of proration units offsetting the proration units containing the proposed unorthodox locations in the Grayburg Jackson Seven Rivers Queen Grayburg San Andres Pool. Both Tenneco and Phillips have been notified of this application by certified mail and have been requested to notify you if they have no objections.

Thank-you very much for your help in this matter. Should you have any further questions or be in need of any additional information, please contact Kevin Bliss or Raye P. Miller.

Sincerely,

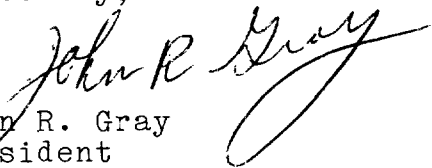
  
John R. Gray  
President

JRG:kmh

NEW MEXICO OIL CONSERVATION COMMISSION  
WELL LOCATION AND ACREAGE DEDICATION PLAT

Form C-102  
Supersedes C-128  
Effective 1-1-65

All distances must be from the outer boundaries of the Section.

Operator MARBOB ENERGY CORP.			Lease M. DODD "A"		Well No. 31
Unit Letter H	Section 22	Township 17S	Range 29E	County EDDY	
Actual Footage Location of Well: 1350 feet from the NORTH line and 330 feet from the EAST line					
Ground Level Elev. 3585.6	Producing Formation San Andres	Pool Grayburg Jackson SR-Qn-G-SA		Dedicated Acreage: 40 Acres	

1. Outline the acreage dedicated to the subject well by colored pencil or hachure marks on the plat below.
2. If more than one lease is dedicated to the well, outline each and identify the ownership thereof (both as to working interest and royalty).
3. If more than one lease of different ownership is dedicated to the well, have the interests of all owners been consolidated by communitization, unitization, force-pooling, etc?

☐ Yes ☐ No If answer is "yes," type of consolidation \_\_\_\_\_

If answer is "no," list the owners and tract descriptions which have actually been consolidated. (Use reverse side of this form if necessary.) \_\_\_\_\_

No allowable will be assigned to the well until all interests have been consolidated (by communitization, unitization, forced-pooling, or otherwise) or until a non-standard unit, eliminating such interests, has been approved by the Commission.

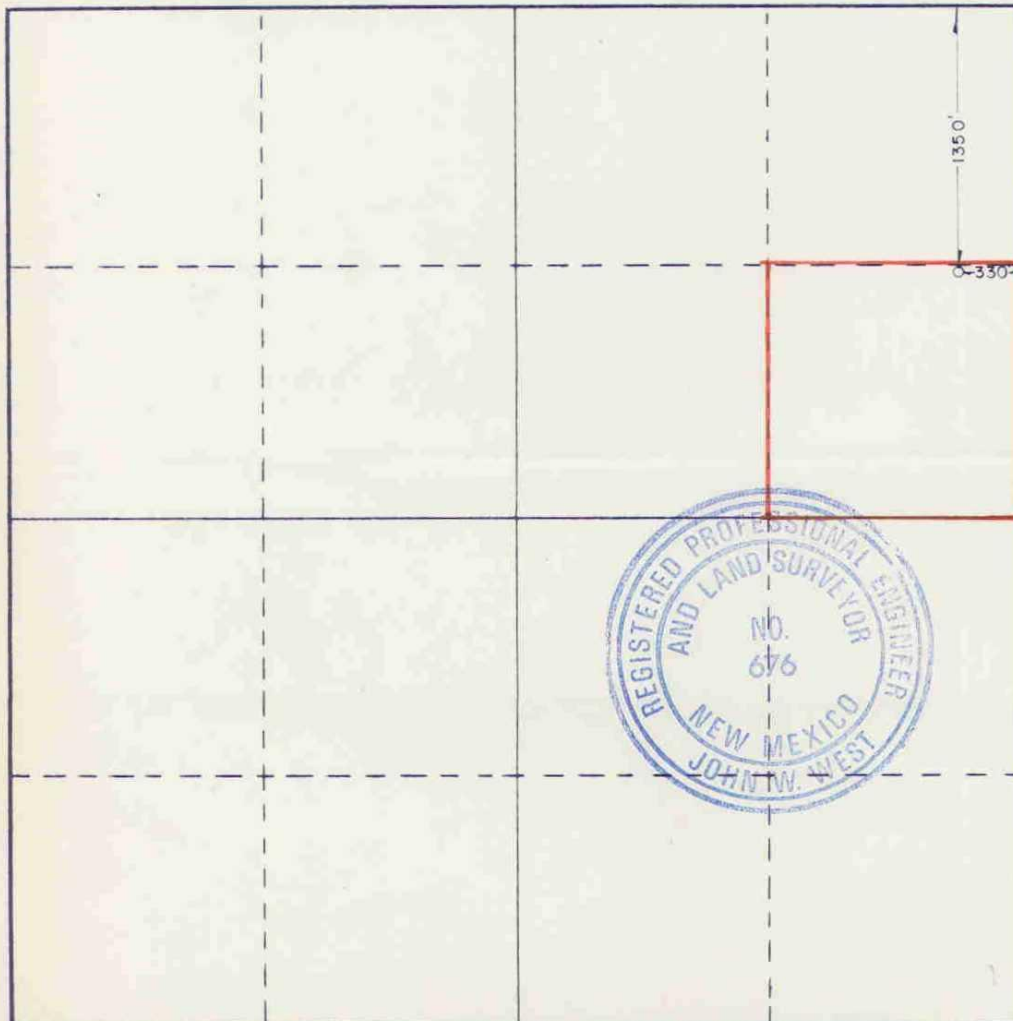

CERTIFICATION

I hereby certify that the information contained herein is true and complete to the best of my knowledge and belief.

*Carolyn Orris*  
Name

Carolyn Orris

Position

Production Clerk

Company

Marbob Energy Corp.

Date

7/6/84

I hereby certify that the well location shown on this plat was plotted from field notes of actual surveys made by me or under my supervision, and that the same is true and correct to the best of my knowledge and belief.

Date Surveyed

7/3/84

Registered Professional Engineer  
and/or Land Surveyor

*John W. West*

Certificate No. JOHN W. WEST, 676

RONALD J. EIDSON, 3239

0 330 660 990 1320 1650 1980 2310 2640 2970 3300 3630 3960 4290 4620 4950 5280 5610 5940 6270 6600

EXHIBIT "C"

TOM BOYD DODD (U.S. LEASE NO. 058362)

<u>WELL NO.</u>	<u>LEGAL DESCRIPTION</u>	<u>TYPE OF WELL</u>
2	1980 FSL 660 FEL 11-17-29	Production
3	660 FSL 1980 FEL 11-17-29	Production
4	1980 FSL 1980 FEL 11-17-29	Injection
5	330 FSL 330 FEL 11-17-29	Injection
6	1295 FSL 2310 FEL 11-17-29	Production (Proposed)

CONTINENTAL STATE (NM LEASE NO. E-4200)

1	660 FSL 1980 FWL 15-17-29	Production
2	1980 FSL 1980 FWL 15-17-29	Production (Plugged)
3	1980 FNL 1980 FWL 15-17-29	Production (Plugged)

Underlined wells indicate the wells for which administrative approval of unorthodox location is sought herein.

EXHIBIT "C"

MARY DODD A (U.S. LEASE NO. 028731 A)

<u>WELL NO.</u>	<u>LEGAL DESCRIPTION</u>	<u>TYPE OF WELL</u>
1	330 FSL 1650 FWL 22-17-29	Production (Plugged)
2	1980 FSL 660 FEL 22-17-29	Production
3	1980 FNL 660 FEL 22-17-29	Production
4	660 FSL 660 FEL 22-17-29	Production
5	660 FSL 1980 FEL 22-17-29	Production (Plugged)
6	1980 FSL 1980 FEL 22-17-29	Production
7	330 FSL 330 FEL 22-17-29	Production
8	330 FSL 1650 FEL 22-17-29	Production
9	1980 FNL 1980 FEL 22-17-29	Injection (Plugged)
10	675 FNL 660 FEL 22-17-29	Injection
11	1650 FSL 330 FEL 22-17-29	Production
12	1650 FSL 1650 FEL 22-17-29	Production
13	660 FSL 660 FEL 15-17-29	Production
14	330 FSL 2310 FWL 22-17-29	Production
15	2160 FNL 330 FEL 22-17-29	Production
16	1980 FSL 660 FEL 15-17-29	Production
17	350 FSL 1650 FEL 15-17-29	Production
18	330 FSL 990 FWL 14-17-29	Production
19	1650 FSL 1650 FEL 15-17-29	Injection
20	1980 FSL 660 FWL 14-17-29	Injection
21	660 FSL 1934 FEL 15-17-29	Production (re-entry)
22	2310 FSL 330 FEL 22-17-29	Production
23	2615 FSL 1345 FEL 22-17-29	Production
24	2310 FSL 2310 FEL 22-17-29	Production
25	990 FSL 2210 FEL 22-17-29	Production
26	2615 FSL 1345 FEL 22-17-29	Production
27	940 FSL 330 FEL 22-17-29	Production
28	990 FSL 1652 FWL 22-17-29	Production
29	1650 FNL 1370 FEL 22-17-29	Production
30	330 FSL 1980 FWL 14-17-29	Production
<u>31</u>	<u>1650 FNL 330 FEL 22-17-29</u>	<u>Production(Proposed)</u>
32	1650 FNL 2210 FEL 22-17-29	Production
33	990 FNL 990 FEL 22-17-29	Production(Proposed)
<u>34</u>	<u>100 FNL 330 FEL 22-17-29</u>	<u>Production(Proposed)</u>
35	330 FSL 330 FWL 14-17-29	Production(Proposed)

EXHIBIT "C"

MARY DODD B. (U.S. LEASE NO. 028731 B)

<u>WELL NO.</u>	<u>LEGAL DESCRIPTION</u>	<u>TYPE OF WELL</u>
1	660 FNL 660 FEL 14-17-29	Production
2	1980 FNL 660 FEL 14-17-29	Injection
3	1980 FNL 660 FWL 14-17-29	Production
4	660 FNL 1980 FEL 14-17-29	Injection
6	660 FNL 1980 FWL 14-17-29	Production
7	1980 FNL 1980 FWL 14-17-29	Injection (Plugged)
8	660 FNL 660 FWL 14-17-29	Injection
9	1980 FNL 660 FEL 15-17-29	Injection (Plugged)
10	660 FNL 1980 FWL 10-17-29	Production
11	660 FNL 660 FEL 15-17-29	Production
12	1980 FNL 1980 FWL 10-17-29	Production
13	1980 FSL 1650 FWL 10-17-29	Production
14	990 FSL 1650 FWL 10-17-29	Production
15	330 FSL 2310 FEL 10-17-29	Production
16	660 FNL 1980 FEL 15-17-29	Injection
17	1980 FNL 660 FWL 14-27-29	Production
18	1980 FWL 1980 FSL 14-17-29	Injection (Plugged)
19	660 FSL 660 FWL 11-17-29	Production
20	660 FSL 660 FEL 10-17-29	Injection
21	660 FSL 1980 FWL 11-17-29	Injection
22	1980 FSL 1980 FEL 14-17-29	Injection
23	1980 FSL 1980 FWL 11-17-29	Production
24	1980 FNL 1980 FEL 14-17-29	Production
25	1980 FNL 1980 FEL 15-17-29	Production
26	1980 FSL 660 FEL 10-17-29	Production
27	1980 FSL 660 FWL 11-17-29	Injection
28	1980 FSL 1980 FEL 10-17-29	Injection
29	1980 FNL 1980 FEL 10-17-29	Production
30	1980 FNL 660 FEL 10-17-29	Injection
31	1980 FNL 660 FWL 11-17-29	Production
32	1980 FNL 1980 FWL 11-17-29	Injection
34	660 FSL 1980 FEL 14-17-29	Production
35	330 FSL 330 FEL 14-17-29	Production
36	330 FSL 1345 FEL 14-17-29	Production
37	1345 FSL 1295 FEL 14-17-29	Production
38	1345 FSL 2310 FEL 14-17-29	Production
39	330 FEL 1345 FSL 14-17-29	Production
40	1650 FSL 1650 FWL 14-17-29	Production (Proposed)
41	2615 FNL 330 FEL 14-17-29	Production (Proposed)
42	2615 FNL 1345 FEL 14-17-29	Production (Proposed)
43	2565 FSL 2465 FEL 14-17-29	Production (Proposed)
44	2615 FSL 1750 FWL 14-17-29	Production (Proposed)



M. Dodd A 31 Proration Unit  
M. Dodd A 34 Proration Units  
Offsetting Proration Units  
Marbob Operated Proration Units



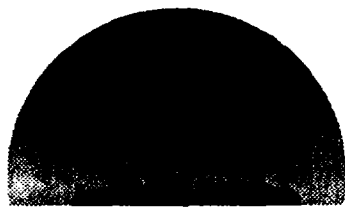

**marbob**

energy corporation

July 11, 1984

RECEIVED

JUL 20 1984

OIL CONSERVATION DIVISION

Phillips Oil Company  
4001 Penbrook  
Odessa, Texas 79762  
Attn: Harold McLemore

RE: M. Dodd A. No. 31:  
1350 FNL, 330 FEL  
Sec. 22, T-17S, R-29E.  
M. Dodd A No. 34:  
100 FNL, 330 FEL  
Sec. 22, T-17S, R-29E.  
Eddy County, New Mexico  
Grayburg Jackson Seven  
Rivers Queen Grayburg  
San Andres Pool.

Gentlemen:

Marbob Energy Corporation as operator of the M. Dodd A No.s 31 and 34 wells hereby notifies you that we have applied to the New Mexico Oil Conservation Division for administrative approval of unorthodox locations and permits to drill at the above locations. Administrative approval is being sought on the basis that the wells are being drilled in a secondary recovery project.

You are being contacted as an operator of a proration unit offsetting the above described locations in the Grayburg Jackson Seven Rivers Queen Grayburg San Andres Pool. If you have no objections to the drilling of these wells sign below and forward one copy to the NMOCD in Santa Fe, one copy to this office, and retain one copy for your files. I have provided addressed stamped envelopes for your convenience.

Thank-you very much for your cooperation in this matter.  
Please do not hesitate to contact me should you have any  
questions.

Sincerely,



Kevin J. Bliss  
Land Department

APPROVAL

COMPANY: Phillips Oil Company  
BY: G. R. Smith G. R. Smith  
TITLE: Director, Reservoir Engineering  
DATE: July 13, 1984

CRRR:

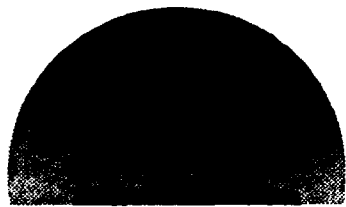

**marbob**  
energy corporation

July 11, 1984



Tenneco Oil Exploration and Production  
Southwestern Division  
6800 Park Ten Boulevard  
Suite 200 North  
San Antonio, Texas 78213  
Attn: Douglas C. Keen

RE: M. Dodd A. No. 31:  
1350 FNL, 330 FEL  
Sec. 22, T-17S, R-29E.  
M. Dodd A No. 34:  
100 FNL, 330 FEL  
Sec. 22, T-17S, R-29E.  
Eddy County, New Mexico  
Grayburg Jackson Seven  
Rivers Queen Grayburg  
San Andres Pool.

Gentlemen:

Marbob Energy Corporation as operator of the M. Dodd A No.s 31 and 34 wells hereby notifies you that we have applied to the New Mexico Oil Conservation Division for administrative approval of unorthodox locations and permits to drill at the above locations. Administrative approval is being sought on the basis that the wells are being drilled in a secondary recovery project.

You are being contacted as an operator of a proration unit offsetting the above described locations in the Grayburg Jackson Seven Rivers Queen Grayburg San Andres Pool. If you have no objections to the drilling of these wells sign below and forward one copy to the NMOCD in Santa Fe, one copy to this office, and retain one copy for your files. I have provided addressed stamped envelopes for your convenience.

Thank-you very much for your cooperation in this matter.  
Please do not hesitate to contact me should you have any  
questions.

Sincerely,



Kevin J. Bliss  
Land Department

APPROVAL

COMPANY: Tenneco Oil Co.  
BY: Douglass C. Leon  
TITLE: Dir. Geol. Eng. Mgr  
DATE: July 23, 1984

CRRR: