

## APPLICATION FOR AUTHORIZATION TO INJECT

BEFORE EXAMINER STOGNER  
OIL CONSERVATION DIVISION

- I. Purpose: ☐ Secondary Recovery ☐ Pressure Maintenance ☒ Disposal ☐ Storage  
Application qualifies for administrative approval? ☒ yes ☐ no

II. Operator: SAGE ENERGY COMPANYCASE NO. 8926Address: P. O. Drawer 3068, Midland, Texas 79702Contact party: Jay H. Hardy/Danny Roberts Phone: 915 683 5271

III. Well data: Complete the data required on the reverse side of this form for each well proposed for injection. Additional sheets may be attached if necessary.

- IV. Is this an expansion of an existing project? ☐ yes ☒ no  
If yes, give the Division order number authorizing the project \_\_\_\_\_.

V. Attach a map that identifies all wells and leases within two miles of any proposed injection well with a one-half mile radius circle drawn around each proposed injection well. This circle identifies the well's area of review.

- \* VI. Attach a tabulation of data on all wells of public record within the area of review which penetrate the proposed injection zone. Such data shall include a description of each well's type, construction, date drilled, location, depth, record of completion, and a schematic of any plugged well illustrating all plugging detail.

VII. Attach data on the proposed operation, including:

1. Proposed average and maximum daily rate and volume of fluids to be injected;
2. Whether the system is open or closed;
3. Proposed average and maximum injection pressure;
4. Sources and an appropriate analysis of injection fluid and compatibility with the receiving formation if other than reinjected produced water; and
5. If injection is for disposal purposes into a zone not productive of oil or gas at or within one mile of the proposed well, attach a chemical analysis of the disposal zone formation water (may be measured or inferred from existing literature, studies, nearby wells, etc.).

- \* VIII. (Attach appropriate geological data on the injection zone including appropriate lithologic detail, geological name, thickness, and depth. Give the geologic name, and depth to bottom of all underground sources of drinking water (aquifers containing waters with total dissolved solids concentrations of 10,000 mg/l or less) overlying the proposed injection zone as well as any such source known to be immediately underlying the injection interval.)

IX. Describe the proposed stimulation program, if any.

- \* X. Attach appropriate logging and test data on the well. (If well logs have been filed with the Division they need not be resubmitted.)

- \* XI. Attach a chemical analysis of fresh water from two or more fresh water wells (if available and producing) within one mile of any injection or disposal well showing location of wells and dates samples were taken.

XII. Applicants for disposal wells must make an affirmative statement that they have examined available geologic and engineering data and find no evidence of open faults or any other hydrologic connection between the disposal zone and any underground source of drinking water.

XIII. Applicants must complete the "Proof of Notice" section on the reverse side of this form.

## XIV. Certification

I hereby certify that the information submitted with this application is true and correct to the best of my knowledge and belief.

Name: Jay H. Hardy Title: Vice President - EngineeringSignature: Jay H. Hardy Date: April 29, 1986

- \* If the information required under Sections VI, VIII, X, and XI above has been previously submitted, it need not be duplicated and resubmitted. Please show the date and circumstance of the earlier submittal.

NA

DISTRIBUTION: Original and one copy to Santa Fe with one copy to the appropriate Division district office.



S. P. YATES  
PRESIDENT  
JOHN A. YATES  
VICE PRESIDENT  
- B. W. HARPER  
SEC. - TREAS.

105 SOUTH FOURTH STREET  
ARTESIA, NEW MEXICO 88210  
TELEPHONE (505) 748-1471

June 20, 1986

Sage Energy Company  
P. O. Box 3068  
Midland, Texas 79702

Attention: Mr. Jay H. Hardy

BEFORE EXAMINER STOGNER OIL CONSERVATION DIVISION	
<i>Sage Energy</i>	EXHIBIT NO. <u>2</u>
CASE NO. <u>8926</u>	

Re: Agreement to Inject Produced  
Water into the Lowe State # 1  
Well  
Sec. 10, T15S-R33E  
Lea County, New Mexico

Gentlemen:

In our telephone conversation today we discussed your desire to inject water into the captioned well and our concerns about the water being injected into the same interval as is producing in our off-set wells. We also discussed our letter to you, dated May 13, 1986, in which we informed you that we would oppose your application before the New Mexico Oil Conservation Division.

This is to evidence an agreement between us that Sage Energy Company will be able to inject produced water into the captioned well without objection of Yates Petroleum Corporation under the following conditions:

1. Only water produced on the W/2SW/4 Section 10, T15S-R33E will be injected into the subject well.
2. The maximum rate of injection will be 40 barrels of water per day. This injection rate will be the average daily injection based on the total volume of water injected during any single month period.
3. Yates will have the right to monitor the injection rate by using any industry-accepted method. If Yates desires to use equipment such as a flow meter to monitor said rate the cost and expense of maintaining such equipment will be borne by Yates.
4. Yates reserves the right to object to the NMOCD and any other regulatory and/or judicial body should the average daily rate of injection exceed that agreed upon herein.

Sage Energy Company  
June 20, 1986

Page 2

If these terms are acceptable to you, please sign and return one copy of this letter agreement to us.

Very truly yours,

YATES PETROLEUM CORPORATION



Randy G. Patterson  
Land Manager

RGP/mw

The above terms are accepted and agreed upon this 23 day of June, 1986.

SAGE ENERGY COMPANY

By

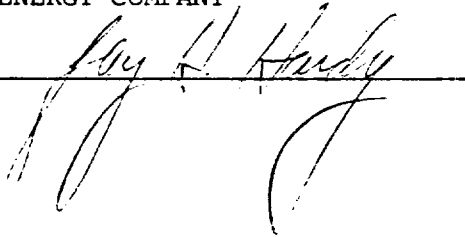

BEFORE EXAMINER STOGNER OIL CONSERVATION DIVISION	
<u>Sage Energy</u>	EXHIBIT NO. <u>3</u>
CASE NO. <u>8926</u>	

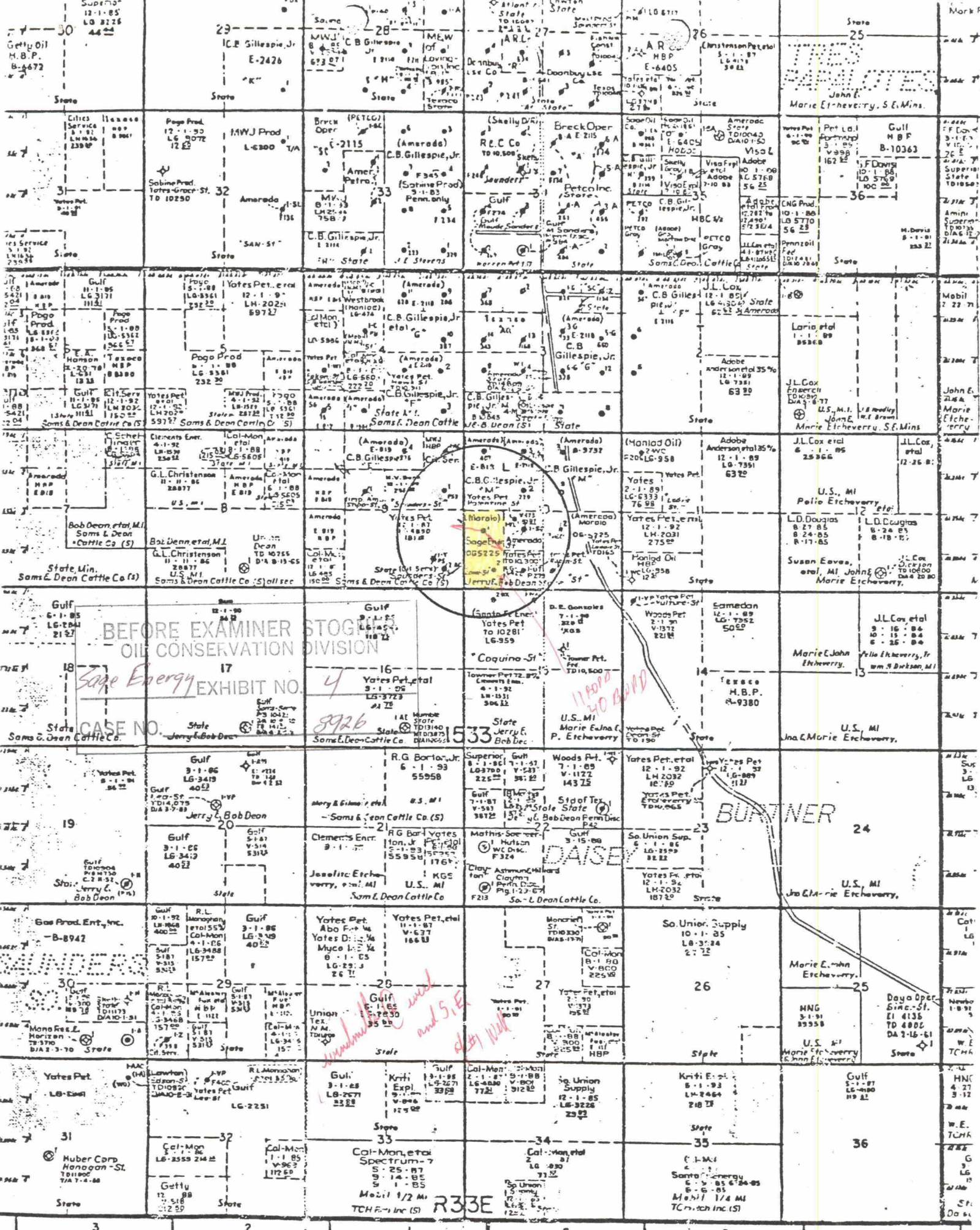

WELLS IN AREA OF REVIEW

<u>SAGE ENERGY COMPANY</u>	<u>LOCATION</u>	<u>TYPE</u>	<u>COMPLETION DATE</u>	<u>TD/PE</u>	<u>CASING PROGRAM</u>	<u>PERFORATIONS</u>
<u>Lowe State</u>	1L	10-15-33	011 6/4/69	10,200' / 10,020'	13 3/8" - 355', 365 sx; 8 5/8" - 4280', 700 sx; 5 1/2" - 10199', 500 sx; 12 3/4" - 411', 375 sx; 8 5/8" - 4230', 1000 sx; 5 1/2" 10058', 400 sx;	9565' - 9890'
<u>Lowe State</u>	2M	10-15-33	011 7/6/84	10,058' / 10,013'		9951' - 9970'
<u>YATES PETROLEUM CORP.</u>						
<u>Valentine State</u>	1K	10-15-33	011 1/10/83	10,400' / 10,300'	13 3/8" - 455', 450 sx; 8 5/8" - 4190', 2250 sx.; 5 1/2" 10397'; 1300 sx; 13 3/8" - 455, 450 sx, 8 5/8" - 4159', 1850 sx.; 5 1/2" 10050', 850 sx;	9797' - 10114'
<u>Robin UT State</u>	1N	10-15-33	011 3/29/83	10,250' / 10,003'		9865' - 9974'
<u>MARALO INC.</u>						
<u>State 10</u>	10	10-15-33	011 4/17/84	10,205' / 10,148'	13 3/8" - 432', 400 sx; 8 5/8" - 4030', 1550 sx; 5 1/2" - 10205', 1175 sx; 13 3/8" - 405', 400 sx; 8 5/8" - 4000', 1400 sx; 5 1/2" - 10,200', 1180 sx;	9944' - 9968'
<u>State 10</u>	2J	10-15-33	011 5/19/84	10,200' / -		9818' - 9998'
<u>CHARLES GILLESPIE, Jr.</u>						
<u>State "M"</u>	1D	10-15-33	011 10/24/51	10,077' / 9925'	13 3/8" - 297', 250 sx; 8 5/8" - 4232', 13 3/8" - 9925', 600 sx; 13 3/8" - 295', 250 sx; 8 5/8" - 4235', 1500 sx; 5 1/2" - 9960', 600 sx;	9800' - 9914'
<u>State "M"</u>	2F	10-15-33	011 3/11/52	10,050' / 9950'		9911' - 9925'
<u>AMERADA</u>						
<u>State SG #1</u>	1K	10-15-33 P&A	12/4/52	10,069' / -	13 3/8" - 295', 300 sx; 8 5/8" - 4235', 1500 sx; 5 1/2" - 9960', 500 sx.	9845' - 9860'
<u>YATES PETROLEUM CORP.</u>						
<u>Coquina WK State 1C</u>		15-15-33	011 4/19 83	10,181' / 10,116'	13 3/8" - 461', 450 sx; 8 5/8" - 4175', 2835 sx; 5 1/2" - 10181', 800 sx;	9867' - 9999'
<u>Coquina WK State 2D</u>		15-15-33	011 1/23/84	10,224' / 10,098'	13 3/8" - 455', 450 sx; 8 5/8" - 4195', 1710 sx; 5 1/2" 10,224', 1080 sx;	9502' - 9907'

BEFORE EXAMINER STOGNE  
OIL CONSERVATION DIVISION

Sage Energy

EXHIBIT NO. 5

CASE NO. 8926

LOCATION		TYPE	COMPLETION DATE	TD/PBD	CASING PROGRAM	PERFORATION
<u>IMPERIAL AMERICAN</u>						
Saunders State Y	1P	9-15-33 P&A	9/14/69	10,120' / 10,067'	13 3/8" - 325', 400 sx;;, 8 5/8" - 4280', 600 sx;	9574' - 1001
<u>IMPERIAL AMERICAN</u>						
State AC #1	1P	9-15-33 P&A	3/5/53	10,078' / -	13 3/8" - 346', 325 sx; 8 5/8" - 4276', 2335 sx; 5 1/2" - 10076', 200 sx;	9574' - 1003
<u>MMU PROD. Co.</u>						
Saunders 9 State	1H	9-15-33 011	7/26/82	10,150' / 10,064'	13 3/8" - 392', 700 sx; 8 5/8" - 4237', 1500 sx; 5 1/2" - 10150', 300 sx;	9806' - 9896

BEFORE EXAMINER STOGNER  
OIL CONSERVATION DIVISION

Sage Energy

EXHIBIT NO. 6

CASE NO. 8926



# PRODUCING WELL DATA SHEET (P&A)

P&A October 30, 1958

Amerada  
OPERATOR

State SG  
LEASE

Unit "K" 1980' FSL and 1980' FML of 10 SECTION 15 TOWNSHIP RANGE 33, Lea Co. NM

WELL NO. FOOTAGE LOCATION

## Schematic

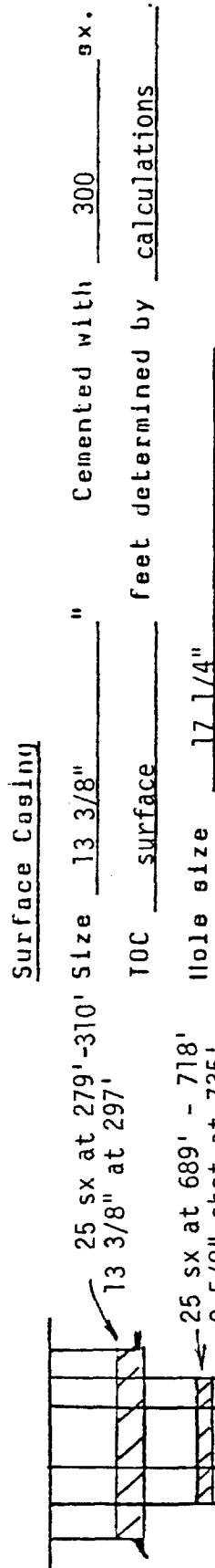

## Tabular Data

Surface Casing			
Size	13 3/8"	"	Cemented with 300 ex.
IOC	surface	feet determined by	calculations
Hole size	17 1/4"		
Intermediate Casing			
Size	8 5/8"	"	Cemented with 1500 ex.
IOC	800	feet determined by	calculations
Hole size	11"		
Long string			
Size	5 1/2"	"	Cemented with 500 ex.
IOC	7147	feet determined by	calculations
Hole size	7 7/8"		

25 sx plug at 9775' - 9960'

Perforated Intervals:

9845' feet to 9860' feet  
(perforated or open-hole, indicate which)

BEFORE EXAMINER SIGN  
OIL CONSERVATION DIVISION

Sage Energy

EXHIBIT NO. 7

CASE NO. 8926

# PRODUCING WELL DATA SHEET (P&A)

P&A 10-1-71

Imperial American Management Co.  
OPERATOR

Saunders State  
LEASE

Unit "P" 660' FSL and 660' FEL of SECTION 9 TOWNSHIP 15 RANGE 33 Lea Co. N.M.  
WELL NO. FOOTAGE LOCATION

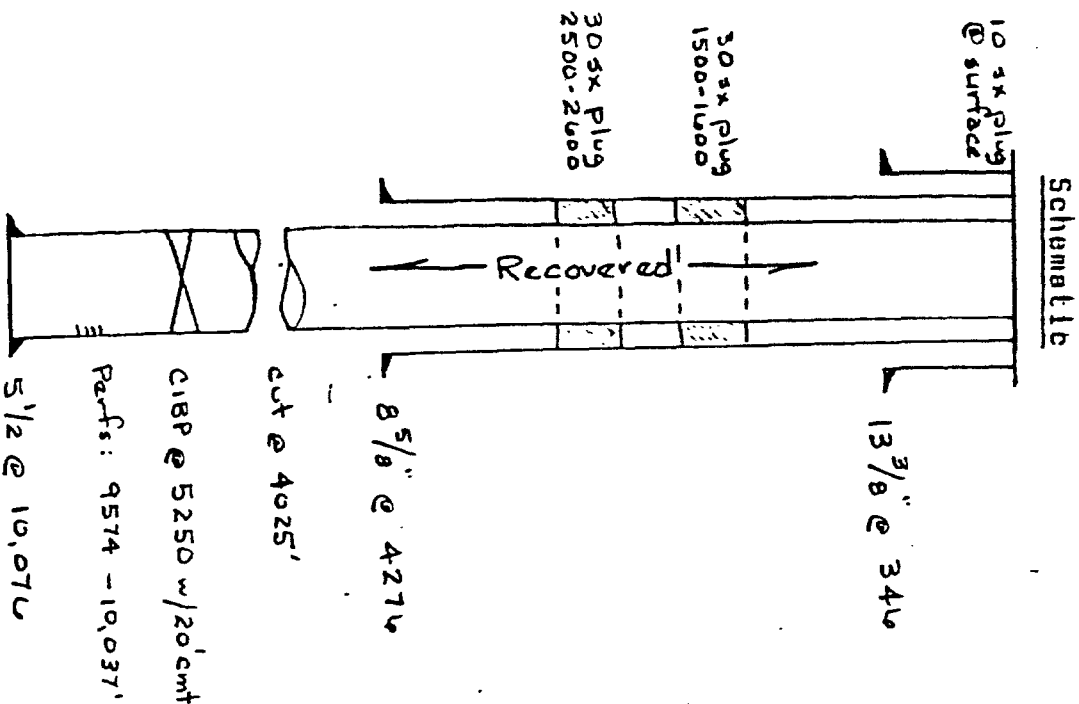

Surface Casing		Tabular Data	
Size	13 3/8"		
TOC	surface	feet determined by	visual
Hole size	17 1/4"		
Intermediate Casing			
Size	8 5/8"	Cemented with	2335
TOC	circulated	feet determined by	calculations
Hole size	11"		
Long string			
Size	5 1/2"	Cemented with	200 gx.
TOC	8553	feet determined by	calculations
Hole size	7 7/8"		
Total depth	10,076'		
Perforated intervals:			
(perforated or open-hole, indicate which)			
9574'	feet to	10,037'	feet

BEFORE EXAMINER STOGNER  
OIL CONSERVATION DIVISION  
EXHIBIT NO. 8  
CASE NO. 2926



# PRODUCING WELL DATA SHEET (P&A)

P&A October 1, 1971

Imperial-American  
OPERATOR

Saunders State "y"  
LEASE

1Y Unit "P" 990' FSL and 990' FEL of 9 15 33 Lea County, NM  
WELL NO. FOOTAGE LOCATION SECTION TOWNSHIP RANGE

## Schematic

## Tabular Data

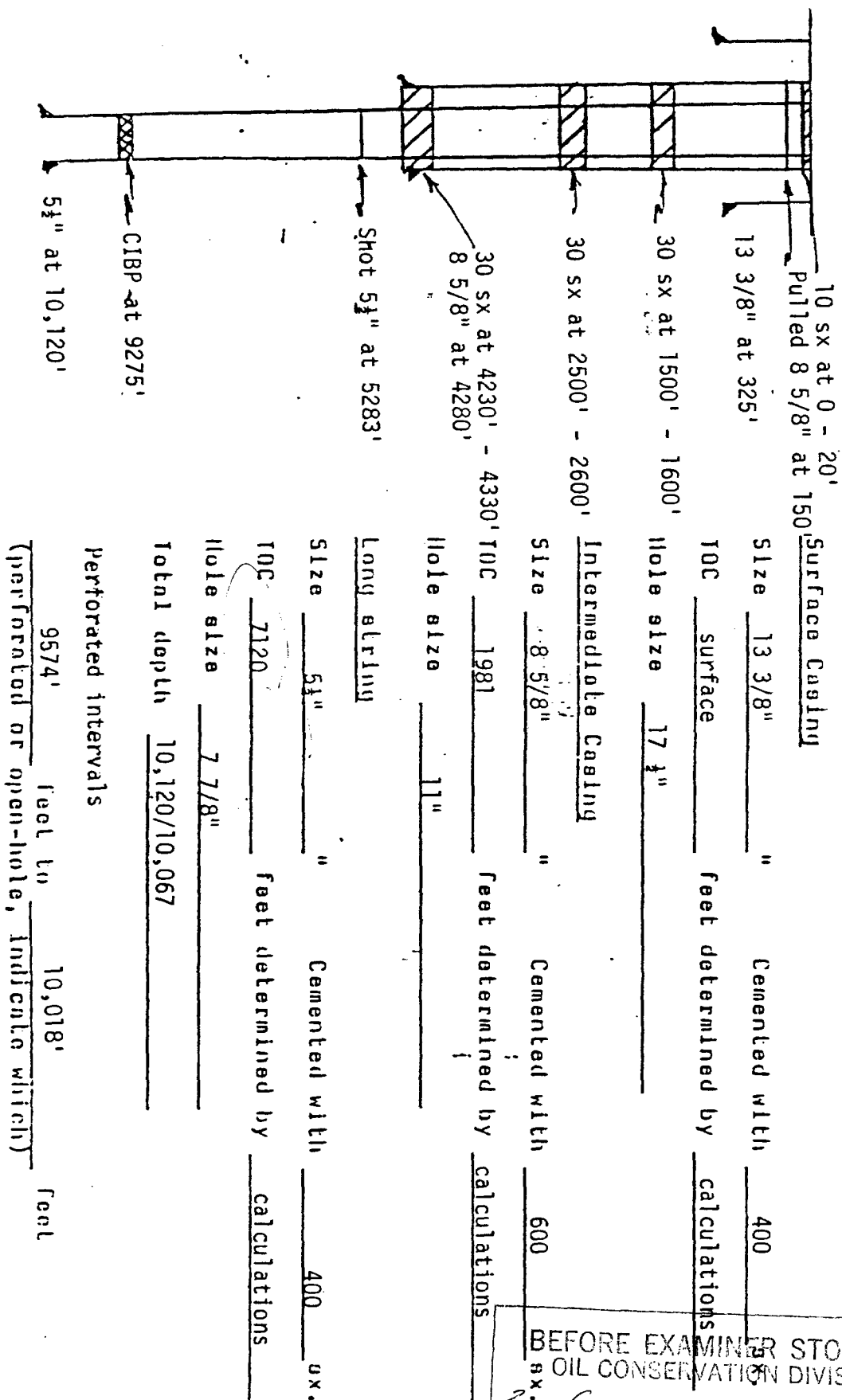

BEFORE EXAMINER STOGNER  
OIL CONSERVATION DIVISION  
Sage Energy EXHIBIT NO. 9  
CASE NO. 8926

DATA ON THE PROPOSED OPERATIONS

VII.

1. The average and maximum daily rate and volume of fluids to be injected will be at the rate of 40 BWPD.
2. The system is open
3. Water to be disposed of on vacuum.
4. Disposing of produced Permo Upper Penn water.
5. Not applicable.

VIII. The injection zone is:

Perf. from 9536' to 9890'. Top of Permo-Penn is at 9446', thickness of Permo-Penn is approximately 700'.  
Source of drinking water is cretaceous at 50' to 350'.

IX. No stimulation program needed.

X. Logs and test data on file with the division.

XI. Analysis attached

XII. I have no knowledge of open faults or any other hydrologic connection between the disposal zone and any underground source of drinking water.

BEFORE EXAMINER STOGNER OIL CONSERVATION DIVISION	
<i>Sage Energy</i>	EXHIBIT NO. <u>10</u>
CASE NO. <u>8926</u>	

LABORATORY WATER ANALYSIS

No. W86-148

To SAGE ENERGY

Date 4/17/86

Drawer 3068

Midland, Texas 79702

This report is the property of Halliburton Company and neither it nor any part thereof nor a copy thereof is to be published or disclosed without first securing the express written approval of laboratory management; it may however, be used in the course of regular business operations by any person or concern and employees thereof receiving such report from Halliburton Company.

Submitted by \_\_\_\_\_ Date Rec. 4/17/86

Well No. \_\_\_\_\_ Depth \_\_\_\_\_ Formation \_\_\_\_\_

County \_\_\_\_\_ Field \_\_\_\_\_ Source \_\_\_\_\_

	West of Lowe #1	SE of Lowe #1	
Resistivity	<u>7.86 @ 70°F</u>	<u>9.71 @ 70°F</u>	
Specific Gravity	<u>1.000</u>	<u>1.000</u>	
pH	<u>6.8</u>	<u>7.5</u>	
Calcium (Ca)	<u>110</u>	<u>190</u>	*MPL
Magnesium (Mg)	<u>Nil</u>	<u>Nil</u>	
Chlorides (Cl)	<u>550</u>	<u>550</u>	
Sulfates (SO <sub>4</sub> )	<u>321</u>	<u>280</u>	
Bicarbonates (HCO <sub>3</sub> )	<u>348</u>	<u>204</u>	
Soluble Iron (Fe)	<u>Nil</u>	<u>Nil</u>	
T.D.S.	<u>1329</u>	<u>1224</u>	

Remarks:

BEFORE EXAMINER STOGNER  
OIL CONSERVATION DIVISION  
*Sage Energy*  
EXHIBIT NO. 11  
CASE NO. 8926

\*Milligrams per liter

Respectfully submitted,

Analyst: *Joan Thompson*

HALLIBURTON COMPANY

cc:

By \_\_\_\_\_  
CHEMIST

NOTICE

THIS REPORT IS LIMITED TO THE DESCRIBED SAMPLE TESTED. ANY USER OF THIS REPORT AGREES THAT HALLIBURTON SHALL NOT BE LIABLE FOR ANY LOSS OR DAMAGE, WHETHER IT BE TO ACT OR OMISSION, RESULTING FROM SUCH REPORT OR ITS USE.

# WELL LOCATION AND ACREAGE DEDICATION PLAT

Form C-104  
Supersedes C-128  
Effective 1-4-65

All distances must be from the outer boundaries of the Section.

Operator <b>SOLAR OIL COMPANY</b>			Lease <b>LOWE STATE</b>		Well No. <b>1</b>
Unit Letter <b>L</b>	Section <b>10</b>	Township <b>15 SOUTH</b>	Range <b>33 EAST</b>	County <b>LEA</b>	
Actual Footage Location of Well: <b>1980</b> feet from the <b>SOUTH</b> line and <b>660</b> feet from the <b>WEST</b> line					
Ground Level Elev. <b>4184.7</b>	Producing Formation	Pool		Dedicated Acreage:  Acres	

1. Outline the acreage dedicated to the subject well by colored pencil or hatchure marks on the plat below.
2. If more than one lease is dedicated to the well, outline each and identify the ownership thereof (both as to working interest and royalty).
3. If more than one lease of different ownership is dedicated to the well, have the interests of all owners been consolidated by communitization, unitization, force-pooling, etc?

☐ Yes    ☐ No    If answer is "yes," type of consolidation \_\_\_\_\_

If answer is "no," list the owners and tract descriptions which have actually been consolidated. (Use reverse side of this form if necessary.) \_\_\_\_\_

No allowable will be assigned to the well until all interests have been consolidated (by communitization, unitization, forced-pooling, or otherwise) or until a non-standard unit, eliminating such interests, has been approved by the Commission.

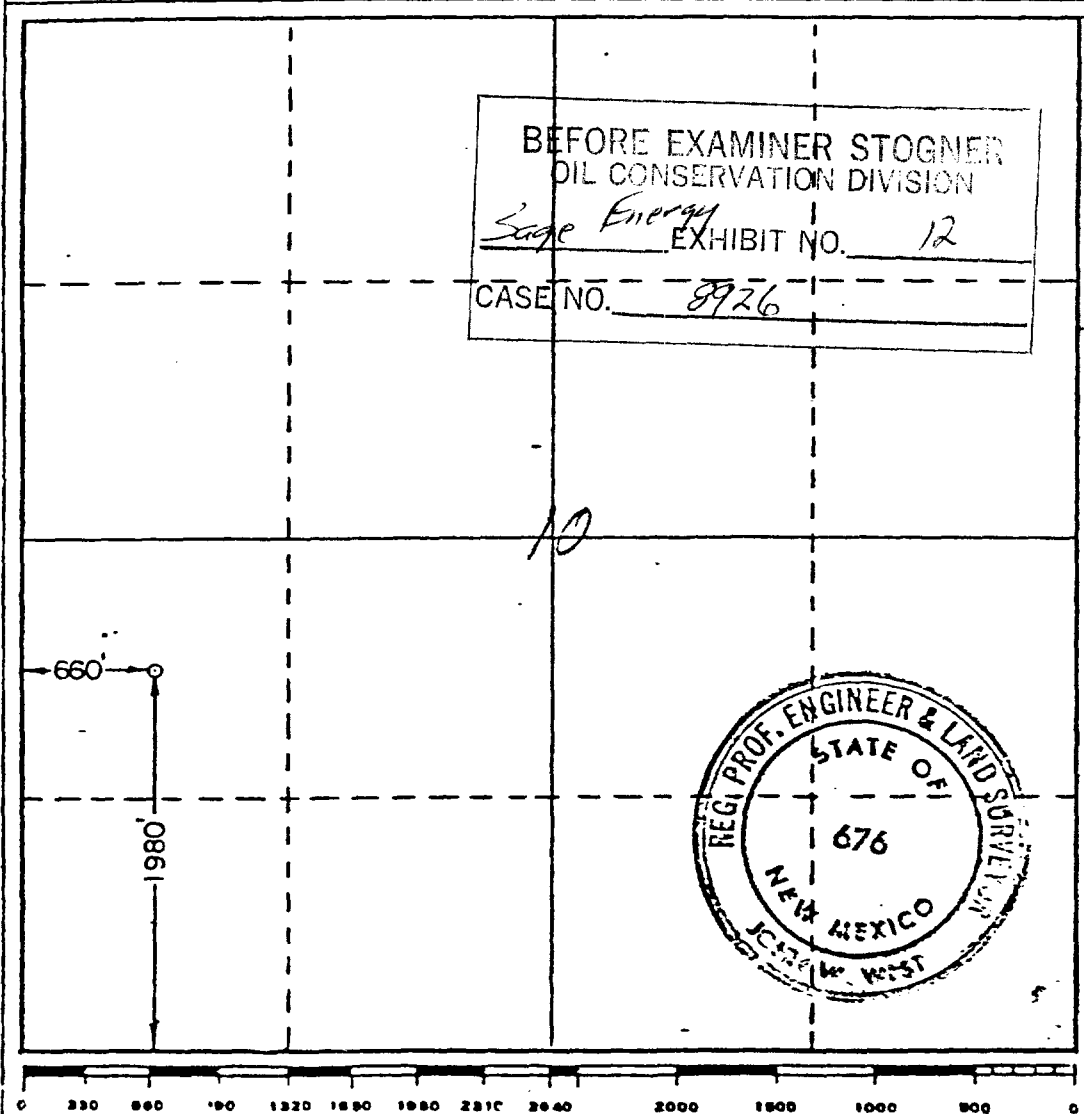

<b>CERTIFICATION</b>	
I hereby certify that the information contained herein is true and complete to the best of my knowledge and belief.	
Name _____	
Position _____	
Company _____	
Date _____	
I hereby certify that the well location shown on this plat was plotted from field notes of actual surveys made by me or under my supervision, and that the same is true and correct to the best of my knowledge and belief.	
Date Surveyed <b>MARCH 3, 1969</b>	
Registered Professional Engineer and/or Land Surveyor  <i>James W. West</i>	
Certificate No.	<b>676</b>

# INJECTION WELL DATA SHEET

SIDE 1

Sage Energy Company  
OPERATOR

Lowe State  
LEASE

Unit "L" 1980' FSL and 660' FWL  
WELL NO. FOOTAGE LOCATION

SECTION

10 15 TOWNSHIP

RANGE

33 Lea Co., NM

## Schematic

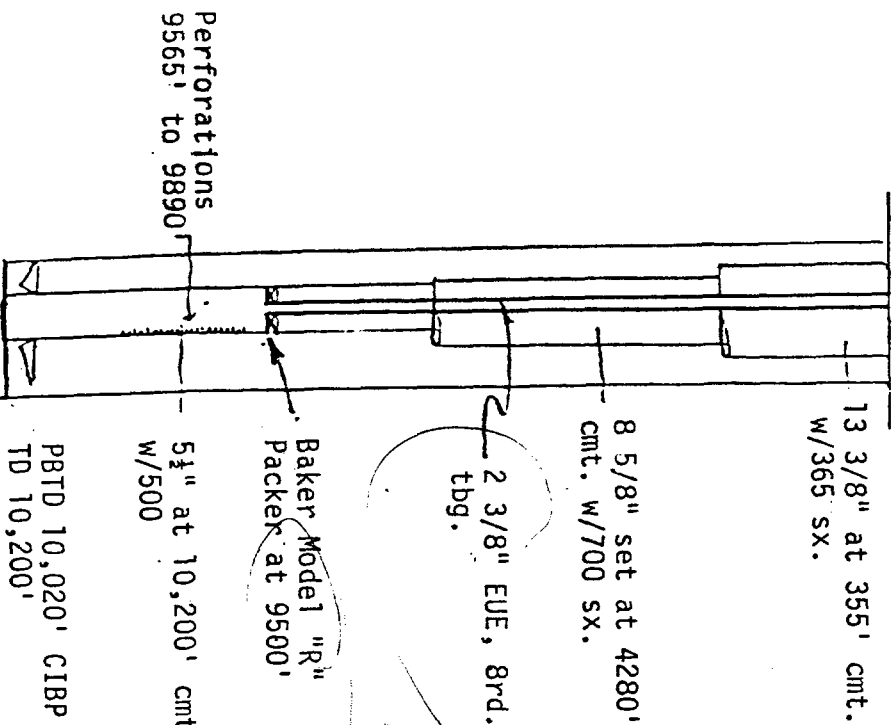

## Surface Casing

## Tabular Data

Size 13 3/8" " Cemented with 365  
TOC Circulated feet determined by Calculations  
Hole size 17 1/2"

## Intermediate Casing

Size 8 5/8" " Cemented with 700 sx.  
TOC 3700 feet determined by Calculations  
Hole size 9 7/8"

## Long string

Size 5 1/2" " Cemented with 500 sx.  
TOC 9500' feet determined by Calculations  
Hole size 7 7/8"  
Total depth 10,200 TD PBD 10,020

## Injection Interval

9565' feet to 9890' feet  
(perforated or open-hole, indicate which)

BEFORE EXAMINER STOGNER  
OIL CONSERVATION DIVISION  
Sage Energy EXHIBIT NO. 13  
CASE NO. 8926

INJECTION WELL DATA SHEET -- SIDE 2

Tubing size 2 3/8" lined with internal plastic coating set in a

Baker Model "R" packer at 9500' feet  
(brand and model)

(or describe any other casing-tubing seal).

Other Data

1. Name of the injection formation Saunders Permo Upper Penn.

2. Name of field or pool (if applicable) Saunders Permo Upper Penn

3. Is this a new well drilled for injection? ☐ Yes ☒ No  
If no, for what purpose was the well originally drilled? Oil and Gas exploration

4. Has the well ever been perforated in any other zone(s)? List all such perforated intervals and give plugging detail (sacks of cement or bridge plug(s) used) \_\_\_\_\_

CIBP at 10,020 with 1 sx cement, perforated with 17 holes from 9890 to 9565.

5. Give the depth to and name of any overlying and/or underlying oil or gas zones (pools) in this area. \_\_\_\_\_

None

CERTIFIED MAIL

Mr. Jerry Dean  
1532 Burch Street  
Lovington, New Mexico 88260

Re: Sage Energy Company Lowe State No. 1, Saunders (Penn) Field, 660' FWL  
and 1980' FSL of Sec. 10, T-15-S, R-33-E, Lea County, New Mexico.

Dear Mr. Dean:

Sage has made application to the New Mexico Conservation Commission to convert the referenced well to a disposal facility. We plan to use the existing perforations in the Saunders (Penn) formation from 9,565' to 10,000' for this purpose. It is our intent to dispose of the produced water from the Lowe State No. 2, using the existing flow line. The surface of the land will not be disturbed using this process. As surface owner, we request your consideration and approval.

If you have any questions regarding this matter, please call.

Very truly yours,

Jay H. Hardy  
Vice President - Engineering

JHH:h

P 397 521 575

RECEIPT FOR CERTIFIED MAIL

NO INSURANCE COVERAGE PROVIDED—  
NOT FOR INTERNATIONAL MAIL

(See Reverse)

Sent to Jerry Dean	
Street and No. 1532 Burch Street	
P.O., State and ZIP Code Lovington, New Mexico 88260	
Postage	\$ 1.25
Certified Fee	.85
Special Delivery Fee	
Restricted Delivery Fee	1.25
Return Receipt Showing to whom and Date Delivered	.75
Return Receipt Showing to whom, Date, and Address of Delivery	
TOTAL Postage and Fees	\$ 4.10
Postmark or Date April 16, 1986	

PS Form 3800, Feb. 1982

BEFORE EXAMINER STOGNER OIL CONSERVATION DIVISION	
Sage Energy	EXHIBIT NO. 14
CASE NO. 8926	

PS Form 3811, Dec. 1980	
● SENDER: Complete items 1, 2, 3, and 4. Add your address in the "RETURN TO" space on reverse.	
(CONSULT POSTMASTER FOR FEES)	
1. The following service is requested (check one). <input type="checkbox"/> Show to whom and date delivered ..... <input type="checkbox"/> Show to whom, date, and address of delivery..	
2. <input type="checkbox"/> RESTRICTED DELIVERY (The restricted delivery fee is charged in addition to the return receipt fee.)	
TOTAL \$	
3. ARTICLE ADDRESSED TO: Jerry Dean 1532 Burch Street Lovington, New Mexico 88260	
4. TYPE OF SERVICE: <input type="checkbox"/> REGISTERED <input type="checkbox"/> INSURED <input type="checkbox"/> CERTIFIED <input type="checkbox"/> COD <input type="checkbox"/> EXPRESS MAIL	ARTICLE NUMBER P397 521 575
(Always obtain signature of addressee or agent)	
I have received the article described above. SIGNATURE <input type="checkbox"/> Addressee <input type="checkbox"/> Authorized agent	
5. DATE OF DELIVERY 4/22/86	POSTMARK
6. ADDRESSEE'S ADDRESS (Only if requested)	



**SAGE ENERGY COMPANY**

P. O. DRAWER 3068

**MIDLAND, TEXAS 79702**

915/688-5271

June 23, 1986

MWJ Producing Company  
1804 First National Bank Building  
Midland, Texas 79701

Re: Sage Energy Company, Lowe State No. 1 - Saunders (Penn) Field, 660'  
FWL and 1980' FSL of Sec. 10, T-15-S, R-33-E, Lea County, New Mexico

Dear Sir:

Enclosed for your use and information is a copy of the application to convert the referenced well. Notification of our intent to convert this well was made by letter of April 16, 1986. Please indicate your receipt of this application by signing in the space indicated below. Your cooperation is appreciated.

Very truly yours,

*Frances Holzgraf*

Frances Holzgraf  
Production Clerk

Encls.

MWJ Producing Company

By: *J. R. Schuyler*

BEFORE EXAMINER STOGNER OIL CONSERVATION DIVISION	
<i>Sage Energy</i>	EXHIBIT NO. <u>15</u>
CASE NO. <u>8926</u>	

**SAGE ENERGY COMPANY**

P. O. DRAWER 8068

**MIDLAND, TEXAS 79702**

915/683-5271

June 23, 1986

Charles B. Gillispie, Jr.  
P. O. Box 8  
Midland, Texas 79702

Re: Sage Energy Company, Lowe State No. 1 - Saunders (Penn) Field, 660'  
FWL and 1980' FSL of Sec. 10, T-15-S, R-33-E, Lea County, New Mexico

Dear Sir:

Enclosed for your use and information is a copy of the application to convert the referenced well. Notification of our intent to convert this well was made by letter of April 16, 1986. Please indicate your receipt of this application by signing in the space indicated below. Your cooperation is appreciated.

Very truly yours,

*Frances Holzgraf*

Frances Holzgraf  
Production Clerk

Encls.

Charles B. Gillispie, Jr.

By: *Bonita Fitts*

BEFORE EXAMINER STOGNER OIL CONSERVATION DIVISION	
<i>Sage Energy</i>	EXHIBIT NO. <u>16</u>
CASE NO. <u>8926</u>	

# Affidavit of Publication

STATE OF NEW MEXICO )

) ss.

COUNTY OF LEA )

Joyce Clemens being first duly sworn on oath deposes and says that he is <sup>A</sup>dv. Director of THE LOVINGTON DAILY LEADER, a daily newspaper of general paid circulation published in the English language at Lovington, Lea County, New Mexico; that said newspaper has been so published in such county continuously and uninterruptedly for a period in excess of Twenty-six (26) consecutive weeks next prior to the first publication of the notice hereto attached as hereinafter shown; and that said newspaper is in all things duly qualified to publish legal notices within the meaning of Chapter 167 of the 1937 Session Laws of the State of New Mexico.

That the notice which is hereto attached, entitled

Legal Notice

and numbered \_\_\_\_\_ in the

\_\_\_\_\_ Court of Lea County, New Mexico, was published in a regular and entire issue of THE LOVINGTON DAILY LEADER and not in any supplement thereof, once each week on the same day of the week, for one (1)

consecutive weeks, beginning with the issue of \_\_\_\_\_

April 11, 19 86

and ending with the issue of \_\_\_\_\_

\_\_\_\_\_, 19 \_\_\_\_\_

And that the cost of publishing said notice is the sum of \$ 6.03

which sum has been (Paid) ~~in excess of~~ as Court Costs

Joyce Clemens  
Subscribed and sworn to before me this 23rd

day of April, 19 86

Mrs Jean Serier  
Notary Public, Lea County, New Mexico

My Commission Expires Sept. 28, 19 86

## LEGAL NOTICE

"Sage Energy Company, P.O. Drawer 3068, Midland, Texas 79702 has applied to convert its Lowe State No. 1 well located 1980' from the South line and 660' from the West line of Unit Letter "L", Section 10, Township 15 South, Range 33 East, Lea County, New Mexico, to a water disposal facility. The operator intends to inject formation water into the Saunders (Penn.) at a depth from 9565' to 10,000', at the approximate rate of 500 BWPD on vacuum. Interested parties must file objections or request a hearing with the Oil Conservation Commission, P.O. Box 1488, Santa Fe, New Mexico, 87504, within 15 days of today's date."

## SAGE ENERGY COMPANY

Frances Holzgraf

Clerk-Production

Published in the Lovington Daily Leader April 11, 1986.

BEFORE EXAMINER STOGNER  
OIL CONSERVATION DIVISION

Sage Energy

EXHIBIT NO. 17

CASE NO. 8926