

Gary Lueck  
US Insurance Group  
266-7991  
Bond

**ENERGY and MINERALS DEPARTMENT**

Oil Conservation Division  
P. O. Box 1980  
Hobbs, New Mexico 88240

0

CAS 05 06102281 RETURN TO SENDER  
CASA PETROLEUM INC  
103 E COMGRESS RD  
ARTESIA NM 88210  
RETURN TO SENDER

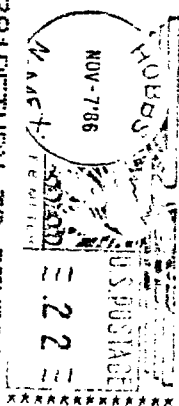

Casa Petroleum  
105 North Sixth Street  
Artesia, NM 88210

BEFORE EXAMINER STOGNER  
OIL CONSERVATION DIVISION  
EXHIBIT NO. 1  
CASE NO. 9041



STATE OF NEW MEXICO  
**ENERGY AND MINERALS DEPARTMENT**  
OIL CONSERVATION DIVISION  
HOBBS DISTRICT OFFICE

TONY ANAYA  
GOVERNOR

November 7, 1986

POST OFFICE BOX 1980  
HOBBS, NEW MEXICO 88240  
(505) 393-6161

Mr. Jeff Taylor  
Oil Conservation Division  
Box 2088  
Santa Fe, NM 87504-2088

Dear Jeff:

I recommend the Casa Petroleum, Inc. Peterson #1-F, located 1980/N and 1980/W, Section 17, T4S, R33E, Roosevelt County, New Mexico be set for hearing in order that the well can be plugged.

Casa drilled the well in 1984 and never did file any completion reports. We have called and written the operator requesting that these reports be filed and have had no response. The other properties operated by this company have been taken over by other operators and the bonding company has requested cancellation of the bond for this well.

Copies of correspondence concerning this are attached for your information. If you have questions, please call.

Very truly yours,

OIL CONSERVATION DIVISION

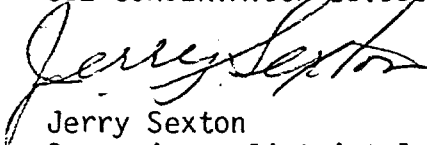

Jerry Sexton  
Supervisor, District I

JS/ED

cc: R.L. Stamets  
Casa Petroleum, 105 North Sixth St., Artesia, NM 88210



TONEY ANAYA  
GOVERNOR

STATE OF NEW MEXICO  
**ENERGY AND MINERALS DEPARTMENT**  
OIL CONSERVATION DIVISION  
HOBBS DISTRICT OFFICE

October 1, 1986

POST OFFICE BOX 1980  
HOBBS, NEW MEXICO 88240  
(505) 393-6161

Casa Petroleum, Inc.            or  
105 North Sixth Street  
Artesia, NM 88210

Mr. Patch Carr  
3108 Futura  
Roswell, NM 88201

Re: Peterson #1-F  
1980/N & 1980/W  
Section 17, T4S, R33E  
Roosevelt County, NM

Gentlemen:

The above referenced well was drill in 1984. As of this date we have not received any of the completion reports necessary. Please file the following:

- 1) Form C-105 Well Completion Report
- 2) Notarized, tabulated list of deviation surveys
- 3) One copy of all logs
- 4) C-104 for allowable assignment or
- 5) C-103 Request to Temporarily Abandon or Plug and Abandon

If these reports are not received within the next 30 days, we will turn this over to the Oil Conservation Division Attorney for legal action.

Very truly yours,

OIL CONSERVATION DIVISION

Jerry Sexton  
Supervisor, District I

JS/ED

cc: Jeff Taylor  
OCD Attorney



TONEY ANAYA  
GOVERNOR

STATE OF NEW MEXICO  
ENERGY AND MINERALS DEPARTMENT  
OIL CONSERVATION DIVISION

May 7, 1986

50 YEARS



1935 - 1985

POST OFFICE BOX 2088  
STATE LAND OFFICE BUILDING  
SANTA FE, NEW MEXICO 87501  
(505) 827-5800

U. S. Insurance Group  
P. O. Box 2639  
Dallas, Texas 75221

Attention: Tommie Abshier

Re: \$7,500 One-Well Plugging Bond  
Casa Petroleum, Inc., Principal  
United States Fire Insurance Company  
1980' FNL and 1980' FWL of Sec. 17,  
T-4-S, R-33-E, Depth: 8300 feet  
Bond No. 610-140976-2

Dear Ms. Abshier:

I am in receipt of your request for cancellation of the above-referenced bond. I have checked with our Hobbs district office and they have advised me that this bond cannot be cancelled as the well has not been plugged nor transferred to another bonded operator.

If you have any questions, please do not hesitate to contact me.

Sincerely,

DIANE RICHARDSON  
Administrator  
Bonding Department



TONEY ANAYA  
GOVERNOR

STATE OF NEW MEXICO  
ENERGY AND MINERALS DEPARTMENT  
OIL CONSERVATION DIVISION  
HOBBS DISTRICT OFFICE

February 3, 1986

50 YEARS

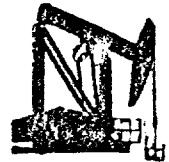

1935 - 1985

POST OFFICE BOX 1980  
HOBBS, NEW MEXICO 88240  
(505) 393-6161

Casa Petroleum, Inc.  
105 North Sixth Street  
Artesia, New Mexico 88210

Gentlemen:

No reports have been submitted for your Peterson Well No. 1 located in Unit F of Section 17, T-4-S, R-33-E, Roosevelt County, New Mexico, since June 11, 1985, at which time Form C-103 covering work done in February was approved.

Please immediately submit Form C-103 covering any work done since that time and showing present status and future plans; Form C-105, notarized tabulated list of the deviation surveys; and one copy of each log run on the well, if any.

Yours very truly,

OIL CONSERVATION DIVISION

Jerry Sexton  
Supervisor, District 1

mc

STATE OF NEW MEXICO  
ENERGY AND MINERALS DEPARTMENT

NO. OF COPIES & LEASES	
DISTRIBUTION	
SANTA FE	
FILE	
U.S.G.S.	
LAND OFFICE	
OPERATOR	

OIL CONSERVATION DIVISION

P. O. BOX 2088  
SANTA FE, NEW MEXICO 87501

Form O-1  
Rev. 10-77

SUNDRY NOTICES AND REPORTS ON WELLS

DO NOT USE THIS FORM FOR PROPOSALS TO DRILL OR TO DEPLEN OR PLUG BACK TO A DIFFERENT RESERVOIR.  
USE "APPLICATION FOR PERMIT - " (FORM C-101) FOR SUCH PROPOSALS.

OIL WELL ☒ GAS WELL ☐ OTHER ☐

Name of Operator

CASA PETROLEUM, INC.

Address of Operator

105 NORTH SIXTH STREET

ARTESIA, NEW MEXICO

88210

Location of Well

UNIT LETTER F 1980 FEET FROM THE NORTH LINE AND 1980 FEET FROM

THE WEST LINE, SECTION 17 TOWNSHIP 4S RANGE 33E NMPM.

15. Elevation (State whether DF, RT, GR, etc.)

4389 MSL

1. Indicate Type of Lease

State ☐

Fee X

5. State Oil & Gas Lease No.

7. Unit Agreement Name

8. Name of Lease Holder

PETERSON

9. Well No.

1

10. Field and Pool, or Well Unit

NORTH PETERSON

11. County

ROOSEVELT

Check Appropriate Box To Indicate Nature of Notice, Report or Other Data

NOTICE OF INTENTION TO:

SUBSEQUENT REPORT ON:

PERFORM REMEDIAL WORK ☐

PLUG AND ABANDON ☐

REMEDIAL WORK ☐

ALTERING CASING ☐

TEMPORARILY ABANDON ☐

COMMENCE DRILLING OPERATIONS ☐

PLUG AND ABANDON ☐

PULL OR ALTER CASING ☐

CHANGE PLANS ☐

CASING TEST AND CEMENT JOBS ☐

OTHER ☐

1. Describe Proposed or Completed Operations (Clearly state all pertinent details, and give pertinent dates, including estimated date of starting any proposed work; SEE RULE 1103.

2/21/85

ACIDIZE 3911-68 6 HOLES WITH 500 GAL 15% HCL

I, hereby certify that the information above is true and complete to the best of my knowledge and belief.

SIGNED Jerry Sexton  
ORIGINAL SIGNED BY JERRY SEXTON  
DISTRICT 1 SUPERVISOR

TITLE Secretary

DATE 2/21/85

JUN 1 1 1985

APPROVED BY \_\_\_\_\_  
CONDITIONS OF APPROVAL, IF ANY:

OIL CONSERVATION DIVISION

P. O. BOX 2088

SANTA FE, NEW MEXICO 87501

Form C-100  
Revised 10-

LAND					
STATE					
COUNTY					
TOWNSHIP					
RANGE					
SECTION					
LAND OFFICE					
OPERATOR					

5a. Indicate Type of Lease

State ☐

Fee ☒

5. State Oil & Gas Lease No.

SUNDRY NOTICES AND REPORTS ON WELLS

(DO NOT USE FOR PROPOSALS TO DRILL OR TO DEEPEN OR PLUG BACK TO A DIFFERENT RESERVOIR. USE APPLICATION FOR PERMIT - " (FORM C-101) FOR SUCH PROPOSALS.)

OIL WELL ☒ GAS WELL ☐ OTHER ☐

7. Unit Agreement Name

Name of Operator

CASA PETROLEUM, INC.

8. Farm or Lease Name

PETERSON

Address of Operator

105 NORTH SIXTH STREET

ARTESIA, NEW MEXICO 88210

9. Well No.

1

Location of Well

UNIT LETTER F 1980 FEET FROM THE NORTH LINE AND 1980 FEET FROM

10. Field and Pool, or Without

NORTH PETERSON

THE WEST LINE, SECTION 17 TOWNSHIP 4S RANGE 33E N.M.P.M.

15. Elevation (Show whether DF, RT, GR, etc.)

4389 MSL

12. County

ROOSEVELT

Check Appropriate Box To Indicate Nature of Notice, Report or Other Data  
NOTICE OF INTENTION TO:

SUBSEQUENT REPORT OF:

PERFORM REMEDIAL WORK ☐

PLUG AND ABANDON ☐

REMEDIAL WORK ☐

ALTERING CASING ☐

TEMPORARILY ABANDON ☐

COMMENCE DRILLING OPNS. ☐

PLUG AND ABANDONMENT ☐

PULL OR ALTER CASING ☐

CHANGE PLANS ☐

CASING TEST AND CEMENT JOBS ☐

OTHER ACIDIZE AND PERFORATE

OTHER ☐

7. Describe Proposed or Completed Operations (Clearly state all pertinent details, and give pertinent dates, including estimated date of starting any proposed work) SEE RULE 1703.

11/30/84

ACIDIZE 8080-84 WITH 1500 GAL 15% NEFE AND CLAY STABILIZER

12/7/84

PERFORATE: 7823-30 10 HOLES

8. I hereby certify that the information above is true and complete to the best of my knowledge and belief.

SIGNED Jerry Sexton

TITLE Secretary

DATE 12/8/84

ORIGINAL SIGNED BY JERRY SEXTON

DISTRICT 1 SUPERVISOR

APPROVED BY

TITLE

DATE

CONDITIONS OF APPROVAL, IF ANY:

JUN 11 1985

OIL CONSERVATION DIVISION  
P. O. BOX 2088  
SANTA FE, NEW MEXICO 87501

NO. OF COPIES RECEIVED		
DISTRIBUTION		
TANZANIA		
FILE		
U.S.C.S.		
LAND OFFICE		
OPERATOR		

5. State Oil & Gas Lease No.

## SUNDRY NOTICES AND REPORTS ON WELLS

(DO NOT USE THIS FORM FOR PROPOSALS TO DRILL OR TO DEEPEN OR PLUG BACK TO A DIFFERENT RESERVOIR. USE "APPLICATION FOR PERMIT - " (FORM C-101) FOR SUCH PROPOSALS.)

OIL ☒ GAS ☐  
WELL WELL OTHER-

Name of Operator

CASA PETROLEUM, INC.

Address of Operator

105 NORTH SIXTH STREET

ARTESIA, NEW MEXICO 88210

Location of Well:

UNIT LETTER F, 1980 FEET FROM THE NORTH LINE AND 1980 FEET FROM

THE WEST LINE, SECTION 17 TOWNSHIP 4S RANGE 33E NE 1/4

15. Elevation (Show whether DF, RT, GR, etc.)

4389 MSL.

12. County

ROOSEVELT

Check Appropriate Box To Indicate Nature of Notice, Report or Other Data

NOTICE OF INTENTION TO:	SUBSEQUENT REPORT
-------------------------	-------------------

PERFORM REMEDIAL WORK ☐  
TEMPORARILY ABANDON ☐  
PULL OR ALTER CASING ☐

OTHER

PLUG AND ABANDON ☐

CHANGE PLANS ☐

REMEDIAL WORK ☐  
 COMMENCE DRILLING OPER. ☐  
 CASING TEST AND CEMENT JOB ☐  
 OTHER \_\_\_\_\_ ACIDIZE PERFS ☐

AUTOPING CASINO  
PUG AND CORN HILL

7. Describe Proposed or Completed Operations (Clearly state all pertinent details, and give pertinent dates, including estimated date of starting any new work) SEE RULE 1103.

11/14/84

ACIDIZE PERFS WITH 1500 GALS 7 1/2% MSR

11/16/84

PERF: 7850-54

7858-59

7899-7900

7901

ACIDIZE WITH 4000 GAL 15% NEFE

3. I hereby certify that the information above is true and complete to the best of my knowledge and belief.

SIGNED M. J. Law

THE *Secretary*

ORIGINAL SIGNED BY JERRY SEXTON  
DISTRICT 1 SUPERVISOR

Y I Y L R

DATE

JUN 11 1985

CONDITIONS OF APPROVAL, IF ANY:



STATE OF NEW MEXICO  
ENERGY AND MINERALS DEPARTMENT

NO. OF COPIES DESIRED	
DISTRIBUTION	
SANTA FE	
FILE	
U.S.G.S.	
LAND OFFICE	
OPERATOR	

OIL CONSERVATION DIVISION  
P.O. BOX 2088  
SANTA FE, NEW MEXICO 87501

Form 1-101  
Rev. 1-1-77

5a. Indicate Type of Lease  
State ☐ Fee ☒  
5. State Oil & Gas Lease No.

SUNDRY NOTICES AND REPORTS ON WELLS

(DO NOT USE THIS FORM FOR PROPOSALS TO DRILL OR TO DEEPEN OR PLUG BACK TO A DIFFERENT RESERVOIR.  
USE "APPLICATION FOR PERMIT -" FORM C-1011 FOR SUCH PROPOSALS.)

OIL WELL <input checked="" type="checkbox"/> GAS WELL <input type="checkbox"/> OTHER <input type="checkbox"/>		7. Unit Agreement Name
Name of Operator CASA PETROLEUM, INC.		8. Field or Lease Name PETERSON
Address of Operator 105 NORTH SIXTH STREET ARTESIA, NEW MEXICO 88210		9. Well No. 1
Location of Well UNIT LETTER <u>F</u> 1980 FEET FROM THE <u>NORTH</u> LINE AND 1980 FEET FROM THE <u>WEST</u> LINE, SECTION <u>17</u> TOWNSHIP <u>4S</u> RANGE <u>33E</u> NMPM.		10. Field and Foot, or Address NORTH PETERSON
11. Elevation (Show whether DF, RT, GR, etc.) 4389 MSL		12. County ROOSEVELT

Check Appropriate Box To Indicate Nature of Notice, Report or Other Data

NOTICE OF INTENTION TO:

SUBSEQUENT REPORT OF:

PERFORM REMEDIAL WORK <input type="checkbox"/>	PLUG AND ABANDON <input type="checkbox"/>	REMEDIAL WORK <input type="checkbox"/>	ALTERING CASING <input type="checkbox"/>
TEMPORARILY ABANDON <input type="checkbox"/>	CHANGE PLANS <input type="checkbox"/>	COMMENCE DRILLING OPNS. <input type="checkbox"/>	PLUG AND ABANDON <input type="checkbox"/>
PULL OR ALTER CASING <input type="checkbox"/>	OTHER <input type="checkbox"/>	CASING TEST AND CEMENT JOB <input checked="" type="checkbox"/>	

7. Describe Proposed or Completed Operations (Clearly state all pertinent details, and give pertinent dates, including estimated date of starting any proposed work) SEE RULE 1103.

11/9/84  
RUN 506' 5 1/2" 17# CSG. AND 8050' 5 1/2" 17# CSG  
CEMENT WITH 400 SKS CLASS C NEAT  
CIRC 50 SKS TO PIT  
PLUG DOWN 3:20 P.M.  
W.O.C. 18 HOURS

11/10/84  
SPOT 1500 GALS 7 1/2% MSR AND 7 BBLS 3% KCL

8. I hereby certify that the information above is true and complete to the best of my knowledge and belief.

SIGNED Mary O'Hara SECRETARY DATE 11/12/84

APPROVED BY \_\_\_\_\_ FILE \_\_\_\_\_ DATE JUN 11 1985

CONDITIONS OF APPROVAL, IF ANY:

CONSERVATION DIVISION  
P. O. BOX 2088  
SANTA FE, NEW MEXICO 87501

Form C-103  
Revised 10-1-78

NO. OF COPIES RECEIVED	
DISTRIBUTION	
SANTA FE	
FILE	
U.S.O.S.	
LAND OFFICE	
OPERATOR	

5a. Indicate Type of Lease  
State ☒ Fee ☐  
5. State Oil & Gas Lease No.

SUNDRY NOTICES AND REPORTS ON WELLS

DO NOT USE THIS FORM FOR PROPOSALS TO DRILL OR TO OPEN OR PLUG BACK TO A DIFFERENT RESERVOIR.  
USE "APPLICATION FOR PERMIT -" (FORM C-101) FOR SUCH PROPOSALS.

OIL WELL ☒ GAS WELL ☐ OTHER ☐

Name of Operator

CASA PETROLEUM, INC.

Address of Operator

105 NORTH SIXTH STREET

ARTESIA, NEW MEXICO

88210

Location of Well

UNIT LETTER F 1980 FEET FROM THE NORTH LINE AND 1980 FEET FROM

THE WEST LINE. SECTION 17 TOWNSHIP 4S RANGE 33E N.M.P.M.

7. Unit Agreement Name

8. Farm or Lease Name

PETERSON

9. Well No.

1

10. Field and Pool, or Wildcat

NORTH PETERSON

15. Elevation (Show whether DF, RT, GR, etc.)

4389 MSL

12. County

ROOSEVELT

Check Appropriate Box To Indicate Nature of Notice, Report or Other Data

NOTICE OF INTENTION TO:

SUBSEQUENT REPORT OF:

PERFORM REMEDIAL WORK ☐

PLUG AND ABANDON ☐

REMEDIAL WORK ☐

ALTERING CASING ☐

TEMPORARILY ABANDON ☐

COMMENCE DRILLING OPNS. ☐

PLUG AND ABANDONMENT ☐

PULL OR ALTER CASING ☐

CHANGE PLANS ☐

CASING TEST AND CEMENT JOB ☒

OTHER ☐

7. Describe Proposed or Completed Operations (Clearly state all pertinent details, and give pertinent dates, including estimated date of starting any proposed work) SEE RULE 1103.

DRILLED 12 1/4" HOLE TO 1935'

RAN 46 JTS 8 5/8" 8 ROUND, RANGE 3 J55 24# CASING

SET AND CEMENTED AT 1930' WITH 200 SACKS OF HIGH EARLY II AND 364 SACKS LIGHT WEIGHT III

PLUG DOWN 10/10/84

CIRC 150 SACKS TO PIT

WOC 18 HOURS, NIPPLE UP AND PRESSURE UP ON 8 5/8" 1500# OK 30 MINUTES

8. I hereby certify that the information above is true and complete to the best of my knowledge and belief.

EDD Eddie W. Seay

TITLE Secretary

DATE 10/23/84

Eddie W. Seay

OCT 29 1984

APPROVED BY Oil & Gas Inspector

TITLE

DATE

CONDITIONS OF APPROVAL, IF ANY

NO. OF COPIES RECEIVED	
DISTRIBUTION	
SANTA FE	
FILE	
U.S.G.S.	
LAND OFFICE	
OPERATOR	

5A. Indicate Type of Lease

STATE ☐ REC ☒

5. State Oil & Gas Lease No.

APPLICATION FOR PERMIT TO DRILL, DEEPEN, OR PLUG BACK

1. Type of Work

DRILL ☒

DEEPEN ☐

PLUG BACK ☐

2. Type of Well

OIL WELL ☒

GAS WELL ☐

OTHER

SINGLE ZONE ☐

MULTIPLE ZONE ☐

3. Name of Operator

CASA PETROLEUM, INC.

4. Address of Operator

105 N. SIXTH STREET, ARTESIA, NEW MEXICO 88210

5. Location of Well

UNIT LETTER I LOCATED 1980 FEET FROM THE NORTH LINE

6. 1980 FEET FROM THE WEST LINE OF SEC. 17 TWP. 4S RGE. 33E NMPM

7. Unit Agreement Name

8. Farm or Lease Name

PETERSON

9. Well No.

10. Field and Pool, or Wildcat

NORTH PETERSON

UNDESIGNATED

12. County

ROOSEVELT

11. Elevations (show whether DE, KI, etc.)

21A. Kind & Status Plug. Bond

ONE WELL

19. Proposed Depth

8400

19A. Formation

FUSSLEMAN

20. Rotary or C.T.

ROTARY

22. Approx. Date Work will start

AUGUST 15, 1984

PROPOSED CASING AND CEMENT PROGRAM

SIZE OF HOLE	SIZE OF CASING	WEIGHT PER FOOT	SETTING DEPTH	SACKS OF CEMENT	EST. TOP
17 1/2"	13 3/8"		350'	CIRC	
11	8 5/8"	24#	1900'	500	
7 7/8"	5 1/2"	1550 & 1700	8400	500	

PROPOSE TO DRILL 17 1/2" HOLE TO APPROXIMATELY 350'. SET 13 3/8" CSG AND CIRC CEMENT  
DRILL 11 HOLE TO 1900' AND SET 8 5/8" 24# J55 CSG CEMENT WITH 500 SKS  
PRIOR TO DRILLING OUT INSTALL BOP'S AND TEST.

DRILL 7 7/8" HOLE TO 8400'. RUN CNL DLL IF WELL DEEMED ECONOMICAL RUN 5 1/2" J55 CSG  
COMPLETION PROCEDURE WILL BE DETERMINED

APPROVAL VALID FOR 180 DAYS  
PERMIT EXPIRES 1/16/85  
UNLESS DRILLING UNDERWAY

ABOVE SPACE DESCRIBE PROPOSED PROGRAM; IF PROPOSAL IS TO DEEPEN OR PLUG BACK, GIVE DATA ON PRESENT PRODUCTIVE ZONE AND PROPOSED NEW PRODUCTIVE ZONE. GIVE BLOWOUT PREVENTER PROGRAM, IF ANY.

I hereby certify that the information above is true and complete to the best of my knowledge and belief.

Signed Jerry Sexton Title PRESIDENT Date 6/14/84

(This space for State Use)

ORIGINAL SIGNED BY JERRY SEXTON

DISTRICT I SUPERVISOR

ED BY

TITLE

DATE

JUL 16 1984

NOTATIONS OF APPROVAL, IF ANY:

All distances must be from the outer boundaries of the Section.

Operator Casa Petroleum		Lease Peterson		Well No. 1
Unit Letter J	Section 17	Township 4 South	Range 33 East	County Roosevelt
Actual Footage Location of Well:				
1980 feet from the North		1980 feet from the West		line
Ground Level Elev. 4389 MSL	Producing Formation	Pool	Dedicated Acreage: 40 Acres	

1. Outline the acreage dedicated to the subject well by colored pencil or hatchure marks on the plat below.
2. If more than one lease is dedicated to the well, outline each and identify the ownership thereof (both as to working interest and royalty).
3. If more than one lease of different ownership is dedicated to the well, have the interests of all owners been consolidated by communitization, unitization, force-pooling, etc?

☐ Yes ☐ No If answer is "yes," type of consolidation \_\_\_\_\_

If answer is "no," list the owners and tract descriptions which have actually been consolidated. (Use reverse side of this form if necessary.) \_\_\_\_\_

No allowable will be assigned to the well until all interests have been consolidated (by communitization, unitization, forced-pooling, or otherwise) or until a non-standard unit, eliminating such interests, has been approved by the Division.

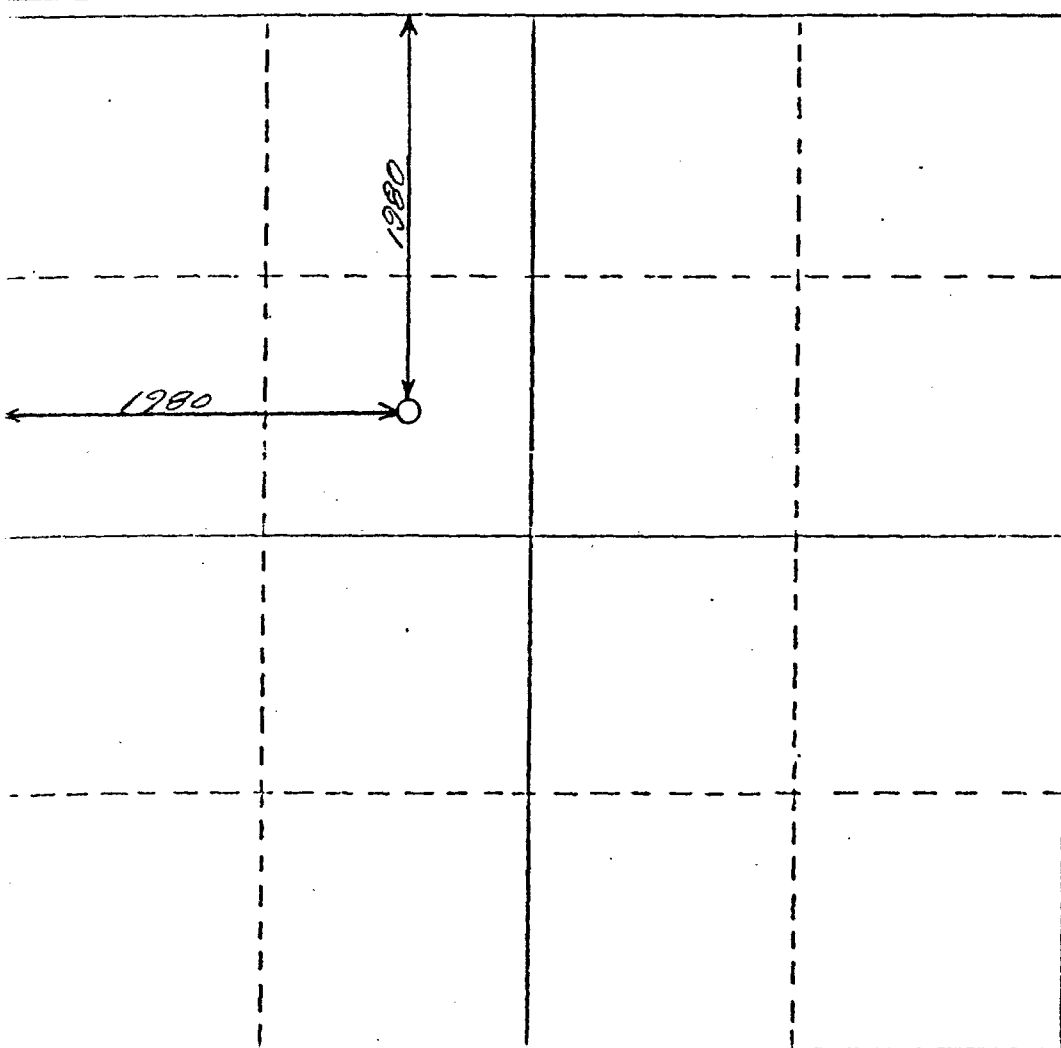

CERTIFICATION

I hereby certify that the information contained herein is true and complete to the best of my knowledge and belief.

*Kang, C. Lin*  
Name

PRESIDENT  
Position

CASA PETROLEUM, INC.  
Company

6/20/84  
Date

I hereby certify that the well location shown on this plat was plotted from field notes of actual surveys made by me or under my supervision, and that the same is true and correct to the best of my knowledge and belief.

2/4/84

Date Surveyed

P. R. Patton

Registered Professional Engineer  
and/or Land Surveyor

8112

Certificate No.