

**MEWBOURNE OIL COMPANY**

P. O. BOX 7698  
TYLER, TEXAS 75711  
214 - 561-2900

October 16, 1987

State of New Mexico  
Oil Conservation Division  
P. O. Box 2088  
Santa Fe, New Mexico 87504-2088

Oil Conservation Division  
OIL CONSERVATION DIVISION  
Incl. No. 1  
Case No. 9269  
12/2/87

Attention: Mr. R. L. Stamets  
Division Director

Re: Application for Downhole Commingling  
Gulf-State No. 1-E  
Section 36, T20S-R38E  
Lea County, New Mexico

Dear Mr. Stamets:

Mewbourne Oil Company is this day making application for downhole commingling the above referenced well according to Rule 303 C of the State of New Mexico Rules and Regulations. We are complying with the requirements as follows:

1. Name and address of the operator.

Mewbourne Oil Company, P. O. Box 7698, Tyler, Texas 75711

2. Lease name, well number, well location, name of the pools to be commingled.

Gulf-State #1-E, Sec. 36, T20S-R38E, Lea County, New Mexico  
Blinebry, Tubb, Drinkard and Abo

3. A plat of the area and ownership of all offsetting leases.

See Attached Map

4. A current 24-hour productivity test.

See attached copy of Form C-116 previously submitted. (This test should have been reported for all four pools). We do not have individual tests for each pool.

5. Resume of well's completion including treating, testing, etc., of each zone and a prognostication of future production for each zone.

See attached Form C-103 for perforations and treating reports. Total stabilized production for all four commingled zones is 11 BOPD, 42 BWPD and 26 MCFPD on pump.

6. Estimated bottom-hole pressures for each artificially lifted zone.

Abo	-	776 psia
Tubb	-	719 psia
Drinkard	-	556 psia
Blinebry	-	511 psia

(Based on SITP and IFL after treating)

7. A description of the fluid characteristics of each zone showing that the fluids will not be incompatible in the well-bore.

All oil is 36° to 38° API for all zones. No foaming or precipitates have formed to date.

8. A computation showing that the value of the commingled production will not be less than the sum of the values of the individual streams.

N/A

9. A formula for the allocation of production to each of the commingled zones and a description of the factors or data used in determining such formula.

25% of the total production for each of the four zones.

10. A statement that all offset operators have been notified in writing of the proposed commingling.

See attached letter and offset operator address list.

Note: The Blinebry had declined to about 3 BOPD in June and July 1987 and was considered as a plugging candidate. The addition of the new oil from the other three zones is the only way to continue to produce this well economically and prevent a waste of oil reserves.

Mr. R. L. Stamets

- 3 -

October 16, 1987

Please contact this office if there is any further information required for the approval of this application.

Very truly yours,

MEWBOURNE OIL COMPANY

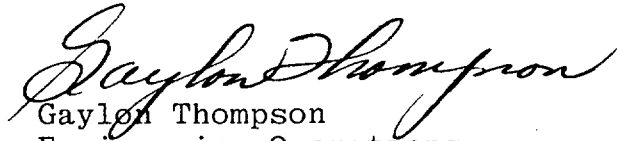
  
Gaylon Thompson  
Engineering Operations

Attachments

Copy to: Mr. Jerry Sexton  
Supervisor, District I

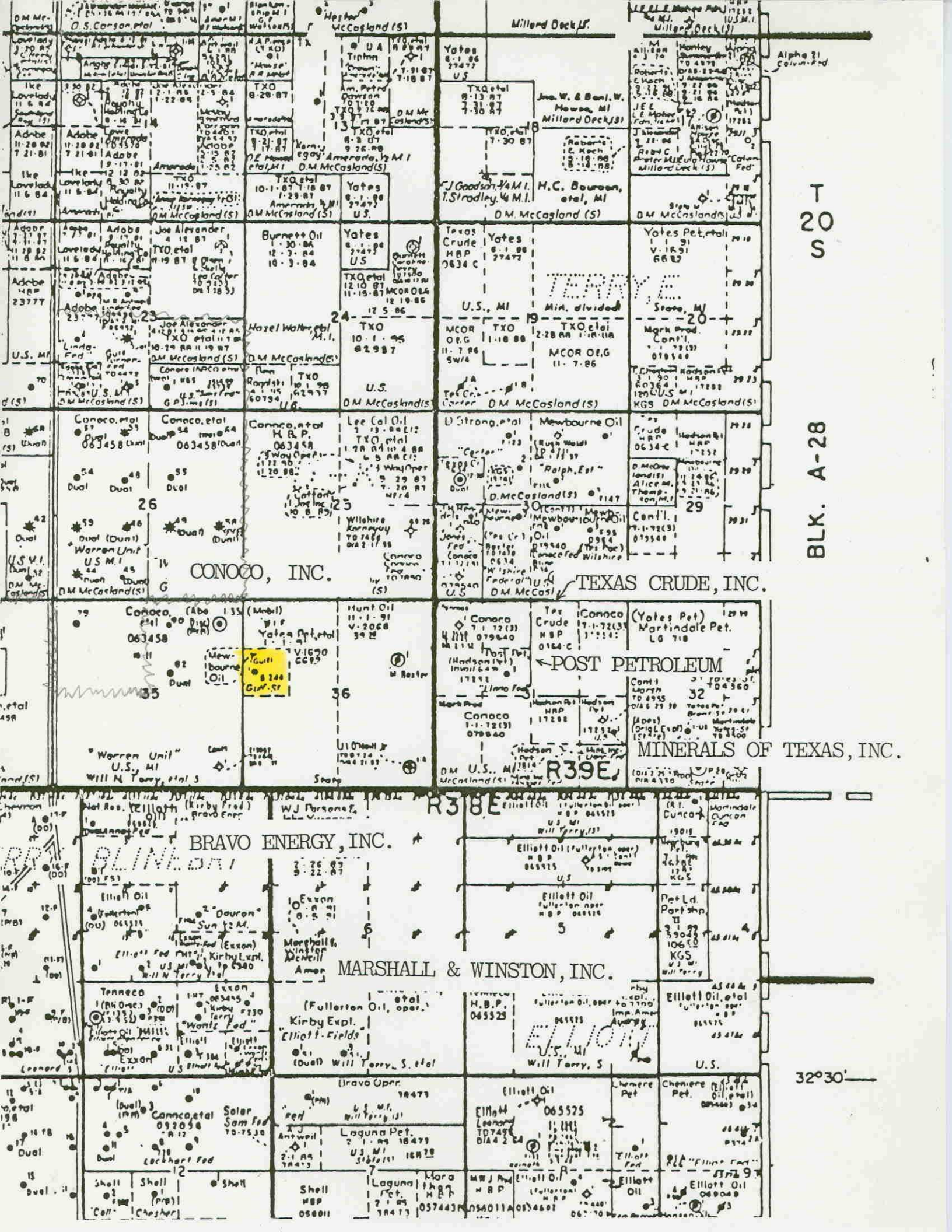

T  
20  
S

BLK. A-28

MINERALS OF TEXAS, INC.

BRAVO ENERGY, INC.

MARSHALL & WINSTON, INC.

CONOCO, INC.

TEXAS CRUDE, INC.

32°30'

**MEWBOURNE OIL COMPANY**

P. O. BOX 7698

TYLER, TEXAS 75711

214 - 561-2900

October 16, 1987

ATTACHED DISTRIBUTION LIST:

Re: Application for Downhole Commingling  
Gulf-State #1  
Section 36, T20S-R38E, Unit E  
Lea County, New Mexico

Gentlemen:

We have this date made application for downhole commingling the referenced well. The four zones we propose to commingle are the Blinebry, Tubb, Drinkard, and Abo. This application has been requested because the well will be uneconomical to operate unless the commingling is granted.

If you have no objection to the approval of the application, please sign two of the attached copies in the space provided at the bottom of this letter. Self-addressed, stamped envelopes have been enclosed for your convenience in mailing one copy to this office and one copy to the New Mexico Oil Conservation Commission in Santa Fe, New Mexico.

Thank you for your prompt attention in regard to this matter.

Very truly yours,

MEWBOURNE OIL COMPANY

  
Gaylon Thompson  
Engineering Operations

Enclosures

WAIVER:

We have no objection to approval of the above referenced application for downhole commingling.

\_\_\_\_\_  
Company Name

\_\_\_\_\_  
Name

\_\_\_\_\_  
Title

\_\_\_\_\_  
Date

DOWNHOLE COMMINGLING  
MEWBOURNE OIL COMPANY  
GULF-STATE NO. 1  
LEA COUNTY, NEW MEXICO

OFFSET OPERATORS

Bravo Energy, Inc.  
P. O. Box 2160  
Broadmoor Petroleum Center - East  
Hobbs, New Mexico 88241

Conoco, Inc.  
P. O. Box 460  
726 East Michigan  
Hobbs, New Mexico 88240

Marshall & Winston, Inc.  
#10 Desta Drive  
Midland, Texas 79705

Minerals of Texas, Inc.  
5603 Cary Grant  
San Antonio, Texas 78240

Post Petroleum Company, Inc.  
301 Northwest 63rd Street  
Suite 400  
Oklahoma City, Oklahoma 73116

Michael Huhnke  
Texas Crude, Inc.  
801 Travis, Suite 2100  
Houston, Texas 77002

NEW MEXICO OIL CONSERVATION COMMISSION  
GAS - OIL RATIO TESTS

2-11  
Revised 1-1-85

Operator <b>MEWBOURNE OIL COMPANY</b>		Fec#		BLINBRY		County <b>LEA</b>								
Address <b>P. O. BOX 7698, TYLER, TEXAS 75711</b>				TYPE OF TEST - (X)		Scheduled <input type="checkbox"/> Completion <input type="checkbox"/> Special <input checked="" type="checkbox"/>								
LEASE NAME	WELL NO.	LOCATION			DATE OF TEST	CHOKE SIZE	TBG. PRESS.	DAILY ALLOW-ABLE	LENGTH OF TEST HOURS	PROD. DURING TEST			GAS - OIL RATIO CU. FT./BBL.	
		U	S	T						R	WATER BBL.	GRAV. OIL BBL.		OIL BBL.
GULF-STATE	1	E	36	20S	38E	10/29/87P	--	--	24	24	38	14	18	1286:1

No well will be assigned an allowable greater than the amount of oil produced on the official test.  
 During gas-oil ratio test, each well shall be produced at a rate not exceeding the top unit allowable for the pool in which well is located by more than 25 percent. Operator is encouraged to take advantage of this 25 percent tolerance in order that well can be assigned increased allowables when authorized by the Commission.  
 Gas volumes must be reported in MCF measured at a pressure base of 15,025 psia and a temperature of 60° F. Specific gravity base will be 0.60.  
 Report casing pressure in lieu of tubing pressure for any well producing through casing.  
 Mail original and one copy of this report to the district office of the New Mexico Oil Conservation Commission in accordance with Rule 301 and appropriate pool rules.

I hereby certify that the above information is true and complete to the best of my knowledge and belief.

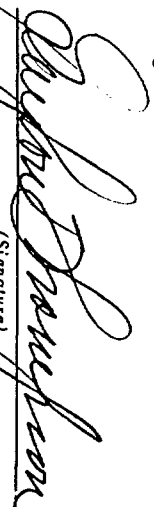
  
 (Signature)  
**Richard Thompson**  
 Engineering Operations Secretary  
 (Title)  
 October 30, 1987  
 (Date)

NO. OF COPIES RECEIVED		
DISTRIBUTION		
SANTA FE		
FILE		
U.S.G.S.		
LAND OFFICE		
OPERATOR		

NEW MEXICO OIL CONSERVATION COMMISSION

Form C-103  
Supersedes Old  
C-102 and C-103  
Effective 1-1-65

5a. Indicate Type of Lease  
State  Fee   
5. State Oil & Gas Lease No.  
L-2950

SUNDRY NOTICES AND REPORTS ON WELLS  
(DO NOT USE THIS FORM FOR PROPOSALS TO DRILL OR TO DEEPEN OR PLUG BACK TO A DIFFERENT RESERVOIR.  
USE "APPLICATION FOR PERMIT -" (FORM C-101) FOR SUCH PROPOSALS.)

1. OIL WELL <input checked="" type="checkbox"/> GAS WELL <input type="checkbox"/> OTHER <input type="checkbox"/>	7. Unit Agreement Name
2. Name of Operator Mewbourne Oil Company	8. Farm or Lease Name Gulf-State
3. Address of Operator P. O. Box 7698, Tyler, Texas 75711	9. Well No. 1
4. Location of Well UNIT LETTER <u>E</u> <u>1980</u> FEET FROM THE <u>North</u> LINE AND <u>330</u> FEET FROM THE <u>West</u> LINE, SECTION <u>36</u> TOWNSHIP <u>20 South</u> RANGE <u>38 East</u> NMPM.	10. Field and Pool, or Wildcat Blinebry
15. Elevation (Show whether DF, RT, GR, etc.) 3570' GL	12. County Lea

16. Check Appropriate Box To Indicate Nature of Notice, Report or Other Data  
NOTICE OF INTENTION TO: SUBSEQUENT REPORT OF:

PERFORM REMEDIAL WORK <input type="checkbox"/>	PLUG AND ABANDON <input type="checkbox"/>	REMEDIAL WORK <input checked="" type="checkbox"/>	ALTERING CASING <input type="checkbox"/>
TEMPORARILY ABANDON <input type="checkbox"/>	CHANGE PLANS <input type="checkbox"/>	COMMENCE DRILLING OPNS. <input type="checkbox"/>	PLUG AND ABANDONMENT <input type="checkbox"/>
PULL OR ALTER CASING <input type="checkbox"/>	OTHER <input type="checkbox"/>	CASING TEST AND CEMENT JOBS <input type="checkbox"/>	OTHER <input type="checkbox"/>

17. Describe Proposed or Completed Operations (Clearly state all pertinent details, and give pertinent dates, including estimated date of starting any proposed work) SEE RULE 1103.

6930-7184  
8/26/87 - MIRU pulling unit. RU Welex and perforated Abo as follows: 7182-84', 3 holes; 7165-72' 8 holes; 7150-52', 3 holes; 7136-37', 2 holes; 7098-7100', 3 holes; 7032-40', 9 holes; 6965-68', 4 holes; 6956-60', 5 holes; 6930-38', 9 holes. Perforated Tubb as follows: 6761', 1 hole; 6755', 1 hole; 6750', 1 hole; 6746-48', 3 holes; 6737-41', 5 holes; 6731', 1 hole; 6703', 1 hole; 6697-6700', 4 holes; 6673', 1 hole; 6666', 1 hole; 6659', 1 hole; 6633', 1 hole; 6620-22', 3 holes; 6612-17', 6 holes. RD Welex. 6612-6761

how? 7072'  
8/27/87 - RIH w/packer & RBP. Set RBP at 7225'. Set packer at 7072'. RU Western and acidized perfs from 7098-7184' with 3200 gals 15% NE-FE acid + 30 ball sealers. Max PP 600# at 5.5 BPM, Min 0# at 3.5 BPM, Avg 400# at 5 BPM. ISDP vacuum. Had good ball action. Reset RBP at 7225' and tested to 2000#. Set packer at 6854'. Acidized perfs from 7098-7184' and 6930-7040' with 4500 gals 15% NE-FE acid + 112 ball sealers. Max PP 1700# at 6.0 BPM, Min 700# at 6.1 BPM, Avg 1400# at 6.0 BPM. ISDP vacuum. Had good ball action. 440 bbl load to recover.

9/01/87 - SITP 375#. Set RBP at 6844'. Spotted 3 bbls acid across perfs. Set packer at 6515' and acidized Tubb from 6612-6761' w/3000 gals 15% NE-FE acid + 60 ball sealers. Breakdown press 3750#. Max 5000#, Min 2800# at 2.8 BPM, Avg 4000# at 4 BPM. Had good ball action ISDP 2000#, 5 Mins 2000#, 10 mins 2000#, 15 mins 1975#, RD Western. Opened well up. Flowed 16 BLW. 123 bbls load to recover.

18. I hereby certify that the information above is true and complete to the best of my knowledge and belief.

SIGNED Raylout Thompson TITLE Engr. Oprns. Secretary DATE 9/15/87

APPROVED BY \_\_\_\_\_ TITLE \_\_\_\_\_ DATE \_\_\_\_\_  
CONDITIONS OF APPROVAL, IF ANY: