

R - 7 - W

R - 6 - W

COLORADO
NEW MEXICO

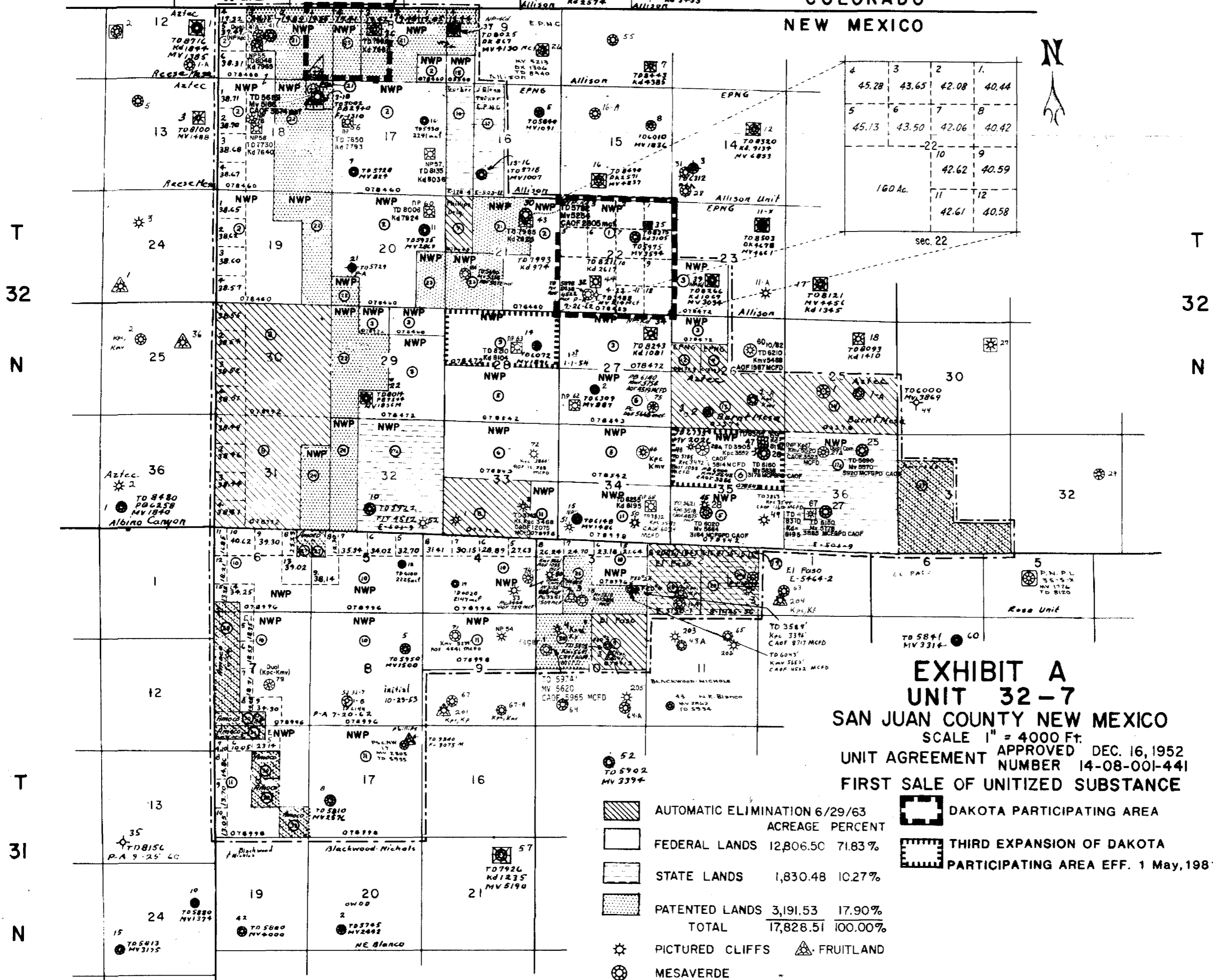

160 Ac. sec. 22

4	3	2	1
45.28	43.65	42.08	40.44
5	6	7	8
45.13	43.50	42.06	40.42
		9	
		10	
		11	12
		42.62	40.59
		42.61	40.58

EXHIBIT A
UNIT 32-7
SAN JUAN COUNTY NEW MEXICO
SCALE 1" = 4000 Ft.
UNIT AGREEMENT APPROVED DEC. 16, 1952
FIRST SALE OF UNITIZED SUBSTANCE

- 52 TO 5902 MV 3394
- AUTOMATIC ELIMINATION 6/29/63 ACREAGE PERCENT
- FEDERAL LANDS 12,806.50 71.83%
- STATE LANDS 1,830.48 10.27%
- PATENTED LANDS 3,191.53 17.90%
- TOTAL 17,828.51 100.00%**
- PICTURED CLIFFS
- FRUITLAND
- MESAVERDE
- DAKOTA

- DAKOTA PARTICIPATING AREA
- THIRD EXPANSION OF DAKOTA PARTICIPATING AREA EFF. 1 May, 1981

6/30/86