

State of New Mexico

#3355



W.R. HUMPHRIES
COMMISSIONER

Commissioner of Public Lands

P.O. BOX 1148
SANTA FE, NEW MEXICO 87504-1148

October 18, 1990

Walsh & Watts, Inc.,
Oil Producers
1111 Seventh Street
Wichita Falls, TX 76301

Attn: Alfred B. Guinn

Re: North Square Lake Premier Unit
Eddy County, New Mexico
1990 Plan of Development

Dear Mr. Guinn:

The Commissioner of Public Lands this date approved the 1990 Plan of Development for the North Square Lake Premier Unit. Our approval is subject to like approval by all other appropriate agencies.

The possibility of drainage by wells outside of the Unit Area and the need for further development may exist. You will be contacted at a later date regarding these possibilities.

If we may be of further help, please do not hesitate to contact Clyde Langdale at (505) 827-5791.

Sincerely,

W. R. HUMPHRIES

BY:

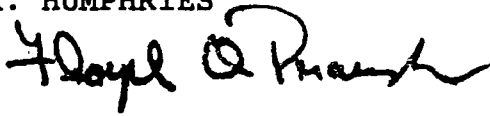
Floyd O. Prando, Director
Oil, Gas & Minerals Division

cc: OCD
Unit Corresp.
Unit POD

State of New Mexico



W.R. HUMPHRIES
COMMISSIONER



Commissioner of Public Lands

P.O. BOX 1148
SANTA FE, NEW MEXICO 87504-1148

October 15, 1990

Walsh and Watts Inc.,
Oil Producers
1111 Seventh Street
Wichita Falls, TX 76301

Attn: Alfred B. Guinn

Re: North Square Lake Premier Unit
1990 Plan of Development

Dear Mr. Guinn:

The Commissioner of Public Lands this date approved the 1990 Plan of Development for the North Square Lake Premier Unit. Our approval is subject to like approval by all other appropriate agencies.

The possibility of drainage by wells outside of the Unit Area and the need for further development may exist. You will be contacted at a later date regarding these possibilities.

If we may be of further help, please do not hesitate to contact Clyde Langdale at (505) 827-5791.

Sincerely,

W. R. HUMPHRIES

BY: 
Floyd O. Prando, Director
Oil, Gas & Minerals Division

cc: OCD
Unit Corresp.
Unit POD

State of New Mexico



W.R. HUMPHRIES
COMMISSIONER



Commissioner of Public Lands

SLO REF NO. OG-671

P.O. BOX 1148
SANTA FE, NEW MEXICO 87504-1148

February 4, 1988

3355

Walsh and Watts, Inc.
ATTENTION: Mr. Alfred B. Guinn
1111 Seventh Street
Wichita Falls, Texas 76301

Re: 1988 Plan of Operations
North Square Lake Premier Unit
Eddy County, New Mexico

Gentlemen:

The Commissioner of Public Lands has this date approved your 1988 Plan of Operations for the North Square Lake Premier Unit Area, Eddy County, New Mexico. Your Plan for 1988 advised that injection and production rates will be maintained. You also plan to keep injection rates balanced, and will monitor all wells for necessity to treat for paraffin, corrosion and scale. No drilling workovers are planned.

Our approval is subject to like approval by the New Mexico Oil Conservation Division and the Bureau of Land Management.

Enclosed is an approved copy for your files.

If we may be of further help please do not hesitate to call on us.

Very truly yours,

W. R. HUMPHRIES
COMMISSIONER OF PUBLIC LANDS

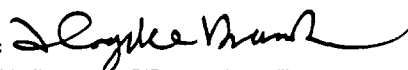
BY: 
FLOYD O. PRANDO, Director
Oil and Gas Division
(505) 827-5744

WRH/FOP/pm
encls.

cc: OCD-Santa Fe, New Mexico
BLM-Roswell, New Mexico Attn: Mr. Armando Lopez
Gulram, Inc.



United States Department of the Interior

GEOLOGICAL SURVEY
Drawer 1857
Roswell, New Mexico 88201

September 26, 1973

Walsh and Watts, Inc.
Attention: Mr. Alfred B. Guinn
1111 Seventh Street
Wichita Falls, Texas 76301

Gentlemen:

Your letter of September 17 transmits two copies of an instrument, executed by Shell Oil Company and Walsh and Watts, Inc., whereby Shell assigns its duties and obligations as unit operator of the North Square Lake Premier unit, Eddy County, New Mexico, to Walsh and Watts, Inc. By such instrument, Walsh and Watts, Inc., accepts the duties and obligations of unit operator.

The resignation of Shell Oil Company as operator of the North Square Lake Premier unit and the designation of Walsh and Watts, Inc., as successor operator of such unit are hereby accepted by this office. The instrument was approved by the Commissioner of Public Lands of the State of New Mexico on September 21, 1973.

Sincerely yours,

CARL C. TRAYWICK
Acting Area Oil and Gas Supervisor

cc:
Com. Pub. Lands, Santa Fe (ltr. only)

Shell Oil Company
P. O. Box 2099
Houston, Texas 77001

BLM, Santa Fe (ltr. only)
Artesia (ltr. only)
N.M.O.C.C., Santa Fe (ltr. only)✓

REShook:ds:lh

Demer 1857
Roswell, New Mexico 88201

MAIN OFFICE OCC

FEB 18 AM 10:28

February 17, 1966

Shell Oil Company
P. O. Box 1509
Midland, Texas

Gentlemen:

Your initial plan of operation for the North Square Lake Premier unit, Eddy County, New Mexico, has been approved on this date subject to like approval by the appropriate State officials.

Two approved copies of the plan are enclosed.

Sincerely yours,

(ORIGINAL SENT TO TRAYWICK)

CARL C. TRAYWICK
Acting Oil & Gas Supervisor

cc:
Washington (w/cy of plan)
Artesia (w/cy of plan)
Com. of Pub. Lands - Santa Fe (ltr. only)
N.M.O.C.C. - Santa Fe (ltr. only)

A 3355

NMOCD

WALSH AND WATTS, INC.
OIL PRODUCERS
1111 SEVENTH STREET
WICHITA FALLS, TEXAS 76301
817-723-2104
January 25, 1995

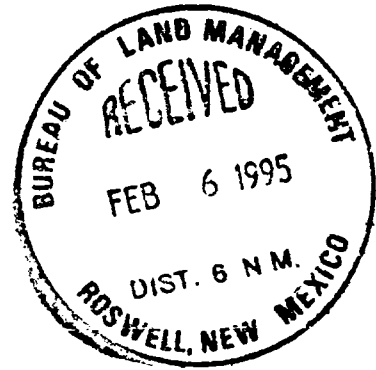

United States Department of Interior
Bureau of Land Management
Roswell District Office
P. O. Box 1397
Roswell, New Mexico 82210-1397

Attention: Mr. Francis R. Cherry, Jr.
District Manager

Refer to: 3180 (065)

Re: 1995 Plan of Operations
North Square Lake Premier Unit
Eddy County, New Mexico

Gentlemen:

Summary of 1994 Operations:

No new wells drilled or completed. No wells shut-in, recompleted or converted to injection. Treated wells as needed for scale, paraffin and corrosion.

Plan of Operations 1995:

Injection and production rates to be maintained. Monitor wells for necessity to treat for paraffin, corrosion and scale. No drilling or workovers planned.

Attached is statistical production data updated to present.

If you require additional information, please advise.

Yours very truly,

WALSH AND WATTS, INC.

By: *Alf B. Guinn*

Alfred B. Guinn

ABG"bd

Enclosure

cc: State of New Mexico
Commission of Public Lands
P. O. Box 1148
Santa Fe, New Mexico 87504-1148

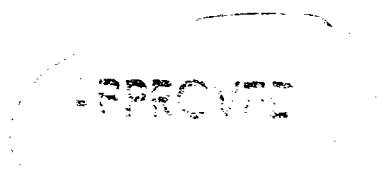

10/10/01

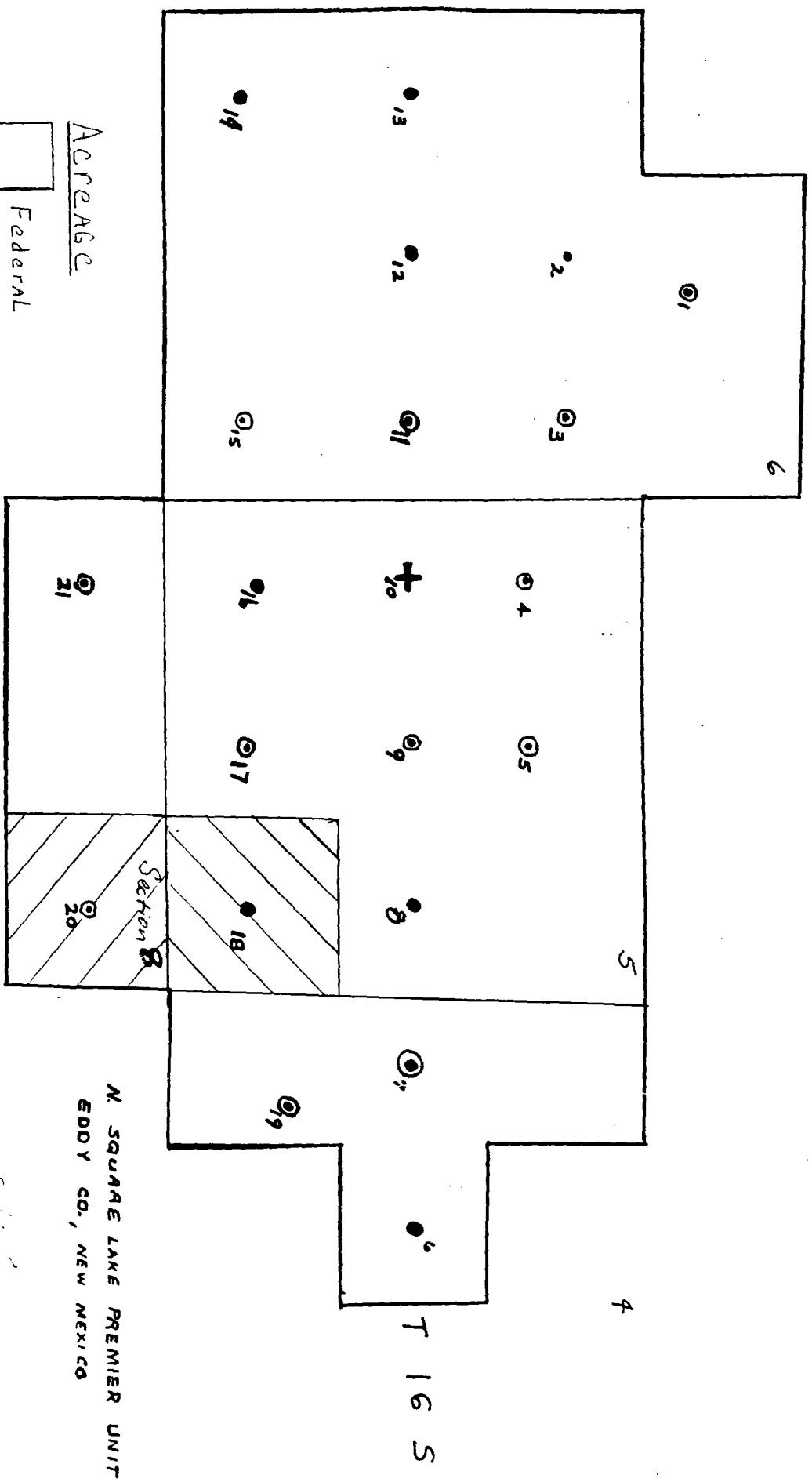
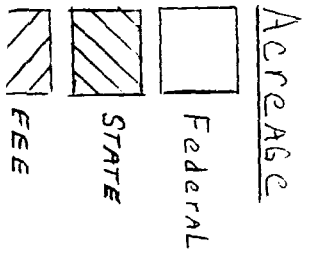

N. SQUARE LAKE PREMIER UNIT
 EDDY CO., NEW MEXICO

R 31 E

T 16 S

WALSH AND WATTS, INC. Supplemental Recovery
OIL PRODUCERS Progress Report
 1111 SEVENTH STREET
 WICHITA FALLS, TEXAS 76301

FIELD Square Lake (G/SA) North
 UNIT North Square Lake Premier Unit
 YEAR 1994

STATISTICAL DATA

Unit Effective 3/01/66 Injection Started 9/66
 Est. Ult. Rec. 450,000 Primary + 650,000 Secondary = 1,100,000

MONTHLY PRODUCTION

	January	February	March	April	May	June
Oil, Bbls.	705	659	690	618	649	581
Gas, MCF	108	108	108	108	108	108
Producing GOR, SCF/Bbl.	153	164	157	175	166	186
Net GOR, SCF/Bbls.	153	164	157	175	166	186
Water Bbls.	710	644	715	700	744	720
Withdrawals, Res. Bbls.	1620	1478	1550	1463	1538	1446
Producing WOR, Bbl/Bbl	1.007	.977	1.036	1.133	1.146	1.239

MONTHLY INJECTION

	January	February	March	April	May	June
Water, Bbls.	3810	3444	3815	3700	3844	3720
Gas, MCF	---	---	---	---	---	---
Gas, Reservoir Bbls.	---	---	---	---	---	---
Total Inj., Res. Bbls	3810	3444	3815	3700	3844	3720
Net Voidage, Res. Bbls	2190	1966	2265	2277	2306	2274

CUMULATIVE - PRODUCTION

	January	February	March	April	May	June
Since Inj. Oil, Bbls.	581,879	538,538	583,208	583,846	584,495	585,076
Gas, MCF	---	---	---	---	---	---
Wtr., Bbls	727,771	728,415	729,130	729,830	730,574	731,294
Since Unit Oil, Bbls.	581,879	502,538	583,228	583,846	584,445	585,076
Gas, MCF	---	---	---	---	---	---
Wtr., Bbls	727,771	728,415	729,130	729,830	730,574	731,294
Since Disc. Oil, Bbls.	1,007,731	1,008,390	1,009,080	1,009,698	1,010,347	1,010,928

CUMULATIVE - INJECTION

	January	February	March	April	May	June
Since Unit Wtr., Bbls	8,997,654	9,001,098	9,004,913	9,008,613	9,012,457	9,016,177
Gas, MCF	---	---	---	---	---	---
Since Unit Wtr., Bbls	---	---	---	---	---	---
Gas, MCF	---	---	---	---	---	---

PHASE OF

	January	February	March	April	May	June
Production to Date	1,006,731	1,007,390	1,008,080	1,008,698	1,009,347	1,009,928
Remaining Production	91,761	91,102	90,412	89,794	89,145	88,564

WELL STATUS

	January	February	March	April	May	June
Producer	7	7	7	7	7	7
Injector	11	11	11	11	11	11
Shut-In	0	0	0	0	0	0
T.A.	0	0	0	0	0	0
P&A	3	3	3	3	3	3

WALSH AND WATTS, INC. Supplemental Recovery
OIL PRODUCERS Progress Report
 1111 SEVENTH STREET
 WICHITA FALLS, TEXAS 76301

FIELD Square Lake (G/SA) North
 UNIT North Square Lake Premier unit
 YEAR 1964

STATISTICAL DATA

Unit Effective 3/01/66 Injection Started 9/66
 Est. Ult. Rec. 450,000 Primary + 650,000 Secondary = 1,100,000

MONTHLY PRODUCTION	July	August	September	October	November	December
Oil, Bbls.	484	690	606	650	600	655
Gas, MCF	108	108	108	108	108	108
Producing GOR, SCF/Bbl.	223	157	178	166	180	165
Net GOR, SCF/Bbls.	223	157	178	166	180	165
Water Bbls.	735	744	720	744	720	744
Withdrawals, Res. Bbls.	1364	1579	1471	1539	1465	1544
Producing WOR, Bbl/Bbl	1.519	1.078	1.188	1.145	1.200	1.136

MONTHLY INJECTION	July	August	September	October	November	December
Water, Bbls.	3835	3844	3720	3844	3620	3844
Gas, MCF	---	---	---	---	---	---
Gas, Reservoir Bbls.	---	---	---	---	---	---
Total Inj., Res. Bbls	3835	3844	3720	3844	3620	3844
Net Voidage, Res. Bbls	2471	2265	2249	2305	2155	2300

CUMULATIVE - PRODUCTION	July	August	September	October	November	December
Since Inj. Oil, Bbls.	585,560	586,250	586,856	587,506	588,106	588,761
Gas, MCF	---	---	---	---	---	---
Wtr., Bbls	732,029	732,773	733,493	734,237	734,957	735,701
Since Unit Oil, Bbls.	585,560	586,250	586,856	587,506	588,106	588,761
Gas, MCF	---	---	---	---	---	---
Wtr., Bbls	732,029	732,773	733,493	734,237	734,957	735,701
Since Disc. Oil, Bbls.	1,011,412	1,012,102	1,012,708	1,013,358	1,013,958	1,014,613

CUMULATIVE - INJECTION	July	August	September	October	November	December
Since Unit Wtr., Bbls	9,020,012	9,023,856	9,027,576	9,031,420	9,035,040	9,038,884
Gas, MCF	---	---	---	---	---	---
Since Unit Wtr., Bbls	---	---	---	---	---	---
Gas, MCF	---	---	---	---	---	---

BASE OF	July	August	September	October	November	December
Production to Date	1,010,412	1,011,103	1,011,708	1,012,358	1,012,958	1,013,613
Remaining Production	88,080	87,390	86,784	86,134	85,534	84,879

WELL STATUS	July	August	September	October	November	December
Producer	7	7	7	7	7	7
Injector	11	11	11	11	11	11
Shut-In	0	0	0	0	0	0
C.A.	0	0	0	0	0	0
P&A	3	3	3	3	3	3
ISW	0	0	0	0	0	0