

**marbob**  
energy corporation

#3791

February 23, 1990

Bureau of Land Management  
Roswell District Office  
P.O. Box 1397  
Roswell, NM 88202-1397

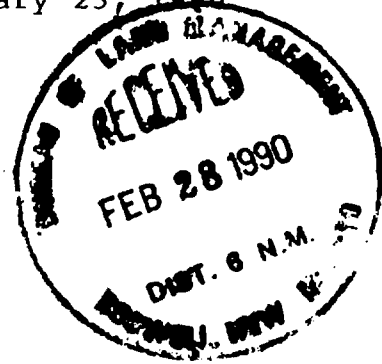

Attention: Mr. Joe L. Lara  
Assistant District Manager

RE: 1990 Plan of Operations  
Square Lake 12 Unit  
Eddy County, New Mexico

Dear Mr. Lara:

Marbob Energy Corporation as unit operator of the Square Lake 12 Unit submits this 1990 Plan of Operations on behalf of the working interest owners and in compliance with the Bureau of Land Management requirements.

There were no new wells drilled in 1989 and the status of all wells has remained the same throughout the year. Well numbers 101, 104, 106, 107, 108, 109, 111, 112, and 116 are pumping wells. Well number 224 is temporarily abandoned, and well numbers 100, 102, 105, 110, 115, and 117 are water injection wells.

It is anticipated for 1990 that all pumping and injection wells will have to be cleaned out and have scale inhibitor placed in them. There are no new wells planned at this time.

All working interest owners under the Square Lake 12 Unit have been provided with a copy of this Plan of Operations. Marbob Energy Corporation as unit operator, and the working interest owners believe that all current unit obligations and requirements have been met.

If this Plan of Operations meets with your approval, then we request that you so signify on the space provided below and return a copy of this plan to Marbob Energy Corporation in the self addressed envelope.

Sincerely,



David Martin  
Land Department

RM/dr

Approved this 20th day of April, 1990.  
Bureau of Land Management  
By: Joe A. Lusa  
Title: Asst. District Manager  
Lease : Square Lake 12 Unit

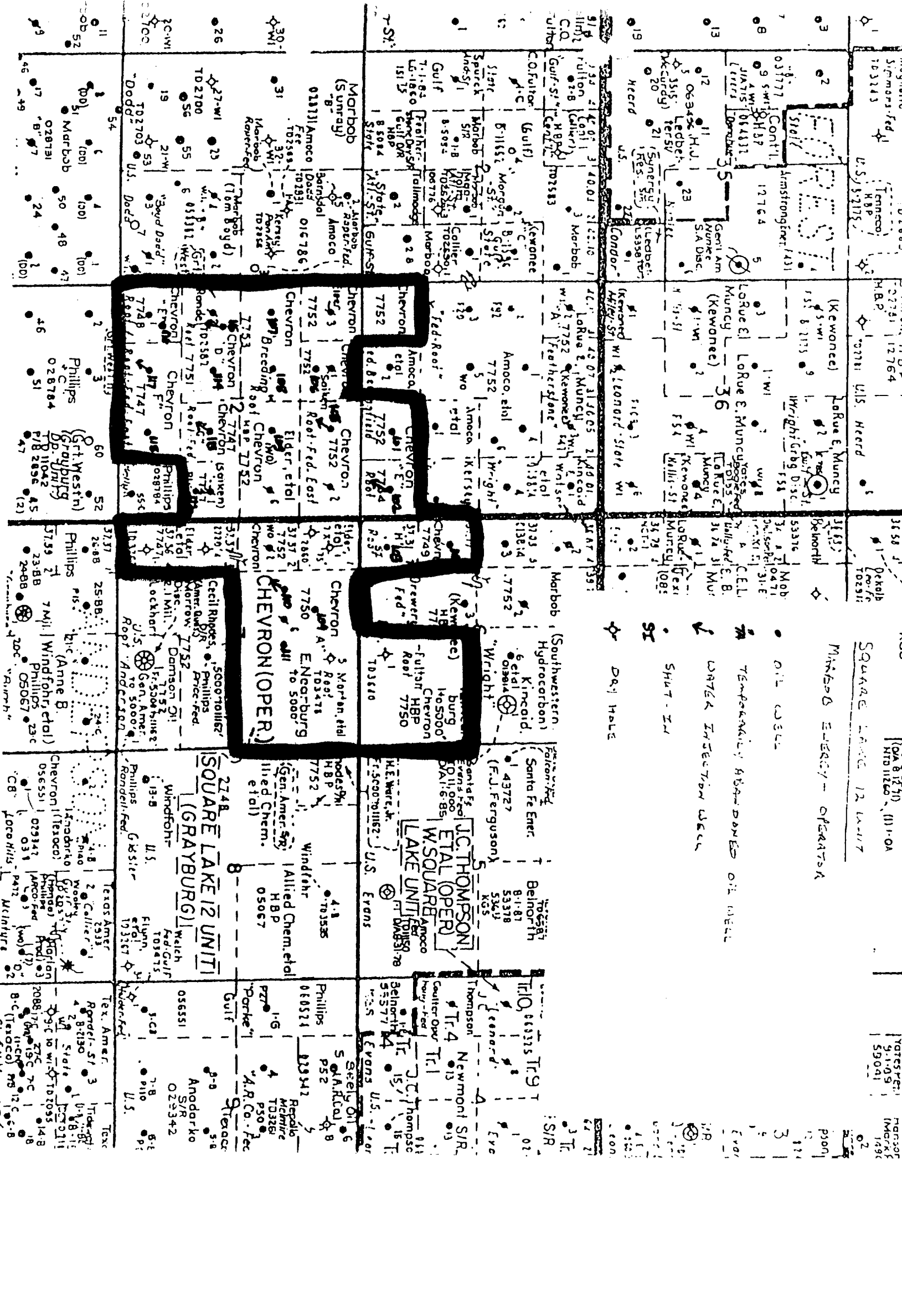

Notes: (GA 81231) (111-0A) HRO 11250  
MORSE 9-1-09 59041  
MORSE 1496

Notes: (GA 81231) (111-0A) HRO 11250  
MORSE 9-1-09 59041  
MORSE 1496

Notes: (GA 81231) (111-0A) HRO 11250  
MORSE 9-1-09 59041  
MORSE 1496

MINERAL ENERGY OPERATORS

SQUARE LAKE 12 UNIT

TEMPERATURE AND DAMAGED OIL WELL

DATE & INJECTION WELL

SHUT-IN

DAY HOLE

J.C. THOMPSON  
ETAL (OPER)  
W.SQUARE  
LAKE UNIT

J.C. THOMPSON  
NEW MONT S/R  
Tr. 4  
Tr. 15  
Tr. 16

CHEVRON (OPER.)  
E. ENGBURG  
7750  
103471

WINDFHR  
ALLIED Chem. etal  
HBP  
05067

PHILLIPS  
060524  
229342  
S. O.A. etal  
P52

Cecil Rhodes  
5000 TOLLER  
AMER. OIL & GAS  
7752  
FR. 5004 PHILIP  
ROCKHAWK  
U.S. GEN. AMER.  
ROPT. AND CR-500

WINDFHR  
U.S.  
13-B  
193367

PHILLIPS  
060524  
229342  
S. O.A. etal  
P52

CHEVRON (OPER.)  
E. ENGBURG  
7750  
103471

WINDFHR  
U.S.  
13-B  
193367

PHILLIPS  
060524  
229342  
S. O.A. etal  
P52

CHEVRON (OPER.)  
E. ENGBURG  
7750  
103471

WINDFHR  
U.S.  
13-B  
193367

PHILLIPS  
060524  
229342  
S. O.A. etal  
P52

CHEVRON (OPER.)  
E. ENGBURG  
7750  
103471

WINDFHR  
U.S.  
13-B  
193367

PHILLIPS  
060524  
229342  
S. O.A. etal  
P52

## MARBOB ENERGY CORPORATION

## SQUARE LAKE "12" UNIT

DATE	OIL(BBLS) MONTH	(BBL) DAY	GAS MONTH	(MCF) DAY	WATER PRODUCED MONTH	INJECTION WATER/MONTH
12/89	856	27	155	5	11,502	16,188
11/89	910	30	204	7	11,131	21,163
10/89	925	30	254	8	11,502	8,714
9/89	856	29	133	4	11,131	7,041
8/89	996	32	183	6	11,502	5,560
7/89	998	32	122	4	11,502	3,264
6/89	1,014	34	204	7	11,131	4,936
5/89	1,027	33	120	4	11,502	12,423
4/89	990	33	157	5	11,131	12,024
3/89	1,094	35	149	5	11,502	12,269
2/89	820	28	106	4	10,387	9,328
1/89	1,027	33	179	6	11,483	6,691

Total	<u>11,493</u>		<u>1,966</u>			
-------	---------------	--	--------------	--	--	--

12/88	1,048	34	151	5	11,502	33,789
11/88	960	32	127	4	11,131	32,699
10/88	997	32	147	5	11,502	33,789
9/88	887	30	116	4	11,131	32,699
8/88	606	20	114	4	11,502	33,788
7/88	439	14	150	5	11,502	33,791
6/88	764	25	71	2	11,131	32,701
5/88	2,115	68	17	2	11,502	33,791
4/88	826	28	8	2	11,131	32,701
3/88	760	24	0	2	11,502	33,790
2/88	711	24	0	2	10,760	31,603
1/88	769	25	19	2	11,502	31,605

TOTALS	<u>10,882</u>		<u>920</u>			
--------	---------------	--	------------	--	--	--



IN REPLY REFER TO:

UNITED STATES  
DEPARTMENT OF THE INTERIOR  
GEOLOGICAL SURVEY  
Drawer 1857  
Roswell, New Mexico 88201

July 30, 1968

Keweenaw Oil Company  
P. O. Box 2239  
Tulsa, Oklahoma 74101

Attention: Mr. R. S. Allison

Gentlemen:

Your initial plan of operation covering secondary recovery operations for the Square Lake 12 unit, Eddy County, New Mexico, has been approved on this date.

One approved copy of the plan is enclosed.

Sincerely yours,

(ORIG. SIGNED BY JOHN A. ANDERSON)

JOHN A. ANDERSON  
Regional Oil and Gas Supervisor

cc:  
Washington (w/cy plan)  
Artesia (w/cy plan)  
NMOCC, Santa Fe (ltr. only) ✓

1968 JUL 31 AM 11:00

GOVERNOR  
DAVID F. CARGO  
CHAIRMAN

State of New Mexico  
Oil Conservation Commission



LAND COMMISSIONER  
GUYTON B. HAYS  
MEMBER

STATE GEOLOGIST  
A. L. PORTER, JR.  
SECRETARY - DIRECTOR

P. O. BOX 2088  
SANTA FE

July 3, 1968

Mr. Richard Morris  
Montgomery, Federici, Andrews,  
Hannahs & Morris  
Attorneys at Law  
Post Office Box 2307  
Santa Fe, New Mexico

Re: Case No. 3791  
Order No. R-3445  
Applicant:  
Kewanee Oil Company

Dear Sir:

Enclosed herewith are two copies of the above-referenced Commission order recently entered in the subject case.

Very truly yours,

A. L. PORTER, Jr.  
Secretary-Director

ALP/ir

Carbon copy of order also sent to:

Hobbs OCC   x  

Artesia OCC   x  

Aztec OCC           

Other            Unit Division - Land Office, and Malcolm Long