

5579

EXXON COMPANY, U.S.A.

POST OFFICE BOX 1600 • MIDLAND, TEXAS 79702-1600

RECEIVED
SOUTHWESTERN DIVISION
MAR 8 1993

PRODUCTION DEPARTMENT
SOUTHWESTERN DIVISION

March 31, 1993

Plan of Development 1993
Laguna Grande Unit
Contract Number
12-08-0001-14272
Section 29: E/2 T23S-R29E
Eddy County, NM

Mr. Armando A. Lopez
U. S. Department of the Interior
Bureau of Land Management
Roswell District Office
P. O. Box 1397
Roswell, NM 88202-1397

Gentlemen:

During the calendar year of 1992, no wells were drilled. We were able to negotiate a contract to a lower pressure gas line and are currently selling gas in the lower pressure line. The Unit well is currently producing approximately 200 MCF per day. There are no plans to drill any additional wells or to recompleate this well in 1993.

Attached is a current plat showing the location of the Unit well together with a copy of Petroleum Information, Corporation's production for the Unit well.

Exxon, as Operator of this unit, requests your approval of this Plan of Development and Operations.

Very truly yours,

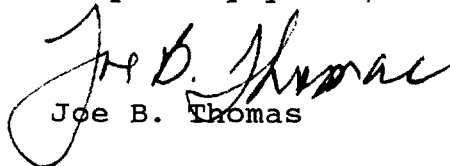
Joe B. Thomas

✓ c: New Mexico Oil Conservation Division
P. O. Box 2088
Santa Fe, NM 87501

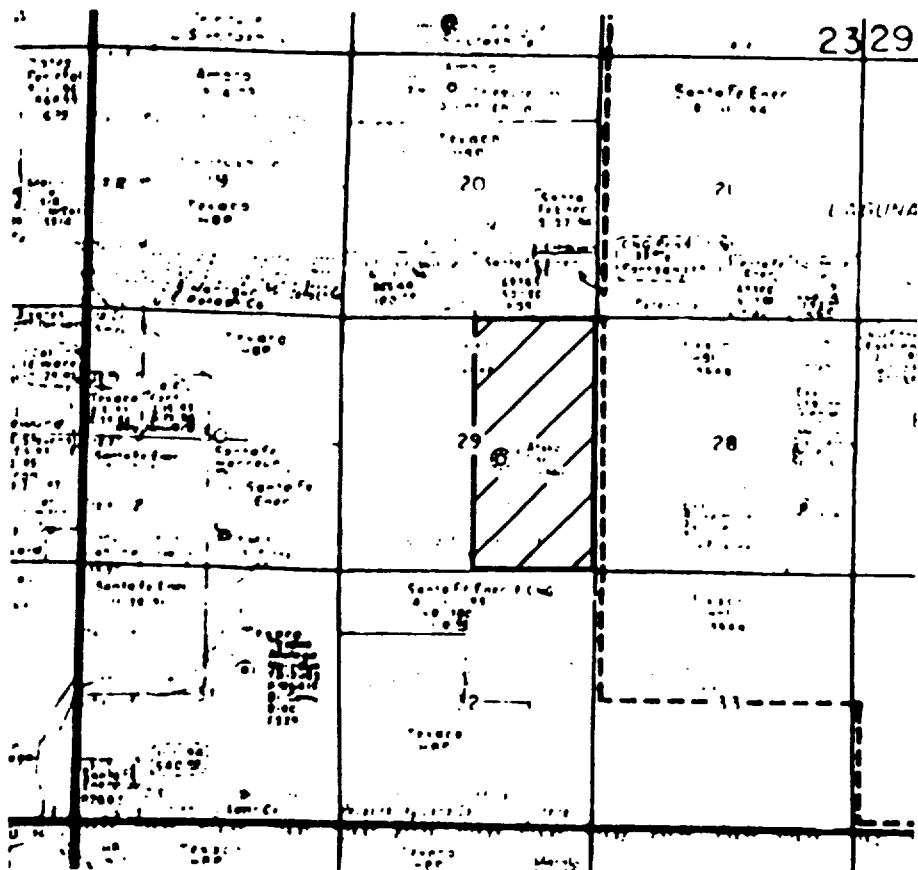

1" = 4000'

1993 Plan of Development
 Location Plat showing 320 Acre
 Exxon Operated Laguna Grande Unit

E/2 Section 29 T-23-S, R-29-E
 Eddy County, NM

Entity: LAGUNA GRANDE UNIT (403600)
 Operator: EXXON CORPORATION (11016)
 Field: LAGUNA SALADO (31225)
 Reservoir: ATOKA (PENN) (405)
 Formation: ATOKA /ATOKAN/(403ATOK)
 Location: T23S R29E 29 EDDY, NM Dist: 22
 Product: GAS
 Start: 198102
 Stop: 199211
 Well Status: ACTIVE
 # of Wells: 1

API Number	Well Number	Completion Number	Date	Dir	Perforations	Total	Type
					Upper	Lower	Well
3001523414	003	003	NA	NA	12104	12116	13690 NA
Well Number							
Date	Gas	Cond	Water	Water	Cond	Calc	*****
YYMMDD	MCFD	BPD	BPD	Yield	Yield	AOI	CLP FTP SITP BHP/Z
				BBL/MCF	BBL/MCF	MCF	
810120-1P 1995							6785 6258
830506							4851
840427							638
850820							1698
860710							3338
870911							1530
880818							1830
890807							1186
900915							1490
900915							1490
910912							1310
Year	Month	Number	Gas	Cond	Water	Gas	Cond
		Of Wells	Allowable			(MCF)	(BBL)
Beginning cumulatives for 1981		0				0	0
1981	Jan	1				1999	0
1981	Feb	1				18530	0
1981	Mar	1				19584	0
1981	Apr	1				19156	0
1981	May	1				19216	0
1981	Jun	1				0	0
1981	Jul	0				0	0
1981	Aug	1				18436	0
1981	Sep	1				17984	0
1981	Oct	1				16771	30
1981	Nov	1				18255	0
1981	Dec	1				19767	0
Year to date production for 1981						169698	0
Cumulatives at year end for 1981						169698	0
Year	Month	Number	Gas	Cond	Water	Gas	Cond
		Of Wells	Allowable			(MCF)	(BBL)
Beginning cumulatives for 1982		1				169698	0
1982	Jan	1				18806	0
1982	Feb	1				17924	0
1982	Mar	1				19641	0
1982	Apr	1				17847	18

1982	May	1	18239	17	0
1982	Jun	1	17776	16	0
1982	Jul	1	18494	10	0
1982	Aug	1	14775	4	0
1982	Sep	1	957	0	0
1982	Oct	1	681	0	0
1982	Nov	1	11566	5	0
1982	Dec	1	11316	0	0
Year to date production for 1982					
Cumulatives at year end for 1982					
			168022	70	29
			337720	70	59
Year to date production for 1983					
Cumulatives at year end for 1983					
Year	Month	Number	Gas	Cond	Water
Beginning		Of Wells	Allowable	(BBL)	(BBL)
1983	Jan	1	337720	70	59
1983	Feb	1	6430	0	
1983	Mar	1	18449	2	
1983	Apr	1	19786	9	
1983	May	1	11211	0	
1983	Jun	1	11946	0	
1983	Jul	1	5774	3	
1983	Aug	1	13262	0	
1983	Sep	1	1795	4	
1983	Oct	1	23279	0	
1983	Nov	1	3844	0	
1983	Dec	1	7606	0	
1983			7354	5	
Year to date production for 1983					
Cumulatives at year end for 1983					
			130736	23	0
			468456	93	59
Year to date production for 1984					
Cumulatives at year end for 1984					
Year	Month	Number	Gas	Cond	Water
Beginning		Of Wells	Allowable	(BBL)	(BBL)
1984	Jan	1	468456	93	59
1984	Feb	1	298		
1984	Mar	1	34		
1984	Apr	1	34		
1984	May	0	49		
1984	Jun	0	0		
1984	Jul	0	0		
1984	Aug	1	168		
1984	Sep	1	11812		
1984	Oct	1	16743		
1984	Nov	1	12077		
1984	Dec	1	11624		
Year to date production for 1984					
Cumulatives at year end for 1984					
			52839	0	0
			521295	93	59
Year to date production for 1985					
Cumulatives at year end for 1985					
Year	Month	Number	Gas	Cond	Water
Beginning		Of Wells	Allowable	(BBL)	(BBL)
1985	Jan	1	521295	93	59
1985	Feb	1	11854	0	
1985	Mar	1	10398	0	
1985	Apr	1	13276	9	
1985	May	1	10423	1	
1985			12706	14	

1985	Jun	1	10139	7	0
1985	Jul	1	10309	20	59
1985	Aug	1	9262	0	59
1985	Sep	1	4659	0	59
1985	Oct	1	9960	29	59
1985	Nov	1	5045	23	59
1985	Dec	1	4932	0	59
Year to date production for 1985					
Cumulatives at year end for 1985					
Year	Month	Number	Gas	Cond	Water
Beginning			(MCF)	(BBL)	(BBL)
1986	Jan	1	634258	196	59
1986	Feb	1	8439	10	59
1986	Mar	1	7013	30	59
1986	Apr	1	6094	0	59
1986	May	1	5881	0	59
1986	Jun	1	4939	0	59
1986	Jul	1	2156	14	59
1986	Aug	1	0	0	59
1986	Sep	1	4304	14	59
1986	Oct	1	4614	0	59
1986	Nov	1	5300	12	59
1986	Dec	1	3597	0	59
1986		0	0	3	59
Year to date production for 1986					
Cumulatives at year end for 1986					
Year	Month	Number	Gas	Cond	Water
Beginning			(MCF)	(BBL)	(BBL)
1987	Jan	1	52337	83	59
1987	Feb	1	686595	279	59
1987	Mar	1	2672	20	59
1987	Apr	1	5972	12	59
1987	May	1	4449	4	59
1987	Jun	1	1998	3	59
1987	Jul	1	1528	7	59
1987	Aug	1	4468	8	59
1987	Sep	1	6380	1	59
1987	Oct	1	5473	15	59
1987	Nov	1	5721	36	59
1987	Dec	1	5446	0	59
1987		1	5735	0	59
1987		1	4592	14	59
Year to date production for 1987					
Cumulatives at year end for 1987					
Year	Month	Number	Gas	Cond	Water
Beginning			(MCF)	(BBL)	(BBL)
1988	Jan	1	741029	120	59
1988	Feb	1	54434	399	59
1988	Mar	1	741029	399	59
1988	Apr	1	6092	10	59
1988	May	1	4686	20	59
1988	Jun	1	1214	1	59
1988		1	4909	18	59
1988		1	309	0	59
1988		1	1944	22	59

1988	Jul	1	5398	0	26
1988	Aug	1	3936	1	4
1988	Sep	1	3606	0	24
1988	Oct	1	5111	16	32
1988	Nov	1	4123	16	32
1988	Dec	1	6123	0	30
Year to date production for 1988					
Cumulatives at year end for 1988					
Year	Month	Number	Gas	Cond	Water
Beginning			(MCF)	(BBL)	(BBL)
1989	Jan	1	788480	503	251
1989	Feb	1	4436	15	30
1989	Mar	1	1030	0	14
1989	Apr	1	5487	0	23
1989	May	1	5056	0	74
1989	Jun	1	5672	0	155
1989	Jul	1	4227	15	150
1989	Aug	1	5865	3	30
1989	Sep	1	2981	0	80
1989	Oct	1	4601	36	360
1989	Nov	1	5434	0	155
1989	Dec	1	4978	15	150
Year to date production for 1989					
Cumulatives at year end for 1989					
Year	Month	Number	Gas	Cond	Water
Beginning			(MCF)	(BBL)	(BBL)
1990	Jan	1	845631	600	1602
1990	Feb	1	5861	0	70
1990	Mar	1	4669	7	28
1990	Apr	1	5929	0	62
1990	May	1	4186	0	60
1990	Jun	1	5991	7	76
1990	Jul	1	3926	6	30
1990	Aug	1	6495	5	31
1990	Sep	1	4867	9	31
1990	Oct	1	6020	4	29
1990	Nov	1	3683	4	31
1990	Dec	1	6556	6	30
Year to date production for 1990					
Cumulatives at year end for 1990					
Year	Month	Number	Gas	Cond	Water
Beginning			(MCF)	(BBL)	(BBL)
1991	Jan	1	64461	59	509
1991	Feb	1	910092	659	2111
1991	Mar	1	910092	659	2111
1991	Apr	1	6096	1	29
1991	May	1	6121	4	28
1991	Jun	1	5454	0	31
1991	Jul	1	6924	14	30
1991	Aug	1	6766	0	31
1991	Sep	1	5836	0	30
1991	Oct	1	5948	0	31
1991	Nov	1			
1991	Dec	1			

1991	Aug	1	5050	0	29
1991	Sep	1	6431	0	29
1991	Oct	1	5669	0	31
1991	Nov	1	5652	0	30
1991	Dec	1	285	0	31
Year to date production for 1991					
Cumulatives at year end for 1991			66232	19	360
			976324	678	2471
Year to date production for 1992					
Cumulatives at year end for 1992			976324	678	2471
1992	Jan	1	4667	0	20
1992	Feb	1	5994	8	29
1992	Mar	1	5840	0	31
1992	Apr	1	5803	0	30
1992	May	1	8071	7	31
1992	Jun	1	7504	5	30
1992	Jul	1	8352	0	31
1992	Aug	1	7936	0	31
1992	Sep	1	7136	0	30
1992	Oct	1	6375	0	31
1992	Nov	1	5964	3	29
1992	Dec	0	0	0	0
Year to date production for 1992			73642	23	323
Cumulatives at year end for 1992			1049966	701	2794
***** All cumulatives are through last updated month and					
***** may not agree with previously published hard copy					
***** output due to amendments made to prior months.					

#5579

OIL CONSERVATION DIVISION

RECEIVED

EXXON COMPANY, U.S.A.

POST OFFICE BOX 1600 • MIDLAND, TEXAS 79702-1600

192 MAR 20 1992

March 9 1992

PRODUCTION DEPARTMENT
SOUTHWESTERN DIVISION

1992 Plan of Development/
Operations Laguna Grande
Unit-effective 12/01/75
Contract Number
12-08-0001-14272
Section 29: E/2 T23S-R29E
Eddy County, NM
Laguna Salado Atoka Field

Mr. Joe G. Lara
United States Department of Interior
Bureau of Land Management
Roswell District Office
P. O. Box 1397
Roswell, NM 88202-1397

During the calendar year, no wells were drilled. The Unit well, the Laguna Grande Unit well # 3, was worked over and additional perforations from 12174-12189 feet were opened in the Atoka Limestone. The well is still on report and is testing approximately 300 mcf per day. We are currently investigating the possibility of selling our gas to a lower pressure line to increase the Unit's production rate. Depending upon the outcome of these negotiations, we may also investigate the feasibility of running a siphon string in the well to keep the well unloaded and flowing at a higher rate.

Attached is a current plat showing the location of the Unit together with a copy of Dwight's production data for the well.

Exxon, as Operator of this Unit, requests your approval of this Plan of Development and Operations.

Very truly yours,

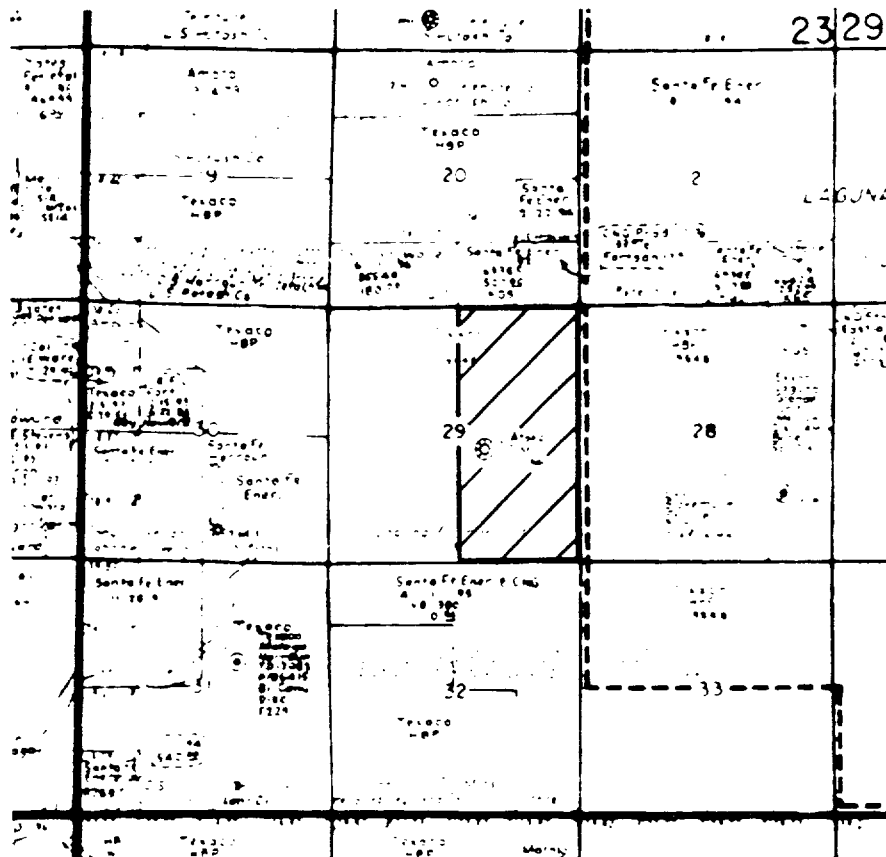

Joe B. Thomas

→ c: New Mexico Oil Conservation Division
P. O. Box 2088
Santa Fe, NM 87504



1" = 4000'

1992 Plan of Development Submittal

Location Plat Showing 320 acre  Exxon Operated Laguna Grande Unit

E/2 Section 29 T-23-S, R-29-E

Eddy County, New Mexico

ENTITY: LAGUNA GRANDE UNIT (403600) PRODUCT: GAS
 OPERATOR: EXXON CORPORATION (11016) START: 198102
 FIELD: LAGUNA SALADO (31225) STOP: 199107
 RESERVOIR: ATOKA (PENN (405) STATUS: ACTIVE
 FORMATION: ATOKA /ATOKAN/(403ATOK) # OF WELLS: 1
 LOCATION: T23S R29E 29 EDDY, NM DIST: 22

API NUMBER	WELL NUMBER	COMPLETION DATE	DIR	PERFORATIONS UPPER LOWER	TOTAL DEPTH	TYPE WELL
3001523414	003	NA	NA	12104	12116	13690
YEAR	MONTH	NUMBER OF WELLS	GAS ALLOWABLE	GAS (MCF)	COND (BBL)	WATER (BBL)
BEGINNING CUMULATIVES FOR 1981		0		0	0	0
1981	JAN	1		0	0	0
1981	FEB	1		1999	0	0
1981	MAR	1		18530	0	0
1981	APR	1		19584	0	0
1981	MAY	1		19156	0	0
1981	JUN	1		19216	0	0
1981	JUL	0		0	0	0
1981	AUG	1		18436	0	0
1981	SEP	1		17984	0	0
1981	OCT	1		16771	0	30
1981	NOV	1		18255	0	0
1981	DEC	1		19767	0	0
YEAR TO DATE PRODUCTION FOR 1981				169698	0	30
CUMULATIVES AT YEAR END FOR 1981				169698	0	30
YEAR	MONTH	NUMBER OF WELLS	GAS ALLOWABLE	GAS (MCF)	COND (BBL)	WATER (BBL)
BEGINNING CUMULATIVES FOR 1982		1		169698	0	30
1982	JAN	1		18806	0	0
1982	FEB	1		17924	0	14
1982	MAR	1		19641	0	0
1982	APR	1		17847	18	15
1982	MAY	1		18239	17	0
1982	JUN	1		17776	16	0
1982	JUL	1		18494	10	0
1982	AUG	1		14775	4	0
1982	SEP	1		957	0	0
1982	OCT	1		681	0	0
1982	NOV	1		11566	5	0
1982	DEC	1		11316	0	0
YEAR TO DATE PRODUCTION FOR 1982				168022	70	29
CUMULATIVES AT YEAR END FOR 1982				337720	70	59
YEAR	MONTH	NUMBER OF WELLS	GAS ALLOWABLE	GAS (MCF)	COND (BBL)	WATER (BBL)
BEGINNING CUMULATIVES FOR 1983		1		337720	70	59
1983	JAN	1		6430	0	0
1983	FEB	1		18449	2	0
1983	MAR	1		19786	9	0
1983	APR	1		11211	0	0
1983	MAY	1		11946	0	0
1983	JUN	1		5774	3	0
1983	JUL	1		13262	0	0

1983
1983
1983

AUG
SEP
OCT

1
1
1

1795
23279
3844

4
0
0

YEAR	MONTH	NUMBER	GAS	COND	WATER
1983	NOV	1	7606	0	
1983	DEC	1	7354	5	
YEAR TO DATE PRODUCTION FOR 1983					
			130736	23	0
CUMULATIVES AT YEAR END FOR 1983					
			468456	93	59
YEAR	MONTH	NUMBER <th>GAS</th> <th>COND</th> <th>WATER</th>	GAS	COND	WATER
1984	JAN	1	468456	93	59
BEGINNING CUMULATIVES FOR 1984					
1984	FEB	1	298		
1984	MAR	1	34		
1984	APR	1	34		
1984	MAY	0	49		
1984	JUN	0	0		
1984	JUL	0	0		
1984	AUG	1	168		
1984	SEP	1	11812		
1984	OCT	1	16743		
1984	NOV	1	12077		
1984	DEC	1	11624		
YEAR TO DATE PRODUCTION FOR 1984					
			52839	0	0
CUMULATIVES AT YEAR END FOR 1984					
			521295	93	59

YEAR	MONTH	NUMBER	GAS	COND	WATER
1985	JAN	1	521295	93	59
BEGINNING CUMULATIVES FOR 1985					
1985	FEB	1	11854	0	
1985	MAR	1	10398	0	
1985	APR	1	13276	9	
1985	MAY	1	10423	1	
1985	JUN	1	12706	14	
1985	JUL	1	10139	7	
1985	AUG	1	10309	20	
1985	SEP	1	9262	0	
1985	OCT	1	4659	0	
1985	NOV	1	9960	29	
1985	DEC	1	5045	23	
YEAR TO DATE PRODUCTION FOR 1985					
			4932	0	0
CUMULATIVES AT YEAR END FOR 1985					
			112963	103	0
			634258	196	59

YEAR	MONTH	NUMBER	GAS	COND	WATER
1986	JAN	1	634258	196	59
BEGINNING CUMULATIVES FOR 1986					
1986	FEB	1	8439	10	
1986	MAR	1	7013	30	
1986	APR	1	6094	0	
1986	MAY	1	5881	0	
1986	JUN	1	4939	0	
1986	JUL	1	2156	14	
1986	AUG	0	0	0	
1986	SEP	1	4304	14	
1986	OCT	1	4614	0	
1986	NOV	1	5300	12	
1986	DEC	1	3597	0	
YEAR TO DATE PRODUCTION FOR 1986					
			0	3	0
CUMULATIVES AT YEAR END FOR 1986					
			52337	83	0
			686595	279	59

YEAR	MONTH	NUMBER	GAS	COND	WATER
1986	JAN	1	686595	279	59
BEGINNING CUMULATIVES AT YEAR END FOR 1986					
1986	FEB	1	52337	83	0
1986	MAR	1	686595	279	59
1986	APR	1	52337	83	0
1986	MAY	1	686595	279	59
1986	JUN	1	52337	83	0
1986	JUL	1	686595	279	59
1986	AUG	0	52337	83	0
1986	SEP	1	686595	279	59
1986	OCT	1	52337	83	0
1986	NOV	1	686595	279	59
1986	DEC	0	52337	83	0
YEAR TO DATE PRODUCTION FOR 1986					
			0	3	0
CUMULATIVES AT YEAR END FOR 1986					
			52337	83	0
			686595	279	59

YEAR MONTH OF WELLS ALLOWABLE (MCF) (BBL) (BBL)

BEGINNING CUMULATIVES FOR 1987

YEAR	MONTH	NUMBER	GAS ALLOWABLE	COND	WATER
1987	JAN	1	686595	279	59
1987	FEB	1	2672	20	
1987	MAR	1	5972	12	
1987	APR	1	4449	4	
1987	MAY	1	1998	3	
1987	JUN	1	1528	7	
1987	JUL	1	4468	8	
1987	AUG	1	6380	1	
1987	SEP	1	5473	15	
1987	OCT	1	5721	36	
1987	NOV	1	5446	0	
1987	DEC	1	5735	0	
1987	DEC	1	4592	14	
1987	DEC	1	54434	120	0

YEAR TO DATE PRODUCTION FOR 1987
 CUMULATIVES AT YEAR END FOR 1987

BEGINNING CUMULATIVES FOR 1988

YEAR	MONTH	NUMBER	GAS ALLOWABLE	COND	WATER
1988	JAN	1	741029	399	59
1988	FEB	1	6092	10	59
1988	MAR	1	4686	20	0
1988	APR	1	1214	1	0
1988	MAY	1	4909	18	0
1988	JUN	1	309	0	0
1988	JUL	1	1944	22	44
1988	AUG	1	5398	0	26
1988	SEP	1	3936	1	4
1988	OCT	1	3606	0	24
1988	NOV	1	5111	16	32
1988	DEC	1	4123	16	32
1988	DEC	1	6123	0	30
1988	DEC	1	47451	104	192
1988	DEC	1	788480	503	251

YEAR TO DATE PRODUCTION FOR 1988
 CUMULATIVES AT YEAR END FOR 1988

BEGINNING CUMULATIVES FOR 1989

YEAR	MONTH	NUMBER	GAS ALLOWABLE	COND	WATER
1989	JAN	1	788480	503	251
1989	FEB	1	4436	15	30
1989	MAR	1	1030	0	14
1989	APR	1	5487	0	23
1989	MAY	1	5056	0	74
1989	JUN	1	5672	0	155
1989	JUL	1	4227	15	150
1989	AUG	1	5865	3	30
1989	SEP	1	2981	0	80
1989	OCT	1	4601	36	360
1989	NOV	1	5434	0	155
1989	DEC	1	4978	15	150
1989	DEC	1	7384	13	130
1989	DEC	1	57151	97	1351
1989	DEC	1	845631	600	1602

YEAR TO DATE PRODUCTION FOR 1989
 CUMULATIVES AT YEAR END FOR 1989

BEGINNING CUMULATIVES FOR 1990

YEAR	MONTH	NUMBER	GAS ALLOWABLE	COND	WATER
1990	JAN	1	845631	600	1602
1990	FEB	1	5861	0	70
1990	MAR	1	4669	7	28
1990	APR	1	5929	0	62
1990	APR	1	4186	0	60

1990

MAY

1

5991

7

76

1990	JUN	1	3926	6	30
1990	JUL	1	6495	5	31
1990	AUG	1	4867	9	31
1990	SEP	1	6020	4	29
1990	OCT	1	3683	4	31
1990	NOV	1	6556	6	30
1990	DEC	1	6278	11	31
YEAR TO DATE PRODUCTION FOR 1990					
CUMULATIVES AT YEAR END FOR 1990			64461	59	509
			910092	659	2111
YEAR TO DATE PRODUCTION FOR 1991					
CUMULATIVES AT YEAR END FOR 1991			910092	659	2111
1991	JAN	1	6096	1	29
1991	FEB	1	6121	4	28
1991	MAR	1	5454	0	31
1991	APR	1	6924	14	30
1991	MAY	1	6766	0	31
1991	JUN	1	5836	0	30
1991	JUL	1	5948	0	31
1991	AUG	0	0	0	0
1991	SEP	0	0	0	0
1991	OCT	0	0	0	0
1991	NOV	0	0	0	0
1991	DEC	0	0	0	0
YEAR TO DATE PRODUCTION FOR 1991					
CUMULATIVES AT YEAR END FOR 1991			43145	19	210
			953237	678	2321
***** ALL CUMULATIVES ARE THROUGH LAST UPDATED MONTH AND *****					
***** MAY NOT AGREE WITH PREVIOUSLY PUBLISHED HARD COPY *****					
***** OUTPUT DUE TO AMENDMENTS MADE TO PRIOR MONTHS. *****					

#55 79

OIL CONSERVATION DIVISION

EXXON COMPANY, U.S.A.

RECEIVED

February 20, 1991

POST OFFICE BOX 1600 • MIDLAND, TEXAS 79702-1600

91 FEB 25 AM 9 09

PRODUCTION DEPARTMENT
SOUTHWESTERN DIVISION

1991 Plan of Development/
Operations Laguna Grande
Unit-Effective 12/01/75
Contract Number
12-08-0001-14272
Section 29:E/2 T23S-R29E
Eddy County, NM
Laguna Salado Atoka Field

3-7-91

D-Unit letter
The Ry

Mr. Joe G. Lara
United States Department of Interior
Bureau of Land Management
Roswell District Office
P. O. Box 1397
Roswell, NM 88202-1397

During the 1990 calendar year, no wells were drilled nor was a workover performed on the Unit's only well, The Laguna Grande Unit well # 3. Attached is a current map showing the location of this well together with a report showing production data in statistical form for this well.

During the period of January 1, 1991 through December 31, 1991, no drill wells are planned. Exxon, as Operator, plans to work over the unit well in mid- 1991 and add additional Atoka pay (from 12,172 feet to 12,192 feet).

Exxon, as Operator of this unit, requests your approval of this Plan of Development and Operations.

Very truly yours,

Joe B. Thomas

✓ c: New Mexico Oil Conservation Division
P. O. Box 2088
Santa Fe, NM 87501

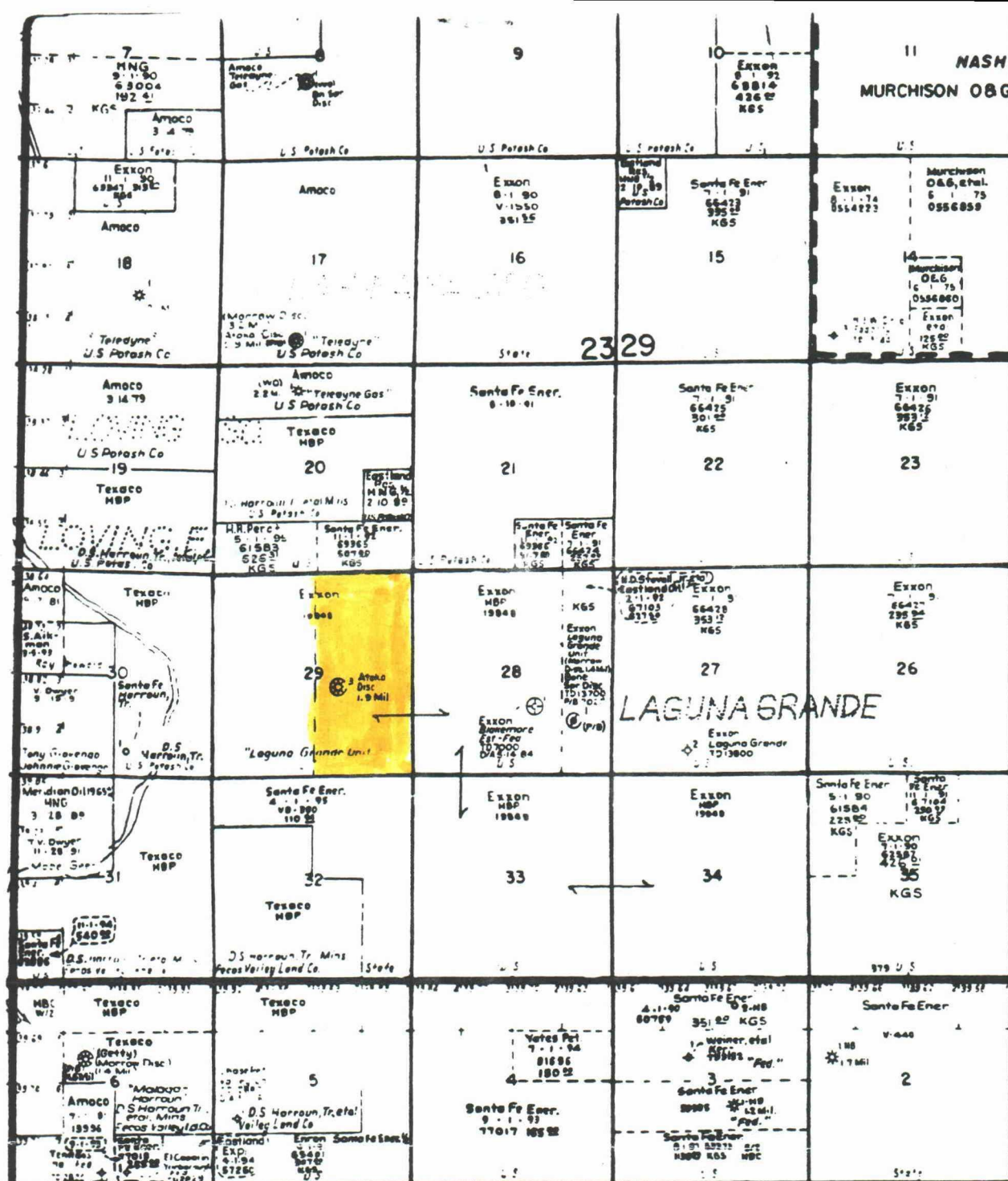

R29E

Location Map showing 320 acres
of Laguna Grande Unit, Eddy
County, New Mexico.



**PRODUCTION DATA
FOR LAGUNA GRANDE UNIT
1990**

	<u>OIL</u> <u>BOPD</u>	<u>WATER</u> <u>BWPD</u>	<u>GAS</u> <u>*MCFGPD</u>
J	0	2	184
F	0	1	167
M	0	2	191
A	0	2	237
M	0	1	203
J	0	1	131
J	0	1	210
A	0	1	159
S	0	1	201
O	0	1	119
N	0	1	219
D	0	1	201
Cumulative for 1990	<u>0B0</u>	<u>487BW</u>	<u>67,340MCFG</u>

*M = Thousand



STATE OF NEW MEXICO
ENERGY, MINERALS AND NATURAL RESOURCES DEPARTMENT
OIL CONSERVATION DIVISION

BRUCE KING
GOVERNOR

March 7, 1991

POST OFFICE BOX 2088
STATE LAND OFFICE BUILDING
SANTA FE, NEW MEXICO 87504
(505) 827-5800

Exxon Comany USA
P. O. Box 1600
Midland, Texas 79702-1600

Attention: Joe B. Thomas

Re: 1991 Plan of Development/
Operations Laguna Grande
Unit-Effective 12/01/75
Contract Number
12-08-0001-14272
Section 29: E/2, T-23-S, R-29-E
Eddy County
Laguna Salado Atoka Field

Gentlemen:

The above-referenced submittal has been approved by the New Mexico Oil Conservation Division effective this date. Such approval is contingent upon like approval by the New Mexico Commissioner of Public Lands and the Bureau of Land Management.

Sincerely,

A handwritten signature in cursive script, appearing to read "Roy E. Johnson".

ROY E. JOHNSON,
Senior Petroleum Geologist

REJ/dr

cc: Commissioner of Public Lands
Bureau of Land Management

EXXON COMPANY, U.S.A.

POST OFFICE BOX 1600 • MIDLAND, TEXAS 79702-1600

#5579

EXPLORATION DEPARTMENT
WESTERN DIVISION

March 21, 1989

Plan of Development and Operations
Laguna Grande Unit - Effective 12/1/75
Contract No. 12-08-0001-14272
E/2 Section 29, T-23-S, R-29-E
Eddy County, New Mexico
Laguna Salado Atoka Field

Bureau of Land Management
Roswell District Office
P. O. Box 1397
Roswell, New Mexico 88201-1397

Attention: Mr. Joe G. Lara

Gentlemen:

During the 1988 calendar year, no wells were drilled nor was a workover performed on the Unit's only well, the Laguna Grande Unit Well No. 3. Attached are a current unit map showing the location of this well and a report showing production data in statistical form for this well.

During the period of January 1, 1989 through December 31, 1989, no drill wells or workovers are planned.

Exxon, as operator of this unit, requests your approval of this Plan of Development and Operations.

Very truly yours,

M. Beth B. Frantes
M. Beth B. Frantes
Trades and Unitization
915/683-0174

MBBF:kn
Attachments

c: New Mexico Oil Conservation Division
P. O. Box 2088
Santa Fe, New Mexico 87501

Working Interest Owners
(See Attached Listing)

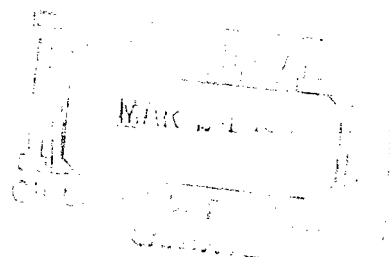

LAGUNA GRANDE UNIT
WORKING INTEREST OWNERS

Amoco Production Company
P. O. Box 591
Tulsa, OK 74102

Apache Corporation
7666 East 61st, Suite 500
Tulsa, OK 74133

Mr. Thomas Edward Moore
P. O. Box 2156
Midland, TX 79702

Nortex Corporation
1212 Main Street, Ste. 1400
Houston, TX 77002

Phillips Petroleum Company
P. O. Box 1967
Houston, TX 77251-1967

Mr. Wayne A. Piette
2309 Stanolind
Midland, TX 79701

Sabine Corporation
2001 Ross Ave. #LB 109 LTV 1000
Dallas, TX 75201-2993

Bird Creek Resources
1412 S. Boston, Suite 550
Tulsa, OK 74119

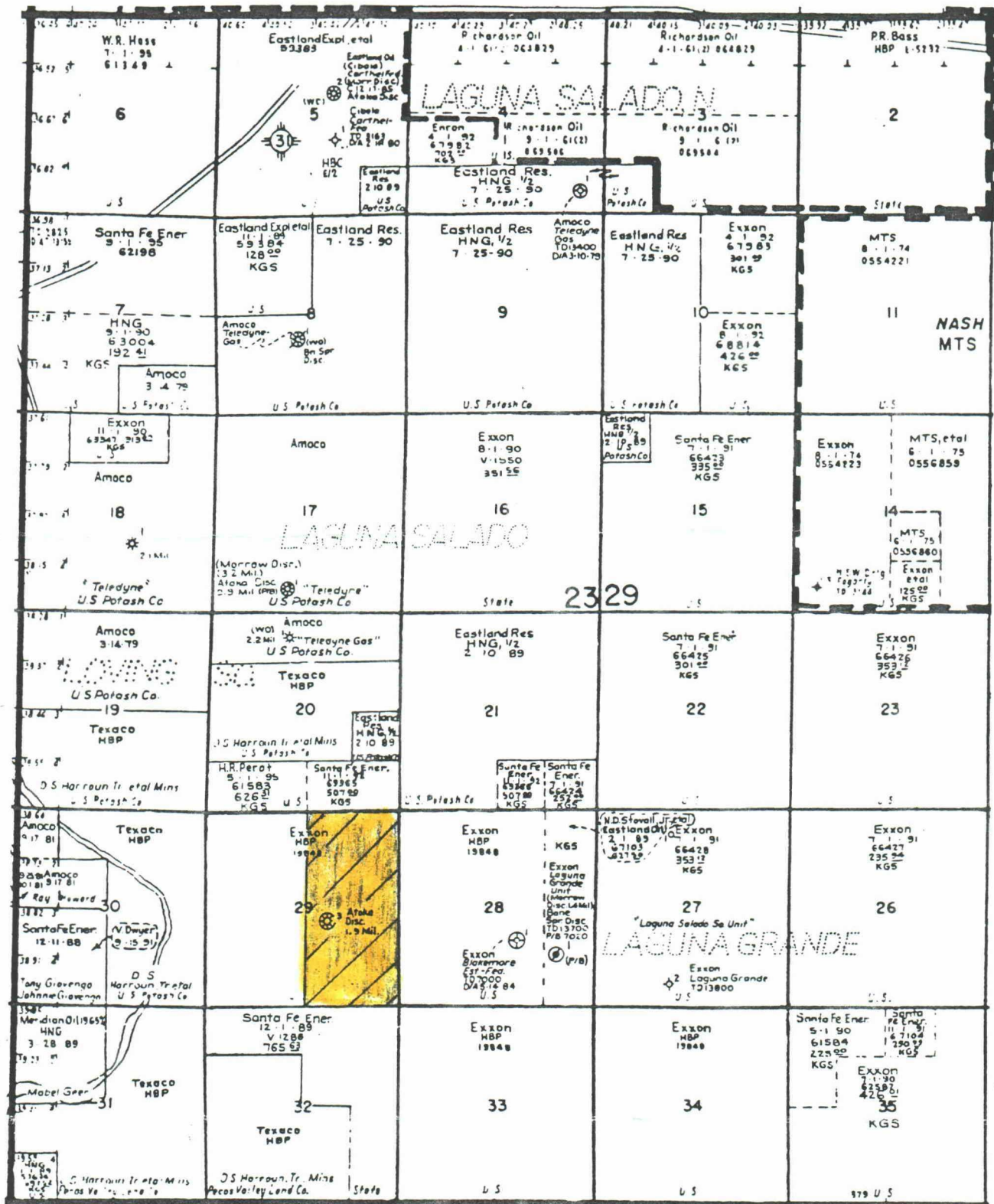

Location Map showing 320 acres  of Laguna Grande Unit, Eddy County, New Mexico.

PRODUCTION DATA
FOR LAGUNA GRANDE UNIT
1988

	<u>Oil</u> <u>BOPD</u>	<u>Water</u> <u>BWPD</u>	<u>Gas</u> <u>*MCFGPD</u>
J	0	0	197
F	1	0	167
M	0	0	182
A	1	0	164
M	0	0	10
J	1	1	65
J	0	1	174
A	0	0	127
S	0	1	120
O	1	1	165
N	1	1	137
D	0	1	198
Cumulative for 1988	<u>10480</u>	<u>190BW</u>	<u>51000MCFG</u>

*M = Thousand

Unit Name LAGUNA GRANDE UNIT (EXPLORATORY)
Operator Exxon Company
County EDDY

DATE	OCC CASE NO.	5579	EFFECTIVE	TOTAL	ACREAGE	STATE	FEDERAL	INDIAN-FEE	SEGREGATION	TERM
APPROVED	OCC ORDER NO.	R-5121	DATE						CLAUSE	
COMMISSIONER	OCC:	November 17, 1975	12-1-75	7680.00	7680.00	960	5,800.00	920	yes	5yrs.

11-18-75

Effective December 1, 1975

UNIT AREA

TOWNSHIP 23 SOUTH, RANGE 29 EAST, NMPM
Sections 15, 16, All
Section 21: S/2SE/4
Sections 22, 23: All
Sections 26, 27, 28, and 29: All
Section 32: E/2E/2, W/2NE/4, N/2NW/4
Sections 33 and 34: All

ALL STATE LANDS
ELIMINATED 3-27-81
EFFECTIVE DATE 9-19-83
APP: 9-19-83

E² Sec. 29-23S-29E REMAINS IN UNIT

Unit Name LAGUNA GRANDE UNIT (EXPLORATORY)
 Operator EXXON COMPANY
 County EDDY

STATE TRACT NO.	LEASE NO.	INSTI- TUTION	SEC.	TWP.	RGE.	SUBSECTION	RATIFIED		ACREAGE NOT RATIFIED	LESSEE
							DATE	ACRES		
7	LG-1553	C.S.	16	23S	29E	A11	8-26-75	640.00		Exxon Company
8	L-6748-2	C.S.	32	23S	29E	E/2E/2, W/2NE/4, N/2NW/4	10-10-75	320.00		Dalco Inc.

ELIMINATED
 EFFECTIVE DATE 3-27-83
 APP. 9-14-83

State of New Mexico

#5579

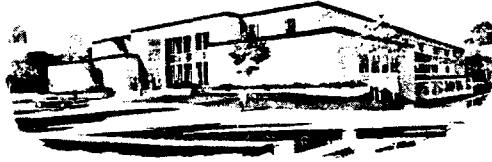

JIM BACA
COMMISSIONER

Commissioner of Public Lands

September 19, 1983

P.O. BOX 1148
SANTA FE, NEW MEXICO 87504-1148

Exxon Company, U.S.A.
P. O. Box 1600
Midland, Texas 79702

Re: Automatic Elimination
Laguna Grande Unit
Eddy County, New Mexico

ATTENTION: Mr. Joe Pope

As per Article 2 (e) the Laguna Grande Unit, Eddy County, New Mexico has contracted to include only those lands within the initial Atoka Participating Area. The effective date of this contraction is March 27, 1981.

Please be advised that this office has this date accepted your revised Exhibits "A" and "B" which reflect this contraction.

Very truly yours,

JIM BACA
COMMISSIONER OF PUBLIC LANDS

BY:
RAY D. GRAHAM, Director
Oil and Gas Division
AC 505/827-5744

JB/RDG/pm
encls.
cc:

OCD-Santa Fe, New Mexico
BLM-Albuquerque, New Mexico
BLM-Roswell, New Mexico

State of New Mexico



JIM BACA
COMMISSIONER

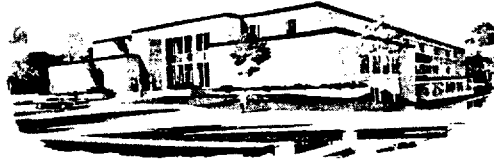

Commissioner of Public Lands

September 16, 1983

P.O. BOX 1148
SANTA FE, NEW MEXICO 87504-1148

Exxon Company, U. S. A.
P. O. Box 1600
Midland, Texas 79702

Re: Commercial Determination
Laguna Grande Unit Well No. 3
Eddy County, New Mexico

ATTENTION: Mr Joe Pope

Gentlemen:

This office is in receipt of your letter dated September 12, 1983, wherein as unit operator of the Laguna Grande Unit, Eddy County, New Mexico, you believe that the Unit Well No. 3 is capable of producing unitized substances in commercial quantities.

According to the data submitted, this office concurs with your determination that the Well No. 3 is capable of producing unitized substances in paying quantities from the Atoka formation.

This office has also approved your Initial Atoka Participating Area. The Initial Participating area is described as the E/2 of Section 29, Township 23 South, Range 29 East, and is effective as of January 16, 1981.

Our approval is subject to like approval by the Bureau of Land Management.

Very truly yours,

JIM BACA
COMMISSIONER OF PUBLIC LANDS

BY:
RAY D. GRAHAM, Director
Oil and Gas Division
AC 505/827-5744

JB/RDG/pm
encls.

cc: OCD-Santa Fe, New Mexico
BLM-Albuquerque, New Mexico
BLM-Roswell, New Mexico

EXXON COMPANY, U.S.A.
POST OFFICE BOX 1600 • MIDLAND, TEXAS 79702

EXPLORATION DEPARTMENT
SOUTHWESTERN DIVISION

September 12, 1983

Re: Laguna Grande Unit Agreement
Revised Exhibits A and B
Effective January 16, 1983

United States Department of the Interior
Bureau of Land Management
Roswell District Office
P. O. Box 1397
Roswell, New Mexico 88201

Attention: Mr. Al Collar

Commission of Public Lands
New Mexico State Land Office
Post Office Box 1148
Santa Fe, New Mexico 87504-1148

Attention: Mr. Ray D. Graham

New Mexico Oil Conservation Commission
P. O. Box 2088
Santa Fe, New Mexico 87054

Gentlemen:

Enclosed are five copies to the Bureau of Land Management, three copies to the State Land Office and one copy to the Oil Conservation Commission of our revised Exhibit A and Exhibit B to the captioned Unit Agreement. These revisions are submitted pursuant to Article 2 of the Unit Agreement. Said unit area contracted pursuant to the terms of Article 2(e) to a single participating area effective March 27, 1981. The enclosed Exhibits A and B reflect that contraction.

Very truly yours,



Joe Pope
Land-Unitization
(915) 683-0467

JP:eg

enc.

cc: Working Interest Owners
(see attached)

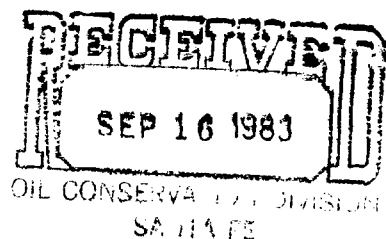

WORKING INTEREST OWNERS

Amoco Production Company
P. O. Box 591
Tulsa, Oklahoma 74102

Attn: Joint Interest Group

First City National Bank of Midland
for the Account of Thomas Edward Moore
P. O. Box 2097
Midland, Texas 79702

Sabine Production Company
Suite 210 Paragon Towner
Midland, Texas 79702

Attention: David A. Fuller

Getty Oil Company
P. O. Box 1231
Midland, Texas 79702

Apache Corporation
1500 City West Boulevard
P. O. Box 4628
Houston, Texas 77210

Phillips Petroleum Company
Exploration & Production
Department, Room 421
Frank Phillips Building
Bartlesville, Oklahoma 74004

Attn: R. E. Hoobler

Wayne A. Piette
2309 Stanolind
Midland, Texas 79701

LAGUNA GRANDE UNIT AREA

EDDY COUNTY, NEW MEXICO

E/2 Section 29

T-23S, R-29-E

EXHIBIT A

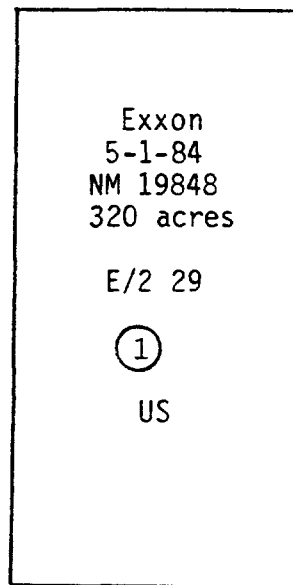

USA 320 acre 

Unit Area 320 acres

Tract ①

SCALE: 3 inches = 1 mile

Revised September 12, 1983
Effective March 27, 1981

Federal Lease Number

N. M. 19848 320 acres

EXHIBIT "B" - LAGUNA GRANDE UNIT AREA - EDDY COUNTY, NEW MEXICO

Tract No.	Description of Land	No. of Acres	Lease No. & Expiration Date	Basic Royalty & Percentage	Lessee of Record & Interest	Overriding Royalty or Production Payments
1	Sec 29: E/2	320	N. M. 19848 5-1-84	USA - 12.5%	Exxon - 100%	Tim Daly and Nancy T. Daly - 3.125%
						Tommy Phipps, et al Trustees Margene Blakemore Trust 4.375%

Total: 1 Tract of Federal Land - 320 acres, 100% of Unit Area

This Federal Unit has contracted to one 320 acre tract according to the terms of the Unit Operating Agreement.

EXXON COMPANY, U.S.A.
POST OFFICE BOX 1600 • MIDLAND, TEXAS 79702

EXPLORATION DEPARTMENT
SOUTHWESTERN DIVISION

August 27, 1981

5579

Re: Application for Approval of
Second Participating Area
Laguna Grande Unit
Effective December 1, 1975
N.M. State Land Office-Certificate
November 18, 1975
U.S.G.S. Certification-
Determination December 1, 1975
Contract No. 12 08 0001 14272
All of Section 29;
N/2 NW/4, NE/4, E/2 SW/4 Section 32
T-23-S, R-29-E, containing 960 acres
more or less
EDDY COUNTY, NEW MEXICO

Area Oil and Gas Supervisor
Geological Survey
Drawer 1857
Roswell, New Mexico 88201

Commissioner of Public Lands U. S.
New Mexico State Land Office
Post Office Box 1148
Santa Fe, New Mexico 87501

Gentlemen:

Exxon Corporation, as Unit Operator under the Laguna Grande Unit Agreement, and pursuant to the provisions of Section 11 thereof, respectfully submits for your approval the selection of the following described lands to constitute the Second Participating Area for this unit and the First for the Atoka producing zone or formation, to-wit:

All of Section 29, and the N/2 NW/4, NE/4, E/2 SW/4 Section 32, in Township 23 South, Range 29 East, containing 960 acres, more or less, Eddy County, New Mexico.

The Working Interest Owners are being advised of the above described Second Participating Area. No objections or comments have been received as of this date.

In support of this Application, the following numbered items are attached and made a part hereof:

1. Ownership map showing the boundaries of the Unit Area and the Initial and proposed Second Participating Area.
2. A schedule showing the lands entitled to participation in unitized substances produced from the Atoka formation, with the percentage of participation of each lease or tract indicated thereon.
3. Geologic Summary stating facts and information obtained or resulting from the drilling of Laguna Grande Unit Well No. 3.

Laguna Grande
August 27, 1981
Page 2

4. Geologic Map of the Laguna Grande Unit Area and immediate vicinity.

Laguna Grande Unit Well No. 3 located in the SE/4 Section 29, T-23-S, R-29-E, was completed on January 16, 1981. As specified in Section 11 of the Unit Agreement, the effective date of this Second Participating Area should be January 16, 1981.

Applicant respectfully requests your approval of the Initial Atoka Formation Participating Area (the First Participating Area was a Morrow Formation), as hereinabove described, effective as of January 16, 1981.

Sincerely,

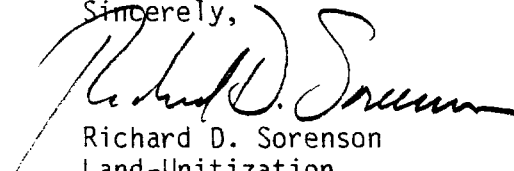

Richard D. Sorenson
Land-Unitization
Telephone (915) 683-0326

RDS:elf

xc J. D. Gilley, Exxon Building w/eclosures
All Working Interest Owners (see attached listing) w/copy of Items 1., 2., &
3.

WORKING INTEREST OWNERS

LAGUNA GRANDE UNIT

T-23-S, R-29-E

EDDY COUNTY, NEW MEXICO

Amoco Production Company
Attention: Joint Interest Group
Post Office Box 591
Tulsa, Oklahoma 74102

Thomas Edward Moore
Post Office Box 2156
Midland, Texas 79702

Sabine Production Company
1200 Mercantile Bank Building
Dallas, Texas 75201

Dow Chemical Company
Attention: Mark S. Martin
1123 Wilco Building
Midland, Texas 79702

Phillips Petroleum Company
Exploration & Production Department
Attention: R. E. Hoobler
Room 421 Frank Phillips Building
Bartlesville, Oklahoma 74004

Getty Oil Company
Attention: Tom I. Fraser, Jr.
Post Office Box 1231
Midland, Texas 79702

Wayne A. Piette
2309 Stanolind
Midland, Texas 79701

LAGUNA GRANDE UNIT AREA

EDDY COUNTY, NEW MEXICO

T 23 S - R 29 E

ATOKA FORMATION PARTICIPATING AREA

EXHIBIT A

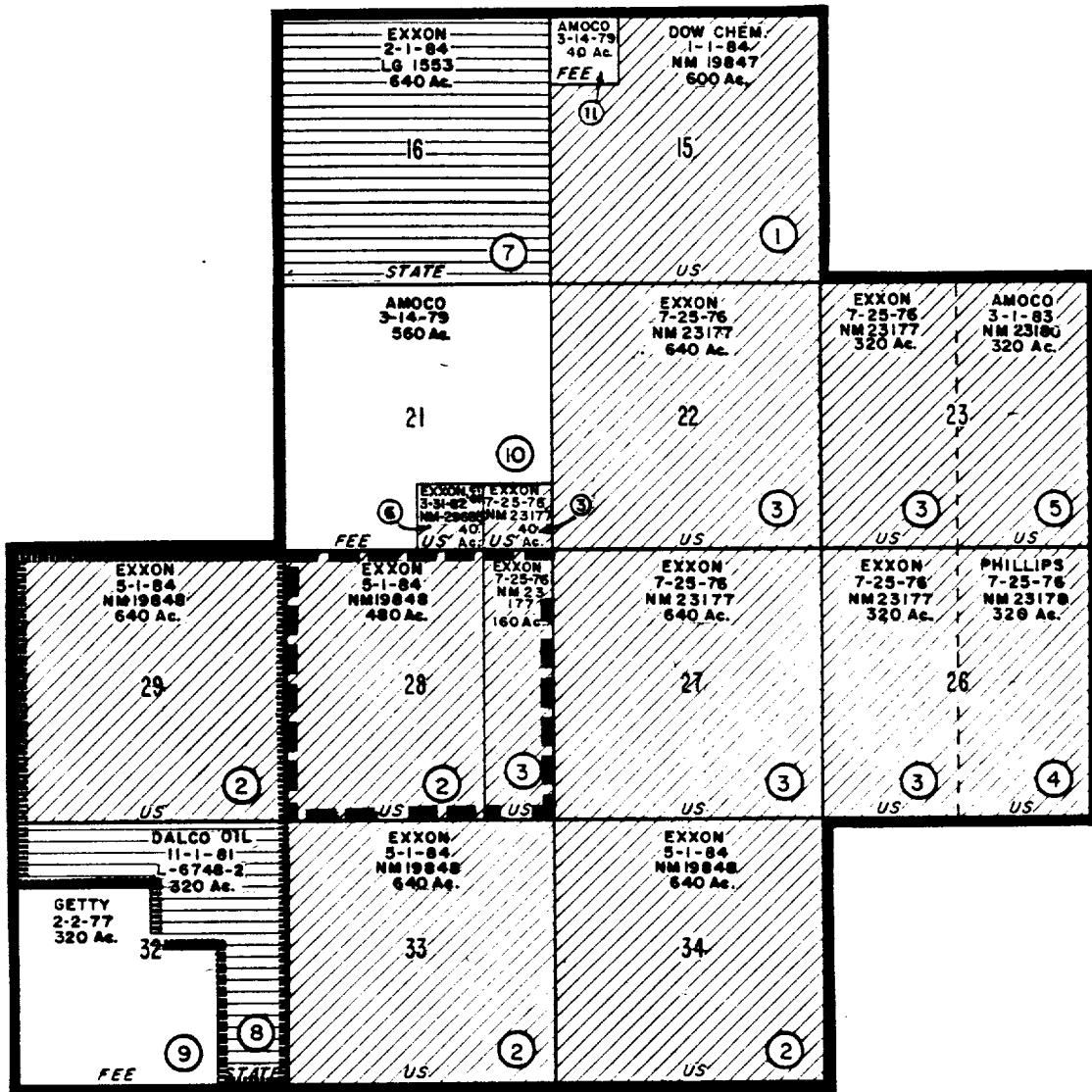

USA	5800	ACRES
STATE	960	ACRES
FEE	920	ACRES
UNIT AREA	7680	ACRES



TRACT ⑧ ————— UNIT AREA BOUNDARY

----- PARTICIPATING AREA FOR THE MORROW FORMATION (PARTICIPATING AREA #1)

----- PROPOSED NEW PARTICIPATING AREA FOR THE ATOKA FORMATION

LAGUNA GRANDE UNIT NO. 3 WELL
Eddy County, New Mexico

The Laguna Grande Unit No. 3 Well was completed January 16, 1981 for a CAOF of 1,995 MCF/GPD from sands in the Pennsylvanian (Atoka) from a depth interval of 12,104' to 12,116 feet with a maximum flow rate of 1198 MCF/GPD of gas. There were 11 feet of porous Atoka sand in this well.

The well was drilled to a depth of 13,500' on December 30, 1980. This depth was sufficient enough to drill through the Morrow sands. There were 36' of sand encountered, however log analysis showed the sands were tight and a decision to plug back to the Atoka was made.

The accompanying geologic maps depict the correlation and area of clean sand development within the Atoka and structural configuration on top of the Atoka. The gas accumulation is thought to be due to updip pinchout of several sand lenses and therefore, is stratigraphic in nature. Log analysis shows an average porosity of 12% in the Atoka sand.

LAW/sjs

ECONOMIC ANALYSIS
FOR
EXXON NO. 3 LAGUNA GRANDE FEDERAL UNIT WELL

- I. RESERVE CALCULATION
- II. FOUR POINT TEST
- III. BOTTOM HOLE PRESSURE CHART
- IV. ECONOMICS

RESERVE CALCULATION

I. Basic data for calculating by decline curve method.

- A. Current Rate = 650 MCFG/D
- B. Final Rate = 10 MCFG/D
- C. Decline Rate = 30%/Year
- D. Cumulative Production = 102.53 MMCFG (to 8/1/81)

II. Reserves

$$N = 102,530 + \frac{(10-650)365}{\ln(1-.30)} = 757.5 \text{ MMCFG}$$

III. Well Life

Estimated at 12 Yrs

IV. Producing Rate

.650 MMCFG/D for 1st year declining to .010 MMCFG/D in 12th year

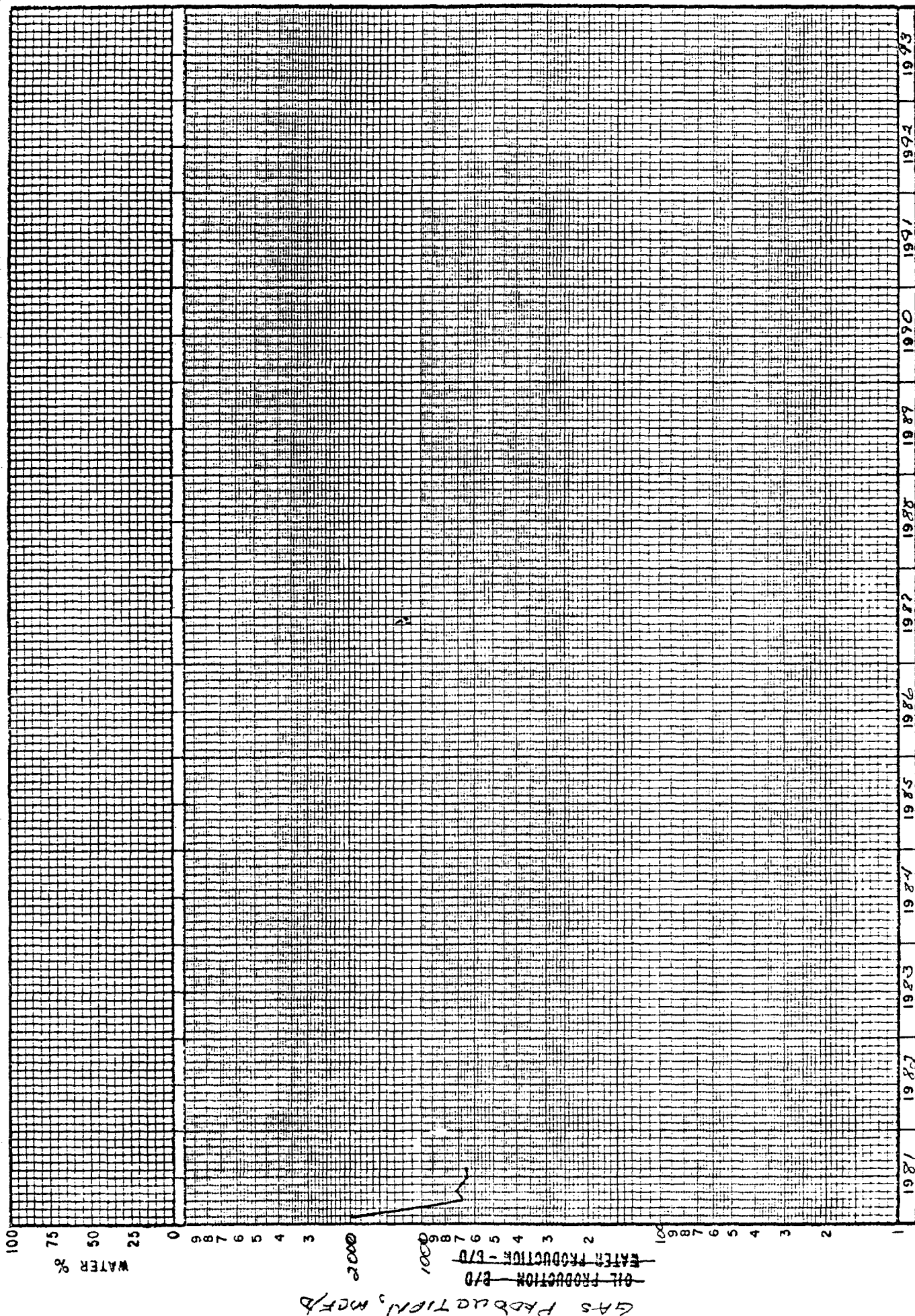

FIELD 55. CARLSBAD

LEASE LAGUNA GRANDE

WELL 53

well
file

MULTIPOINT AND ONE POINT BACK PRESSURE TEST FOR GAS WELL

Type Test <input checked="" type="checkbox"/> Initial <input type="checkbox"/> Annual <input type="checkbox"/> Special				Test Date 1-20-81	
Company Exxon Company USA				Connection None	
Pool LaGuna Grande				Formation Atoka	
Completion Date 1-15-81		Total Depth 13690'		Plug Back TD 12600'	
				Elevation 3013' GL	
Csg. Size 5 1/2"		Wt. 20.8		Set At 12725'	
Perforations: From 12104' To 12116'				Well No. 3	
Thg. Size 2 7/8"		Wt. 6.5		Set At 11900'	
Perforations: Open Ended				Unit G	
				Sec. 29	
				Twp. 23s	
				Hgt. 29e	
Type Well - Single - Brdenhead - G.G. or G.O. Multiple Single				Packer Set At 11900'	
Producing Thru Tubing				County Eddy	
Reservoir Temp. °F 60		Mean Annual Temp. °F 60		Baro. Press. - P _a 13.2	
State New Mexico					
L 12110		H -		Cg 0.5758	
% CO ₂ 0.426		% N ₂ 0.917		% H ₂ S -	
Prover 3.826		Meter Run F			

FLOW DATA						TUBING DATA		CASING DATA		Duration of Flow	
NO.	Prover Line Size	X	Orifice Size	Press. p.s.i.g.	Diff. h _w	Temp. °F	Press. p.s.i.g. DWT	Temp. °F	Press. p.s.i.g.		Temp. °F
SI							6785				57.0 hrs
1.	3.826	2/64	1.000	490	15	93	6115	58	Packer		1.0 hr
2.	3.826	3/64	1.000	500	26	88	5717	62			1.0 hr
3.	3.826	4/64	1.000	500	42	84	5305	62			1.0 hr
4.	3.826	5.5/64	1.000	510	68	82	4700	62			1.0 hr
5.											

RATE OF FLOW CALCULATIONS							
NO.	Coefficient (24 Hour)	$\sqrt{h_w P_m}$	Pressure P _m	Flow Temp. Factor F _t	Gravity Factor F _g	Super Compress. Factor, F _{sp}	Rate of Flow Q, Mcf/D
1	4.758	86.88	503.2	0.9697	1.318	1.029	543.64
2	4.758	115.51	513.2	0.9741	1.318	1.031	727.48
3	4.758	146.81	513.2	0.9777	1.318	1.032	928.93
4	4.758	188.62	523.2	0.9795	1.318	1.034	1197.99
5							

NO.	F _t	Temp. °R	T _f	Z	Gas Liquid Hydrocarbon Ratio	Dry Gas	Mcft/bbl.
1	0.75	553	1.62	0.945	A.P.I. Gravity of Liquid Hydrocarbons	-	Deg.
2	0.76	548	1.60	0.941	Specific Gravity Separator Gas	0.5758	XXXXXX
3	0.76	544	1.59	0.939	Specific Gravity Flowing Fluid	XXXXXX	
4	0.78	542	1.58	0.936	Critical Pressure	675	P.S.I.A.
5					Critical Temperature	342	R

NO.	P _c	P _c ²	P _w	P _w ²	P _c ² - P _w ²
1	8187.2	67030.2	7589.2	57596.0	9434.2
2			7194.2	51756.5	15273.7
3			6760.2	45700.3	21329.9
4			6027.2	36327.1	30703.1
5					

(1) $\frac{P_c^2}{P_c^2 - P_w^2} = 7.105$

(2) $\left[\frac{P_c^2}{P_c^2 - P_w^2} \right]^n = 3.669$

AOF = Q $\left[\frac{P_c^2}{P_c^2 - P_w^2} \right]^n = 1995$

Absolute Open Flow 1995

Mold @ 15.025

Angle of Slope @ 56° 28'

Slope, n 0.663

Remarks: * BOTTOM HOLE PRESSURE (-9097) 12110' USED FOR PRESSURE CALCULATIONS

Approved By Division	Conducted By: JARREL SERVICES, INC.	Calculated By: Joe A. Coleman	Checked By: PE# 2208 Joe A. Coleman
----------------------	--	----------------------------------	--

JARREL SERVICES, INC.

POST OFFICE BOX 1654

PHONE 505 393-5396

HOBBS, NEW MEXICO 88240

COMPANY: Exxon Company USA

WELL: LaGuna Grande, No. 3

FIELD: LaGuna Grande Atoka

CHRONOLOGICAL PRESSURE DATA

DATE	STATUS OF WELL	TIME	ELASPED TIME		SURFACE PRESSURE		BHP @ (-9097)	
			HRS.	MIN.	TBG	CSG	11931'	12110'PS
1981								
1/17	Flowing. Run Tandem Bombs & set Bombs off @ 11931'	11:30 AM	-	-	3875 DWT	PKR	5058	5076
	Shut in	1:00 PM	1	30	3882	1149.93	5058	5076
	"	1:15	0	15	-	-	5833	5854
	"	1:30	0	30	-	-	6115	6136
	"	2:00	1	00	-	-	6548	6569
	"	3:00	2	00	-	-	6803	6824
	"	4:00	3	00	-	-	6981	7002
	"	5:00	4	00	-	-	7083	7104
	"	6:00	5	00	-	-	7166	7187
	"	7:00	6	00	-	-	7210	7231
	"	8:00	7	00	-	-	7261	7282
	"	9:00	8	00	-	-	7293	7314
	"	10:00	9	00	-	-	7312	7333
	"	11:00	10	00	-	-	7344	7365
	"	12:00 MN	11	00	-	-	7389	7410
1/18	"	1:00 AM	12	00	-	-	7420	7441
	"	2:00	13	00	-	-	7459	7480
	"	3:00	14	00	-	-	7478	7499
	"	4:00	15	00	-	-	7503	7524
	"	5:00	16	00	-	-	7522	7543
	"	6:00	17	00	-	-	7554	7575
	"	7:00	18	00	-	-	7573	7594
	"	8:00	19	00	-	-	7605	7626
	"	9:00	20	00	-	-	7618	7639
	"	10:00	21	00	-	-	7643	7664
	"	11:00	22	00	-	-	7662	7683
	"	12:00 N	23	00	-	-	7682	7703
	"	1:00 PM	24	00	-	-	7701	7722
	"	2:00	25	00	-	-	7720	7741
	"	3:00	26	00	-	-	7739	7760
	"	4:00	27	00	-	-	7752	7773
	"	5:00	28	00	-	-	7771	7792
	"	6:00	29	00	-	-	7777	7798
	"	7:00	30	00	-	-	7796	7817
	"	8:00	31	00	-	-	7809	7830
	"	9:00	32	00	-	-	7828	7849
	"	10:00	33	00	-	-	7841	7862
	"	11:00	34	00	-	-	7854	7875
	"	12:00 MN	35	00	-	-	7873	7894
1/19	"	1:00 AM	36	00	-	-	7879	7900
	"	2:00	37	00	-	-	7892	7913
	"	3:00	38	00	-	-	7904	7925
	"	4:00	39	00	-	-	7911	7932

WELL: LaGuna Grande, No. 3PAGE: 2

DATE	STATUS OF WELL	TIME	ELAPSED TIME		SURFACE PRESSURE		BHP @ (-9097)	
			HRS.	MIN.	TBG	CSG	11951'	12110' P.
	Shut in	5:00	40	00	-	-	7924	7945
	"	6:00	41	00	-	-	7943	7964
	"	7:00	42	00	-	-	7955	7976
	"	8:00	43	00	-	-	7962	7985
	"	9:00	44	00	-	-	7975	7996
	"	10:00	45	00	-	-	7987	8008
	"	11:00	46	00	-	-	7994	8015
	"	12:00 N	47	00	-	-	8006	8027
	"	1:00 PM	48	00	-	-	8019	8040
	"	2:00	49	00	-	-	8025	8046
	"	3:00	50	00	-	-	8032	8053
	"	4:00	51	00	-	-	8038	8059
	"	5:00	52	00	-	-	8051	8072
	"	6:00	53	00	-	-	8057	8078
	"	7:00	54	00	-	-	8064	8085
	"	8:00	55	00	-	-	8070	8091
	"	9:00	56	00	-	-	8083	8104
	"	10:00	57	00	-	-	8089	8110
	"	11:00	58	00	-	-	8096	8117
	"	12:00	59	00	-	-	8102	8123
1/20	"	1:00 AM	60	00	-	-	8108	8129
	"	2:00	61	00	-	-	8115	8136
	"	3:00	62	00	-	-	8121	8142
	"	4:00	63	00	-	-	8127	8148
	"	5:00	64	00	-	-	8134	8155
	"	6:00	65	00	-	-	8140	8161
	"	7:00	66	00	-	-	8146	8167
	Opened Well	8:00	67	00	6785	MCF/D	8152	8174 LA
	Started 1st Rate	8:45	0	45	6217		8057	8085
	Finished 1st Rate	9:45	1	00	6115	543.64	7554	7576
	& Started 2nd Rate							
	Finished 2nd Rate	10:45	1	00	5717	727.48	7159	7181
	& Started 3rd Rate							
	Finished 3rd Rate	11:45	1	00	5305	928.93	6726	6747
	& Started 4th Rate							
	Finished 4th Rate	12:45 PM	1	00	4700	1197.99	5994	6014
	Fished Bombs &	1:45	1	00	4620	-	5917	5937
	Run Flowing Gradient							

DIETZEN CORPORATION
MADE IN U.S.A.

NO 340R-1310 DIETZEN GRAPH PAPER
SEMI LOGARITHMIC
3 CYCLES X 10 DIVISIONS PER INCH

JARREL SERVICES, INC.

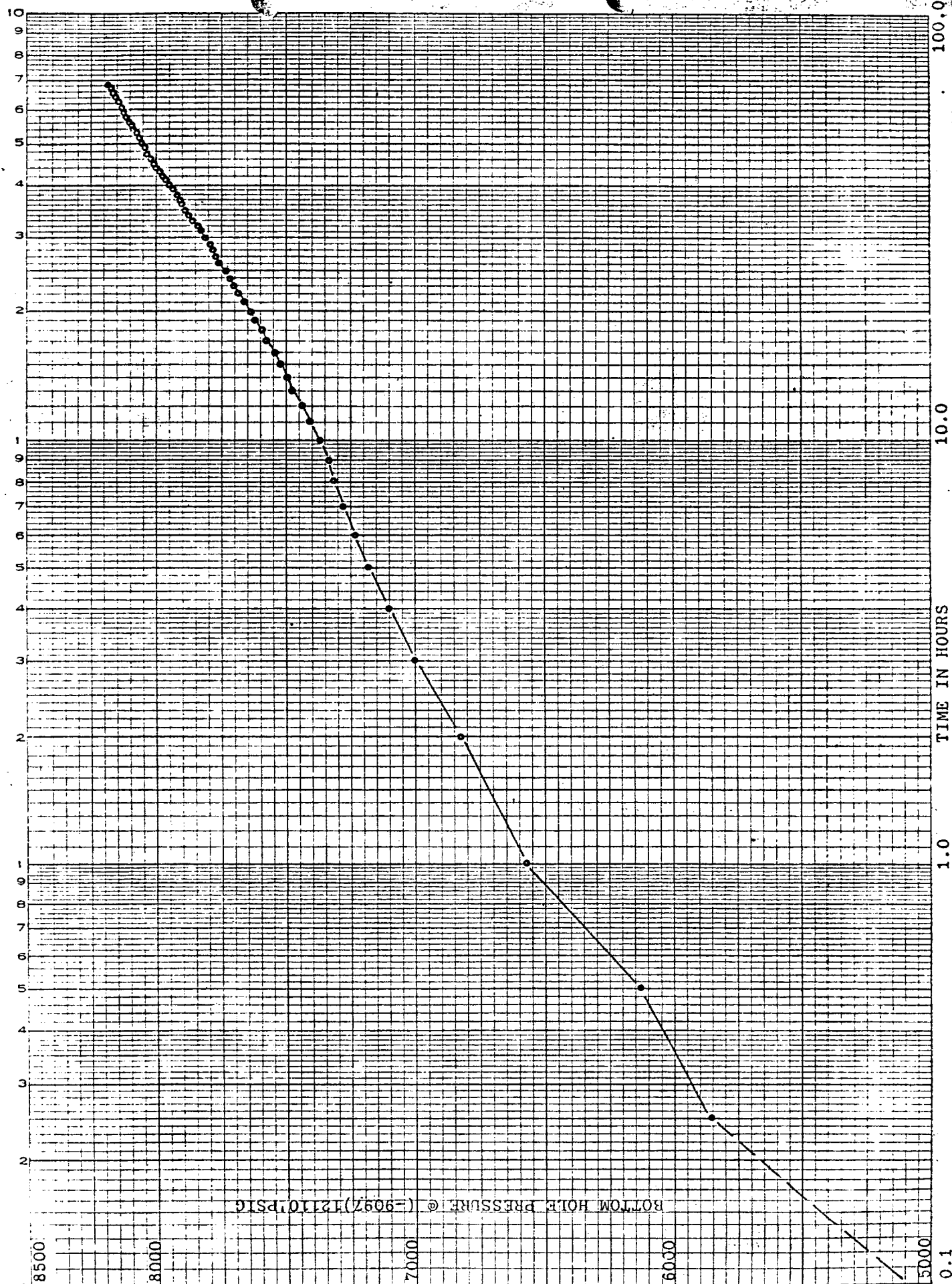

JARREL SERVICES, INC.

POST OFFICE BOX 1654

PHONES 505 393-5396 — 393-8274

HOBBS, NEW MEXICO 88240

BOTTOM HOLE PRESSURE RECORD

OPERATOR Exxon Company USA
 FIELD LaGuna Grande
 FORMATION Atoka
 LEASE LaGuna Grande WELL # 3
 COUNTY Eddy STATE New Mexico
 DATE 1-20-81 TIME 1:45 PM
 Status Flowing
 Test Depth 11931'
 Time S. I. - Last test date -
 Tub Pres. 4620 DWT BHP last test -
 Cas. Pres. PKR BHP change -
 Elev. 3013' GL Fluid top Flowing
 Datum (-9097) ** Water top -
 Temp. @ - Run by JSI #21
 Cal. No. A18478N Chart No. 1

Depth	Pressure	Gradient
0	4620	-
3000	4958	.115
5000	5168	.105
7000	5382	.107
9000	5598	.108
11000	5816	.109
11500	5870	.108
11931	5917	.109
12110 (-9097)	5937 * **	(.109)

* EXTRAPOLATED PRESSURE

** MIDPOINT OF CASING PERFORATIONS

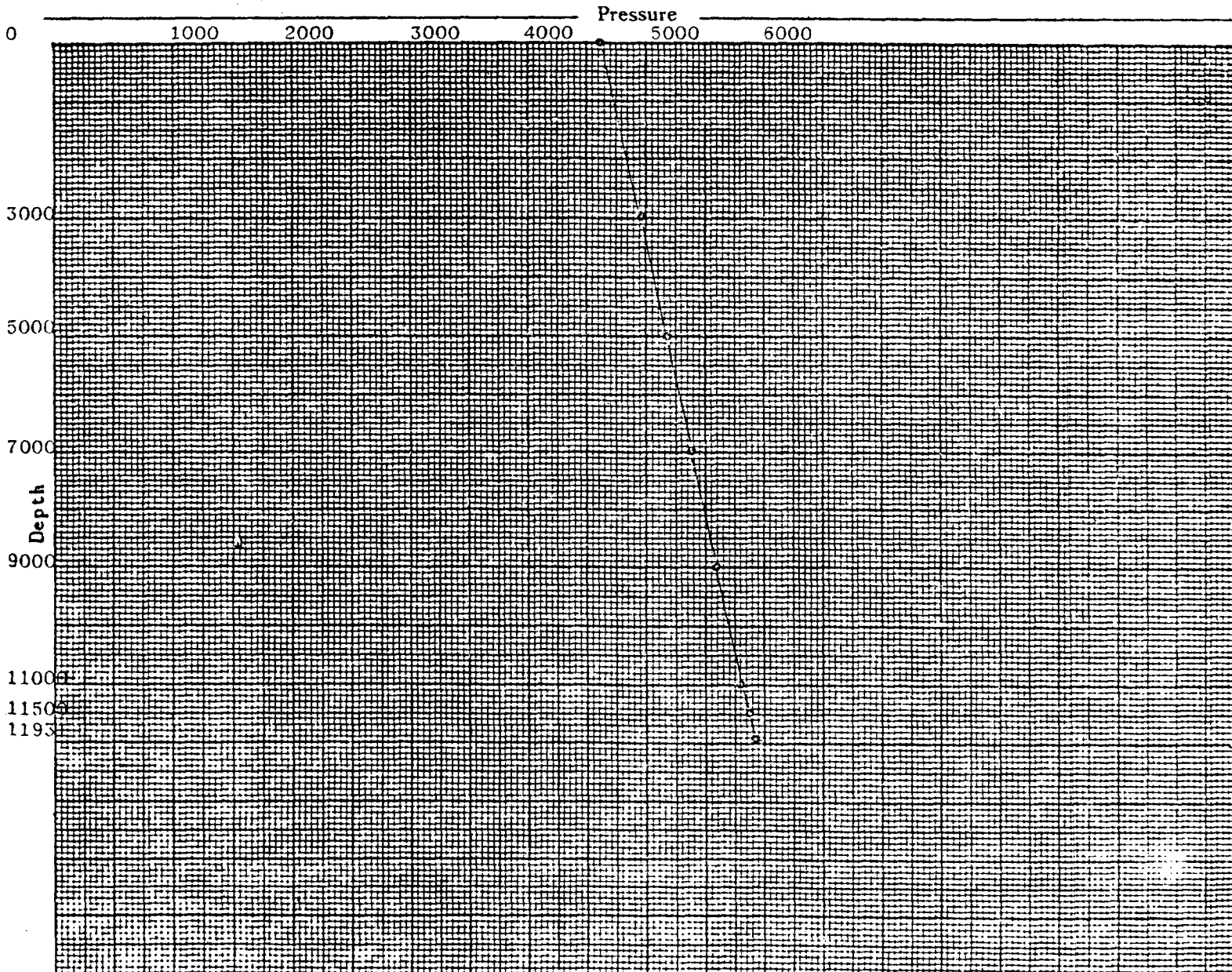

ECONOMICS FOR EXXON NO. 3 LAGUNA GRANDE FEDERAL UNIT WELL

RESERVES .757 BCF
GAS PRICE \$2.87/MCF ESCALATED 12% PER YEAR

Years	Well EUR MMCFG	Net Interest (Less Royalty & Override)	Net Production MMCFG	Avg. Gas Price \$	Net Income M\$	Operating Expense M\$	Drilling Cost M\$	Federal Income Tax M\$	Undiscounted Net Income M\$	Well Payout Years
1981-1992	757	.875	663	5.97	2890.0	36.0	1708.0	346.5	451.2	4.69

State of New Mexico

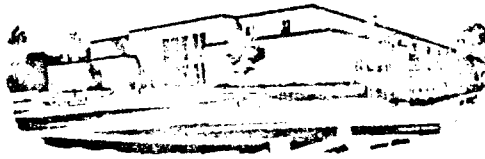

Commissioner of Public Lands

May 28, 1980

ALEX J. ARMIJO
COMMISSIONER

P. O. BOX 1148
SANTA FE, NEW MEXICO 87501

Exxon Company
P. O. Box 1600
Midland, Texas 79702

Re: AMENDED PLAN OF DEVELOPMENT & OPERATION
Laguna Grande Unit-Effective 12-1-75
Eddy County, New Mexico

ATTENTION: Mr. W. H. Hall

Gentlemen:

The Commissioner of Public Lands has this date approved your Amended Plan of Development for the Laguna Grande Unit, Eddy County, New Mexico. Such plan was received in this office May 19, 1980. The plan calls for the reworking of the No. 1 and the drilling of a Morrow well in the NE/4 of Section 29, Township 23 South, Range 29 East, Eddy County, New Mexico. Our approval is subject to like approval by the United States Geological Survey and the New Mexico Oil Conservation Division.

Enclosed is one approved copy for your files. In the future please submit Three (3) copies of the plan to this office.

Please remit a Three (\$3.00) Dollar filing fee.

Very truly yours,

ALEX J. ARMIJO
COMMISSIONER OF PUBLIC LANDS

BY:
RAY D. GRAHAM, Director
Oil and Gas Division
AC 505-827-2748

AJA/RDG/s
encls.
cc:

OCD-Santa Fe, New Mexico ✓
USGS-Roswell, New Mexico
USGS-Albuquerque, New Mexico

EXXON COMPANY, U.S.A.

POST OFFICE BOX 1600 • MIDLAND, TEXAS 79702 • (915) 684-4400



May 2, 1980

5579

Re: PLAN OF DEVELOPMENT & OPERATION
Laguna Grande Unit - Effective 12-1-75
N.M. State Land Office Cert. - 11-18-75
U.S.G.S. Certification-Determination-
12-1-75
Contract No. 12-08-0001-14272
T-23-S, R-29-E
Eddy County, New Mexico

Area Oil and Gas Supervisor
U. S. Geological Survey
Suite 815, Western Building
505 Marquette, N.W.
Albuquerque, NM 87102

Commissioner of Public Lands
New Mexico State Land Office
P. O. Box 1148
Santa Fe, NM 87501

Attention: Mr. Ray D. Graham

Attention: Mr. Jack Willock

Gentlemen:

The above captioned Unit became effective December 1, 1975. Since that date two (2) wells have been drilled under the terms of said Agreement. These wells are:

1. Laguna Grande Unit Well No. 1, located in the NE/4 SE/4 Section 28, T-23-S, R-29-E, Eddy County, New Mexico, was completed in the Morrow interval from 13,107' to 13,258' for a CAOF of 4.1 MMCF gas on April 21, 1976. It produced a total of 197,727 MCF gas during the period March 28, 1977, to August 3, 1978, at which time the well ceased to produce. Further evaluation indicates remedial work in the Morrow would not be economic. During the drilling of the well, tests made indicated possible commercial gas production from the Strawn formation. A drillstem test of the Strawn interval from 11,880' to 11,922' flowed 1.25 MMCF gas on one-half (1/2) inch choke.
2. Laguna Grande Unit Well No. 2 located in the SE/4 SW/4 Section 27, T-23-S, R-29-E, Eddy County, New Mexico, was drilled to a total depth of 13,806' and completed as a dry hole on December 31, 1977.
3. During 1979 the Laguna Grande Unit Well No. 1 was recompleted. A plug back and workover from the original Morrow perforations to a Strawn interval at 11,888-11,900' was completed in May, 1979. The Strawn completion produced 11,514 MCF gas and was shut-in December 9, 1979.

It is the purpose of this letter to formally submit for your approval a Plan of Development and Operation for the year 1980. This Plan is being submitted pursuant to the provisions of Article 10, Unit Agreement, Laguna Grande Unit. The Working Interest Owners in the Unit have approved this plan.

U. S. Geological Survey
N.M. Commissioner of Public Lands
May 2, 1980
Page Two

1. During the calendar year 1980, the Unit plans to abandon the current Strawn completion in Unit Well No. 1 and attempt a completion in the Morrow limestone which has not been production tested. An unsuccessful completion in the Morrow limestone would be followed by a completion attempt in the Atoka interval.
2. A 13,500' Morrow Formation Test is planned for drilling at a location 1980' FNL and 1980' FEL of Section 29, T-23-S, R-29-E, Eddy County, New Mexico.
3. The availability of drillable locations on the Unit Area is restricted due to potash rights and the boundaries of the Salt Lake which occupies portions of Sections 15, 16, 21 and 22, T-23-S, R-29-E, Eddy County, New Mexico. These restrictive elements must be considered and dealt with as geologically satisfactory locations are determined.
4. Operating practices for the proper conservation of natural resources will be observed.

Exxon, as Operator of this Unit, respectfully requests your approval of this Plan of Development and Operation.

Yours very truly,

W. H. Hall
LAND-UNITIZATION
Telephone (915) 683-0423

WHH:lpj

cc: New Mexico Oil Conservation Division 
P. O. Box 2088
Santa Fe, NM 87501

Working Interest Owners (See Attached Listing)

WORKING INTEREST OWNERS
LAGUNA GRANDE UNIT

Amoco Production Company
P. O. Box 3092
Houston, TX 77001

Dow Chemical Company
1123 Wilco Building
Midland, TX 79701

Sabine Production Company
Suite 901, Wall Towers East
Midland, TX 79701

Hayes Oil Company
1312 Midland Savings Building
Midland, TX 79701

Phillips Petroleum Company
4001 Penbrook
Odessa, TX 79762

Getty Oil Company
P. O. Box 1231
Midland, TX 79702

EXXON COMPANY, U.S.A.

POST OFFICE BOX 1600 • MIDLAND, TEXAS 79702 • (915) 684-4411

March 5, 1980

Re: PLAN OF DEVELOPMENT & OPERATION
Laguna Grande Unit - Effective
12-1-75
N.M. State Land Office Cert.-
11-18-75
U.S.G.S. Certification-Determination-
12-1-75
Contract No. 12-08-0001-14272
T-23-S, R-29-E
Eddy County, New Mexico

5577
Area Oil and Gas Supervisor
U. S. Geological Survey
P. O. Drawer 1857
Roswell, NM 88201

Commissioner of Public Lands
New Mexico State Land Office
P. O. Box 1148
Santa Fe, NM 87501

Gentlemen:

The above captioned Unit became effective December 1, 1975. Since that date two (2) wells have been drilled under the terms of said Agreement. These wells are:

1. Laguna Grande Unit Well No. 1, located in the NE/4 SE/4 Section 28, T-23-S, R-29-E, Eddy County, New Mexico, was completed in the Morrow interval from 13,107' to 13,258' for a CAOF of 4.1 MMCF gas on April 21, 1976. It produced a total of 197,727 MCF gas during the period March 28, 1977, to August 3, 1978, at which time the well ceased to produce. Further evaluation indicates remedial work in the Morrow would not be economic. During the drilling of the well, tests made indicated possible commercial gas production from the Strawn formation. A drillstem test of the Strawn interval from 11,880' to 11,922' flowed 1.25 MMCF gas on one-half (1/2) inch choke.
2. Laguna Grande Unit Well No. 2 located in the SE/4 SW/4 Section 27, T-23-S, R-29-E, Eddy County, New Mexico, was drilled to a total depth of 13,806' and completed as a dry hole on December 31, 1977.
3. During 1979 the Laguna Grande Unit Well No. 1 was recompleted. A plug back and workover from the original Morrow perforations to a Strawn interval at 11,888-11,900' was completed in May 1979. The Strawn completion produced 11,514 MCF gas and was shut in December 9, 1979.

It is the purpose of this letter to formally submit for your approval a Plan of Development and Operation for the year 1980. This Plan is being submitted pursuant to the provisions of Article 10, Unit Agreement, Laguna Grande Unit. The Working Interest Owners in the Unit have approved this plan.

U. S. Geological Survey
Commissioner of Public Lands
Page Two
March 5, 1980

1. During the calendar year 1980, the Unit plans to abandon the current Strawn completion in Unit Well No. 1 and attempt a completion in the Morrow limestone which has not been production tested. An unsuccessful completion in the Morrow limestone would be followed by a completion attempt in the Atoka interval.
2. We will continue geologic evaluation of the Unit Area and strive to define economic justification for further drilling within the unit.
3. The availability of drillable locations on the Unit Area is restricted due to potash rights and the boundaries of the Salt Lake which occupies portions of Sections 15, 16, 21 and 22, T-23-S, R-29-E, Eddy County, New Mexico. These restrictive elements will have to be considered and dealt with when a geologically satisfactory location has been determined.
4. Operating practices for the proper conservation of natural resources will be observed.

Exxon, as Operator of this Unit, respectfully requests your approval of this Plan of Development and Operation.

Yours very truly,

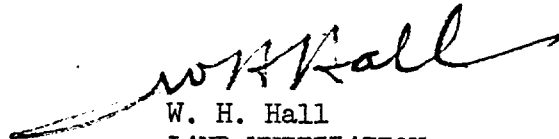

W. H. Hall

LAND-UNITIZATION

Telephone (915)683-0423

WHH/ld

cc: New Mexico Oil Conservation Commission
P. O. Box 2088
Santa Fe, New Mexico 87501

Working Interest Owners (See Attached Listing)

WORKING INTEREST OWNERS
LAGUNA GRANDE UNIT

Amoco Production Company
P. O. Box 3092
Houston, TX 77001

Dow Chemical Company
1123 Wilco Building
Midland, TX 79701

Sabine Production Company
P. O. Box 3083
Midland, TX 79702

Hayes Oil Company
1312 Midland Savings Building
Midland, TX 79701

Phillips Petroleum Company
4001 Penbrook
Odessa, TX 79762

Getty Oil Company
P. O. Box 1351
Midland, TX 79702

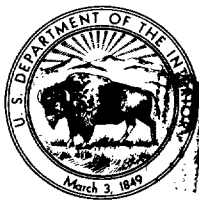

RECEIVED

MAR 16 1979

**OIL CONSERVATION DIVISION
SANTA FE**

GEOLOGICAL SURVEY

P. O. Box 26124

Albuquerque, New Mexico 87125

Exxon Company, U.S.A.
Attention: Mr. Marvin L. Wigley
P. O. Box 1600
Midland, Texas 79702

no. 5579

Gentlemen:

The 1979 plan of development submitted for the Laguna Grande unit area, Eddy County, New Mexico, was approved on this date subject to like approval by the appropriate State officials.

Such plan proposes to plug back Unit Well No. 1 from the Morrow and recomplete in the Strawn while conducting evaluations of the wells drilling and completing immediately north and west of the unit area.

One approved copy is enclosed.

Sincerely yours,

Oil and Gas Supervisor, SRMA

Enclosure

cc:
NMOCD, Santa Fe (ltr. only) ← This Copy for
Com. Pub. Lands, Santa Fe (ltr. only)



ALEX J. ARMIJO
COMMISSIONER

State of New Mexico

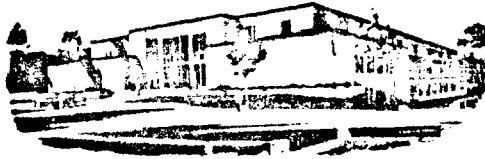

Commissioner of Public Lands

March 2, 1979

RECEIVED
MAR 2 1979
Oil Conservation

P. O. Box 1148
SANTA FE, NEW MEXICO

Exxon Company, USA
P. O. Box 1600
Midland, Texas 79701

55 79

Re: Laguna Grande Unit
Eddy County, New Mexico
1979 PLAN OF DEVELOPMENT AND
OPERATION

ATTENTION: Mr. Marvin L. Wigley

Gentlemen:

The Commissioner of Public Lands has this date approved your 1979 Plan of Development and Operation for the Laguna Grande Unit, Eddy County, New Mexico. During the calendar year 1979, your plans are to plug back the Laguna Grande Unit Well No. 1 from the Morrow and attempt a gas completion in the Strawn interval which tested gas, also, will continue geologic evaluation of the Unit area.

This approval is subject to like approval by the United States Geological Survey and the New Mexico Oil Conservation Division.

Enclosed is one approved copy for your files. In the future please submit three (3) copies to this office of your Plan of Development.

Please remit a Three (\$3.00) Dollar filing fee.

Very truly yours,

ALEX J. ARMIJO
COMMISSIONER OF PUBLIC LANDS

BY:
RAY D. GRAHAM, Director
Oil and Gas Division

AJA/RDG/s
encls.
cc:

OCD-Santa Fe, New Mexico
USGS-Roswell, New Mexico
USGS-Albuquerque, New Mexico

OIL CONSERVATION DIVISION

P. O. BOX 2088

SANTA FE, NEW MEXICO 87501

March 5, 1979

Exxon Company, U.S.A.
Post Office Box 1600
Midland, Texas 79702

Attention: Marvin L. Wigley

Re: Case No. 5579
Laguna Grande Unit
1979 Plan of Development
and Operation

Gentlemen:

We hereby approve the 1979 Plan of Development and Operation for the Laguna Grande Unit, Eddy County, New Mexico, subject to like approval by the United States Geological Survey and the Commissioner of Public Lands.

One approved copy of the Plan is returned herewith.

Yours very truly,

JOE D. RAMEY
Director

JDR/LT/fd
enc.

cc: U.S.G.S. - Roswell
Commissioner of Public Lands

C
O
P
Y

EXXON COMPANY, U.S.A.

POST OFFICE BOX 1600 • MIDLAND, TEXAS 79702 • (915) 684-4411

*Approved
no. 5579*



February 26, 1979

Re: PLAN OF DEVELOPMENT & OPERATION
Laguna Grande Unit - Effective
12-1-75
N.M. State Land Office Cert.-
11-18-75
U.S.G.S. Certification-Determination-
12-1-75
Contract No. 12-08-0001-14272
T-23-S, R-29-E
Eddy County, New Mexico

Area Oil and Gas Supervisor
U. S. Geological Survey
P. O. Drawer 1857
Roswell, NM 88201

Commissioner of Public Lands
New Mexico State Land Office
P. O. Box 1148
Santa Fe, NM 87501

Gentlemen:

The above captioned Unit became effective December 1, 1975. Since that date two (2) wells have been drilled under the terms of said Agreement. These wells are:

1. Laguna Grande Unit Well No. 1, located in the NE/4 SE/4 Section 28, T-23-S, R-29-E, Eddy County, New Mexico, was completed in the Morrow interval from 13,258' to 13,529' for a CAOF of 4.1 MMCF gas on April 21, 1976. It produced a total of 212,752 MCF gas during the period March 28, 1977, to August 3, 1978, at which time the well ceased to produce. Further evaluation indicates remedial work in the Morrow would not be economic. During the drilling of the well, tests made indicated possible commercial gas production from the Strawn formation. A drillstem test of the Strawn interval from 11,880' to 11,922' flowed 1.25 MMCF gas on one-half (1/2) inch choke.
2. Laguna Grande Unit Well No. 2 located in the SE/4 SW/4 Section 27, T-23-S, R-29-E, Eddy County, New Mexico, was drilled to a total depth of 13,806' and completed as a dry hole on December 31, 1977.

It is the purpose of this letter to formally submit for your approval a Plan of Development and Operation for the year 1979. This Plan is being submitted pursuant to the provisions of Article 10, Unit Agreement, Laguna Grande Unit. The Working Interest Owners in the Unit have approved this plan.

1. During the calendar year 1979, the Unit plans to plug back the Laguna Grande Unit Well No. 1 from the Morrow and attempt a gas completion in the Strawn interval which tested gas as set forth above.

Area Oil and Gas Supervisor
U. S. Geological Survey

Commissioner of Public Lands
New Mexico State Land Office

Page Two

2. We will continue geologic evaluation of the Unit Area as additional data is acquired from wells drilling and completing in Sections 4, 8 and 18, T-23-S, R-29-E, immediately North and West of the Unit Area.
3. The availability of drillable locations on the Unit Area is restricted due to potash rights and the boundaries of the Salt Lake which occupies portions of Sections 15, 16, 21 and 22, T-23-S, R-29-E, Eddy County, New Mexico. These restrictive elements will have to be considered and dealt with when a geologically satisfactory location has been determined.
4. Operating practices for the proper conservation of natural resources will be observed.

Exxon, as Operator of this Unit, respectfully requests your approval of this Plan of Development and Operation.

Yours very truly,

Marvin L. Wigley, Supervisor
LAND-UNITIZATION

MLW:lpj

cc: New Mexico Oil Conservation Commission
P. O. Box 2088
Santa Fe, NM 87501

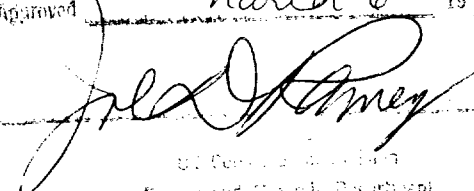

Working Interest Owners (See Attached Listing)

Approved March 6 19 78

Director
Energy and Mineral Department

WORKING INTEREST OWNERS
LAGUNA GRANDE UNIT

Amoco Production Company
P. O. Box 3092
Houston, TX 77001
Attn: Mr. Richard E. Ogden

Dow Chemical Company
1123 Wilco Building
Midland, TX 79701
Attn: Mr. Mark S. Martin

Sabine Production Company
Suite 200, 619 West Texas Street
Midland, TX 79701
Attn: Mr. Ronald V. Pepper

Hayes Oil Company
1312 Midland Savings Building
Midland, TX 79701
Attn: Mr. Wayne A. Piette

Phillips Petroleum Company
4001 Penbrook
Odessa, TX 79762
Attn: Mr. E. M. Gorence

Getty Oil Company
P. O. Box 1351
Midland, TX 79702

EXXON COMPANY, U.S.A.

POST OFFICE BOX 1600 • MIDLAND, TEXAS 79702 • (915) 684-4411

March 29, 1978

Re: Laguna Grande Unit
Initial Participating Area
Section 28, T-23-S, R-29-E,
Eddy County, New Mexico

WORKING INTEREST OWNERS
(See Attached Listing)

Gentlemen:

By letter dated March 13, 1978, Exxon, as Operator of the Laguna Grande Unit, requested approval of the above captioned Initial Participating Area by the U.S.G.S. and Commissioner of Public Lands of the State of New Mexico. This approval has been granted as follows:

1. U.S.G.S., by their letter dated March 22, 1978. That agency also returned a copy of our application on which their approval is indicated.
2. Commissioner of Public Lands, State of New Mexico, advised of his approval by letter dated March 16, 1978. He also attached a copy of our application on which his approval is indicated.

Copies of these approvals are enclosed for your files. Please note that the effective date of the Initial Participating Area is March 27, 1976.

Yours very truly,

Marvin L. Wigley
Marvin L. Wigley, Supervisor
LAND-UNITIZATION

MLW:lpj

Encls.

cc/W Encls: Phillips Petroleum Company
Attn: Mr. Stan Rever
P. O. Box 791
Houston, TX 77001

cc/W Encls. U.S.G.S. Approval:
State of New Mexico-Santa Fe, NM
OCC-Santa Fe, NM

WORKING INTEREST OWNERS
LAGUNA GRANDE UNIT
EDDY COUNTY, NEW MEXICO

Amoco Production Company
P. O. Box 3092
Houston, TX 77001
Attn: Mr. A. R. Reed

Dow Chemical Company
1123 Wilco Building
Midland, TX 79701
Attn: Mr. Mark S. Martin

Sabine Production Company
Suite 200, 619 West Texas Street
Midland, TX 79701
Attn: Mr. Ronald V. Pepper

Hayes Oil Company
1312 Midland Savings Building
Midland, TX 79701
Attn: Mr. Wayne A. Piette

Phillips Petroleum Company
Fourth and Washington Streets
Odessa, TX 79761
Attn: Mr. E. M. Gorence

Getty Oil Company
P. O. Box 1351
Midland, TX 79702
Attn: Mr. James B. Davis



United States Department of the Interior

GEOLOGICAL SURVEY

P. O. Box 26124
Albuquerque, New Mexico 87125

MAR 22 1978

Exxon Corporation
Attention: Mr. Marvin L. Wigley
P. O. Box 1600
Midland, Texas 79702

Gentlemen:

Your application of March 13, 1978, requesting approval of the initial Morrow participating area for the Laguna Grande unit agreement, Eddy County, New Mexico, was approved on this date, effective as of March 27, 1976.

The initial Morrow participating area embraces 640.00 acres described as all of sec. 28, T. 23 S., R. 29 E., N.M.P.M. Such participating area is based on the completion of unit well No. 1 in the NE $\frac{1}{4}$ SE $\frac{1}{4}$ sec. 28, as a commercial unit well. Unit well No. 1 was completed on March 27, 1976, for a calculated absolute open flow potential of 4,105 MCF of gas per day from the Morrow interval 13,107 to 13,258 feet.

Copies of the approved application are being distributed to the appropriate Federal offices and one copy is returned herewith. You are requested to furnish the State of New Mexico and all interested principals with evidence of this approval.

Sincerely yours,

GENE F. DANIEL
Acting Area Oil & Gas Supervisor

Enclosure

RECEIVED
MIDLAND

MAR 27 1978

EXXON
Land Section

EXXON COMPANY, U.S.A.

POST OFFICE BOX 1600 • MIDLAND, TEXAS 79702 • (915) 684-4411

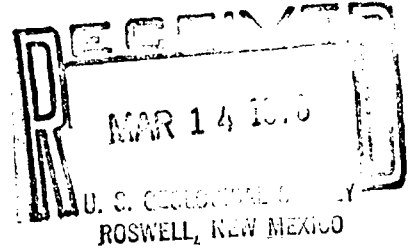

March 13, 1978

Re: Application for Approval of
Initial Participating Area
Laguna Grande Unit, Effective
December 1, 1975
N.M. State Land Office-Certificate
November 18, 1975
U.S.G.S. Certification-Determination-
December 1, 1975
Contract No. 12-08-0001-14272
T-23-S, R-29-E
Eddy County, New Mexico

Area Oil and Gas Supervisor
U.S. Geological Survey
P. O. Drawer 1857
Roswell, NM 88201

Commissioner of Public Lands
New Mexico State Land Office
P. O. Box 1148
Santa Fe, NM 87501

Gentlemen:

Exxon Corporation, as Unit Operator under the Laguna Grande Unit Agreement, and pursuant to the provisions of Section 11 thereof, respectfully submits for your approval the selection of the following described lands to constitute the Initial Participating Area for the Morrow producing zone or formation, to-wit:

All of Section 28, T-23-S, R-29-E, containing 640 acres of
land, more or less, Eddy County, New Mexico

The Working Interest Owners were advised of the above described Initial Participating Area by our letter of February 8, 1978. No objections or comments have been received as of this date.

In support of this Application, the following numbered items are attached and made a part hereof:

1. Ownership map showing the boundaries of the Unit Area and the proposed Initial Participating Area.
2. A schedule showing the lands entitled to participation in unitized substances produced from the Morrow formation, with the percentage of participation of each lease or tract indicated thereon.
3. Geologic Summary stating facts and information obtained or resulting from the drilling of Laguna Grande Unit Wells No. 1 and 2.
4. Geologic Map of the Laguna Grande Unit Area and immediate vicinity.

Area Oil and Gas Supervisor
U.S. Geological Survey
March 13, 1978
Page Two

Commissioner of Public Lands
New Mexico State Land Office

5. Cross Section.

Laguna Grande Unit Well No. 1, located in the NE/4 SE/4 Section 28, T-23-S, R-29-E, was completed on March 27, 1976, with an initial production of 2,897 Mcf per day from the Morrow Formation at a depth of 13,107 to 13,258 feet. By letter of June 24, 1976, the U.S. Geological Survey concurred with Exxon Corporation's determination that this well was capable of producing unitized substances in paying quantities from the Morrow Formation, pursuant to Section 9 of the Unit Agreement. As specified in Section 11 of the Unit Agreement, the effective date of this Initial Participating Area should be March 27, 1976.

Applicant respectfully requests your approval of the Initial Morrow Formation Participating Area as hereinabove described, effective as of March 27, 1976.

Yours very truly,

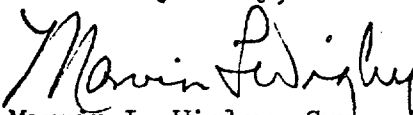

Marvin L. Wigley, Supervisor
LAND-UNITIZATION

MLW:lpj

cc: Mr. C. S. Neel, Jr., Bldg./w Encls.
All Working Interest Owners (See Attached Listing)
w/Copy of Items 1. and 2. Herein

Approved MAR 22 1978

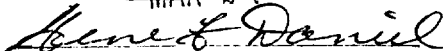
Effective MAR 27 1976



Area Oil & Gas Supervisor
U. S. Geological Survey

Subject to like approval by the
appropriate State officials.

WORKING INTEREST OWNERS
LAGUNA GRANDE UNIT

Amoco Production Company
P. O. Box 3092
Houston, TX 77001
Attn: Mr. Richard E. Ogden

Dow Chemical Company
1123 Wilco Building
Midland, TX 79701
Attn: Mr. Mark S. Martin

Sabine Production Company
Suite 200, 619 West Texas Street
Midland, TX 79701
Attn: Mr. Ronald V. Pepper

Hayes Oil Company
1312 Midland Savings Building
Midland, TX 79701
Attn: Mr. Wayne A. Piette

Phillips Petroleum Company
Fourth and Washington Streets
Odessa, TX 79761
Attn: Mr. E. M. Gorence

Getty Oil Company
P. O. Box 1351
Midland, TX 79702

EXXON COMPANY, U.S.A.

POST OFFICE BOX 1600 • MIDLAND, TEXAS 79702 • (915) 684-4411

March 29, 1978

Re: Laguna Grande Unit
1978 Plan of Development & Operation
Eddy County, New Mexico

WORKING INTEREST OWNERS
(See Attached Listing)

Gentlemen:

By letter dated March 6, 1978, Exxon, as Operator of the Laguna Grande Unit, filed the proposed 1978 Plan of Development & Operation with the U.S.G.S. and the Commissioner of Public Lands. A copy was furnished to the New Mexico Oil Conservation Commission. These Agencies have indicated their approval of the proposed plan as follows:

1. U.S.G.S., by letter dated March 22, 1978. Their approval is also indicated on a copy of our letter of March 6, 1978.
2. Commissioner of Public Lands indicated approval by letter dated March 16, 1978, and by returning an approved copy of our letter of March 6, 1978.
3. New Mexico Oil Conservation Commission indicated approval by their letter dated March 20, 1978, and by returning an approved copy of our letter dated March 6, 1978.

Copies of these approvals are enclosed for your files.

Yours very truly,

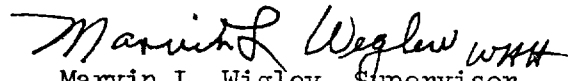
Marvin L. Wigley, Supervisor
LAND-UNITIZATION

MLW:lpj

Encls.

cc/W Encls: Phillips Petroleum Company
Attn: Mr. Stan Rever
P. O. Box 791
Houston, TX 77001

cc/W Encls. U.S.G.S. Approval:
State of New Mexico-Santa Fe, NM
OCC-Santa Fe, NM

WORKING INTEREST OWNERS
LAGUNA GRANDE UNIT
EDDY COUNTY, NEW MEXICO

Amoco Production Company
P. O. Box 3092
Houston, TX 77001
Attn: Mr. A. R. Reed

Dow Chemical Company
1123 Wilco Building
Midland, TX 79701
Attn: Mr. Mark S. Martin

Sabine Production Company
Suite 200, 619 West Texas Street
Midland, TX 79701
Attn: Mr. Ronald V. Pepper

Hayes Oil Company
1312 Midland Savings Building
Midland, TX 79701
Attn: Mr. Wayne A. Piette

Phillips Petroleum Company
Fourth and Washington Streets
Odessa, TX 79761
Attn: Mr. E. M. Gorence

Getty Oil Company
P. O. Box 1351
Midland, TX 79702
Attn: Mr. James B. Davis



United States Department of the Interior

GEOLOGICAL SURVEY

P. O. Box 26124
Albuquerque, New Mexico 87125

MAR 22 1978

Exxon Corporation
Attention: Mr. Marvin L. Wigley
P.O. Box 1600
Midland, Texas 79702

Gentlemen:

Your 1978 plan of development for the Laguna Grande unit area, Eddy County, New Mexico, was approved on this date subject to like approval by the appropriate officials of the State of New Mexico. Such plan proposes re-evaluation of unit geologic data based on information obtained by the completion of unit well No. 2 as a dry hole, after reaching a total depth of 13,806 feet on September 24, 1977.

One approved copy of the plan is enclosed.

Sincerely yours,

GENE F. DANIEL
Acting Area Oil & Gas Supervisor

Enclosure

RECEIVED
MIDLAND

MAR 27 1978

EXXON
Land Section

EXXON COMPANY, U.S.A.

POST OFFICE BOX 1600 • MIDLAND, TEXAS 79702 • (915) 684-4411

March 6, 1978

Re: PLAN OF DEVELOPMENT & OPERATION
Laguna Grande Unit - Effective 12-1-75
N.M. State Land Office Cert.-11-18-75
U.S.G.S. Certification-Determination-
December 1, 1975
Contract No. 12-08-0001-14272
T-23-S, R-29-E
Eddy County, New Mexico

Area Oil and Gas Supervisor
U.S. Geological Survey
P. O. Drawer 1857
Roswell, NM 88201

Commissioner of Public Lands
New Mexico State Land Office
P. O. Box 1148
Santa Fe, NM 87501

Gentlemen:

On March 27, 1976, Exxon Corporation, as Operator of the captioned Unit, completed the Laguna Grande Unit Well No. 1, located on the NE/4 SE/4 Section 28, T-23-S, R-29-E, Eddy County, New Mexico. This well went on production March 28, 1977. The Laguna Grande Unit Well No. 2, located 1980' FWL and 660' FSL Section 27, T-23-S, R-29-E, Eddy County, New Mexico, was drilled to a total depth of 13,806 feet and completed as a dry hole on December 31, 1977. The No. 2 well was drilled in accordance with the 1977 Plan of Development and Operation. You have been furnished complete information on both Wells No. 1 and No. 2.

We now formally submit for your approval a Plan of Development and Operation for the year 1978. This plan is being submitted pursuant to the provisions of Article 10, Unit Agreement, Laguna Grande Unit. The Working Interest Owners in the Laguna Grande Unit have approved this plan.

1. During the calendar year of 1978, the Unit does not plan to drill any additional wells for the following reasons:
 - (a) As a result of the completion of Laguna Grande Unit Well No. 2 as a dry hole, extensive re-evaluation of geologic data will be necessary before another location can be selected.
 - (b) The availability of drillable locations on the Unit Area is restricted due to potash rights and the boundaries of the Salt Lake which occupies portions of Sections 15, 16, 21 and 22, T-23-S, R-29-E, Eddy County, New Mexico. These restrictive elements will have to be considered and dealt with when a geologically satisfactory location has been determined.

Area Oil and Gas Supervisor
U.S. Geological Survey
March 6, 1978
Page Two

Commissioner of Public Lands
New Mexico State Land Office

2. Operating practices for the proper conservation of natural resources will be observed.

Exxon, as Operator of this Unit, respectfully requests your approval of this Plan of Development and Operation.

Yours very truly,

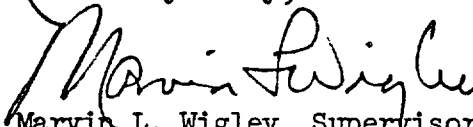

Marvin L. Wigley, Supervisor
LAND-UNITIZATION

MLW:lpj

cc: New Mexico Oil Conservation Commission
P. O. Box 2088
Santa Fe, NM 87501

Working Interest Owners (See Attached Listing)

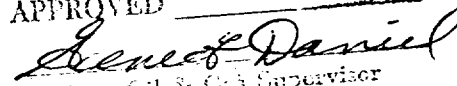
APPROVED MAR 22 1978

ACTING Area Oil & Gas Supervisor
U. S. Geological Survey

Subject to like approval by the
appropriate State officials.

WORKING INTEREST OWNERS
LAGUNA GRANDE UNIT

Amoco Production Company
P. O. Box 3092
Houston, TX 77001
Attn: Mr. Richard E. Ogden

Dow Chemical Company
1123 Wilco Building
Midland, TX 79701
Attn: Mr. Mark S. Martin

Sabine Production Company
Suite 200, 619 West Texas Street
Midland, TX 79701
Attn: Mr. Ronald V. Pepper

Hayes Oil Company
1312 Midland Savings Building
Midland, TX 79701
Attn: Mr. Wayne A. Piette

Phillips Petroleum Company
Fourth and Washington Streets
Odessa, TX 79761
Attn: Mr. E. M. Gorence

Getty Oil Company
P. O. Box 1351
Midland, TX 79702



United States Department of the Interior

GEOLOGICAL SURVEY

P. O. Box 37124
Albuquerque, New Mexico 87187

MAR 22 1978

Oxxon Corporation
Attention: Mr. Marvin L. Wigley
P. O. Box 1888
Midland, Texas 79702

no. 3579

Gentlemen:

Your application of March 13, 1976, requesting approval of the initial Morrow participating area for the Laguna Grande unit development, Eddy County, New Mexico, was approved on this date, effective as of March 27, 1976.

The initial Morrow participating area embraces 846.00 acres described as all of sec. 28, T. 23 S., R. 29 E., N. 1 P.M. Such participating area is based on the completion of unit well No. 1 in the NE 1/4 sec. 28, as a commercial unit well. Unit well No. 1 was completed on March 27, 1976, for a calculated absolute open flow potential of 2,195 MCF of gas per day from the Morrow interval 13,107 to 13,154 feet.

Copies of the approved application are being distributed to the appropriate Federal offices and one copy is returned herewith. You are requested to furnish the State of New Mexico and all interests' principals with evidence of this approval.

Sincerely yours,

(CR-2-CCB) GENE F. DANIEL

GENE F. DANIEL
Acting Area Oil & Gas Supervisor

Enclosure

cc:
BLM, Santa Fe (ltr. only)
BMOCC, Santa Fe (ltr. only) ←
Com. Pub. Lands, Santa Fe (ltr. only)



United States Department of the Interior

GEOLOGICAL SURVEY

P. O. Box 26124
Albuquerque, New Mexico 87105

MAR 22 1978

Exxon Corporation
Attention: Mr. Marvin L. Wigley
P.O. Box 1600
Midland, Texas 79702

No. 8577

Gentlemen:

Your 1972 plan of development for the Laguna Grande unit area, Eddy County, New Mexico, was approved on this date subject to like approval by the appropriate officials of the State of New Mexico. Such plan proposes re-evaluation of unit geologic data based on information obtained by the completion of unit well No. 2 as a dry hole, after reaching a total depth of 13,806 feet on September 24, 1977.

One approved copy of the plan is enclosed.

Sincerely yours,

(ORIG. SIGNED) [Signature]

GENE F. DANIEL
Acting Area Oil & Gas Supervisor

Enclosure

CC:
NMOCC, Santa Fe (1tr. only) ~~XXXX~~ This Copy for
Com. Pub. Lands, Santa Fe (1tr. only)



State of New Mexico

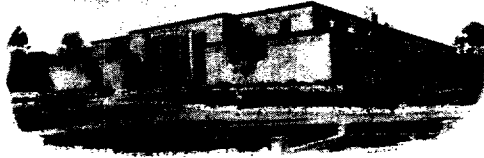

Commissioner of Public Lands

PHIL R. LUCERO
COMMISSIONER

March 16, 1978

RECEIVED

MAR 17 1978

Oil Conservation Commission

P. O. BOX 1148
SANTA FE, NEW MEXICO 87501

Exxon Company, USA
P. O. Box 1600
Midland, Texas 79701

Mr. 5579

Re: Laguna Grande Unit
Eddy County, New Mexico
1978 PLAN OF DEVELOPMENT & OPERATION

ATTENTION: Mr. Marvin L. Wigley

Gentlemen:

The Commissioner of Public Lands has this date approved your 1978 Plan of Development and Operation for the Laguna Grande Unit, Eddy County, New Mexico. Such plan proposes the drilling of no wells during 1978. This approval is subject to like approval by the United States Geological Survey.

Enclosed is one approved copy for your files.

Please remit a Three (\$3.00) Dollar filing fee.

Very truly yours,

PHIL R. LUCERO
COMMISSIONER OF PUBLIC LANDS

BY:
RAY D. GRAHAM, Director
Oil and Gas Division

PRL/RDG/s
encl.
cc:

OCC-Santa Fe, New Mexico ✓
USGS-Roswell, New Mexico
USGS-Albuquerque, New Mexico

OIL CONSERVATION COMMISSION

P. O. BOX 2088

SANTA FE, NEW MEXICO 87501

March 20, 1978

**Exxon Company, U.S.A.
Post Office Box 1600
Midland, Texas 79702**

Attention: Marvin L. Wigley

**Re: Case No. 5579
Laguna Grande Unit
1978 Plan of Development
and Operation**

Gentlemen:

**We hereby approve the 1978 Plan of Development and
Operation for the Laguna Grande Unit, Eddy County, New
Mexico, subject to like approval by the United States
Geological Survey and the Commissioner of Public Lands.**

**Two approved copies of the Plan are returned
herewith.**

Very truly yours,

**JOE D. RAMEY
Secretary-Director**

**JDR/LT/fd
enc.**

**cc: U.S.G.S. - Roswell
Commissioner of Public Lands**

EXXON COMPANY, U.S.A.

POST OFFICE BOX 1600 • MIDLAND, TEXAS 79702 • (915) 684-4411

March 6, 1978

Re: PLAN OF DEVELOPMENT & OPERATION
Laguna Grande Unit - Effective 12-1-75
N.M. State Land Office Cert.-11-18-75
U.S.G.S. Certification-Determination-
December 1, 1975
Contract No. 12-08-0001-14272
T-23-S, R-29-E
Eddy County, New Mexico

Area Oil and Gas Supervisor
U.S. Geological Survey
P. O. Drawer 1857
Roswell, NM 88201

Commissioner of Public Lands
New Mexico State Land Office
P. O. Box 1148
Santa Fe, NM 87501

Gentlemen:

On March 27, 1976, Exxon Corporation, as Operator of the captioned Unit, completed the Laguna Grande Unit Well No. 1, located on the NE/4 SE/4 Section 28, T-23-S, R-29-E, Eddy County, New Mexico. This well went on production March 28, 1977. The Laguna Grande Unit Well No. 2, located 1980' FWL and 660' FSL Section 27, T-23-S, R-29-E, Eddy County, New Mexico, was drilled to a total depth of 13,806 feet and completed as a dry hole on December 31, 1977. The No. 2 well was drilled in accordance with the 1977 Plan of Development and Operation. You have been furnished complete information on both Wells No. 1 and No. 2.

We now formally submit for your approval a Plan of Development and Operation for the year 1978. This plan is being submitted pursuant to the provisions of Article 10, Unit Agreement, Laguna Grande Unit. The Working Interest Owners in the Laguna Grande Unit have approved this plan.

1. During the calendar year of 1978, the Unit does not plan to drill any additional wells for the following reasons:
 - (a) As a result of the completion of Laguna Grande Unit Well No. 2 as a dry hole, extensive re-evaluation of geologic data will be necessary before another location can be selected.
 - (b) The availability of drillable locations on the Unit Area is restricted due to potash rights and the boundaries of the Salt Lake which occupies portions of Sections 15, 16, 21 and 22, T-23-S, R-29-E, Eddy County, New Mexico. These restrictive elements will have to be considered and dealt with when a geologically satisfactory location has been determined.

Area Oil and Gas Supervisor
U.S. Geological Survey
March 6, 1978
Page Two

Commissioner of Public Lands
New Mexico State Land Office

2. Operating practices for the proper conservation of natural resources will be observed.

Exxon, as Operator of this Unit, respectfully requests your approval of this Plan of Development and Operation.

Yours very truly,

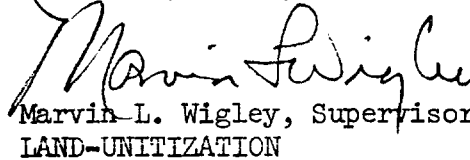
Marvin L. Wigley, Supervisor
LAND-UNITIZATION

MLW:lpj

cc: New Mexico Oil Conservation Commission
P. O. Box 2088
Santa Fe, NM 87501



Working Interest Owners (See Attached Listing)

WORKING INTEREST OWNERS
LAGUNA GRANDE UNIT

Amoco Production Company
P. O. Box 3092
Houston, TX 77001
Attn: Mr. Richard E. Ogden

Dow Chemical Company
1123 Wilco Building
Midland, TX 79701
Attn: Mr. Mark S. Martin

Sabine Production Company
Suite 200, 619 West Texas Street
Midland, TX 79701
Attn: Mr. Ronald V. Pepper

Hayes Oil Company
1312 Midland Savings Building
Midland, TX 79701
Attn: Mr. Wayne A. Piette

Phillips Petroleum Company
Fourth and Washington Streets
Odessa, TX 79761
Attn: Mr. E. M. Gorence

Getty Oil Company
P. O. Box 1351
Midland, TX 79702

Approved.....3/20.....1978

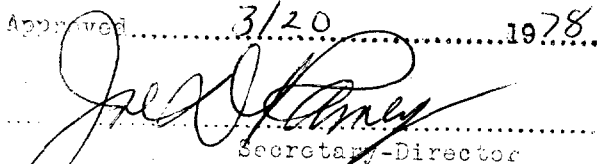
.....
Secretary-Director

NEW MEXICO OIL CONSERVATION COMMISSION

NOTICE: This document is subject to the approval of the New Mexico Oil Conservation Commission. The Commission is composed of representatives of the oil and gas industry, the public, and the state. The Commission's purpose is to conserve the state's oil and gas resources and to promote the orderly development of the oil and gas industry in New Mexico.

State of New Mexico

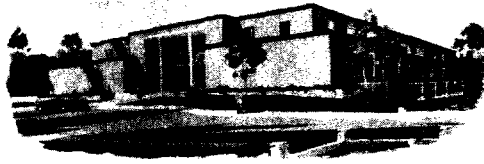

Commissioner of Public Lands

PHIL R. LUCERO
COMMISSIONER

December 8, 1977

P. O. BOX 1148
SANTA FE, NEW MEXICO 87501

Exxon Company, U.S.A.
Post Office Box 1600
Midland, Texas 79702

Mr. 5579

Re: Laguna Grande Unit
INITIAL PARTICIPATING AREA FOR
THE MORROW FORMATION
Eddy County, New Mexico

ATTENTION: Mr. W. H. Hall

Gentlemen:

The Commissioner of Public Lands has this date approved the Initial Participating Area for the Morrow Formation for the Laguna Grande Unit, Eddy County, New Mexico. Our approval is subject to like approval by the United States Geological Survey.

The Initial Participating Area for the Morrow formation consists of All of Sections 27, 28, 33 and 34; T23S, R29E containing 2560 acres of land, more or less; Eddy County, New Mexico

In the future please submit three copies of each instrument to this office. We are retaining the original copy for our records and have xeroxed one copy for your files and one copy for our duplicate file.

Very truly yours,

PHIL R. LUCERO
COMMISSIONER OF PUBLIC LANDS

BY:
RAY D. GRAHAM, Director
Oil and Gas Division

PRL/RDG/s

encls.

cc:

OCC-Santa Fe, New Mexico
USGS-Roswell, New Mexico
USGS-Albuquerque, New Mexico

EXXON COMPANY, U.S.A.

POST OFFICE BOX 1600 - MIDLAND, TEXAS 79702 (915) 684-4411

January 25, 1977

Re: PLAN OF DEVELOPMENT & OPERATION
Laguna Grande Unit - Effective Dec. 1, 1975
N. M. State Land Office Cert. - Nov. 18, 1975
U.S.G.S. Certification-Determination -
December 1, 1975
Contract No. 12-08-0001-14272
T23S, R29E
Eddy County, New Mexico

Supervisor
United States Geological Survey
P. O. Drawer 1857
Roswell, New Mexico 88201

Commissioner of Public Lands
N. M. State Land Office
P. O. Box 1148
Santa Fe, New Mexico 87501

Gentlemen:

Exxon Corporation, as Operator of the above captioned Unit, has heretofore drilled and completed the Laguna Grande (Federal) Unit Well No. 1 which is shut in and waiting on connections. You have previously been furnished with complete information with regard to this well. It is expected that this well will be placed on production during the first half of 1977.

We now formally submit for your approval a Plan of Development and Operation for the year 1977. This plan is being submitted pursuant to the provisions of Article 10, Unit Agreement, Laguna Grande Unit. The Working Interest Owners in the Laguna Grande Unit have approved this plan.

1. During the calendar year 1977 one well will be commenced on the Unit area at a location yet to be determined. This well will be drilled to a depth sufficient to thoroughly test the productive interval in the Laguna Grande (Federal) Unit Well No. 1.
2. Operating practices for the proper conservation of natural resources will be observed.

Exxon, as Operator of this Unit, respectfully requests your approval of this Plan of Development and Operation.

Yours very truly

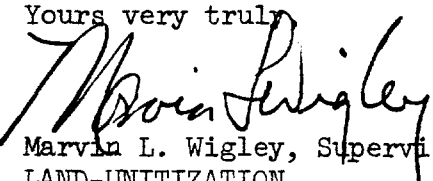
Marvin L. Wigley, Supervisor
LAND-UNITIZATION

MLW:lpj

cc: New Mexico Oil Conservation Commission ✓
P. O. Box 2088
Santa Fe, NM 87501
Working Interest Owners (See Attached Listing)

Approved.....19.....

.....
Secretary-Director

Amoco Production Company
P. O. Box 6002
Houston, TX 77001
Attn: Mr. Victor Morgan

Amoco Production Company
P. O. Box 6002
Houston, TX 77001
Attn: Mr. Victor Morgan

Dow Chemical Company
1123 Wilco Building
Midland, TX 79701
Attn: Mr. Mark S. Martin

Sabine Production Company
Suite 200
619 West Texas Street
Midland, TX 79701
Attn: Mr. Ronald V. Pepper

Hayes Oil Company
1312 Midland Savings Building
Midland, TX 79701

Phillips Petroleum Company
Phillips Petroleum Building
Fourth and Washington Streets
Odessa, TX 79760
Attn: Mr. S. A. Rever

Skelly Oil Company
P. O. Box 1351
Midland, TX 79702
Attn: Mr. Wm. B. Crownover



United States Department of the Interior

GEOLOGICAL SURVEY
Conservation Division
Western Bank Building
505 Marquette, NW, Room 815
Albuquerque, New Mexico 87102

FEB 10 1977

Exxon Company, USA
Attention: Mr. Marvin L. Wigley
P. O. Box 1600
Midland, Texas 79701

Gentlemen:

One approved copy of your 1977 plan of development for the Laguna Grande unit agreement, Eddy County, New Mexico is enclosed. Such plan, proposing the drilling of unit well No. 2 during calendar year 1977 was approved on this date subject to like approval by the appropriate State officials.

Sincerely yours,

(ORIG. SGD.) JAMES W. SUTHERLAND

Area Oil and Gas Supervisor

Enclosure

cc:
Com. Pub. Lands, Santa Fe (1tr. only)
NMOCC, Santa Fe (1tr. only)



State of New Mexico



Commissioner of Public Lands

January 31, 1977

PHIL R. LUCERO
COMMISSIONER



P. O. BOX 1148
SANTA FE, NEW MEXICO 87501

Exxon Company
P. O. Box 1600
Midland, Texas 79701

Re: PLAN OF DEVELOPMENT & OPERATION
Laguna Grande Unit
Eddy County, New Mexico

ATTENTION: Mr. Marvin L. Wigley

Gentlemen:

The Commissioner of Public Lands has this date approved your Plan of Development and Operation for the Laguna Grande Unit, Eddy County, New Mexico, for the year 1977. Your plan proposes the drilling of one well during the calendar year 1977.

This approval is subject to like approval by the United States Geological Survey.

Enclosed is One approved copy for your files. In the future please submit Three (3) copies to this office. We shall retain two (2) copies and return one copy to you.

Your Three (\$3.00) Dollar filing fee has been received.

Very truly yours,

PHIL R. LUCERO
COMMISSIONER OF PUBLIC LANDS

BY:
RAY D. GRANAN, Director
Oil and Gas Division

PRM/RDG/s

encl.

cc:

USGS-Bowling, New Mexico
USGS-Albuquerque, New Mexico
OGC- Santa Fe, New Mexico

Unit Name LAGUNA GRANDE UNIT (EXPLORATORY)
Operator Exxon Company
County EDDY

000

DATE	OCC CASE NO.	5579	EFFECTIVE	TOTAL	ACREAGE	STATE	FEDERAL	INDIAN-FEE	SEGREGATION	TERM
APPROVED	OCC ORDER NO.	R-5121	DATE						CLAUSE	
COMMISSIONER	OCC:	November 17, 1975	12-1-75	7680.00		960	5,800.00	920	yes	5yrs.

11-18-75

Effective December 1, 1975

UNIT AREA

TOWNSHIP 23 SOUTH, RANGE 29 EAST, NMPM
Sections 15, 16, All
Section 21: S/2SE/4
Sections 22, 23: All
Sections 26, 27, 28, and 29: All
Section 32: E/2E/2, W/2NE/4, N/2NW/4
Sections 33 and 34: All

Unit Name LAGUNA GRANDE UNIT (EXPLORATORY)
Operator EXXON COMPANY
County EDDY

STATE TRACT NO.	LEASE NO.	INSTI- TUTION	SEC.	TWP.	RGE.	SUBSECTION	RATIFIED		ACREAGE NOT RATIFIED	LESSEE
							DATE	ACRES		
7	LG-1553	C.S.	16	23S	29E	All	8-26-75	640.00		Exxon Company
8	L-6748-2	C.S.	32	23S	29E	E/2E/2, W/2NE/4, N/2NW/4	10-10-75	320.00		Dalco Inc.

33 11

EXXON COMPANY, U.S.A.
POST OFFICE BOX 1600 • MIDLAND, TEXAS 79701

EXPLORATION DEPARTMENT
SOUTHWESTERN DIVISION

March 5, 1976

Re: Laguna Grande Unit
Eddy County, New Mexico

United States Department of the Interior
Geological Survey
Drawer 1857
Roswell, NM 88201
Attn: Mr. John Duletsky

Oil Conservation Commission
State of New Mexico
P. O. Box 2088
Santa Fe, New Mexico 87501
Attn: Mr. Phil R. Lucero

Commissioner of Public Lands
P. O. Box 1148
Santa Fe, New Mexico 87501
Attn: Mr. Ray D. Graham

Gentlemen:

Enclosed is Revised copy of Page 1 of Exhibit "B" to Unit Agreement of the captioned Laguna Grande Unit. In the copy originally furnished you, Section 34 was inadvertently left out of the description of Tract No. 2 shown on Page 1 of Exhibit "B", however, the total number of acres shown is correct. We ask that you please substitute this revised page in your copy of the Unit Agreement.

Very truly yours,

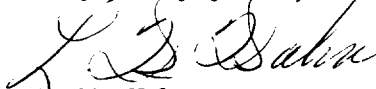
L. H. Hahn
LAND-UNITIZATION

LHH:lpj
Enclosure
cc/w Encl. Working Interest Owners (See Listing Attached)

LAGUNA GRANDE UNIT
UNIT AGREEMENT
EDDY COUNTY, NEW MEXICO

WORKING INTEREST OWNERS:

Amoco Production Company
P. O. Box 3092
Houston, TX 77001
Attn: Mr. Joe W. Durkee

Dow Chemical Company
1123 Wilco Building
Midland, TX 79701
Attn: Mr. Mark S. Martin

Dalco Oil Company
Suite 200, 619 West Texas Street
Midland, TX 79701
Attn: Mr. Ronald V. Pepper

Hayes Oil Company
c/o Dow Chemical Company
1123 Wilco Building
Midland, TX 79701

Phillips Petroleum Company
Fourth and Washington
Phillips Petroleum Building
Odessa, TX 79760
Attn: Mr. S. A. Rever

Skelly Oil Company
P. O. Box 1351
Midland, TX 79701
Attn: Mr. Wm. B. Crownover

OVERRIDING ROYALTY OWNERS:

Teledyne, Inc.
Attn: Mr. Phillip H. Muir
1901 Avenue of the Stars
Los Angeles, CA 90067

Robert N. Enfield & Mona L. Enfield
P. O. Box 2431
Santa Fe, NM 87501

EXHIBIT "B" - LAGUNA GRANDE UNIT AREA - EDDY COUNTY, NEW MEXICO

Tract No.	Description of Land	No. of Acres	Lease No. & Expiration Date of Lse.	Basic Royalty & Percentage of Record & Int.	Overriding Royalty or Production Payments	Working Interest Owners and Percentage
1	T23S, R29E Sec. 15: E½, E½W½, SW¼NW½, W½SW½	600	NM19847 1-1-84	USA 12½% Hayes - 25% Dow - 75%	None	Hayes 25% of 87.5% Dow - 75% of 87.5%
2	T23S, R29E Sec. 28: W½, W½E½ Sec. 29: All Sec. 33: All Sec. 34: All	2400	NM19848 5-1-84	USA 12½% Exxon	Tim Daly (Nancy T.) 1/32 of 8/8 (.03125) Tommy Phipps et al, Trustees Margene Blakemore Trust 4.375% of 8/8 (.04375)	Exxon 80%
3	T23S, R29E Sec. 21: SE½SE½ Sec. 22: All Sec. 23: W½ Sec. 26: W½ Sec. 27: All Sec. 28: E½E½	2120	NM23177 7-25-76	USA 12½% Exxon-All	Glenn R. Easterly (Viola Lillian) 4% of 8/8 Jack Easterly (Janice L.) 1/2 of 1%, Raymond C. Walker (Geraldine) 1/2 of 1%, Lyndell C. Brown (Eula Fern) 1/2 of 1%, Don R. Link 1%, Carol Ann Hoffman 1%).	Exxon 83.5%
4	T23S, R29E Sec. 26: E½	320	NM23178 7-25-76	USA 12½% Phillips-All	Peggy E. Baetz (Bertrand V.) 2½% of 8/8 Eddy Land Co. 2½% of 8/8 **	Phillips 82.5%
5	T23S, R29E Sec. 23: E½	320	NM23180 3-1-83	USA 12½% Amoco-All	Robert N. Enfield (Mona L.) 5% of 8/8*	Amoco 82.5%
6	T23S, R29E Sec. 21: SW½SE½	40	Open			

Total: 6 Tracts Federal Land - 5,800 Acres, 75.52% of the Unit Area

EXXON COMPANY, U.S.A.

POST OFFICE BOX 1600 · MIDLAND, TEXAS 79701 · (915) 684-4411

November 26, 1975

Re: Laguna Grande Unit
Eddy County, New Mexico

*see if OCC
got a copy of
this - if not,
send this to them*

United States Department of the Interior
Geological Survey
Drawer 1857
Roswell, New Mexico 88201

Attention: Mr. Ray Stall

Gentlemen:

In our letter to you of November 25, we failed to include the following information which you had requested in our telephone conversation of November 21:

1. Spud Date of Laguna Grande Unit (Federal) Well No. 1: 11-13-75.
2. As of November 26, we set 13-3/8" casing at 343' and 10-3/4" casing at 2900' and drilling cement.

If further information is needed, please advise.

Very truly yours,

L. H. Hahn
L. H. Hahn
LAND-UNITIZATION

LHH:lpj

cc: Mr. Ray D. Graham
Commissioner of Public Lands
P. O. Box 1148
Santa Fe, New Mexico 87501

Mr. Phil R. Lucero ✓
Oil Conservation Commission
State of New Mexico
P. O. Box 2088
Santa Fe, New Mexico 87501

Mr. Conrad E. Coffield
Hinkle, Bondurant, Cox & Eaton
521 Midland Tower
Midland, Texas 79701



United States Department of the Interior

GEOLOGICAL SURVEY
Drawer 1857
Roswell, New Mexico 88201

December 1, 1975

Exxon Company, U.S.A.
Attention: Mr. L. H. Hahn
P. O. Box 1600
Midland, Texas 79701

Gentlemen:

One approved copy of the Laguna Grande unit agreement, Eddy County, New Mexico, with Exxon Corporation as unit operator is returned herewith. Such agreement has been assigned No. 14-08-0001-14272, and is effective as of December 1, 1975, the date of approval.

You are requested to furnish the New Mexico Oil Conservation Commission and all other interested principals with evidence of this approval.

Sincerely yours,

JOHN DULETSKY
Acting Area Oil and Gas Supervisor

cc: N.M.O.C.C., Santa Fe (ltr. only) ✓
Com. Pub. Lands, Santa Fe (ltr. only)
Area Geologist, Roswell (ltr. only)
Artesia (w/cy agr.)

ARStall:lh

EXXON COMPANY, U.S.A.
POST OFFICE BOX 1000 • MIDLAND, TEXAS 79701

EXPLORATION DEPARTMENT
SOUTHWEST DIVISION

November 25, 1975

Re: Laguna Grande Unit
Eddy County, New Mexico

United States Department of the Interior
Geological Survey
Drawer 1857
Roswell, New Mexico 88201

Attention: Mr. Ray Stall

Gentlemen:

With reference to telephone conversation with Mr. Stall on Friday, November 21, we enclose the following items pertaining to the captioned unit:

1. Three copies of Certificate of Approval dated November 18, 1975, by the Commissioner of Public Lands of the State of New Mexico.
2. Copy of Mr. Ray D. Graham's letter of November 18, 1975, wherein he points out the necessity of correcting Lease No. LG-6748 to L-6748-2 on Exhibit "B", under Tract 8.
3. Copy of The Oil Conservation Commission of New Mexico's Order No. R-5121 approving this Unit contingent upon approval by the Commissioner of Public Lands and the U.S.G.S.
4. Three copies of Ratification instrument signed by Robert N. and Mona L. Enfield covering their production payment interest in the Unit. These instruments were received by us after we submitted all material to you with our letter of October 14, 1975.

We trust the afore material will enable you to proceed with the approval of the Unit, and we request that you please return an original of all instruments, together with your Certificate, so that same may be recorded in Eddy County. Should you have any questions in this matter, please call.

Very truly yours,

L. H. Hahn
LAND-UNITIZATION

LHH:lpj
Enclosures

cc: Mr. Ray D. Graham, Director/w copy of OCC Order No. R-5121 and
Commissioner of Public Lands copy of Ratification signed by Enfields
P. O. Box 1148
Santa Fe, New Mexico 87501

cc: Mr. Phil R. Lucero, Chairman/w Copy of Certificate of Approval
Oil Conservation Commission from Commissioner of Public Lands
State of New Mexico and Copy of Ratification signed by Enfields
P. O. Box 2088
Santa Fe, New Mexico 87501

Mr. Conrad E. Coffield
Hinkle, Bondurant, Cox & Eaton
521 Midland Tower
Midland, TX 79701



NEW MEXICO STATE LAND OFFICE

CERTIFICATE OF APPROVAL

COMMISSIONER OF PUBLIC LANDS, STATE OF NEW MEXICO

LAGUNA GRANDE UNIT

EDDY COUNTY, NEW MEXICO

There having been presented to the undersigned Commissioner of Public Lands of the State of New Mexico for examination, the attached Agreement for the development and operation of acreage which is described within the attached Agreement, dated August 26, 1975, which said Agreement has been executed by parties owning and holding oil and gas leases and royalty interests in and under the property described, and upon examination of said Agreement, the Commissioner finds:

- (a) That such agreement will tend to promote the conservation of oil and gas and the better utilization of reservoir energy in said area.
- (b) That under the proposed agreement, the State of New Mexico will receive its fair share of the recoverable oil or gas in place under its lands in the area.
- (c) That each beneficiary Institution of the State of New Mexico will receive its fair and equitable share of the recoverable oil and gas under its lands within the area.
- (d) That such agreement is in other respects for the best interests of the state, with respect to state lands.

NOW, THEREFORE, by virtue of the authority conferred upon me under Sections 7-11-39, 7-11-40, 7-11-41, 7-11-47, and 7-11-48, New Mexico Statutes Annotated, 1953 Compilation, I, the undersigned Commissioner of Public Lands of the State of New Mexico, do hereby consent to and approve the said Agreement, however, such consent and approval being limited and restricted to such lands within the Unit Area, which are effectively committed to the Unit Agreement as of this date, and, further, that leases insofar as the lands covered thereby committed to this Unit Agreement shall be and the same are hereby amended to conform with the terms of such Unit Agreement, and said leases shall remain in full force and effect in accordance with the terms and conditions of said Agreement. This approval is subject to all of the provisions and requirements of the afore-said statutes.

IN WITNESS WHEREOF, this Certificate of Approval is executed, with seal affixed, this 18th. day of November, 19 75.

COMMISSIONER OF PUBLIC LANDS
of the State of New Mexico

RATIFICATION

KNOW ALL MEN BY THESE PRESENTS, THAT:

WHEREAS, certain instruments entitled UNIT AGREEMENT FOR THE DEVELOPMENT AND OPERATION OF THE LAGUNA GRANDE UNIT AREA, EDDY COUNTY, NEW MEXICO, and the UNIT OPERATING AGREEMENT FOR THE LAGUNA GRANDE UNIT, EDDY COUNTY, NEW MEXICO, have been executed as of the 26th day of August, 1975, by various persons conducting operations with respect to the LAGUNA GRANDE UNIT AREA located in Eddy County, New Mexico, as more particularly described in said agreement; and

WHEREAS, the Unit Agreement, by Exhibit "A", shows on a map the boundary lines of the Unit Area and the Tracts therein, and by Exhibit "B" described each tract within the Unit Area; and

WHEREAS, the Unit Agreement and Unit Operating Agreement each provides that a person may become a party thereto by signing the original of said instrument, a counterpart thereof, or other instrument agreeing to be bound by the provisions thereof; and

WHEREAS, the undersigned (whether one or more) is, or claims to be, the owner of a royalty, overriding royalty and/or working interest in one or more of the Tracts described in Exhibit "B" of the Unit Agreement:

NOW, THEREFORE, the undersigned (whether one or more), for and in consideration of the premises and the benefits anticipated to accrue under each of said agreements, does hereby agree to become a party to, and to be bound by the provisions of the said Unit Agreement, and also the said Unit Operating Agreement, if the undersigned is a Working Interest Owner, and the undersigned does hereby agree that the parties to said agreements are those persons signing the originals of said instruments, counterparts thereof, or other instruments agreeing to be bound by the provisions thereof. The undersigned does also hereby acknowledge receipt of a true copy of the said Unit Agreement, and also the said Unit Operating Agreement, if the undersigned is a Working Interest Owner.

IN WITNESS WHEREOF, the undersigned has executed this instrument on the date set forth below opposite the undersigned's signature.

Date: 11/3/75

Address:

P. O. Box 2431

Santa Fe, New Mexico 87501

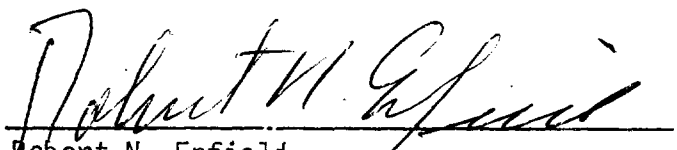
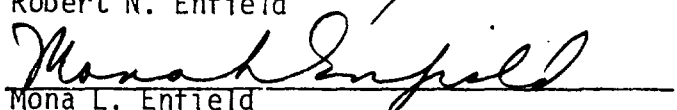
Robert N. Enfield

Mona L. Enfield

THE STATE OF

COUNTY OF

The foregoing instrument was acknowledged before me this ____ day of _____, 1975, by _____ of _____, a _____ corporation, on behalf of said corporation.

My Commission Expires:

Notary Public in and for
Said County and State.

THE STATE OF New Mexico

COUNTY OF Santa Fe

The foregoing instrument was acknowledged before me this 3rd day of November, 1975, by Robert N. Enfield, and wife, Mona L. Enfield

My Commission Expires:

May 10, 1978

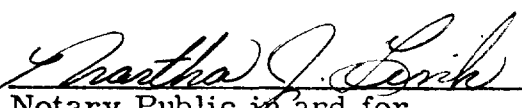

Notary Public in and for
Said County and State.



PHIL R. LUCERO
COMMISSIONER

State of New Mexico



Commissioner of Public Lands
November 18, 1975

TELEPHONE
505-827-2748

P. O. BOX 1148
SANTA FE, NEW MEXICO 87501

Exxon Company
P. O. Box 1600
Midland, Texas 79701

Re: Laguna Grande Unit
Eddy County, New Mexico

ATTENTION: Mr. L. H. Mohn

Gentlemen:

The Commissioner of Public Lands has this date approved the Laguna Grande Unit, Eddy County, New Mexico. This approval is subject to like approval by the United States Geological Survey.

Enclosed are Six (6) Certificates of approval. We are furnishing the USGS with a copy of our letter of approval.

On your Exhibit "B", under Tract 8, please change the lease number from LG-6748 to L-6748-2.

Please advise this office when the USGS approves the agreement so that we may finish processing same.

Very truly yours,

PHIL R. LUCERO
COMMISSIONER OF PUBLIC LANDS

BY:
RAY D. GRAHAM, Director
Oil and Gas Division

PRL/RDG/s
encls.
cc:

USGS-Roswell, New Mexico
OCC- Santa Fe, New Mexico ✓

EXXON COMPANY, U.S.A.

POST OFFICE BOX 1600 - MIDLAND, TEXAS 79701

EXPLORATION DEPARTMENT
SOUTHWESTERN DIVISION

December 3, 1975

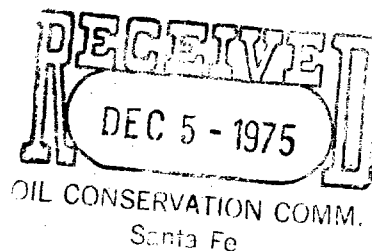

Re: Laguna Grande Unit
Eddy County, New Mexico

Commissioner of Public Lands
P. O. Box 1148
Santa Fe, New Mexico 87501

Attn: Mr. Ray D. Graham, Director
Oil and Gas Division

Oil Conservation Commission
State of New Mexico
P. O. Box 2088
Santa Fe, New Mexico 87501

Attn: Mr. Phil R. Lucero, Chairman

Gentlemen:

We enclose herewith for your file copies of letter dated December 1, 1975, from U.S.G.S., together with Certification-Determination, approving the captioned Unit agreement and assigning No. 14-08-0001-14272 to such Unit agreement, with the effective date of December 1, 1975.

We also enclose corrected Exhibit "A" (Plat) and Page 2 of Exhibit "B" to be substituted in your copy of the Unit Agreement. The Lease Number LG-6748 shown for Tract 8 on both Exhibits "A" and "B" has now been corrected to L-6748-2 as requested by Mr. Graham in his letter of November 18, 1975.

The Unit Agreement, together with Ratifications and approvals by U.S.G.S. and Commissioner of Public Lands, is being sent for recording in Eddy County. As soon as recording data is available, it will be furnished to all interested parties.

Very truly yours,

A handwritten signature in dark ink, appearing to read "L. H. Hahn".

L. H. Hahn
LAND-UNITIZATION

/lpj

Enclosures

cc/w Encls: United States Department of the Interior
Geological Survey
Drawer 1857
Roswell, NM 88201
Attn: Mr. John Duletsky

A DIVISION OF EXXON CORPORATION



United States Department of the Interior

GEOLOGICAL SURVEY

Drawer 1857
Roswell, New Mexico 88201

RECEIVED
MIDLAND

DEC 02 1975

EXXON
Land Section

December 1, 1975

Exxon Company, U.S.A.
Attention: Mr. L. H. Hahn
P. O. Box 1600
Midland, Texas 79701

Gentlemen:

One approved copy of the Laguna Grande unit agreement, Eddy County, New Mexico, with Exxon Corporation as unit operator is returned herewith. Such agreement has been assigned No. 14-08-0001-14272, and is effective as of December 1, 1975, the date of approval.

You are requested to furnish the New Mexico Oil Conservation Commission and all other interested principals with evidence of this approval.

Sincerely yours,

JOHN DULETSKY
Acting Area Oil and Gas Supervisor

CERTIFICATION--DETERMINATION

Pursuant to the authority vested in the Secretary of Interior, under the act approved February 25, 1920, 41 Stat. 437, as amended, 30 U. S. C. secs. 181, et seq., and delegated to the Area Oil and Gas Supervisors of the Geological Survey, I do hereby:

A. Approve the attached agreement for the development and operation of the Laguna Grande Unit Area, State of New Mexico.

B. Certify and determine that the unit plan of development and operation contemplated in the attached agreement is necessary and advisable in the public interest for the purpose of more properly conserving the natural resources.

C. Certify and determine that the drilling, producing, rental, minimum royalty, and royalty requirements of all Federal leases committed to said agreement are hereby established, altered, changed, or revoked to conform with the terms and conditions of this agreement.

Dated December 1, 1975.

Acting

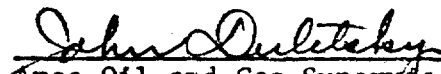
Area Oil and Gas Supervisor
United States Geological Survey

Contract Number 14-08-0001-14272

LAGUNA GRANDE UNIT AREA

EDDY COUNTY, NEW MEXICO

T 23 S - R 29 E

EXHIBIT A

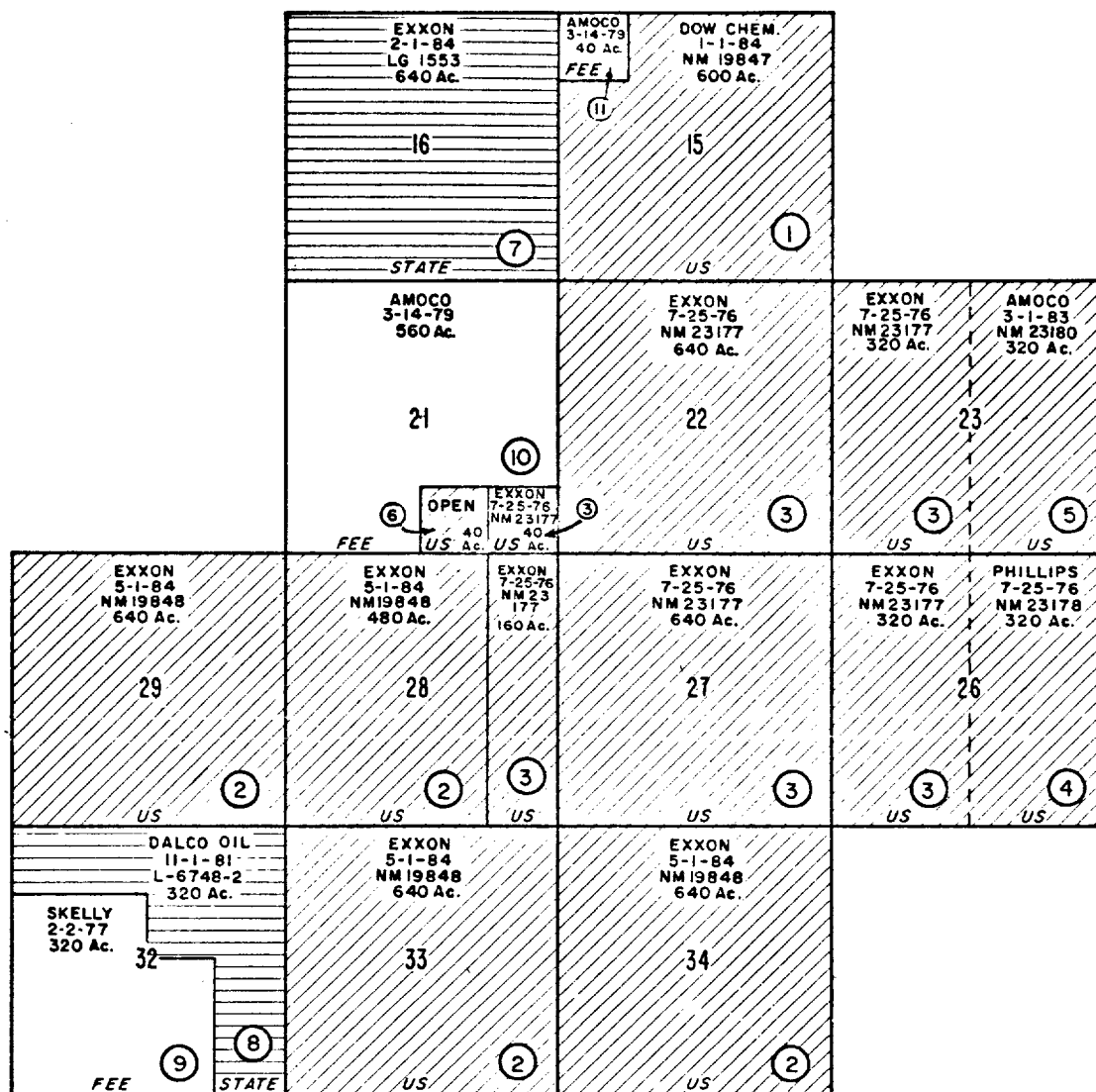

USA	5800	ACRES
STATE	960	ACRES
FEE	920	ACRES
UNIT AREA	7680	ACRES



TRACT ⑧

Federal Lease Numbers

19847
19848
23177
23178
23180

7	T23S, R29E Sec. 16: All	640	LG1553 2-1-84	St. of NM 1/8	Exxon-All	None	Exxon 87.5%
8	T23S, R29E Sec. 32: E $\frac{1}{2}$ E $\frac{1}{2}$, W $\frac{1}{2}$ NE $\frac{1}{4}$, N $\frac{1}{2}$ NW $\frac{1}{4}$	320	L-6748-2 11-1-81	St. of NM 1/8	Dalco-All	None	Dalco 87.5%

Total: 2 Tracts State Land - 960 Acres, 12.50% of the Unit Area

9	T23S, R29E Sec. 32: SW $\frac{1}{4}$, S $\frac{1}{2}$ NW $\frac{1}{4}$ W $\frac{1}{2}$ SE $\frac{1}{4}$	320	Fee 2-2-77	D. S. Harroun et al 3/16	Skelly- All	None	Skelly 81.25%
10	T23S, R29E Sec. 21: N $\frac{1}{4}$, N $\frac{1}{2}$ S $\frac{1}{4}$, S $\frac{1}{2}$ SW $\frac{1}{4}$	560	Fee 3-14-79	Teledyne Inc. 3/16	Amoco-All	None	Amoco 81.25%
11	T23S, R29E Sec. 15: NW $\frac{1}{4}$ NW $\frac{1}{4}$	40	Fee 3-14-79	Teledyne Inc. 3/16	Amoco-All	None	Amoco 81.25%

Total: 3 Tracts Fee Land - 920 Acres, 11.98% of the Unit Area

- * PPI \$750.00/acre payable out of 5% of 8/8
 - ** PPI \$375.00/acre payable out of 2% of 8/8
- Total Acres in Unit Area: 7,680 Acres

In the above Schedule "Exxon" indicates Exxon Corporation, "Amoco" indicated Amoco Production Company, "Hayes" indicates Hayes Oil Company, "Dow" indicates Dow Chemical Company, "Phillips" indicates Phillips Petroleum Company, "Dalco" indicates Dalco Oil Company and "Skelly" indicates Skelly Oil Company.

Other _____

LAW OFFICES
HINKLE, BONDURANT, COX & EATON
521 MIDLAND TOWER
MIDLAND, TEXAS 79701

CLARENCE E. HINKLE
W. E. BONDURANT, JR. (1914-1973)
LEWIS C. COX, JR.
PAUL W. EATON, JR.
CONRAD E. COFFIELD
HAROLD L. HENSLEY, JR.
STUART D. SHANOR
C. D. MARTIN
PAUL J. KELLY, JR.

JAMES H. BOZARTH
ANDREW ALLEN
RONALD G. HARRIS
JAMES H. ISBELL

TELEPHONE (915) 683-4691

ONLY MESSRS COFFIELD, MARTIN,
BOZARTH & ISBELL
LICENSED IN TEXAS

ROSWELL, NEW MEXICO OFFICE
600 HINKLE BUILDING
(505) 622-6510

October 29, 1975

Oil Conservation Commission
State of New Mexico
Post Office Box 2988
Santa Fe, New Mexico 87501

Re: Exxon Corporation -
Laguna Grande Unit
Docket No. 28-75
Case No. 5579

Gentlemen:

Please refer to our letter addressed to you dated October 15, 1975 in connection with the above referenced matter. Included in the materials transmitted with that letter were three copies of the Unit Agreement for the Laguna Grande Unit for the Commission's information in connection with the hearing on the Laguna Granda Unit involving lands in Township 23 South, Range 29 East, N.M.P.M., Eddy County, New Mexico.

It has now come to Exxon's attention that in connection with one of the Amoco federal leases, the serial number on the lease has been changed because of certain administrative action involving the Bureau of Land Management and unitization of certain lands in the base lease which are not involved in connection with the Laguna Grande Unit. As a consequence, what was previously designated as Tract 1 must now be designated as Tract 5. Accordingly, an Amendment has been made to both Exhibit "A" and Exhibit "B" to the Unit Agreement for the Laguna Grande Unit. Transmitted herewith are three copies of each of these Exhibits and we respectfully request that you substitute these new Exhibits for those which are contained in the copies of the Unit Agreement previously submitted to you.

October 29, 1975

Thank you.

Very truly yours,

HINKLE, BONDURANT, COX & EATON

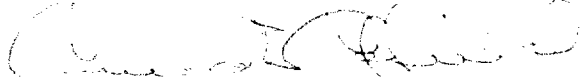
A handwritten signature in dark ink, appearing to read "Conrad E. Coffield", written in a cursive style.

Conrad E. Coffield

CEC:rf
Enclosures

xc/enc: Mr. Clarence E. Hinkle

State of New Mexico

TELEPHONE
505-827-2748

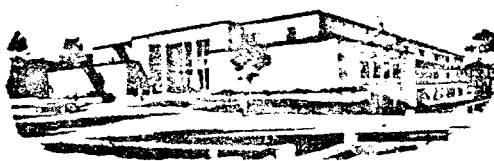

Commissioner of Public Lands

May 23, 1975

PHIL R. LUCERO
COMMISSIONER

P. O. BOX 1148
SANTA FE, NEW MEXICO 87501

Exxon Company
P. O. Box 1600
Midland, Texas 79701

Re: Proposed- Laguna Grande Unit
Eddy County, New Mexico

ATTENTION: Mr. Marvin L. Wigley

Gentlemen:

In reply to your letter of April 14, 1975, in connection with the subject unit, we have no objection to the unit area as described in your letter.

Approval of the proposed unit will be conditioned on receipt of a unit agreement which will meet all requirements of the Commissioner of Public Lands and the United States Geological Survey.

Very truly yours,

PHIL R. LUCERO
COMMISSIONER OF PUBLIC LANDS

BY: *Ray D. Graham*
RAY D. GRAHAM, Director
Oil and Gas Division

PRL/RDG/s

RECEIVED
MIDLAND

MAY 27 1975

EXXON
Land Section



IN REPLY REFER TO:

United States Department of the Interior
GEOLOGICAL SURVEY
Denver Federal Center
Denver, Colorado 80225

RECEIVED
MIDLAND

MAY 15 1975

MAY 13 1975
EXXON
Land Section

Exxon Company, U.S.A.
Attention: Mr. Marvin L. Wigley
P. O. Box 1600
Midland, Texas 79701

Gentlemen:

Your application of April 14, 1975, filed with the Oil and Gas Supervisor, Roswell, New Mexico, requests the designation of the Laguna Grande unit area embracing 7,680 acres, more or less, Eddy County, New Mexico, as logically subject to exploration and development under the unitization provisions of the Mineral Leasing Act, as amended.

Pursuant to unit plan regulations 30 CFR 226 the land requested as outlined on your plat marked "Exhibit A, Laguna Grande Unit Area, Eddy County, New Mexico," is hereby designated as a logical unit area.

The unit agreement submitted for the area designated should provide for a well to test all formations of Pennsylvanian Age or to a depth of 14,000 feet. The Form of Agreement for Unproved Areas (1968 reprint) should be used with the following modifications:

1. Add the following new section:

"PROTECTION OF POTASH DEPOSITS. No wells will be drilled for oil or gas at a location on Federal lands which in the opinion of the Supervisor or at a location on State lands which in the opinion of the Commissioner would result in undue waste of potash deposits or constitute a hazard to or unduly interfere with mining operations being conducted for the extraction of potash deposits.

The drilling or abandonment of any well on unitized land shall be done in accordance with applicable oil and gas operating regulations, including such requirements as to Federal lands as may be prescribed by the Supervisor and as to State lands by the Commissioner, as necessary to prevent the infiltration of oil, gas or water into formations containing potash deposits or into mines or workings being utilized in the extraction of such deposits.

Well records and survey plats that an oil and gas lessee of Federal lands must file pursuant to applicable operating

regulations (30 CFR Part 221) shall be available for inspection at the Office of the Supervisor to any party holding a potash permit or lease on the Federal land on which the well is situated insofar as such records are pertinent to the mining and protection of potash deposits."

2. Add the words "as amended" after "(30 F.R. 12319)" in Section 26, Nondiscrimination.
3. The inclusion of the appropriate language for State and fee lands.

If conditions are such that further modification of said standard form is deemed necessary, three copies of the proposed modifications with appropriate justification must be submitted to this office through the Oil and Gas Supervisor for preliminary approval.

In the absence of any other type of land requiring special provisions or of any objections not now apparent, a duly executed agreement identical with said form, modified as outlined above, will be approved if submitted in approvable status within a reasonable period of time. However, notice is hereby given that the right is reserved to deny approval of any executed agreement submitted which, in our opinion, does not have the full commitment of sufficient lands to afford effective control of operations in the unit area.

When the executed agreement is transmitted to the Supervisor for approval include the latest status of all acreage. In preparation of Exhibits "A" and "B", follow closely the format of the sample exhibits attached to the 1968 reprint of the aforementioned form.

Inasmuch as this unit agreement involves State land, we are sending a copy of the letter to the Commissioner of Public Lands in Santa Fe. Please contact the State of New Mexico before soliciting joinders regardless of prior contacts or clearances from the State.

Sincerely yours,

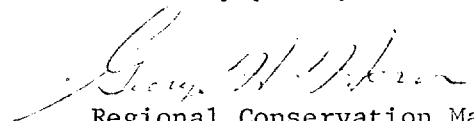

Regional Conservation Manager
For the Director

#5579

EXXON COMPANY, U.S.A.

POST OFFICE BOX 1600 • MIDLAND, TEXAS 79702-1600

1995 FEB 8 AM 8 52

MIDLAND PRODUCTION ORGANIZATION
LAND SERVICES

January 31, 1995

1995 Plan of Development/
Operations Laguna Grande
Unit-effective 12/01/75
Contract Number
12-08-0001-14272
Section 29: E/2 T23S-R29E
Eddy County, NM
Laguna Salado Atoka Field

Ms. Leslie Cone
United States Department of Interior
Bureau of Land Management
Roswell District Office
P. O. Box 1397
Roswell, NM 88202-1397

During the calendar year, no wells were drilled and no workover operations were done. The Unit well, the Laguna Grande Unit well # 3, continued in production.

Attached is a current plat showing the location of the Unit together with a copy of Dwight's production data for the well.

Also attached is a Summary of Unit Activities 1992-1994, Summary of anticipated 1995 Unit Activities, list of Unit Wells and status, and production history 1992-1994 shown through a production plot.

Exxon, as Operator of this Unit, requests your approval of this Plan of Development and Operations.

Very truly yours,

Joe B. Thomas

c: New Mexico Oil Conservation Division
P. O. Box 2088
Santa Fe, NM 87504

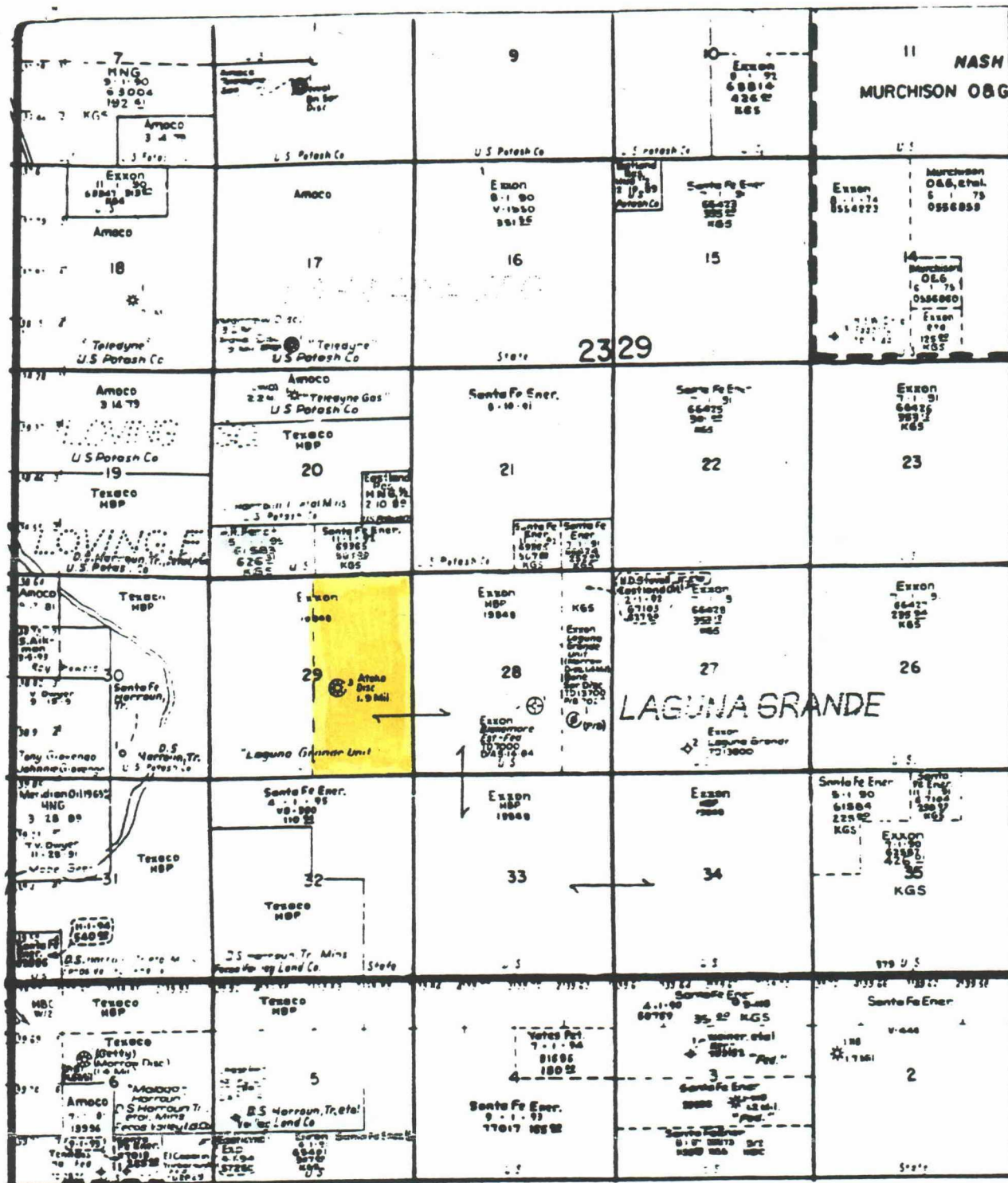

T23S

R29E

Location Map showing 320 acres
of Laguna Grande Unit, Eddy
County, New Mexico.



Entity: LAGUNA GRANDE UNIT (403600)
 Operator: EXXON CORPORATION (11016)
 Field: LAGUNA SALADO (31225)
 Reservoir: ATOKA (PENN) (405)
 Formation: ATOKA /ATOKAN/(403ATOK)
 Location: T023S R029E 29 EDDY, NM Dist: 22

Product: GAS
 Start: 198102
 Stop: 199312
 Well Status: INACTIVE
 # of wells: 1

API Number	Well Number	Completion Date	Dir Drill	Perforations Upper	Total Lower	Type Depth Well
3001523414	003	NA	NA	12104	12116	13690 NA

Date	Gas	Cond	Water	Water	Cond	Calc	*****	Pressures	*****
YYMMDD	MCFD	BPD	BWPD	BBL/MMCF	BBL/MMCF	MOF	CLP	FTP	SITP BHP/Z
810120	1995								6785 6492
830506									4851 5568
840427									638 882
850820									1698 2500
860710									3338 4488
870911									1530 2243
880818									1830 2695
890807									1186 1712
900915									1490 2184
910912									1310 1905
920726									1210 1750
930901									1125 1618

Year	Dec	Wells	Y E A R	T O	D A T E	C U M U L A T	I V E S
			Gas (MCF)	Cond (BBL)	Water (BBL)	Gas (MCF)	Cond (BBL)
1981	1	1	169698	0	30	169698	0
1982	1	1	168022	70	29	337720	70
1983	1	1	130736	23	0	468456	93
1984	1	1	52839	0	0	521295	93
1985	1	1	112963	103	0	634258	196
1986	1	1	52337	83	0	686595	279
1987	1	1	54434	120	0	741029	399
1988	1	1	47451	104	192	788480	503
1989	1	1	57151	97	1351	845631	600
1990	1	1	64461	59	509	910092	659
1991	1	1	66232	19	360	976324	678
1992	1	1	80529	35	354	1056853	713
1993	1	1	74627	37	359	1131480	750
1994	1	1	0	0	0	1131480	750

All cumulatives are through last updated month and may not agree with previously published hard copy output due to amendments made to prior months.

1995 Plan of Development

- **Summary of 1992-1994 Unit Activities:**
 - continued unit operations
 - no new wells drilled
 - no workovers
- **Summary of anticipated 1995 Unit Activities:**
 - continued unit operations
 - evaluate additional potential for Unit
- **List of Unit wells and status**
 - Laguna Grande Federal Unit #3 - Active
- **Production history 1992-1994**
 - refer to attached production plot

LAGUNE GRANDE UNIT

DATA: UTDB BASE TABLES - OPER: EXXON - RUN ON 1-17-95

FIELD - AC3366 SOUTH CARLSBAD

LEASE - AC336647832 LAGUNA GRANDE UT(FED)ATOKA P/A

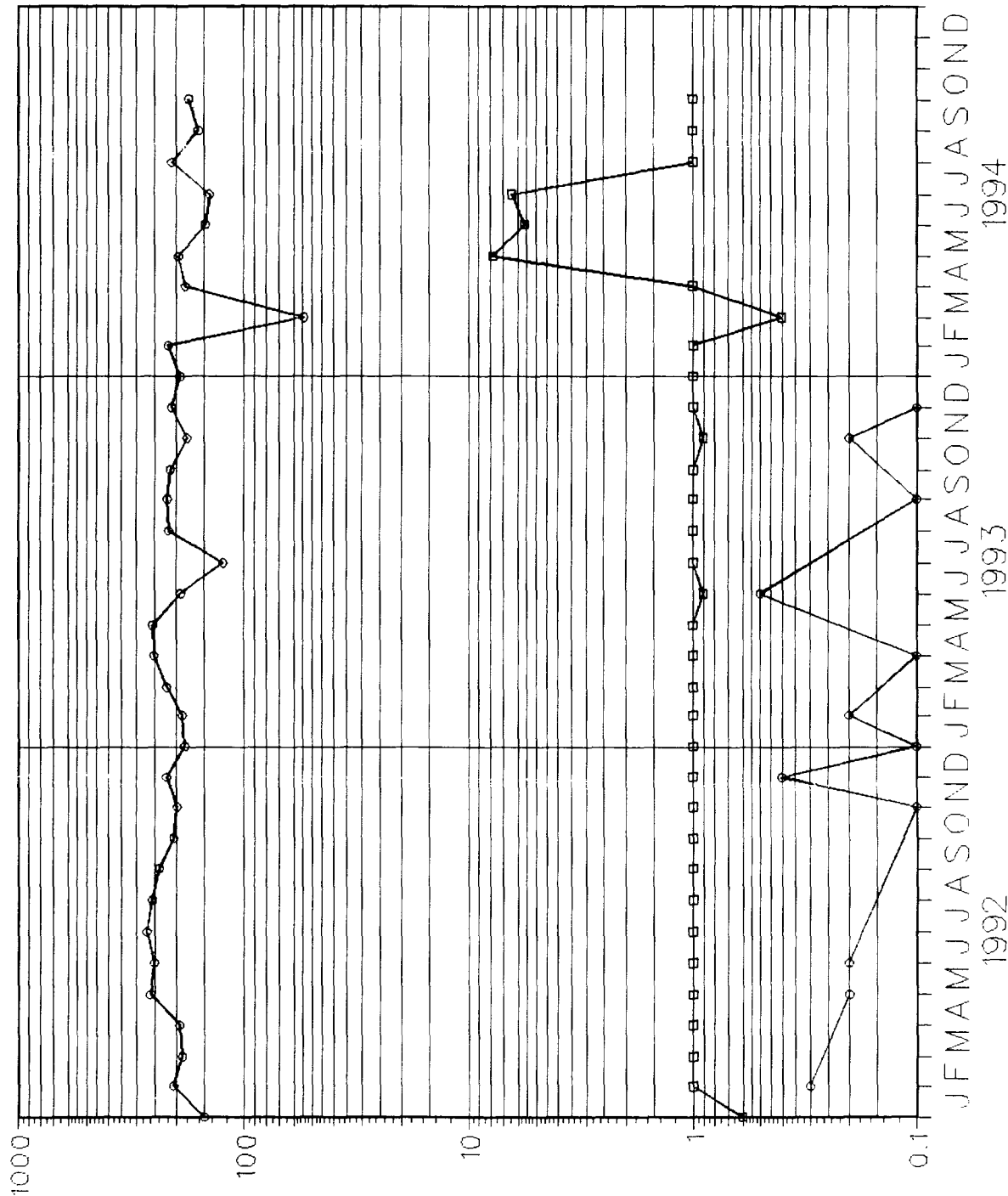

Legend

- AVG PRD WTR, BBL/D
- AVG PRD COND, BBL/D
- ◇ AVG PRD GWG, KCF/D