

Set for hearing

HANSON OPERATING COMPANY, INC.

P.O. BOX 1515

ROSWELL, NEW MEXICO 88202-1515

PHONE AC 505-822-7330

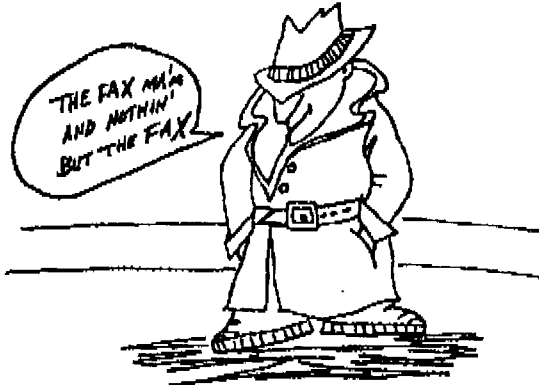

FROM FAX NUMBER (505) 622-7330

DATE: Sept. 10, 1993

TIME: 10:15 A.M. P.M.

TOTAL NUMBER OF PAGES INCLUDING THIS TRANSMITTAL PAGE: 6

TO: David Catawagh - Fax # 827-5741

DEPARTMENT: NM O.C.D - Santa Fe

10856

COMMENTS: _____

SIGNED: David Sweeney

PLEASE NOTE

IF YOU DO NOT RECEIVE THE TOTAL NUMBER OF PAGES INDICATED ABOVE OR DO NOT RECEIVE A CLEAR IMAGE, PLEASE TELEPHONE THE ABOVE REPRESENTATIVE AT THE PHONE NUMBER INDICATED ABOVE.

SENT BY: P. m. (1100)-4
November 1983
(Formerly 9-331)

9-10-93 : 9:00 : HANSON & McBRIDE-

5058275741;# 2/ 6

UNITED STATES
DEPARTMENT OF THE INTERIOR
BUREAU OF LAND MANAGEMENT

SUBMIT IN TRIPlicate*
(Other instructions on re-
verse side)

Expires August 31, 1985

3. LEASE DESIGNATION AND SERIAL NO.

NM-71794

6 IF INDIAN, ALLOTTEE OR TRIBE NAME

Case 10856

SUNDRY NOTICES AND REPORTS ON WELLS

(Do not use this form for proposals to drill or to deepen or plug back to a different reservoir.
Use "APPLICATION FOR PERMIT" for such proposals.)

1. OIL WELL <input checked="" type="checkbox"/> GAS WELL <input type="checkbox"/> OTHER <input type="checkbox"/>		7. UNIT AGREEMENT NAME	
2. NAME OF OPERATOR HANSON OPERATING COMPANY, INC.		8. FARM OR LEASE NAME Tuxedo Federal	
3. ADDRESS OF OPERATOR P.O. Box 1515, Roswell, New Mexico 88202-1515		9. WELL NO. #1	
4. LOCATION OF WELL (Report location clearly and in accordance with any State requirements. See also space 17 below.) At surface 1990' FSL & 2004' FEL, Unit J NW 1/4 SE 1/4		10. FIELD AND POOL, OR WILDCAT North Allison-San Andres	
14. PERMIT NO. 30-041-20870		11. SEC., T., R., M., OR BLK. AND SUBDIVISION OR AREA Sec. 17, T8S, R37E	
15. ELEVATIONS (Show whether SP, ST, GR, etc.) 4038' GR		12. COUNTY OR PARISH Roosevelt	13. STATE New Mexico

16. Check Appropriate Box To Indicate Nature of Notice, Report, or Other Data

NOTICE OF INTENTION TO:		SUBSEQUENT REPORT OF:	
TEST WATER SHUT-OFF <input type="checkbox"/>	PULL OR ALTER CASING <input type="checkbox"/>	WATER SHUT-OFF <input type="checkbox"/>	REPAIRING WELL <input type="checkbox"/>
FRACTURE TREAT <input type="checkbox"/>	MULTIPLE COMPLETE <input type="checkbox"/>	FRACTURE TREATMENT <input type="checkbox"/>	ALTERING CASING <input type="checkbox"/>
SHOOT OR ACIDIZE <input type="checkbox"/>	ABANDON* <input type="checkbox"/>	SHOOTING OR ACIDIZING <input type="checkbox"/>	ABANDONMENT* <input type="checkbox"/>
REPAIR WELL <input type="checkbox"/>	CHANGE PLANT <input type="checkbox"/>	(Other) _____	
(Other) HORIZONTALLY COMPLETE <input type="checkbox"/>		(Note: Report results of multiple completion on Well Completion or Recompletion Report and Log form.)	

17. OPERATIONS PROPOSED OR COMPLETED OPERATIONS: (Clearly state all pertinent details, and give pertinent dates, including estimated date of starting any proposed work. If well is directionally drilled, give subsurface locations and measured and true vertical depths for all markers and zones pertinent to this work.)

Hanson Operating Company, Inc., is proposing to Horizontally complete in the San Andres interval (4853' to 4865'). The 8 5/8" 32# casing will be sectionally milled from approximately (4821' to 4841'). A cement plug will be set from T.D. to 100' above milled section. Dress off cement plug to 4825' - K.O.P. Run in hole with a 3 7/8" bit and drilling assembly to drill curve. (4825'-4867') Run in hole with 3 7/8" bit and lateral drilling assembly. Drill approximately 300' of lateral displacement in a N 90 W direction.

See attached plat.

18. I hereby certify that the foregoing is true and correct
SIGNED Patricia J. McHew TITLE Production Analyst DATE September 9, 1993
(This space for Federal or State office use)

APPROVED BY _____ TITLE _____ DATE _____
CONDITIONS OF APPROVAL, IF ANY:

*See Instructions on Reverse Side

Title 18 U.S.C. Section 1001, makes it a crime for any person knowingly and willfully to make to any department or agency of the United States any false, fictitious or fraudulent statements or representations as to any matter within its jurisdiction.

TUD FT

TUXEDO FEDERAL # 1

KOP = 4825 FT

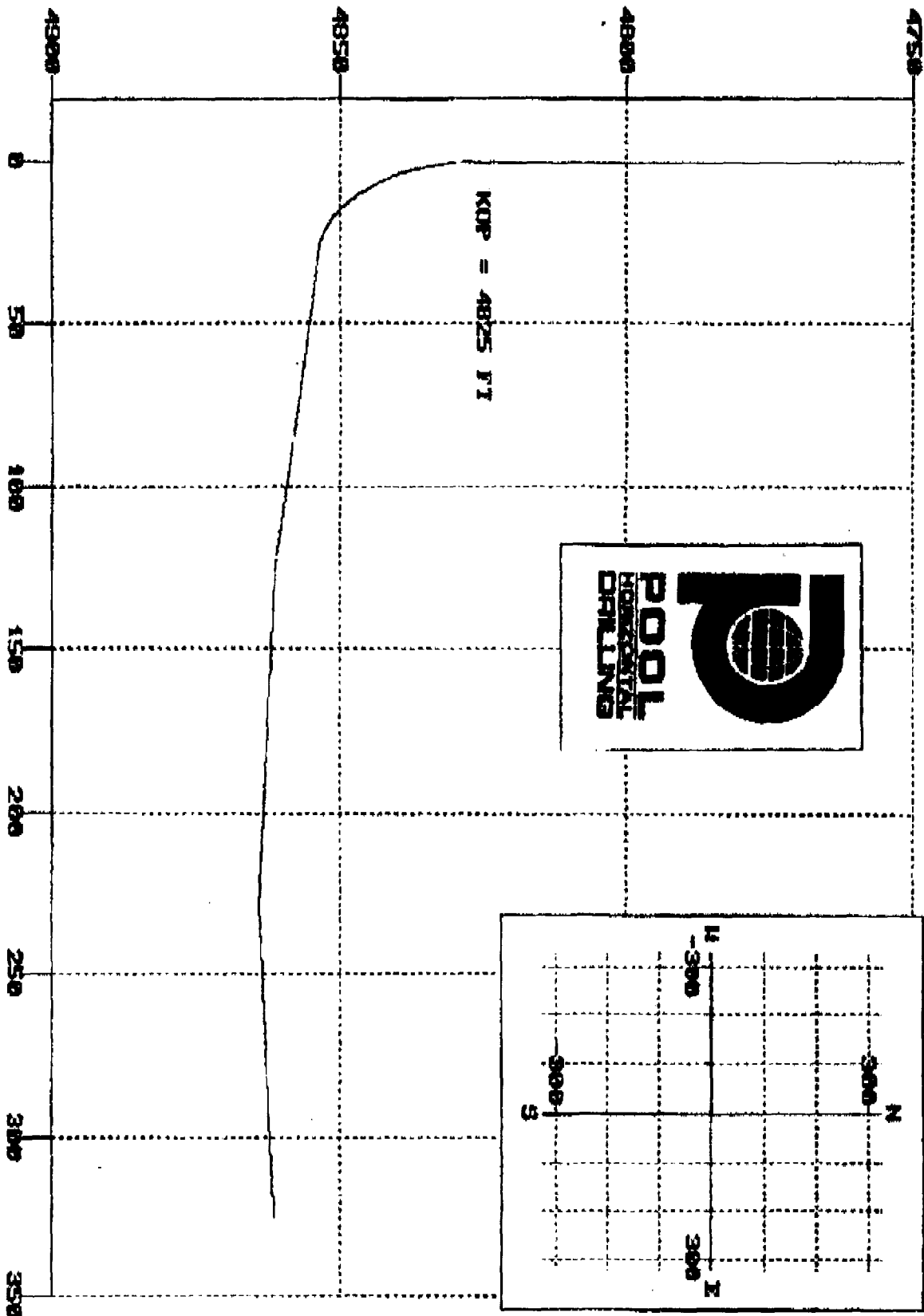
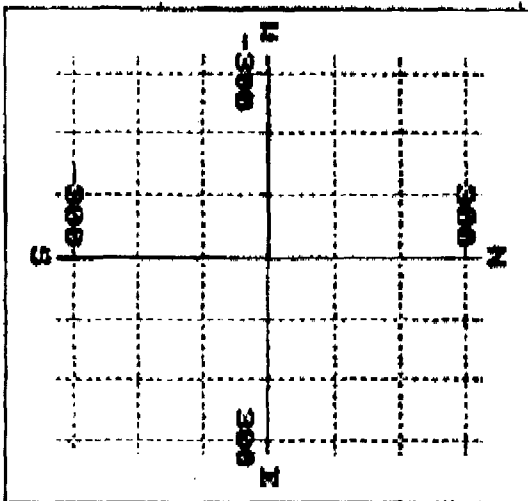
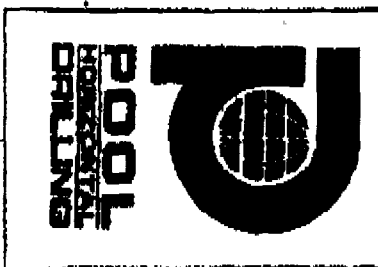

DISTANCE FT

FILE: HANSON

TRADITIONAL UNITS 1993-09-02 16:00

RADIUS OF CURVATURE METHOD

VERTICAL SECTION OR CLOSURE DIRECTION IS 270.00 DEGREES

MEAS. DEPTH	SURVEY INCL. DIR.	DEPTH (TVD)	NORTH -SOUTH	EAST -WEST	CLOSURE DIST. DIR.	DEG /FT	ROC FT	TVD FT
4750.00	.00 N OE	4750.00		.00	.00 .00 N OE			
4825.00	.00 N OE	4825.00		.00	.00 .00 N OE			
... THE ABOVE LINE IS MULTISHOT INPUT DATA ...								
750.00	0.00 N90W	4750.00	.00	.00	.00 N90W			
830.00	10.00 N90W	4829.97	.00	-.44	.44 N90W	2.00	28.65	28.65
835.00	20.00 N90W	4834.80	.00	-1.73	1.73 N90W	2.00	28.65	28.65
840.00	30.00 N90W	4839.32	.00	-3.84	3.84 N90W	2.00	28.65	28.65
845.00	40.00 N90W	4843.41	.00	-6.70	6.70 N90W	2.00	28.65	28.65
850.00	50.00 N90W	4846.95	.00	-10.23	10.23 N90W	2.00	28.65	28.65
855.00	60.00 N90W	4849.81	.00	-14.32	14.32 N90W	2.00	28.65	28.65
860.00	70.00 N90W	4851.92	.00	-18.85	18.85 N90W	2.00	28.65	28.65
865.00	80.00 N90W	4853.21	.00	-23.67	23.67 N90W	2.00	28.65	28.65
867.00	84.00 N90W	4853.49	.00	-25.65	25.65 N90W	2.00	28.65	28.65
967.00	87.00 N90W	4861.34	.00	-125.33	125.33 N90W	.03	1910.00	1910.00
067.00	90.00 N90W	4863.95	.00	-225.29	225.29 N90W	.03	1910.00	1910.00
167.00	93.00 N90W	4861.34	.00	-325.24	325.24 N90W	.03	1910.00	1910.00

TOTAL P.03

OIL CONSERVATION DIVISION

P.O. Box 2088

Santa Fe, New Mexico 87504-2088

DISTRICT I
P.O. Box 1980, Hobbs, NM 88240

DISTRICT II
P.O. Drawer DD, Artesia, NM 88210

DISTRICT III
1000 Rio Brazos Rd., Aztec, NM 87410

WELL LOCATION AND ACREAGE DEDICATION PLAT

All Distances must be from the outer boundaries of the section

Operator Hanson Operating Company		Lease Tuxedo Federal		Well No. 1
Unit Letter J	Section 17	Township 8 South	Range 37 East	County Roosevelt

Actual Footage Location of Well:
1990 feet from the **South** line and **2004** feet from the **East** line

Ground level Elev. 4038	Producing Formation San Andres	Pool North Allison Pool S.A.	Dedicated Acreage: 40 Acres
-----------------------------------	--	---	---------------------------------------

- Outline the acreage dedicated to the subject well by colored pencil or hatchure marks on the plat below.
 - If more than one lease is dedicated to the well, outline each and identify the ownership thereof (both as to working interest and royalty).
 - If more than one lease of different ownership is dedicated to the well, have the interest of all owners been consolidated by communization, unitization, force-pooling, etc.?
 - Yes No If answer is "yes" type of consolidation _____
- If answer is "no" list the owners and tract descriptions which have actually been consolidated. (Use reverse side of this form if necessary.)
 No allowable will be assigned to the well until all interests have been consolidated (by communization, unitization, forced-pooling, or otherwise) or until a non-standard unit, eliminating such interest, has been approved by the Division.

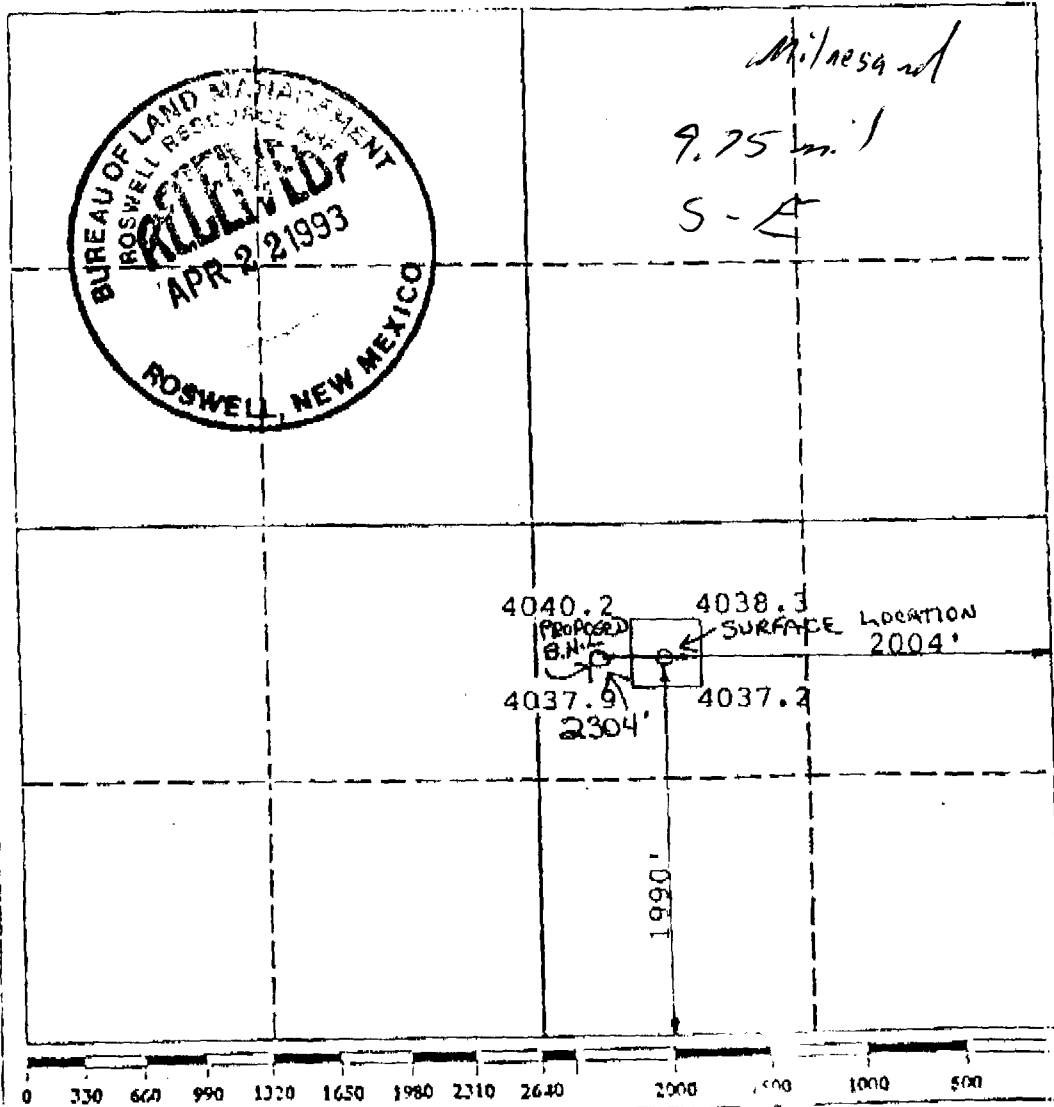

OPERATOR CERTIFICATION

I hereby certify that the information contained herein is true and complete to the best of my knowledge and belief.

Signature: *P.R. Patton*
 Printed Name: **P.R. Patton**
 Position: **agent for**
 Company: **Hanson Operating Co.**
 Date: **April 21, 1993**

SURVEYOR CERTIFICATION

I hereby certify that the well location shown on this plat was plotted from field notes of actual surveys made by me or under my supervision, and that the same is true and correct to the best of my knowledge and belief.

Date Surveyed: **April 13, 1993**
 Signature & Seal of Professional Surveyor: *P.R. Patton*
 Certificate No.: **8112**

T85, R39E

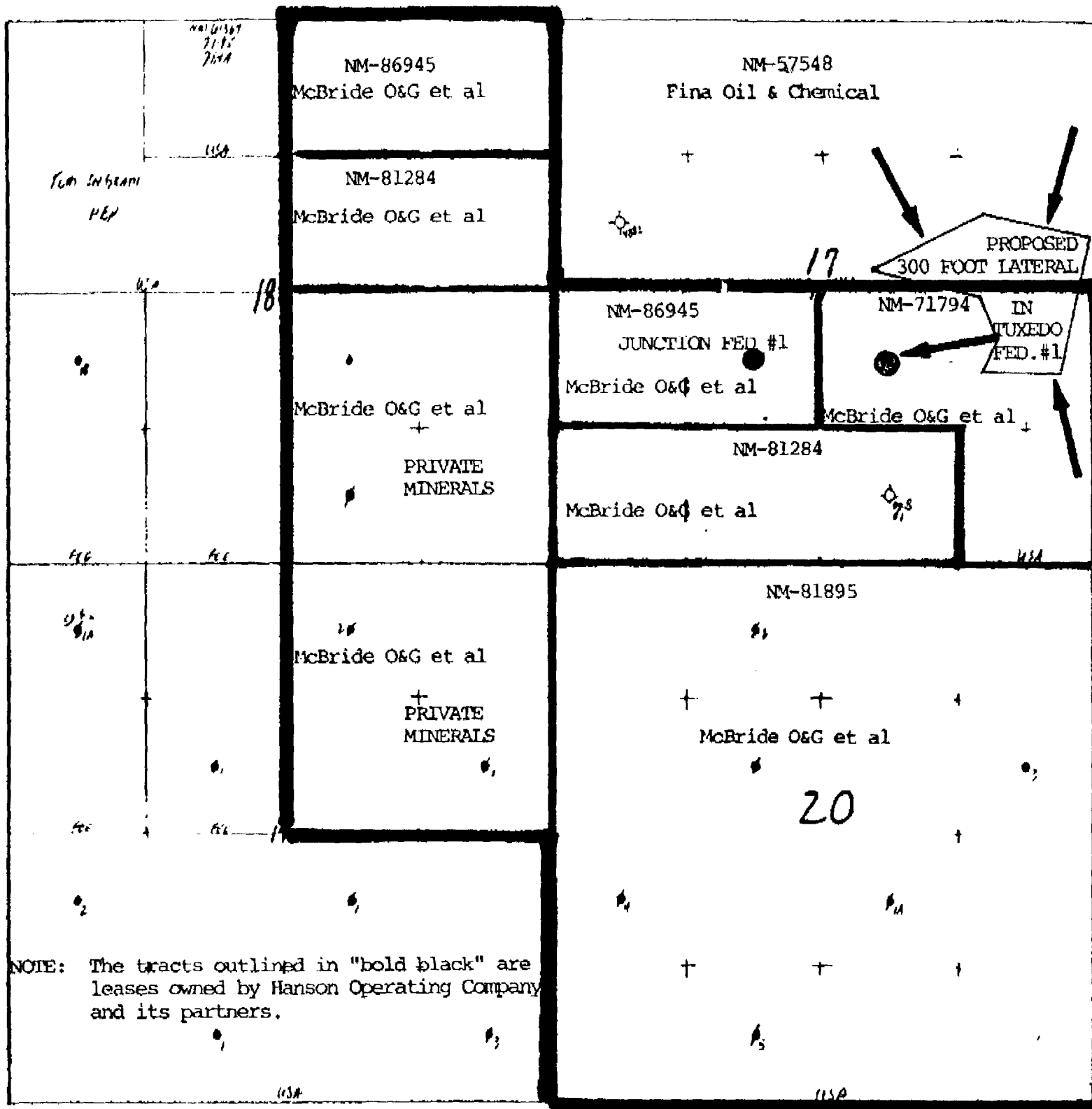



STATE OF NEW MEXICO
ENERGY, MINERALS AND NATURAL RESOURCES DEPARTMENT

OIL CONSERVATION DIVISION
RECEIVED

OIL CONSERVATION DIVISION
HOBBS DISTRICT OFFICE

BRUCE KING
GOVERNOR
'93 OCT 5 AM 9 10

September 30, 1993

POST OFFICE BOX 1980
HOBBS, NEW MEXICO 88241-1980
(505) 393-6161

OIL CONSERVATION DIVISION
P. O. BOX 2088
SANTA FE, NEW MEXICO 87501

Case 10856

RE: Proposed:

- MC _____
- DHC _____
- ~~NSL~~ _____
- NSP _____
- SWD _____
- WFX _____
- PMX _____

DD

Gentlemen: *Original completion*

I have examined the application for the:

<u>Hanson Operating Co. Inc.</u>	<u>Tuxedo Federal</u>	<u>#1-J</u>	<u>17-8-37</u>
Operator	Lease & Well No.	Unit	S-T-R

and my recommendations are as follows:

OK

Yours very truly,

Jerry Sexton
 Jerry Sexton
 Supervisor, District 1

**UNITED STATES
DEPARTMENT OF THE INTERIOR
BUREAU OF LAND MANAGEMENT**

N.M. DRILLING COMMISSION
P. O. BOX 1980
HOBBS, NEW MEXICO 88240

Form approved.
Budget Bureau No. 1004-0135
Expires August 31, 1985
3. LEASE DESIGNATION AND SERIAL NO.
NM-73794
IF INDIAN, ALLOTTEE OR TRIBE NAME

SUNDRY NOTICES AND REPORTS ON WELLS

(Do not use this form for proposals to drill or to deepen or plug back to a different reservoir.
Use "APPLICATION FOR PERMIT—" for such proposals.)

1. OIL WELL <input checked="" type="checkbox"/> GAS WELL <input type="checkbox"/> OTHER <input type="checkbox"/>		7. UNIT AGREEMENT NAME	
2. NAME OF OPERATOR HANSON OPERATING COMPANY, INC.		8. FARM OR LEASE NAME Tuxedo Federal	
3. ADDRESS OF OPERATOR P.O. Box 1515, Roswell, New Mexico 88202-1515		9. WELL NO. #1	
4. LOCATION OF WELL (Report location clearly and in accordance with any State requirements.* See also space 17 below.) At surface 1990' FSL & 2004' FEL, Unit J NW¼ SE¼		10. FIELD AND POOL, OR WILDCAT North Allison-San Andres	
14. PERMIT NO. 30-041-20870		15. ELEVATIONS (Show whether DP, RT, GR, etc.) 4038' GR	
		12. COUNTY OR PARISH Roosevelt	13. STATE New Mexico

16. Check Appropriate Box To Indicate Nature of Notice, Report, or Other Data

NOTICE OF INTENTION TO:		SUBSEQUENT REPORT OF:	
TEST WATER SHUT-OFF <input type="checkbox"/>	PULL OR ALTER CASING <input type="checkbox"/>	WATER SHUT-OFF <input type="checkbox"/>	REPAIRING WELL <input type="checkbox"/>
FRACTURE TREAT <input type="checkbox"/>	MULTIPLE COMPLETE <input type="checkbox"/>	FRACTURE TREATMENT <input type="checkbox"/>	ALTERING CASING <input type="checkbox"/>
SHOOT OR ACIDIZE <input type="checkbox"/>	ABANDON* <input type="checkbox"/>	SHOOTING OR ACIDIZING <input type="checkbox"/>	ABANDONMENT* <input type="checkbox"/>
REPAIR WELL <input type="checkbox"/>	CHANGE PLAN? <input type="checkbox"/>	(Other) <input type="checkbox"/>	
(Other) HORIZONTALLY COMPLETE <input type="checkbox"/>		(Note: Report results of multiple completion on Well Completion or Recompletion Report and Log form.)	

17. DESCRIBE PROPOSED OR COMPLETED OPERATIONS: (Clearly state all pertinent details, and give pertinent dates, including estimated date of starting any proposed work. If well is directionally drilled, give subsurface locations and measured and true vertical depths for all markers and zones pertinent to this work.)*

Hanson Operating Company, Inc., is proposing to Horizontally complete in the San Andres interval (4853' to 4865'). The 8 5/8" 32# casing will be sectionally milled from approximately (4821' to 4841'). A cement plug will be set from T.D. to 100' above milled section. Dress off cement plug to 4825' - K.O.P. Run in hole with a 3 7/8" bit and drilling assembly to drill curve. (4825'-4867') Run in hole with 3 7/8" bit and lateral drilling assembly. Drill approximately 300' of lateral displacement in a N 90 W direction.

See attached plat.

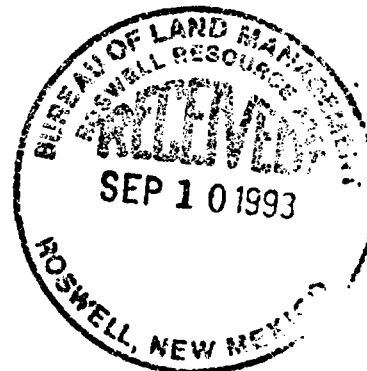

18. I hereby certify that the foregoing is true and correct
SIGNED Patricia A. McGeau TITLE Production Analyst DATE September 9, 1993

(This space for Federal or State office use)

APPROVED BY _____ TITLE _____ DATE _____
CONDITIONS OF APPROVAL, IF ANY: _____

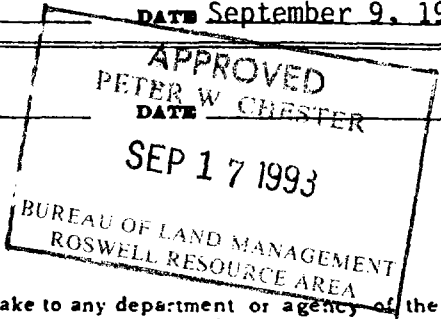

*See Instructions on Reverse Side

Instructions

General: This form is designed for submitting proposals to perform certain well operations, and reports of such operations when completed, as indicated, on Federal and Indian lands pursuant to applicable Federal law and regulations, and, if approved or accepted by any State, on all lands in such State, pursuant to applicable State law and regulations. Any necessary special instructions concerning the use of this form and the number of copies to be submitted, particularly with regard to local, area, or regional procedures and practices, either are shown below or will be issued by, or may be obtained from, the local Federal and/or State office.

Item 4: If there are no applicable State requirements, locations on Federal or Indian land should be described in accordance with Federal requirements. Consult local State or Federal office for specific instructions.

Item 17: Proposals to abandon a well and subsequent reports of abandonment should include such special information as is required by local Federal and/or State offices. In addition, such proposals and reports should include reasons for the abandonment; data on any former or present productive zones, or other zones with present significant fluid contents not sealed off by cement or otherwise; depths (top and bottom) and method of placement of cement plugs; mud or other material placed below, between and above plugs; amount, size, method of parting of any casing, liner or tubing pulled and the depth to top of any left in the hole; method of closing top of well; and date well site conditioned for final inspection looking to approval of the abandonment.

PRIVACY ACT

The Privacy Act of 1971 and the regulation in 43 CFR 2.48(d) provide that you be furnished the following information in connection with information required by this application.

AUTHORITY: 30 U.S.C. 181 et. seq., 351 et. seq., 25 U.S.C. et. seq.; 43 CFR 3160.
PRINCIPAL PURPOSE: The information is to be used to evaluate, when appropriate, approve applications, and report completion of secondary well operations, on a Federal or Indian lease.

ROUTINE USES: (1) Evaluate the equipment and procedures used during the proposed or completed subsequent well operations. (2) Request and grant approval to perform those actions covered by 43 CFR 3162.3-2(2). (3) Analyze future applications to drill or modify operations in light of data obtained and methods used. (4)(5) Information from the record and/or the record will be transferred to appropriate Federal, State, local or foreign agencies, when relevant to civil, criminal or regulatory investigations or prosecutions.

EFFECT OF NOT PROVIDING INFORMATION: Filing of this notice and report and disclosure of the information is mandatory once an oil or gas well is drilled.

The Paperwork Reduction Act of 1980 (44 U.S.C. 3501, et. seq.) requires us to inform you that:

This information is being collected in order to evaluate proposed and/or completed subsequent well operations on Federal or Indian oil and gas leases.

This information will be used to report subsequent operations once work is completed and when requested, to obtain approval for subsequent operations not previously authorized.

Response to this request is mandatory for the specific types of activities specified in 43 CFR Part 3160

RECEIVED

SEP 20 1993

OFFICE

TUXEDO FEDERAL #1

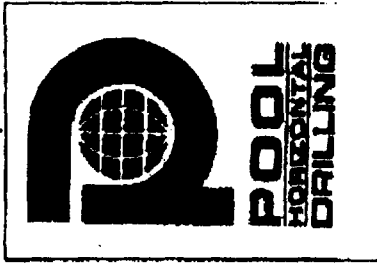
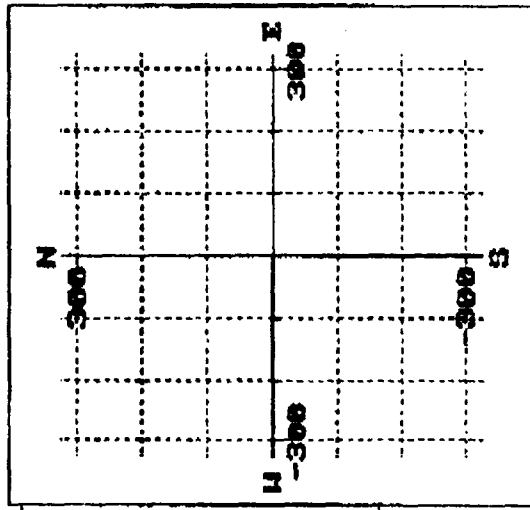

KOP = 4825 FT

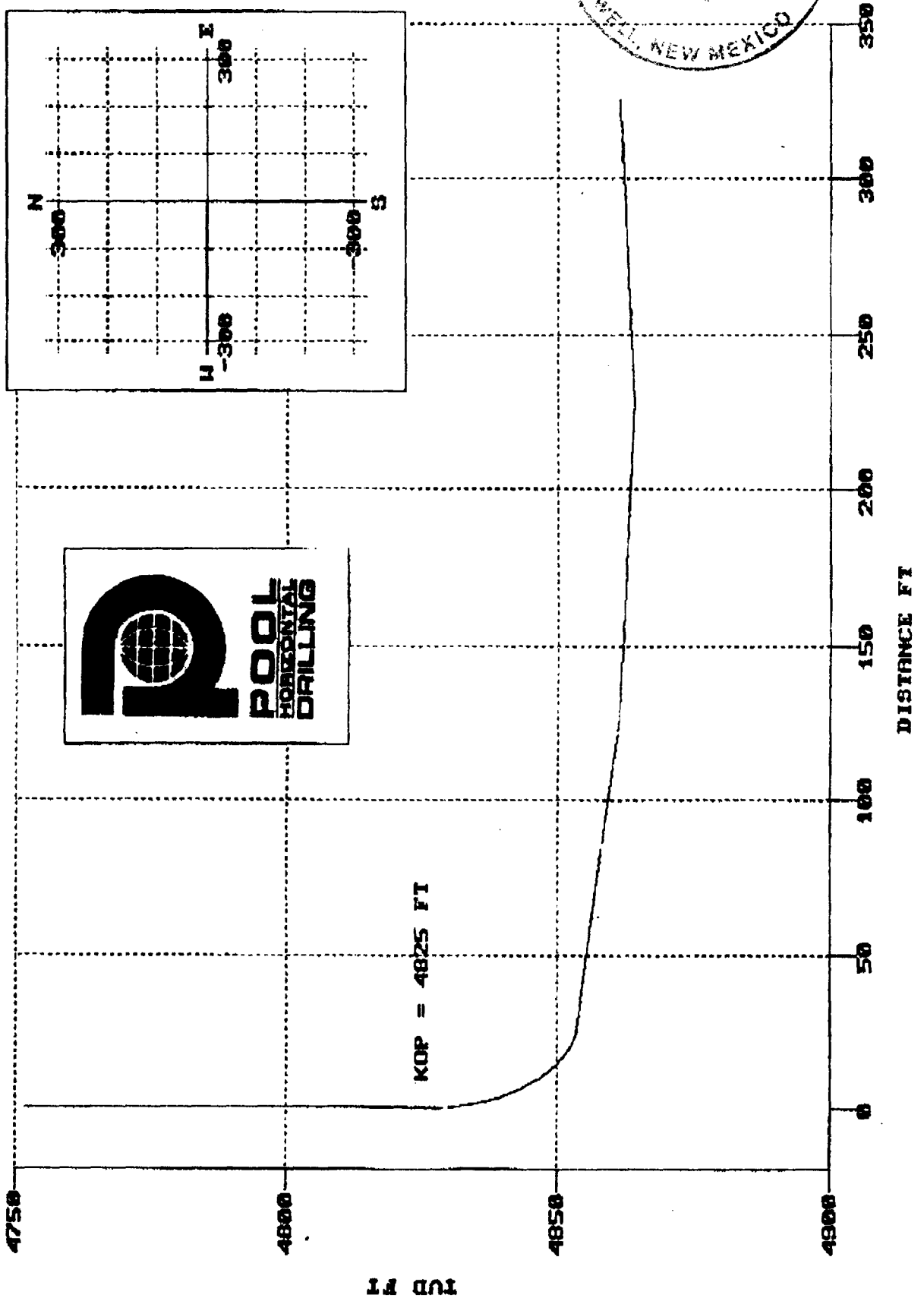

FILE: HANSON

TRADITIONAL UNITS 1993-09-02 16:00

RADIUS OF CURVATURE METHOD

VERTICAL SECTION OR CLOSURE DIRECTION IS 270.00 DEGREES

MEAS. DEPTH	SURVEY INCL. DIR.	DEPTH (TVD)	NORTH -SOUTH	EAST -WEST	CLOSURE DIST. DIR.	DEG /FT	ROC FT	TVD FT
4750.00	.00 N OE	4750.00		.00	.00 .00 N OE			
4825.00	.00 N OE	4825.00		.00	.00 .00 N OE			
... THE ABOVE LINE IS MULTISHOT INPUT DATA ...								
4750.00	0.00 N90W	4750.00	.00	.00	.00 N90W			
4830.00	10.00 N90W	4829.97	.00	-.44	.44 N90W	2.00	28.65	28.65
4835.00	20.00 N90W	4834.80	.00	-1.73	1.73 N90W	2.00	28.65	28.65
4840.00	30.00 N90W	4839.32	.00	-3.84	3.84 N90W	2.00	28.65	28.65
4845.00	40.00 N90W	4843.41	.00	-6.70	6.70 N90W	2.00	28.65	28.65
4850.00	50.00 N90W	4846.95	.00	-10.23	10.23 N90W	2.00	28.65	28.65
4855.00	60.00 N90W	4849.81	.00	-14.32	14.32 N90W	2.00	28.65	28.65
4860.00	70.00 N90W	4851.92	.00	-18.85	18.85 N90W	2.00	28.65	28.65
4865.00	80.00 N90W	4853.21	.00	-23.67	23.67 N90W	2.00	28.65	28.65
4867.00	84.00 N90W	4853.49	.00	-25.65	25.65 N90W	2.00	28.65	28.65
4967.00	87.00 N90W	4861.34	.00	-125.33	125.33 N90W	.03	1910.00	1910.00
5067.00	90.00 N90W	4863.95	.00	-225.29	225.29 N90W	.03	1910.00	1910.00
5167.00	93.00 N90W	4861.34	.00	-325.24	325.24 N90W	.03	1910.00	1910.00



RECEIVED
SEP 20 1993
COP HOURS
OFFICE

COUNTY *Roosevelt*

POOL *North Allison - San Andres*

TOWNSHIP *8 South*

RANGE *37 East*

NMFM

6	5	4	3	2	1
7	8	9	10	11	12
18	17	16	15	14	13
19	20	21	22	23	24
30	29	28	27	26	25
31	32	33	34	35	36

Description: *NW¹/₄ Sec. 19 (R-2692, 5-1-64)*
Ext: *SE¹/₄ Sec. 18; NE¹/₄ Sec. 19 (R-4232, 1-1-72)*

COUNTY *Roosevelt*

POOL *North Allison - San Andres*

TOWNSHIP *8 South*

RANGE *37 East*

NMPM

6	5	4	3	2	1
7	8	9	10	11	12
18	17	16	15	14	13
19	20	21	22	23	24
30	29	28	27	26	25
31	32	33	34	35	36

Description: *NW 1/4 Sec. 19 (R-2692, 5-1-64)*

Ext: *SE 1/4 Sec. 18; NE 1/4 Sec. 19 (R-4232, 1-1-72)*