

R28E

T
18
S

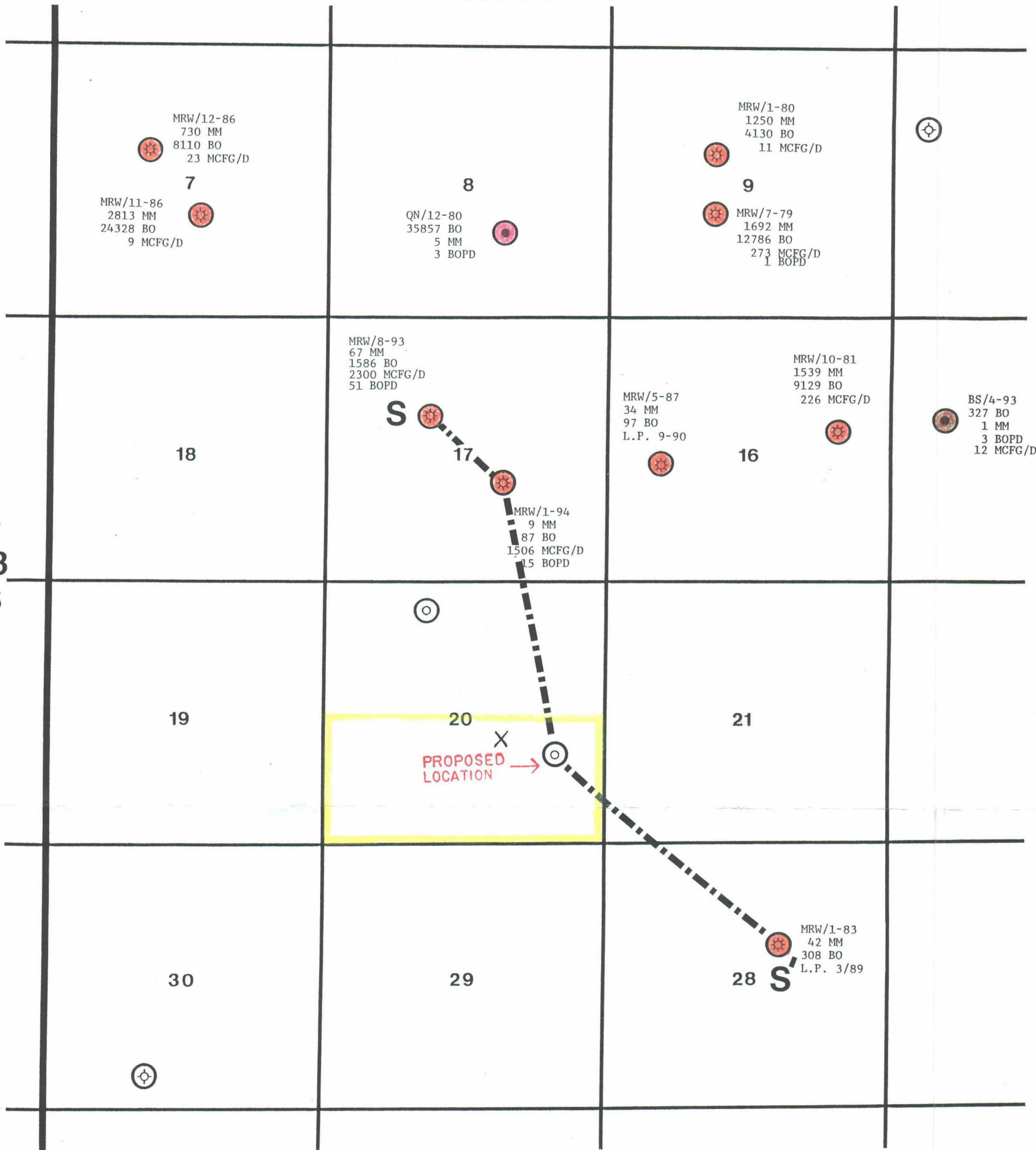

○ MORROW PENETRATION

LEGEND

- QUEEN
- BONE SPRING
- MORROW

ZONE/DATE 1st PRODUCTION	CUMULATIVE GAS	CUMULATIVE OIL	DAILY RATE
--------------------------	----------------	----------------	------------

**BEFORE THE
OIL CONSERVATION DIVISION**
Santa Fe, New Mexico

Case No. 10961 Exhibit No. 5

Submitted by: Mewbourne Oil Company

Hearing Date: April 28, 1994

MOC **MEWBOURNE OIL COMPANY**
MIDLAND, TEXAS DISTRICT

ILLINOIS CAMP PROSPECT
EDDY COUNTY, NEW MEXICO

PRODUCTION STUDY
CUMULATIVE THRU OCTOBER, 1993
DAILY RATES AS OF 10/93

MARCH, 1994 SCALE 1" = 2000' D. SHATZER