



BRUCE KING
GOVERNOR

STATE OF NEW MEXICO

ENERGY, MINERALS AND NATURAL RESOURCES DEPARTMENT

OIL CONSERVATION DIVISION
ARTESIA DISTRICT OFFICE



ANITA LOCKWOOD
CABINET SECRETARY

July 20, 1994

Phoenix Resources Co.
6525 North Meridian
Okla City, OK 73116

Re: Powell #1 Unit Ltr. C
Section 23, T-7S, R-28E
Chaves County, New Mex.

Gentlemen,

You filed OCD Form C-103 on this well in 1987 indicating your intentions to plug the subject well. According to our records the well remains unplugged.

Please let us hear from you by August 15, 1994 concerning your plans for beginning plugging operations.

Copies of Oil Conservation Division rules 201, 202 and 203 regarding plugging are attached for your information.

Very Truly Yours,

Ray Smith
Oil & Gas Inspector

RS:br

PHOENIX RESOURCES CO.
P.O. Box 9689 S. Denver Sta.
Denver CO 80218

C

NO. OF COPIES RECEIVED	
DISTRIBUTION	
SANTA FE	
FILE	
U.S.G.S.	
LAND OFFICE	
OPERATOR	

RECEIVED BY: O. BOX 2088
SANTA FE, NEW MEXICO 87501
FEB - 5 1987
O. C. D.
LOCAL OFFICE

5a. Indicate Type of Lease
State Fee

5. State Oil & Gas Lease No.

SUNDRY NOTICES AND REPORTS ON WELLS

DO NOT USE THIS FORM FOR PROPOSALS TO DRILL OR TO DEEPEN OR PLUG BACK TO A DIFFERENT RESERVOIR.
USE "APPLICATION FOR PERMIT" (FORM C-101) FOR SUCH PROPOSALS.

1. <input checked="" type="checkbox"/> OIL WELL <input type="checkbox"/> GAS WELL <input type="checkbox"/> OTHER-	7. Unit Agreement Name
2. Name of Operator Phoenix Resources Company	8. Farm or Lease Name Powell
3. Address of Operator 6525 North Meridian, Oklahoma City, OK 73116	9. Well No. 1
4. Location of Well UNIT LETTER <u>C</u> <u>660'</u> FEET FROM THE <u>north</u> LINE AND <u>1980</u> FEET FROM THE <u>west</u> LINE, SECTION <u>23</u> TOWNSHIP <u>7S</u> RANGE <u>28E</u> NMPM.	10. Field and Pool, or Wildcat Wildcat S.A.
15. Elevation (Show whether DF, RT, GR, etc.) 4011.6' GR	12. County Chaves

16. Check Appropriate Box To Indicate Nature of Notice, Report or Other Data

NOTICE OF INTENTION TO:		SUBSEQUENT REPORT OF:	
PERFORM REMEDIAL WORK <input type="checkbox"/>	PLUG AND ABANDON <input checked="" type="checkbox"/>	REMEDIAL WORK <input type="checkbox"/>	ALTERING CASING <input type="checkbox"/>
TEMPORARILY ABANDON <input type="checkbox"/>	CHANGE PLANS <input type="checkbox"/>	COMMENCE DRILLING OPS. <input type="checkbox"/>	PLUG AND ABANDONMENT <input type="checkbox"/>
PULL OR ALTER CASING <input type="checkbox"/>	OTHER <input type="checkbox"/>	CASING TEST AND CEMENT JOB <input type="checkbox"/>	OTHER <input type="checkbox"/>

17. Describe Proposed or Completed Operations (Clearly state all pertinent details, and give pertinent dates, including estimated date of starting any proposed work) SEE RULE 1703.

Plug and abandon as follows:

Set CIBP @ 2300' and spot 35' cement plug on top of BP.
Circulate hole w/salt water mud using 25 sx salt gel/100 bbls water.
Pull up to 1530' and spot 25 sx cement plug from 1530' to 1200' (TOC @ 1470' CBL).
POOH LD tubing. Perforate 4-1/2" casing @ 350'. Establish circulation with fresh water.
Cement through 4-1/2" casing til get cement returns on 4-1/2x8-5/8" annulus.
Cut off casing (8-5/8" and 4-1/2") 3' below ground level.
Weld on P&A marker.
Clean location.
Rig down and move out.

18. I hereby certify that the information above is true and complete to the best of my knowledge and belief.

SIGNED: David A. Rudolph TITLE: Sr Production Engr. DATE: 1/29/87

APPROVED BY: John Williams TITLE: OIL AND GAS INSPECTOR DATE: FEB 16 1987

CONDITIONS OF APPROVAL, IF ANY:

NO. OF COPIES RECEIVED	
DISTRIBUTION	
SANTA FE	<input checked="" type="checkbox"/>
FILE	<input checked="" type="checkbox"/>
U.S.G.S.	<input checked="" type="checkbox"/>
LAND OFFICE	
OPERATOR	

NEW MEXICO OIL CONSERVATION COMMISSION
WELL COMPLETION OR RECOMPLETION REPORT AND LOG

RECEIVED BY
JAN 29 1987
O. C. D.
ARTESIA, OFFICE

Form C-105
Revised 10-8

10. TYPE OF WELL *Bgm*

b. TYPE OF COMPLETION

OIL WELL GAS WELL DRY

NEW WELL WORK OVER DEEPEN PLUG BACK DIFF. RESVR. OTHER

2. Name of Operator
Phoenix Resources Co.

3. Address of Operator
6525 N. Meridian, Oklahoma City, OK 73116

4. Location of Well

UNIT LETTER **C** LOCATED **660** FEET FROM THE **North** LINE AND **1980** FEET FROM THE **West** LINE OF SEC. **23** TWP. **7S** RGE. **28E**

15. Date Spudded **3/20/80** 16. Date P.D. Reached **3/27/80** 17. Date Compl. (Ready to Prod.) **4/21/80** 18. Elevations (DF, RKB, RT, GR, etc.) **4011.6 GR** 19. Elev. Casinghead

20. Total Depth **2650'** 21. Plug Back TYP. 22. If Multiple Compl., How Many 23. Intervals Drilled By **X** Rotary Tools Cable Tools

24. Producing Intervals of this completion (Top, Bottom, Name)
Perf'd 2496-2549'; 2582-2592'; 2393-2436'.
Completion attempt in San Andres failed. Communication developed w/annulus

25. Was Directional Survey Made **No**

26. Type Electric and Other Logs Run
Dual Laterolog/Micro Laterolog; Sidewall Neutron Gamma Ray

27. Was Well Cased **No**

28. CASING RECORD (Report all strings set in well)

CASING SIZE	WEIGHT LB. FT.	DEPTH SET	HOLE SIZE	CEMENTING RECORD	AMOUNT PULLED
8-5/8"	24	398	11"	175 sx cir to surf.	<i>Loss ID-2</i>
4-1/2"	10.5#	2636'	6-3/4"	360 sx w/TOC @ 1500'	<i>2-6-87</i>

29. LINER RECORD

SIZE	TOP	BOTTOM	SACKS CEMENT	SCREEN

30. TUBING RECORD

SIZE	DEPTH SET	PACKER SET

31. Perforation Intervals (Interval, size and number)

2393-2436'
2496-2549'
2582-2592'

32. ACID, SHOT, FRACTURE, CEMENT SQUEEZE, ETC.

DEPTH INTERVAL	AMOUNT AND KIND MATERIAL USED
2393-2436	3000 gals 20% NEFE acid
2582-2592	1000 gals 20% NEFE acid
2496-2549'	100 gals 20% NEFE acid

33. PRODUCTION

Date First Production **No production.** Production Method (*Flowing, gas lift, pumping - Size and type pump*) **Shut in** Well Status (*Prod. or Shut-in*)

Date of Test	Hours Tested	Choke Size	Flow Pn. For Test Period	Oil - Bbl.	Gas - MCF	Water - Bbl.	Gas - Oil Ratio

Flow Tubing From	Casing Pressure	Calculated 24-Hour Rate	Oil - Bbl.	Gas - MCF	Water - Bbl.	Oil Gravity - API (Corr.)

24. Disposition of Core (Solid, used for fuel, vented, etc.)

Test Witnessed By

35. List of Attachments
Copy of logs as mentioned above.

36. I hereby certify that the information shown on both sides of this form is true and complete to the best of my knowledge and belief.

SIGNED *Scott Willis* TITLE **Production Technician** DATE **1/23/87**

50. Indicate Type of Lease
State Fee

51. State Oil & Gas Lease No.

7. Unit Agreement Name

8. Farm or Lease Name
Powell

9. Well No.
1

10. Field and Pool, or Wildcat
Wildcat - S.A.

11. County
Chaves

Phoenix Resources Co - Howell #1 C-23-1-40
TESTIMONY FOR SHOW CAUSE HEARINGS

1. Would you state your name, position and place of residence for the record, please?

2. How long have you held this position? _____

3. Have you previously testified before the Commission, and are your credentials a matter of record? _____

4. Does District II include that part of Chaves County involved in this case? Yes
5. Do your duties as Deputy Inspector include making recommendations to the Commission as to when wells should be plugged and abandoned? Yes
6. Are you familiar with the subject matter of Case _____ Yes?
7. What is the purpose of this case? _____

8. Have you reviewed all reports filed with the Commission concerning these wells? Yes
9. Do you have these records with you? Yes
10. Please refer to the records which pertain to this well and summarize its history?
C-101 Approved 2/28/80
Received C-103 April 1, 1980 Setting + Cementing of 2 5/8 Csg
Received C-103 April 1, 1980 Setting + Cementing of 4 1/2" Csg.
April 3, 1981 We asked for reports to update our files - No Response
November 12, 1981 We asked for reports to update our files -
November 29, 1981 We received a C-103 showing the perforating, treating +
swab reports - This was the last correspondence received.

1/7/83 Phoenix Resources said via telephone that they would
file a notice of intent to P+ A the well

11. On what date was the last official form filed with the Commission? _____

November 20, 1981

12. Do you have any other communications relative to this case which should be called to the Commission's attention? _____

13. In your opinion, could the failure to plug this well cause waste? yes

14. Would you elaborate on how waste could be caused? Possible contamination of fresh water + loss of reservoir energy

15. Are you prepared to recommend a plugging program at this time, or would you prefer to describe the program at the actual time of plugging? _____

Would prefer to describe the plugging program @ the actual time of plugging.

16. Would you now refer to the records on the _____ well and summarize its history (Q11-15) _____

Same as Item 10

17. Are the exhibits true and correct copies of Commission records? yes

18. I have nothing further.

INSTRUCTIONS

This form is to be filed with the appropriate District Office of the Commission not later than 30 days after the completion of any newly-drilled or deepened well. It shall be accompanied by one copy of all electrical and radio-activity logs run on the well and a summary of all special tests conducted, including drill stem tests. All depths reported shall be measured depths. In the case of directionally drilled wells, true vertical depths shall also be reported. For multiple completions, items 30 through 34 shall be reported for each zone. The form is to be filed in quintuplicate except on state land, where six copies are required. See Rule 1105.004.

INDICATE FORMATION TOPS IN CONFORMANCE WITH GEOGRAPHICAL SECTION OF STATE

Southeastern New Mexico

Northwestern New Mexico

- T. Anhy _____ T. Canyon _____ T. Ojo Alamo _____ T. Penn. "B" _____
T. Salt _____ T. Strawn _____ T. Kirtland-Fruitland _____ T. Penn. "C" _____
B. Salt _____ T. Atoka _____ T. Pictured Cliffs _____ T. Penn. "D" _____
T. Yates _____ T. Miss _____ T. Cliff House _____ T. Leadville _____
T. 7 Rivers _____ T. Devonian _____ T. Menefee _____ T. Madison _____
T. Queen 1311' _____ T. Silurian _____ T. Point Lookout _____ T. Elbert _____
T. Grayburg _____ T. Montoya _____ T. Mancos _____ T. McCracken _____
T. San Andres 1774' _____ T. Simpson _____ T. Gallup _____ T. Ignacio Qtzite _____
T. Glorieta _____ T. McKee _____ Base Greenhorn _____ T. Granite _____
T. Paddock _____ T. Ellenburger _____ T. Dakota _____ T. _____
T. Blinebry _____ T. Gr. Wash _____ T. Morrison _____ T. _____
T. Tubb _____ T. Granite _____ T. Todilto _____ T. _____
T. Drinkard _____ T. Delaware Sand _____ T. Entrada _____ T. _____
T. Abo _____ T. Bone Springs _____ T. Wingate _____ T. _____
T. Wolfcamp _____ T. _____ T. Chinle _____ T. _____
T. Penn. _____ T. _____ T. Permian _____ T. _____
T. Cisco (Bough C) _____ T. _____ T. Penn. "A" _____ T. _____

OIL OR GAS SANDS OR ZONES

- No. 1, from _____ to _____ No. 4, from _____ to _____
No. 2, from _____ to _____ No. 5, from _____ to _____
No. 3, from _____ to _____ No. 6, from _____ to _____

IMPORTANT WATER SANDS

Include data on rate of water inflow and elevation to which water rose in hole.

- No. 1, from _____ to _____ feet _____
No. 2, from _____ to _____ feet _____
No. 3, from _____ to _____ feet _____
No. 4, from _____ to _____ feet _____

FORMATION RECORD (Attach additional sheets if necessary)

Table with 8 columns: From, To, Thickness in Feet, Formation, From, To, Thickness in Feet, Formation. Row 1: Attached Drilling, Time & Sample Log.

PHOENIX RESOURCES COMPANY
No. 1 Powell
Section 23, T-7-S, R-28-E
Chaves County, New Mexico

Elevation: 4012 GL
4020 KB

Location: 660' FNL, 1980' FWL

Casing: 8 5/8" at 406' (KB)

Hole Size: 7 7/8"

TD: 2650' (driller), 2653' (logger)

Logging Program:

Service Company: Dresser-Atlas

1. Sidewall Neutron-GR-Calip.: TD-Surface
2. Dual Laterolog-Rxo: TD-Casing (Note: Three repeats of the San Andres P-1, P-2, and P-3 zones were run.)

Correlations:

Formation	Depth	Datum
T/ Rustler	640	+3380
T/ Salado	662	+3358
T/ Yates Sand	696	+3324
T/ Lower Queen Sand	1311	+2709
T/ San Andres	1774	+2246
T/ Pi Marker	2252	+1768
T/ P-1	2390	+1630
T/ P-2	2472	+1548
T/ P-3	2584	+1436

Zones of Interest:

San Andres:

P-1. The porosity log showed 10 feet of continuous net porosity greater than 6% as calculated for dolomite matrix and 8 feet greater than 8% (maximum - 10%). The zone is from 2330-40 feet. The invasion profile from the saturation log shows fair to good qualitative permeability. Water saturations in that zone range from 25-27%. There were several cases of rough drilling and bit torque in that interval indicating formation fractures and multiple repeats with the Rxo tool did not repeat which also indicates fractures. Samples showed good to excellent intercrystalline and small vugular matrix porosity. The cuttings were quite fine which eliminated evidence of larger vugs. The intercrystalline porosity was so well distributed that some of the dolomite samples were friable which experience has shown to be associated with excellent reservoir conditions. It is highly probable that

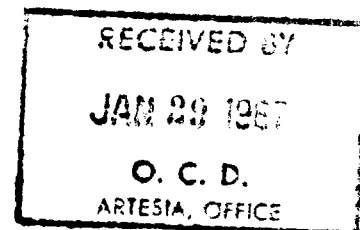

Page 2

this zone will be hydrocarbon productive.

P-2. This interval logged a total of 41 net feet of dolomite porosity greater than 6% (maximum - 18%). There is an upper zone (2481-2520) of 35 net feet and a lower zone (2541-51) of 6 net feet. Water saturations (Sw) in the upper zone ranged from 43-71%. In the lower zone the range was 66-75%. Sample porosity was good to excellent; however, sample stain and fluorescence was only fair. These factors suggest that the P-2 is wet.

P-3. There are 8 net feet of greater than 6% dolomite porosity (maximum - 11%). The water saturations are high (58-65%), the permeability is low, and the samples are limy and tight. The zone is very likely wet.

Queen Sand: Log calculations were made using Rw values based on sidewall core analysis from the #1 Miller-Olsen. The sand calculates to be very highly water saturated.

Yates Sand: The results of log calculations in the Yates Sand were similar to those of the Queen.

Respectfully Submitted,

Stuart D. Hanson
Consulting Geologist

STATE OF NEW MEXICO

ENERGY AND MINERALS DEPARTMENT

OIL CONSERVATION DIVISION

ARTESIA DISTRICT OFFICE

January 6, 1987

P.O. Drawer DD
Artesia, N.M. 8821
PH: 505-748-1283



GARREY CARRUTHERS
GOVERNOR

POST OFFICE BOX 2088
STATE LAND OFFICE BUILDING
SANTA FE, NEW MEXICO 87501
(505) 827-5800

Phoenix Resources Co.
6525 N. Meridian
Oklahoma City, OK 73116

Re: Powell #1
Ut.C 23-7S-28E
Chaves County, N.Mex.

Gentlemen,

According to our records no work has been done on the subject well nor have any reports been received since November 20, 1981.

You are hereby requested to submit a Form C-103 Intent to P & A, with operations to commence within thirty (30) days.

Failure to comply with this request will result in the setting of a hearing, to appear and show cause why the subject well should not be plugged and abandoned in accordance with a Division approved program.

If you have any questions regarding this matter or need assistance please feel free to contact me.

Sincerely,

A handwritten signature in cursive script that reads "Mike Williams".

Mike Williams
Oil & Gas Inspector

MW:br

FIELD TRIP REPORT

P E C T I O N
 C L A S S I F I C A T I O N
 A C C I D E N T
 O U R S
 U A R T E R
 H O U R S

Name Mike Williams Date 9/23/86 Miles 212 District II
 Time of Departure 8:00 Time of Return 3:00 Car No. 9027

In the space below indicate the purpose of the trip and the duties performed, listing wells or leases visited and any action taken.

Signature _____

H O G 3 Z

1 well C-23-7-28 Phoenix Resources Inc Powell #1
 Checked 1 A'd Well - Well TR'd w/
 Hg in hole

H O G 3 Z

1 well m-36-10-26 Paul Slayton Queen Ridge #1
 Well TR'd - Well covered w/ dirt could
 not find well bore. Mr Slayton said
 he cut off well head + welded plate
 on CSG several years ago.

MW + IR

<u>Mileage</u>	<u>Per Diem</u>	<u>Hours</u>
UIC _____	UIC _____	UIC _____
RFA _____	RFA _____	RFA _____
Other <u>212</u>	Other <u>6</u>	Other <u>7</u>

TYPE INSPECTION PERFORMED	INSPECTION CLASSIFICATION	NATURE OF SPECIFIC WELL OR FACILITY INSPECTED
H - Housekeeping P - Plugging C - Plugging Cleanup T - Well Test R - Repair/workover F - Waterflow M - Mishap or Spill W - Water Contamination O - Other	U - Underground Injection Control - Any inspection of or related to injection project, facility, or well or resulting from injection into any well. (SWD, 2ndry injection and production wells, water flows or pressure tests, surface injection equipment, plugging, etc.) R - Inspections relating to Reclamation Fund Activity O - Other - Inspections not related to injection or The Reclamation Fund E - Indicates some form of enforcement action taken in the field (show immediately below the letter U, R or O)	D - Drilling P - Production I - Injection C - Combined prod. inf. operations S - SWD U - Underground Storage G - General Operation F - Facility or location M - Meeting O - Other



PHOENIX RESOURCES COMPANY

3524 N.W. 56, Suite 300, Oklahoma City, Oklahoma 73112 (405) 949-7700

November 18, 1981

RECEIVED

NOV 27 1981

O. C. Z.
SPECIAL AGENT

State of New Mexico
Energy and Minerals Department
Oil Conservation Division
P.O. Drawer DD
Artesia, New Mexico 88210

Attention: Mr. Mike Williams,
Oil & Gas Inspector

Re: Powell #1-C
Sec. 23-7-28
Chaves County, NM

Gentlemen:

Enclosed is the C-103 form for the subject well. We regret any inconvenience this delay may have caused and will advise you of future operations.

Sincerely yours,

T. M. Wadsworth

T. M. Wadsworth
Drilling Manager

TMW:ple
Attachment

1/7/83 - Talked to Phoenix Resources they will get
notice of intent to P&A in ASAP

DISTRIBUTION		
DATE	/	
FILE	/	
U.S.G.S.		
LAND OFFICE		
OPERATOR	/	

NEW MEXICO OIL CONSERVATION COMMISSION

Supplements to
C-102 and C-103
Effective 1-1-65

5a. Indicate Type of Lease
State Fed
5. State Oil & Gas Lease No.

RECEIVED

SUNDRY NOTICES AND REPORTS ON WELLS

(DO NOT USE THIS FORM FOR PROPOSALS TO DRILL OR TO DEEPEN OR PLUG BACK TO A DIFFERENT RESERVOIR. USE "APPLICATION FOR PERMIT -" (FORM C-101) FOR SUCH PROPOSALS.)

1. OIL WELL <input checked="" type="checkbox"/> GAS WELL <input type="checkbox"/> OTHER <input type="checkbox"/>	2. Name of Operator PHOENIX RESOURCES CO. /	7. Unit Agreement Name OV 20 1981
3. Address of Operator 3524 Northwest 56th Street, Suite 300; Oklahoma City, OK 73112	8. Farm or Lease Name C. C. D. ARTESIA, OFFICE	8. Farm or Lease Name Powell
4. Location of Well UNIT LETTER C 660' FEET FROM THE North LINE AND 1,980' FEET FROM THE West LINE, SECTION 23 TOWNSHIP 7S RANGE 28E NMPM.	9. Well No. 1	10. Field and Pool, or Wildcat Wildcat - S.A.
15. Elevation (Show whether DF, RT, GR, etc.) 4,011.6' GR	12. County Chaves	

16. Check Appropriate Box To Indicate Nature of Notice, Report or Other Data

NOTICE OF INTENTION TO:

SUBSEQUENT REPORT OF:

PERFORM REMEDIAL WORK
TEMPORARILY ABANDON
PULL OR ALTER CASING
OTHER

PLUG AND ABANDON
CHANGE PLANS

REMEDIAL WORK
COMMENCE DRILLING OPNS.
CASING TEST AND CEMENT JOB
OTHER

ALTERING CASING
PLUG AND ABANDONMENT

Completion attempt

17. Describe Proposed or Completed Operations (Clearly state all pertinent details, and give pertinent dates, including estimated date of starting any proposed work) SEE RULE 1103.

Date	Activity
3/31/80	MI completion rig. Pressure tested 4½" casing to 1000 psi -- lost 50 psi in 20 minutes. NU BOP. Ran GR/CBL. Perforated San Andres @ 2393' - 2442' (21 Holes Total).
4/1/80	TIH with tubing and packer. Treated perms with 7000 gals. of 20% NEFE acid. Flowed and swabbed 130 BLW.
4/2/80	SITP = 500 psi. Swabbed 60 BW (15 BW over load) and 5 BO.
4/3/80	Squeezed perms at 2393' - 2442' with 50 sks. of cement.
4/4/80	Drilled out cement. Tested perforations to 1000 psi -- lost 50 psi in 15 minutes.
4/5/80	Perforated San Andres @ 2393'- 2436' (15 Holes Total). TIH with tubing and packer. Acidized with 3000 gals. of 20% NEFE acid. Flowed and swabbed 54 BLW.
4/6/80	SITP = 300 psi. Swabbed 30 BLW.
4/7/81	SITP = 150 psi. Swabbed 22 BLW (14 BW over load).

18. I hereby certify that the information above is true and complete to the best of my knowledge and belief.

SIGNED T.M. Wadsworth TITLE _____ DATE _____

APPROVED BY Mike Williams TITLE OIL AND GAS INSPECTOR DATE DEC 11 1981

CONDITIONS OF APPROVAL, IF ANY:

Supplement to Form C-103
for
Powell #1, Chaves Co., N.M.

Date	Activity
4/8/80	RDMO completion rig pending further study.
4/15/80	MI completion rig. NU BOP. Tested tubing-casing annulus to 800 psi -- held Ok.
4/16/80	POOH. Perforated San Andres at 2496' - 2549' (10 Holes Total) and 2582' - 2592' (5 Holes Total). TIH with retrievable bridge plug (RBP) and packer.
4/17/80	Acidized perfs at 2582' - 2592' with 1000 gals. of 20% NEFE acid. Set RBP at 2564'. Set packer at 2560'. While acidizing perfs at 2496' - 2549', had communication develop with annulus*. Moved RBP to 2596'. Set packer at 2564'. Swabbed 27 BW.
4/18/80	SIP = 100 psi. Swabbed 10½ BW.
4/19/80	SIP = Ø. Swabbed 9 BW.
4/20/80	SIP = Ø. Swabbed 3 BW (3½ BW over load). Set RBP at 2565'. Set packer at 2462'. Swabbed 49 BW (38 BW over load).
4/21/80	SIP = Ø. Pulled packer and RBP. Ran tubing in hole. NU tubinghead. RDMO completion rig pending further evaluation.

* 4-1/2" x 2-3/8" annulus.



STATE OF NEW MEXICO
ENERGY AND MINERALS DEPARTMENT
OIL CONSERVATION DIVISION
ARTESIA DISTRICT OFFICE

BRUCE KING
GOVERNOR
LARRY KEHOE
SECRETARY

November 12, 1981

P.O. DRAWER DD
ARTESIA, NEW MEXICO 88210
(505) 746-4861

Phoenix Resources Company
3524 Northwest 56th
Suite 300
Oklahoma City, OK 73112

Re: Powell #1-C
Sec. 23-7S-28E
Chaves County

Gentlemen:

A letter was written April 3, 1981, asking that you submit all necessary reports in order that we might bring our file up to date on the subject well.

As of this date we have not had any response.

Please file these reports as soon as possible.

Sincerely yours,

A handwritten signature in cursive script, appearing to read "Mike Williams".

Mike Williams
Oil & Gas Inspector

MW:jw
Enclosure



STATE OF NEW MEXICO
ENERGY AND MINERALS DEPARTMENT
OIL CONSERVATION DIVISION
ARTESIA DISTRICT OFFICE

April 3, 1981

BRUCE KING
GOVERNOR

LARRY KEHOE
SECRETARY

P.O. DRAWER DD
ARTESIA, NEW MEXICO 88210
(505) 748-1283

Phoenix Resources Company
3524 Northwest 56th
Suite 300
Oklahoma City, OK 73112

Re: Powell #1-C
Sec. 23-7-28
Chaves County, NM

Gentlemen:

As of this date this office has not received a report on the subject well since the running of the 4½" casing dated April 1, 1980. Please submit all necessary reports to bring our file up to date.

If you have any further questions concerning this matter please feel free to call me.

Sincerely yours,

A handwritten signature in cursive script that reads "Mike Williams".

Mike Williams
Oil & Gas Inspector

MW:jw

DISTRIBUTION		
SANTA FE	1	
FILE	1	✓
U.S.G.S.		
LAND OFFICE		
OPERATOR	1	

MEXICO OIL CONSERVATION COMMISSION RECEIVED

Effective 1-1-00

APR 3 1980

5a. Indicate Type of Lease
 State Fee
 5. State Oil & Gas Lease No.

SUNDRY NOTICES AND REPORTS ON WELLS **O. C. D.**

(DO NOT USE THIS FORM FOR PROPOSALS TO DRILL OR TO DEEPEN OR PLUG BACK TO A WELL. USE "APPLICATION FOR PERMIT -" (FORM C-101) FOR SUCH PROPOSALS.)

1. OIL WELL <input checked="" type="checkbox"/> GAS WELL <input type="checkbox"/> OTHER <input type="checkbox"/>	7. Unit Agreement Name
2. Name of Operator PHOENIX RESOURCES COMPANY ✓	8. Farm or Lease Name Powell
3. Address of Operator 3524 Northwest 56th, Suite 300, Oklahoma City, Oklahoma 73112	9. Well No. #1
4. Location of Well UNIT LETTER <u>C</u> , <u>660'</u> FEET FROM THE <u>North</u> LINE AND <u>1980'</u> FEET FROM THE <u>West</u> LINE, SECTION <u>23</u> TOWNSHIP <u>7S</u> RANGE <u>28E</u> NMPM.	10. Field and Pool, or Wildcat Wildcat - S.A.
15. Elevation (Show whether DF, RT, GR, etc.) 4011.6 GR	12. County Chaves

16. Check Appropriate Box To Indicate Nature of Notice, Report or Other Data

NOTICE OF INTENTION TO:

SUBSEQUENT REPORT OF:

PERFORM REMEDIAL WORK <input type="checkbox"/>	PLUG AND ABANDON <input type="checkbox"/>	REMEDIAL WORK <input type="checkbox"/>	ALTERING CASING <input type="checkbox"/>
TEMPORARILY ABANDON <input type="checkbox"/>	CHANGE PLANS <input type="checkbox"/>	COMMENCE DRILLING OPNS. <input type="checkbox"/>	PLUG AND ABANDONMENT <input type="checkbox"/>
PULL OR ALTER CASING <input type="checkbox"/>	OTHER <input type="checkbox"/>	CASING TEST AND CEMENT JOB <input checked="" type="checkbox"/>	OTHER <input type="checkbox"/>

17. Describe Proposed or Completed Operations (Clearly state all pertinent details, and give pertinent dates, including estimated date of starting any proposed work) SEE RULE 1103.

- Set 4½", 10.5#/ft, K-55, ST&C casing at 2636' (GR).
- Cemented with 360 sacks of cement (497 ft³). Calculated TOC at 1500'.
- Tested casing to 1000 psi for 30 minutes with 50 psi pressure loss.

18. I hereby certify that the information above is true and complete to the best of my knowledge and belief.

SIGNED Tom Wadsworth TITLE Drilling Manager DATE April 1, 1980

APPROVED BY W.A. Gassett TITLE SUPERVISOR, DISTRICT II DATE APR 4 1980

CONDITIONS OF APPROVAL, IF ANY:

DISTRIBUTION		
SANTA FE	1	
FILE	1	✓
U.S.G.S.		
LAND OFFICE		
OPERATOR	1	

NEW MEXICO OIL CONSERVATION COMMISSION RECEIVED

Supersedes Old C-102 and C-103 Effective 1-1-65

APR 3 1980

5a. Indicate Type of Lease
 State Fee
 5. State Oil & Gas Lease No.

SUNDRY NOTICES AND REPORTS ON WELLS SANTA FE OFFICE
 (DO NOT USE THIS FORM FOR PROPOSALS TO DRILL OR TO DEEPEN OR PLUG BACK TO A DIFFERENT RESERVOIR. USE "APPLICATION FOR PERMIT -" (FORM C-101) FOR SUCH PROPOSALS.)

O.C.D.

1. OIL WELL GAS WELL OTHER
 2. Name of Operator
 PHOENIX RESOURCES COMPANY ✓
 3. Address of Operator
 3524 Northwest 56th, Suite 300, Oklahoma City, Oklahoma 73112
 4. Location of Well
 UNIT LETTER C 660' FEET FROM THE North LINE AND 1980' FEET FROM
 THE West LINE, SECTION 23 TOWNSHIP 7S RANGE 28E NMPM.

7. Unit Agreement Name
 8. Farm or Lease Name
 Powell
 9. Well No.
 #1
 10. Field and Pool, or Wildcat
 Wildcat - S.A.

15. Elevation (Show whether DF, RT, GR, etc.)
 4011.6 GR

12. County
 Chaves

16. Check Appropriate Box To Indicate Nature of Notice, Report or Other Data
 NOTICE OF INTENTION TO: SUBSEQUENT REPORT OF:

PERFORM REMEDIAL WORK
 TEMPORARILY ABANDON
 FULL OR ALTER CASING
 OTHER
 PLUG AND ABANDON
 CHANGE PLANS
 OTHER

REMEDIAL WORK
 COMMENCE DRILLING OPNS.
 CASING TEST AND CEMENT JOBS
 OTHER
 ALTERING CASING
 PLUG AND ABANDONMENT

17. Describe Proposed or Completed Operations (Clearly state all pertinent details, and give pertinent dates, including estimated date of starting any proposed work) SEE RULE 1102.

- Set 8-5/8", 24#/ft, K-55, ST&C casing at 398' (GR).
- Cemented with 175 sacks of cement (231 ft³), Had 10+ bbls of cement returns. Cement in place at 1630 hours, 3/20/78.
- NU BOP stack. Tested BOP and casing to 750 psi for 30 minutes with no pressure loss at 1030 hours, 3/21/80.

18. I hereby certify that the information above is true and complete to the best of my knowledge and belief.

SIGNED Tom Wadsworth TITLE Drilling Manager DATE April 1, 1980

APPROVED BY W.A. Suscott TITLE SUPERVISOR, DISTRICT II DATE APR 4 1980

CONDITIONS OF APPROVAL, IF ANY:

30-005-60668
Form C-101
Revised 10-1-78

NO. OF COPIES RECEIVED	
DISTRIBUTION	
SANTA FE	<input checked="" type="checkbox"/>
FILE	<input checked="" type="checkbox"/>
U.S.G.S.	<input checked="" type="checkbox"/>
LAND OFFICE	
OPERATOR	

RECEIVED
FEB 25 1980
O. C. D.

5A. Indicate Type of Lease
STATE FEE

5. State Oil & Gas Lease No.

APPLICATION FOR PERMIT TO DRILL, DEEPEN, OR PLUG BACK WELLS

1a. Type of Work
b. Type of Well DRILL DEEPEN PLUG BACK
OIL WELL GAS WELL OTHER
SINGLE ZONE MULTIPLE ZONE

7. Unit Agreement Name

2. Name of Operator
Phoenix Resources Company

8. Farm or Lease Name
Powell

3. Address of Operator
c/o Oil Reports & Gas Services, Inc., Box 763, Hobbs, N M 88240

9. Well No.
1

4. Location of Well
UNIT LETTER **C** LOCATED **660** FEET FROM THE **North** LINE

10. Field and Pool, or Wildcat
Wildcat SA

AND **1980** FEET FROM THE **West** LINE OF SEC. **23** TWP. **7S** RGE. **28E** NMPM

12. County
Chaves

19. Proposed Depth **3200** 19A. Formation **San Andres** 20. Rotary or C.T. **Rotary**

21. Elevations (show whether DF, RT, etc.) **4011.6** 21A. Kind & Status Plug. Bond **Blanket** 21B. Drilling Contractor **Baber Well Service** 22. Approx. Date Work will start **3/11/80**

PROPOSED CASING AND CEMENT PROGRAM

SIZE OF HOLE	SIZE OF CASING	WEIGHT PER FOOT	SETTING DEPTH	SACKS OF CEMENT	EST. TOP
11	8 5/8	24#	250-400*	150	circ.
6 3/4	4 1/2	10.5#	3200	250	1400

Completion to be conventional perforation & treatment.

Blowout preventor: 10" series 900 Shafer double ram.

APPROVAL VOID
FOR 60 DAYS UNLESS
DRILLING COMMENCED,
EXPIRES 5-28-80

ON ABOVE SPACE DESCRIBE PROPOSED PROGRAM; IF PROPOSAL IS TO DEEPEN OR PLUG BACK, GIVE DATA ON PRESENT PRODUCTIVE ZONE AND PROPOSED NEW PRODUCTIVE ZONE. GIVE BLOWOUT PREVENTER PROGRAM, IF ANY.

I hereby certify that the information above is true and complete to the best of my knowledge and belief.

Signed W. A. Gressett Title Agent Date 2/22/80

(This space for State Use)

APPROVED BY W. A. Gressett TITLE SUPERVISOR, DISTRICT II DATE FEB 28 1980

CONDITIONS OF APPROVAL, IF ANY:

* as stated above

MEXICO OIL CONSERVATION COMMISSION
WELL LOCATION AND ACREAGE DEDICATION PLAT

Form C-102
 Supersedes C-128
 Effective 1-1-65

All distances must be from the outer boundaries of the Section.

Operator Phoenix Resources Co.			Lease Powell		Well No. 1
Unit Letter C	Section 23	Township 7 South	Range 28 East	County Chaves	
Actual Footage Location of Well: 660 feet from the North line and 1980 feet from the West line					
Ground Level Elev. 4011.6	Producing Formation San Andres	Pool Wildcat SA	Dedicated Acreage: 40 Acres		

1. Outline the acreage dedicated to the subject well by colored pencil or hachure marks on the plat below.
2. If more than one lease is dedicated to the well, outline each and identify the ownership thereof (both as to working interest and royalty).
3. If more than one lease of different ownership is dedicated to the well, have the interests of all owners been consolidated by communitization, unitization, force-pooling, etc?

RECEIVED
FEB 25 1980
O. C. D.
 ARTESIA, OFFICE

Yes No If answer is "yes," type of consolidation _____

If answer is "no," list the owners and tract descriptions which have actually been consolidated. (Use reverse side of this form if necessary.) _____

No allowable will be assigned to the well until all interests have been consolidated (by communitization, unitization, forced-pooling, or otherwise) or until a non-standard unit, eliminating such interests, has been approved by the Commission.

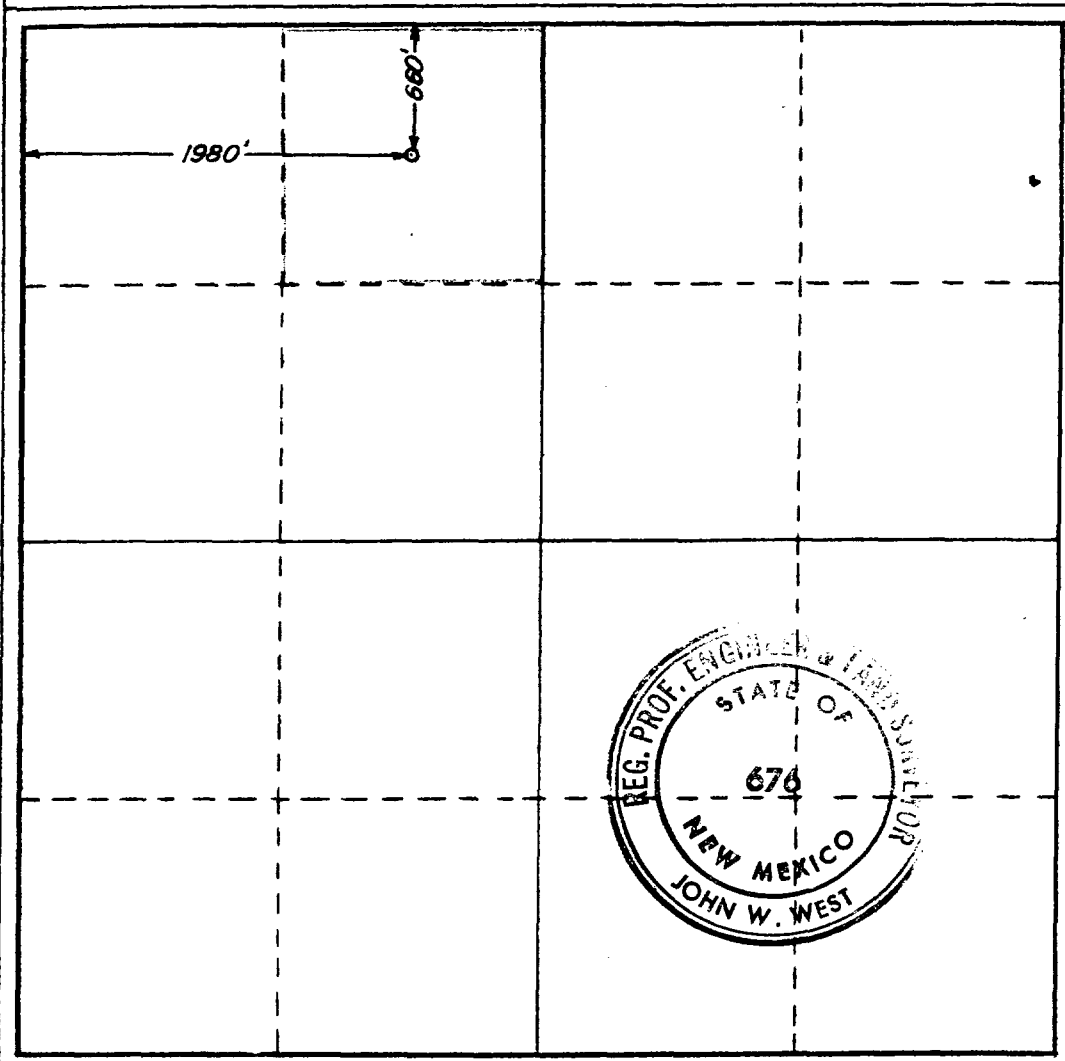

CERTIFICATION

I hereby certify that the information contained herein is true and complete to the best of my knowledge and belief.

Name
Barbara Walker
 Position
Agent
 Company
Phoenix Resources Company
 Date
2/22/80

I hereby certify that the well location shown on this plat was plotted from field notes of actual surveys made by me or under my supervision, and that the same is true and correct to the best of my knowledge and belief.

Date Surveyed
February 19, 1980
 Registered Professional Engineer
 and/or Land Surveyor

John W. West
 Certificate No. **JOHN W. WEST 676**
PATRICK A. ROMERO 6863
Ronald J. Eidson 3239

