

STATE OF NEW MEXICO
ENERGY AND MINERALS DEPARTMENT

OIL CONSERVATION DIVISION

P. O. BOX 2088

SANTA FE, NEW MEXICO 87501

OCT 22 1981

Form C-101
Revised 10-1-78

NO. OF COPIES RECEIVED	
DATE OF RECEIPT	
SANTA FE	
FILE	<input checked="" type="checkbox"/>
U.S.G.S.	
LAND OFFICE	
OPERATOR	

6A. Indicate Type of Lease

STATE ☐

FEE ☒

6. State Oil & Gas Lease No.

OIL CONSERVATION DIVISION
SANTA FE

APPLICATION FOR PERMIT TO DRILL, DEEPEN, OR PLUG BACK

a. Type of Work		7. Unit Agreement Name	
b. Type of Well OIL WELL <input checked="" type="checkbox"/> GAS WELL <input type="checkbox"/> OTHER <input type="checkbox"/>		8. Farm or Lease Name Ute Anticline	
c. Name of Operator National Oil Company		9. Well No. 1	
d. Address of Operator 1350 Seventeenth Street, Ste 200 Market Ctr., Denver, CO 80202		10. Field and Pool, or Wildcat Wildcat	
e. Location of Well UNIT LETTER A LOCATED 660 FEET FROM THE north LINE NO 660 FEET FROM THE east LINE OF SEC. 11 TWP. 12N RGE. 32E NMPM		12. County Quay	
19. Proposed Depth 3700'		19A. Formation San Andres/Permian	
20. Rotary or C.T. Rotary		21. Elevations (Show whether DF, RT, etc.) 4063' GL, 4073' KB	
21A. Kind & Status Plug. Bond Blanket #371F6865		21B. Drilling Contractor Swanson Drlg.	
22. Approx. Date Work will start 11/10/81			

PROPOSED CASING AND CEMENT PROGRAM

SIZE OF HOLE	SIZE OF CASING	WEIGHT PER FOOT	SETTING DEPTH	SACKS OF CEMENT	EST. TOP
10 3/4	8 5/8"	24# J-55	700'	300 sxs	surface
7 7/8	4 1/2"	14#	3700'	375 sxs	2800'

National Oil Company proposes to drill a 3700' Permian test where uphole potential may also exist in the San Andres Limestone. A fresh water mud system will be used. Standard annular and blind ram BOP's will be used. If the San Andres appears to be productive, a differential fill float collar will be run 50' below the base of the San Andres in the casing string.

APPROVAL VALID FOR 90 DAYS
PERMIT EXPIRES 1-21-82
UNLESS DRILLING UNDERWAY

COLLECT AND PLACE COPIES FOR
NEW MEXICO DEPARTMENT OF MINES, GEOLOGY
AT AT LEAST TEN FOOT INTERVALS

ABOVE SPACE DESCRIBE PROPOSED PROGRAM: IF PROPOSAL IS TO DEEPEN OR PLUG BACK, GIVE DATA ON PRESENT PRODUCTIVE ZONE AND PROPOSED NEW PRODUCTIVE ZONE. GIVE BLOWOUT PREVENTER PROGRAM, IF ANY.

I hereby certify that the information above is true and complete to the best of my knowledge and belief.

Signed Ron Pocham Title Drilling & Production Manager Date 10/19/81

(This space for State Use)

APPROVED BY SENIOR PETROLEUM GEOLOGIST DATE 10-22-81

CONDITIONS OF APPROVAL, IF ANY:

OIL CONSERVATION COMMISSION TO BE NOTIFIED
WITHIN 24 HOURS OF BEGINNING OPERATIONS

NEW MEXICO OIL CONSERVATION COMMISSION
WELL LOCATION AND ACREAGE DEDICATION PLAT

OCT 22 1981

All distances must be from the outer boundaries of the Section

OIL CONSERVATION DIVISION

SANTA FE

National Oil Company		Ute Anticline		SANTA FE	
Unit Letter	Section	Township	Range	County	
	11	12-N	32-E	Quay	
Actual Surface Location of Well:					
660		NORTH		660	
feet from the		line and		feet from the	
				EAST	
				line	
Ground Level Elev.	Producing Formation	Pool		Dedicated Acreage:	
4063.16				Acres	

1. Outline the acreage dedicated to the subject well by colored pencil or hatchure marks on the plat below.
2. If more than one lease is dedicated to the well, outline each and identify the ownership thereof (both as to working interest and royalty).
3. If more than one lease of different ownership is dedicated to the well, have the interests of all owners been consolidated by communitization, unitization, force-pooling, etc?

☐ Yes ☐ No If answer is "yes," type of consolidation _____

If answer is "no," list the owners and tract descriptions which have actually been consolidated. (Use reverse side of this form if necessary.) _____

No allowable will be assigned to the well until all interests have been consolidated (by communitization, unitization, forced-pooling, or otherwise) or until a non-standard unit, eliminating such interests, has been approved by the Commission.

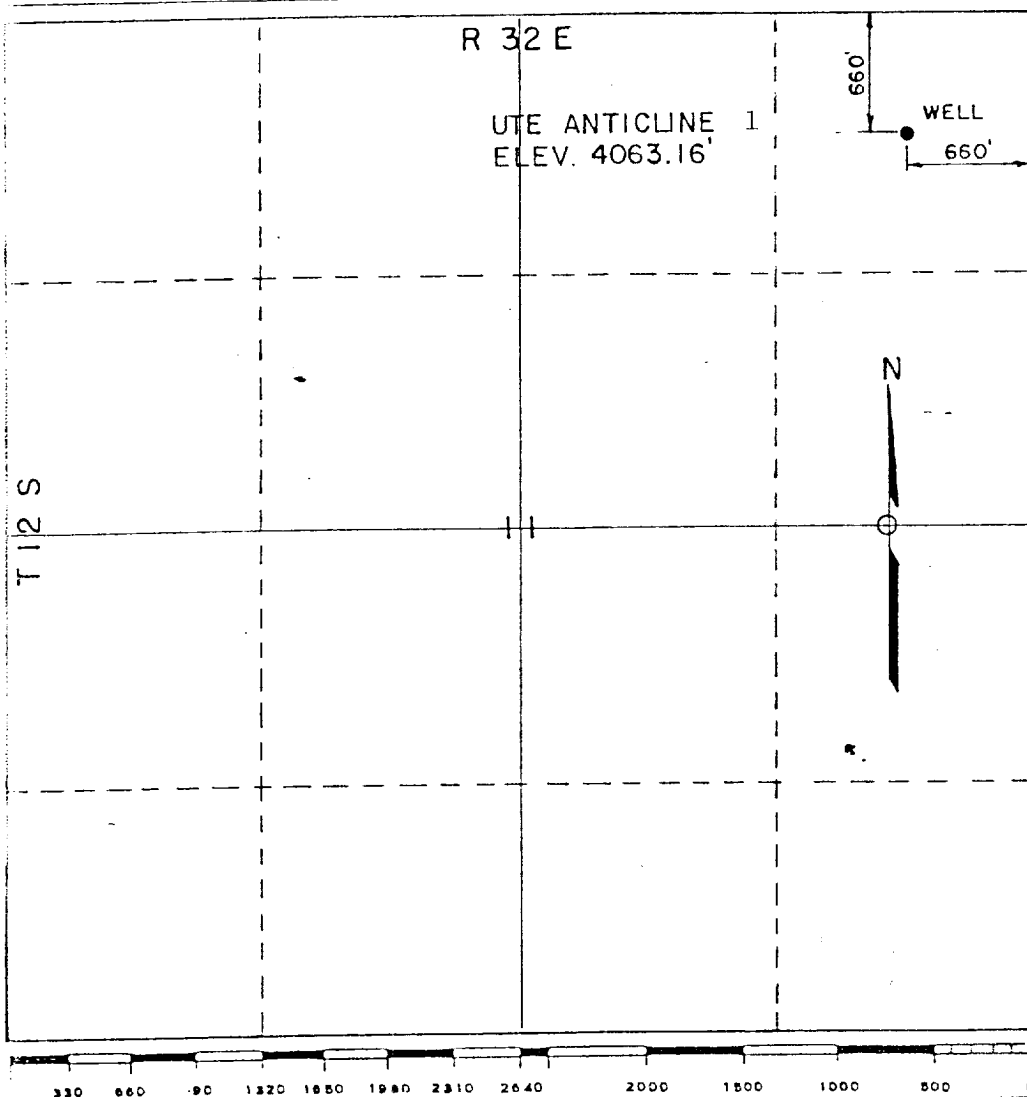

CERTIFICATION

I hereby certify that the information contained herein is true and complete to the best of my knowledge and belief.

Name _____

Position _____

Company _____

Date _____

I hereby certify that the well location shown on this plat was plotted from field notes of actual surveys made by me or under my supervision, and that the same is true and correct to the best of my knowledge and belief.

October 8, 1981

Date Surveyed _____

Registered Professional Engineer and/or Land Surveyor

Thomas T. Mann, P.E. & L.S.

N.M. License No. 277
Certificate No.