

STATE OF NEW MEXICO
ENERGY AND MINERALS DEPARTMENT

OIL CONSERVATION DIVISION

Form C-101
Revised 10-1-78

NO. OF COPIES RECEIVED	
DISTRIBUTION	
SANTA FE	
FILE	✓
U.S.G.S.	
LAND OFFICE	
OPERATOR	

P. O. BOX 2088
SANTA FE, NEW MEXICO 87501

API #
30-037-20023

OCT 22 1981

OIL CONSERVATION DIVISION

SANTA FE

1. Indicate Type of Lease
STATE ☒ FEE ☐
2. State Oil & Gas Lease No.
LG-4977

APPLICATION FOR PERMIT TO DRILL, DEEPEN, OR PLUG BACK

a. Type of Work DRILL <input checked="" type="checkbox"/> DEEPEN <input type="checkbox"/> PLUG BACK <input type="checkbox"/>		7. Unit Agreement Name
b. Type of Well OIL WELL <input checked="" type="checkbox"/> GAS WELL <input type="checkbox"/> OTHER <input type="checkbox"/> SINGLE ZONE <input type="checkbox"/> MULTIPLE ZONE <input type="checkbox"/>		8. Farm or Lease Name Columbine State
2. Name of Operator National Oil Company		9. Well No. 1
3. Address of Operator 1350 Seventeenth Street, Ste 200 Market Ctr., Denver, CO 80202		10. Field and Pool, or Wildcat Wildcat
4. Location of Well UNIT LETTER N LOCATED 1980 FEET FROM THE west LINE AND 660 FEET FROM THE south LINE OF SEC. 32 TWP. 13N RGE. 32E NMPM		12. County Quay
19. Proposed Depth 3700'		19A. Formation San Andres/Permian
20. Rotary or C.T. Rotary		
21. Elevations (Show whether DF, RT, etc.) 3955' GL, 3965' KB	21A. Kind & Status Plug. Bond Blanket #371F6865	21B. Drilling Contractor Swanson Drlg.
22. Approx. Date Work will start 11/1/81		

PROPOSED CASING AND CEMENT PROGRAM

SIZE OF HOLE	SIZE OF CASING	WEIGHT PER FOOT	SETTING DEPTH	SACKS OF CEMENT	EST. TOP
10 3/4	8 5/8"	24# J-55	700'	300 sxs	surface
7 7/8	4 1/2"	14#	3700'	375 sxs	2800'

National Oil Company proposes to drill a 3700' Permian test where uphole potential may also exist in the San Andres Limestone. A fresh water mud system will be used. Standard annular and blind ram BOP's will be used. If the San Andres appears to be productive, a differential fill float collar will be run 50' below the base of the San Andres in the casing string.

APPROVAL VALID FOR 90 DAYS
PERMIT EXPIRES 1-21-82
UNLESS DRILLING UNDERWAY

COLLECT AND LOG SAMPLES FOR
NEW MEXICO BUREAU OF MINES, SOCORRO
AT AT LEAST TEN FOOT INTERVALS

ABOVE SPACE DESCRIBE PROPOSED PROGRAM: IF PROPOSAL IS TO DEEPEN OR PLUG BACK, GIVE DATA ON PRESENT PRODUCTIVE ZONE AND PROPOSED NEW PRODUCTIVE ZONE. GIVE BLOWOUT PREVENTER PROGRAM, IF ANY.

I hereby certify that the information above is true and complete to the best of my knowledge and belief.

Signed Ron Pacham Title Drilling & Production Manager Date 10/19/81

(This space for State Use)

Carl Ulvog

SENIOR PETROLEUM GEOLOGIST

APPROVED BY Carl Ulvog TITLE SENIOR PETROLEUM GEOLOGIST DATE 10-22-81

CONDITIONS OF APPROVAL, IF ANY:

OIL CONSERVATION COMMISSION TO BE NOTIFIED
WITHIN 24 HOURS OF BEGINNING OPERATIONS

NEW MEXICO OIL CONSERVATION COMMISSION
WELL LOCATION AND ACREAGE DEDICATION

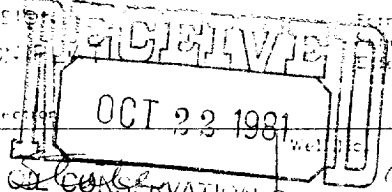

All distances must be from the outer boundaries of the Section

Operator <i>National Oil Company</i>		Lease <i>Columbine</i>		Conservation Division <i>SANTA FE</i>	
Well Letter	Section 32	Township 13-N	Range 32-E	County Quay	

Aerial Footage Location of Well:

1980	feet from the WEST	line and	660	feet from the SOUTH	line
Ground Level Elev. 3955.29	Producing Formation		Pool	Dedicated Acreage: Acres	

1. Outline the acreage dedicated to the subject well by colored pencil or hatchure marks on the plat below.
2. If more than one lease is dedicated to the well, outline each and identify the ownership thereof (both as to working interest and royalty).
3. If more than one lease of different ownership is dedicated to the well, have the interests of all owners been consolidated by communitization, unitization, force-pooling, etc?

☐ Yes ☐ No If answer is "yes," type of consolidation _____

If answer is "no," list the owners and tract descriptions which have actually been consolidated. (Use reverse side of this form if necessary.) _____

No allowable will be assigned to the well until all interests have been consolidated (by communitization, unitization, forced-pooling, or otherwise) or until a non-standard unit, eliminating such interests, has been approved by the Commission.

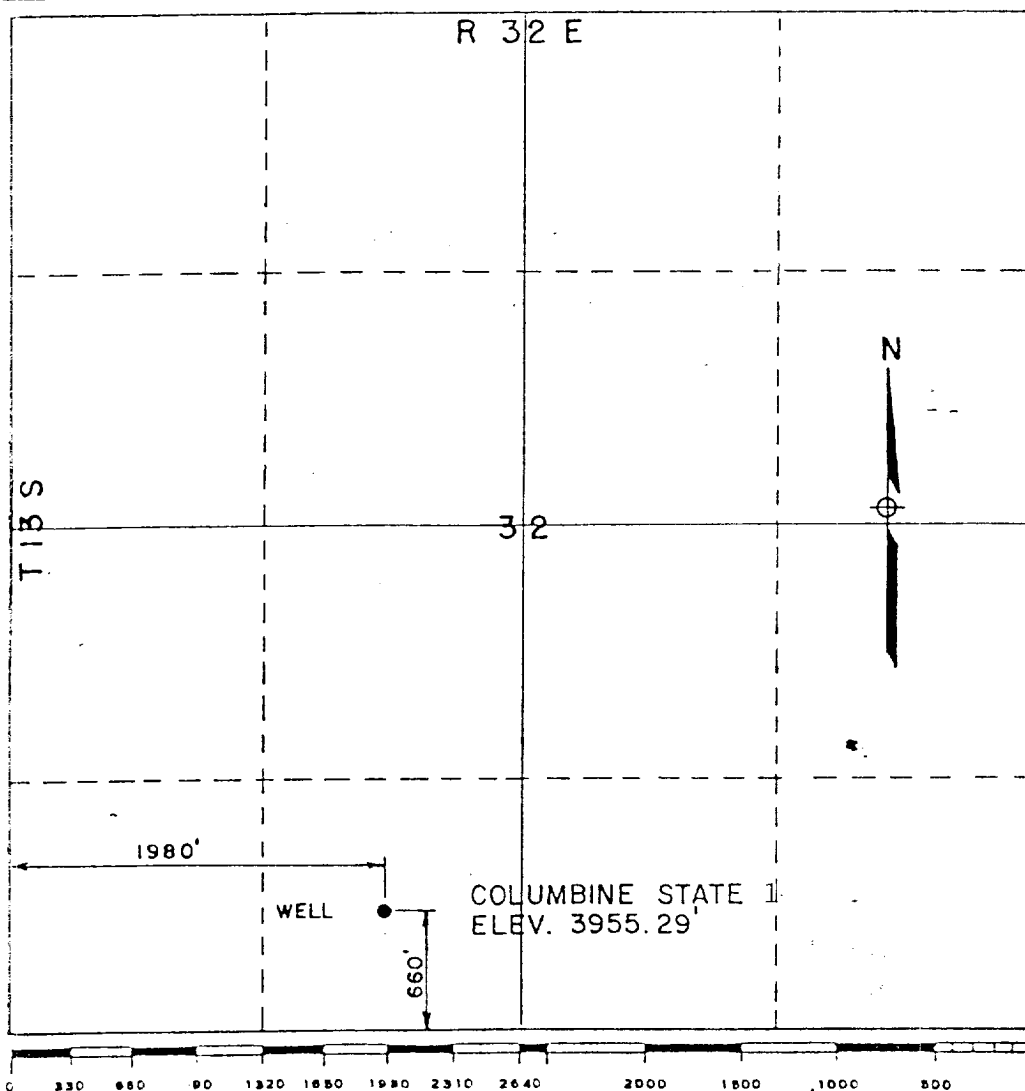

CERTIFICATION	
I hereby certify that the information contained herein is true and complete to the best of my knowledge and belief.	
Name	
Position	
Company	
Date	
I hereby certify that the well location shown on this plat was plotted from field notes of actual surveys made by me or under my supervision, and that the same is true and correct to the best of my knowledge and belief.	
October 22, 1981	
Date Surveyed	
Registered Professional Engineer and/or Land Surveyor Thomas T. Mann E.&L.S. N.M. License No. 277 Certificate No.	