

OIL CONSERVATION DIVISION

Form C-101
Revised 10-1-78

NO. OF COPIES RECEIVED	
DISTRIBUTION	
SANTA FE	
FILE	✓
U.S.G.S.	
LAND OFFICE	
OPERATOR	

P. O. BOX 2088

SANTA FE, NEW MEXICO 87001

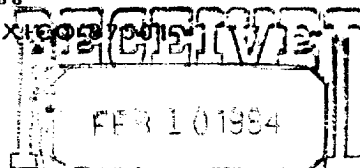
API #
30.037-20033

3. A. Indicate Type of Lease

STATE ☐FEE ☒

3. State Oil & Gas Lease No.

APPLICATION FOR PERMIT TO DRILL, DEEPEN, OR PLUG BACK OIL CONSERVATION DIVISION

1a. Type of Work

SANTA FE

b. Type of Well

DRILL ☒DEEPEN ☐PLUG BACK ☐OIL WELL ☐GAS WELL ☒

OTHER

SINGLE ZONE ☐MULTIPLE ZONE ☐

2. Name of Operator

Yates Petroleum Corporation

3. Address of Operator

207 S. 4th, Artesia, New Mexico 88210

4. Location of Well

UNIT LETTER H

LOCATED 1980

FEET FROM THE North LINE

AND

660

FEET FROM THE

East

LINE OF SEC. 31

TWP. 11N

RCC. 27E

NADP

7. Unit Agreement Name

8. Farm or Lease Name

T-4 Cattle Co.

9. Well No.

3

10. Field and Pool, or Wildcat

Undes. Penn

17. County

Quay

19. Proposed Depth

7600'

19A. Formation

Penn

20. Rotary or C.T.

Rotary

21. Elevations (Show whether DF, KT, etc.)

4367'

21A. Kind & Status Plug. Bond

Blanket

21B. Drilling Contractor

Landis #4

22. Approx. Date Work will start

ASAP

23.

PROPOSED CASING AND CEMENT PROGRAM

SIZE OF HOLE	SIZE OF CASING	WEIGHT PER FOOT	SETTING DEPTH	SACKS OF CEMENT	EST. TOP
17 1/2"	13 3/8"	H-40	350'	350 sx	circ
12 1/4"	9 5/8"	36# K-55	3000'	400 sx	
7 7/8"	5 1/2"	15.5# K-55	TD	250 sx	

We propose to drill and test the Penn formations. Approximately 350' of surface casing will be set and cement circulated to shut off gravel and caving. If commercial, production casing will be run and cemented with adequate cover, perforated and stimulated for production.

MUD PROGRAM: Surface to 350', FW gel/LCM 8.4-9.0/gal, vis 33-35; 3000' FW 8.4#/gal vis-min; TD SW gel/starch, 9.0-9.9, vis 40 WL 15 min.

BOP PROGRAM: BOP's will be installed at the offset and tested daily.

COLLECT AND SACK SAMPLES FOR
NEW MEXICO BUREAU OF MINES, SOCORRO
AT AT LEAST TEN FOOT INTERVALS

APPROVAL VALID FOR 90 DAYS
PERMIT EXPIRES 5-14-84
UNLESS DRILLING UNDERWAY

IN ABOVE SPACE DESCRIBE PROPOSED PROGRAM; IF PROPOSAL IS TO DEEPEN OR PLUG BACK, GIVE DATA ON PRESENT PRODUCTIVE ZONE AND PROPOSED NEW PRODUCTIVE ZONE. GIVE BLOWOUT PREVENTER PROGRAM, IF ANY.

I hereby certify that the information above is true and complete to the best of my knowledge and belief.

Signed Glenn Kolberg Title Regulatory Agent

Date 2/7/84

(This space for State Use)

APPROVED BY Carl W. Long

TITLE

DISTRICT SUPERVISOR

DATE

2-14-84

CONDITIONS OF APPROVAL, IF ANY:

OIL CONSERVATION COMMISSION TO BE NOTIFIED
WITHIN 24 HOURS OF BEGINNING OPERATIONS

NEW MEXICO OIL CONSERVATION COMMISSION
WELL LOCATION AND ACREAGE DEDICATION PLAT

Form C-102
Supersedes C-128
Effective 1-1-65

All distances must be from the outer boundaries of the Section.

Operator <i>Yates Petroleum Corporation</i>			Lease <i>T-4 Cattle Company</i>			Well No. <i>3</i>
Alt. Letter <i>H</i>	Section <i>31</i>	Township <i>11 North</i>	Range <i>27 East</i>	County <i>Guay County</i>		
Well Location of Well: <i>1980</i> feet from the <i>North</i> line and <i>660</i> feet from the <i>East</i> line						
Sound Level Elev. <i>4367</i>	Producing Formation <i>Penn</i>		Pool <i>Undesignated Penn</i>		Dedicated Acreage <i>40</i>	

1. Outline the acreage dedicated to the subject well by colored pencil or hatchure marks on the plat below.
2. If more than one lease is dedicated to the well, outline each and identify the ownership thereof (both as to working interest and royalty).
3. If more than one lease of different ownership is dedicated to the well, have the interests of all owners been consolidated by communitization, unitization, force-pooling, etc?

☐ Yes ☐ No If answer is "yes," type of consolidation _____

If answer is "no," list the owners and tract descriptions which have actually been consolidated. (Use reverse side of this form if necessary.) _____

No allowable will be assigned to the well until all interests have been consolidated (by communitization, unitization, forced-pooling, or otherwise) or until a non-standard unit, eliminating such interests, has been approved by the Commission.

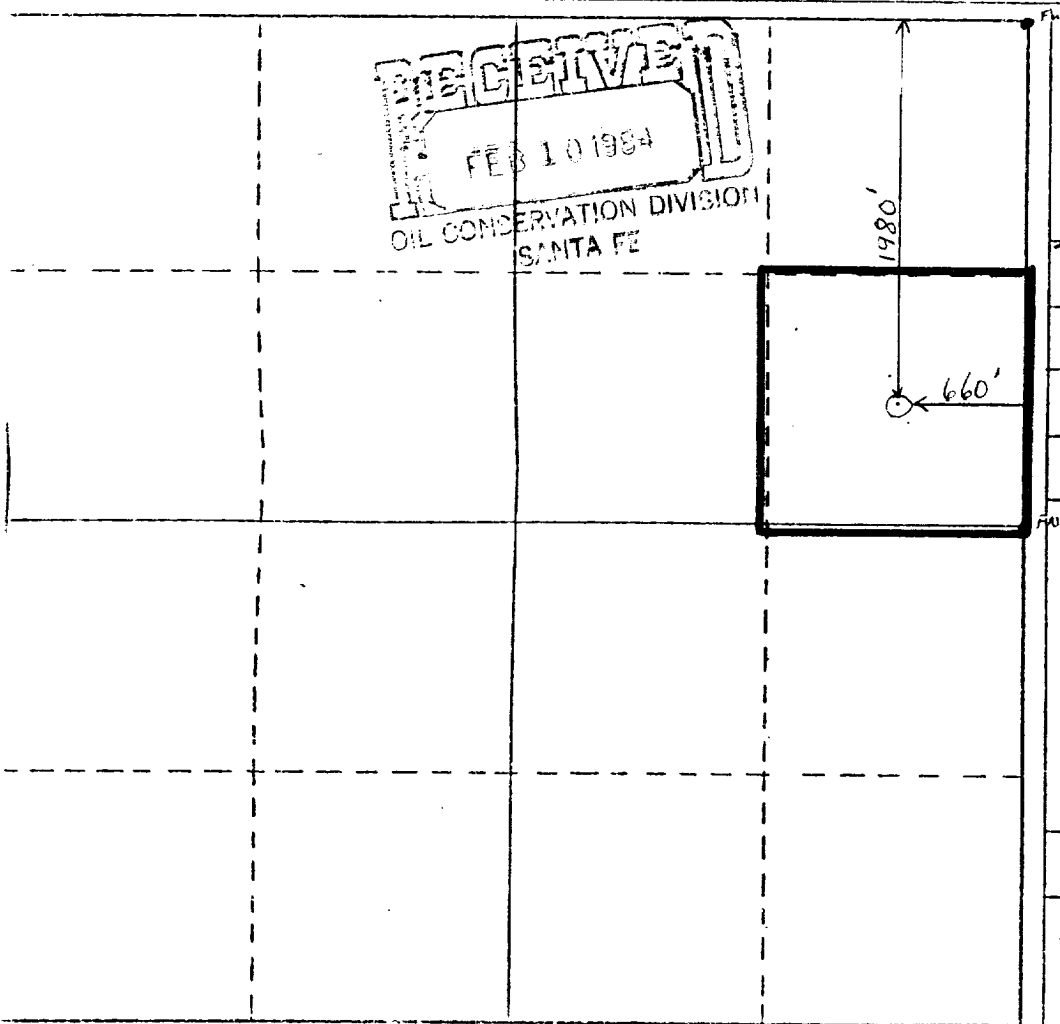

CERTIFICATION

I hereby certify that the information contained herein is true and complete to the best of my knowledge and belief.

Gliserio Rodriguez
Name
Gliserio Rodriguez

Position
Regulatory Agent

Company
Yates Petroleum Corp.

Date
2/7/84

I hereby certify that the well location shown on this plat was plotted from field notes of actual surveys made by me or under my supervision, and that the same is true and correct to the best of my knowledge and belief.

Rod A. Billingsley
Date Surveyed
2-2-1983
Registered Professional Engineer and Land Surveyor
Certificate _____

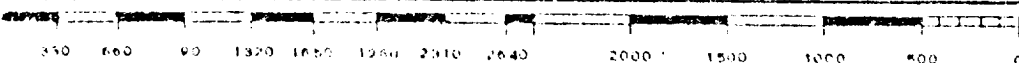

EXHIBIT B

BDP DIAGRAM

