

**NEW MEXICO OIL CONSERVATION COMMISSION
WELL LOCATION AND ACREAGE DEDICATION PLAT**

Form C-102
Supersedes C-128
Effective 1-1-65

All distances must be from the outer boundaries of the Section.

Operator AMOCO PRODUCTION COMPANY			Lease BRAVO DOME CARBON DIOXIDE GAS UNIT		Well No. 1735 201G
Unit Letter G	Section 20	Township T17N	Range R35E	County QUAY	
Actual Footage Location of Well: <div style="display: flex; justify-content: space-between;"> 2310 feet from the NORTH line and 2310 feet from the EAST line </div>					
Ground Level Elev. 4560	Producing Formation TUBB	Pool BRAVO DOME 640 ACRE AREA		Dedicated Acreage: 640 Acres	

1. Outline the acreage dedicated to the subject well by colored pencil or hachure marks on the plat below.
2. If more than one lease is dedicated to the well, outline each and identify the ownership thereof (both as to working interest and royalty).
3. If more than one lease of different ownership is dedicated to the well, have the interests of all owners been consolidated by communitization, unitization, force-pooling, etc?

☒ Yes ☐ No If answer is "yes," type of consolidation **UNITIZATION**

If answer is "no," list the owners and tract descriptions which have actually been consolidated. (Use reverse side of this form if necessary.) _____

No allowable will be assigned to the well until all interests have been consolidated (by communitization, unitization, forced-pooling, or otherwise) or until a non-standard unit, eliminating such interests, has been approved by the Commission.

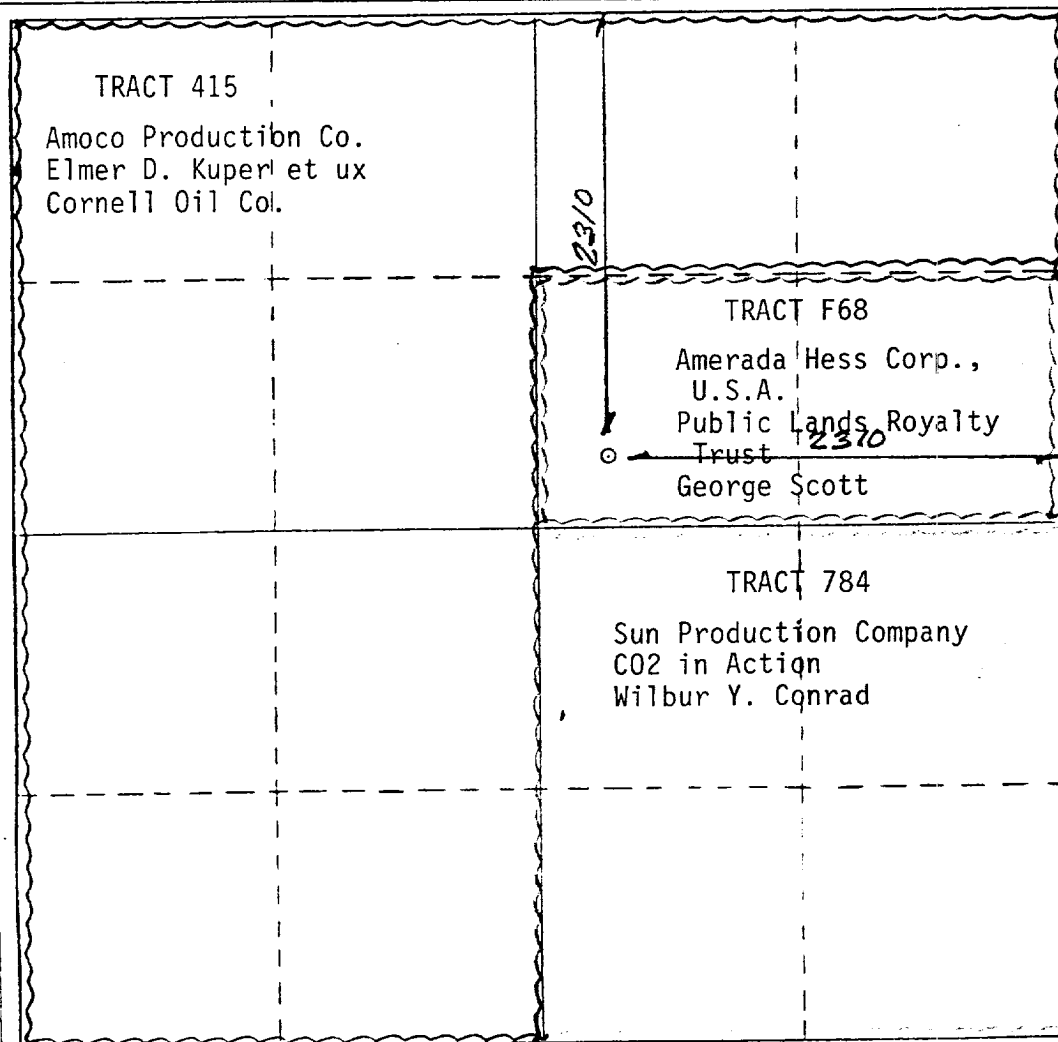

CERTIFICATION

I hereby certify that the information contained herein is true and complete to the best of my knowledge and belief.

Name *Danny Holcomb*
 Position **ADMINISTRATIVE SUPERVISOR**
 Company **AMOCO PRODUCTION COMPANY**
 Date **3-15-85**

I hereby certify that the well location shown on this plat was plotted from field notes of actual surveys made by me or under my supervision, and that the same is true and correct to the best of my knowledge and belief.

MARCH 6, 1985

Date Surveyed _____
[Signature]
 Registered Professional Engineer
 and/or Land Surveyor

N.M.L.S. NO. 5103
 Certificate No.