

General Minerals

916 NINTH STREET

TELEPHONE 723 8895 OR 767 5775

WICHITA FALLS TEXAS 76301

DST No. 1

July 25th 1971

Frank Chappell Jr No. 1

Sec. 13 T12N R29E

San Miguel County N.M.

Depth 3633 - 3663

Tool open 1 hr. 15 min shut in

ISIP 1050

FSIP 1270

IFP 250

FFP 290

Hyd. 1850

ILLEGIBLE

Rec. gas to surface 3 min est.
Flow 500,000 cu ft. Rec. 90 ft gas
cut mud.

P. O. BOX 6785
ODESSA, TEXAS

No. 2400

DATE 8-7-71

TEST TICKET

COMPANY

BASE

ELD

MAIL INVOICES TO

MAIL CHARTS TO

ORDER NO.

DISTRICT

WELL NO.

TEST NO.

COUNTY

STATE

FORMATION

TOTAL DEPTH

PACKER DEPTH

INTERVAL TESTED

ELEVATION

ANCHOR LENGTH

PIPE I.D.

DRILL COLLAR I.D.

TOTAL DC LENGTH

PIPE JT.

DRILL COLLAR JT.

MAIN HOLE

RAT HOLE

PACKER SET

P.M. PACKER SET

HRS.

MINS.

PRE FLOW TIME

MINS.

INITIAL FLOW

MINS.

2ND FLOW PERIOD

MINS.

FINAL FLOW

MINS.

INITIAL SHUT IN

MINS.

2ND SHUT IN TIME

MINS.

FINAL SHUT IN

MINS.

ORDER TYPE

CAPACITY

NUMBER: TOP BOTTOM

RECORDER DEPTH

4927

BOTTOM RECORDER DEPTH

4932

W. TEMP.

TEMP. DEPTH

CHOKE SIZE: TOP

BOTTOM

FLUID TYPE

MUD WEIGHT

9.6

VISCOSITY

45

FILTER CAKE

3/32

WTR. LOSS N.C.

FLUID CUSHION TYPE

AMOUNT

REVERSED OUT

NO YES

SURFACE ACTION

open with a good blow

TEST REMARKS

TEST RECOVERY

Recovered 2600' Gas in Drill pipe. 190' Fluid
0' Free Oil. 180' Oil & Gas cut mud
I Hyd 2384 I SIP 2094 IF 210
FF 252 F SIP 2305 IF Hyd 2386

FLUID SAMPLER DATA

SECOND ASSEMBLY

NO

ROTARY JAR

NO

SAFETY JOINT

NO

SELECTIVE ZONE TOOL

NO

TYPE PACKER

B.T. SIZE 6 3/4

NUMBER

1

PERFORATION LENGTH

25'

ANALYSIS REQUIRED YES

NO

RESERVOIR FLUID SAMPLER

F.F.E. MULTIPLE FLOW TOOL

COMPANY REPRESENTATIVE

(PLEASE PRINT)

OPERATOR

SIGNED

B. Chavis

Sam P. Kiel

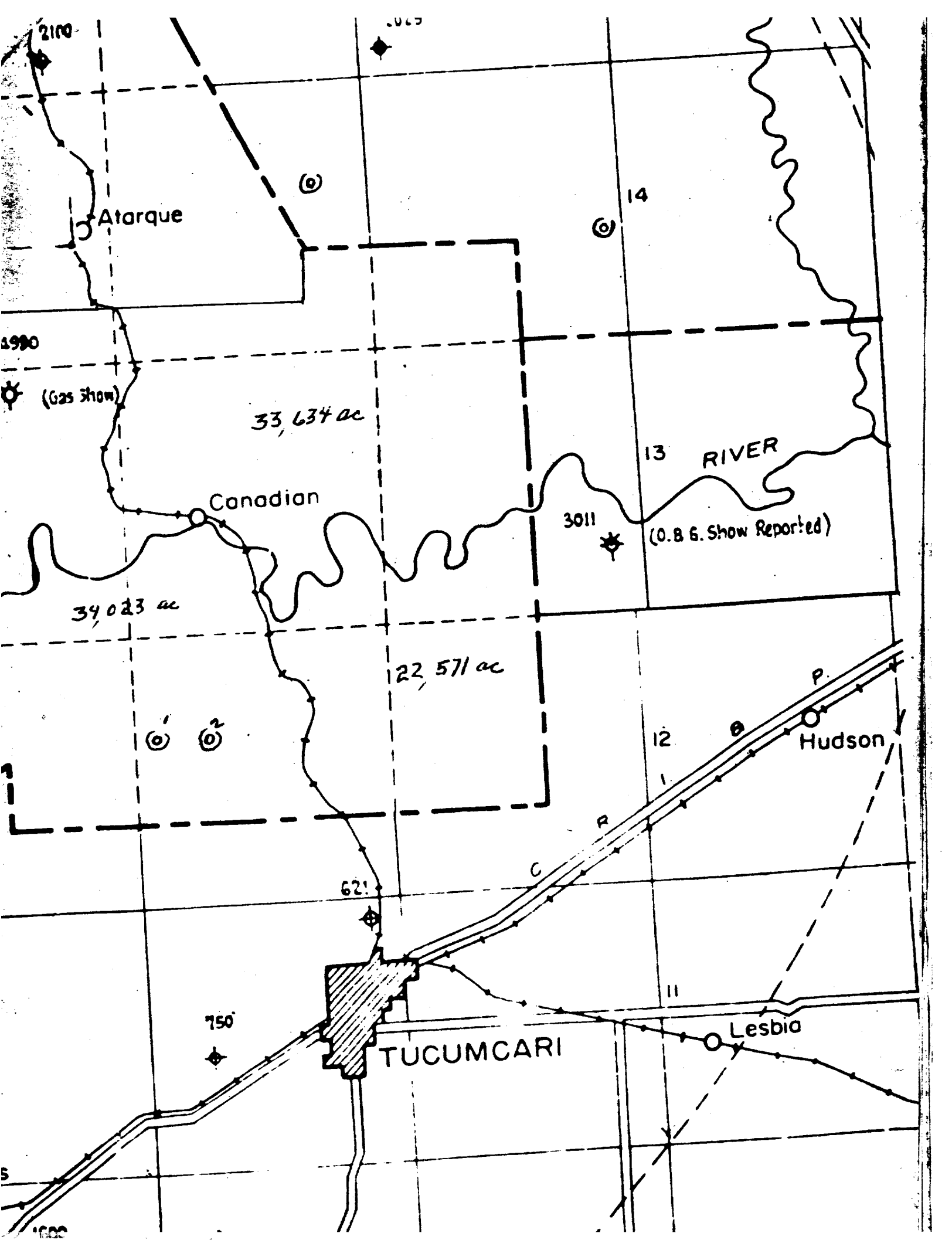

WELL COMPLETION REPORT
CHAPPELL #1

- 9-12-71 Cut off long string and put plate on surface to long string to stop surface water flow w/2' O.L. on surface (10 3/4) and 1/2' metal stops on long string to surface to hold up pipe weight. (5 hrs) Started rig up to run tub. to drill out plug.
- 9-13-71 Run tub. got 170' off bottom run into heavy mud. Started circulating each jt. down Hit plug at 4843'. Drilled plug and started filling on shoe shut in for night.
- 9-14-71 Finished drilling shoe and approx. 25' of contam. cement & washed on to T.D. 4932' Circulated hole clean for 1 hour 10 min. Light skim oil came to surface w/open hole mud. Layed down 3 jts. tubing & flanged up tub. & head tub. set @ 4858 E.L. (74' off bottom). Tub. run as follows: 1-tub. collar w/cut rite on bot. for bit 7': 1 seat nip 1.20' 157 jts. tubing 4852.96' 4' for D.F. Total 4858.96' 2 p.m. started lay down Drill line & spool up sand line. Finished spooling on sand line Run stringer on tub. swab and shut in for night.
- 9-15-71 Started tub. swab, swabbed down to 2,000' and could not lower fluid level continued to swab rest of day swabbing from 3,500' (top fluid 2,000') No gas No oil Shut in for night.
- 9-16-71 Opened well w/'sight' blow on csg & tub. Gas surfaced rich & Heavy. Run swab and recovered approx 200' on first pull approx 2 gal. oil and rest oily water. Run 3 more times and getting very little oil and mostly all water. @ 10:30 fluid at 2,000' swabbing from 3,500'. Water kinda milkie; oil breaks out of water at all times "(very little)". Filled hole w/water and press up to see what press would pump into formation pumped in @ approx. 300# (Hole taking water at this press) Rigged up blocks and line over sand line. Shut down & start preparing to squeeze.
- 9-17-71 Rigged up Halliburton filled well & Circulated @ 950# @ 3 B.P.M. closed csg. in & pumped into form. w/1 1/4 BPM @ 1800# established rate @ 1 1/2 BPM @2100# Pumped approx. 50 qx. cement & displaced w/24 bbl water. Washed pipe, out & around w/60 bbls and recovered approx. 1/2 bbl. cement. Shut in till morn.
- 9-18-71 Hole full and cement set up. Started swabbing. Swabbed 6 hrs & could not lower fluid below 1900' swabbing from 3500'. Closed in.
- 9-19-71 Opened csg w/5-10# press. Tub. w/little less press. Run swab got under 1600' fluid. (Fluid level at 800'). Small amount gas ahead of swab prob. 1/4 cup oil on top of fluid.. Run tub. all the way to bottom to see if any cement set up on bottom. Tagged bottom @ 4927' ; 6' fill up w/10000# weight set down. Pulled tub. back up hole and 20' inside pipe (6 jts. tub. on rack) Shut well in until can work out further completion.