

NEW MEXICO OIL CONSERVATION COMMISSION
Santa Fe, New Mexico

Form C-101
Revised (12/1/55)

NOTICE OF INTENTION TO DRILL

Notice must be given to the District Office of the Oil Conservation Commission and approval obtained before drilling or recompleting begins. If changes in the proposed plan are considered advisable, a copy of this notice showing such changes will be returned to the sender. Submit this notice in QUINTUPLICATE. One copy will be returned following approval. See additional instructions in Rules and Regulations of the Commission.

If State Land submit 6 Copies Attach Form C-128 in triplicate to first 3 copies of form C-101

FRANKFORT OIL COMPANY, ARDMORE, OKLAHOMA

June 27, 1957

(Place)

(Date)

OIL CONSERVATION COMMISSION
SANTA FE, NEW MEXICO

Gentlemen:

You are hereby notified that it is our intention to commence the Drilling of a well to be known as
Frankfort Oil Company (a division of Calvert Distilling Company)

(Company or Operator)

I. V. Lucero

(Lease)

Well No. ONE

in C-SW-SE

The well

located 1980 feet from the East

line and 660

(Unit)

feet from the

South

line of Section 15

T. 11N

R. 15E

NMPM.

(GIVE LOCATION FROM SECTION LINE)

Pool, San Miguel

Count

D	C	B	A
E	F	G	H
L	K	J	I
M	N	X	P

If State Land the Oil and Gas Lease is No.

If patented land the owner is

Address

We propose to drill well with drilling equipment as follows: Rotary

The status of plugging bond is. Blanket bond approved 7-24-5

Drilling Contractor Riceland Drilling Corporation

We intend to complete this well in the not known

formation at an approximate depth of 4500' feet.

CASING PROGRAM

We propose to use the following strings of Casing and to cement them as indicated:

Size of Hole	Size of Casing	Weight per Foot	New or Second Hand	Depth	Sacks Cement
13 3/4"	10 3/4"	32.75	New	200	300
7 7/8"	5 1/2"	14#		Total Depth	

If changes in the above plans become advisable we will notify you immediately.

ADDITIONAL INFORMATION (If recompleting give full details of proposed plan of work.)

200' surface pipe adequate. Casing program amended in compliance with telephone request, M. A. Catner
JUL 26 1957

Approved....., 19.....
Except as follows:

COLLECT AND SACK SAMPLES FOR
NEW MEXICO BUREAU OF MINES, SOCORRO
AT AT LEAST TEN FOOT INTERVALS

OIL CONSERVATION COMMISSION

By DANIEL S. NUTTER
Petroleum Engineer

Sincerely yours

FRANKFORT OIL COMPANY

(Company or Operator)

By

DIVISION SUPERINTENDENT

Send Communications regarding well to

Name Frankfort Oil Co.

Address Box, 1750, Ardmore, Oklahoma

NEW MEXICO OIL CONSERVATION COMMISSION
Well Location and Acreage Dedication Plat

Section A.

Date July 3, 1957

Operator Frankfort Oil Company Lease I. V. Lucero
Well No. One Unit Letter Section 15 Township 11N Range 15E NMP
Located 660' Feet From South Line, 3300 Feet From West Line
County San Miguel G. L. Elevation unknown Dedicated Acreage 640 Acres
Name of Producing Formation Pool Wildcat

1. Is the Operator the only owner* in the dedicated acreage outlined on the plat below?
Yes Yes No .
2. If the answer to question one is "no," have the interests of all the owners been consolidated by communitization agreement or otherwise? Yes No . If answer is "yes," Type of Consolidation
3. If the answer to question two is "no," list all the owners and their respective interests below:

Owner

Land Description

Section B

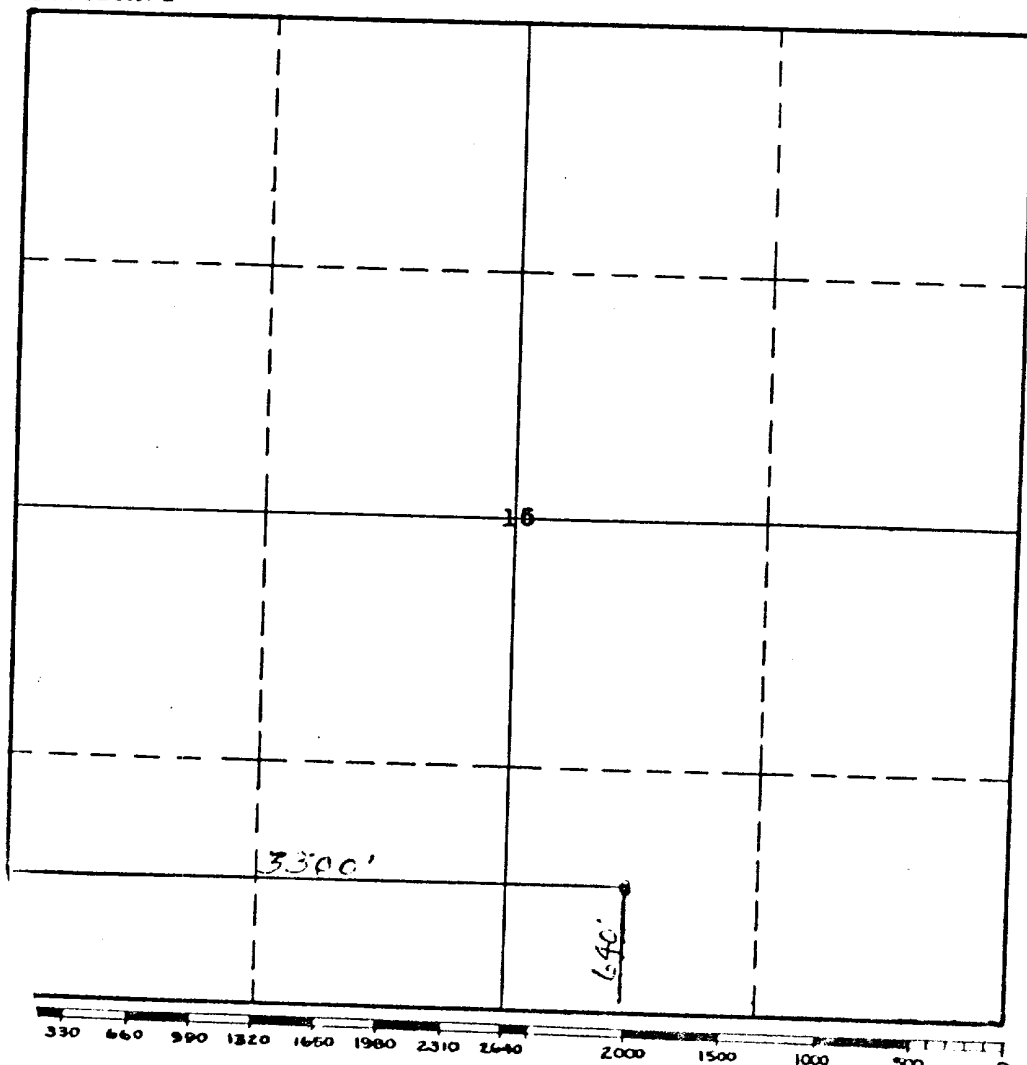

This is to certify that the information in Section A above is true and complete to the best of my knowledge and belief.

Frankfort Oil Company
(Operator)
M. A. Cotner,
Division Superintendent
(Representative)
Box 1750-Ardmore, Okla.
Address

This is to certify that the well location shown on the plat in Section B was plotted from field notes of actual surveys made by me or under my supervision and that the same is true and correct to the best of my knowledge and belief.
Date Surveyed June 29, 1957

H. E. Bausmance
Registered Professional
Engineer and/or Land Surveyor.
R E & L S License number
Certificate No. #136

INSTRUCTIONS FOR COMPLETION:

1. Operator shall furnish and certify to the information called for in Section A.
2. Operator shall outline the dedicated acreage for both oil and gas wells on the plat in Section B.
3. A registered professional engineer or land surveyor registered in the State of New Mexico or approved by the Commission shall show on the plat the location of the well and certify this information in the space provided.
4. All distances shown on the plat must be from the outer boundaries of Section.
5. If additional space is needed for listing owners and their respective interests as required in question 3, Section A, please use space below

* "Owner" means the person who has the right to drill into and to produce from any pool and to appropriate the production either for himself or for himself and another. (65-3-29 (e) NMSA 1953 Comp.)

22.3 1957 M.A.D.



9 10 11

16 15 14

21 22 23

SW. cor Sec. 15
Stone in Place

Location Stake Set
in the Center
of the SW 1/4 of
Sec. 15

T-11-N, R-15-E.

E. 2640' 660'

PLAT
SHOWING SURVEY
FOR THE
FRANKFORT OIL CO.
LOCATION ON
I.V. LUCERO Property.

SAN MIGUEL, CO.
NEW MEXICO.

H.E. Baismann, CE
P.E. & L.S. License #136 Scale 1000' = 1"

6-29-57

45