

NO. OF COPIES RECEIVED	
DISTRIBUTION	
SANTA FE	
FILE	
U.S.G.S.	
LAND OFFICE	
OPERATOR	

NEW MEXICO OIL CONSERVATION COMMISSION

Form C-101
Revised 1-1-65

66 AUG 25 AM 7 51

APPLICATION FOR PERMIT TO DRILL, DEEPEN, OR PLUG BACK

1a. Type of Work b. Type of Well OIL WELL <input checked="" type="checkbox"/> GAS WELL <input type="checkbox"/> OTHER <input type="checkbox"/> SINGLE ZONE <input checked="" type="checkbox"/> MULTIPLE ZONE <input type="checkbox"/>		DRILL <input checked="" type="checkbox"/> DEEPEN <input type="checkbox"/> PLUG BACK <input type="checkbox"/>		7. Unit Agreement Name
2. Name of Operator H. R. Harris & James Walton		3. Address of Operator c/o Oil Reports & Gas Services, Box 763, Hobbs, New Mexico		8. Farm or Lease Name Hall Estate
4. Location of Well UNIT LETTER F LOCATED 1690 FEET FROM THE North LINE AND 1690 FEET FROM THE West LINE OF SEC. 23 TWP. 13 N RGE. 23 E NMPM		9. Well No. 1		10. Field and Pool, or Wildcat Wildcat
12. County San Miguel				
19. Proposed Depth 1200		19A. Formation San Andres		20. Rotary or C.T. Rotary
21. Elevations (Show whether DF, RT, etc.) 4604 GL	21A. Kind & Status Plug. Bond Blanket	21B. Drilling Contractor		22. Approx. Date Work will start Upon Approval

23.

PROPOSED CASING AND CEMENT PROGRAM

SIZE OF HOLE	SIZE OF CASING	WEIGHT PER FOOT	SETTING DEPTH	SACKS OF CEMENT	EST. TOP
8	7 5/8	24 1/2	10 1/2	10 50 lb	Circ.
6 3/4	5 1/2	14 1/2	1200	50	600

APPROVAL VALID
FOR 90 DAYS UNLESS
DRILLING COMMENCED.

EX-103 700.23.1866

IN ABOVE SPACE DESCRIBE PROPOSED PROGRAM: IF PROPOSAL IS TO DEEPEN OR PLUG BACK, GIVE DATA ON PRESENT PRODUCTIVE ZONE AND PROPOSED NEW PRODUCTIVE ZONE. GIVE BLOWOUT PREVENTER PROGRAM, IF ANY.

I hereby certify that the information above is true and complete to the best of my knowledge and belief.

Signed A. L. Smith Title Agent Date 8/24/66

(This space for State Use)

APPROVED BY J. E. Kaptenia TITLE Oil & Gas Inspector DATE 8/25/66

CONDITIONS OF APPROVAL, IF ANY:

COLLECT AND SACK SAMPLES FOR
NEW MEXICO BUREAU OF MINES, GEOLOGY
AT LEAST TWO FEET DEEPER

Dist IV

**NEW MEXICO OIL CONSERVATION COMMISSION
WELL LOCATION AND ACREAGE DEDICATION PLAT**

Form C-102
Supersedes C-128
Effective 1-1-65

All distances must be from the outer boundaries of the Section.

Operator H. R. Harris & James Walton			Lease Hall Estate		25	Well No. 1
Unit Letter F	Section 23	Township 13 North	Range 23 East	County San Miguel		
Actual Footage Location of Well: 1650 feet from the North line and 1650 feet from the West line						
Ground Level Elev. 4604	Producing Formation San Andres		Pool Wildcat		Dedicated Acreage: 40 Acres	

1. Outline the acreage dedicated to the subject well by colored pencil or hatchure marks on the plat below.
2. If more than one lease is dedicated to the well, outline each and identify the ownership thereof (both as to working interest and royalty).
3. If more than one lease of different ownership is dedicated to the well, have the interests of all owners been consolidated by communitization, unitization, force-pooling, etc?

☐ Yes ☐ No If answer is "yes," type of consolidation _____

If answer is "no," list the owners and tract descriptions which have actually been consolidated. (Use reverse side of this form if necessary.) _____

No allowable will be assigned to the well until all interests have been consolidated (by communitization, unitization, forced-pooling, or otherwise) or until a non-standard unit, eliminating such interests, has been approved by the Commission.

For Surveyor's Certification and footage location see attached surveyor's plat.

CERTIFICATION

I hereby certify that the information contained herein is true and complete to the best of my knowledge and belief.

Name *H. L. Smith*
 Position _____
 Agent _____
 Company _____

H. R. Harris & James Walton
 Date **8/21/66**

I hereby certify that the well location shown on this plat was plotted from field notes of actual surveys made by me or under my supervision, and that the same is true and correct to the best of my knowledge and belief.

Date Surveyed _____

Registered Professional Engineer and/or Land Surveyor

Certificate No. _____

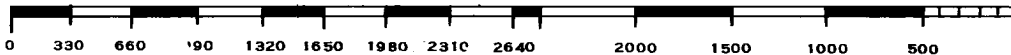

1/4 Cor (Marked Stone)

T 13 N - R 23 E

MAIN OFFICE 0000

'66 Aug 25 AM 7 51

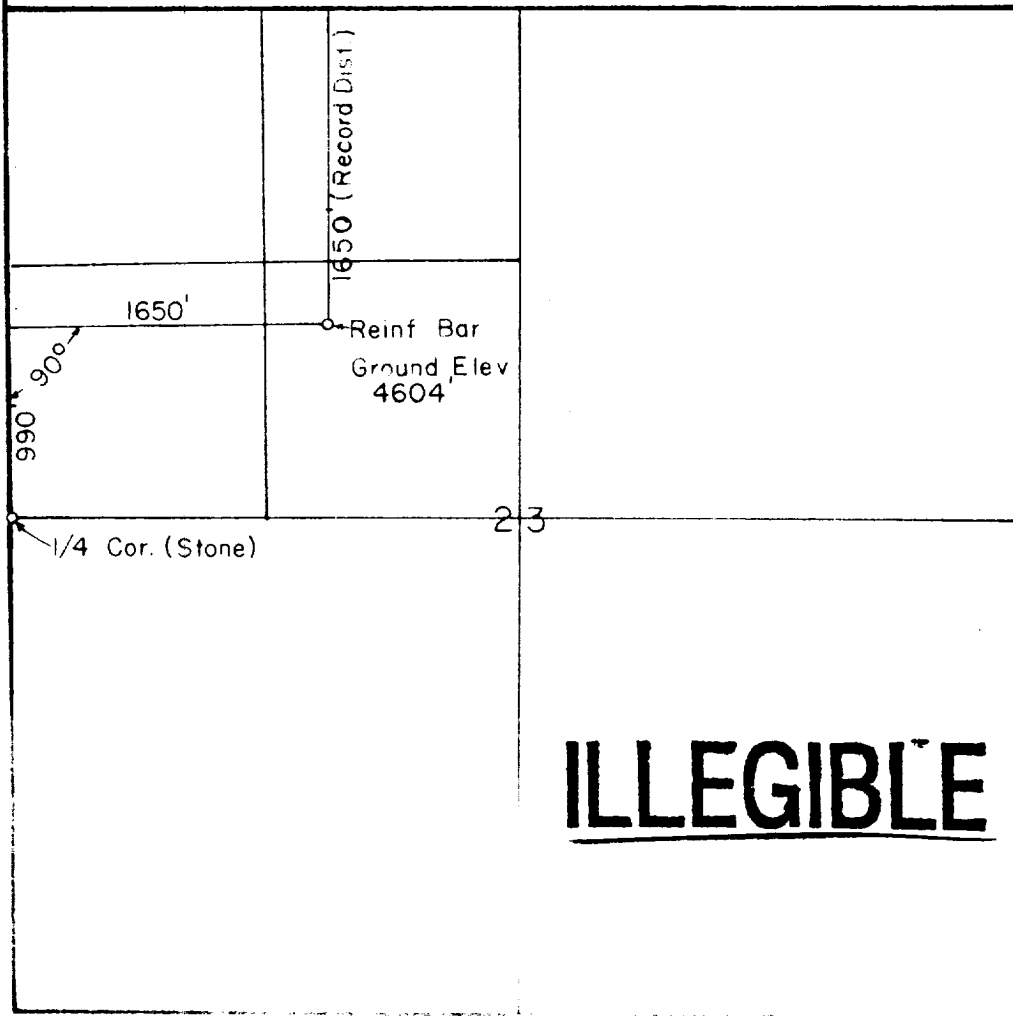
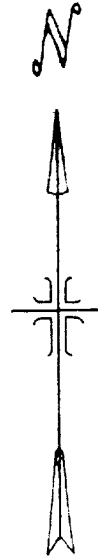

Scale 1" = 100'

STATE OF MISSISSIPPI

PLAT SHOWING

I, J. L. Hallow, Jr., do hereby certify that this plat was prepared from field notes of an actual survey made under my supervision and that the same is a true and correct copy of my original record.

Witness my hand and seal of said office at the City of Jackson, Mississippi, this 1st day of August, 1966, at 7:51 A. M. P. M.

J. L. Hallow, Jr.