



IN REPLY REFER TO:

UNITED STATES  
DEPARTMENT OF THE INTERIOR  
GEOLOGICAL SURVEY

P. O. Box 6721  
Roswell, New Mexico

February 1, 1954

Colorado Mines & Metals Company  
217 - 6th Street, SW  
Albuquerque, New Mexico

Re: Oil and Gas Lease New Mexico 09895-B

Gentlemen:

Receipt is acknowledged of your "Notice of Intention to Drill" dated December 15, 1953, covering your well No. 1 (Valdez) on the subject land in the SW $\frac{1}{4}$ NW $\frac{1}{4}$  sec. 8, T. 14 N., R. 12 E., wildcat area, San Miguel County, New Mexico.

Your proposed work is hereby approved subject to compliance with the provisions of the "Oil and Gas Operating Regulations" revised May 25, 1942, a copy of which is enclosed, and subject to the following conditions:

1. Drilling operations so authorized are subject to the attached sheet for general conditions of approval.
2. Duplicate copies of the percentage sample log is required from surface to total depth.
3. On various sundry notices and reports to be submitted on form 7-331a, please show dates on which the work was performed. Show the date that the well was spudded on the first of such reports submitted.

Very truly yours,

JAMES A. KNAUF  
District Engineer

Copy to: NMOCC, Santa Fe (2) ✓

JaKnauf:bc

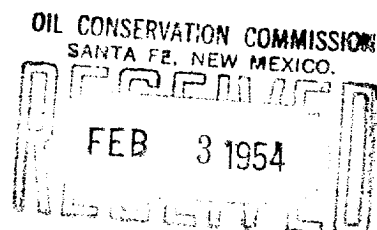

UNITED STATES  
DEPARTMENT OF THE INTERIOR  
GEOLOGICAL SURVEY



... ..

1000

Figure 1. The effect of the concentration of the *Agrobacterium* suspension on the transformation efficiency of *Agrobacterium* strains. The *Agrobacterium* strains were grown in the YEA medium for 24 h at 28°C. The cell concentration of the strains was adjusted to 10<sup>8</sup> cells/ml. The cell suspension was mixed with the plant tissue and the transformation efficiency was determined. The results were expressed as the mean ± SD of three independent experiments. The asterisks indicate the significant difference between the strains at the same concentration of the cell suspension.

*Journal of Management Education* 30(6)p. 789-804

1. *Journal of the American Medical Association*, 1997; 277: 1033-1038.

RECEIVED - PORTLAND, ME  
JUN 10 1964  
U.S. DEPT. OF JUSTICE

627 057

ad: fusca 1.



Form 9-381a  
(Feb. 1951)

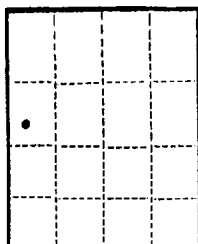

(SUBMIT IN TRIPLICATE)

UNITED STATES  
DEPARTMENT OF THE INTERIOR  
GEOLOGICAL SURVEY

Land Office Land and Survey  
Santa Fe  
Lease No. NM 09895-B  
Unit \_\_\_\_\_

SUNDRY NOTICES AND REPORTS ON WELLS

NOTICE OF INTENTION TO DRILL.....	<input checked="" type="checkbox"/>	SUBSEQUENT REPORT OF WATER SHUT-OFF.....	
NOTICE OF INTENTION TO CHANGE PLANS.....		SUBSEQUENT REPORT OF SHOOTING OR ACIDIZING.....	
NOTICE OF INTENTION TO TEST WATER SHUT-OFF.....		SUBSEQUENT REPORT OF ALTERING CASING.....	
NOTICE OF INTENTION TO RE-DRILL OR REPAIR WELL.....		SUBSEQUENT REPORT OF RE-DRILLING OR REPAIR.....	
NOTICE OF INTENTION TO SHOOT OR ACIDIZE.....		SUBSEQUENT REPORT OF ABANDONMENT.....	
NOTICE OF INTENTION TO PULL OR ALTER CASING.....		SUPPLEMENTARY WELL HISTORY.....	
NOTICE OF INTENTION TO ABANDON WELL.....			

(INDICATE ABOVE BY CHECK MARK NATURE OF REPORT, NOTICE, OR OTHER DATA)

December 15

53

19

Well No. 1 is located 2096.4 ft. from N line and 444.2 ft. from E line of sec. 8

SW 1/4 Sec. 8 14 North, Range 12 East N.M.P.M. & Base  
(1/4 Sec. and Sec. No.) (Twp.) (Range) (Meridian)  
Wildcat San Miguel County New Mexico  
(Field) (County or Subdivision) (State or Territory)

7200

The elevation of the derrick floor above sea level is 7200 ft. Approximately as taken from the the U.S.G.S Sheet of the Lamy Quadrangle. Geological name of surface formation: Dockum.  
DETAILS OF WORK

(State names of and expected depths to objective sands; show sizes, weights, and lengths of proposed casings; indicate mudding jobs, cementing points, and all other important proposed work)

1. Cable Tools
2. 1500 ft. contemplated depth or production.
3. Proposed casing record:  
A.--100-feet 12 1/2" surface casing 40 lbs.  
B.--500-feet 10".  
C.--Intermediate string of 8" to shut off water, if necessary.
4. Drill-stem tests and samples will be caught in duplicate every five feet.

B&B Drilling Company  
Drilling Contractor  
Albuquerque, New Mexico

I understand that this plan of work must receive approval in writing by the Geological Survey before operations may be commenced.

Company Colorado Mines & Metals Company (N.S.L.)

Address 217 - 6th Street, S.W.  
Albuquerque, New Mexico

By

*Edward P. Chase*  
Title Vice Pres.

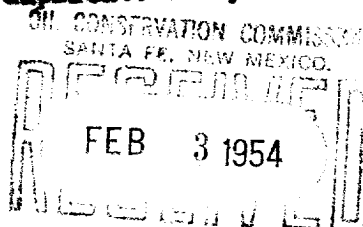



Section.....8..... Township.....14N..... Range.....12E N.M.P.M......

### C E R T I F I C A T E

I, Walter G. Turley, a licensed surveyor of New Mexico, hereby certify that, on October 29, 1953, I proceeded to the field and determined the location of Well No.1 to be in the Southwest quarter of the Northwest quarter of Section 8, Township 14 North, Range 12 East of the New Mexico Principal Meridian and Base, In San Miguel County, from which an iron post with brass cap, marked, witnessed and set by the General Land Office for the quarter corner common to Sections 7 and 8, bears S.39°15'W., 702.0 feet distant, which would be 444.2 feet East of the West boundary of Section 8; and 2096.4 feet south of the North boundary of Section 8.

Walter G. Turley  
Reg Prof. Eng. and Land Surveyor No.95

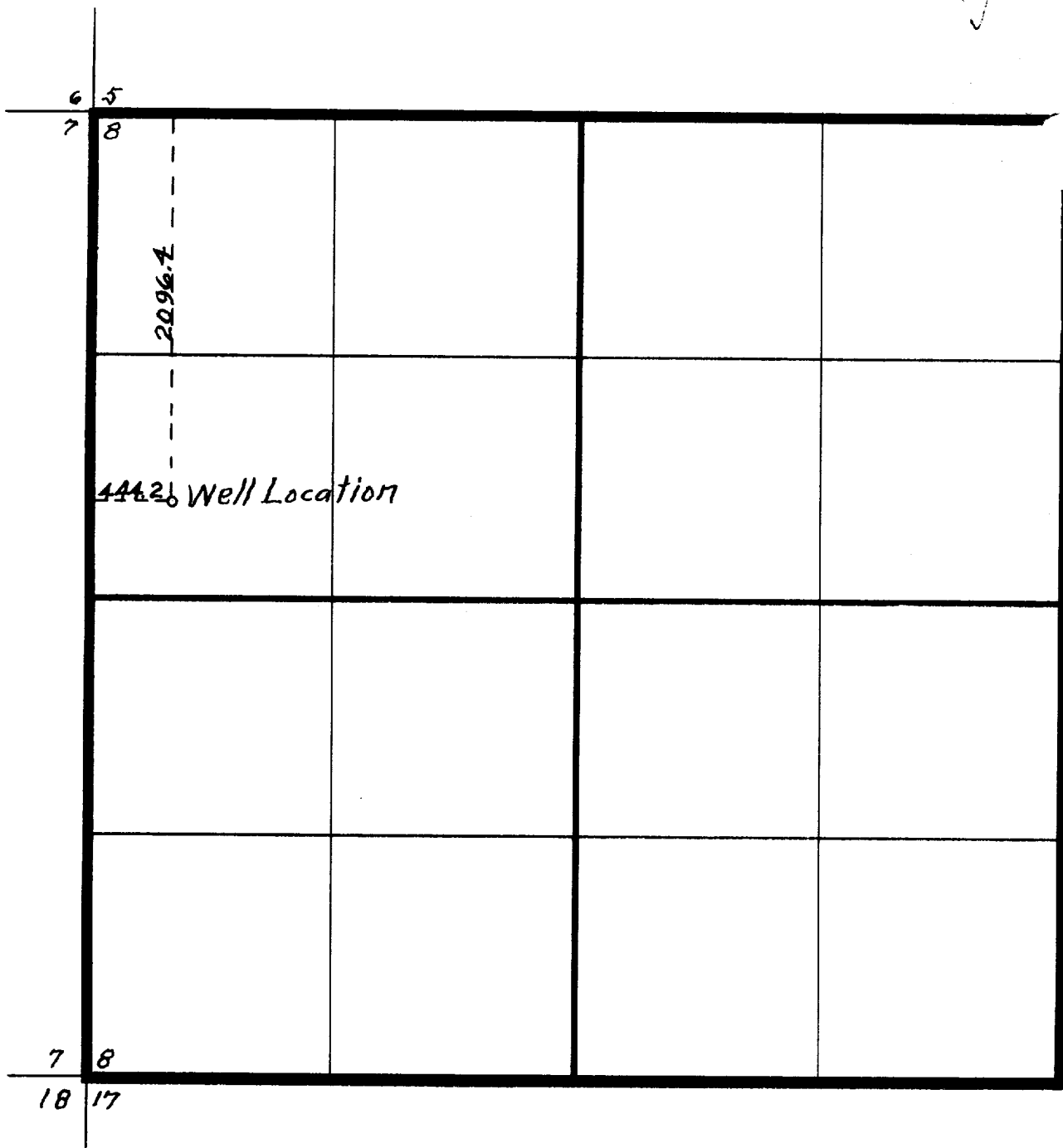

*Section*..... *Township*..... *Range*.....
