

NO. OF COPIES RECEIVED	
DISTRIBUTION	
SANTA FE	
FILE	
U.S.G.S.	
LAND OFFICE	
OPERATOR	

# NEW MEXICO OIL CONSERVATION COMMISSION

Form C-101  
Revised 1-1-65

5A. Indicate Type of Lease	
STATE <input type="checkbox"/>	FEE <input checked="" type="checkbox"/>
5. State Oil & Gas Lease No.	

## APPLICATION FOR PERMIT TO DRILL, DEEPEN, OR PLUG BACK

1a. Type of Work		7. Unit Agreement Name	
b. Type of Well OIL WELL <input checked="" type="checkbox"/> GAS WELL <input type="checkbox"/> OTHER <input type="checkbox"/>		8. Farm or Lease Name <b>HORTON</b>	
2. Name of Operator <b>JAMES W. STRAWN</b>		9. Well No. <b>1</b>	
3. Address of Operator <b>V1009 E. Florida St., Midland, Texas 79701</b>		10. Field and Pool, or Wildcat <b>Wildcat</b>	
4. Location of Well UNIT LETTER <b>A</b> LOCATED <b>330</b> FEET FROM THE <b>North</b> LINE <b>330</b> East <b>32</b> 11 N <b>7</b> E AND FEET FROM THE LINE OF SEC. TWP. RGE. NMPM		12. County <b>Santa Fe</b>	
19. Proposed Depth <b>4,000</b>		19A. Formation	
20. Rotary or C.T. <b>Rotary</b>			
21. Elevations (Show whether DF, RT, etc.) <b>6685.0 GL</b>		21A. Kind & Status Plug. Bond <b>Blanket</b>	
21B. Drilling Contractor <b>Company Rig</b>		22. Approx. Date Work will start <b>December 1, 1975</b>	

23.

## PROPOSED CASING AND CEMENT PROGRAM

SIZE OF HOLE	SIZE OF CASING	WEIGHT PER FOOT	SETTING DEPTH	SACKS OF CEMENT	EST. TOP
12-3/4"	10-3/4"	32#	350	120	
6-1/4"	4-1/2"	9.50#	4000	350	

Forms C-101 & C-102 filed by Sage Corporation and permit granted April 2, 1974. Well was drilled to approximately 1930'. We propose to complete this well, to approximately 4,000'. Guiberson B-1 Blowout preventer to be used.

APPROVAL VALID  
FOR 90 DAYS UNLESS  
BOLTING COMPLETED,  
EXPIRES 3/3/76

IN ABOVE SPACE DESCRIBE PROPOSED PROGRAM: IF PROPOSAL IS TO DEEPEN OR PLUG BACK, GIVE DATA ON PRESENT PRODUCTIVE ZONE AND PROPOSED NEW PRODUCTIVE ZONE. GIVE BLOWOUT PREVENTER PROGRAM, IF ANY.

I hereby certify that the information above is true and complete to the best of my knowledge and belief.

Signed James W. Strawn Title Operator Date 10-23-75  
(This space for State Use)

APPROVED BY Carl W. Hoag TITLE SENIOR PETROLEUM GEOLOGIST DATE 12/4/75  
CONDITIONS OF APPROVAL, IF ANY:

SAFETY AND HEALTH FOR  
NEW MEXICO OIL CONSERVATION COMMISSION  
AT THE UNIVERSITY OF NEW MEXICO

# NEW MEXICO OIL CONSERVATION COMMISSION WELL LOCATION AND ACERAGE DEDICATION PLAT

All distances must be from the outer boundaries of the Section

Operator <b>SAGE CORPORATION</b>			Lease <b>HORTON</b>		Well No.
Unit Letter <b>A</b>	Section <b>32</b>	Township <b>11 NORTH</b>	Range <b>7 EAST</b>	County <b>SANTA FE</b>	
Actual Footage Location of Well:					
<b>330</b> feet from the <b>NORTH</b> line and		<b>330</b> feet from the <b>EAST</b> line			
Ground Level Elev. <b>6685.0</b>	Producing Formation		Pool	Dedicated Acreage:	
					Acres

1. Outline the acreage dedicated to the subject well by colored pencil or hachure marks on the plat below.
  2. If more than one lease is dedicated to the well, outline each and identify the ownership thereof (both as to working interest and royalty),
  3. If more than one lease of different ownership is dedicated to the well, have the interests of all owners been consolidated by communitization, unitization, force-pooling, etc?
- ( ) Yes ( ) No If answer is "yes," type of consolidation .....

If answer is "no," list the owners and tract descriptions which have actually consolidated. (Use reverse side of this form if necessary.) .....

No allowable will be assigned to the well until all interests have been consolidated (by communitization, unitization, forced-pooling, or otherwise) or until a non standard unit, eliminating such interests, has been approved by the Commission.

## CERTIFICATION

I hereby certify that the information contained herein is true and complete to the best of my knowledge and belief.

Name \_\_\_\_\_  
 Position \_\_\_\_\_  
 Company \_\_\_\_\_  
 Date \_\_\_\_\_

I hereby certify that the well location shown on this plat was plotted from field notes of actual surveys made by me or under my supervision, and that the same is true and correct to the best of my knowledge and belief.

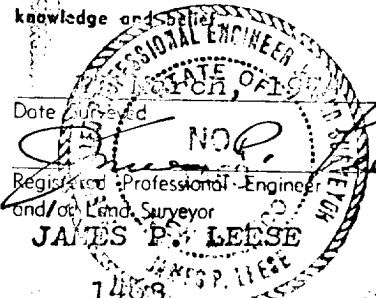
Date Surveyed \_\_\_\_\_  
  
 Registered Professional Engineer  
 and/or Land Surveyor  
**JAMES P. LEESE**  
 1453  
 Certificate No. \_\_\_\_\_

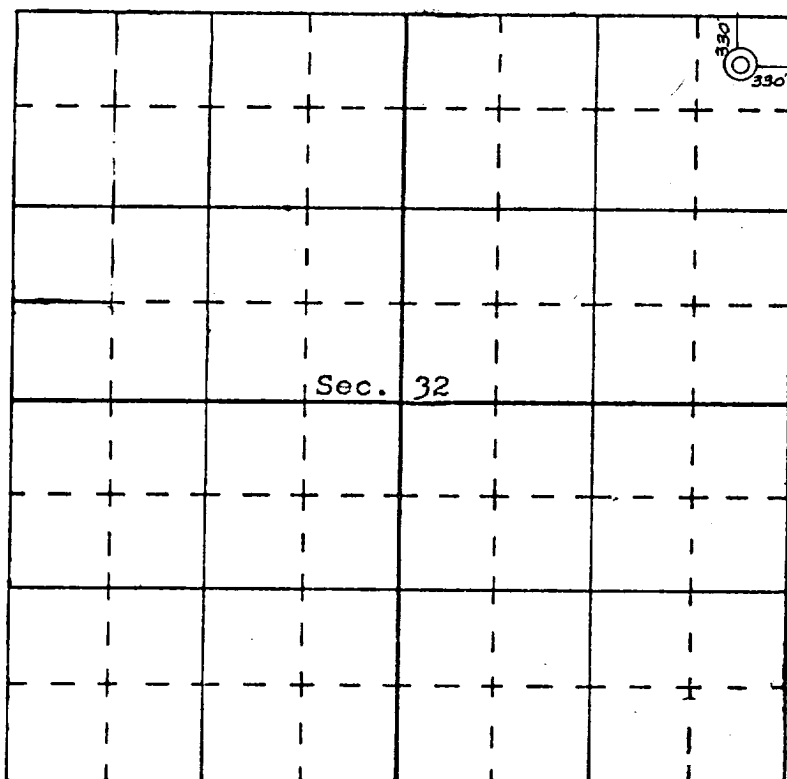

N