

NO. OF COPIES RECEIVED	
DISTRIBUTION	
SANTA FE	
FILE	✓
U.S.G.S.	
LAND OFFICE	
OPERATOR	

NEW MEXICO OIL CONSERVATION COMMISSION

API # 30-049-20015

Form C-101  
Revised 1-1-65

5A. Indicate Type of Lease
STATE <input type="checkbox"/> FEE <input checked="" type="checkbox"/>

5. State Oil & Gas Lease No.

APPLICATION FOR PERMIT TO DRILL, DEEPEN, OR PLUG BACK

1a. Type of Work		7. Unit Agreement Name	
b. Type of Well DRILL <input checked="" type="checkbox"/> DEEPEN <input type="checkbox"/> PLUG BACK <input type="checkbox"/> OIL WELL <input checked="" type="checkbox"/> GAS WELL <input type="checkbox"/> OTHER <input type="checkbox"/> SINGLE ZONE <input type="checkbox"/> MULTIPLE ZONE <input type="checkbox"/>		8. Farm or Lease Name FERREL	
2. Name of Operator COLORADO PLATEAU GEOLOGICAL SERVICES, INC.		9. Well No. 1	
3. Address of Operator P.O. Box 537, Farmington, New Mexico 87401		10. Field and Pool, or Wildcat WILDCAT	
4. Location of Well UNIT LETTER C LOCATED 330 FEET FROM THE NORTH LINE AND 1650 FEET FROM THE WEST LINE OF SEC. 7 TWP. 13N RGE. 9E NMPM		12. County Santa Fe	
19. Proposed Depth 3000'		19A. Formation DAKOTA	20. Rotary or C.T. ROTARY
21. Elevations (Show whether DF, RT, etc.) 6010' GR	21A. Kind & Status Plug. Bond BLANKET	21B. Drilling Contractor STEWART BROS.	22. Approx. Date Work will start NOV. 25, 1981

PROPOSED CASING AND CEMENT PROGRAM

SIZE OF HOLE	SIZE OF CASING	WEIGHT PER FOOT	SETTING DEPTH	SACKS OF CEMENT	EST. TOP
10"	8 5/8"	24#	200'	250	surface
6 3/4"	4 1/2"	15.5	3000'	as necessary	surface
				for production	

We propose to drill a 6 3/4" hole to 3000' to test the Dakota Formation. In the event oil or gas is encountered we will run 4 1/2" production string as necessary. We will set 200' of 8 5/8" surface casing and all casing will be cemented to surface to protect any potential fresh water zones.

APPROVAL VALID FOR 90 DAYS  
PERMIT EXPIRES 2-12-82  
UNLESS DRILLING UNDERWAY

OIL CONSERVATION COMMISSION TO BE NOTIFIED  
WITHIN 24 HOURS OF BEGINNING OPERATIONS

IN ABOVE SPACE DESCRIBE PROPOSED PROGRAM: IF PROPOSAL IS TO DEEPEN OR PLUG BACK, GIVE DATA ON PRESENT PRODUCTIVE ZONE AND PROPOSED NEW PRODUCTIVE ZONE. GIVE BLOWOUT PREVENTER PROGRAM, IF ANY.

I hereby certify that the information above is true and complete to the best of my knowledge and belief.

Signed Samuel B. Bors Title President CPGS Date Nov. 8, 1981

(This space for State Use)

APPROVED BY Carl Illing TITLE SENIOR PETROLEUM GEOLOGIST DATE 11-12-81

CONDITIONS OF APPROVAL, IF ANY:

COLLECT AND SUBMIT SAMPLES FOR  
NEW MEXICO OIL & GAS COMMISSION, SOCORRO  
AT AT LEAST TEN FOOT INTERVALS

All distances must be from the outer boundaries of the Section.

Operator <b>COLORADO PLATEAU GEOLOGICAL SERVICES</b>			Lease <b>FERREL</b>		Well No. <b>1</b>
Unit Letter <b>C</b>	Section <b>7</b>	Township <b>13N</b>	Range <b>9E</b>	County <b>SANTA FE</b>	
Actual Footage Location of Well: <b>330</b> feet from the <b>North</b> line and <b>1650</b> feet from the <b>West</b> line					
Ground Level Elev. <b>6010</b>	Producing Formation <b>Dakota</b>		Pool <b>Wildcat</b>		Dedicated Acreage: <b>40</b> Acres

1. Outline the acreage dedicated to the subject well by colored pencil or hachure marks on the plat below.
2. If more than one lease is dedicated to the well, outline each and identify the ownership thereof (both as to working interest and royalty).
3. If more than one lease of different ownership is dedicated to the well, have the interests of all owners been consolidated by communitization, unitization, force-pooling, etc?

☐ Yes ☐ No If answer is "yes," type of consolidation \_\_\_\_\_

If answer is "no," list the owners and tract descriptions which have actually been consolidated. (Use reverse side of this form if necessary.) \_\_\_\_\_

No allowable will be assigned to the well until all interests have been consolidated (by communitization, unitization, forced-pooling, or otherwise) or until a non-standard unit, eliminating such interests, has been approved by the Commission.

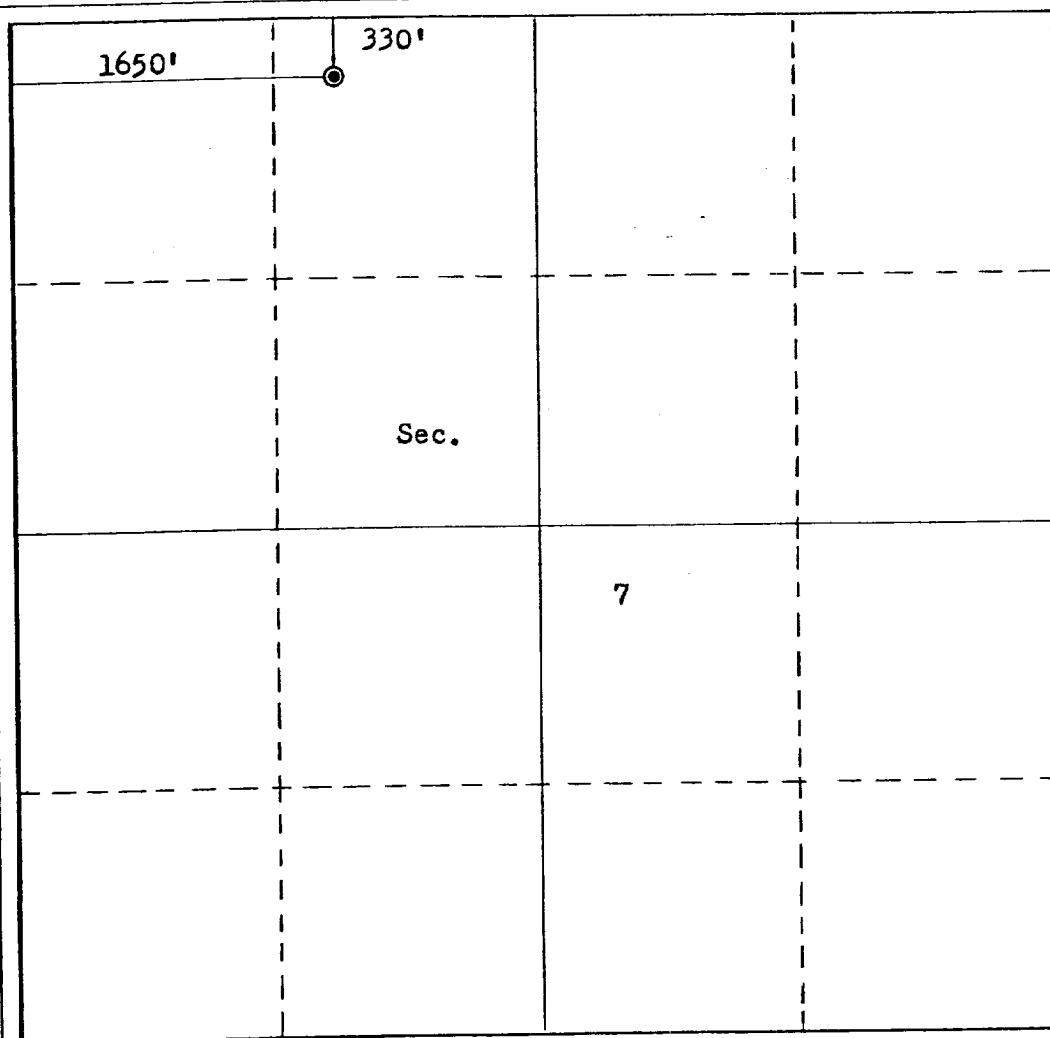

#### CERTIFICATION

I hereby certify that the information contained herein is true and complete to the best of my knowledge and belief.

Name

**BRUCE A. BLACK**

Position

**PRESIDENT**

Company **COLORADO PLATEAU  
GEOLOGICAL SERVICES, INC.**

Date

**NOV. 8, 1981**

I hereby certify that the well location shown on this plat was plotted from field notes of actual surveys made by me or under my supervision, and that the same is true and correct to the best of my knowledge and belief.

Date Surveyed

**November 8, 1981**

Registered Professional Engineer  
and/or Land Surveyor

**Fred B. Kerr Jr.**

Certificate No.

**3950**