

COUNTY OF SANTA FE
 FILE
 U.S.G.S.
 LAND OFFICE
 OPERATOR

NEW MEXICO OIL CONSERVATION COMMISSION

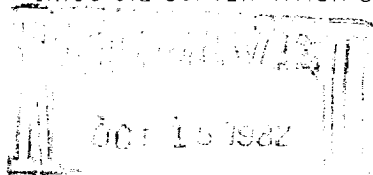

API #30-049-20017

Form O-101
Revised 10-65

1A. Include type of Lease
 STATE ☐ FEE ☒
 5. If Fee, it is a Leasehold

APPLICATION FOR PERMIT TO DRILL, DEEPEN, OR PLUG BACK

1A. Type of Work
 DRILL ☒ DEEPEN ☐ PLUG BACK ☐
 1B. Type of Well
 OIL WELL ☒ GAS WELL ☐ OTHER ☐
 1C. Name of Operator
 Continental Crude Corp.
 1D. Address of Operator
 P.O. Box 58, Santa Fe, New Mexico 87501
 1E. Location of Well
 UNIT LETTER G LOCATED 1980 FEET FROM THE North LINE
 AND 1980 FEET FROM THE East LINE OF SEC. 22 TWP. 15N RGE. 8E S44PM
 1F. Field and Pool, or Field
 Wildcat
 1G. County
 Santa FE
 1H. Depth of Well
 7000
 1I. Formation
 Dakota
 1J. Type of Casing
 Rotary
 1K. Elevations (Surface, Bottom of Hole, etc.)
 6209
 1L. Kind & Value of Plug Bond
 1 Well Bond
 1M. Drilling Contractor
 Yucca Drilling
 1N. Approx. Date Work will start
 November

PROPOSED CASING AND CEMENT PROGRAM

SIZE OF HOLE	SIZE OF CASING	WEIGHT PER FOOT	SETTING DEPTH	SACKS OF CEMENT	EST. TOP
12 1/4"	10 3/4"				surface
9 5/8"	7 5/8"	33.7	unknown	unknown	surface
4 1/2"	5 1/2"	15.5	TD		

We propose to drill a 12 1/2" hole to 350' at which point we will set 10 3/4" casing and circulate cement. We will WOC 18 hours then drill out from under surface casing with a 7 7/8" bit. We propose to drill the well to 7000' at which point logs will be run. If the well looks commercial we will run 5 1/2" 15.5# casing to TD. If the hole is determined dry we will plug following NMOCD rules and regulations.

If hole conditions warrant an intermediate string of casing 7 5/8" 33.5# casing will be run and cemented following NMOCD rule and regulations. If the intermediate string is run a 4 1/2" liner will be set for production string.

COLLECT AND GASH SAMPLES FOR
 NEW MEXICO OIL CONSERVATION COMMISSION
 AT AT LEAST TEN FOOT INTERVALS

EXHIBIT #5

APPROVAL VALID FOR 90 DAYS
 PERMIT EXPIRES 1-13-83
 UNLESS DRILLING UNDERWAY

IN ABOVE SPACE DESCRIBE PROPOSED PROGRAM; IF PROPOSAL IS TO DEEPEN OR PLUG BACK, GIVE DATA ON PRESENT PRODUCTIVE ZONE AND PROPOSED NEW PRODUCTIVE ZONE, GIVE PLUGOUT PREVENTER PROGRAM, IF ANY.

I hereby certify that the information above is true and complete to the best of my knowledge and belief.

Signed [Signature] Title Consultant Date 10-14-82

(This space for State Use)

APPROVED BY Carl Whoy TITLE DISTRICT SUPERVISOR DATE 10-15-82

CONDITIONS OF APPROVAL, IF ANY:

OIL CONSERVATION COMMISSION TO BE NOTIFIED
 WITHIN 24 HOURS OF BEGINNING OPERATIONS

NEW MEXICO OIL AND GAS COMMISSION
WELL LOCATION AND ACREAGE DEDICATION PLAT

Form 2-102
Supersedes 6-128
Effective 1-1-65

All distances must be from the outer boundaries of the Section.

Lessor Continental Crude Corp.			Lease CK Z			Well No. 1		
Tract Number G	Section 22	Township 15 North	Range 8 East	County Santa Fe				
Actual Footage Location of Well: 1980. feet from the North line and 1980 feet from the East line								
Ground Level Elev. 6209	Producing Formation Dakota		Pool Wildcat			Dedicated Acreage: 40 Acres		

1. Outline the acreage dedicated to the subject well by colored pencil or hatchure marks on the plat below.
2. If more than one lease is dedicated to the well, outline each and identify the ownership thereof (both as to working interest and royalty).
3. If more than one lease of different ownership is dedicated to the well, have the interests of all owners been consolidated by communitization, unitization, force-pooling, etc?

☐ Yes ☐ No If answer is "yes," type of consolidation _____

If answer is "no," list the owners and tract descriptions which have actually been consolidated. (Use reverse side of this form if necessary.) _____

No allowable will be assigned to the well until all interests have been consolidated (by communitization, unitization, forced-pooling, or otherwise) or until a non-standard unit, eliminating such interests, has been approved by the Commission.

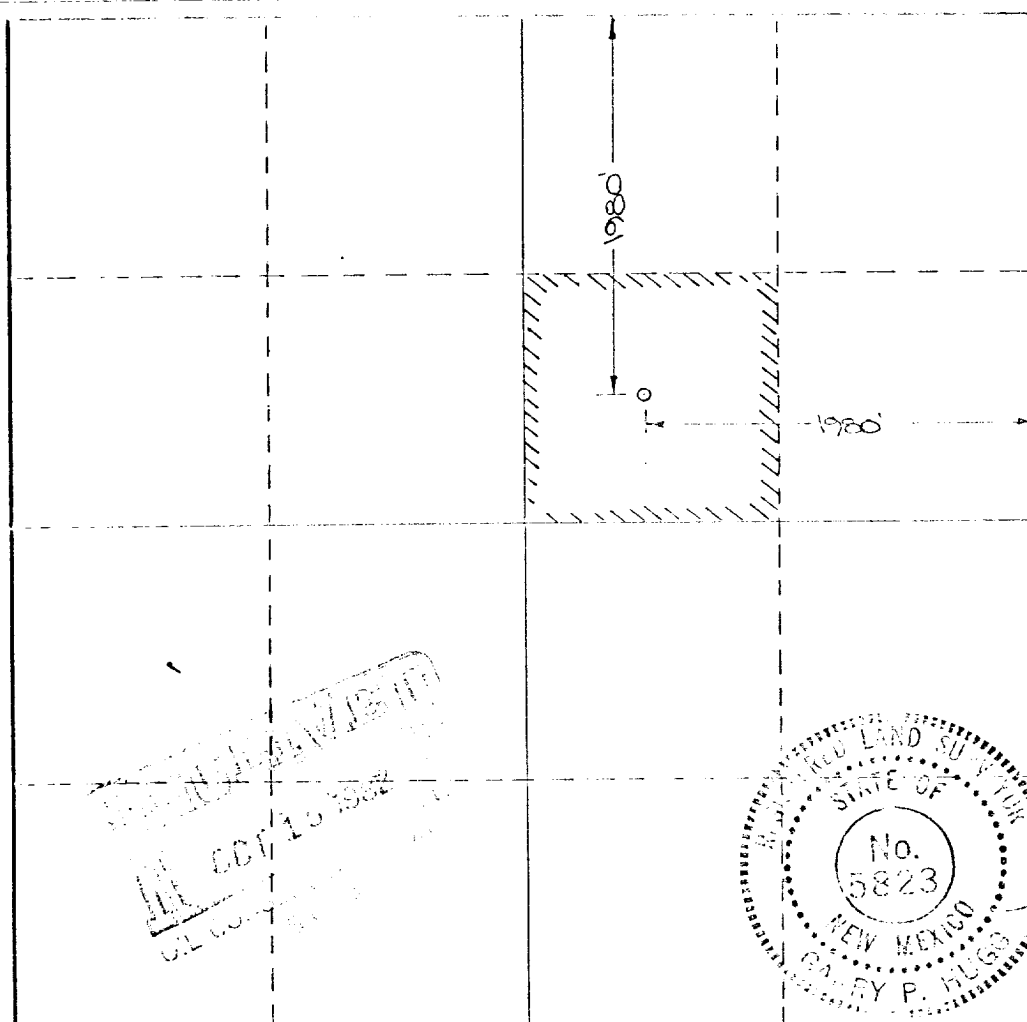

CERTIFICATION

I hereby certify that the information contained herein is true and complete to the best of my knowledge and belief.

[Signature]

Name
Phelps White
Position
Consultant
Company
Continental Crude Corp.
Date
October 14, 1982

I hereby certify that the well location shown on this plat was plotted from field notes of actual surveys made by me or under my supervision, and that the same is true and correct to the best of my knowledge and belief.

October 11, 1982

Date Surveyed
[Signature]
Registered Professional Engineer
and/or Land Surveyor

5823

Certificate No.

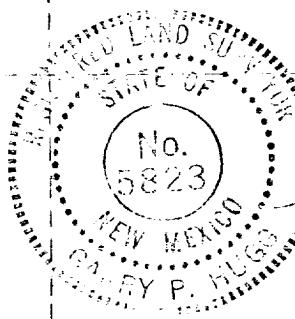

RECEIVED
OCT 15 1982
OIL COMMISSION

100 150 200 250 300 350 400 450 500 550 600 650 700 750 800 850 900 950 1000