

| | |
|------------------------|---|
| NO. OF COPIES RECEIVED | |
| DISTRIBUTION | |
| SANTA FE | ✓ |
| FILE | |
| U.S.G.S. | |
| LAND OFFICE | |
| OPERATOR | |

NEW MEXICO OIL CONSERVATION COMMISSION

Form C-101
Revised 1-1-65

API # 30-049-20020

| | |
|--------------------------------|---|
| 5A. Indicate Type of Lease | |
| STATE <input type="checkbox"/> | FEE <input checked="" type="checkbox"/> |
| 5. State Oil & Gas Lease No. | |

APPLICATION FOR PERMIT TO DRILL, DEEPEN, OR PLUG BACK

| | | | | | |
|--|--|--|--|---|--|
| 1a. Type of Work | | | | 7. Unit Agreement Name | |
| b. Type of Well OIL WELL <input checked="" type="checkbox"/> GAS WELL <input type="checkbox"/> OTHER <input type="checkbox"/> | | | | 8. Farm or Lease Name McKee | |
| 2. Name of Operator Black Oil, Inc. | | | | 9. Well No. 1 | |
| 3. Address of Operator P.O. Box 537, Farmington, NM 87499 | | | | 10. Field and Pool, or Wildcat Wildcat | |
| 4. Location of Well UNIT LETTER <u>I</u> LOCATED <u>1550</u> FEET FROM THE <u>South</u> LINE AND <u>970</u> FEET FROM THE <u>East</u> LINE OF SEC. <u>5</u> TWP. <u>13N</u> RGE. <u>9E</u> NMMPM | | | | 12. County Santa Fe | |
| 19. Proposed Depth 2800 | | | | 19A. Formation Dakota | |
| 20. Rotary or C.T. Rotary | | | | 21. Elevations (Show whether DF, RT, etc.) 5900' | |
| 21A. Kind & Status Plug. Bond Blanket Active | | | | 21B. Drilling Contractor Bayless or Aztec | |
| 22. Approx. Date Work will start August 1, 1984 | | | | | |

23.

PROPOSED CASING AND CEMENT PROGRAM

| SIZE OF HOLE | SIZE OF CASING | WEIGHT PER FOOT | SETTING DEPTH | SACKS OF CEMENT | EST. TOP |
|--------------|----------------|-----------------|---------------|-----------------|----------|
| 12" | 10-3/4" | | 400' | Surface 300 \$x | Surface |
| 8 1/2" | 7-5/8" | | 1050' | Surface 200 \$x | Surface |
| 6 1/4" | 4-1/2" | | 2800' | 200 sx | Surface |

We will drill this well with air. We will set 400' of 10-3/4" casing and drill a 8 1/2" hole to 1050'. Here we will set 7-5/8" casing and drill with air to T.D. at 2800'. If warranted, we will run 4-1/2" production string after logging.

APPROVAL VALID FOR 90 DAYS
PERMIT EXPIRES 9-3-84
UNLESS DRILLING UNDERWAY

OIL CONSERVATION COMMISSION TO BE NOTIFIED
WITHIN 24 HOURS OF BEGINNING OPERATIONS

IN ABOVE SPACE DESCRIBE PROPOSED PROGRAM: IF PROPOSAL IS TO DEEPEN OR PLUG BACK, GIVE DATA ON PRESENT PRODUCTIVE ZONE AND PROPOSED NEW PRODUCTIVE ZONE. GIVE BLOWOUT PREVENTER PROGRAM, IF ANY.

I hereby certify that the information above is true and complete to the best of my knowledge and belief.

Signed Benn G. Barz Title President, Black Oil, Inc. Date May 26, 1984

(This space for State Use)

APPROVED BY Roy Johnson TITLE OIL AND GAS INSPECTOR DATE 6-5-84

CONDITIONS OF APPROVAL, IF ANY:

NON-STANDARD LOCATION MUST BE APPROVED BEFORE
GIVING ALLOWABLE TO WELL.

OIL CONSERVATION DIVISION

P. O. BOX 2088

SANTA FE, NEW MEXICO 87501

Form C-107

Revised 10-1-78

STATE OF NEW MEXICO

ENERGY AND MINERALS DEPARTMENT

All distances must be from the outer boundaries of the Section.

| | | | | | |
|---|---------------------|------------------------|-----------------------|---------------------------------|----------------------|
| Operator BLACK OIL COMPANY | | | Lease McKEE | | Well No. 1 |
| Unit Letter I | Section 5 | Township 13N | Range 9E | County Santa Fe | |
| Actual Footage Location of Well: 1550 feet from the South line and 970 feet from the East line | | | | | |
| Ground Level Elev. 5900 | Producing Formation | | Pool | Dedicated Acreage: Acres | |

1. Outline the acreage dedicated to the subject well by colored pencil or hachure marks on the plat below.
2. If more than one lease is dedicated to the well, outline each and identify the ownership thereof (both as to working interest and royalty).
3. If more than one lease of different ownership is dedicated to the well, have the interests of all owners been consolidated by communitization, unitization, force-pooling, etc?

☐ Yes ☐ No If answer is "yes," type of consolidation _____

If answer is "no," list the owners and tract descriptions which have actually been consolidated. (Use reverse side of this form if necessary.) _____

No allowable will be assigned to the well until all interests have been consolidated (by communitization, unitization, forced-pooling, or otherwise) or until a non-standard unit, eliminating such interests, has been approved by the Commission.

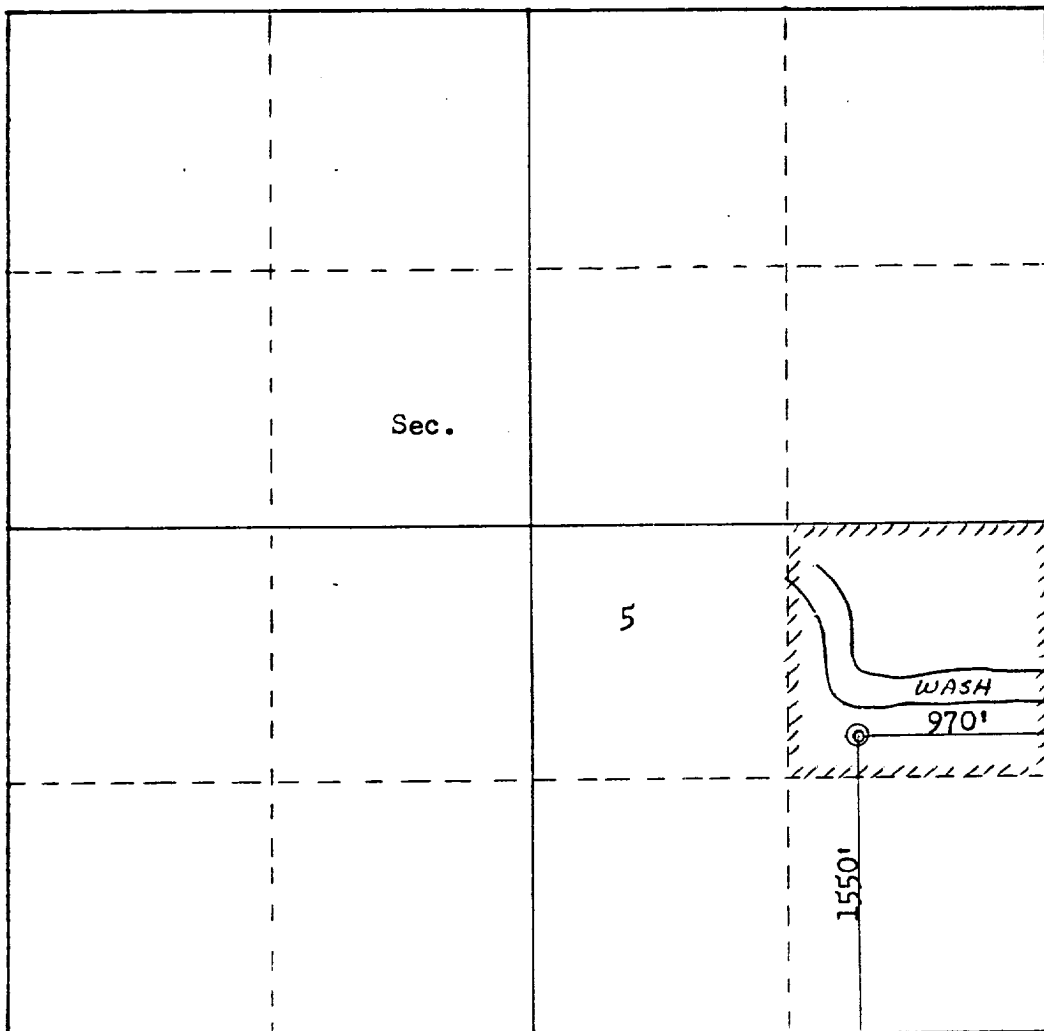

Scale: 1"=1000'

CERTIFICATION

I hereby certify that the information contained herein is true and complete to the best of my knowledge and belief.

Name

Bruce A. Black

Position

President

Company

Black Oil, Inc.

Date

May 29, 1984

I hereby certify that the well location shown on this plat was plotted from field notes of actual surveys made by me or under my supervision, and that the same is true and correct to the best of my knowledge and belief.

Date Surveyed

May 24, 1984

Registered Professional Engineer
and Land Surveyor

Fred B. Kerr Jr.
Fred B. Kerr Jr.

Certificate No. 4211

3950