

NO. OF COPIES RECEIVED	
DISTRIBUTION	
SANTA FE	
FILE	<input checked="" type="checkbox"/>
U.S.G.S.	
LAND OFFICE	
OPERATOR	

NEW MEXICO OIL CONSERVATION COMMISSION

Form C-101  
Revised 1-1-65

API # 30-049-20036

5A. Indicate Type of Lease	
STATE <input type="checkbox"/>	FEE <input checked="" type="checkbox"/>
5. State Oil & Gas Lease No.	

APPLICATION FOR PERMIT TO DRILL, DEEPEN, OR PLUG BACK

1a. Type of Work		7. Unit Agreement Name	
b. Type of Well DRILL <input checked="" type="checkbox"/> DEEPEN <input type="checkbox"/> PLUG BACK <input type="checkbox"/> OIL WELL <input checked="" type="checkbox"/> GAS WELL <input type="checkbox"/> OTHER <input type="checkbox"/> SINGLE ZONE <input type="checkbox"/> MULTIPLE ZONE <input type="checkbox"/>		8. Farm or Lease Name Ferrill	
2. Name of Operator BLACK OIL, INC.		9. Well No. No. 5	
3. Address of Operator P.O. Box 537, Farmington, NM 87499		10. Field and Pool, or Wildcat Wildcat	
4. Location of Well UNIT LETTER <u>G</u> LOCATED <u>1650</u> FEET FROM THE <u>North East</u> LINE AND <u>1740</u> FEET FROM THE <u>North</u> LINE OF SEC. <u>1</u> TWP. <u>13N</u> RGE. <u>8E</u> NMPM		12. County Santa Fe	
19. Proposed Depth 3000'		19A. Formation Dakota	
20. Rotary or C.T. Rotary		21. Elevations (Show whether DF, RT, etc.) 5895 GR	
21A. Kind & Status Plug. Bond Blanket		21B. Drilling Contractor Salazar Bros.	
22. Approx. Date Work will start January 10, 1986			

23.

PROPOSED CASING AND CEMENT PROGRAM

SIZE OF HOLE	SIZE OF CASING	WEIGHT PER FOOT	SETTING DEPTH	SACKS OF CEMENT	EST. TOP
9-5/8"	7"	20	200'	50	Surface
6-1/4"	4-1/2"	10.5	3000'	200	Surface

We propose to drill a 6-1/4" hole to 3000' to test the Niobrara interval at this location. In the event oil or gas is encountered, we will run 4-1/2" casing and attempt a completion as appropriate.

COLLECT AND SACK SAMPLES FOR  
NEW MEXICO BUREAU OF MINES, GEOLOGIC  
AND MINERAL INVESTIGATION  
OIL CONSERVATION COMMISSION TO BE NOTIFIED  
WITHIN 24 HOURS OF BEGINNING OPERATIONS

APPROVAL VALID FOR 90 DAYS  
PERMIT EXPIRES 3-27-86  
UNLESS DRILL & CEMENTED

IN ABOVE SPACE DESCRIBE PROPOSED PROGRAM: IF PROPOSAL IS TO DEEPEN OR PLUG BACK, GIVE DATA ON PRESENT PRODUCTIVE ZONE AND PROPOSED NEW PRODUCTIVE ZONE. GIVE BLOWOUT PREVENTER PROGRAM, IF ANY.

I hereby certify that the information above is true and complete to the best of my knowledge and belief.

Signed [Signature] Title President Date December 13, 1985

(This space for State Use)

APPROVED BY [Signature] TITLE DISTRICT SUPERVISOR DATE 12/27/85

CONDITIONS OF APPROVAL, IF ANY:

NEW MEXICO OIL CONSERVATION COMMISSION  
WELL LOCATION AND ACREAGE DEDICATION PLAT

Form C-102  
Supersedes C-128  
Effective 1-1-65

All distances must be from the outer boundaries of the Section.

Operator <b>BLACK OIL COMPANY</b>			Lease <b>FARRELL</b>		Well No. <b>5</b>
Unit Letter <b>G</b>	Section <b>1</b>	Township <b>13N</b>	Range <b>8E</b>	County <b>Santa Fe</b>	
Actual Footage Location of Well: <b>1740</b> feet from the <b>North</b> line and <b>1650</b> feet from the <b>East</b> line					
Ground Level Elev: <b>5879</b>	Producing Formation		Pool		Dedicated Acreage:  Acres

1. Outline the acreage dedicated to the subject well by colored pencil or hachure marks on the plat below.
2. If more than one lease is dedicated to the well, outline each and identify the ownership thereof (both as to working interest and royalty).
3. If more than one lease of different ownership is dedicated to the well, have the interests of all owners been consolidated by communitization, unitization, force-pooling, etc?

☐ Yes ☐ No If answer is "yes," type of consolidation \_\_\_\_\_

If answer is "no," list the owners and tract descriptions which have actually been consolidated. (Use reverse side of this form if necessary.) \_\_\_\_\_

No allowable will be assigned to the well until all interests have been consolidated (by communitization, unitization, forced-pooling, or otherwise) or until a non-standard unit, eliminating such interests, has been approved by the Commission.

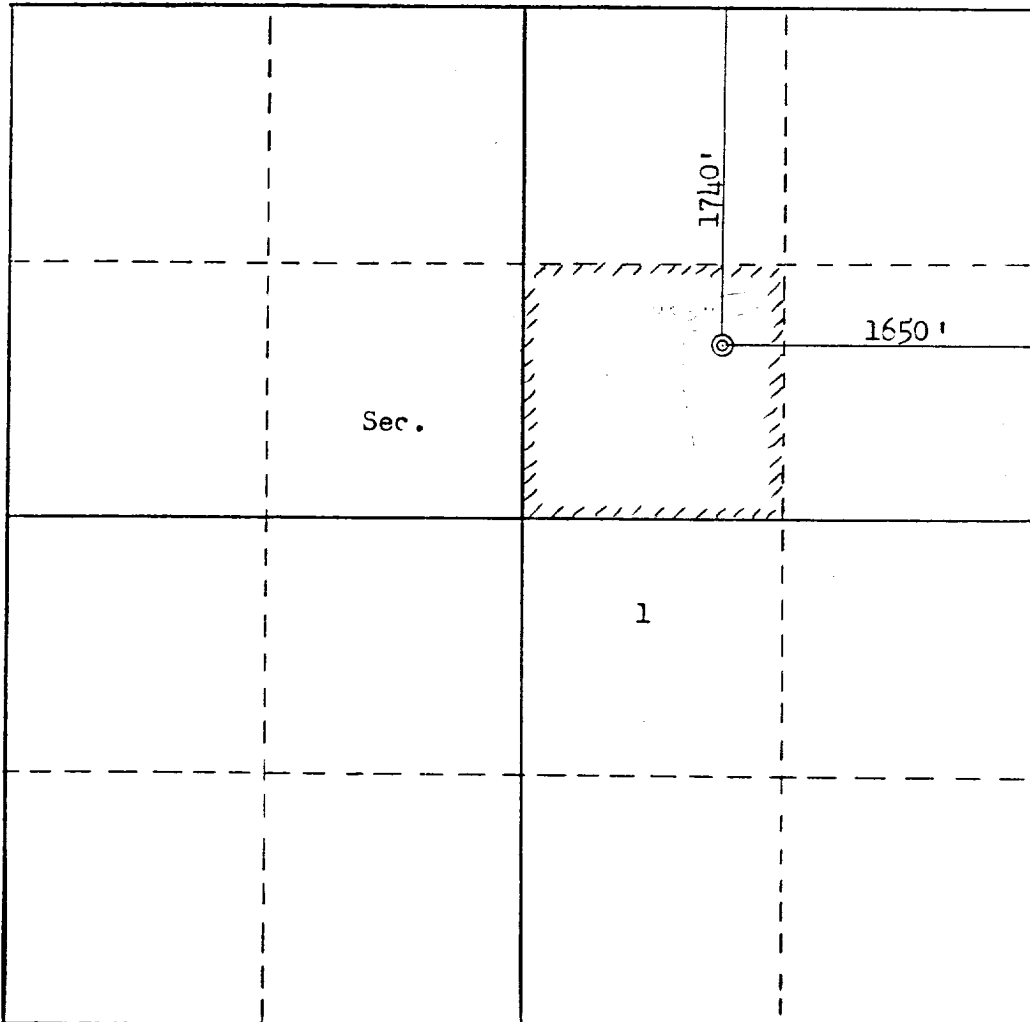

Scale: 1"=1000'

CERTIFICATION

I hereby certify that the information contained herein is true and complete to the best of my knowledge and belief.

Name  
**Bruce A. Black**

Position  
**President**

Company  
**Black Oil, Inc.**

Date  
**December 12, 1985**

I hereby certify that the well location shown on this plat was plotted from field notes of actual surveys made by me or under my supervision, and that the same is true and correct to the best of my knowledge and belief.

Date Surveyed  
**December 12, 1985**

Registered Professional Engineer  
and Land Surveyor

**Fred B. Kerr Jr.**

Certificate No.

**3950**