

11

NO. OF COPIES RECEIVED	
DISTRIBUTION	
SANTA FE	✓
FILE	
U.S.G.S.	
LAND OFFICE	
OPERATOR	

NEW MEXICO OIL CONSERVATION COMMISSION

API # 30-059-20016

Form C-101
Revised 1-1-65

5A. Indicate Type of Lease STATE <input type="checkbox"/> FEE <input checked="" type="checkbox"/>
5. State Oil & Gas Lease No.
7. Unit Agreement Name
8. Farm or Lease Name STEVENSON
9. Well No. 1
10. Field and Pool, or Wildcat WILDCAT
12. County UNION
19. Proposed Depth 2700'
19A. Formation BASEMENT
20. Rotary or C.T. ROTARY
21. Elevations (Show whether DE, RT, etc.) N.A.
21A. Kind & Status Plug, Bond BLANKET-DY FILE
21B. Drilling Contractor CACTUS DRILG Co.
22. Approx. Date Work will start 7-73

APPLICATION FOR PERMIT TO DRILL, DEEPEN, OR PLUG BACK

1a. Type of Work DRILL <input checked="" type="checkbox"/> DEEPEN <input type="checkbox"/> PLUG BACK <input type="checkbox"/>
b. Type of Well OIL WELL <input type="checkbox"/> GAS WELL <input checked="" type="checkbox"/> OTHER <input type="checkbox"/>
2. Name of Operator Amoco Production Company
3. Address of Operator BOX 68, HOBBS, N. M. 88240
4. Location of Well UNIT LETTER M LOCATED 660 FEET FROM THE SOUTH LINE AND 660 FEET FROM THE WEST LINE OF SEC. 11 TWP. 20-N RGE. 34-E NMPM
19. Proposed Depth 2700'
19A. Formation BASEMENT
20. Rotary or C.T. ROTARY
21. Elevations (Show whether DE, RT, etc.) N.A.
21A. Kind & Status Plug, Bond BLANKET-DY FILE
21B. Drilling Contractor CACTUS DRILG Co.
22. Approx. Date Work will start 7-73

PROPOSED CASING AND CEMENT PROGRAM

SIZE OF HOLE	SIZE OF CASING	WEIGHT PER FOOT	SETTING DEPTH	SACKS OF CEMENT	EST. TOP
12 1/4 - 11"	8 5/8"	24#	300'	SUFF. TO	CIRC
7 7/8"	4 1/2"	9.5#	2700'	" "	300'

IN ABOVE SPACE DESCRIBE PROPOSED PROGRAM: IF PROPOSAL IS TO DEEPEN OR PLUG BACK, GIVE DATA ON PRESENT PRODUCTIVE ZONE AND PROPOSED NEW PRODUCTIVE ZONE. GIVE BLOWOUT PREVENTER PROGRAM, IF ANY.

I hereby certify that the information above is true and complete to the best of my knowledge and belief.

Signed Carl Ulvog Title AREA SUPERINTENDENT Foreman Date 10-9-73

(This space for State Use)

APPROVED BY Carl Ulvog TITLE AREA SUPERINTENDENT DATE 10/12/73

CONDITIONS OF APPROVAL, IF ANY:

24. TIMECC-SF
BY: DALE KAPPEL
C-Tyr
C-BUSP
C-R-1

**NEW MEXICO OIL CONSERVATION COMMISSION
WELL LOCATION AND ACREAGE DEDICATION PLAT**

(11)
Form C-102
Supersedes C-128
Effective 1-1-65

All distances must be from the outer boundaries of the Section

Operator AMOCO PRODUCTION COMPANY			Lease Stevenson		Well 1
Plot Letter M	Section 11	Township 20 North	Range 34 East	County Union	
Actual Footage Location of Well: <div style="display: flex; justify-content: space-between;"> 660 feet from the south 660 feet from the west </div>					
Ground Level Elev. NA	Producing Formation BASEMENT		Dedicated Acreage WILDCAT		160

1. Outline the acreage dedicated to the subject well by colored pencil or hatchure marks on the plat below.
2. If more than one lease is dedicated to the well outline each and identify the ownership thereof (both as to working interest and royalty).
3. If more than one lease of different ownership is dedicated to the well, have the interests of all owners been consolidated by communitization, unitization, forced pooling, etc.?

☐ Yes ☐ No If answer is "yes" type of consolidation _____

If answer is "no" list the owners and tract descriptions which have actually been consolidated. (Use reverse side of this form if necessary.) _____

No allowable will be assigned to the well until all interests have been consolidated (by communitization, unitization, forced-pooling, or otherwise) or until a non-standard unit eliminating such interests, has been approved by the Commission.

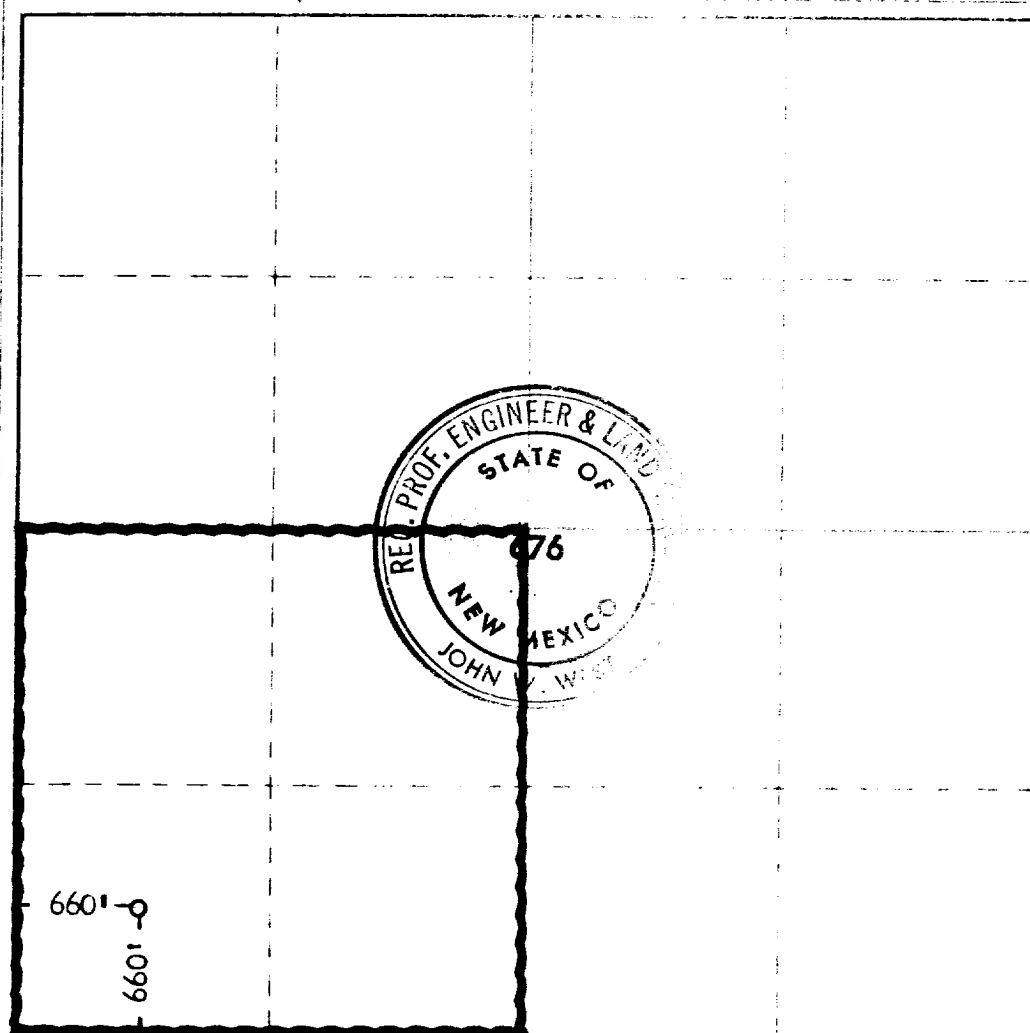

CERTIFICATION

I hereby certify that the information contained herein is true and complete to the best of my knowledge and belief.

Name Ok Williams
 Position **AREA SUPERINTENDENT** Fereman
Amoco Production Company

10-9-73

I hereby certify that the well location shown on this plat was plotted from field notes of actual surveys made by me or under my supervision, and that the same is true and correct to the best of my knowledge and belief.

Date Surveyed
May 14, 1973

Registered Professional Engineer and/or Land Surveyor

John V. West
 Certificate No. **676**