

API # 30-059-20022

NO. OF COPIES RECEIVED	
DISTRIBUTION	
SANTA FE	
FILE	
U.S.G.S.	
LAND OFFICE	
OPERATOR	

## NEW MEXICO OIL CONSERVATION COMMISSION

Form C-101  
Revised 1-4-65

5A. Indicate Type of Lease STATE <input checked="" type="checkbox"/> FEE <input type="checkbox"/>
5. State Oil & Gas Lease No.
7. Unit Agreement Name
8. Farm or Lease Name STATE FT
9. Well No. 1
10. Field and Pool, or Wildcat WILDCAT
12. County UNION

## APPLICATION FOR PERMIT TO DRILL, DEEPEN, OR PLUG BACK

1a. Type of Work DRILL <input checked="" type="checkbox"/> DEEPEN <input type="checkbox"/> PLUG BACK <input type="checkbox"/>			7. Unit Agreement Name
b. Type of Well OIL WELL <input type="checkbox"/> GAS WELL <input checked="" type="checkbox"/> CO <sub>2</sub> OTHER <input type="checkbox"/> SINGLE ZONE <input checked="" type="checkbox"/> MULTIPLE ZONE <input type="checkbox"/>			8. Farm or Lease Name STATE FT
2. Name of Operator Amoco Production Company			9. Well No. 1
3. Address of Operator BOX 367, ANDREWS, TEXAS 79714			10. Field and Pool, or Wildcat WILDCAT
4. Location of Well UNIT LETTER <u>G</u> LOCATED <u>1980</u> FEET FROM THE <u>NORTH</u> LINE AND <u>1980</u> FEET FROM THE <u>EAST</u> LINE OF SEC. <u>36</u> TWP. <u>24-N</u> RGE. <u>33E</u> NMPM			12. County UNION
19. Proposed Depth 2500'			19A. Formation TUBB
20. Rotary or C.T. ROTARY			21. Elevations (Show whether Dr, RT, etc.) 5096' GL
21A. Kind & Status Plug. Bond BLANKET - ON FILE			21B. Drilling Contractor ARTEC WELL SERV
22. Approx. Date Work will start 9-74			

23.

## PROPOSED CASING AND CEMENT PROGRAM

SIZE OF HOLE	SIZE OF CASING	WEIGHT PER FOOT	SETTING DEPTH	SACKS OF CEMENT	EST. TOP
12 1/4" - 11"	8 5/8"	29.35 - 24#	300'	SUFF TO CIRC	
7 7/8"	4 1/2"	11 - 9.5#	2500'	FILL UP TO	300'

RECEIVED  
FOR  
DATE  
12/2/74  
EXPIRES

IN ABOVE SPACE DESCRIBE PROPOSED PROGRAM: IF PROPOSAL IS TO DEEPEN OR PLUG BACK, GIVE DATA ON PRESENT PRODUCTIVE ZONE AND PROPOSED NEW PRODUCTIVE ZONE. GIVE BLOWOUT PREVENTER PROGRAM, IF ANY.

I hereby certify that the information above is true and complete to the best of my knowledge and belief.

Signed Carl Ulvog Title ADMINISTRATIVE ASSISTANT Date AUG 26 1974

(This space for State Use)

OF 3. NMOC-SF  
ATTN: CARL ULVOG  
APPROVED BY Carl Ulvog TITLE SENIOR PETROLEUM GEOLOGIST DATE 9/3/74  
1-DIV  
CONDITIONS OF APPROVAL, IF ANY:  
1- SUSP  
1- IR24

NEW MEXICO OIL CONSERVATION COMMISSION  
WELL LOCATION AND ACREAGE DEDICATION PLAT

**RECEIVED**  
AUG 28 1974

All distances must be from the outer boundaries of the Section

Lessee <b>AMOCO PRODUCTION COMPANY</b>			State <b>FT</b>		Oil Conservation Comm <b>1</b>	
Section <b>G</b>	Section <b>36</b>	Township <b>24 NORTH</b>	Range <b>33 EAST</b>	Union <b>UNION</b>		
Actual Well Location of Well:						
1980 feet from the <b>NORTH</b>		1980 feet from the <b>EAST</b>				
Ground Level Elev. <b>5096.43'</b>	Producing Formation <b>TUBB</b>	Pool <b>WILDCAT</b>	Dedicated Acreage <b>160</b>			

1. Outline the acreage dedicated to the subject well by colored pencil or hachure marks on the plat below.
2. If more than one lease is dedicated to the well, outline each and identify the ownership thereof (both as to working interest and royalty).
3. If more than one lease of different ownership is dedicated to the well, have the interests of all owners been consolidated by communitization, unitization, force-pooling, etc?

☐ Yes ☐ No If answer is "yes," type of consolidation \_\_\_\_\_

If answer is "no," list the owners and tract descriptions which have actually been consolidated. (Use reverse side of this form if necessary.) \_\_\_\_\_

No allowable will be assigned to the well until all interests have been consolidated (by communitization, unitization, forced-pooling, or otherwise) or until a non-standard unit, eliminating such interests, has been approved by the Commission.

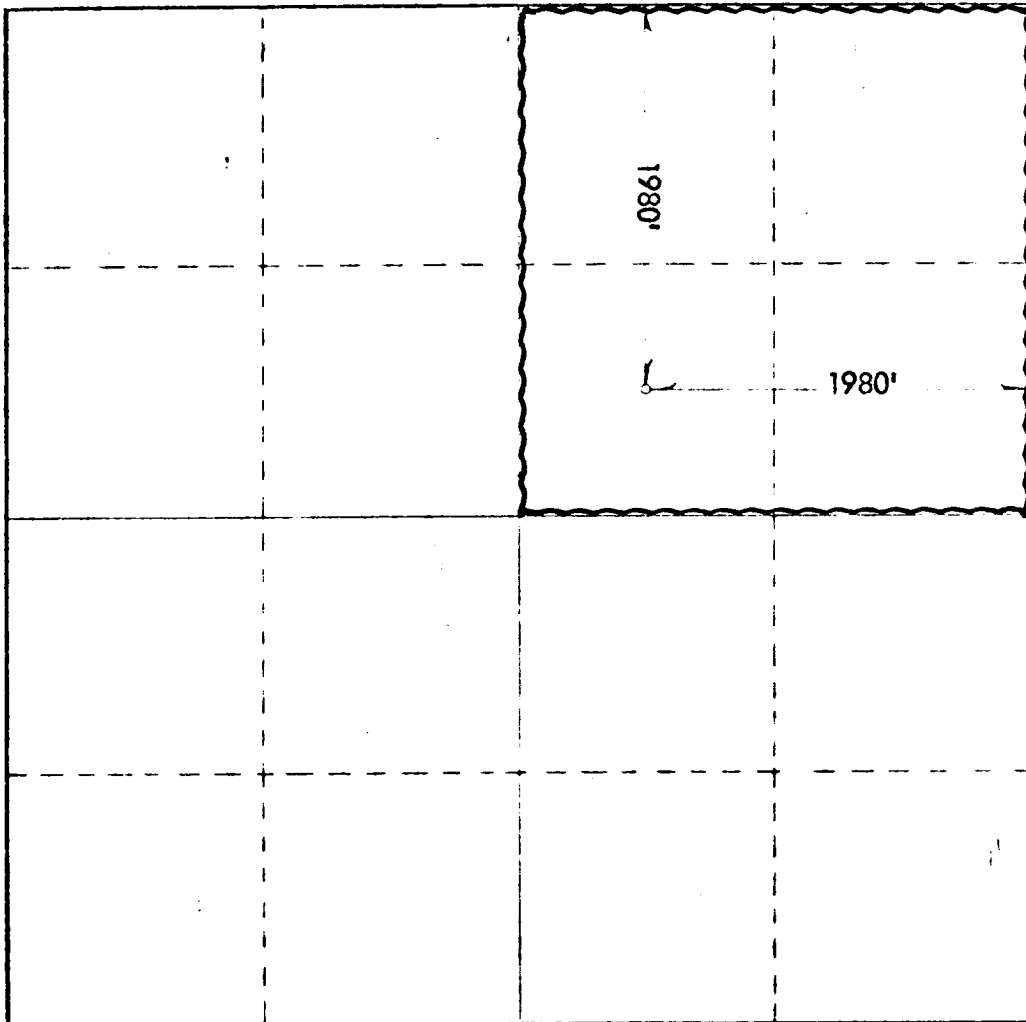

CERTIFICATION

I hereby certify that the information contained herein is true and complete to the best of my knowledge and belief.

*Ray G. Gorman*  
ADMINISTRATIVE ASSISTANT

Amoco Production Company

**AUG 26 1974**

I hereby certify that the well location shown on this plat was plotted from field notes of actual surveys made by me or under my supervision, and that the same is true and correct to the best of my knowledge and belief.

Date **AUGUST 15, 1974**

Registered Professional Engineer and Surveyor

**676**

