

NO. OF COPIES RECEIVED	
DISTRIBUTION	
SANTA FE	
FILE	
U.S.G.S.	
LAND OFFICE	
OPERATOR	

NEW MEXICO OIL CONSERVATION COMMISSION

API # 30-059-20027

Form C-101
Revised 1-1-65

5A. In Lease Type of Lease
STATE ☐ FEE ☒
5. State Oil & Gas Lease No.

APPLICATION FOR PERMIT TO DRILL, DEEPEN, OR PLUG BACK

1a. Type of Work b. Type of Well OIL WELL <input type="checkbox"/> GAS WELL <input checked="" type="checkbox"/> CO ₂ OTHER <input type="checkbox"/> SINGLE ZONE <input checked="" type="checkbox"/> MULTIPLE ZONE <input type="checkbox"/>		DRILL <input checked="" type="checkbox"/> DEEPEN <input type="checkbox"/> PLUG BACK <input type="checkbox"/>	
2. Name of Operator Amoco Production Company		7. Unit Agreement No.	
3. Address of Operator P.O. Drawer "A", Levelland, TX 79336		8. Firm or Lease Name Pittard	
4. Location of Well UNIT LETTER <u>K</u> LOCATED <u>1980</u> FEET FROM THE <u>South</u> LINE AND <u>1980</u> FEET FROM THE <u>West</u> LINE OF SEC. <u>23</u> TWP. <u>19-N</u> RGE. <u>34-E</u> NADP		9. Well No. 1	
		10. Field and Pool, or Well Unit Und. Tubb	
		17. County Union	
		18. Proposed Depth 2,625'	
		19A. Formation Tubb	
		20. History or C.T. Rotary	
21. Elevations (Show whether DT, RT, etc.) 4749.3 GR		21A. Kind & Status Plug. Bond Blanket on File	
		21B. Drilling Contractor N/A	
		22. Approx. Date Work will start May 7, 1979	

PROPOSED CASING AND CEMENT PROGRAM

SIZE OF HOLE	SIZE OF CASING	WEIGHT PER FOOT	SETTING DEPTH	SACKS OF CEMENT	EST. TOP
12 1/4"	9 5/8"	40#	350'	Circ to Surf	Surface
8 3/4"	7"	23-26#	2260'	Tie Back to 9 5/8" csg	Btm of 9 5/8"

After drilling well, logs will be run and evaluation made. Perforating and/or stimulating as necessary in attempting commercial production.

Mud Program: 0 - 350' Native mud and water
350' - 2625' Commercial and to maintain good hole conditions.

OIL CONSERVATION COMMISSION TO BE NOTIFIED
WITHIN 24 HOURS OF BEGINNING OPERATIONS

BOP program is attached
Gas is not dedicated

APPROVED BY 7/30/79 90 DAYS
PERMIT 7/30/79
UNLESS DRILLING UNDERWAY

IN ABOVE SPACE DESCRIBE PROPOSED PROGRAM: IF PROPOSAL IS TO DEEPEN OR PLUG BACK, GIVE DATA ON PRESENT PRODUCTIVE ZONE AND PROPOSED NEW PRODUCTIVE ZONE. GIVE BLOWOUT PREVENTER PROGRAM, IF ANY.

I hereby certify that the information above is true and complete to the best of my knowledge and belief.

Signed Randy Atkins Title Administrative Analyst Date April 26, 1979

(This space for State Use)

APPROVED BY Carl Ulvog TITLE SENIOR INFORMATION GEOLOGIST DATE 5/1/79

CONDITIONS OF APPROVAL, IF ANY:

0+5-NMOCD,SF 1-Susp 1-JA
1-Houston 1-RWA

COLLECT AND SACK SAMPLES FOR
NEW MEXICO OIL CONSERVATION COMMISSION, SOCORRO
AT AT LEAST TEN FOOT INTERVALS

NEW MEXICO OIL CONSERVATION COMMISSION
WELL LOCATION AND ACREAGE DEDICATION PLAT

Form O-112
Supersedes O-128
Effective 1/1/75

All distances must be from the outer boundaries of the Section

Operator Amoco Production Co.		Lease Pritter		Acres 1	
Section K	Section 23	Township 12 North	Range 34 East	County Union	
Acreage of the Location of Well:					
1930		1930		1930	
feet from South		feet from West		feet from East	
Ground Level Elev. 4749.3	Producing Formation Tubb	Foot Undesignated Tubb	Dedicated Acreage 160		

1. Outline the acreage dedicated to the subject well by colored pencil or hatchure marks on the plat below.
2. If more than one lease is dedicated to the well, outline each and identify the ownership thereof (both as to working interest and royalty).
3. If more than one lease of different ownership is dedicated to the well, have the interests of all owners been consolidated by communitization, unitization, force-pooling, etc?

☐ Yes ☐ No If answer is "yes," type of consolidation _____

If answer is "no," list the owners and tract descriptions which have actually been consolidated. (Use reverse side of this form if necessary.) _____

No allowable will be assigned to the well until all interests have been consolidated (by communitization, unitization, forced-pooling, or otherwise) or until a non-standard unit, eliminating such interests, has been approved by the Commission.

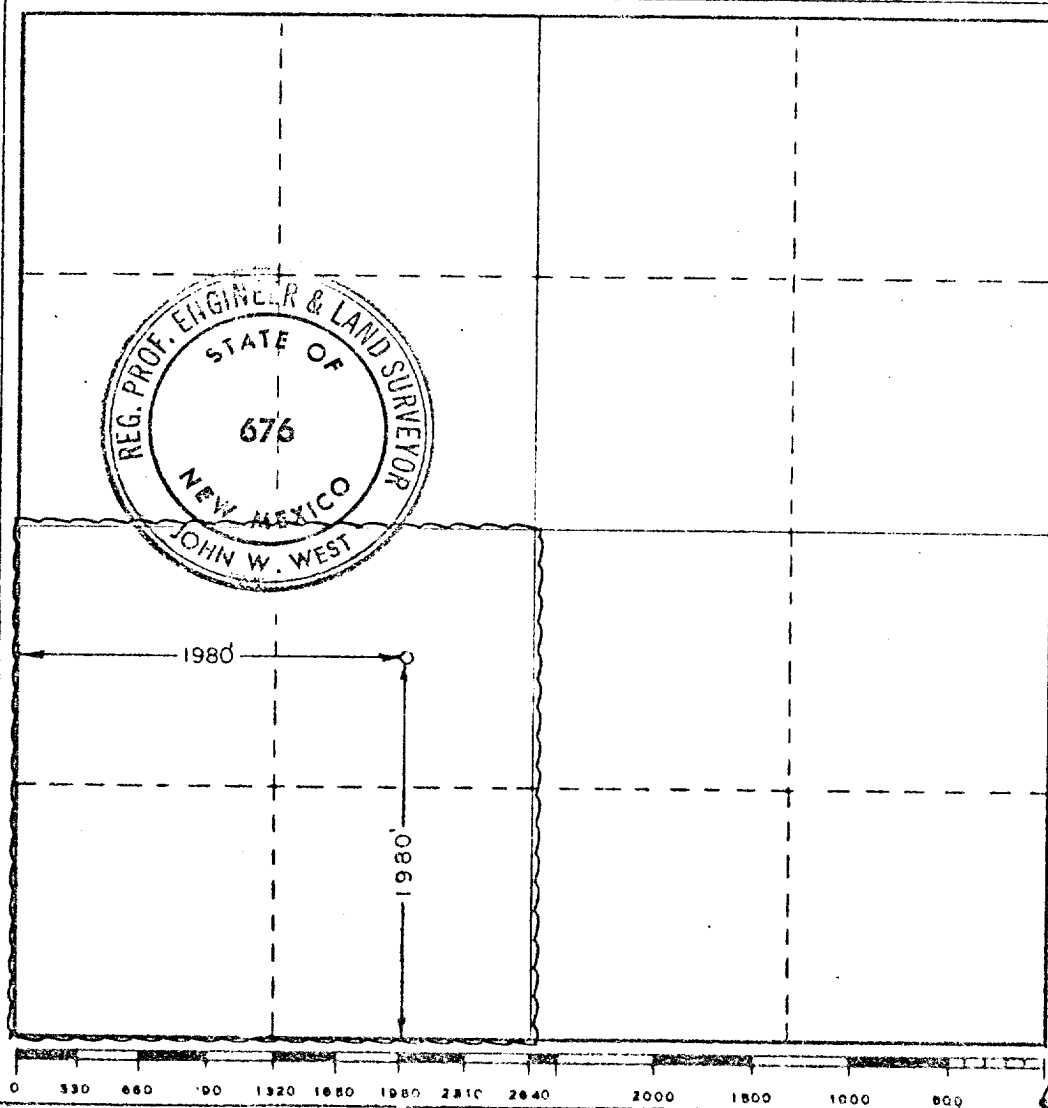

CERTIFICATION

I hereby certify that the information contained herein is true and complete to the best of my knowledge and belief.

Name **Randy Atkins**
Position **Administrative Analyst**
Company **Amoco Production Company**
Date **April 23, 1979**

I hereby certify that the well location shown on this plat was plotted from field notes of actual surveys made by me or under my supervision, and that the same is true and correct to the best of my knowledge and belief.

Date Surveyed
April 16, 1979

Registered Professional Engineer and/or Land Surveyor

John W. West
Certificate No. **John W. West 676**
Ronald J. Eidson 3239

ATTACHMENT "B"
NOTES

1. Blow-out preventers and master valve to be fluid operated and oil fittings must be in good condition, 3,000# W.P. (6,000 p.s.i. test), minimum.
2. Equipment through which bit must pass shall be as large as the inside diameter of the casing that is being drilled through.
3. Nipple above blow-out preventer shall be same size as casing being drilled through.
4. Kelly cock required, 3,000# W.P. (6,000 p.s.i. test) minimum.
5. OMSCO or comparable safety valve must be available on rig floor at all times with proper connection or sub, 3,000# W.P. (6,000 p.s.i. test), minimum.
6. Blow-out preventers and master valve while drilling intermediate hole to 6000' may be 2,000# W.P. (4,000 p.s.i. test), minimum.
7. Choke assembly, beyond second valve from cross, may be positioned (Optional) outside of derrick foundation.
8. Spool or cross may be eliminated if connections are available in the lower part of the blow-out preventer body.
9. Plug valves - gate valves are optional. Valves shown as 2" are minimum size.
10. Casing head and casing head spool, including attached valves, to be furnished by Amoco.
11. Rams in preventers will be installed as follows:

When drilling, use:	When running casing, use:
Top Preventer - Drill pipe rams	Top Preventer - Casing rams
Bottom Preventer - Blind rams or master valve	Bottom Preventer - Blind rams or master valve

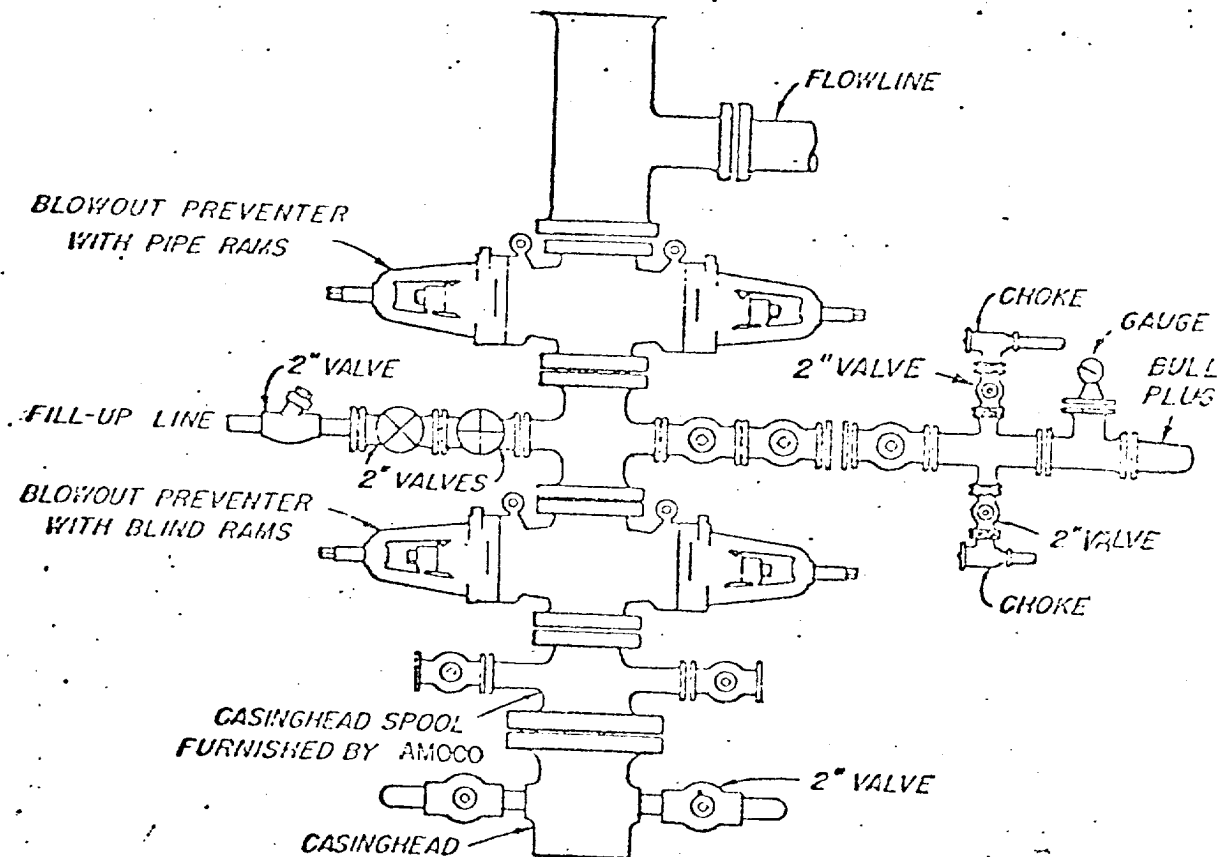

BLOWOUT PREVENTER HOOK-UP

AMOCO PRODUCTION COMPANY

EXHIBIT D-1 MODIFIED

JUNE 1, 1962