

MEXICO OIL CONSERVATION COMMISSION
WELL LOCATION AND ACREAGE DEDICATION PLAT

Form 1-72
Supersedes C-128
Effective 1-1-65

All distances must be from the outer boundaries of the Section.

Operator AMOCO PRODUCTION COMPANY		Name Bravo Dome Carbon Dioxide Gas Unit		Area 2034 081F	
Section F	Section 8	Range 20 NORTH	Range 34 EAST	County UNION	
Acreage of the Section of Wells: <div style="display: flex; justify-content: space-between;"> 1980 feet from the NORTH 1980 feet from the WEST </div>					
Original Elev. 4811.40	Producing Formation Tubb	Area Bravo Dome 640-acre area		Acres 640	

- Outline the acreage dedicated to the subject well by colored pencil or hatchure marks on the plat below.
- If more than one lease is dedicated to the well, outline each and identify the ownership thereof (both as to working interest and royalty).
- If more than one lease of different ownership is dedicated to the well, have the interests of all owners been consolidated by communitization, unitization, force-pooling, etc?

☒ Yes ☐ No If answer is "yes," type of consolidation unitization

If answer is "no," list the owners and tract descriptions which have actually been consolidated (use reverse side of this form if necessary.) _____

No allowable will be assigned to the well until all interests have been consolidated (by communitization, unitization, forced-pooling, or otherwise) or until a non-standard unit, eliminating such interests, has been approved by the Commission.

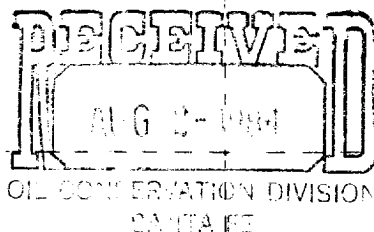
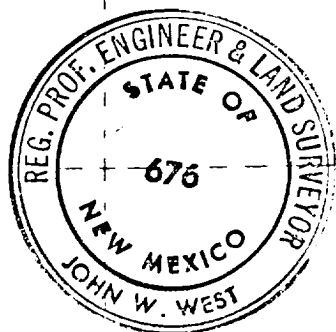
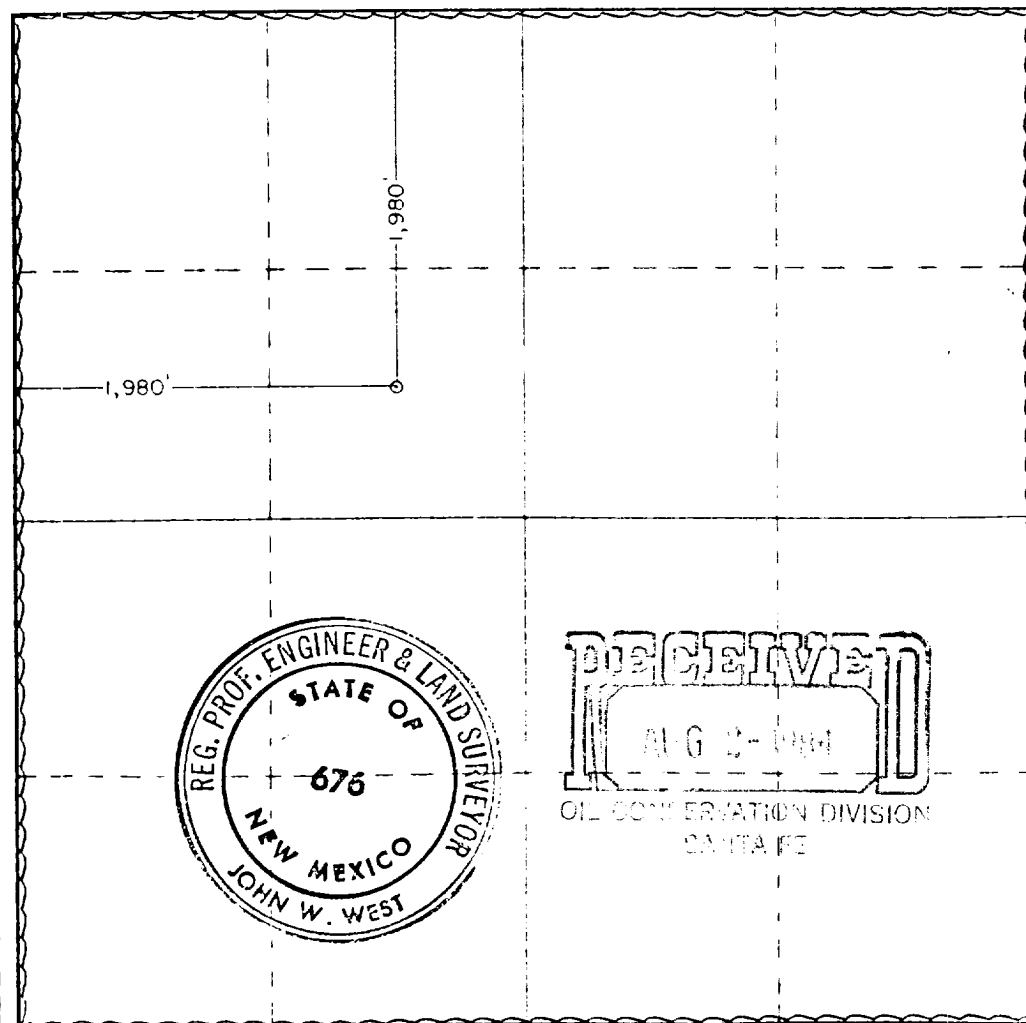

CERTIFICATION

I hereby certify that the information contained herein is true and complete to the best of my knowledge and belief.

By John S. McElroy
Asst. Administrative Analyst

For Amoco Production Company

Date 7-20-84

I hereby certify that the well location shown on this plat was plotted from field notes of actual surveys made by me or under my supervision and that the same is true and correct to the best of my knowledge and belief.

APRIL 26TH, 1979.

Registered Professional Engineer and Land Surveyor

By John W. West
Certificate No. 676
Ronald J. Eidson 3239