

NO. OF COPIES RECEIVED	
DISTRIBUTION	
SANTA FE	
FILE	
U.S.G.S.	
LAND OFFICE	
OPERATOR	

NEW MEXICO OIL CONSERVATION COMMISSION

API # 30-059-20035

Form C-101
Revised 1-1-65

5A. Indicate Type of Lease
STATE ☐ FEE ☒

5. State Oil & Gas Lease No.

APPLICATION FOR PERMIT TO DRILL, DEEPEN, OR PLUG BACK

1a. Type of Work		7. Unit Agreement Name	
b. Type of Well OIL WELL <input type="checkbox"/> GAS WELL <input checked="" type="checkbox"/> CO ₂ OTHER <input type="checkbox"/> DRILL <input checked="" type="checkbox"/> DEEPEN <input type="checkbox"/> PLUG BACK <input type="checkbox"/> SINGLE ZONE <input checked="" type="checkbox"/> MULTIPLE ZONE <input type="checkbox"/>		8. Farm or Lease Name Poling	
2. Name of Operator Amoco Production Company		9. Well No. 1	
3. Address of Operator P. O. Box 68, Hobbs, NM 88240		10. Field and Pool, or Wildcat Und. Tubb	
4. Location of Well UNIT LETTER J LOCATED 1980 FEET FROM THE South LINE AND 1980 FEET FROM THE East LINE OF SEC. 28 TWP. 22-N RGE. 32-E NMPM		11. County Union	
19. Proposed Depth 3220 3200'		19A. Formation Tubb	
20. Rotary or C.T. Rotary		21. Elevations (show whether DI, KI, etc.) 4949.8 GR	
21A. Kind & Status Plug. Bond Blanket-on-file		21B. Drilling Contractor Sitton Drilling Co.	
22. Approx. Date Work will start 8-9-79			

23. PROPOSED CASING AND CEMENT PROGRAM

SIZE OF HOLE	SIZE OF CASING	WEIGHT PER FOOT	SETTING DEPTH	SACKS OF CEMENT	EST. TOP
12-1/4"	8-5/8"	24#	350'	Circ to Surf	Surface
7-7/8"	4-1/2"	9.5#	3200'	Tie back to 8-5/8" csg.	Btm of 8-5/8"

Propose to drill and equip well in the Tubb formation after reaching TD, logs will be run and evaluated. Perforate and/or stimulate as necessary in attempting commercial production.

Mud Program: 0-350' Native mud and water
350'-TD Commercial mud to maintain good hole conditions.

BOP Program is attached
Gas is not dedicated.

APPROVAL VALID FOR 90 DAYS
PERMIT EXPIRES 11-12-79
UNLESS DRILLING UNDERWAY

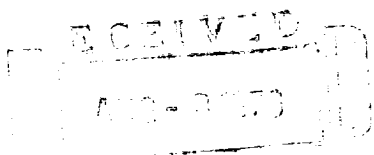

OIL CONSERVATION COMMISSION TO BE NOTIFIED
WITHIN 24 HOURS OF BEGINNING OPERATIONS

IN ABOVE SPACE DESCRIBE PROPOSED PROGRAM. IF PROPOSAL IS TO DEEPEN OR PLUG BACK, GIVE DATA ON PRESENT PRODUCTIVE ZONE AND PROPOSED NEW PRODUCTIVE ZONE. GIVE BLOWOUT PREVENTER PROGRAM, IF ANY.

I hereby certify that the information above is true and complete to the best of my knowledge and belief.

Signed Bob Laws Title Asst. Admin. Analyst Date 8-6-79

(This space for State Use)

APPROVED BY Carl Lulog TITLE SENIOR PETROLEUM GEOLOGIST DATE 8-13-79

CONDITIONS OF APPROVAL, IF ANY:

0+5- NMOCD-SF, 1-Hou, 1-Susp, 1-BD

COLLECT AND SACK SAMPLES FOR
NEW MEXICO BUREAU OF MINES, SOCORRO
AT AT LEAST TEN FOOT INTERVALS

NEW MEXICO OIL CONSERVATION COMMISSION
WELL LOCATION AND ACREAGE DEDICATION PLAT

Form C-102
Supersedes C-128
Effective 1-1-65

All distances must be from the outer boundaries of the Section.

Operator Amoco Production Co.			Lease Poling		Well No. 1
Unit Letter J	Section 28	Township 22 North	Range 32 East	County Union	
Actual Footage Location of Well: 1980 feet from the South line and 1980 feet from the East line					
Ground Level Elev. 4949.8	Producing Formation Tubb		Pool Undesignated Tubb	Dedicated Acreage: 160 Acres	

1. Outline the acreage dedicated to the subject well by colored pencil or hatchure marks on the plat below.
2. If more than one lease is dedicated to the well, outline each and identify the ownership thereof (both as to working interest and royalty).
3. If more than one lease of different ownership is dedicated to the well, have the interests of all owners been consolidated by communitization, unitization, force-pooling, etc?

☐ Yes ☐ No If answer is "yes," type of consolidation _____

If answer is "no," list the owners and tract descriptions which have actually been consolidated. (Use reverse side of this form if necessary.) _____

No allowable will be assigned to the well until all interests have been consolidated (by communitization, unitization, forced-pooling, or otherwise) or until a non-standard unit, eliminating such interests, has been approved by the Commission.

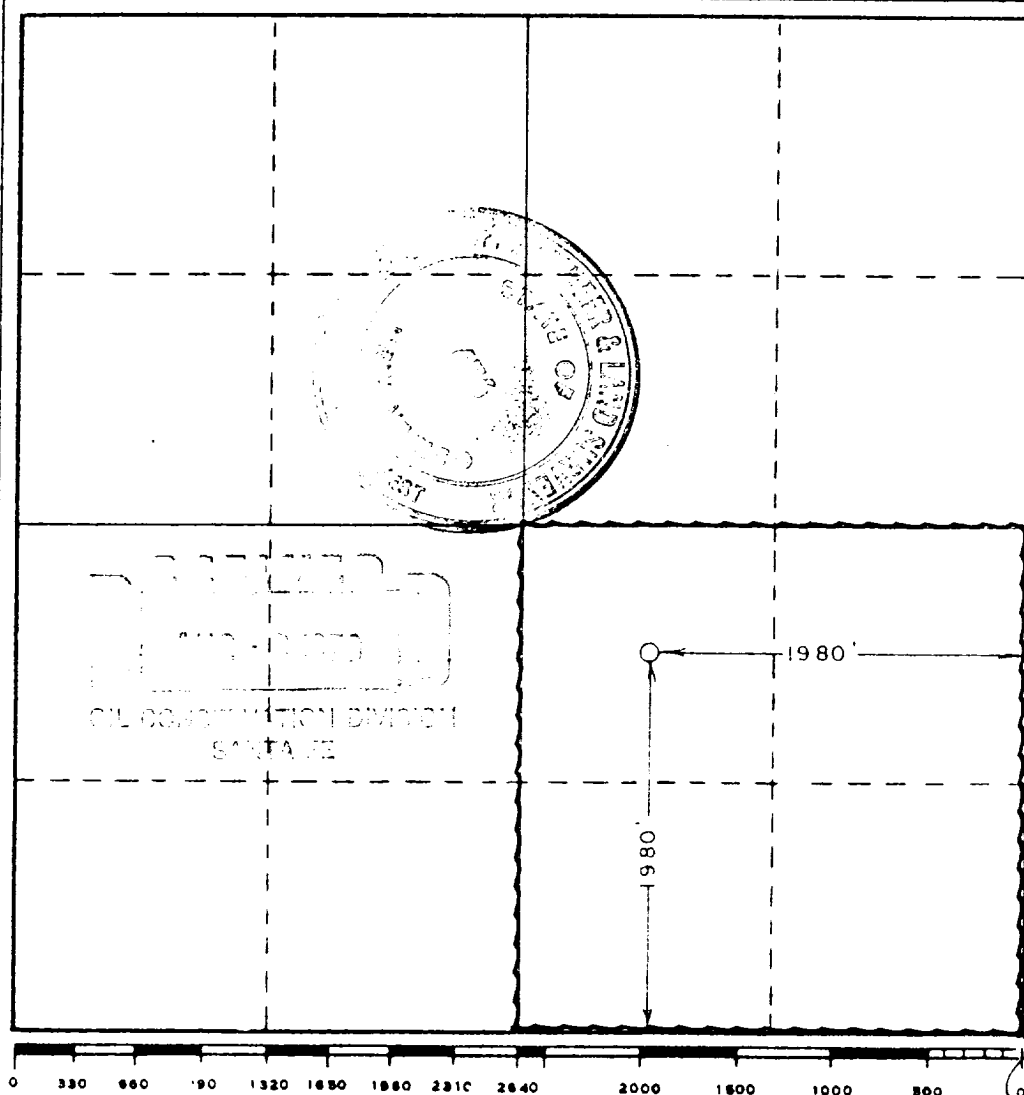

CERTIFICATION

I hereby certify that the information contained herein is true and complete to the best of my knowledge and belief.

Name: **Bob Lewis**
Position: **Asst. Administrative Analyst**
Company: **Amoco Production Company**
Date: **August 7, 1979**

I hereby certify that the well location shown on this plat was plotted from field notes of actual surveys made by me or under my supervision, and that the same is true and correct to the best of my knowledge and belief.

Date Surveyed: **8-6-79**
Registered Professional Engineer and/or Land Surveyor: **John W. West**
Certificate No. **676**
Ronald J. Eidson **3239**

ATTACHMENT "B"
NOTES

- When drilling, use:

When running casing, use:

Top Preventer - Casing rams
Bottom Preventer - Blind rams or
Master valve

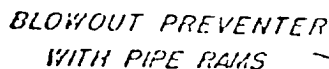

BLOWOUT PREVENTER WITH BLIND RAMS

CASINGHEAD SPOOL
FURNISHED BY

CASINGHEAD

ANON PROXY-TO-SERVER

JUNE 1, 1962