

**NEW MEXICO OIL CONSERVATION COMMISSION
WELL LOCATION AND ACREAGE DEDICATION PLAT**

Form C-102
Supersedes C-128
Effective 1-4-65

All distances must be from the outer boundaries of the Section.

| | | | | | |
|--|------------------------------------|-----------------------------|--|--|------------------------------|
| Operator Amoco Production Co. | | | Lease Bravo Dome Carbon Dioxide Gas Unit | | Well No. 2232-281J |
| Unit Letter J | Section 28 | Township 22 North | Range 32 East | County Union | |
| Actual Footage Location of Well: 1980 feet from the South line and 1980 feet from the East line | | | | | |
| Ground Level Elev. 4949.8 | Producing Formation Tubb | | Pool Bravo Dome 640 Acre Area | Dedicated Acreage: 640 Acres | |

1. Outline the acreage dedicated to the subject well by colored pencil or hatchure marks on the plat below.
2. If more than one lease is dedicated to the well, outline each and identify the ownership thereof (both as to working interest and royalty).
3. If more than one lease of different ownership is dedicated to the well, have the interests of all owners been consolidated by communitization, unitization, force-pooling, etc?

☒ Yes ☐ No If answer is "yes," type of consolidation Pooling Declaration

If answer is "no," list the owners and tract descriptions which have actually been consolidated. (Use reverse side of this form if necessary.) _____

No allowable will be assigned to the well until all interests have been consolidated (by communitization, unitization, forced-pooling, or otherwise) or until a non-standard unit, eliminating such interests, has been approved by the Commission.

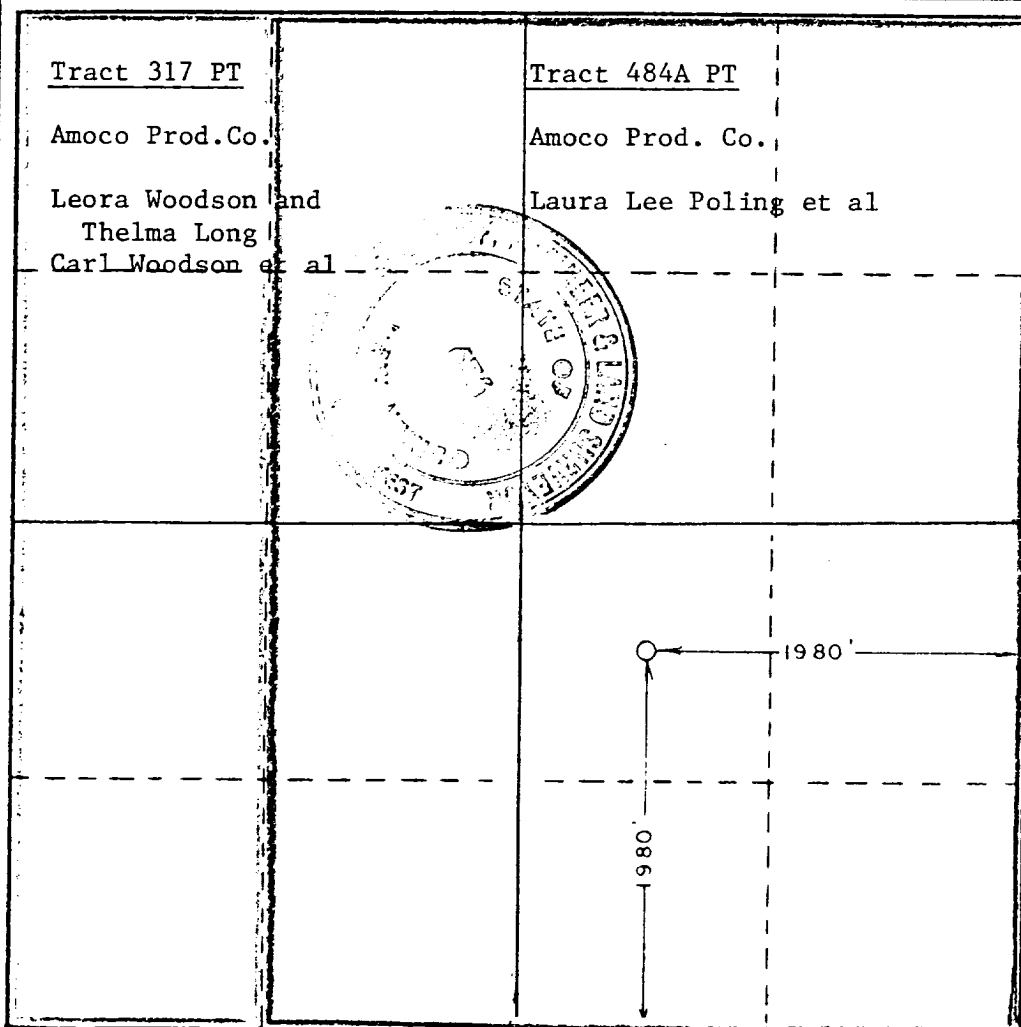

CERTIFICATION

I hereby certify that the information contained herein is true and complete to the best of my knowledge and belief.

Name: John S. McElroy
 Position: Asst. Administrative Analyst

Company: Amoco Production Company

Date: 9-12-84

I hereby certify that the well location shown on this plat was plotted from field notes of actual surveys made by me or under my supervision, and that the same is true and correct to the best of my knowledge and belief.

Date Surveyed: 8-6-79

Registered Professional Engineer and/or Land Surveyor

Ronald J. Eidson

Certificate No. John W. West 676
Ronald J. Eidson 3239