

All distances must be from the outer boundaries of the Section.

Operator AMOCO			Lease Bravo Dome Carbon Dioxide Gas Unit		Well No. 1934 151J
Unit Letter J	Section 15	Township T 19 N	Range R 34 E	County UNION	
Actual Postage Location of Well: 1980 feet from the SOUTH line and 1985 feet from the EAST line					
Ground Level Elev. 4800	Producing Formation Tubb	Pool Bravo Dome 640-acre area		Dedicated Acreage: 640	Acre

1. Outline the acreage dedicated to the subject well by colored pencil or hatchure marks on the plat below.
2. If more than one lease is dedicated to the well, outline each and identify the ownership thereof (both as to working interest and royalty).
3. If more than one lease of different ownership is dedicated to the well, have the interests of all owners been consolidated by communization, unitization, force-pooling, etc?

☒ Yes ☐ No If answer is "yes," type of consolidation Pooling Declaration

If answer is "no," list the owners and tract descriptions which have actually been consolidated. (Use reverse side of this form if necessary.)

No allowable will be assigned to the well until all interests have been consolidated (by communization, unitization, forced-pooling, or otherwise) or until a non-standard unit, eliminating such interests, has been approved by the Division.

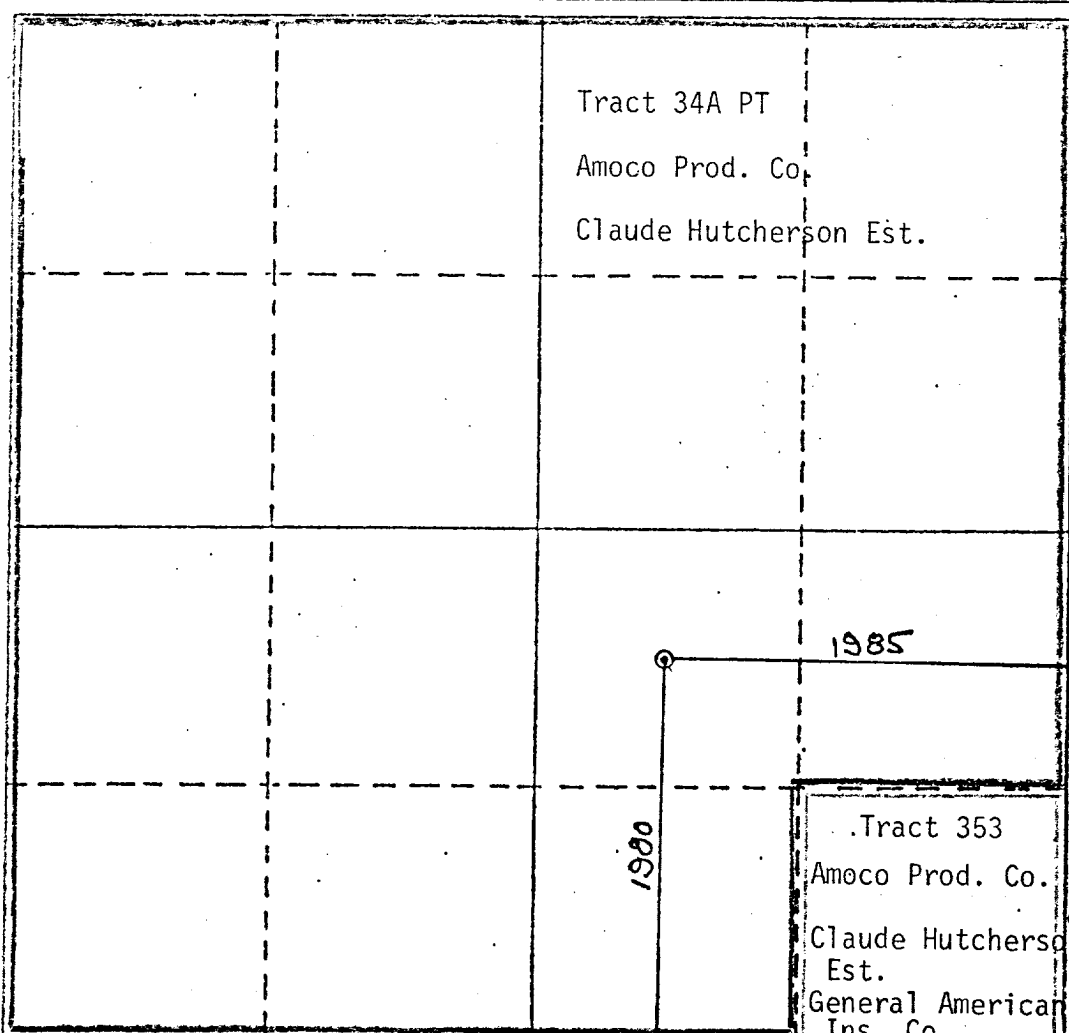

CERTIFICATION

I hereby certify that the information contained herein is true and complete to the best of my knowledge and belief.

Name John S. McElroy
Position Assist. Admin. Analyst
Company Amoco Production Company
Date 8-8-84

I hereby certify that the well location shown on this plat was plotted from field notes of actual surveys made by me or under my supervision, and that the same is true and correct to the best of my knowledge and belief.

Date Surveyed 8-8-84
Registered Land Surveyor
No. 500
State of New Mexico
LEE E. SHIELDS

N. M. L. S. NO 5103
Certificate No.