

NO. OF COPIES RECEIVED	
DISTRIBUTION	
SANTA FE	
FILE	
U.S.G.S.	
LAND OFFICE	
OPERATOR	

# NEW MEXICO OIL CONSERVATION COMMISSION

API # 30-059-20063

Form C-101  
Revised 1-1-65

5A. Indicate Type of Lease STATE <input type="checkbox"/> FEE <input checked="" type="checkbox"/>
5. State Oil & Gas Lease No.
7. Unit Agreement Name
8. Farm or Lease Name Hutcherson C
9. Well No. 1
10. Field and Pool, or Wildcat Und. Tubb
12. County Union
19. Proposed Depth 2630'
19A. Formation Tubb
20. Rotary or C.T. Rotary
21. Elevations (Show whether DT, RT, etc.) 4870 GL
21A. Kind & Status Plug. Bond Blanket-on-file
21B. Drilling Contractor NA
22. Approx. Date Work will start 10-15-80

APPLICATION FOR PERMIT TO DRILL, DEEPEN, OR PLUG BACK	
1a. Type of Work b. Type of Well OIL WELL <input type="checkbox"/> GAS WELL <input checked="" type="checkbox"/> C02 OTHER <input type="checkbox"/> SINGLE ZONE <input checked="" type="checkbox"/> MULTIPLE ZONE <input type="checkbox"/>	
2. Name of Operator Amoco Production Company	
3. Address of Operator P. O. Box 68 Hobbs, NM 88240	
4. Location of Well UNIT LETTER K LOCATED 1650 FEET FROM THE South LINE AND 1994 FEET FROM THE West LINE OF SEC. 9 TWP. 19-N RGE. 34-E NMPM	
23.	

## PROPOSED CASING AND CEMENT PROGRAM

SIZE OF HOLE	SIZE OF CASING	WEIGHT PER FOOT	SETTING DEPTH	SACKS OF CEMENT	EST. TOP
11" or 12-1/4"	8-5/8"	24#	700'	Circ.	Surf.
7-7/8"	5-1/2"	14#	2630'	Tie back to 8-5/8"	Bottom 8-5/8"

Propose to drill and equip well in the Tubb formation. After reaching TD, logs will be run and evaluated. Perforate and stimulate as necessary in attempting commercial production.

MUD PROGRAM: 0'-700' Native mud and fresh water  
700'-TD Commercial mud with minimum properties for safe hole conditions.

BOP Attached  
Gas is not dedicated

RECEIVED  
OCT 08 1980  
OIL CONSERVATION COMMISSION TO BE NOTIFIED  
WITHIN 24 HOURS OF BEGINNING OPERATIONS

0+2-NMOCD, SF T-Hou 1-Susp 1-LBG 1-W. Stafford, Hou

APPROVAL VALID FOR 90 DAYS  
PERMIT EXPIRES 1-7-81  
UNLESS DRILLING UNDERWAY

IN ABOVE SPACE DESCRIBE PROPOSED PROGRAM: IF PROPOSAL IS TO DEEPEN OR PLUG BACK, GIVE DATA ON PRESENT PRODUCTIVE ZONE AND PROPOSED NEW PRODUCTIVE ZONE. GIVE BLOWOUT PREVENTER PROGRAM, IF ANY.

I hereby certify that the information above is true and complete to the best of my knowledge and belief.

Signed Bob Davis Title Admin. Analyst Date 10-7-80

(This space for State Use)

APPROVED BY Carl Velazquez TITLE SENIOR REGIONAL MANAGER DATE 10/9/80

CONDITIONS OF APPROVAL, IF ANY:

## OIL CONSERVATION DIVISION

STATE OF NEW MEXICO  
ENERGY AND MINERALS DEPARTMENTP. O. BOX 2088  
SANTA FE, NEW MEXICO 87501Form C-102  
Revised 10-1-78

All distances must be from the outer boundaries of the Section.

Operator AMOCO			Lease HUTCHERSON C		Well No. 1
Unit Letter K	Section 9	Township T 19 N	Range R 34 E	County UNION	
Actual Postage Location of Well: 1650 feet from the SOUTH line and 1994 feet from the WEST line					
Ground Level Elev. 4870	Producing Formation Tubb		Pool Und. Tubb		Dedicated Acreage: 160 Acres

1. Outline the acreage dedicated to the subject well by colored pencil or hatchure marks on the plat below.
2. If more than one lease is dedicated to the well, outline each and identify the ownership thereof (both as to working interest and royalty).
3. If more than one lease of different ownership is dedicated to the well, have the interests of all owners been consolidated by communitization, unitization, force-pooling, etc?

☐ Yes ☐ No If answer is "yes," type of consolidation \_\_\_\_\_

If answer is "no," list the owners and tract descriptions which have actually been consolidated. (Use reverse side of this form if necessary.) \_\_\_\_\_

No allowable will be assigned to the well until all interests have been consolidated (by communitization, unitization, forced-pooling, or otherwise) or until a non-standard unit, eliminating such interests, has been approved by the Division.

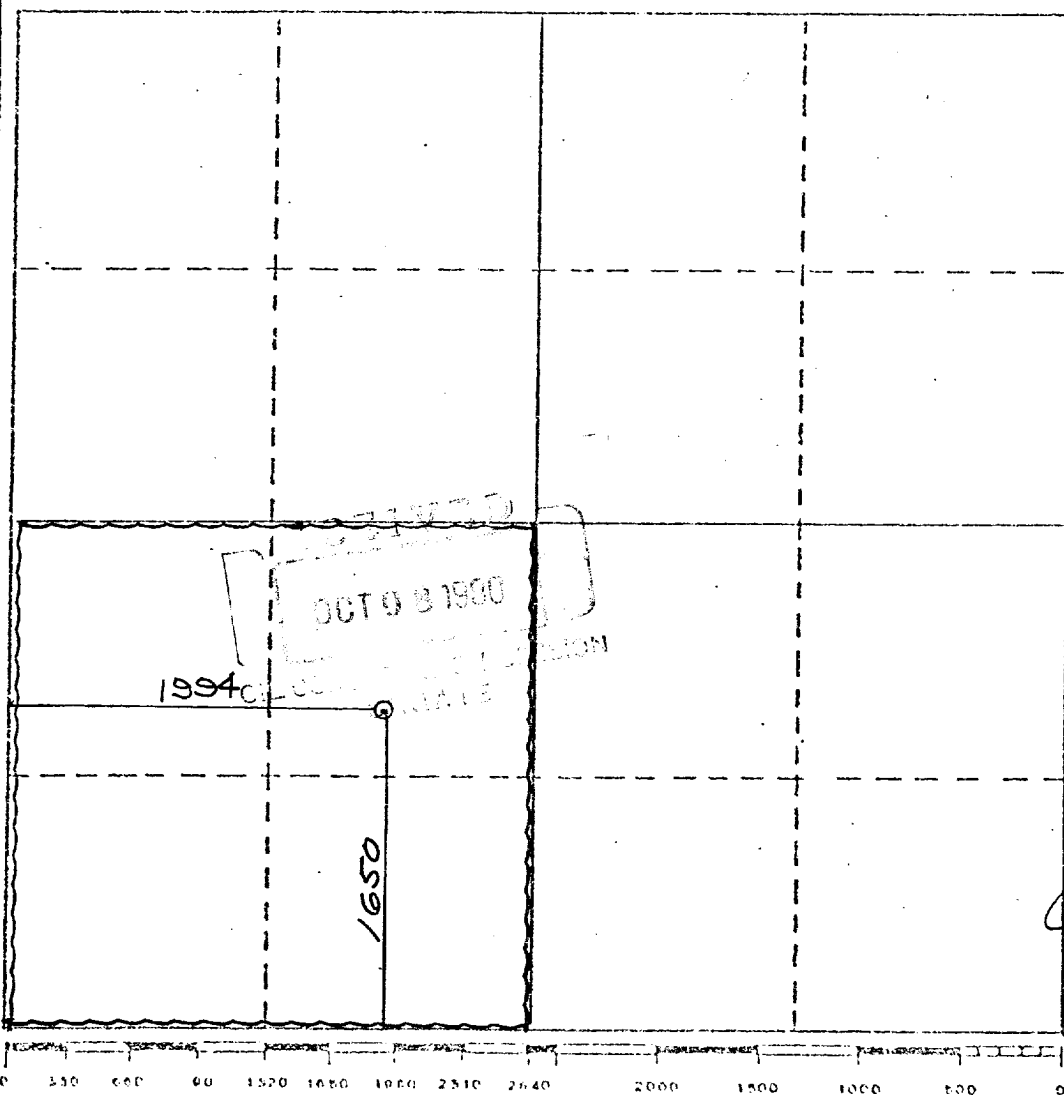

## CERTIFICATION

I hereby certify that the information contained herein is true and complete to the best of my knowledge and belief.

Name Bob Davis  
Position Administrative Analyst  
Company Amoco Production Company  
Date 10-7-80

I hereby certify that the well location shown on this plat was plotted from field notes of actual surveys made by me or under my supervision, and that the same is true and correct to the best of my knowledge and belief.

SEPT 17, 1980

Date Surveyed  
[Signature]  
Registered Professional Engineer  
and/or Land Surveyor

N. M. L. S. NO. 5103  
Certificate No.