

OIL CONSERVATION DIVISION

STATE OF NEW MEXICO
ENERGY AND MINERALS DEPARTMENTP. O. BOX 2088
SANTA FE, NEW MEXICO 87501Form C-102
Revised 10-1-73

All distances must be from the outer boundaries of the Section.

Operator AMOCO			Lease Bravo Dome Carbon Dioxide Gas Unit		Well No. 1934 021K
Unit Letter K	Section 2	Township T 19 N	Range R 34 E	County UNION	
Actual Footage Location of Well:					
1980 feet from the SOUTH		Line and 1980 feet from the WEST		Line	
Ground Level Elev. 4786	Producing Formation Tubb	Pool Bravo Dome 640-acre area		Dedicated Acreage: 640 Acres	

1. Outline the acreage dedicated to the subject well by colored pencil or hatchure marks on the plat below.
2. If more than one lease is dedicated to the well, outline each and identify the ownership thereof (both as to working interest and royalty).
3. If more than one lease of different ownership is dedicated to the well, have the interests of all owners been consolidated by communitization, unitization, force-pooling, etc?

☒ Yes ☐ No If answer is "yes," type of consolidation Pooling Declaration

If answer is "no," list the owners and tract descriptions which have actually been consolidated. (Use reverse side of this form if necessary.)

No allowable will be assigned to the well until all interests have been consolidated (by communitization, unitization, forced-pooling, or otherwise) or until a non-standard unit, eliminating such interests, has been approved by the Division.

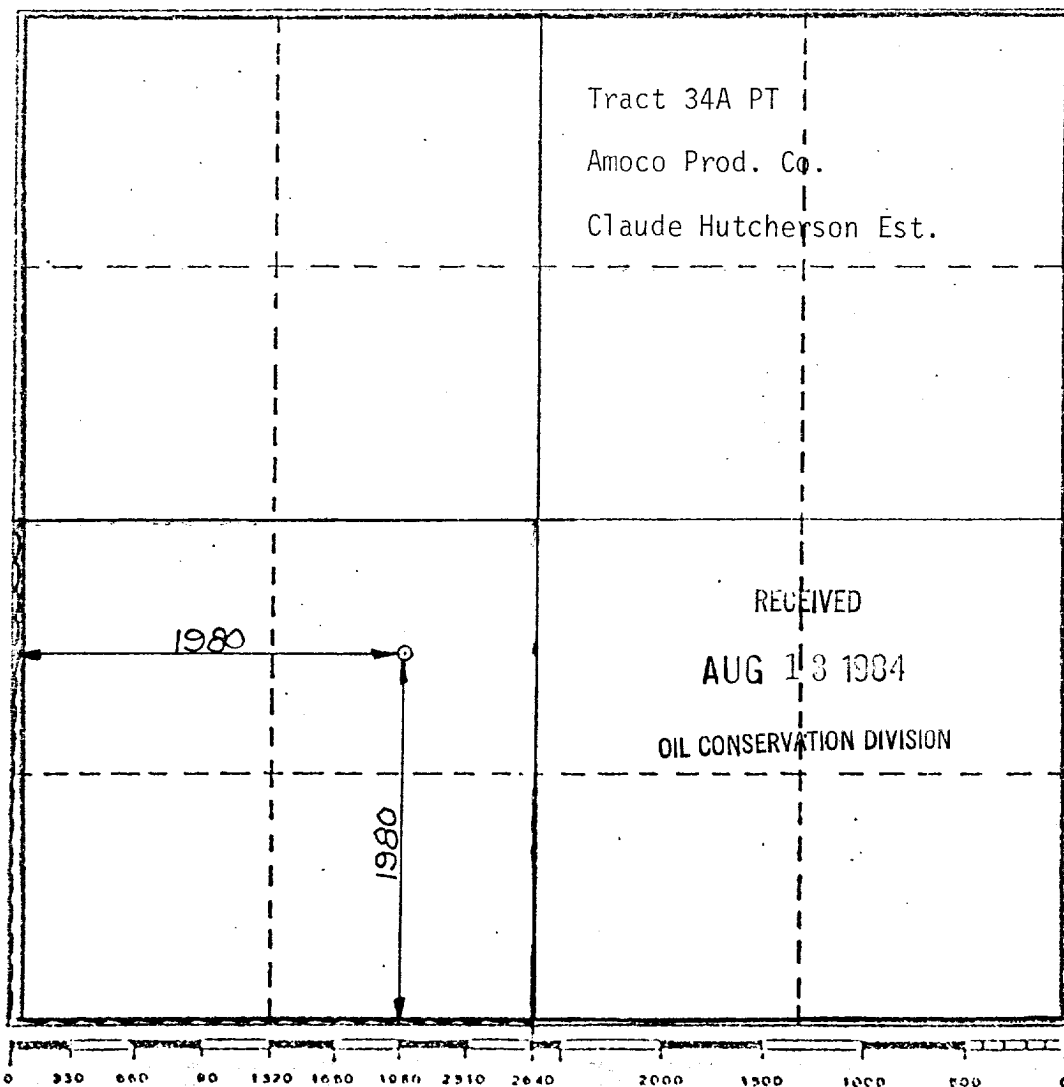

CERTIFICATION

I hereby certify that the information contained herein is true and complete to the best of my knowledge and belief.

Name John R. McElroy
Position Assist. Admin. Analyst
Company Amoco Production Company
Date 8-8-84

I hereby certify that the well location shown on this plat was plotted from field notes of actual surveys made by me or under my supervision, and that the same is true and correct to the best of my knowledge and belief.

AUGUST 29 1984
Date Surveyed
Registered Professional Engineer
and/or Land Surveyor
NMLS NO. 5103
Certificate No. E. SHIEL