

NO. OF COPIES RECEIVED	
DISTRIBUTION	
SANTA FE	
FILE	<input checked="" type="checkbox"/>
U.S.G.S.	
LAND OFFICE	
OPERATOR	

NEW MEXICO OIL CONSERVATION COMMISSION

OIL CONS. DIST. DIV.  
SANTA FE

Form G-101  
Revised 1-1-65

5. Indicate Type of Lease
STATE <input type="checkbox"/> FEE <input checked="" type="checkbox"/>
6. State Oil & Gas Lease No.

API # 30-059-20103

APPLICATION FOR PERMIT TO DRILL, DEEPEN, OR PLUG BACK

1a. Type of work		7. Unit Agreement Name	
b. Type of Well DRILL <input checked="" type="checkbox"/> DEEPEN <input type="checkbox"/> PLUG BACK <input type="checkbox"/>		8. Firm or Lease Name E. Roberts	
c. Kind of Well OIL WELL <input type="checkbox"/> GAS WELL <input checked="" type="checkbox"/> CO2 <input type="checkbox"/> OTHER <input type="checkbox"/>		9. Well No. 1	
10. Field and Pool, or Well Unit Und. Tubb			
11. Name of Operator Amoco Production Company			
12. Address of Operator P. O. Box 68 Hobbs, NM 88240			
13. Location of Well UNIT LETTER G LOCATED 1980 FEET FROM THE North LINE AND 1980 FEET FROM THE East LINE OF SEC. 3 TWP. 19-N RGE. 35-E NMPM			
14. Proposed Depth 2615'		15. Formation Tubb	
16. History of C.T. Rotary			
17. County Union			
18. Kind & Status Plug. Bond Blanket-on-file		21. Drilling Contractor NA	
22. Approx. Date Work will start 1-30-81			

23.

PROPOSED CASING AND CEMENT PROGRAM

SIZE OF HOLE	SIZE OF CASING	WEIGHT PER FOOT	SETTING DEPTH	SACKS OF CEMENT	EST. TOP
12-1/4"	8-5/8"	24#	700'	Circ.	Surface
7-7/8"	5-1/2"	14#	2615'	Tie back to 8-5/8"	BTM 8-5/8"

Propose to drill and equip well in the Tubb formation. After reaching TD logs will be run and evaluated. Perforate and stimulate as necessary in attempting commercial production.

MUD PROGRAM: 0'-700' Native mud and fresh water  
700'-TD Commercial mud and brine with minimum properties for safe hole conditions.

BOP Program Attached  
Gas is not dedicated.

APPROVAL VALID FOR 180 DAYS  
PERMIT EXPIRES 8-1-81  
UNLESS DRILLING UNDERWAY

0+2-NMCCD, SF 1-Hou 1-Susp 1-BD

CONSERVATION DIST. DIV. OF NEW MEXICO  
WITHIN 24 HOURS OF BEGINNING OPERATIONS

IN ABOVE SPACE DESCRIBE PROPOSED PROGRAM: IF PROPOSAL IS TO DEEPEN OR PLUG BACK, GIVE DATA ON PRESENT PRODUCTIVE ZONE AND PROPOSED NEW PRODUCTIVE ZONE. GIVE BLOWOUT PREVENTER PROGRAM, IF ANY.

I hereby certify that the information above is true and complete to the best of my knowledge and belief.

Signed Bob Laws Title Admin. Analyst Date 1-27-81

(This space for State Use)

APPROVED BY Carl Ulvog TITLE SENIOR PETROLEUM GEOLOGIST DATE 2-2-81  
CONDITIONS OF APPROVAL, IF ANY:

**NEW MEXICO OIL CONSERVATION COMMISSION**  
**WELL LOCATION AND ACREAGE DEDICATION PLAT**

Form C-102  
 Supersedes C-128  
 Effective 1-1-65

All distances must be from the outer boundaries of the Section.

Operator <b>AMOCO</b>			Lessee <b>E. ROBERTS</b>		OIL CO. <b>STATE</b> DIVISION No. <b>1</b>	
Unit Letter <b>G</b>	Section <b>3</b>	Township <b>T19N</b>	Range <b>R35E</b>	County <b>UNION</b>		
Actual Footage Location of Well: <b>1980</b> feet from the <b>NORTH</b> line and <b>1980</b> feet from the <b>EAST</b> line						
Ground Level Elev. <b>458.5</b>	Producing Formation <b>Tubb</b>		Pool <b>Und. Tubb</b>		Dedicated Acreage: <b>160</b> Acres	

1. Outline the acreage dedicated to the subject well by colored pencil or hatchure marks on the plat below.
2. If more than one lease is dedicated to the well, outline each and identify the ownership thereof (both as to working interest and royalty).
3. If more than one lease of different ownership is dedicated to the well, have the interests of all owners been consolidated by communitization, unitization, force-pooling, etc?

☐ Yes    ☐ No    If answer is "yes," type of consolidation \_\_\_\_\_

If answer is "no," list the owners and tract descriptions which have actually been consolidated. (Use reverse side of this form if necessary.) \_\_\_\_\_

No allowable will be assigned to the well until all interests have been consolidated (by communitization, unitization, forced-pooling, or otherwise) or until a non-standard unit, eliminating such interests, has been approved by the Commission.

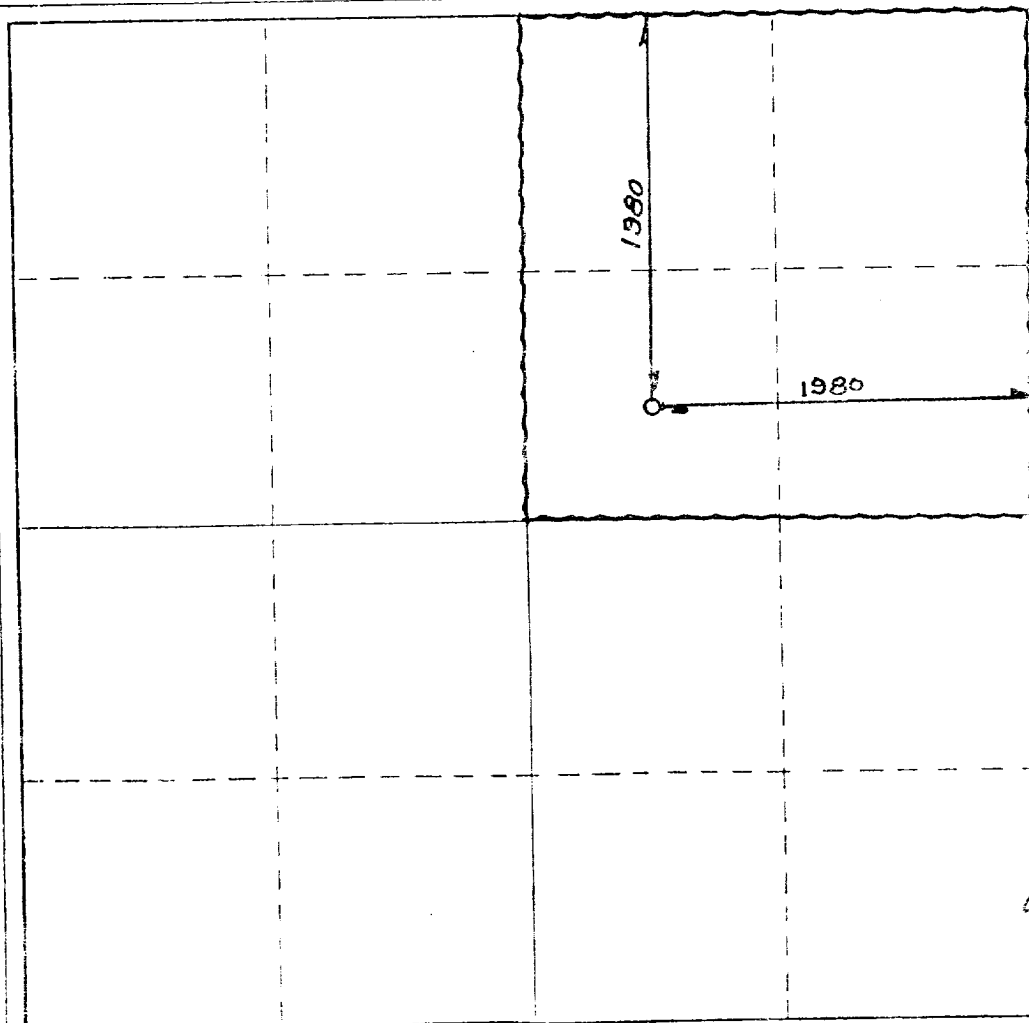

**CERTIFICATION**

*I hereby certify that the information contained herein is true and complete to the best of my knowledge and belief.*

Name **Bob Davis**  
 Position **Admin. Analyst**  
 Company **Amoco Production Company**  
 Date **1-27-81**

*I hereby certify that the well location shown on this plat was plotted from field notes of actual surveys made by me or under my supervision, and that the same is true and correct to the best of my knowledge and belief.*

**JAN. 12, 1981**

Date Surveyed  
 Registered Professional Engineer  
 or Land Surveyor

**N.M.L.S. NO. 5103**

Continue No.

0 330 660 990 1320 1650 1980 2310 2640 2970 3300 3630 3960 4290 4620 4950 5280 5610 5940 6270 6600

ATTACHMENT "B"  
NOTES

1. Blow-out preventers and master valve to be fluid operated and oil fittings must be in good condition, 3,000# W.P. (6,000 p.s.i. test), minimum.
2. Spoolport through which bit must pass shall be as large as the inside diameter of the casing that is being drilled through.
3. Nipple above blow-out preventer shall be same size as casing being drilled through.
4. Kelly lock required, 3,000# W.P. (6,000 p.s.i. test) minimum.
5. BOPD or comparable safety valve must be available on rig floor at all times with proper connection or sub, 3,000# W.P. (6,000 p.s.i. test), minimum.
6. Blow-out preventers and master valve while drilling intermediate hole to 6,000' may be 2,000# W.P. (4,000 p.s.i. test), minimum.
7. Choke assembly, beyond second valve from cross, may be positioned (Optional) outside of derrick foundation.
8. Spool or cross may be eliminated if connections are available in the lower part of the blow-out preventer body.
9. Plug valves - gate valves are optional. Valves shown as 2" are minimum size.
10. Casing head and casing head spool, including attached valves, to be furnished by Amoco.
11. Rams in preventers will be installed as follows:  

When drilling, use:	When running casing, use:
Top Preventer - Drill pipe rams	Top Preventer - Casing rams
Bottom Preventer - Blind rams or master valve	Bottom Preventer - Blind rams or master valve

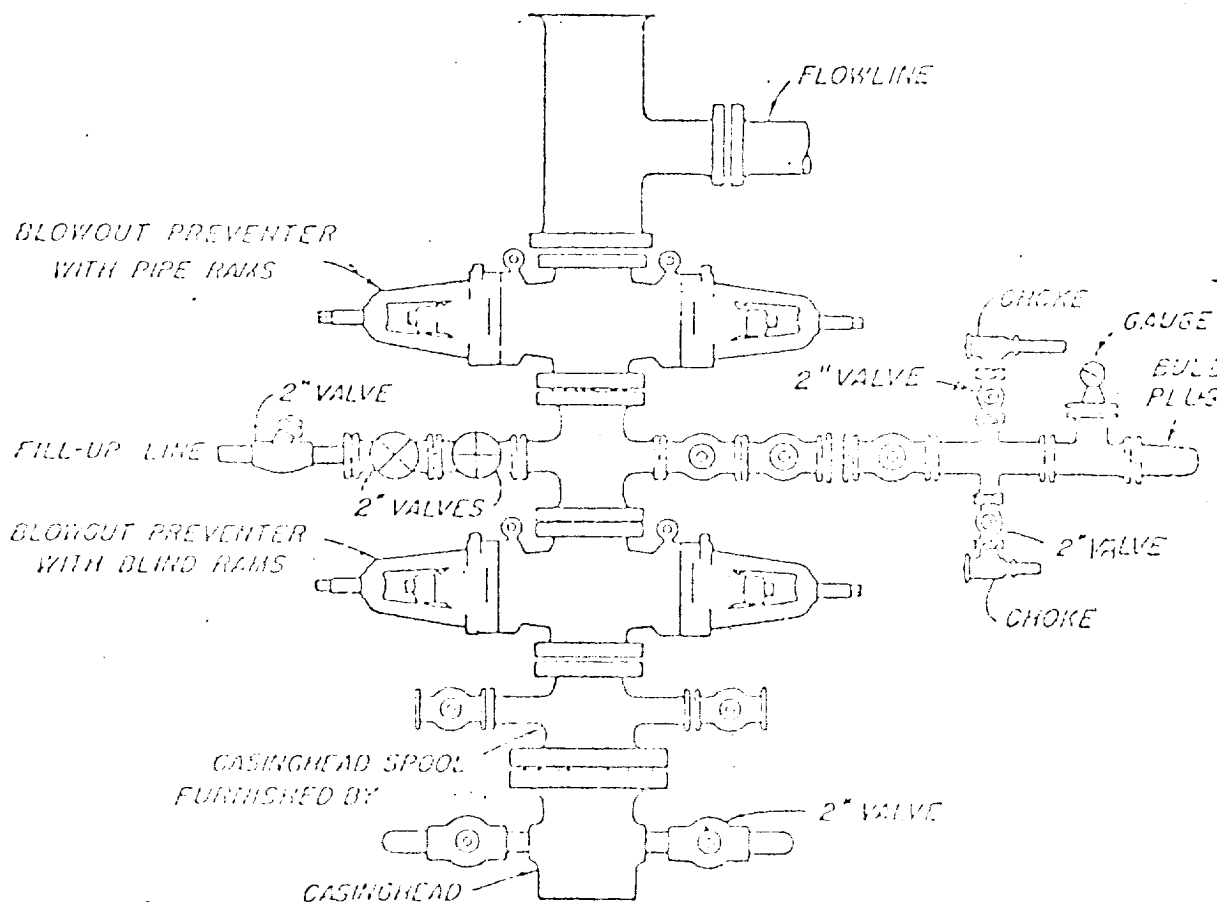

**BLOWOUT PREVENTER HOOK-UP**

AMOCO FIELD SERVICE COMPANY

**EXHIBIT D-1 MODIFIED**

JUNE 1, 1962