

NO. OF COPIES RECEIVED	
DISTRIBUTION	
SANTA FE	
FILE	<input checked="" type="checkbox"/>
U.S.G.S.	
LAND OFFICE	
OPERATOR	

NEW MEXICO OIL CONSERVATION COMMISSION

Form 7-101
Revised 1-1-80

API # 30-059-20106

APPLICATION FOR PERMIT TO DRILL, DEEPEN, OR PLUG BACK

1a. Type of Work		1. Unit Agreement Name	
b. Type of Well OIL WELL <input type="checkbox"/> GAS WELL <input checked="" type="checkbox"/> C02 OTHER		2. Firm or Lease Name Myklebust C	
2. Name of Operator Amoco Production Company		3. Well No. 1	
3. Address of Operator P. O. Box 68 Hobbs, NM 88240		4. Field and Pool, or Wildcat Und. Tubb	
4. Location of Well UNIT LETTER F LOCATED 1980 FEET FROM THE North LINE AND 1980 FEET FROM THE West LINE OF SEC. 21 TWP. 20-N RGE. 35-E N.M.P.M.		5. County Union	
6. Proposed Depth 2635'		7. Formation Tubb	
8. Rotary or C.T. Rotary		9. Approx. Date Work will start 2-23-81	
10. Elevations (Show whether DE, RT, etc.) 4630' GL		11. Kind & Status Play. Bond Blanket-on-file	
12. Drilling Contractor NA		13. Approx. Date Work will start 2-23-81	

PROPOSED CASING AND CEMENT PROGRAM

SIZE OF HOLE	SIZE OF CASING	WEIGHT PER FOOT	SETTING DEPTH	SACKS OF CEMENT	EST. TOP
12-1/4"	8-5/8"	24#	700'	Circ.	Surface
7-7/8"	5-1/2"	14#	2635'	Tie back to 8-5/8"	BTM 8-5/8"

Propose to drill and equip well in the Tubb formation. After reaching TD logs will be run and evaluated. Perforate and stimulate as necessary in attempting commercial production.

MUD PROGRAM: 0'-700' Native mud and fresh water
700'-TD Commercial mud and brine with minimum properties for safe hole conditions.

BOP Program Attached
Gas is not dedicated

0+2-NMOCD, SF 1-Hou 1-Susp 1-BD

APPROVAL VALID FOR 180 DAYS
PERMIT EXPIRES 8-19-81
UNLESS DRILLING UNDERWAY

IN ABOVE SPACE DESCRIBE PROPOSED PROGRAM; IF PROPOSAL IS TO DEEPEN OR PLUG BACK, GIVE DATA ON PRESENT PRODUCTIVE ZONE AND PROPOSED NEW PRODUCTIVE ZONE. GIVE BLOWOUT PREVENTER PROGRAM, IF ANY.

I hereby certify that the information above is true and complete to the best of my knowledge and belief.

Signed Bob Davis Title Admin. Analyst Date 2-17-81

(This space for State Use)

APPROVED BY Carl Hilwig TITLE State Engineer DATE 2/19/81

CONDITIONS OF APPROVAL, IF ANY:

NEW MEXICO OIL CONSERVATION COMMISSION
WELL LOCATION AND ACREAGE DEDICATION PLAT

Form C-102
Supersedes C-128
Effective 1-1-65

All distances must be from the outer boundaries of the Section.

Operator AMOCO		Lease MYKLEBUST C		Well No. 1
Unit Letter F	Section 21	Township T20N	Range R35E	County UNION
Actual Footage Location of Well: 1980 feet from the NORTH line and 1980 feet from the WEST line				
Ground Level Elev. 4630	Producing Formation Tubb	Pool Und. Tubb	Dedicated Acreage: 160 Acres	

1. Outline the acreage dedicated to the subject well by colored pencil or hatchure marks on the plat below.
2. If more than one lease is dedicated to the well, outline each and identify the ownership thereof (both as to working interest and royalty).
3. If more than one lease of different ownership is dedicated to the well, have the interests of all owners been consolidated by communitization, unitization, force-pooling, etc?

☐ Yes ☐ No If answer is "yes," type of consolidation _____

If answer is "no," list the owners and tract descriptions which have actually been consolidated. (Use reverse side of this form if necessary.) _____

No allowable will be assigned to the well until all interests have been consolidated (by communitization, unitization, forced-pooling, or otherwise) or until a non-standard unit, eliminating such interests, has been approved by the Commission.

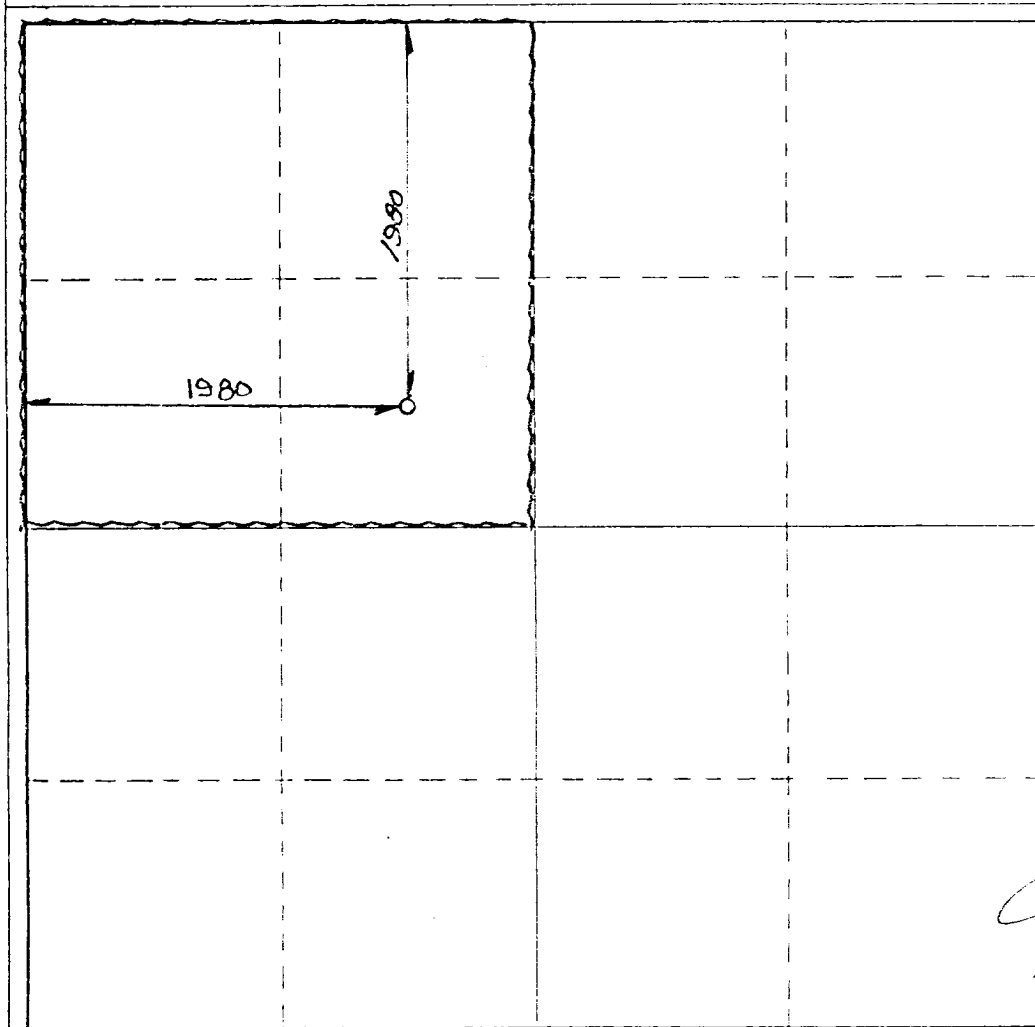

CERTIFICATION

I hereby certify that the information contained herein is true and complete to the best of my knowledge and belief.

Name **Bob Davis**
Position **Admin. Analyst**
Company **Amoco Production Company**
Date **2-17-81**

I hereby certify that the well location shown on this plat was plotted from field notes of actual surveys made by me or under my supervision, and that the same is true and correct to the best of my knowledge and belief.

FEB. 12, 1981

Date Surveyed **2-17-81**
Registered Professional Engineer
and/or Land Surveyor

N.M.L.S. NO. **5103**

Certificate No. **10103**

0 330 660 990 1320 1650 1980 2310 2640 2970 3300 3630 3960 4290 4620 4950 5280 5610 5940 6270 6600

NOTES

1. Blow-out preventers and master valve to be fluid operated and oil fittings must be in good condition, 3,000# W.P. (6,000 p.s.i. test), minimum.
2. Equipment through which bit must pass shall be as large as the inside diameter of the casing that is being drilled through.
3. Nipple above blow-out preventer shall be same size as casing being drilled through.
4. Kelly cock required, 3,000# W.P. (6,000 p.s.i. test) minimum.
5. CMO or comparable safety valve must be available on rig floor at all times with proper connection or sub, 3,000# W.P. (6,000 p.s.i. test), minimum.
6. Blow-out preventers and master valve while drilling intermediate hole to 6000' may be 2,000# W.P. (4,000 p.s.i. test), minimum.
7. Choke assembly, beyond second valve from cross, may be positioned (Optional) outside of derrick foundation.
8. Spool or cross may be eliminated if connections are available in the lower part of the blow-out preventer body.
9. Plug valves - gate valves are optional. Valves shown as 2" are minimum size.
10. Casing head and casing head spool, including attached valves, to be furnished by Amco.
11. Parts in preventers will be installed as follows:
 When drilling, use:
 Top Preventer - Drill pipe rams
 Bottom Preventer - Blind rams or master valve
 When running casing, use:
 Top Preventer - Casing rams
 Bottom Preventer - Blind rams or master valve

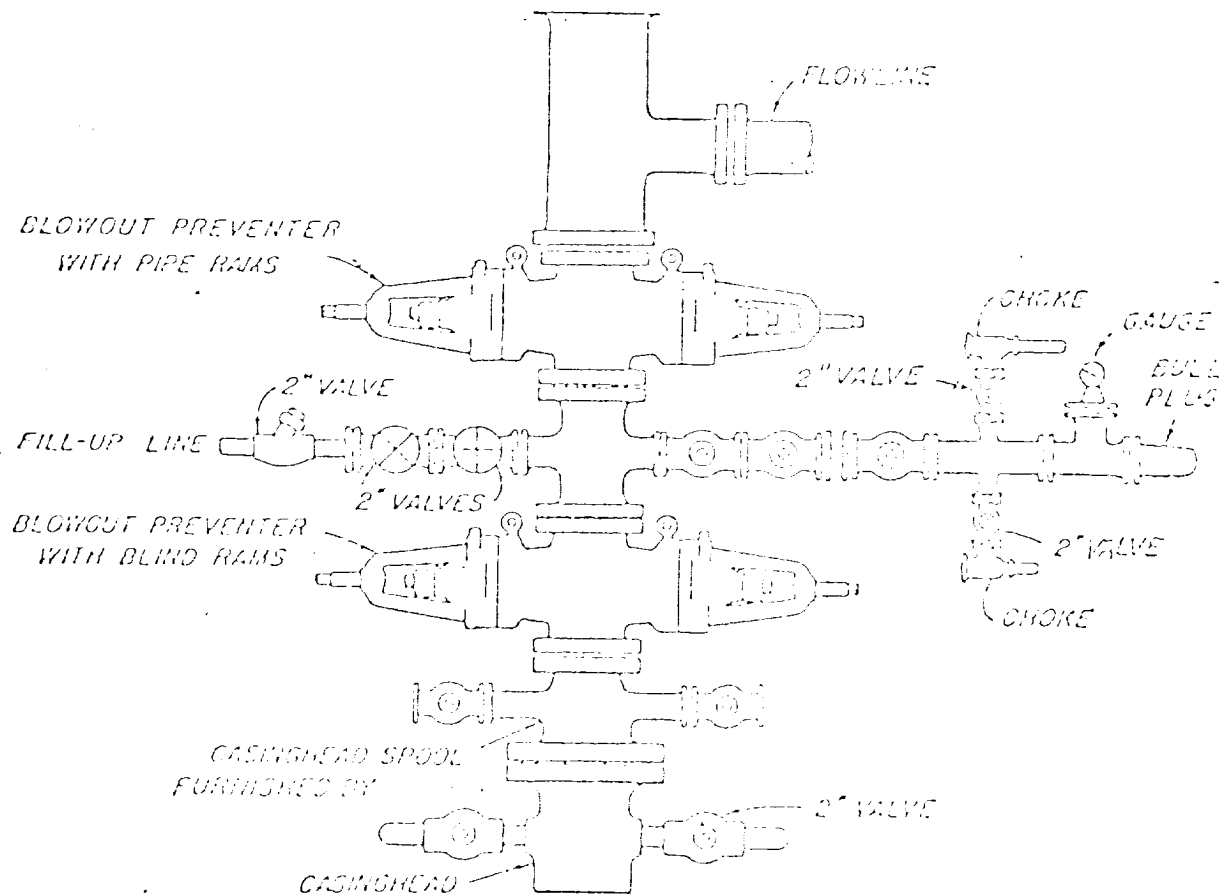

BLOWOUT PREVENTER HOOK-UP

AMCO FIELD SERVICE COMPANY

EXHIBIT D-1 MODIFIED

JUNE 1, 1962