

NO. OF COPIES RECEIVED	
DISTRIBUTION	
SANTA FE	
FILE	<input checked="" type="checkbox"/>
U.S.G.S.	
LAND OFFICE	
OPERATOR	

NEW MEXICO OIL CONSERVATION COMMISSION

API # 30-059-20130

Form C-101
Revised 1-8-81

5A. Indicate Type of Lease
STATE <input checked="" type="checkbox"/> FEE <input type="checkbox"/>
5. State Oil & Gas Lease No.
7. Unit Agreement Name
8. Firm or Lease Name
State LX
9. Well No.
1
10. Field and Pool, or Wildcat
Und. Tubb
12. County
Union
19. Proposed Depth
3880'
19A. Formation
Tubb
20. Rotary or C.T.
Rotary
21. Approx. Date Work will start
3-25-81

APPLICATION FOR PERMIT TO DRILL, DEEPEN, OR PLUG BACK			
1a. Type of Work			
b. Type of Well			
DRILL <input checked="" type="checkbox"/> DEEPEN <input type="checkbox"/> PLUG BACK <input type="checkbox"/>			
OIL WELL <input type="checkbox"/> GAS WELL <input checked="" type="checkbox"/> CO2 OTHER <input type="checkbox"/>			
2. Name of Operator			
Amoco Production Company			
3. Address of Operator			
P. O. Box 68 Hobbs, NM 88240			
4. Location of Well			
UNIT LETTER G LOCATED 1980 FEET FROM THE North LINE			
AND 1980 FEET FROM THE East LINE OF SEC. 35 TWP. 24-N R. 33-E N. 10.00			
21. Elevation (Show whether D.F., R.I., etc.)			
5185 GL			
21A. Kind & Status Plug. Bond			
Blanket-on-file			
21B. Drilling Contractor			
NA			

PROPOSED CASING AND CEMENT PROGRAM

SIZE OF HOLE	SIZE OF CASING	WEIGHT PER FOOT	SETTING DEPTH	SACKS OF CEMENT	EST. TOP
12-1/4"	8-5/8"	24#	700'	Circ.	Surface
7-7/8"	5-1/2"	14#	3880'	Tie back to 8-5/8"	BTM 8-5/8"

Propose to drill and equip well in the Tubb formation. After reaching TD logs will be run and evaluated. Perforate and stimulate as necessary in attempting commercial production.

MUD PROGRAM: 0'-700' Native mud and fresh water
700'-TD Commercial mud and brine with minimum properties for safe hole conditions.

BOP Program Attached.
Gas is not dedicated.

0+2-NMOCD, SF 1-Hou 1-Susp 1-BD APPROVAL VALID FOR 180 DAYS
PERMIT EXPIRES 9-20-81
UNLESS DRILLING UNDERWAY

IN ABOVE SPACE DESCRIBE PROPOSED PROGRAM: IF PROPOSAL IS TO DEEPEN OR PLUG BACK, GIVE DATA ON PRESENT PRODUCTIVE ZONE AND PROPOSED NEW PRODUCTIVE ZONE. GIVE BLOWOUT PREVENTER PROGRAM, IF ANY.

I hereby certify that the information above is true and complete to the best of my knowledge and belief.

Signed Bob Davis Title Admin. Analyst Date 3-20-81
(This space for State Use)

APPROVED BY Carl Ulvog TITLE ADMINISTRATOR DATE 3/24/81
CONDITIONS OF APPROVAL, IF ANY:

NEW MEXICO OIL CONSERVATION COMMISSION
WELL LOCATION AND ACREAGE DEDICATION PLAT

Form C-102
Supersedes C-128
Effective 1-1-65
SECTION

All distances must be from the outer boundaries of the Section.

Operator AMOCO		Lease STATE LX		Well No. 1	
Unit Letter G	Section 35	Township T24N	Range R33E	County UNION	
Actual Footing Location of Well: 1980 feet from the NORTH line on the 1980 line on the EAST line					
Ground Level Elev. 5185	Producing Formation Tlbb		Pool Und. Tubb		Dedicated Acreage: 160 Acres

1. Outline the acreage dedicated to the subject well by colored pencil or hatchure marks on the plat below.
2. If more than one lease is dedicated to the well, outline each and identify the ownership thereof (both as to working interest and royalty).
3. If more than one lease of different ownership is dedicated to the well, have the interests of all owners been consolidated by communization, unitization, force-pooling, etc?

☐ Yes ☐ No If answer is "yes," type of consolidation _____

If answer is "no," list the owners and tract descriptions which have actually been consolidated. (Use reverse side of this form if necessary.) _____

No allowable will be assigned to the well until all interests have been consolidated (by communization, unitization, forced-pooling, or otherwise) or until a non-standard unit, eliminating such interests, has been approved by the Commission.

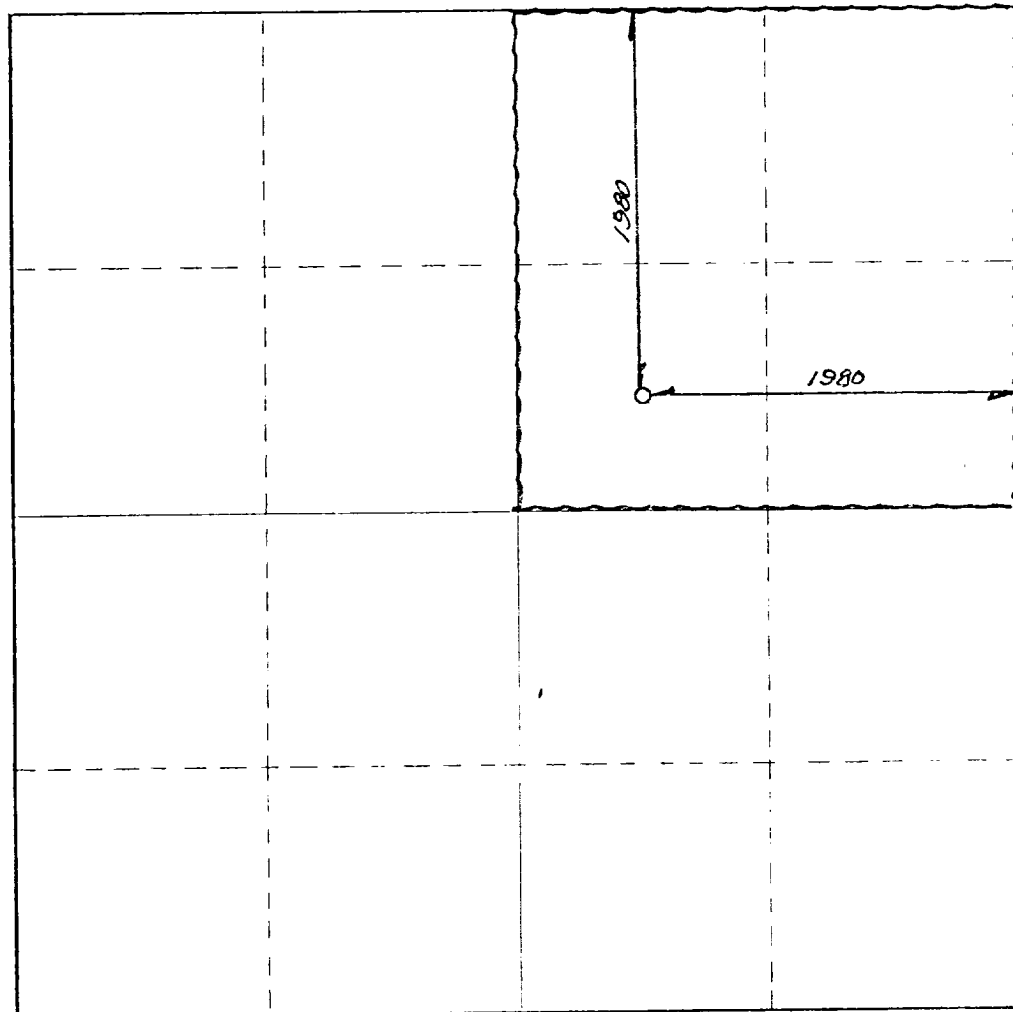

CERTIFICATION

I hereby certify that the information contained herein is true and complete to the best of my knowledge and belief.

Name **Bob Davis**
Position **Admin. Analyst**
Company **Amoco Production Company**
Date **3-20-81**

I hereby certify that the well location shown on this plat was plotted from field notes of actual surveys made by me or under my supervision, and that the same is true and correct to the best of my knowledge and belief.

MARCH 16 1981

Date Surveyed **3-2-81**
W. E. Achille
Registered Professional Engineer
and/or Land Surveyor
N.M.L.S. 5103
Certificate No. C. 5103

0 330 660 990 1320 1650 1980 2310 2640 2970 3300 3630 3960 4290 4620 4950 5280 5610 5940 6270 6600 6930 7260 7590 7920 8250 8580 8910 9240 9570 9900 0

ATTACHMENT "B"
NOTES

1. Blow-out preventers and master valve to be fluid operated and oil fittings must be in good condition, 3,000# W.P. (6,000 p.s.i. test), minimum.
2. Equipment through which bit must pass shall be as large as the inside diameter of the casing that is being drilled through.
3. Nipple above blow-out preventer shall be same size as casing being drilled through.
4. Kelly cock required, 3,000# W.P. (6,000 p.s.i. test) minimum.
5. OMSCO or comparable safety valve must be available on rig floor at all times with proper connection or sub, 3,000# W.P. (6,000 p.s.i. test), minimum.
6. Blow-out preventers and master valve while drilling intermediate hole to 6000' may be 2,000# W.P. (4,000 p.s.i. test), minimum.
7. Choke assembly, beyond second valve from cross, may be positioned (Optional) outside of derrick foundation.
8. Spool or cross may be eliminated if connections are available in the lower part of the blow-out preventer body.
9. Plug valves - gate valves are optional. Valves shown as 2" are minimum size.
10. Casing head and casing head spool, including attached valves, to be furnished by Amoco.
11. Rams in preventers will be installed as follows:

When drilling, use:	When running casing, use:
Top Preventer - Drill pipe rams	Top Preventer - Casing rams
Bottom Preventer - Blind rams or master valve	Bottom Preventer - Blind rams or master valve

ILLEGIBLE

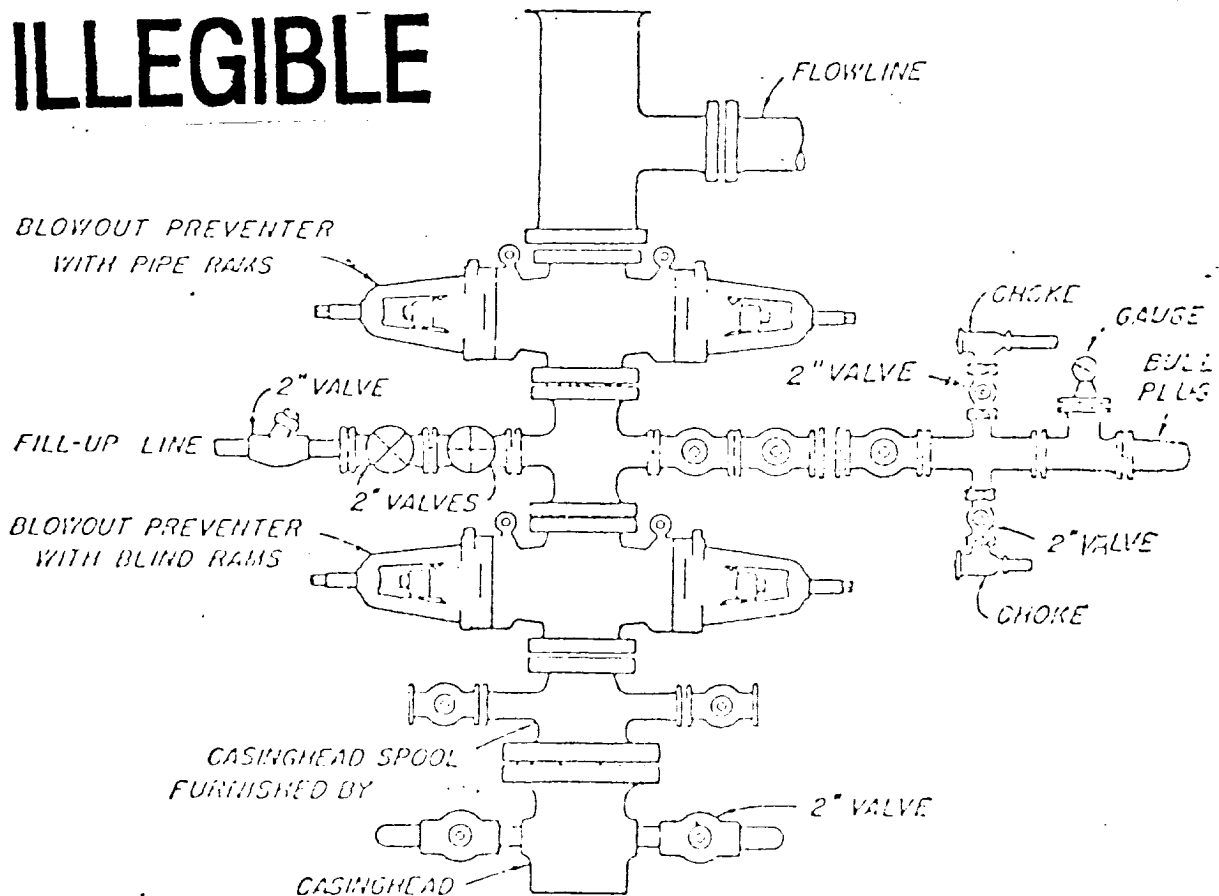

BLOWOUT PREVENTER HOOK-UP

AMOCO PRODUCTION COMPANY

EXHIBIT D-1 MODIFIED

JUNE 1, 1962